



US00D471869S

(12) **United States Design Patent**
Hirose

(10) **Patent No.:** **US D471,869 S**

(45) **Date of Patent:** **** Mar. 18, 2003**

(54) **ELECTRICAL CONNECTOR**

(75) Inventor: **Kumi Hirose**, Utsunomiya (JP)

(73) Assignee: **Japan Aviation Electronics Industry, Limited**, Tokyo (JP)

(**) Term: **14 Years**

(21) Appl. No.: **29/151,755**

(22) Filed: **Dec. 6, 2001**

(30) **Foreign Application Priority Data**

Jun. 6, 2001 (JP) 2001-020242

(51) **LOC (7) Cl.** **13-03**

(52) **U.S. Cl.** **D13/147**

(58) **Field of Search** D13/147; 439/260,
439/329, 492, 495, 570

(56) **References Cited**

U.S. PATENT DOCUMENTS

- 5,690,510 A * 11/1997 Chishima 439/496
- 5,695,359 A * 12/1997 Fujikura et al. 439/495
- 5,800,204 A * 9/1998 Niitsu 439/495
- 5,842,883 A * 12/1998 Igarashi et al. 439/495
- 6,004,156 A * 12/1999 Roque et al. 439/495

- 6,039,610 A * 3/2000 Pauza et al. 439/682
- 6,042,408 A * 3/2000 Noro 439/260
- 6,250,959 B1 * 6/2001 Yamaguchi et al. 439/578
- 6,338,648 B1 * 1/2002 Miura et al. 439/495

* cited by examiner

Primary Examiner—Joel Sincavage

(74) *Attorney, Agent, or Firm*—Michael Best & Friedrich LLC

(57) **CLAIM**

The ornamental design for an electrical connector, as shown and described.

DESCRIPTION

FIG. 1 is a front elevational view of an electrical connector; FIG. 2 is a rear elevational view thereof; FIG. 3 is a right side elevational view thereof; FIG. 4 is a top plan view thereof; FIG. 5 is a bottom plan view thereof; and, FIG. 6 is a perspective view of the front and right side thereof.

A left side elevational view of the electrical connector is omitted because it is presented symmetrical to the right side elevational view of FIG. 3.

1 Claim, 5 Drawing Sheets

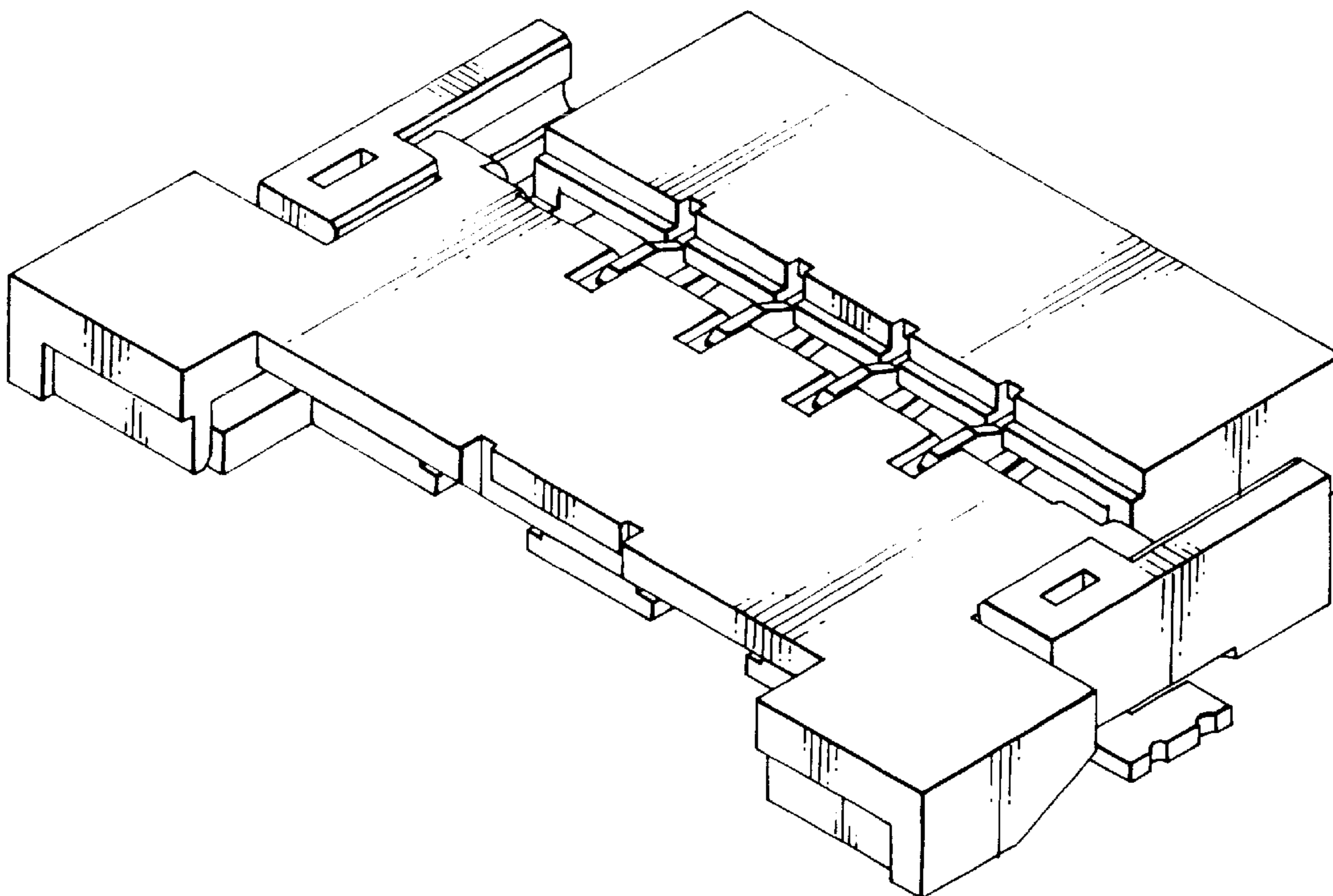

FIG. 1

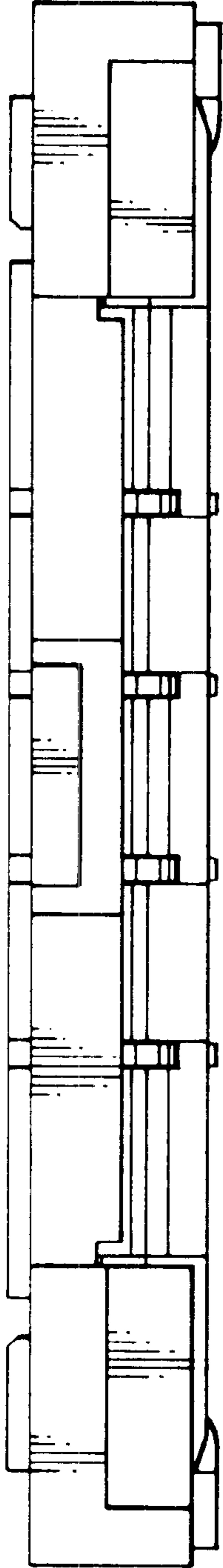

FIG. 2

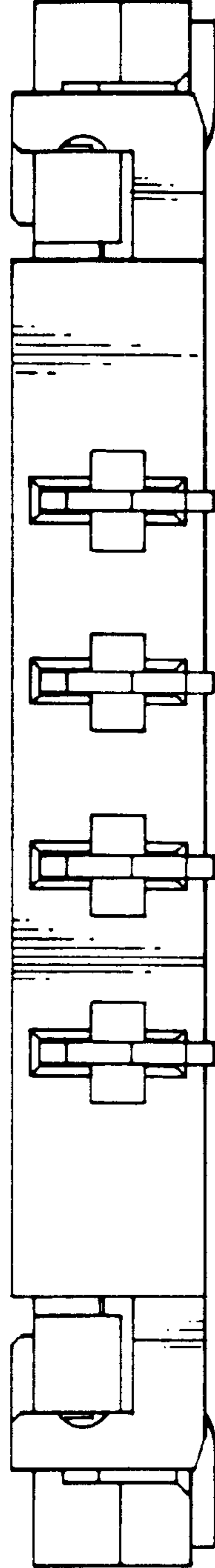

FIG. 3

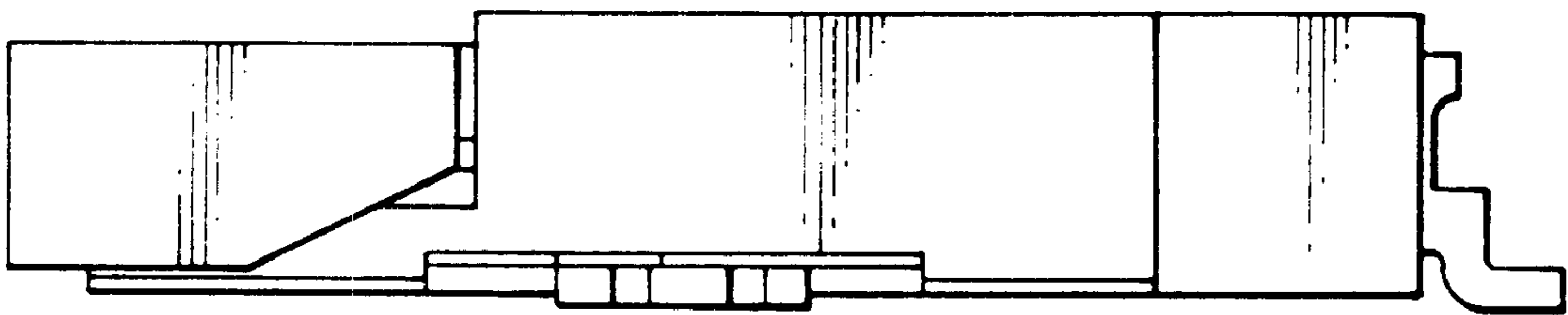
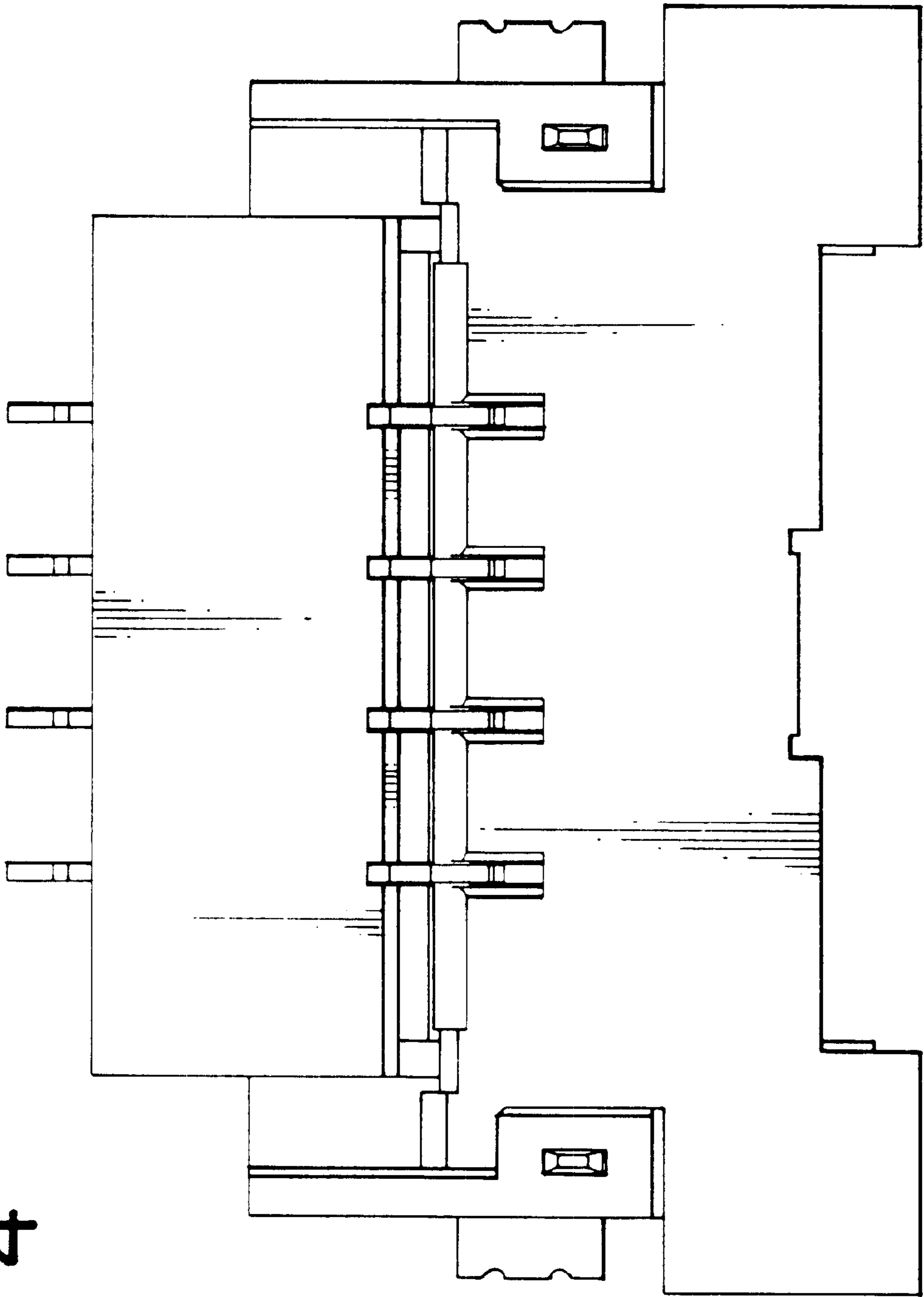

FIG. 4



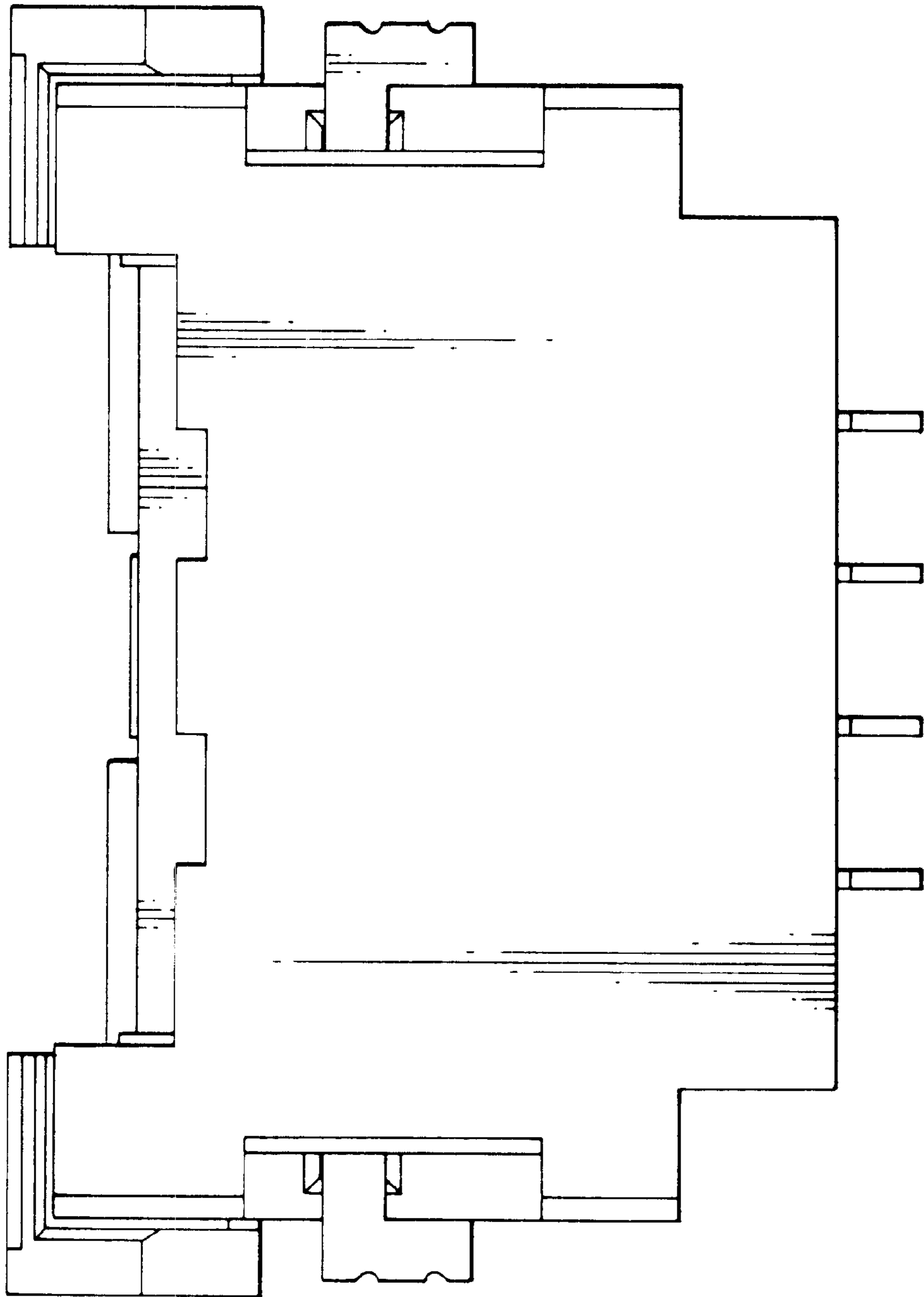

FIG. 5

FIG. 6

