



US00D471784S

(12) **United States Design Patent**
Garvis et al.

(10) **Patent No.:** **US D471,784 S**
(45) **Date of Patent:** **** Mar. 18, 2003**

(54) **BODY FOR HAND HELD MACHINE TOOL**
(75) Inventors: **Conrad A. Garvis**, Mason, OH (US);
Paul Patterson, Cincinnati, OH (US);
Kenneth P. Richied, Liberty Township,
OH (US); **John T. Burke**,
Williamsburg, OH (US)

5,653,294 A * 8/1997 Thurler 81/489
D394,995 S * 6/1998 Cooper D8/68
D415,002 S 10/1999 Rogers et al. D8/69
D416,182 S 11/1999 Kaiser et al. D8/61
D416,775 S 11/1999 Hwang et al. D8/69
5,984,022 A * 11/1999 Harman, Jr. et al. 81/57.11
D420,878 S 2/2000 Li D8/69
6,124,652 A * 9/2000 Karasa et al. 310/50

(73) Assignee: **Senco Products, Inc.**, Cincinnati, OH
(US)

* cited by examiner

(**) Term: **14 Years**

Primary Examiner—Doris V. Coles

Assistant Examiner—T. Chase Nelson

(74) *Attorney, Agent, or Firm*—Frost Brown Todd LLC

(21) Appl. No.: **29/154,982**

(22) Filed: **Feb. 1, 2002**

(51) **LOC (7) Cl.** **08-05**

(52) **U.S. Cl.** **D8/68**

(58) **Field of Search** D8/61, 62, 63,
D8/64, 65, 66, 67, 68, 69, 70; 81/57.11,
429, 464, 465, 466, 469, 489; 173/13, 169,
178, 213, 217; 227/8, 114, 120, 130, 136,
142; 310/50; 408/20, 124, 125, 234, 241 R;
451/358

(56) **References Cited**

U.S. PATENT DOCUMENTS

D221,206 S * 7/1971 Yran D8/68
3,699,366 A * 10/1972 Wood 310/50
3,724,237 A * 4/1973 Wood 81/489
D246,946 S 1/1978 Schultz D8/68
D256,771 S * 9/1980 Kitagawa et al. D8/68
D260,354 S 8/1981 Proops et al. D8/61
4,730,134 A * 3/1988 Sistare 310/50
D337,710 S 7/1993 Lui et al. D8/68
5,447,205 A * 9/1995 Thurler 173/217

(57) **CLAIM**

The ornamental design for a body for hand held machine tool, as shown and described.

DESCRIPTION

FIG. 1 is a perspective view of a body for hand held machine tool showing our new design.

FIG. 2 is a left side elevational view of the body for hand held machine tool shown in FIG. 1.

FIG. 3 is a right side elevational view of the body for hand held machine tool shown in FIG. 1.

FIG. 4 is a top view of the body for hand held machine tool shown in FIG. 1.

FIG. 5 is a bottom view of the body for hand held machine tool shown in FIG. 1.

FIG. 6 is a rear elevational view of the body for hand held machine tool shown in FIG. 1; and,

FIG. 7 is a front elevational view of the body for hand held machine tool shown in FIG. 1.

The broken lines in the drawings are for illustrative purposes only and form no part of the claimed design.

1 Claim, 5 Drawing Sheets

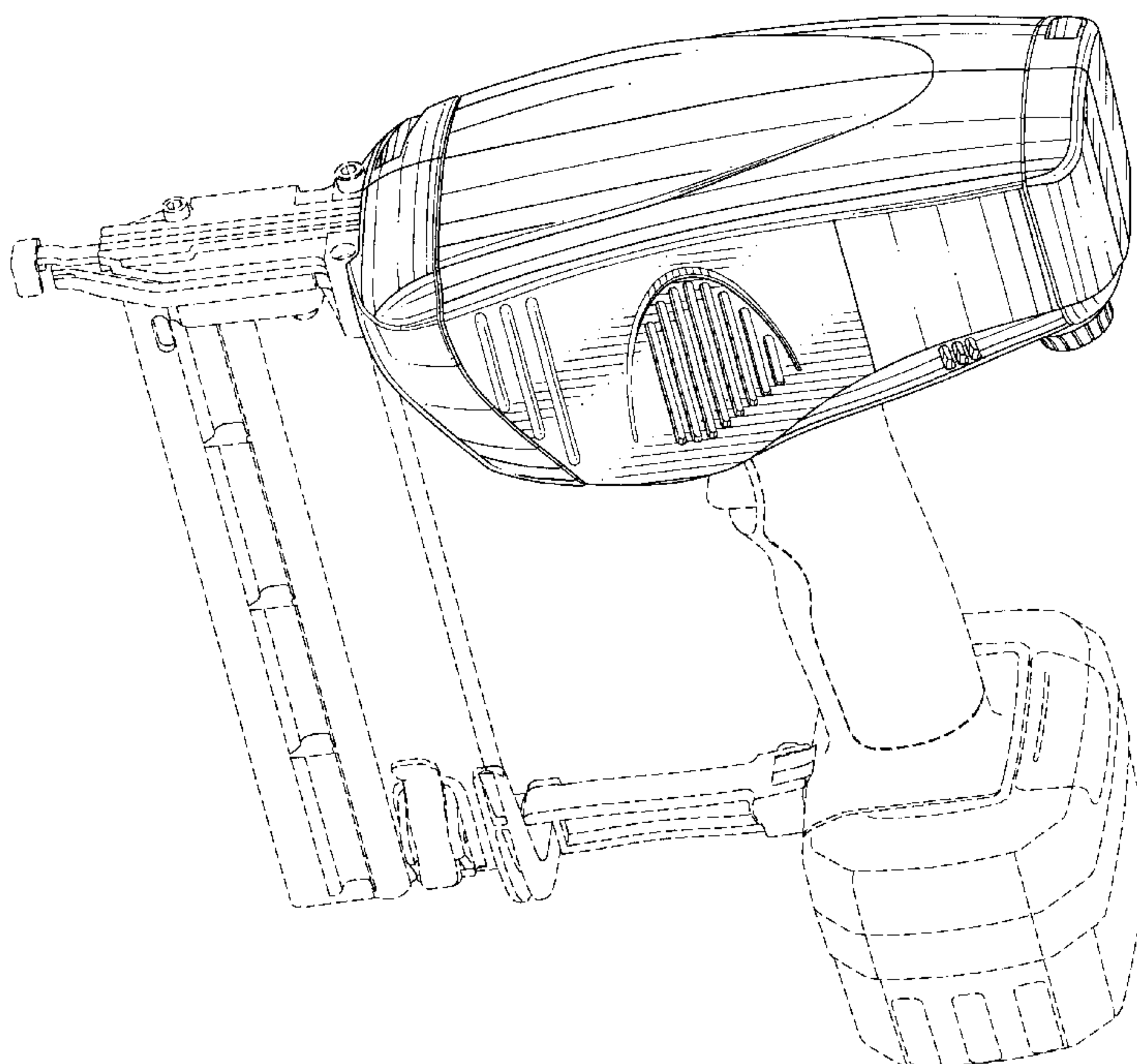

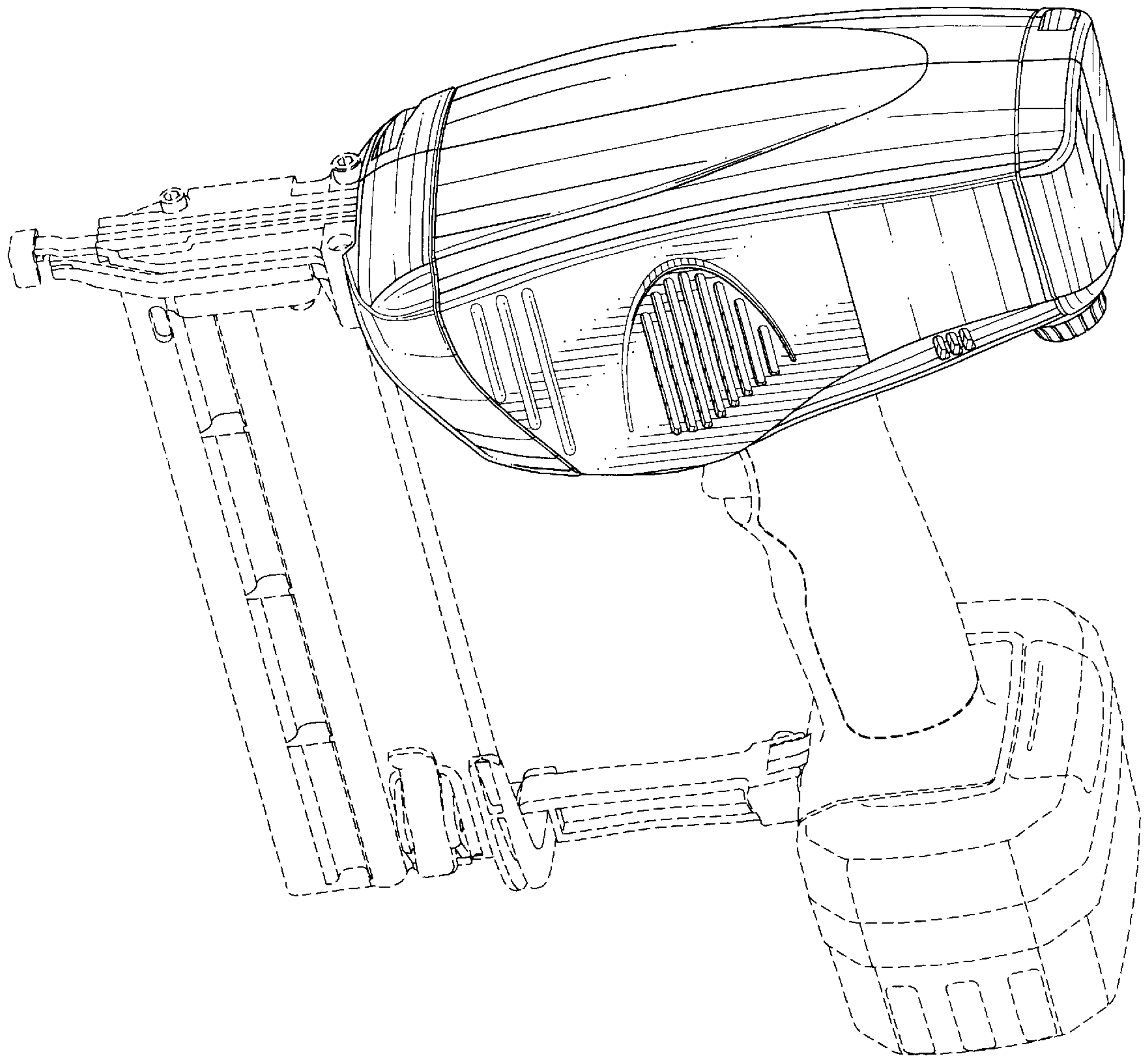

FIG. 1

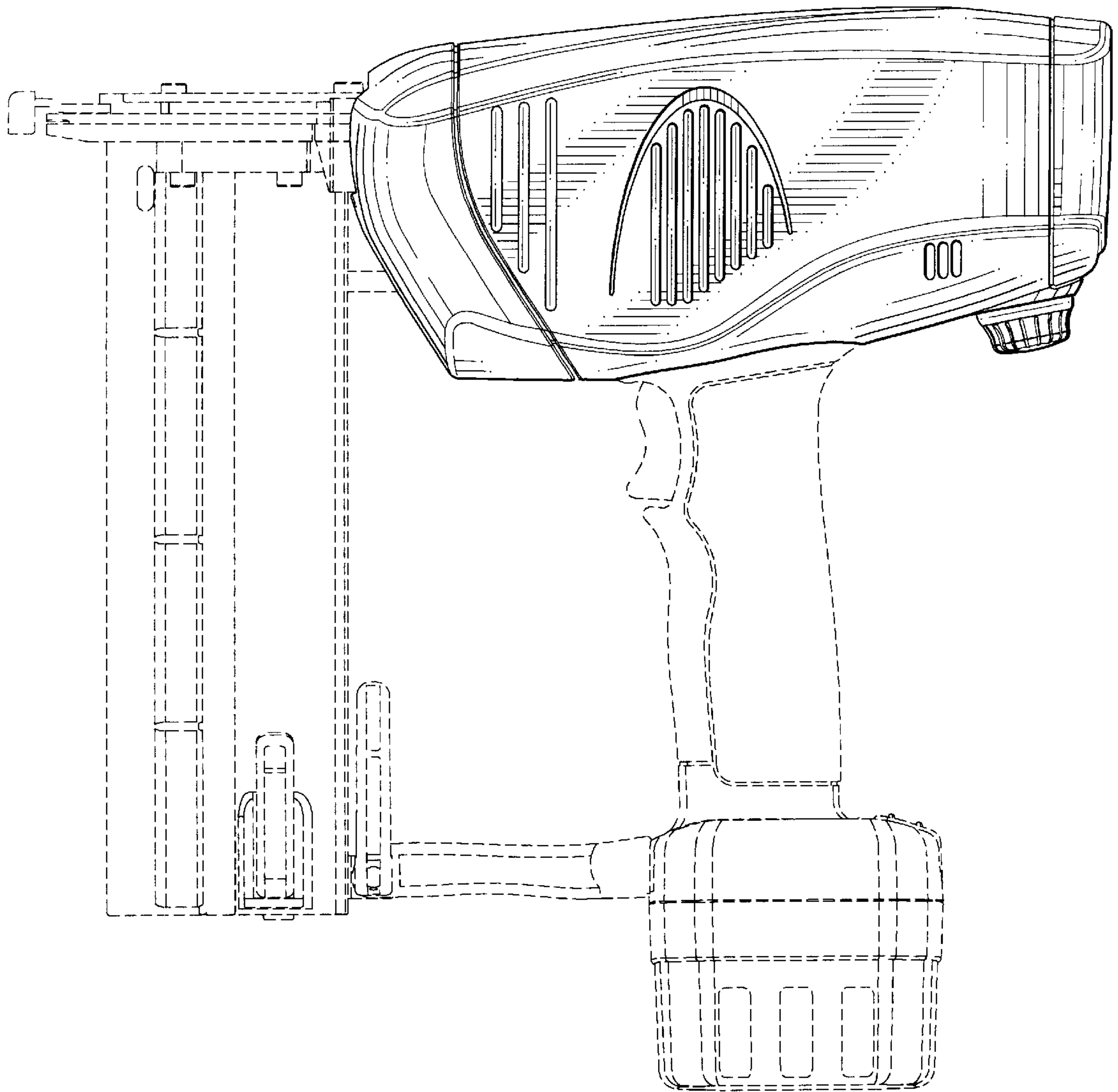

FIG. 2

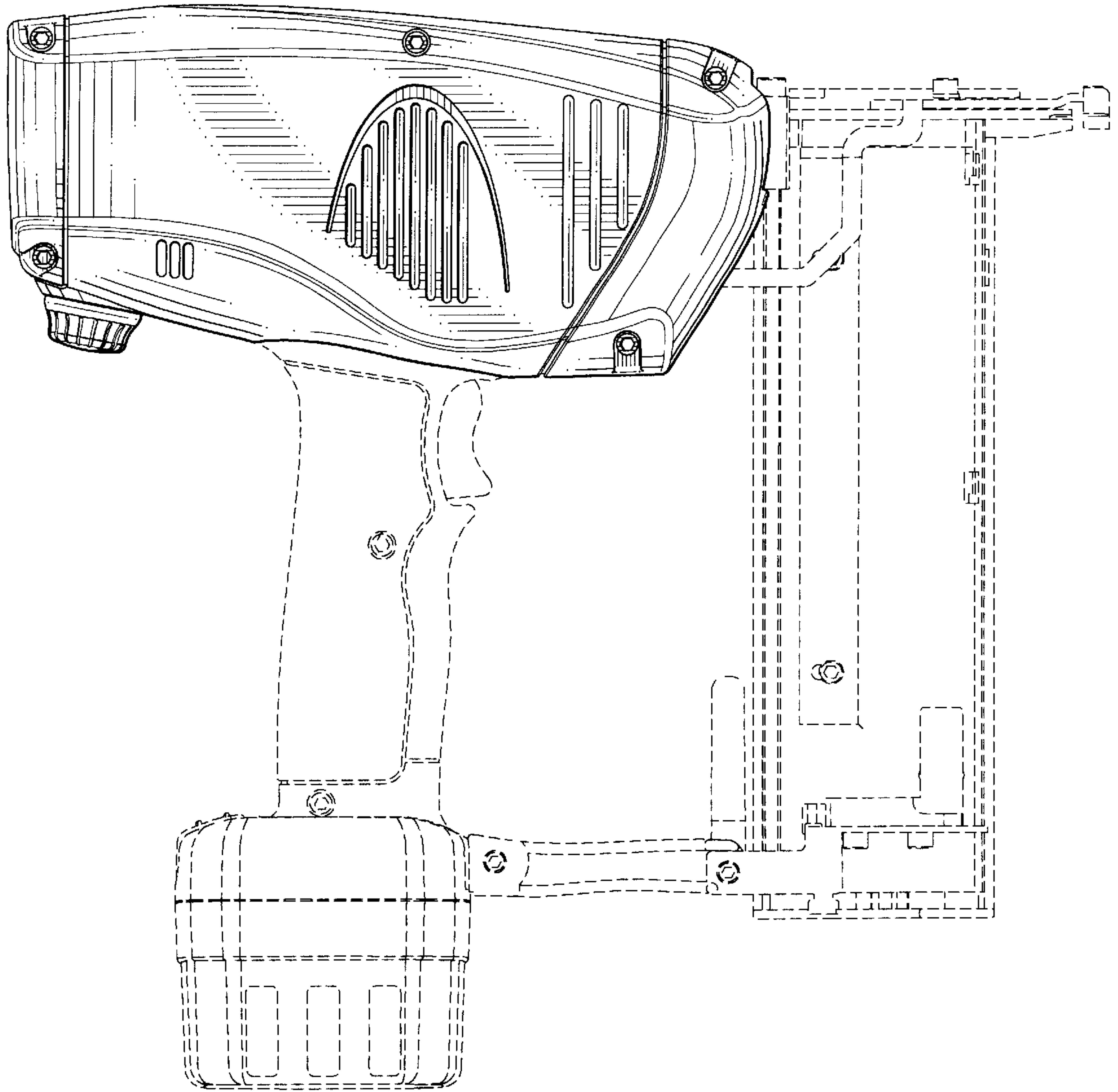

FIG. 3

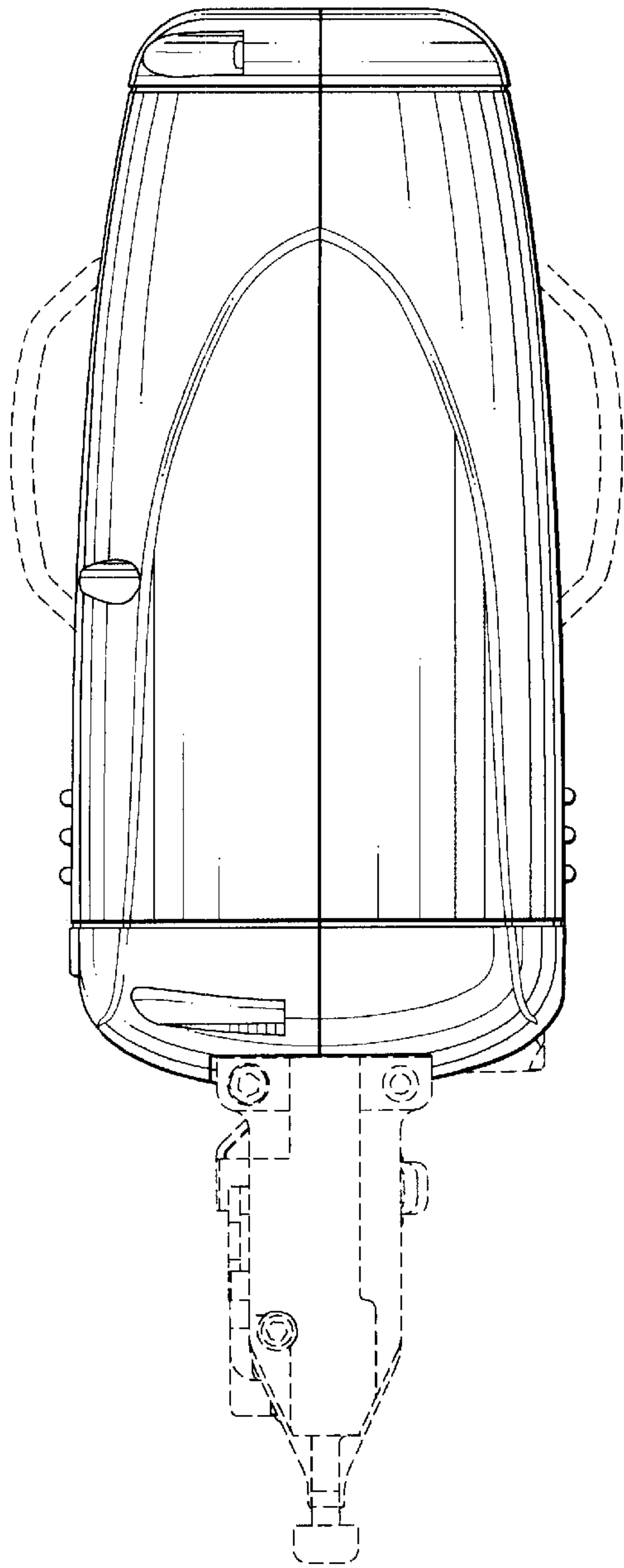

FIG. 4

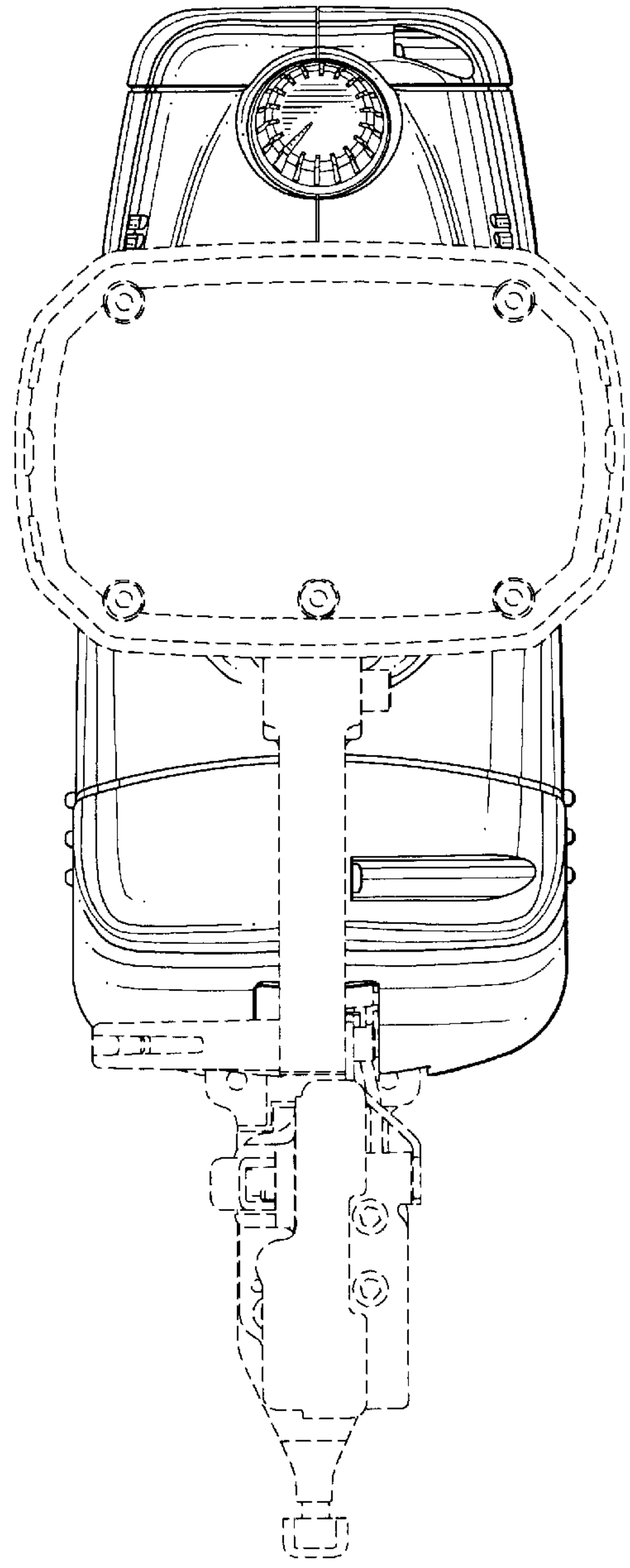

FIG. 5

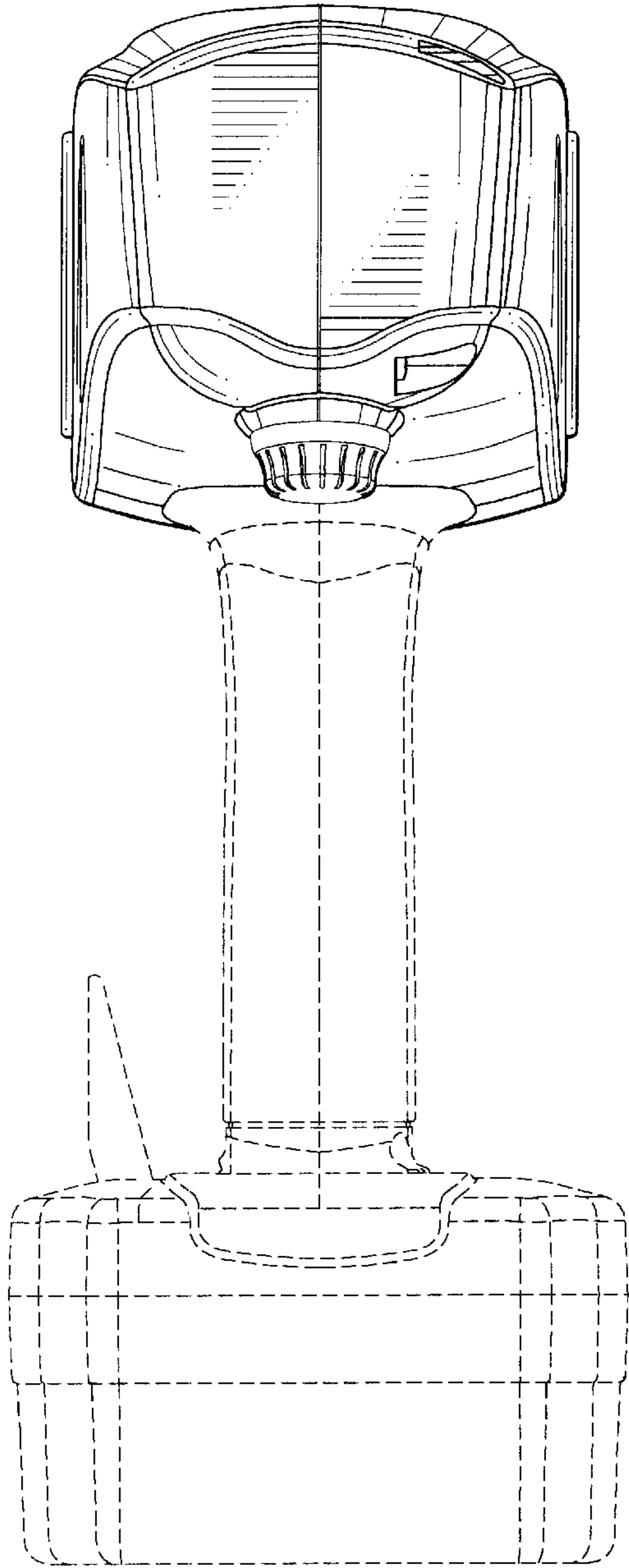

FIG. 6

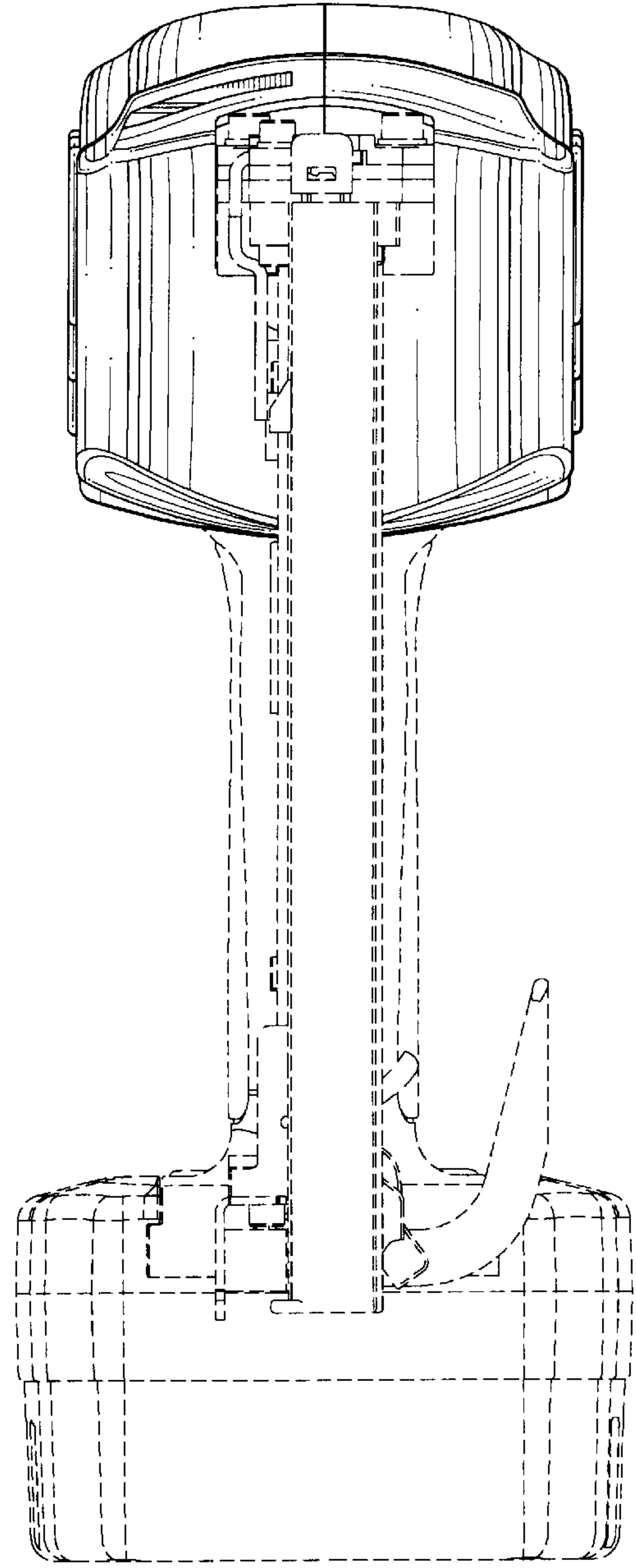

FIG. 7