



US00D470242S

(12) **United States Design Patent**  
**Reithmeyer et al.**

(10) **Patent No.:** **US D470,242 S**

(45) **Date of Patent:** **\*\* Feb. 11, 2003**

(54) **SLAB DOOR PORTION**

(75) Inventors: **Joseph Guy Reithmeyer**, Afton, MN (US); **James Brian Libby**, Stillwater, MN (US)

(73) Assignee: **Andersen Corporation**, Bayport, MN (US)

(\*\*) Term: **14 Years**

(21) Appl. No.: **29/144,667**

(22) Filed: **Jul. 6, 2001**

(51) **LOC (7) Cl.** ..... **25-02**

(52) **U.S. Cl.** ..... **D25/48**

(58) **Field of Search** ..... D25/48, 136, 138; 52/455

D265,929 S	*	8/1982	Simpson	.....	D25/48
D265,932 S		8/1982	Simpson		
4,430,836 A		2/1984	McKann		
5,022,206 A		6/1991	Schild et al.		
5,074,087 A		12/1991	Green		
5,175,970 A		1/1993	Green		

**OTHER PUBLICATIONS**

Stanley Entry Door Systems Brochure, 48 pages, copyright date 1999.

\* cited by examiner

*Primary Examiner*—Doris Clark

(74) *Attorney, Agent, or Firm*—Merchant & Gould P.C.

(57) **CLAIM**

The ornamental design for slab door portion, as shown and described.

(56) **References Cited**

**U.S. PATENT DOCUMENTS**

916,128 A	3/1909	Ellis
1,312,925 A	8/1919	Ruehlmann
3,760,543 A	9/1973	McAllister
4,152,876 A	5/1979	Seely
D255,838 S	7/1980	Emanuel
4,327,535 A	5/1982	Governale

**DESCRIPTION**

FIG. 1 is a front view of a slab door portion; and, FIG. 2 is a cross-sectional view taken along line 2—2 in FIG. 1 of the new design. The broken lines are for illustrative purposes only and form no part of the claimed design.

**1 Claim, 2 Drawing Sheets**

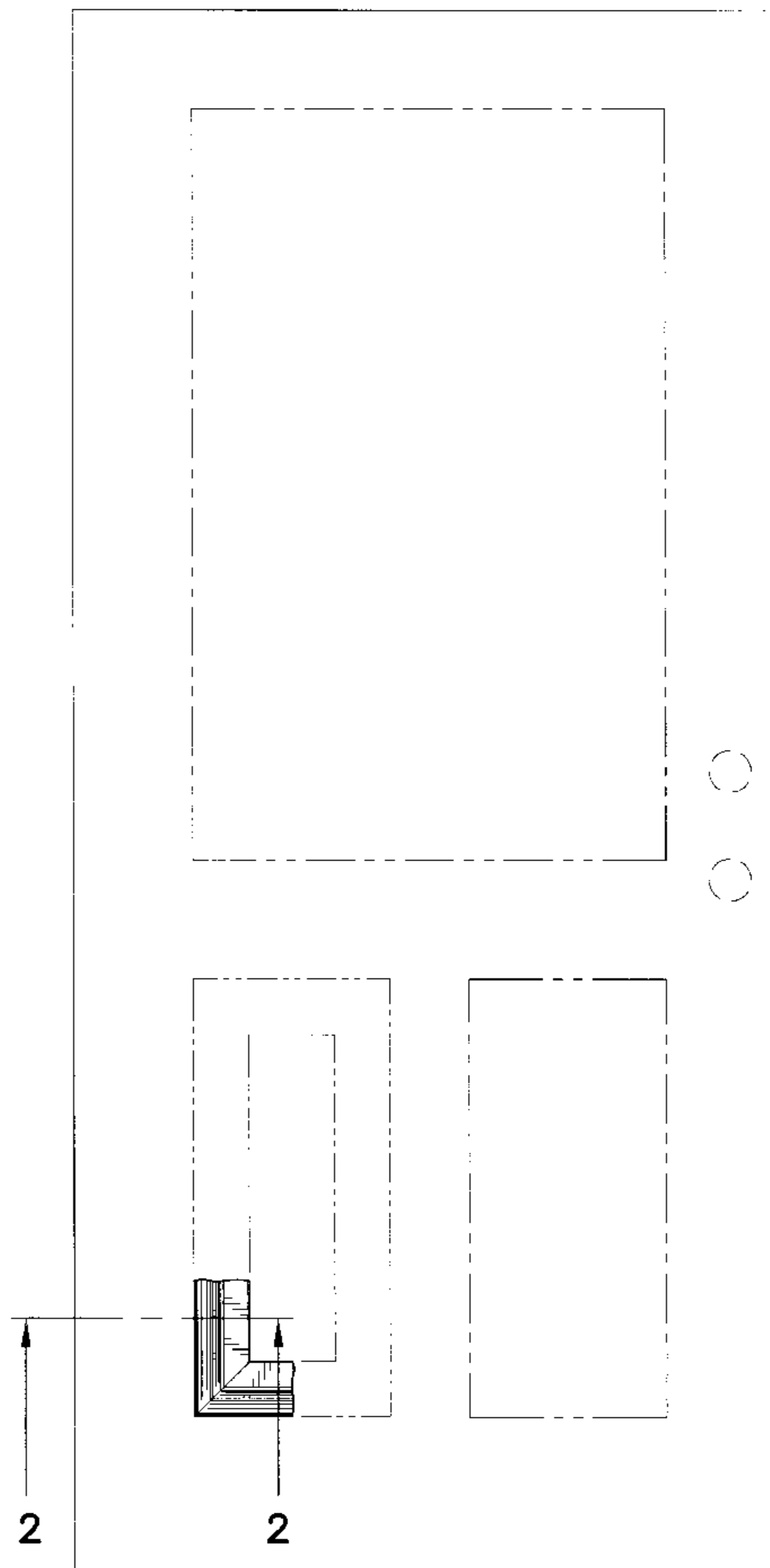

FIG. 1

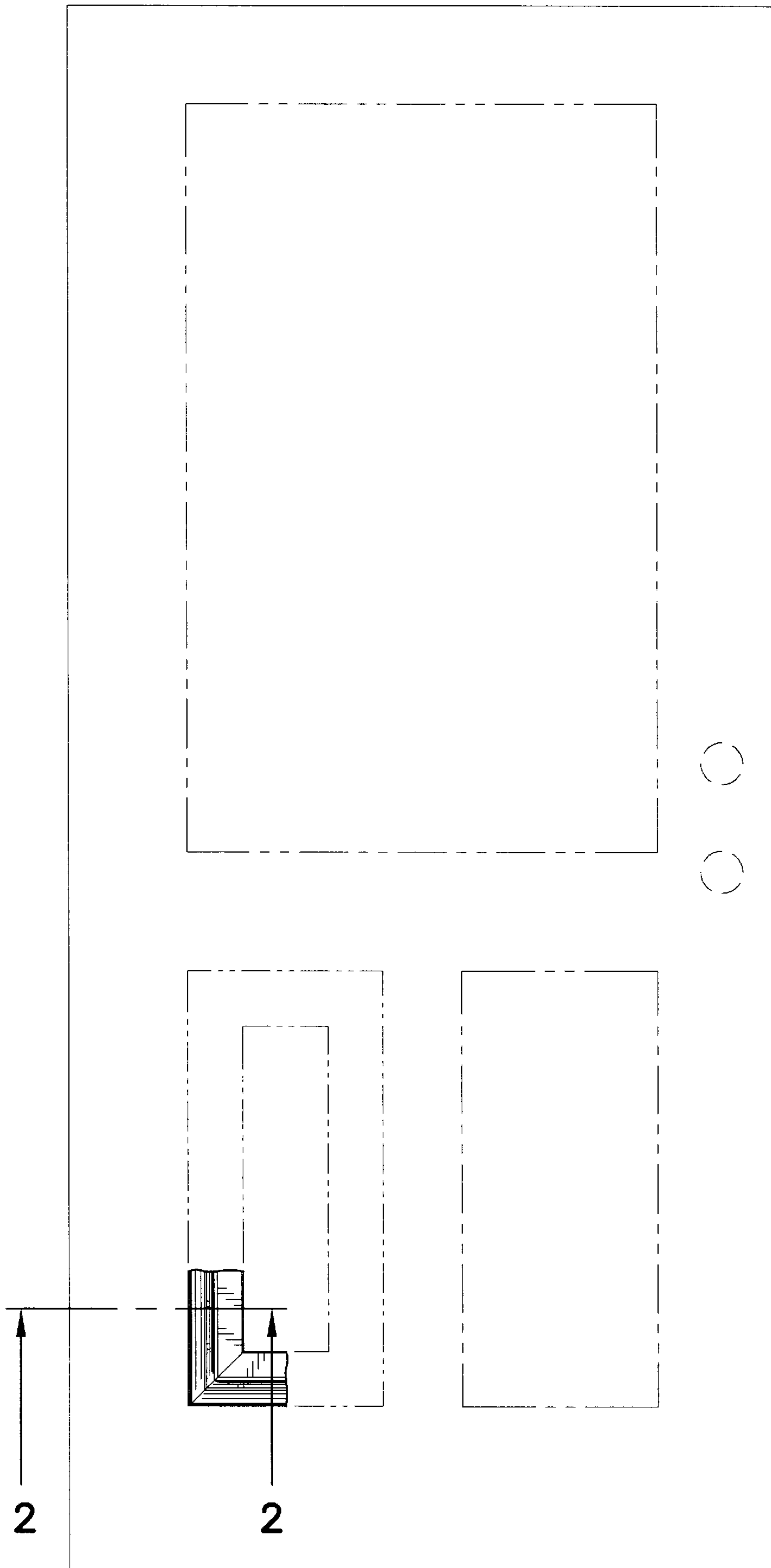

FIG. 2

