



US00D469723S

(12) **United States Design Patent**
McCoy et al.

(10) **Patent No.:** **US D469,723 S**

(45) **Date of Patent:** **** Feb. 4, 2003**

(54) **DRAWBAR FOR TRAILER HITCHES**

(75) Inventors: **Richard W. McCoy**, Granger, IN (US);
Jason R. Moldthan, Osceola, IN (US)

(73) Assignee: **Reese Products, Inc.**, Elkhart, IN (US)

(**) Term: **14 Years**

(21) Appl. No.: **29/148,059**

(22) Filed: **Sep. 12, 2001**

(51) **LOC (7) Cl.** **12-16**

(52) **U.S. Cl.** **D12/162**

(58) **Field of Search** D12/162, 400;
280/507, 504, 506, 511-514, 477, 415.1-417.1,
493, 495, 491.3, 490.1, 491.2; 224/532-535,
521, 924; D8/381

(56) **References Cited**

U.S. PATENT DOCUMENTS

| | | | | | |
|-------------|---|---------|--------------|-------|---------|
| D142,881 S | * | 11/1945 | Martin | | D12/162 |
| D142,882 S | * | 11/1945 | Martin | | D12/162 |
| D142,884 S | * | 11/1945 | Martin | | D12/162 |
| 4,811,877 A | * | 3/1989 | Heideman | | 224/321 |
| D331,899 S | * | 12/1992 | Brisson | | D12/162 |
| D369,581 S | * | 5/1996 | McCoy et al. | | D12/162 |
| D369,582 S | * | 5/1996 | McCoy et al. | | D12/162 |
| D397,067 S | * | 8/1998 | McCoy et al. | | D12/162 |
| 5,850,959 A | * | 12/1998 | Miller | | 224/535 |
| D431,216 S | * | 9/2000 | Belinky | | D12/162 |

OTHER PUBLICATIONS

JC Whitney Catalog, p. 79, See "Drawbar Hitch". Mar. 1999.*

Draw-Tite Web Site, www.draw-tite.com, See "One Piece Forged Ball Mounts" Retrieved Sep. 28, 2002.*

Online catalog for Curt Manufacturing Ball Mounts http://www.curtmfg.com/ballmounts.html Mar. 1, 2002.

Pp. 11-14 of 1995 Draw-Tite Trailer Hitch Applications and Accessories Manual, copyright 1994 by Draw-Tite, Inc.

P. 15 of Reese's 1995 Products, Applications & Towing Accessories Catalog.

* cited by examiner

Primary Examiner—Stacia Cadmus

(74) *Attorney, Agent, or Firm*—McDonald, Hopkins, Burke & Haber Co., L.P.A.

(57) **CLAIM**

The ornamental design for a drawbar for trailer hitches, as shown and described.

DESCRIPTION

FIG. 1 is a perspective view of the drawbar for trailer hitches showing our new design;

FIG. 2 is a left side elevational view thereof;

FIG. 3 is a top plan view thereof;

FIG. 4 is a right side elevational view thereof;

FIG. 5 is a bottom plan view thereof;

FIG. 6 is a rear elevational view thereof;

FIG. 7 is a front elevational view thereof;

FIG. 8 is a perspective view of a second embodiment with a shorter angled intermediate portion between the shank portion and the ball mount portion;

FIG. 9 is a right side elevational view of FIG. 8;

FIG. 10 is a top plan view of FIG. 8;

FIG. 11 is a left side elevation of FIG. 8;

FIG. 12 is a bottom plan view of FIG. 8;

FIG. 13 is a front elevational view of FIG. 8;

FIG. 14 is a rear elevational view of FIG. 8;

FIG. 15 is a perspective view of a third embodiment with the angled portion between the shank portion and the ball mount portion shorter than the intermediate portion of FIG. 1 and FIG. 8;

FIG. 16 is a left side elevational view of FIG. 15;

FIG. 17 is a top plan view of FIG. 15;

FIG. 18 is a bottom plan view of FIG. 15;

FIG. 19 is a right side elevational view of FIG. 15;

FIG. 20 is a front elevational view of FIG. 15; and,

FIG. 21 is a rear elevational view of FIG. 15.

The broken line showing of an aperture in the shank portion in FIG. 1, FIG. 8 and FIG. 15 is for illustrative purposes only and forms no part of the claimed design.

1 Claim, 3 Drawing Sheets

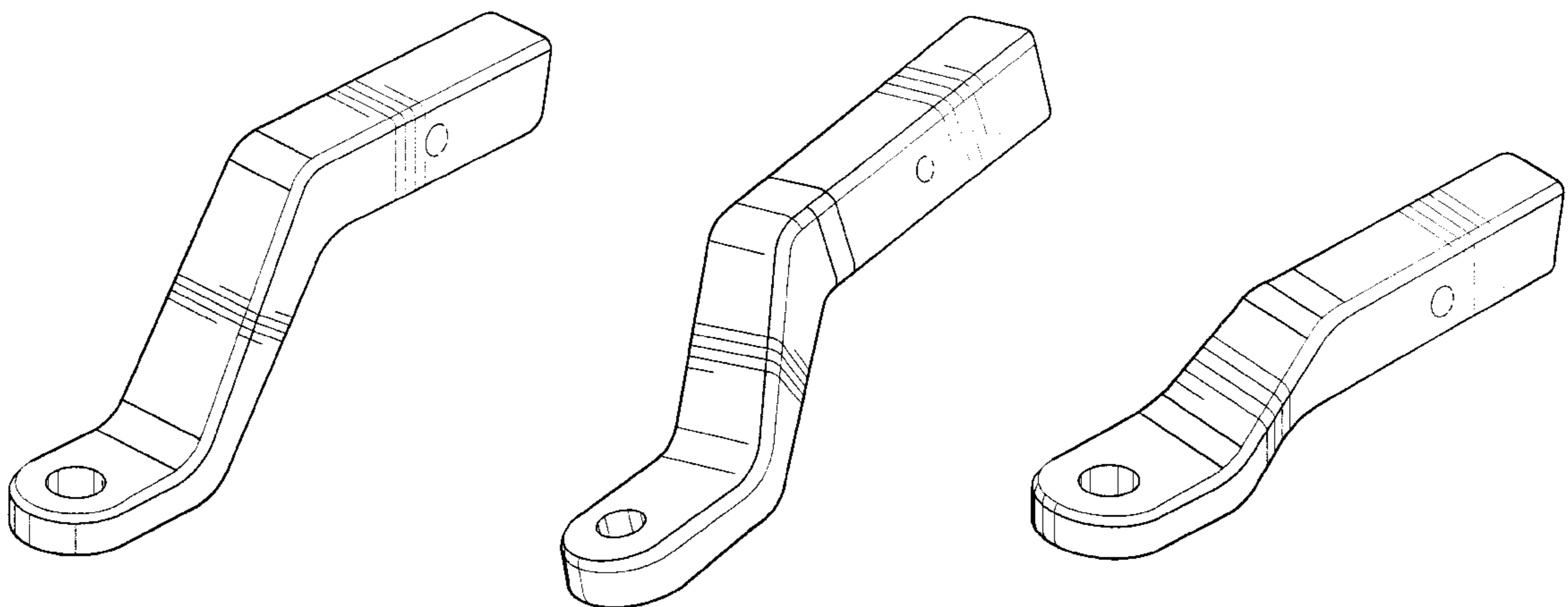

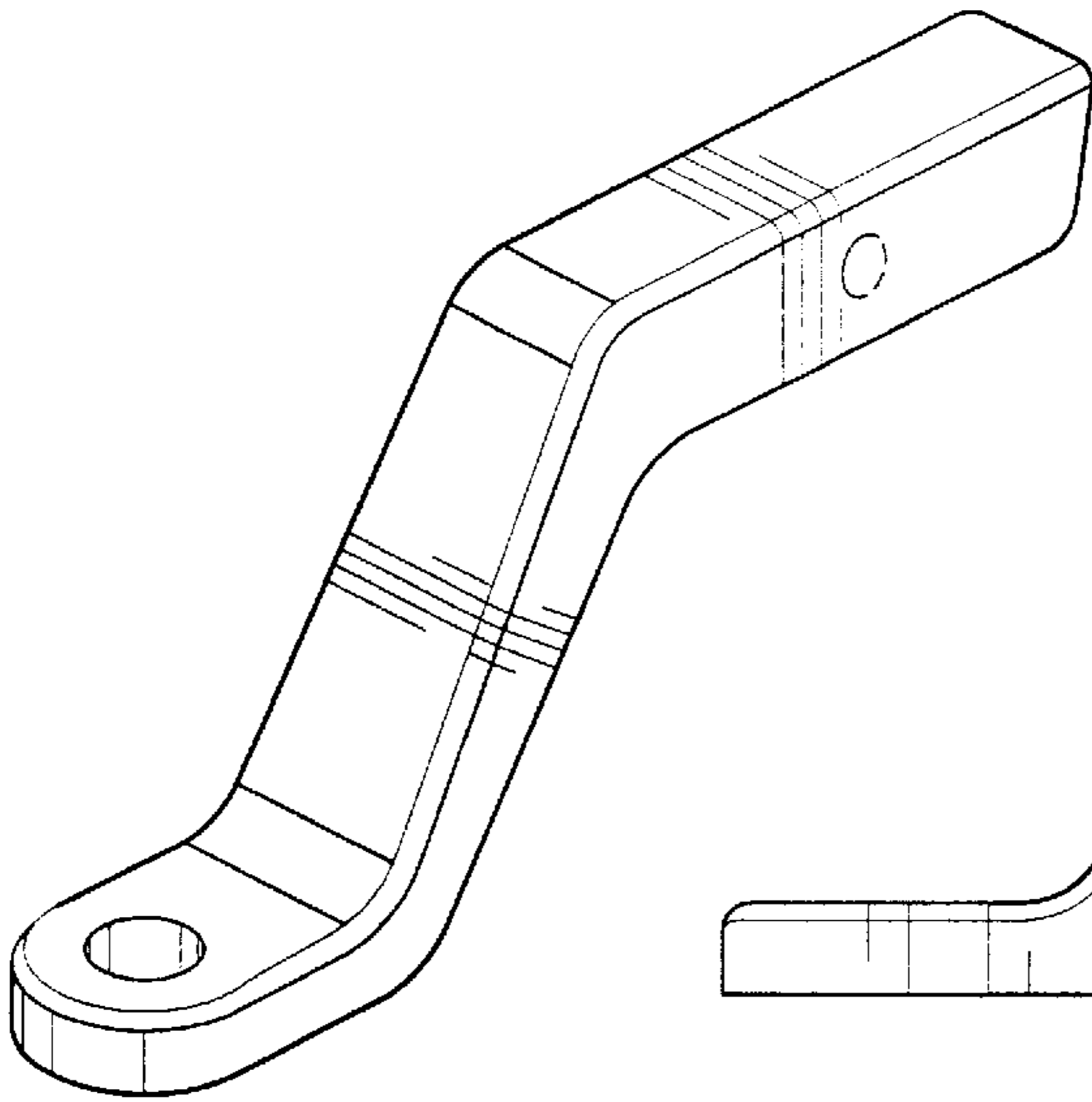

Fig-1

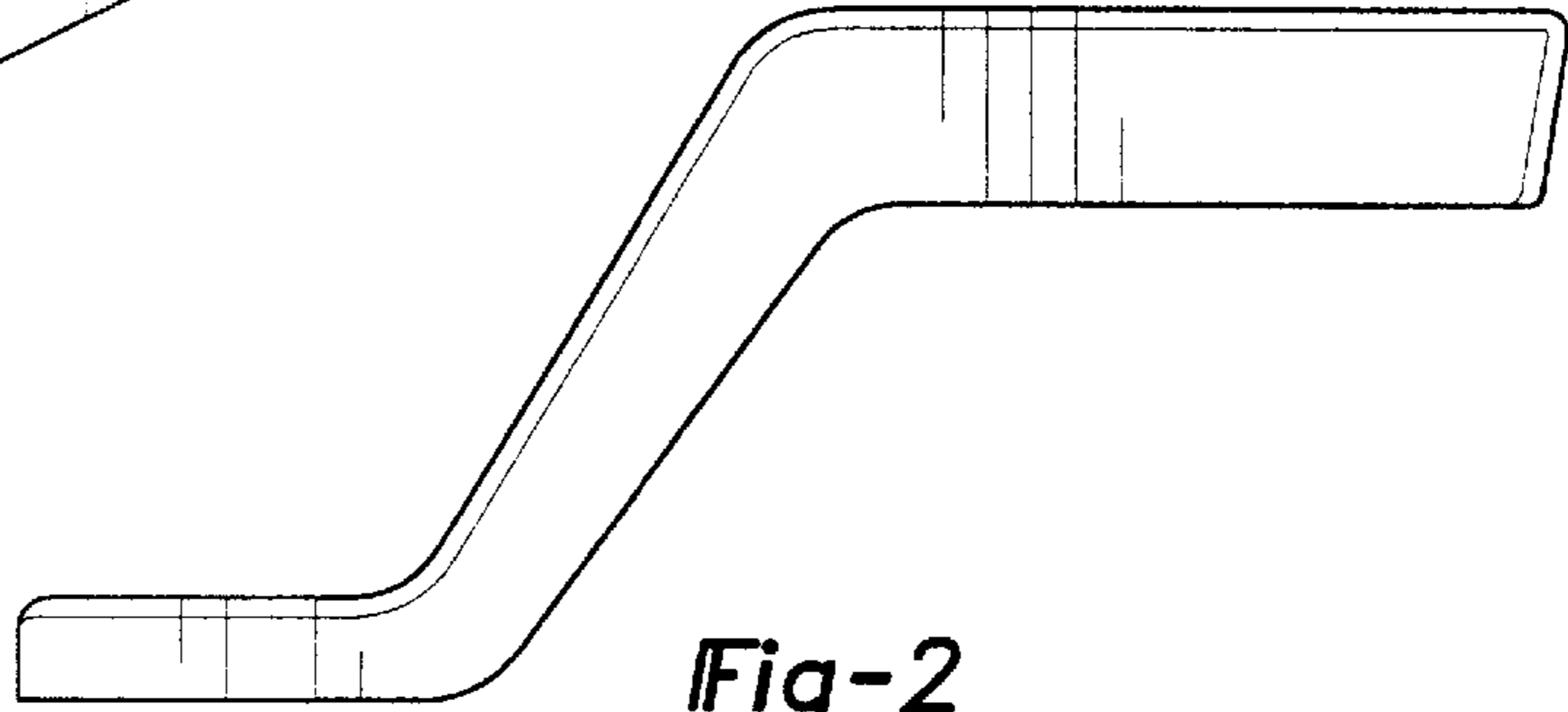

Fig-2

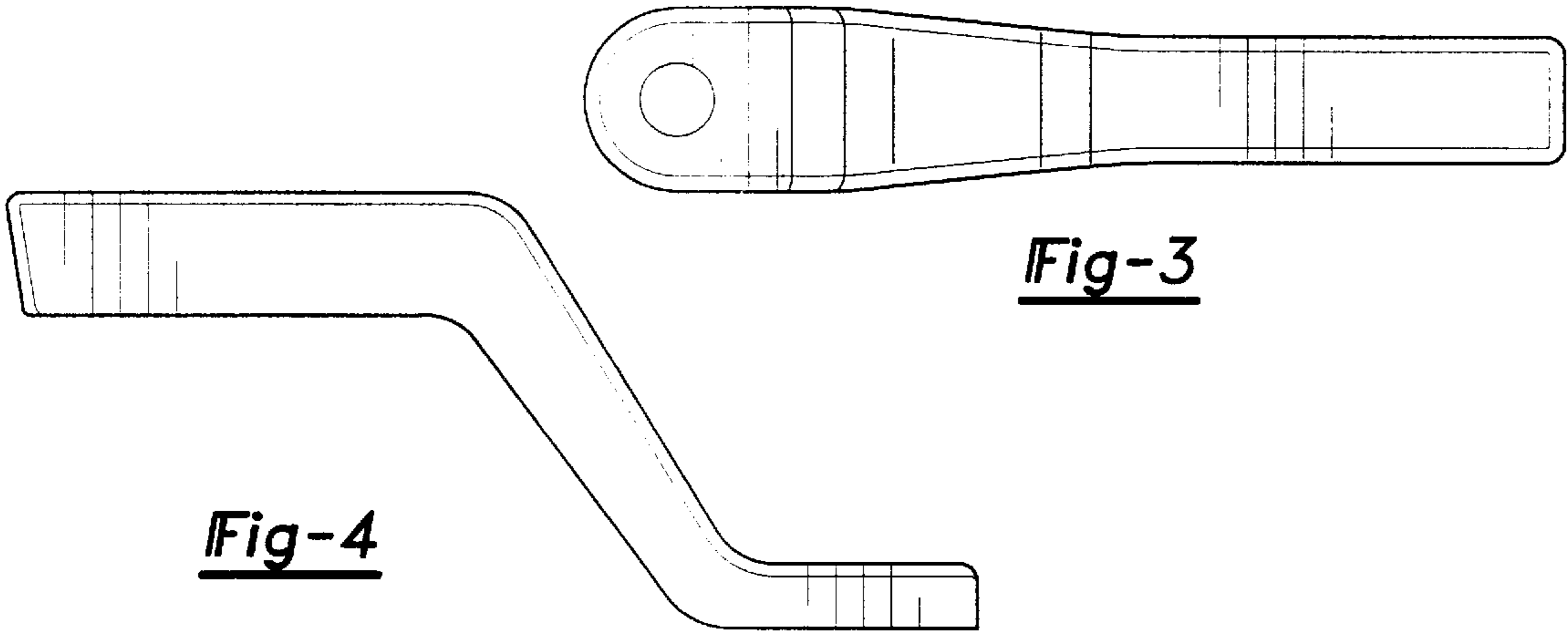

Fig-3

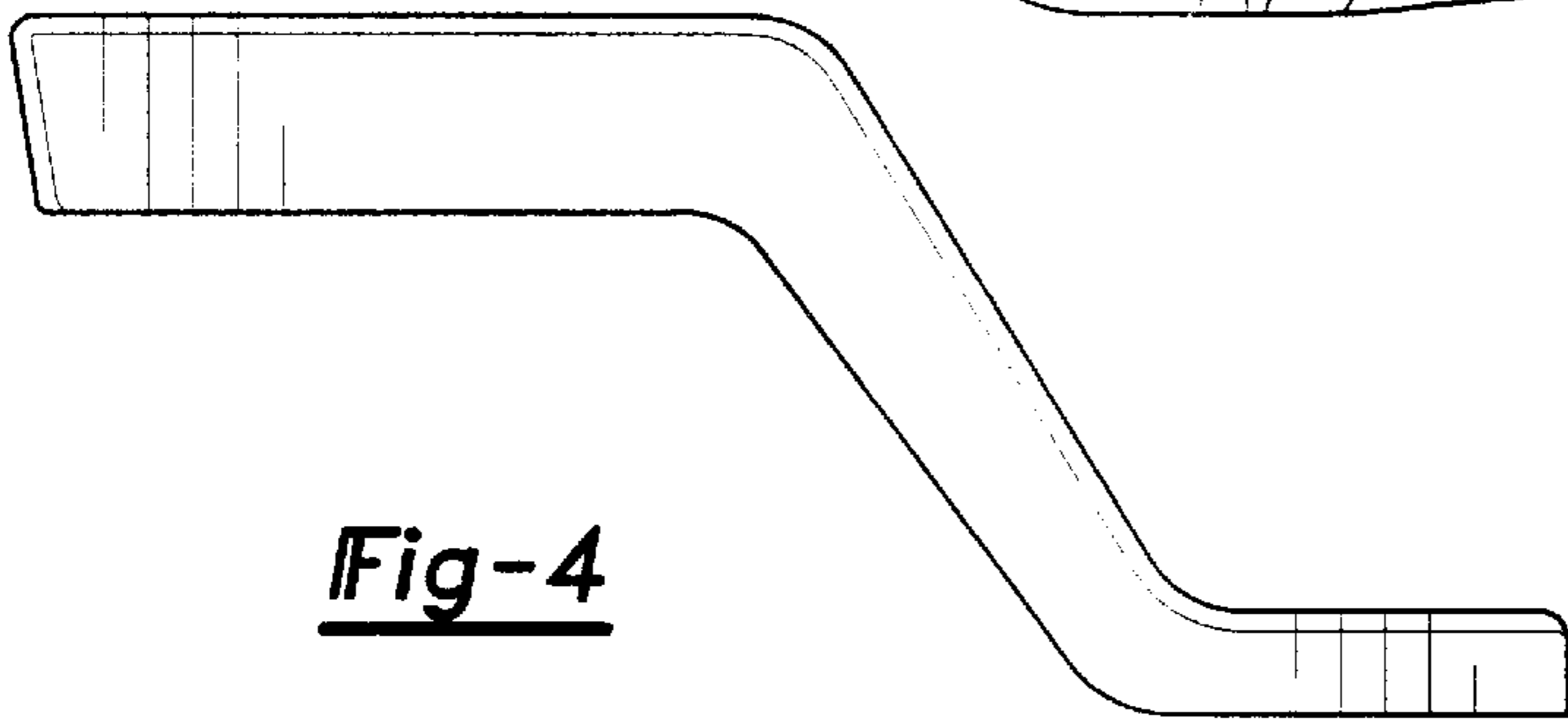

Fig-4

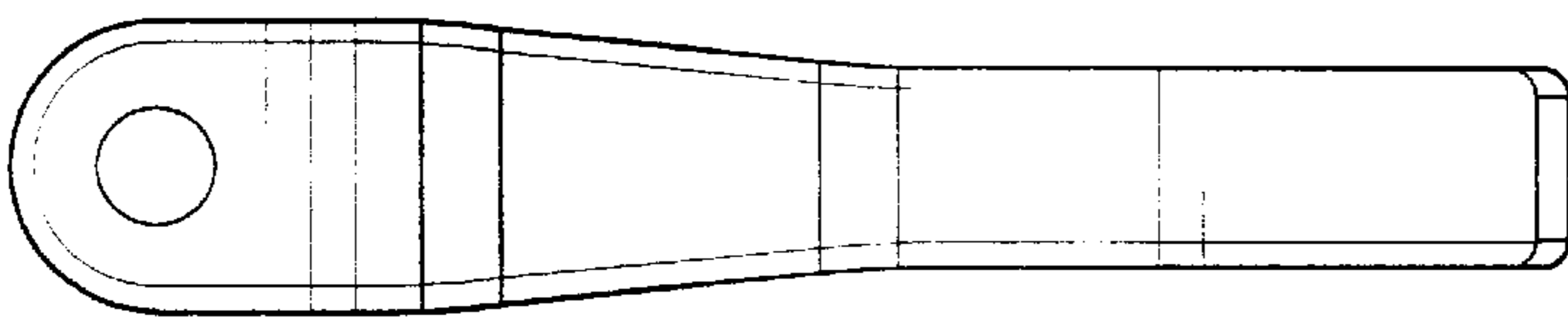

Fig-5

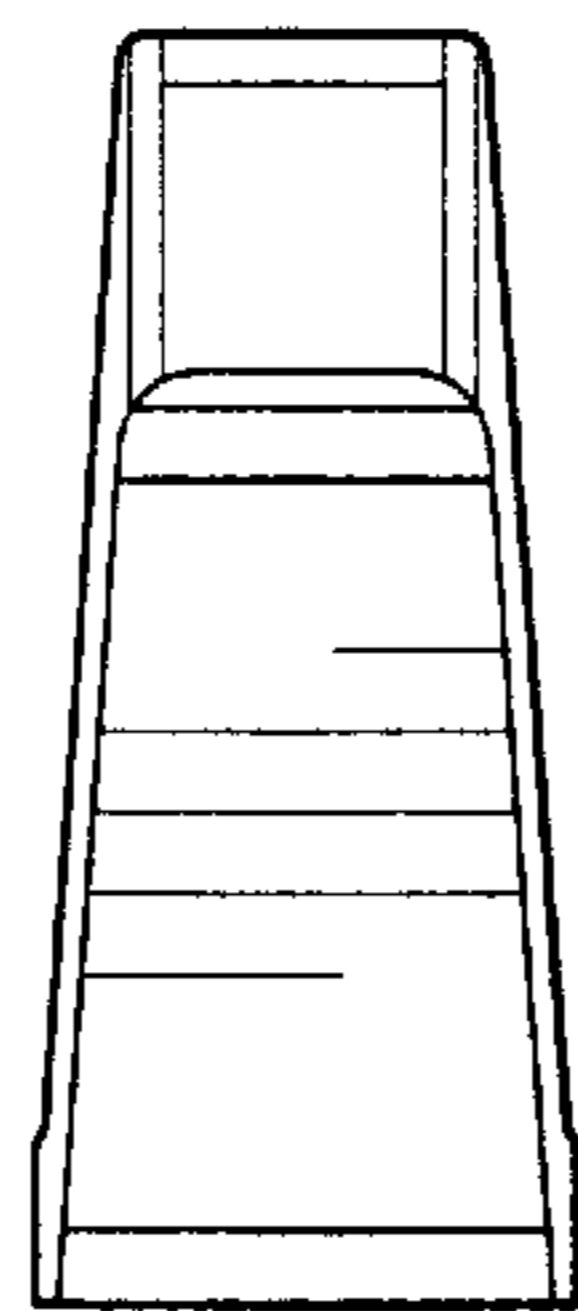

Fig-6

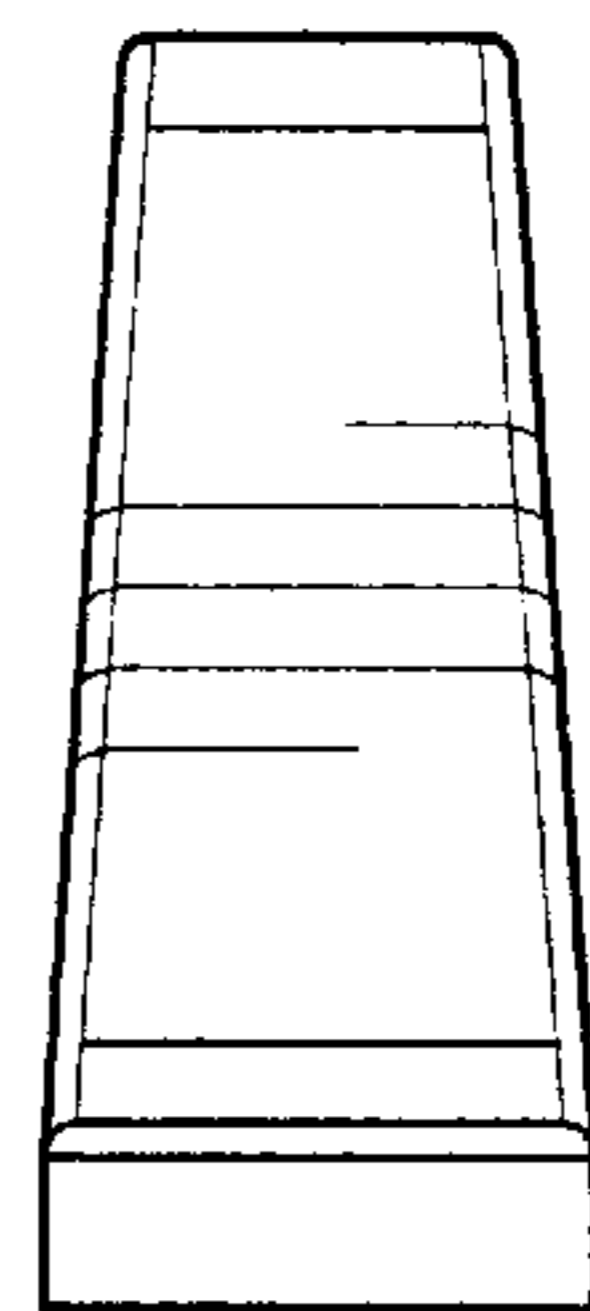
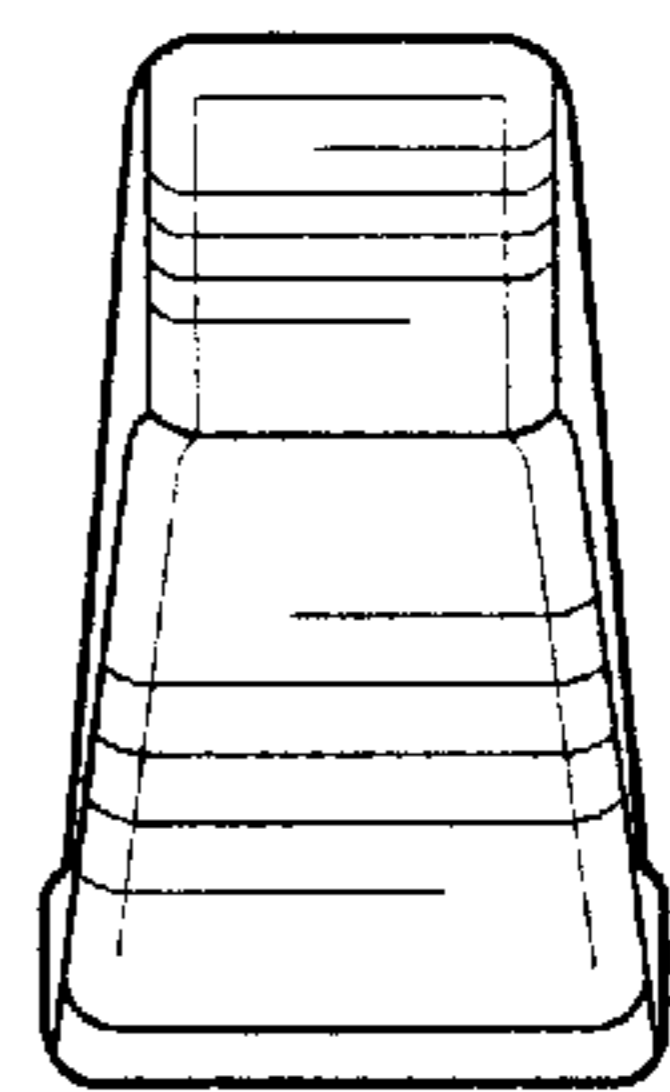
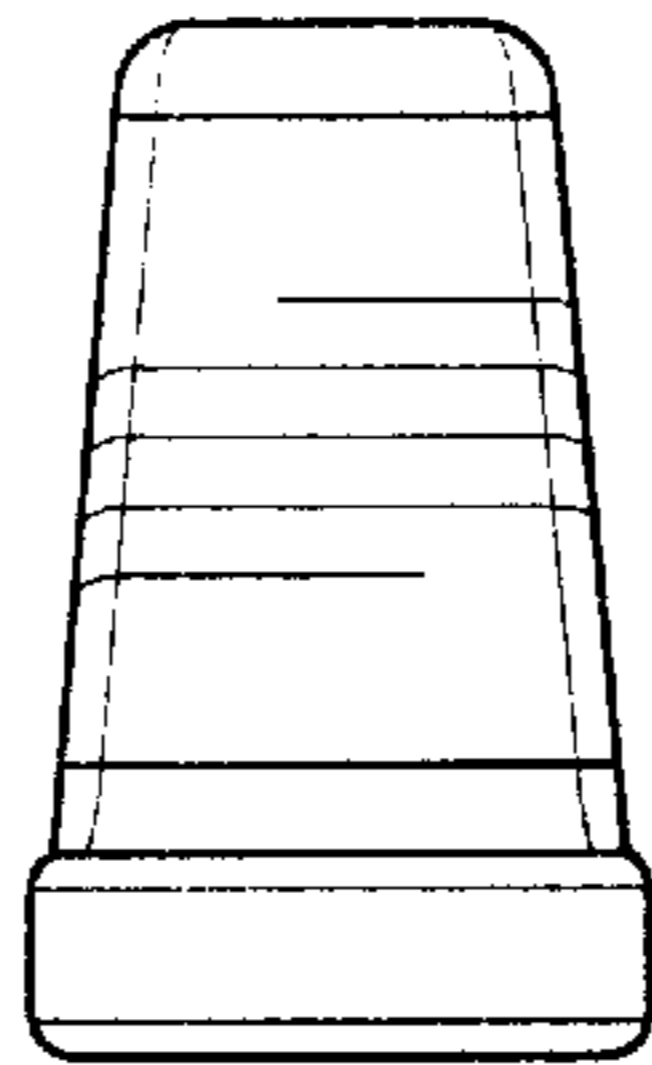
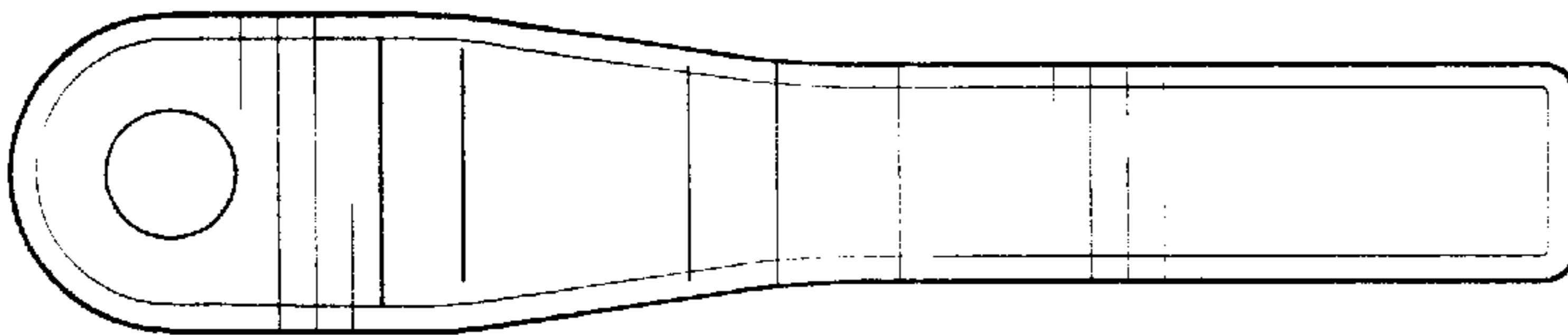
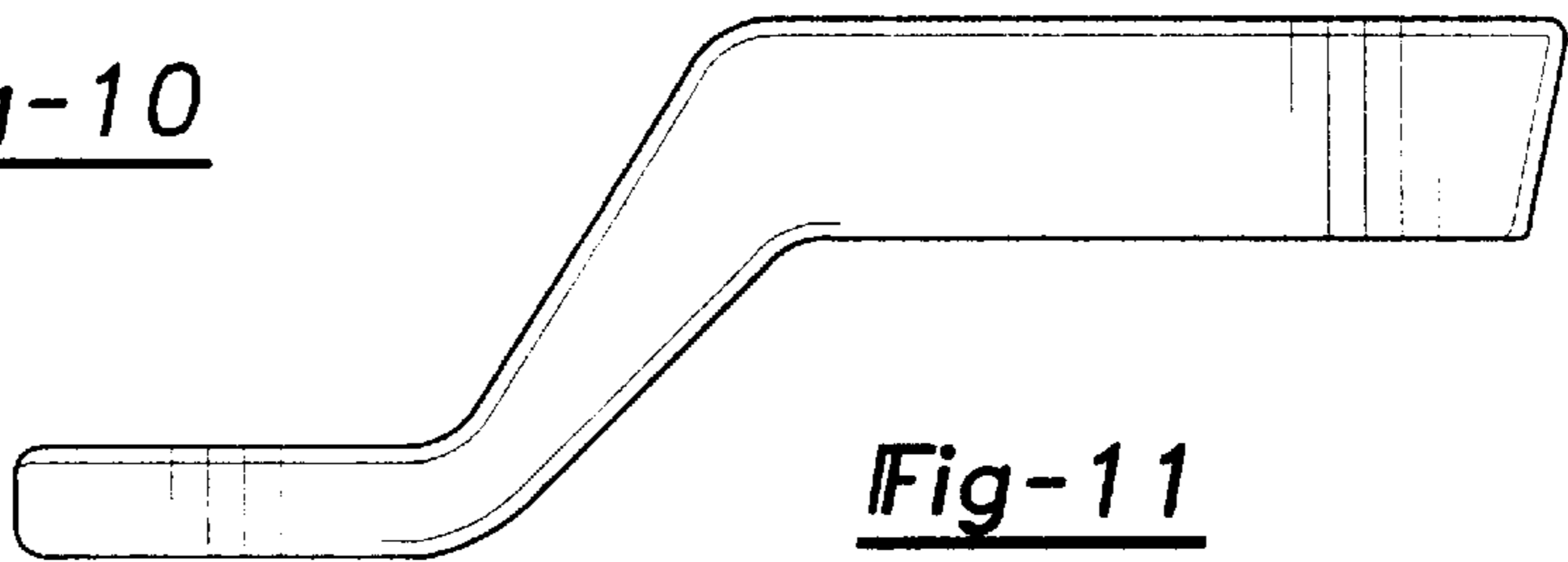
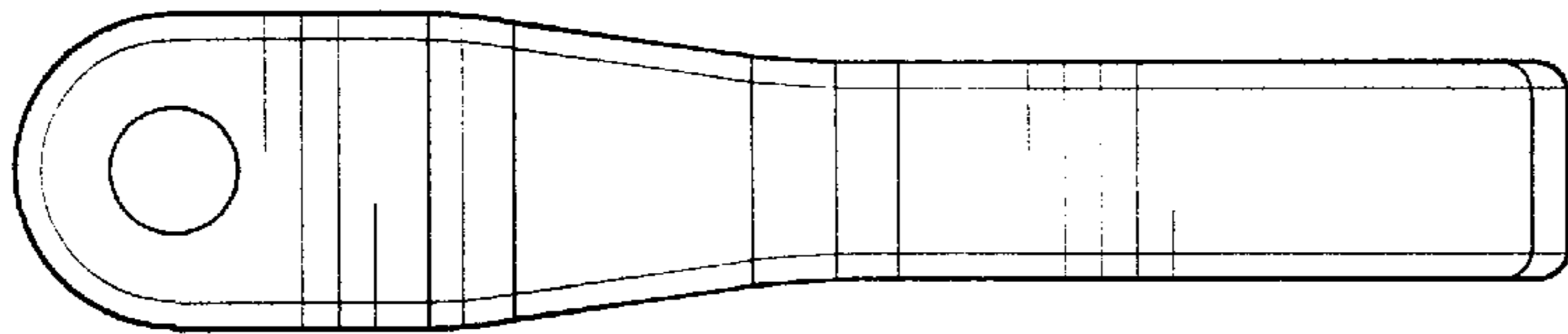
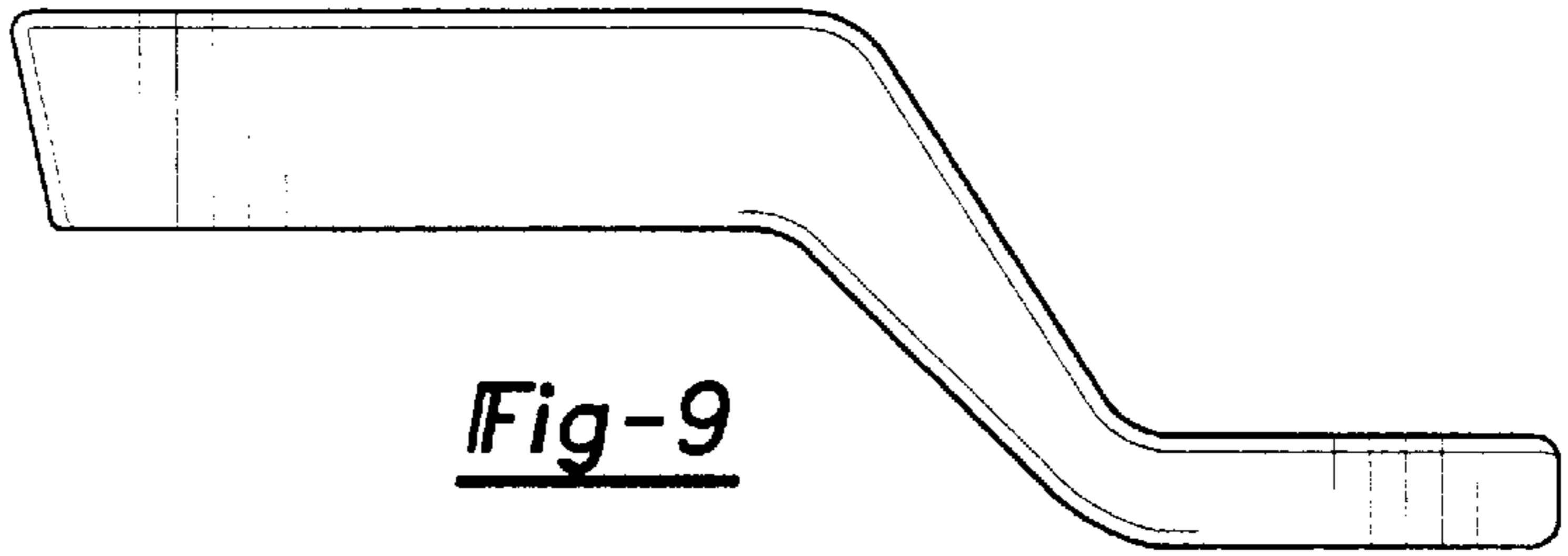
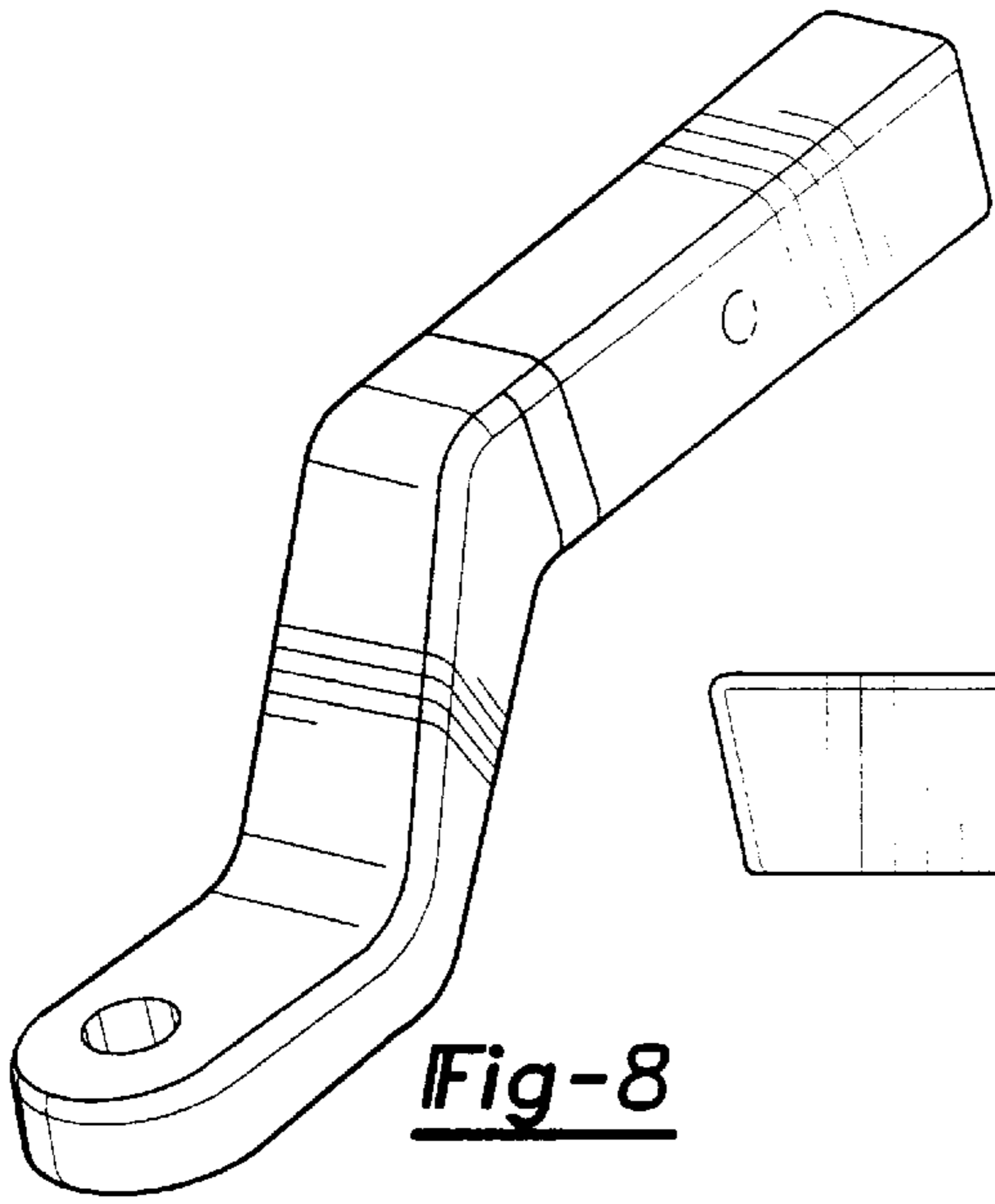

Fig-7



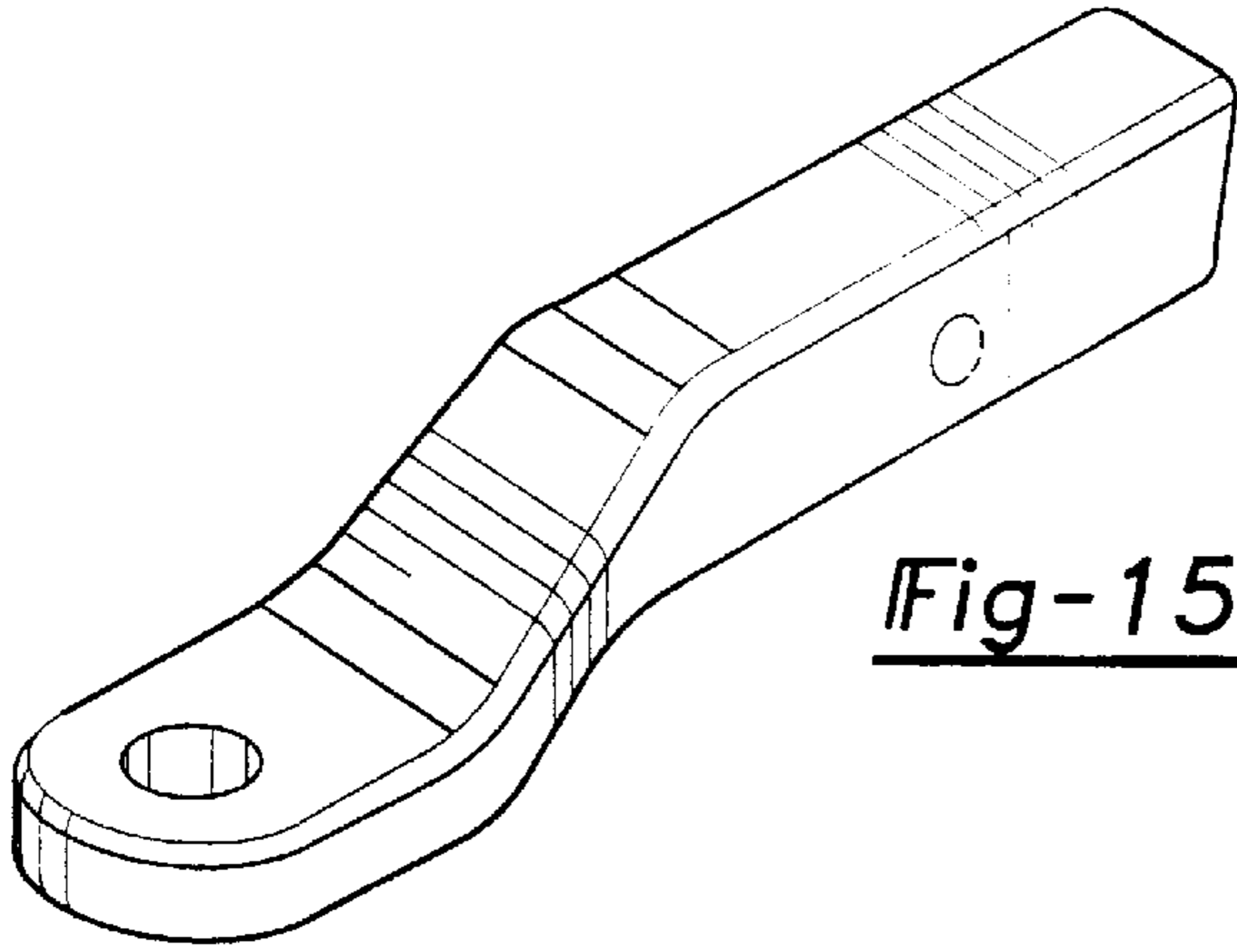

Fig-15

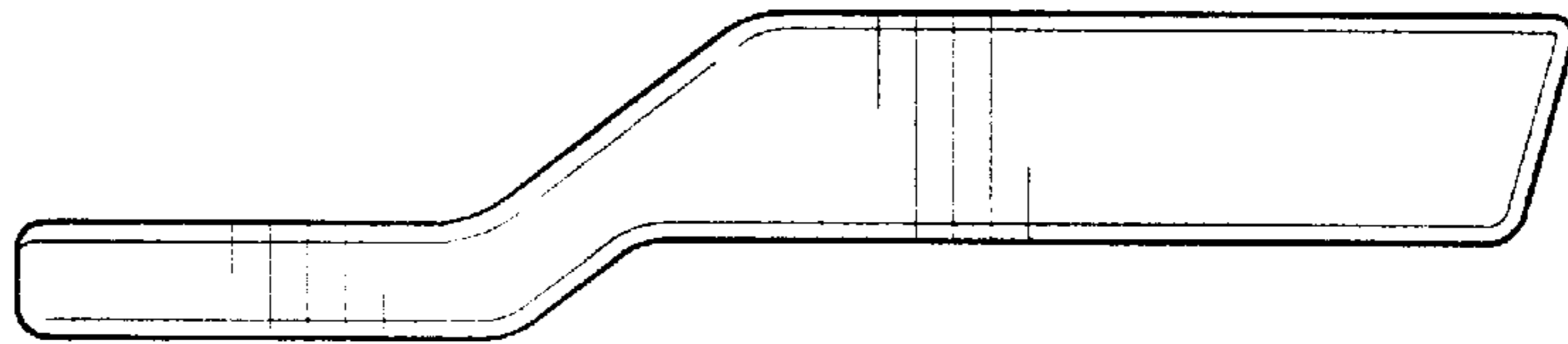

Fig-16

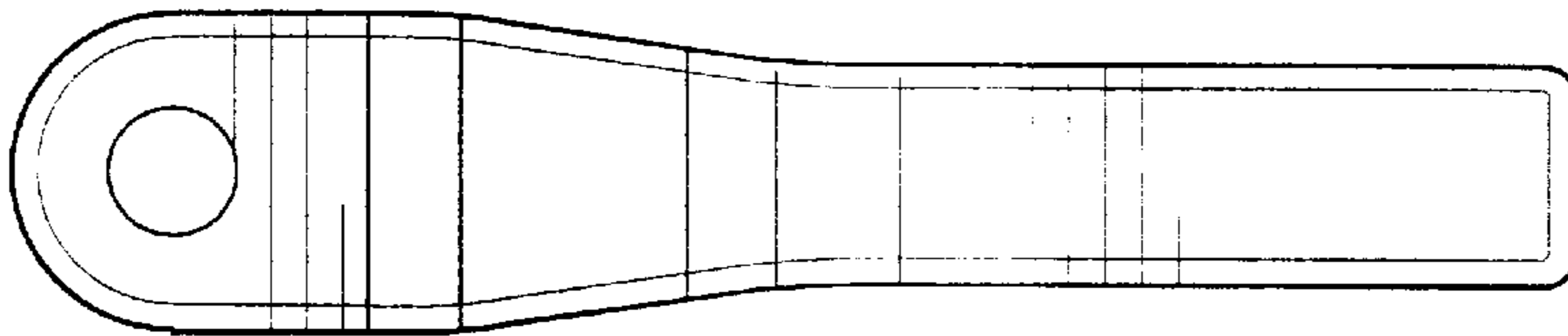

Fig-17

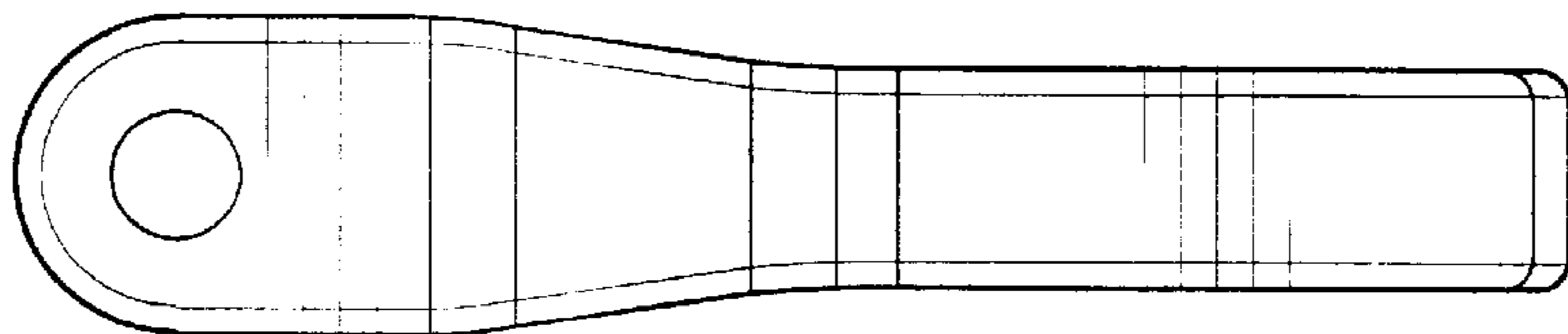

Fig-18

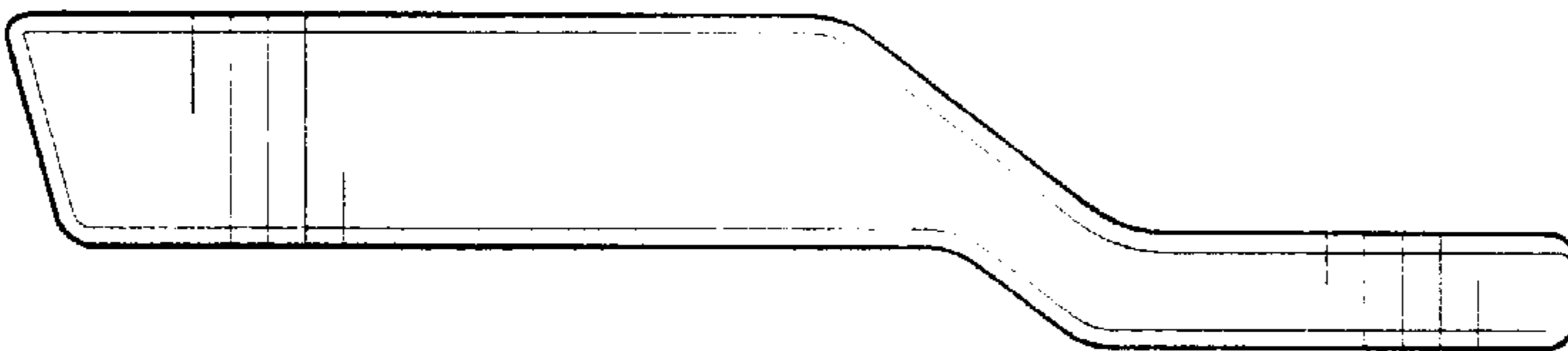

Fig-19

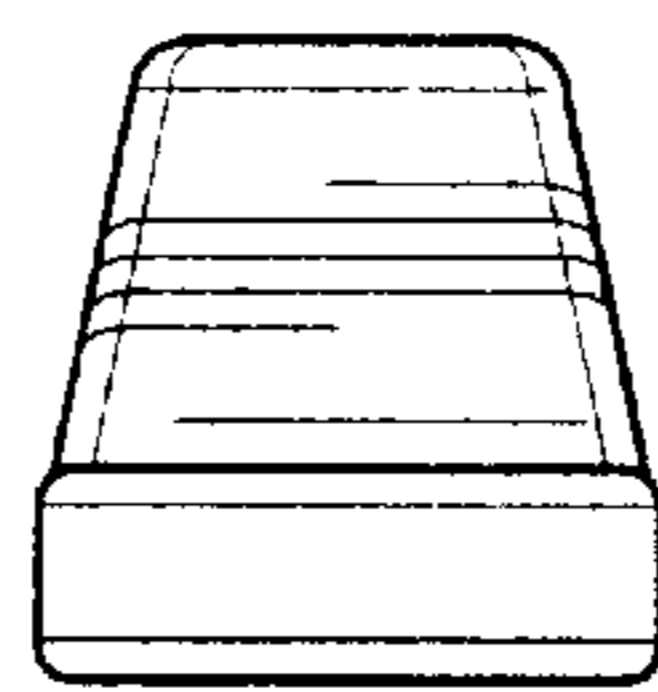

Fig-20

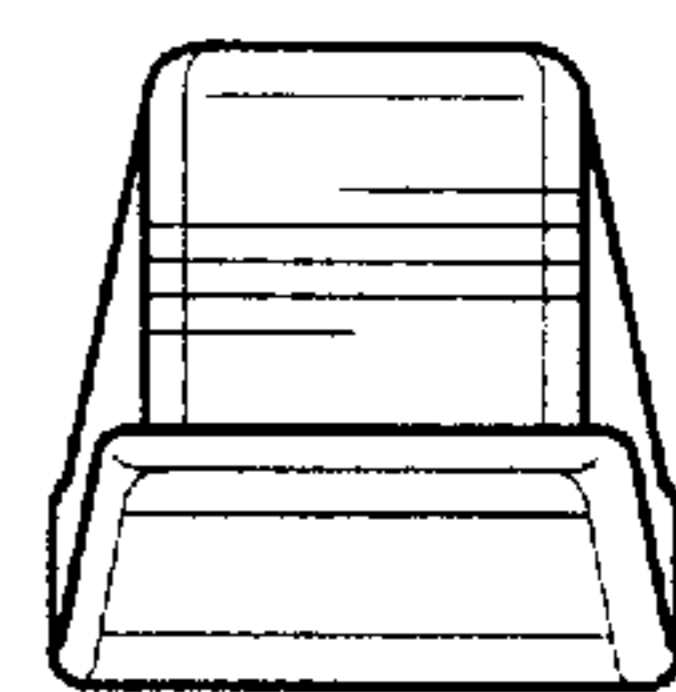

Fig-21