



US00D461248S

(12) **United States Design Patent**
Bianchi et al.

(10) **Patent No.:** **US D461,248 S**

(45) **Date of Patent:** **** Aug. 6, 2002**

(54) **ASSEMBLED BONE IMPLANTS**

(75) Inventors: **John R. Bianchi; Michael Esch; Pat Coleman; P. J. Gorham; Harry Rambo; C. Randal Mills; Kevin Ross; Kevin C. Carter**, all of Alachua, FL (US)

(73) Assignee: **Regeneration Technologies, Inc.**, Alachua, FL (US)

(**) Term: **14 Years**

(21) Appl. No.: **29/123,227**

(22) Filed: **May 12, 2000**

Related U.S. Application Data

(60) Provisional application No. 60/181,622, filed on Feb. 10, 2000.

(51) **LOC (7) Cl.** **24-03**

(52) **U.S. Cl.** **D24/155**

(58) **Field of Search** D24/155; 623/13.12, 623/16-18; 606/60, 61, 72, 73, 87, 90, 96, 99

(56) **References Cited**

U.S. PATENT DOCUMENTS

- 5,489,308 A * 2/1996 Kuslich et al. 623/17
- D397,439 S * 8/1998 Koros et al. D24/155
- 6,149,686 A * 11/2000 Kuslich et al. 623/17.11

* cited by examiner

Primary Examiner—Antoine Duval Davis

(74) *Attorney, Agent, or Firm*—Timothy H. Van Dyke, Esq.; Van Dyke & Associates, P.A.

(57) **CLAIM**

The ornamental design for an assembled bone implant, substantially as shown and described.

DESCRIPTION

FIG. 1 shows an exploded, perspective view of a first embodiment of the assembled bone implant showing our design. The design comprises first and second cylindrical ends. Between the first and second cylindrical ends are first and second cylindrical pins attaching the first and second cylindrical ends.

FIG. 2 shows a perspective view of the embodiment shown in FIG. 1 as assembled.

FIG. 3 shows an exploded, perspective view of a second embodiment of assembled bone implant showing our design. The design comprises first and second cylindrical ends and a center cylindrical segment which are attached together by cylindrical pins to form an assembled dowel shaped bone implant. The center cylindrical segment is made of cancellous bone, and the cylindrical ends are made of cortical bone, or vice versa.

FIG. 4 shows a perspective view of the embodiment shown in FIG. 3 as assembled.

FIG. 5 shows an end plan view of the embodiment shown in FIG. 4. Section lines A—A and B—B are not claimed as part of the subject design.

FIG. 6 shows a cross-sectional view of the embodiment shown in FIG. 4 along section line A—A as shown in FIG. 5; and,

FIG. 7 shows a cross-sectional view of the embodiment shown in FIG. 4 along section line B—B as shown in FIG. 5.

1 Claim, 2 Drawing Sheets

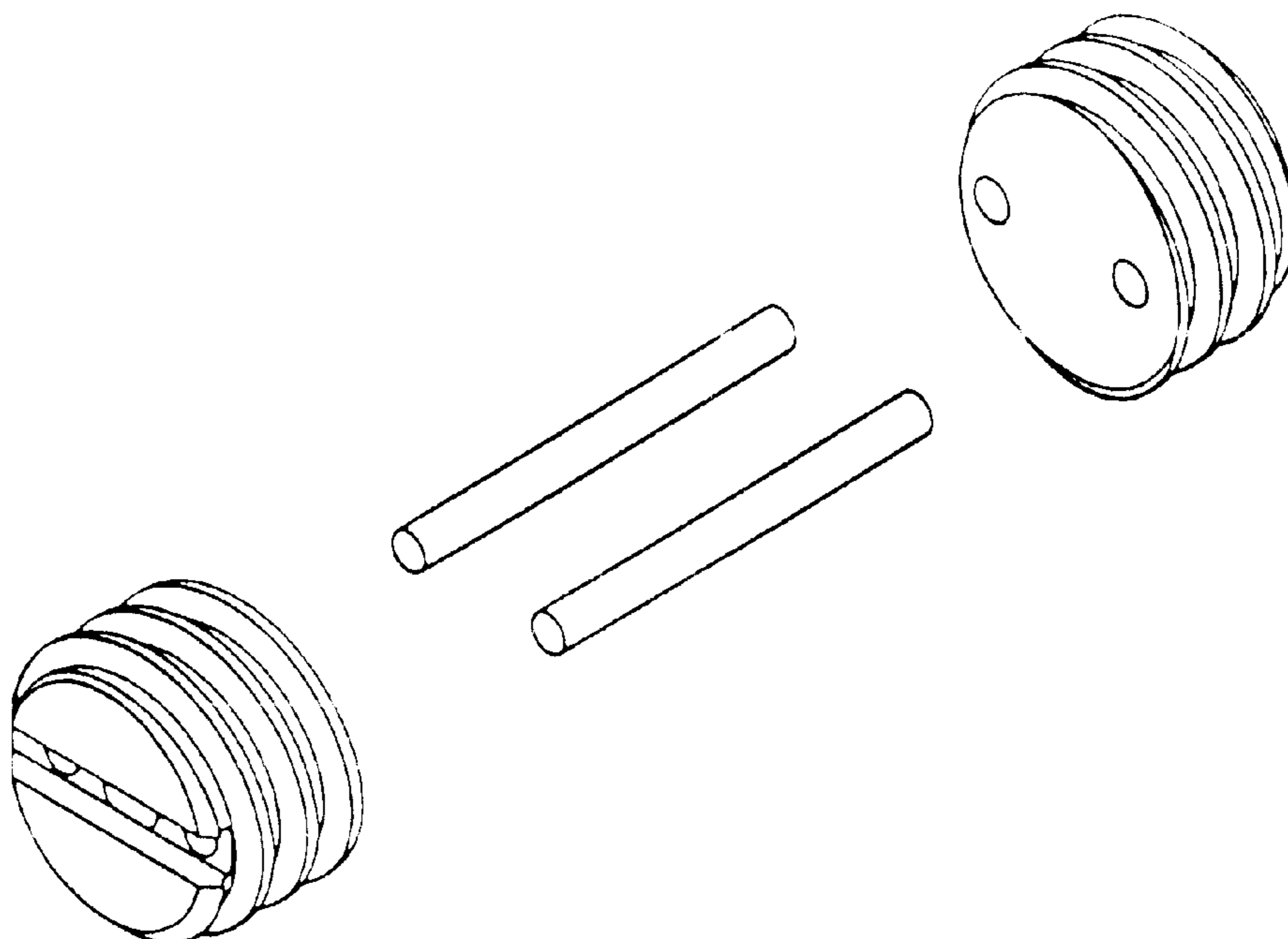

Figure 1

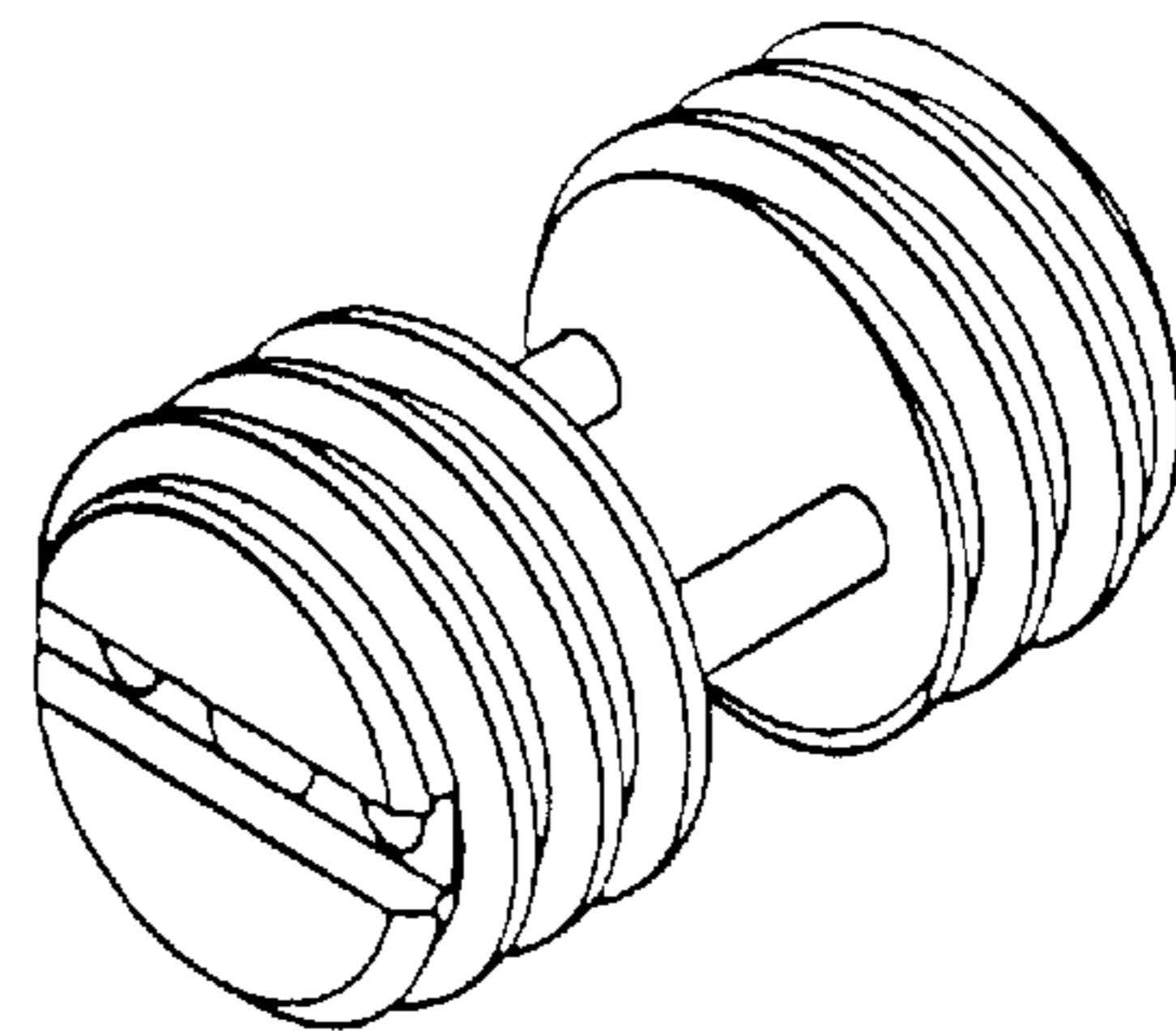
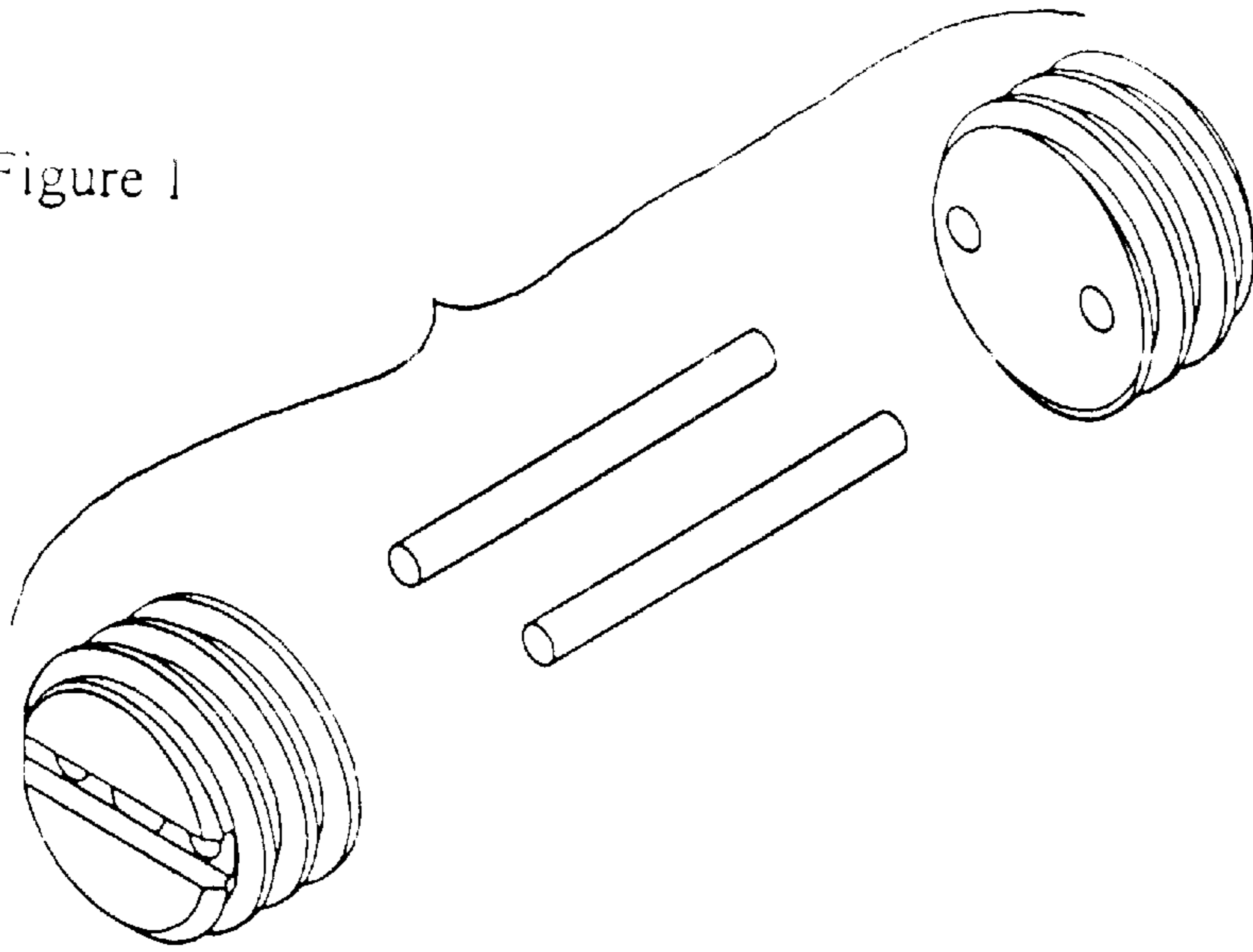

Figure 2

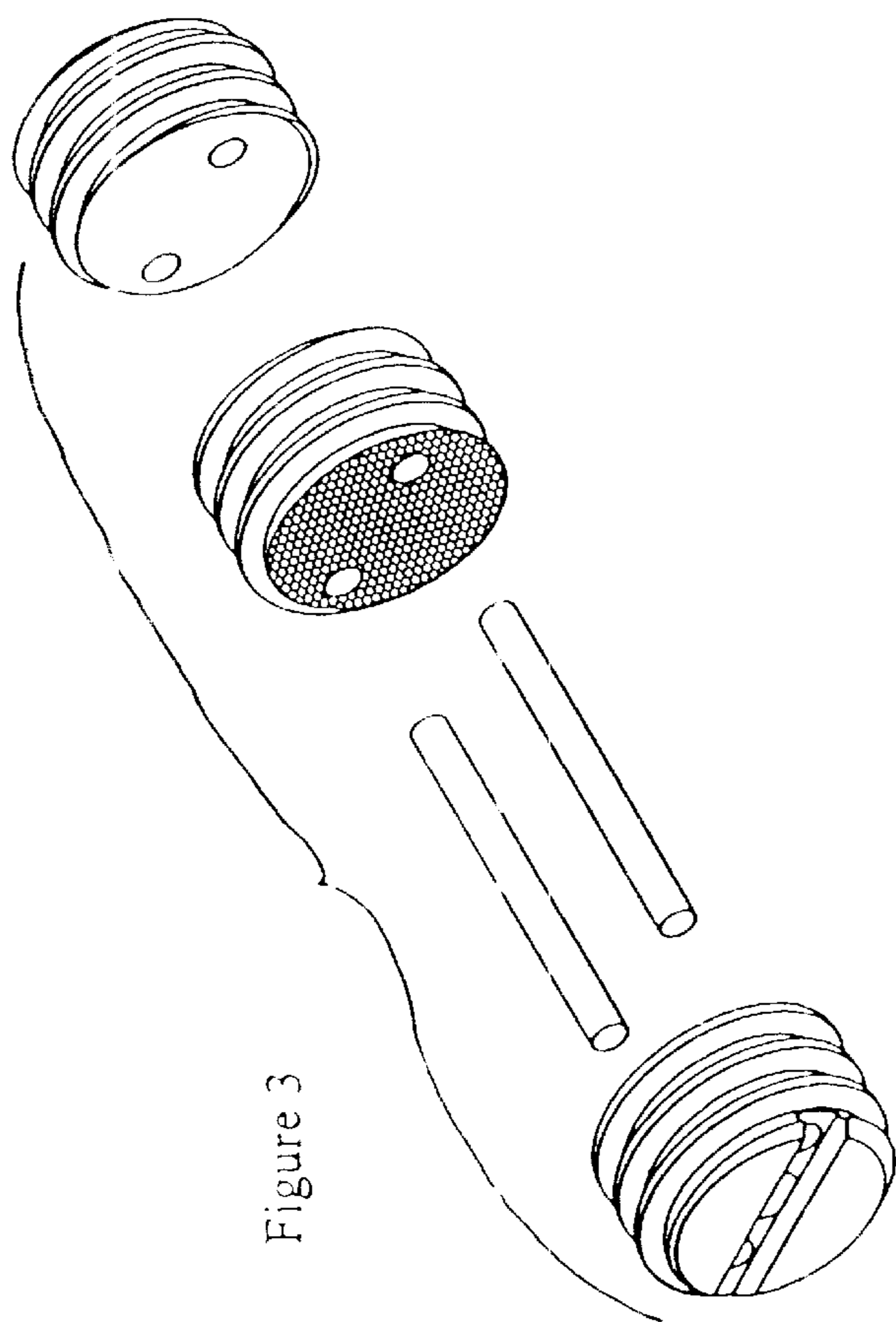

Figure 3

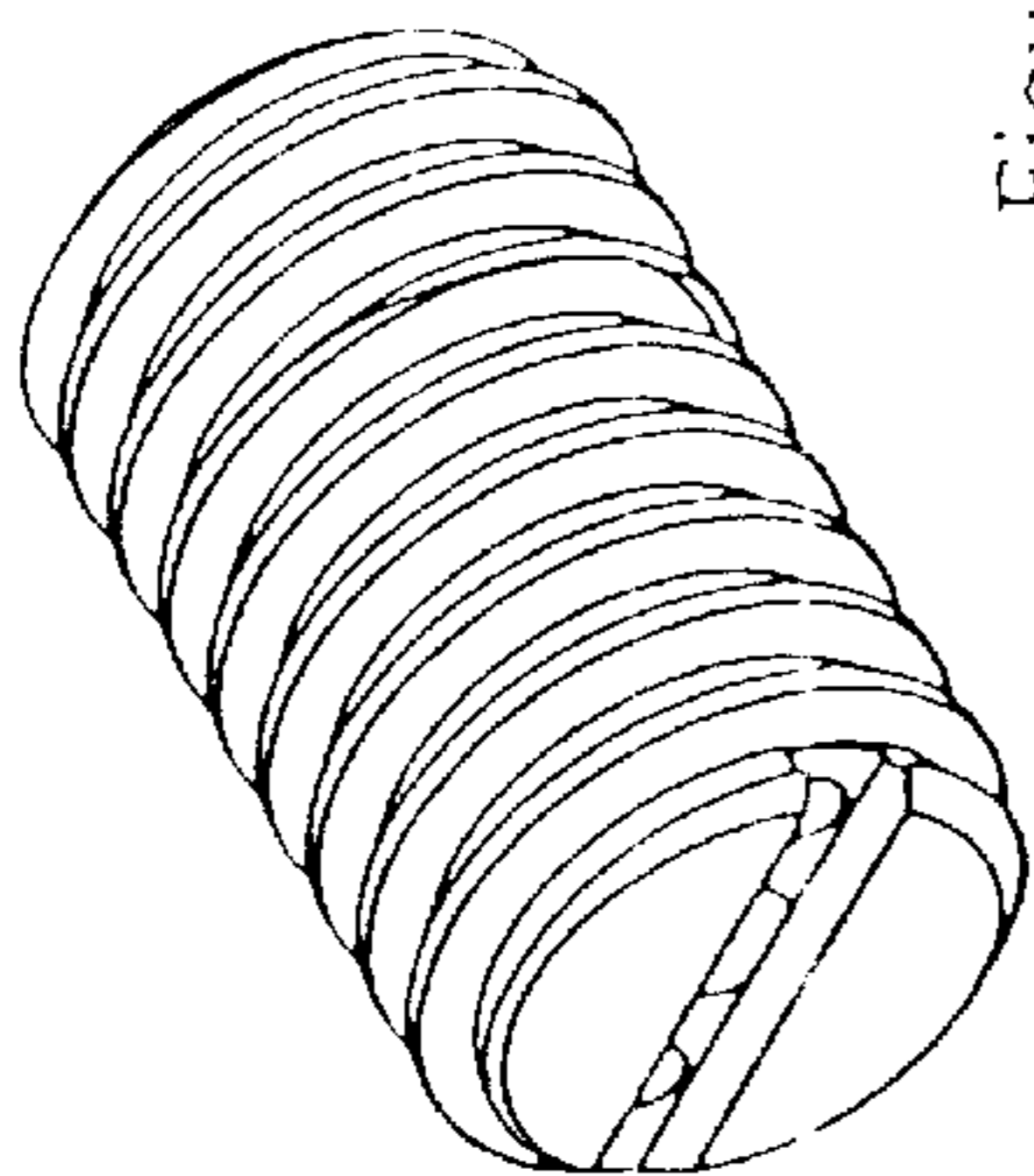

Figure 4

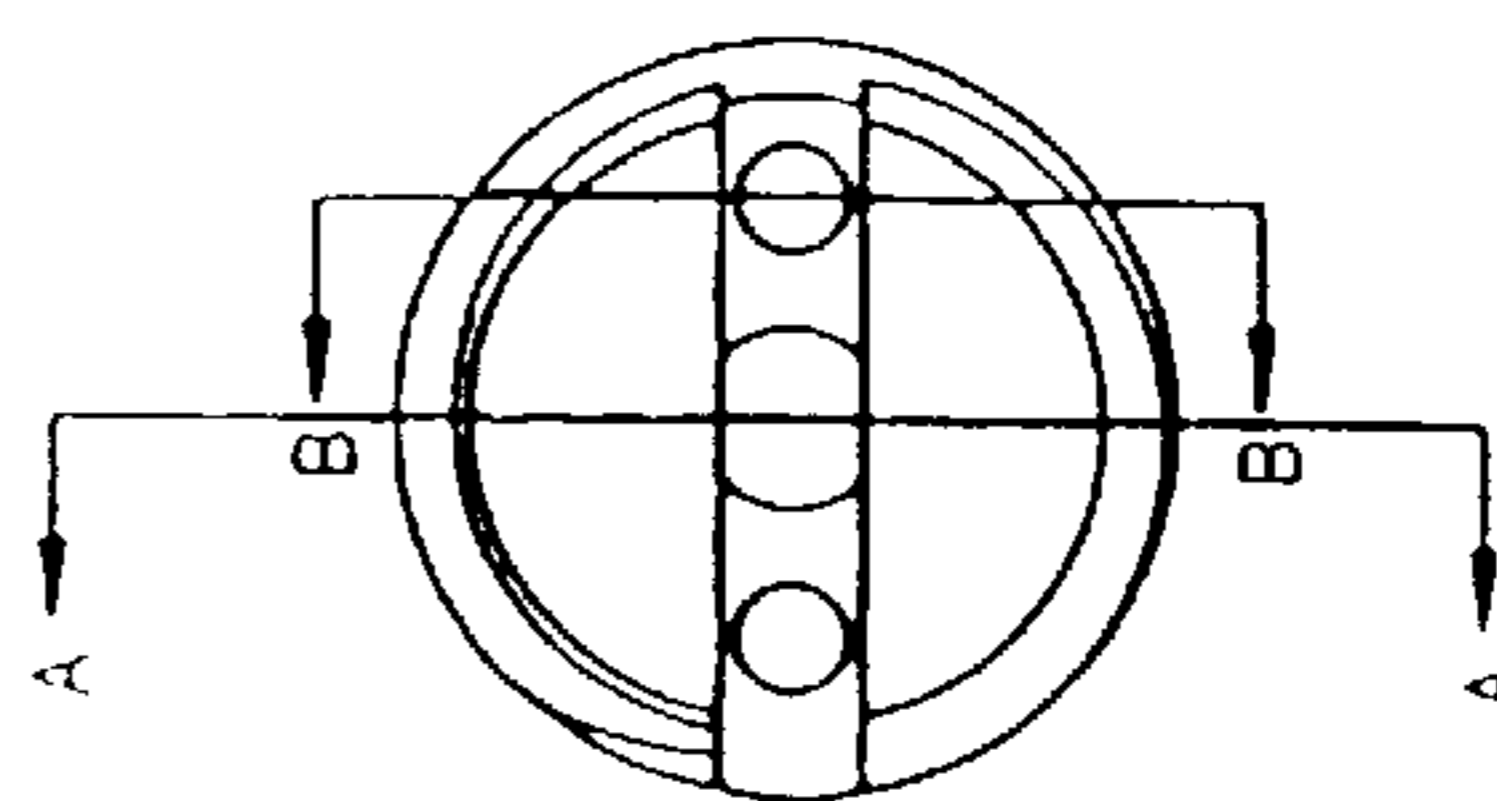

Figure 5

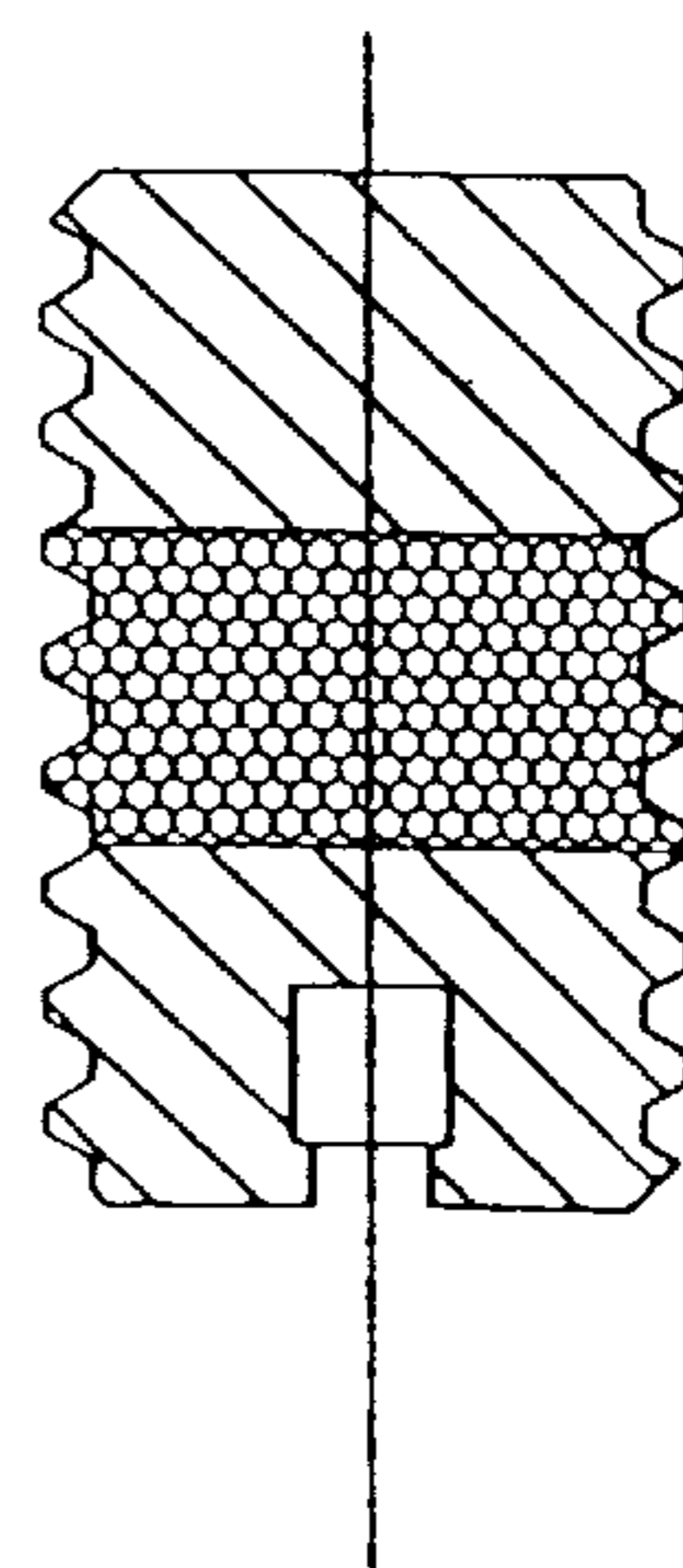

Figure 6

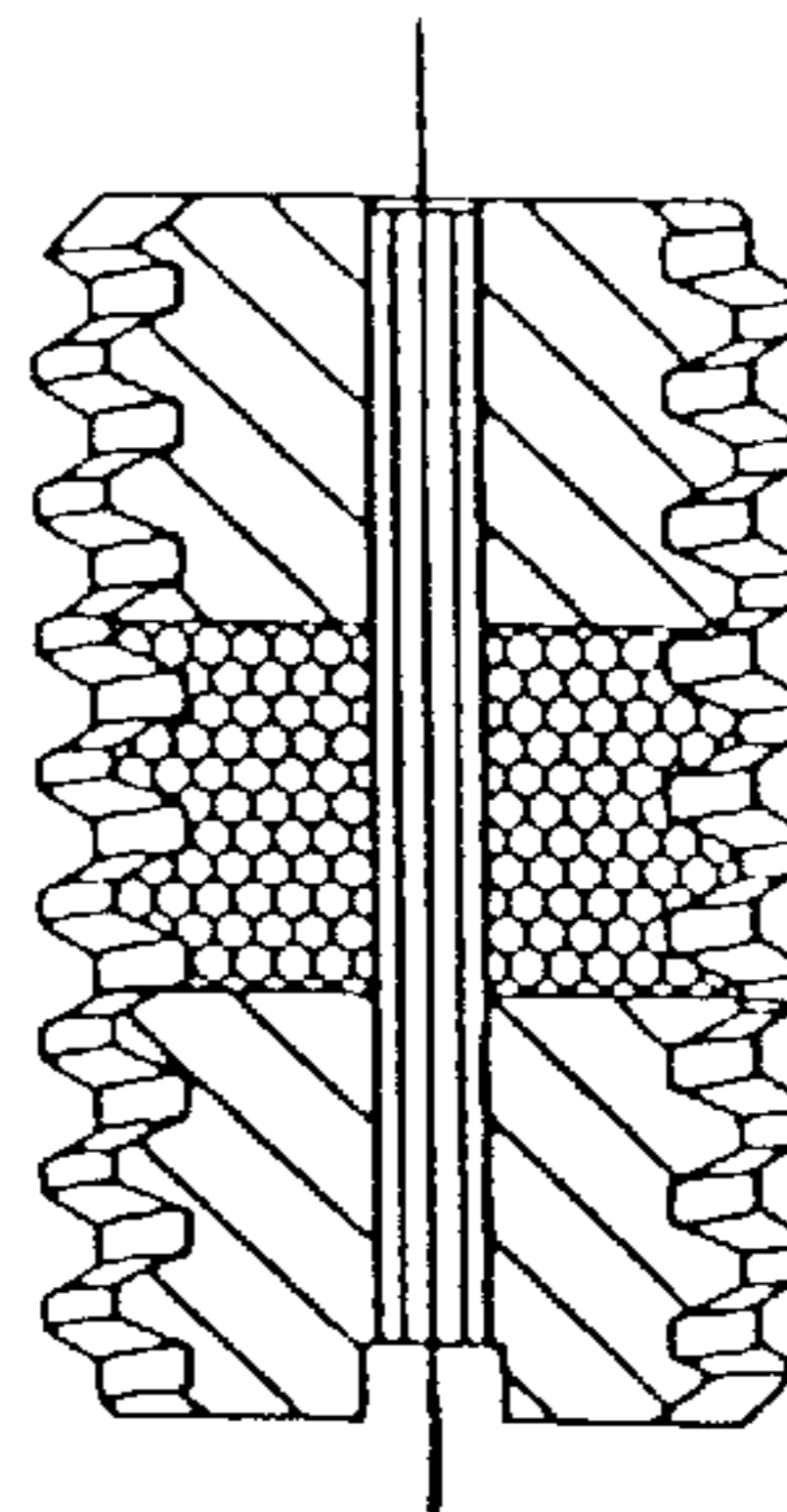

Figure 7