



US00D458996S

(12) **United States Design Patent**
Bryant et al.

(10) **Patent No.:** **US D458,996 S**
(45) **Date of Patent:** **** Jun. 18, 2002**

(54) **ORTHOPAEDIC BONE PLATE**

(75) Inventors: **Mark Bryant**, Auburn; **Aude Leroy-Gallissot**, Warsaw, both of IN (US); **Stephen B. Benirschke**, Seattle, WA (US); **Paul Duwelius**, Lake Oswego, OR (US); **James Goulet**, Ann Arbor, MI (US); **David Templeman**, Plymouth, MN (US); **Robert Winquist**, Seattle, WA (US)

(73) Assignee: **Zimmer, Inc.**

(**) Term: **14 Years**

(21) Appl. No.: **29/151,525**

(22) Filed: **Nov. 13, 2001**

(51) **LOC (7) Cl.** **24-03**

(52) **U.S. Cl.** **D24/155**

(58) **Field of Search** D24/155; 606/60,
606/69-72, 74

(56) **References Cited**

U.S. PATENT DOCUMENTS

5,951,557	A *	9/1999	Luter	606/69
6,183,474	B1 *	2/2001	Bramlet et al.	606/69 X
D443,060	S *	5/2001	Benirschke et al.	D24/155
6,340,362	B1 *	1/2002	Pierer et al.	606/71

* cited by examiner

Primary Examiner—Antoine Duval Davis
(74) *Attorney, Agent, or Firm*—Jacque R. Wilson

(57) **CLAIM**

The ornamental design for an orthopaedic bone plate, as shown and described.

DESCRIPTION

FIG. 1 is a top perspective view of an orthopaedic bone plate showing the present design.
 FIG. 2 is a bottom perspective view thereof.
 FIG. 3 is a top view thereof.
 FIG. 4 is a bottom view thereof.
 FIG. 5 is a left side elevational view thereof.
 FIG. 6 is a right side elevational view thereof.
 FIG. 7 is a front view thereof showing one end of the present invention.
 FIG. 8 is a rear view of the invention shown in FIG. 5.
 FIG. 9 is a top perspective view of second embodiment of the present invention.
 FIG. 10 is a bottom perspective view thereof.
 FIG. 11 is a top view thereof.
 FIG. 12 is a bottom view thereof.
 FIG. 13 is a partial front elevational view thereof
 FIG. 14 is a rear elevational view thereof.
 FIG. 15 is a right side elevational view thereof; and,
 FIG. 16 is a left side elevational view thereof.
 The broken line showing is for illustrative purposes only and forms no part of the claimed design.

1 Claim, 6 Drawing Sheets

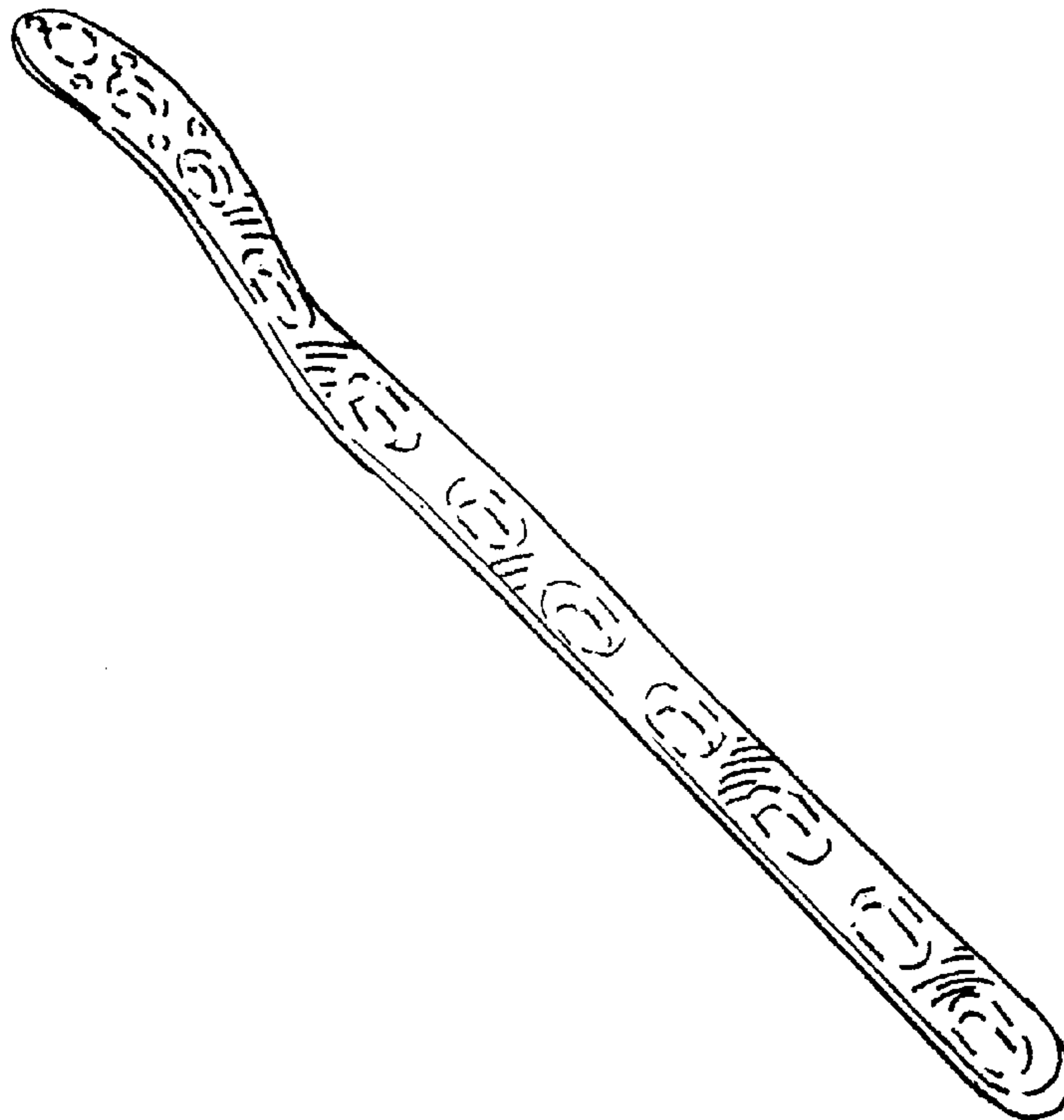

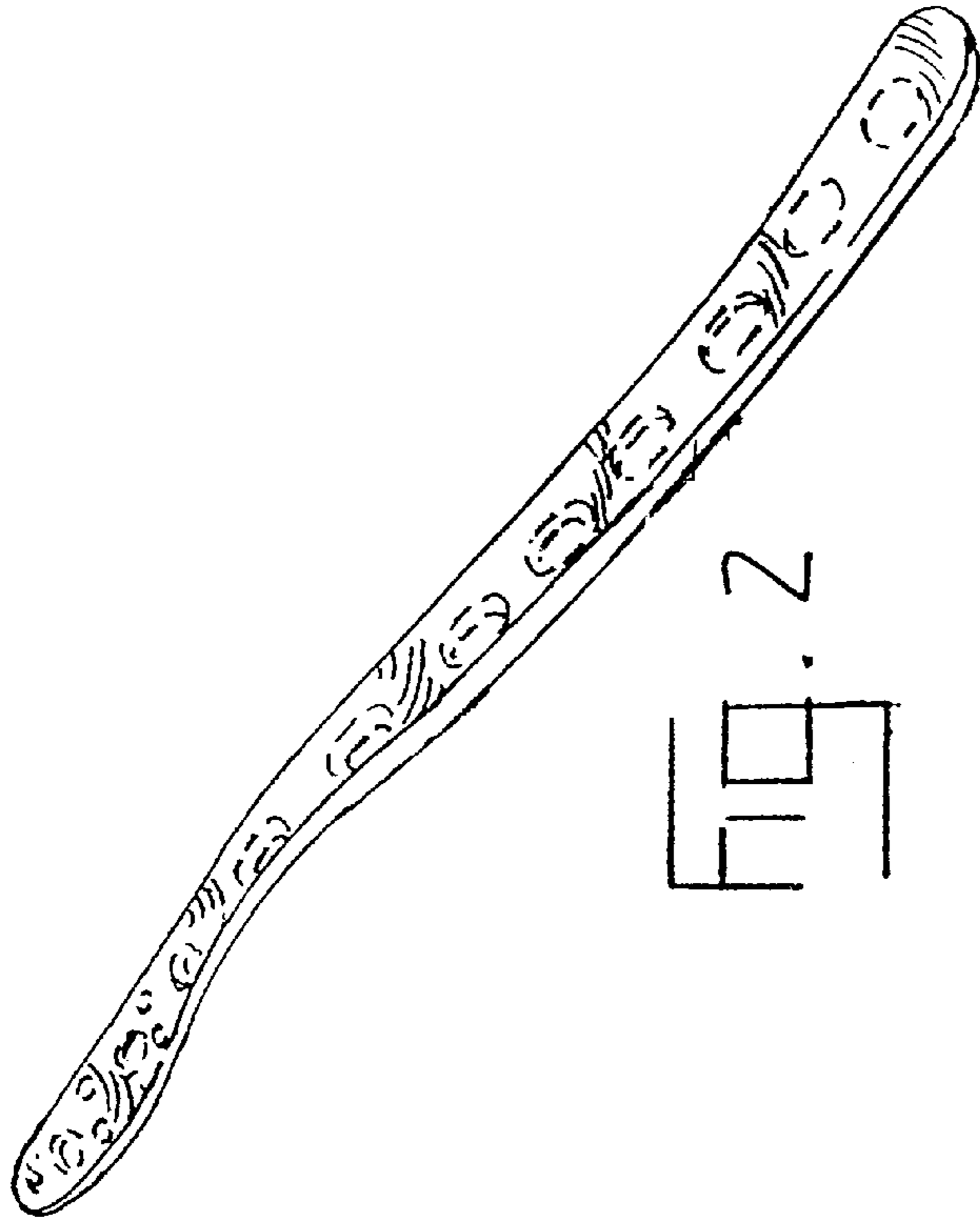

2

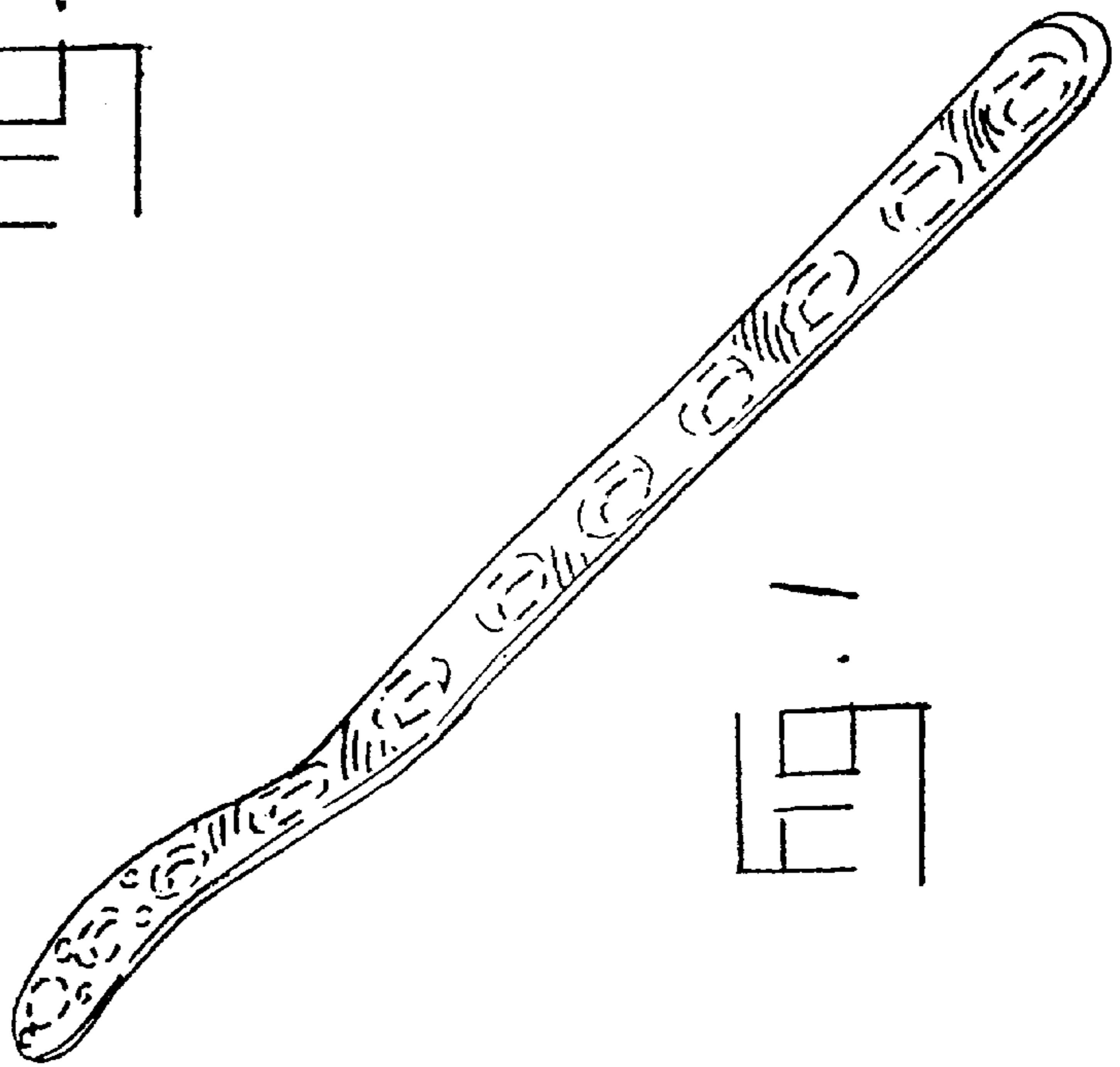

1

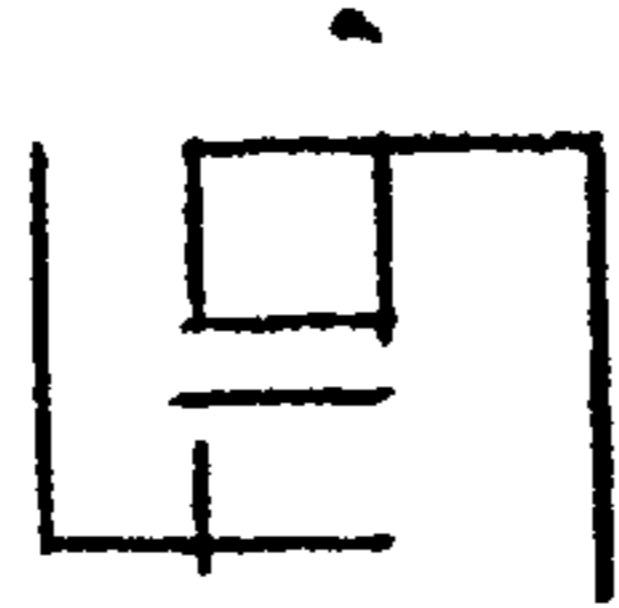

FIG. 3



FIG. 4

7



8

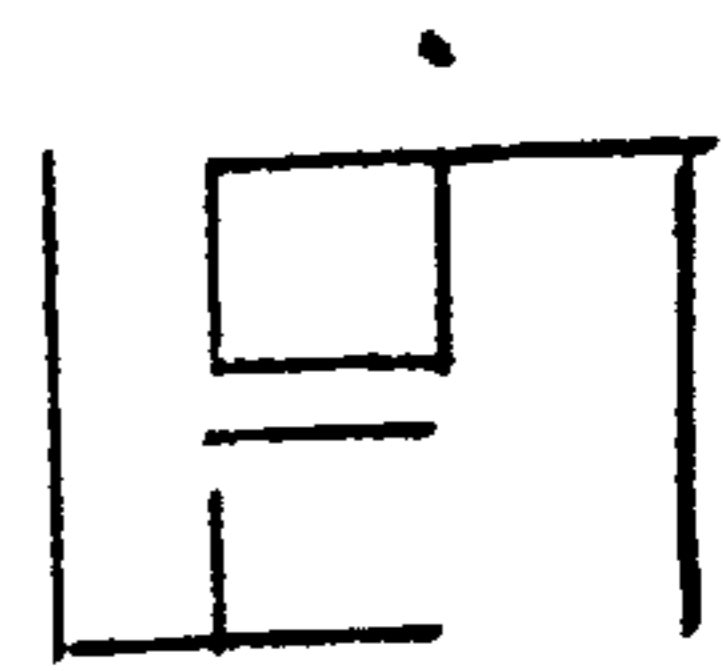
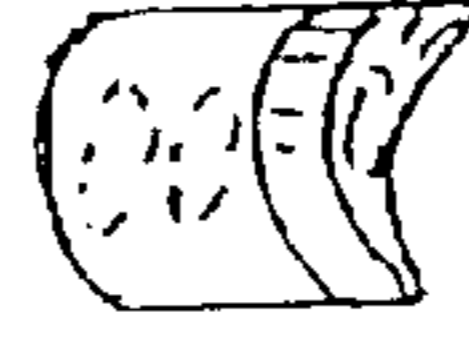

FIG. 5



FIG. 6

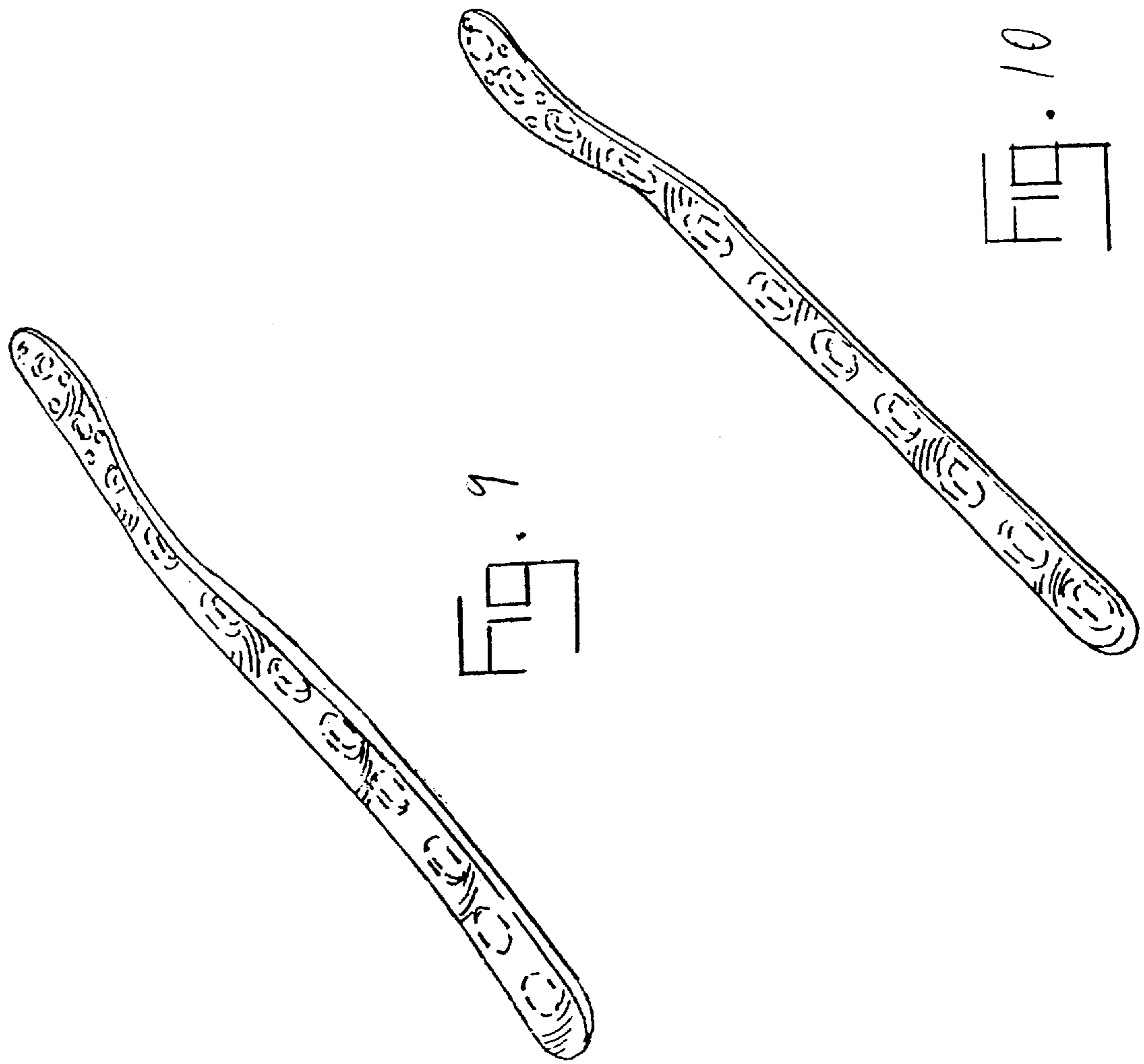



FIG. 11



FIG. 12

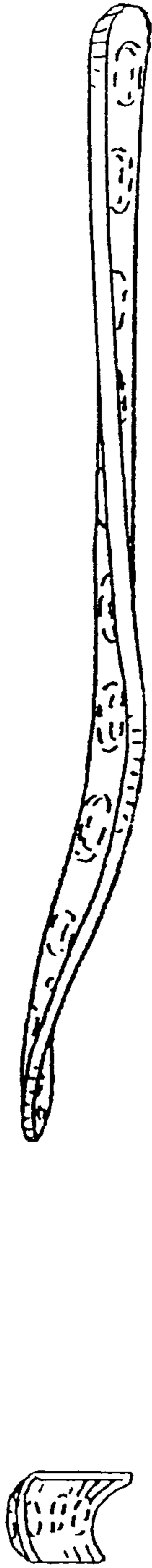

Fig 13

FIG 15



Fig 14

FIG. 16