



US00D458684S

(12) **United States Design Patent**  
**Bryant et al.**

(10) **Patent No.: US D458,684 S**  
(45) **Date of Patent: \*\* Jun. 11, 2002**

(54) **ORTHOPAEDIC BONE PLATE**

(74) *Attorney, Agent, or Firm*—Jacque R. Wilson

(75) **Inventors:** **Mark Bryant**, Auburn; **Aude Leroy-Gallissot**, Warsaw, both of IN (US); **Stephen B. Benirschke**, Seattle, WA (US); **Paul Duwelius**, Lake Oswego, OR (US); **James Goulet**, Ann Arbor, MI (US); **David Templeman**, Plymouth, MN (US); **Robert Winquist**, Seattle, WA (US)

(57) **CLAIM**

The ornamental design for an orthopaedic bone plate, as shown and described.

(73) **Assignee:** **Zimmer, Inc.**, Warsaw, IN (US)

(\*\*) **Term:** **14 Years**

**DESCRIPTION**

(21) **Appl. No.:** **29/151,643**

(22) **Filed:** **Nov. 13, 2001**

(51) **LOC (7) Cl.** ..... **24-03**

(52) **U.S. Cl.** ..... **D24/155**

(58) **Field of Search** ..... D24/155; 606/60, 606/69-72, 74

FIG. 1 is a top perspective view of an orthopaedic bone plate showing the present design.  
FIG. 2 is a bottom perspective view thereof.  
FIG. 3 is top view thereof.  
FIG. 4 is a bottom view thereof.  
FIG. 5 is left side elevational view thereof.  
FIG. 6 is a right side elevational view thereof.  
FIG. 7 is a front view thereof showing one end of the present invention.  
FIG. 8 is a rear view of the invention shown in FIG. 5.  
FIG. 9 is a top perspective view of second embodiment of the present invention.  
FIG. 10 is a bottom perspective view thereof.  
FIG. 11 is a top view thereof.  
FIG. 12 is a bottom view thereof.  
FIG. 13 is a partial front elevational view thereof  
FIG. 14 is a rear elevational view thereof.  
FIG. 15 is a right side elevational view thereof; and,  
FIG. 16 is a left side elevational view thereof.  
The broken line showing is for illustrative purposes only and forms no part of the claimed design.

(56) **References Cited**

**U.S. PATENT DOCUMENTS**

6,096,040 A \* 8/2000 Esser ..... 606/69  
D443,060 S \* 5/2001 Benirschke et al. .... D24/155

\* cited by examiner

*Primary Examiner*—Antoine Duval Davis

**1 Claim, 6 Drawing Sheets**

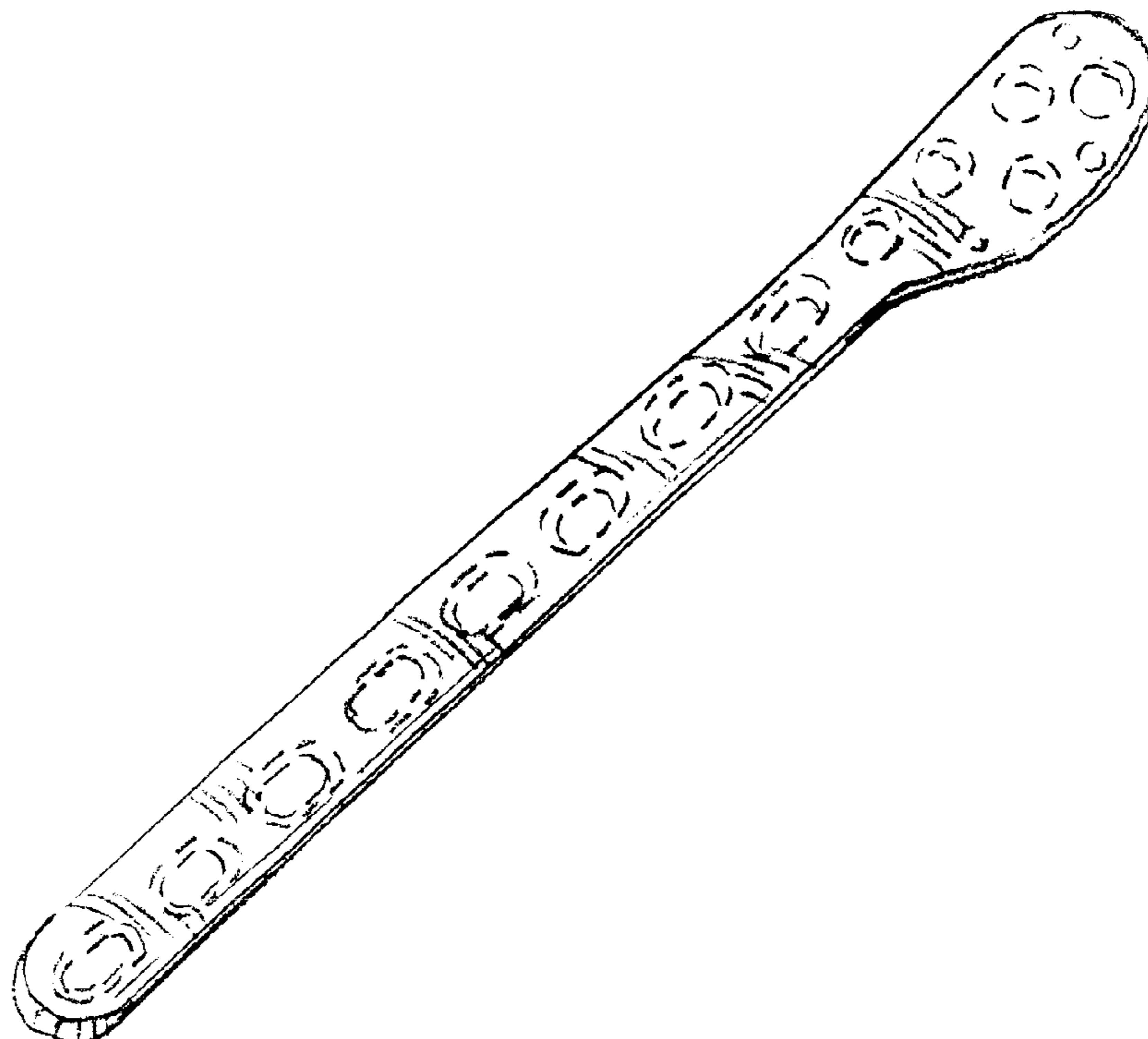

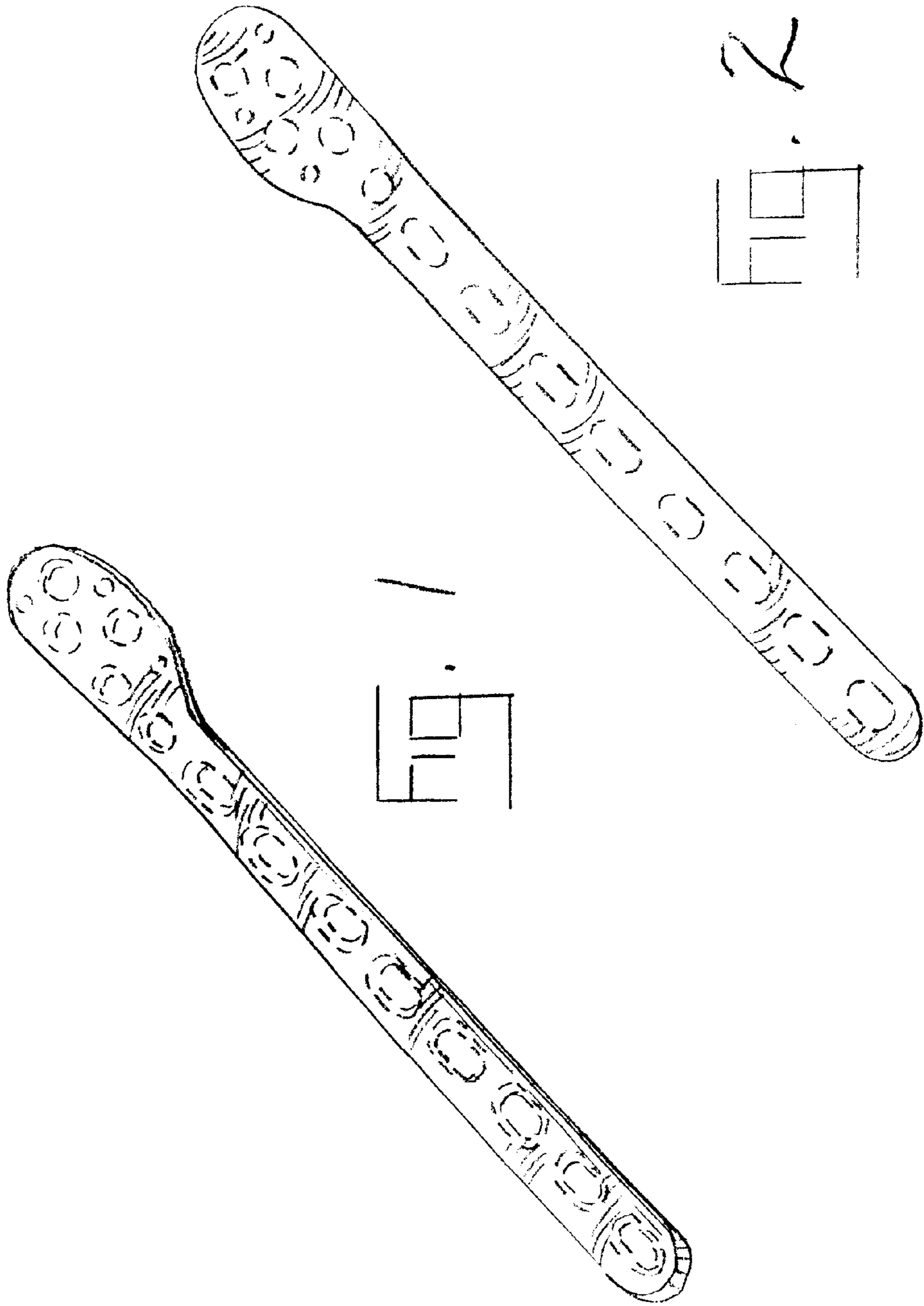

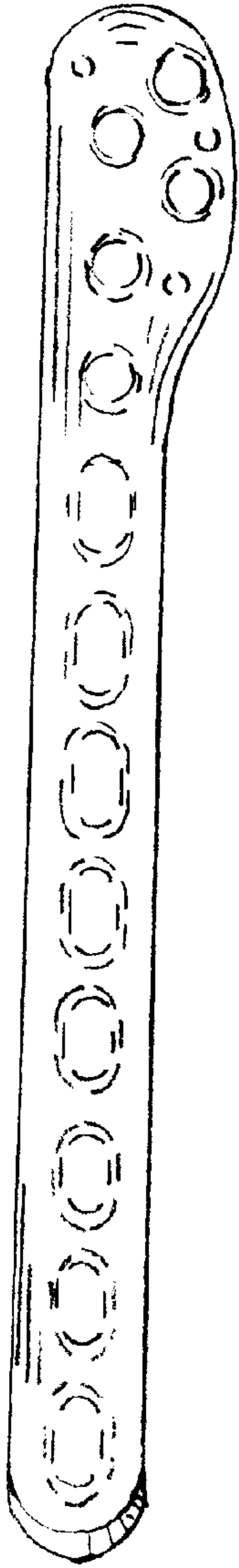

FIG. 3

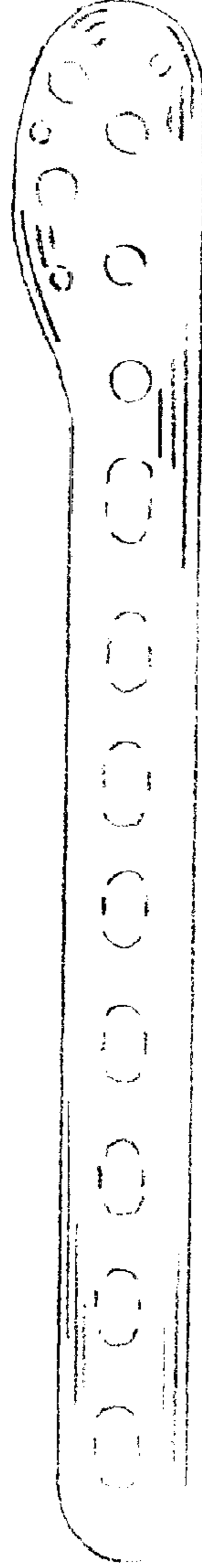

FIG. 4

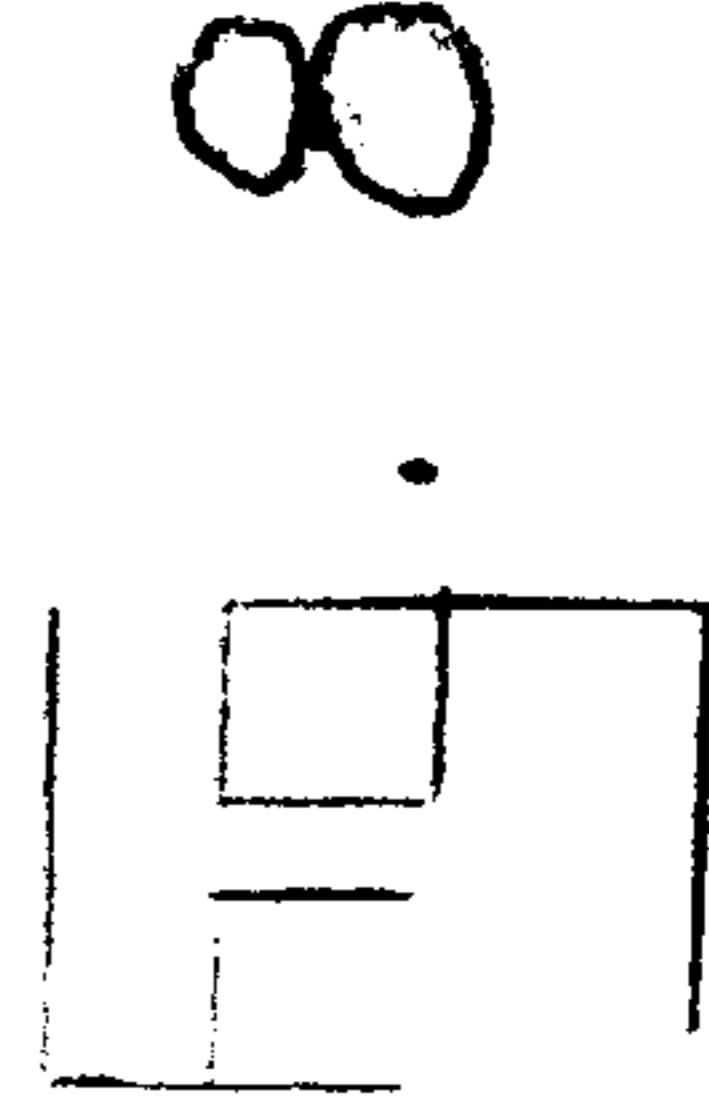
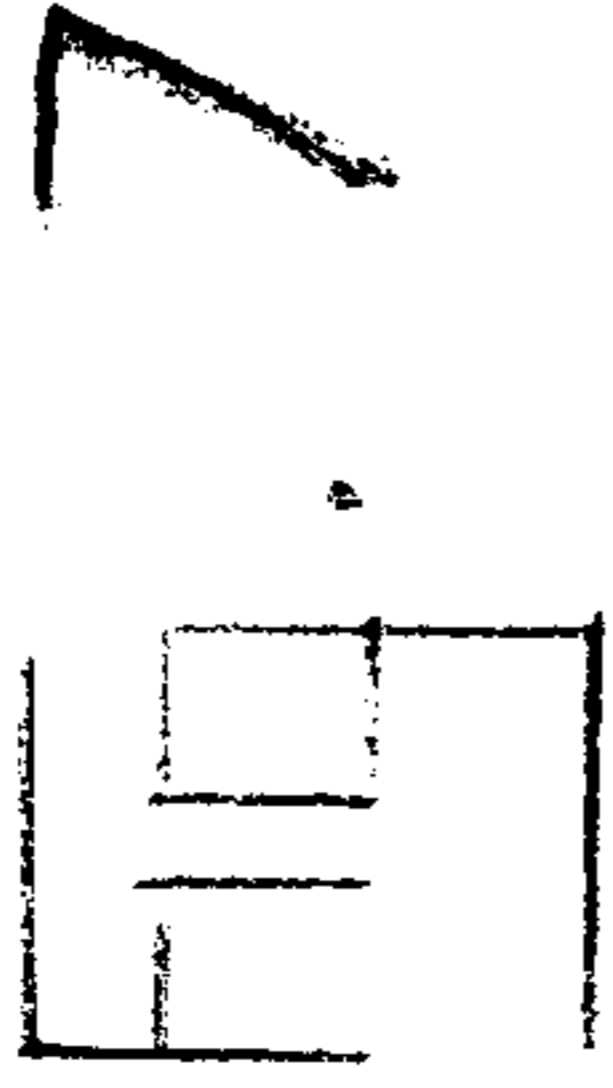

FIG. 5



FIG. 6

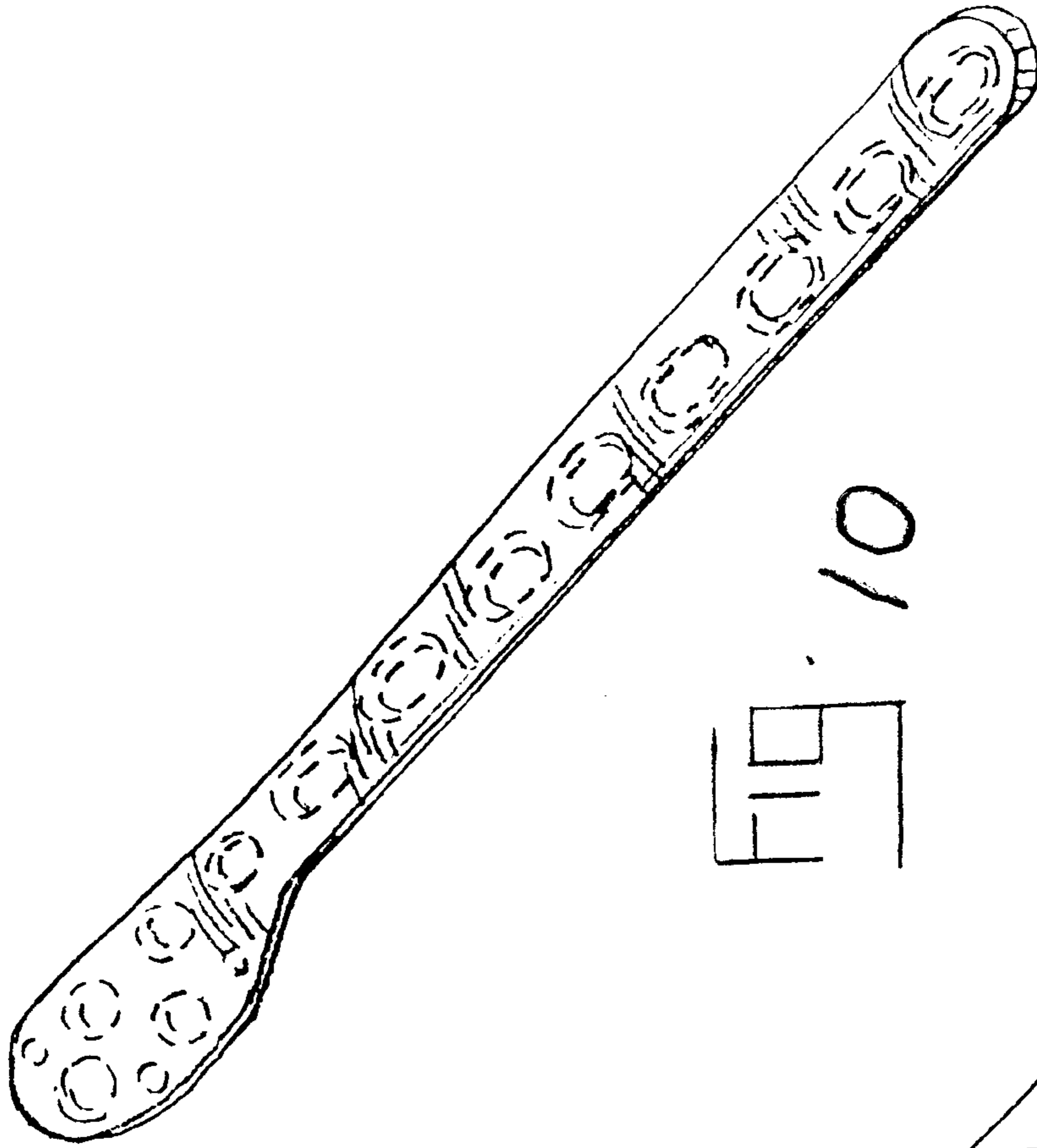

FIG. 10

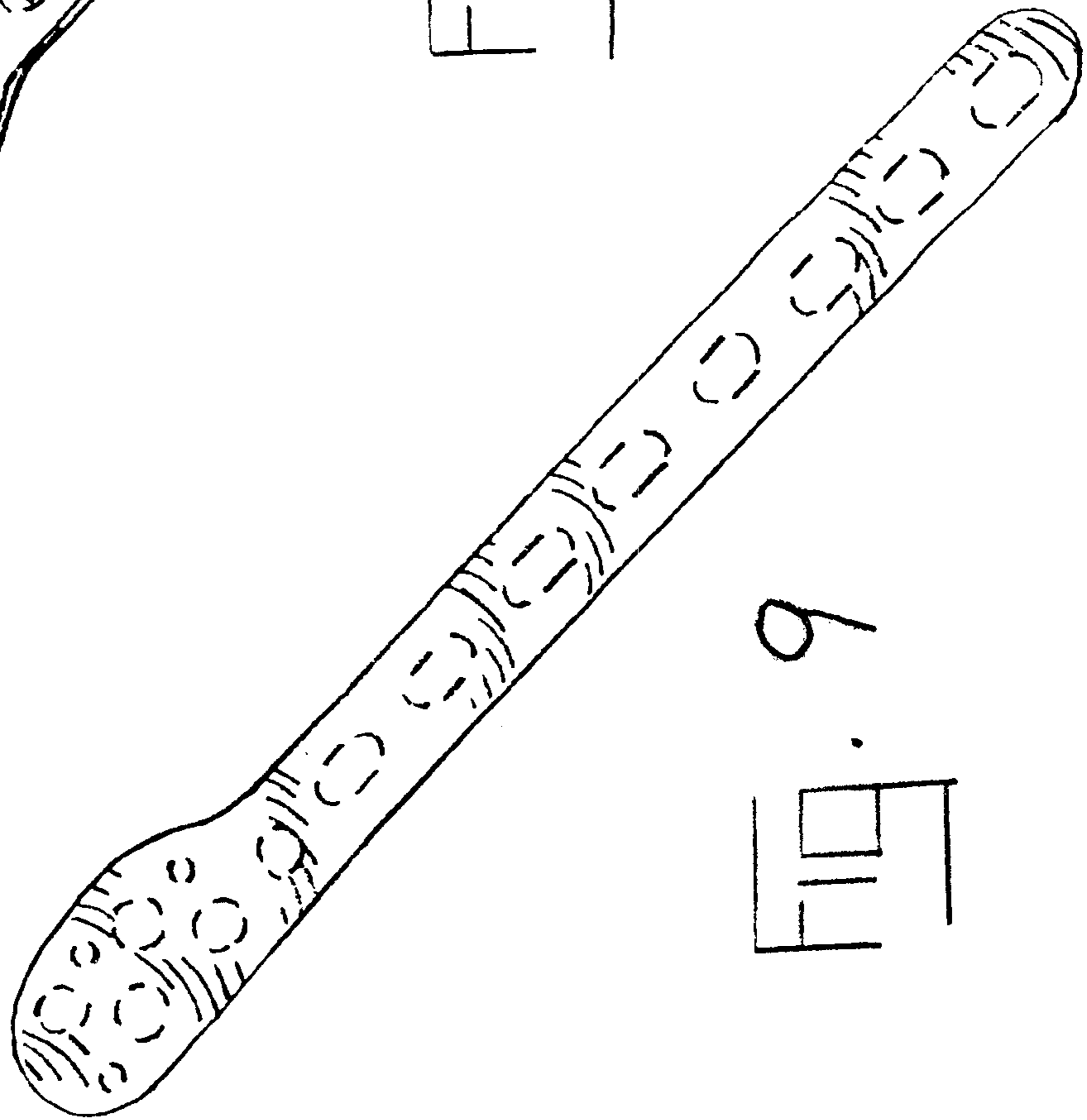

FIG. 9

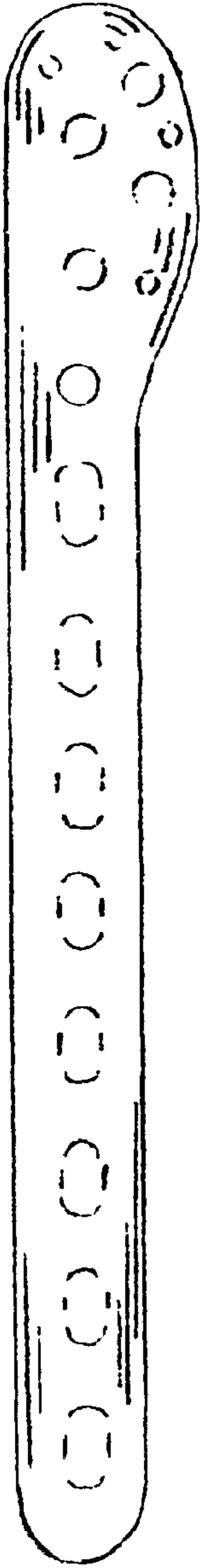

FIG. 11

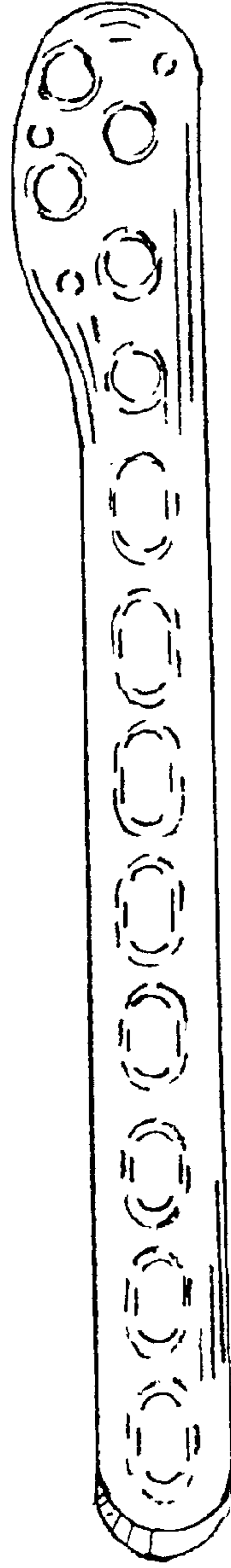

FIG. 12



FIG. 13



14

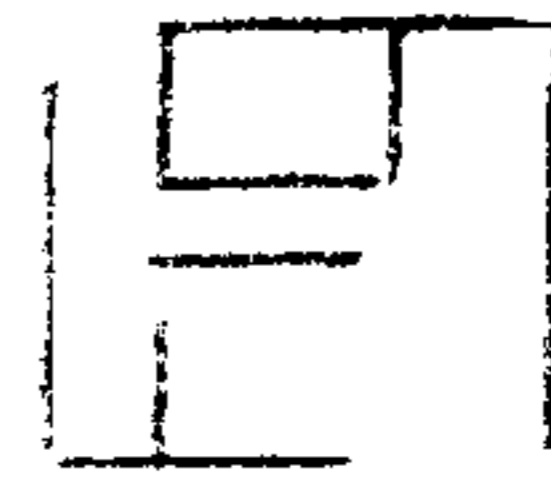

FIG. 15



FIG. 16