



US00D457167S

(12) **United States Design Patent**
Goracy

(10) **Patent No.:** **US D457,167 S**

(45) **Date of Patent:** **** May 14, 2002**

(54) **CURVED MANIFOLD FOR SMALL OVERHEAD VALVE OR CAM ENGINES**

Primary Examiner—Melody N. Brown
(74) *Attorney, Agent, or Firm*—Kelly Bauersfeld Lowry & Kelley, LLP

(76) **Inventor:** **Grant Goracy**, 13563 Cantlay St., Van Nuys, CA (US) 91405

(57) **CLAIM**

(**) **Term:** **14 Years**

The ornamental design for a curved manifold for small overhead valve or cam engines, as shown and described.

(21) **Appl. No.:** **29/133,495**

DESCRIPTION

(22) **Filed:** **Nov. 28, 2000**

(51) **LOC (7) Cl.** **15-01**

FIG. 1 is a front perspective view of a curved manifold for small overhead valve or cam engines embodying my design, wherein exemplary flanges are illustrated in broken lines and do not form part of the claimed design;

(52) **U.S. Cl.** **D15/5**

FIG. 2 is a right-side elevational view thereof;

(58) **Field of Search** D15/1, 5; D12/194; D23/233; 261/69.1; 60/598, 624; 123/52 MC

FIG. 3 is left-side elevational view thereof;

(56) **References Cited**

FIG. 4 is a top plan view thereof;

U.S. PATENT DOCUMENTS

FIG. 5 is a bottom plan view thereof;

D344,273 S * 2/1994 Benson D15/5

FIG. 6 is rear elevational view thereof; and,

D347,638 S * 6/1994 Benson D15/5

FIG. 7 is a front elevational view thereof.

* cited by examiner

1 Claim, 2 Drawing Sheets

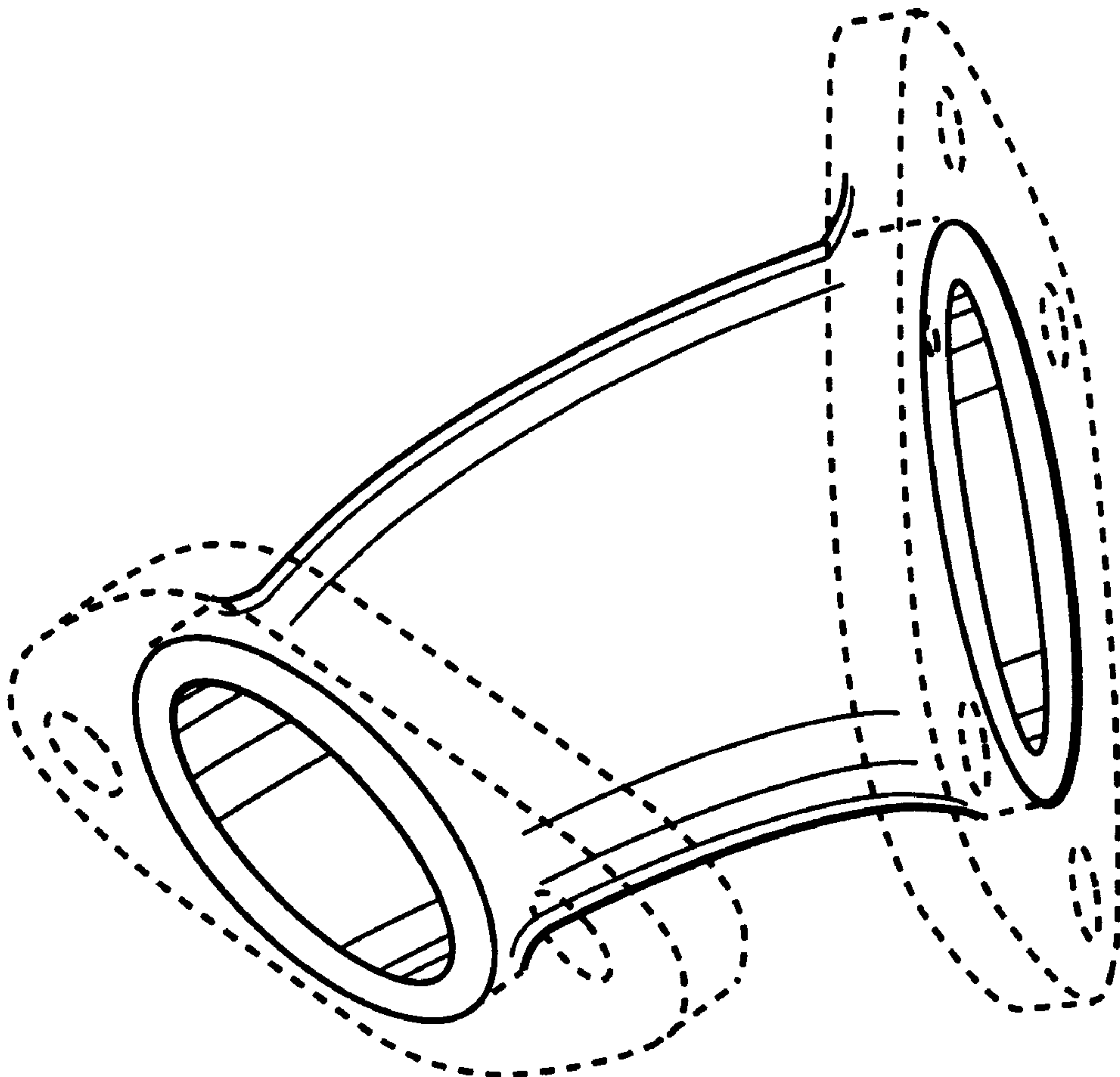

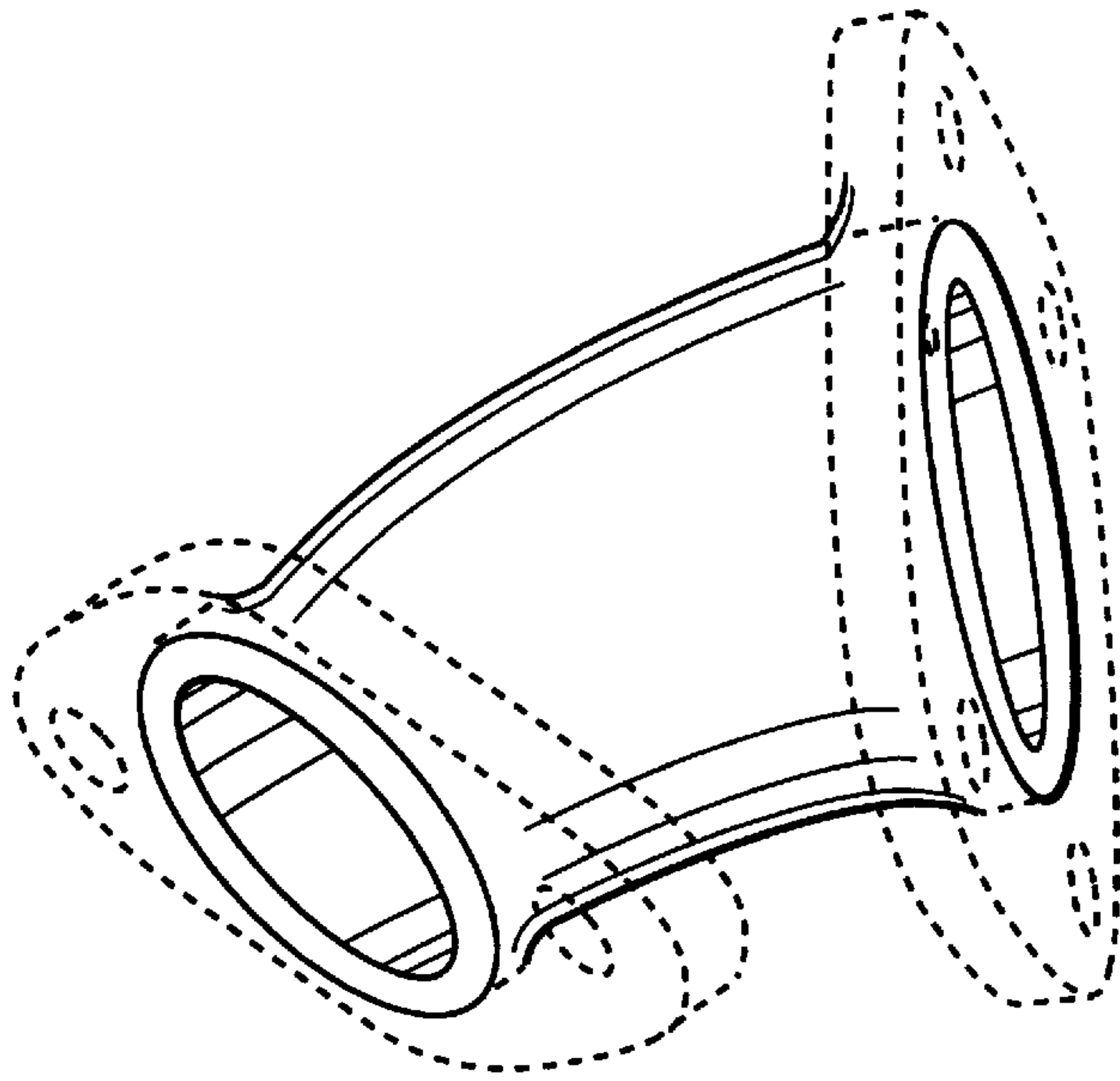

FIG. 1

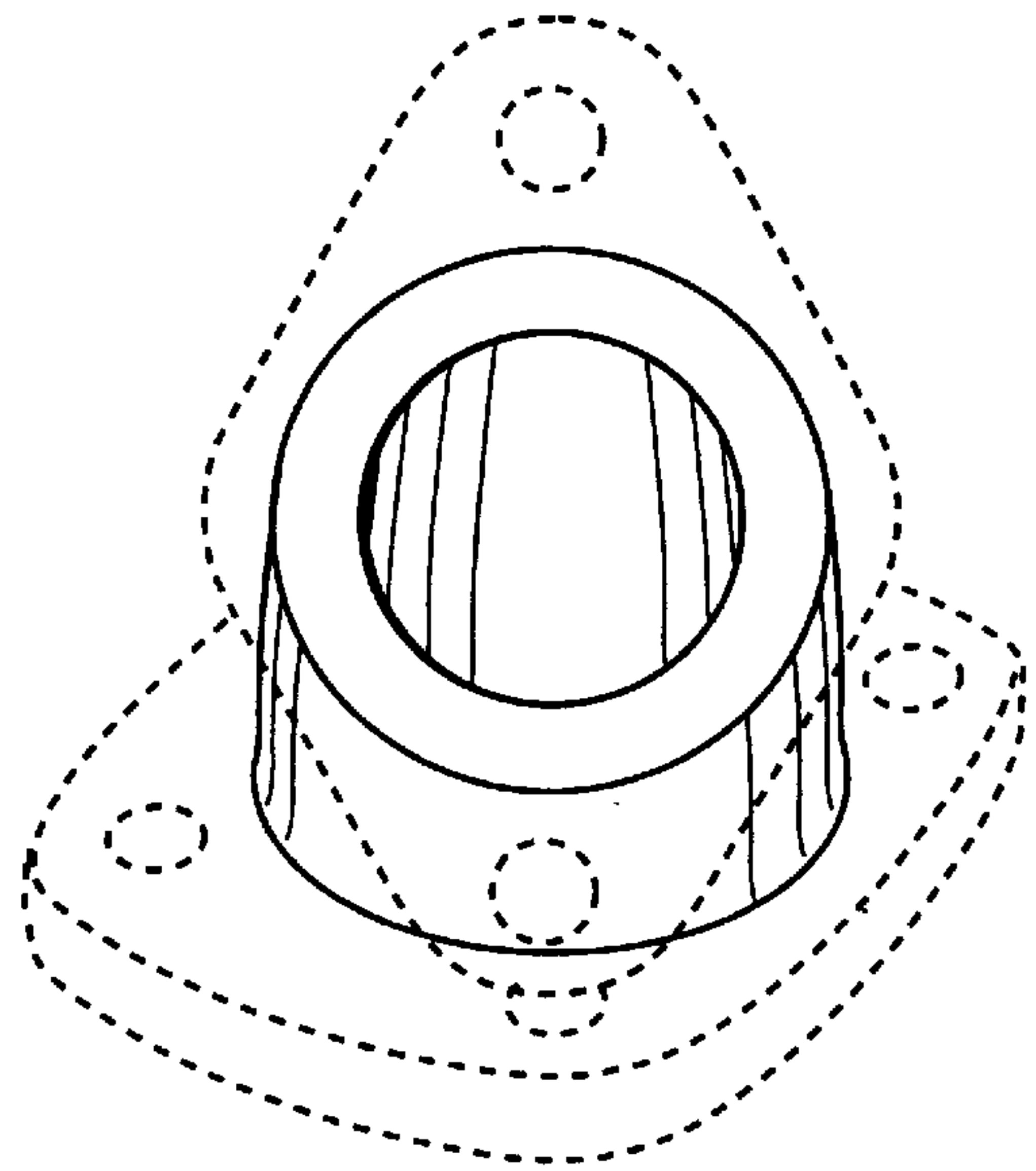

FIG. 2

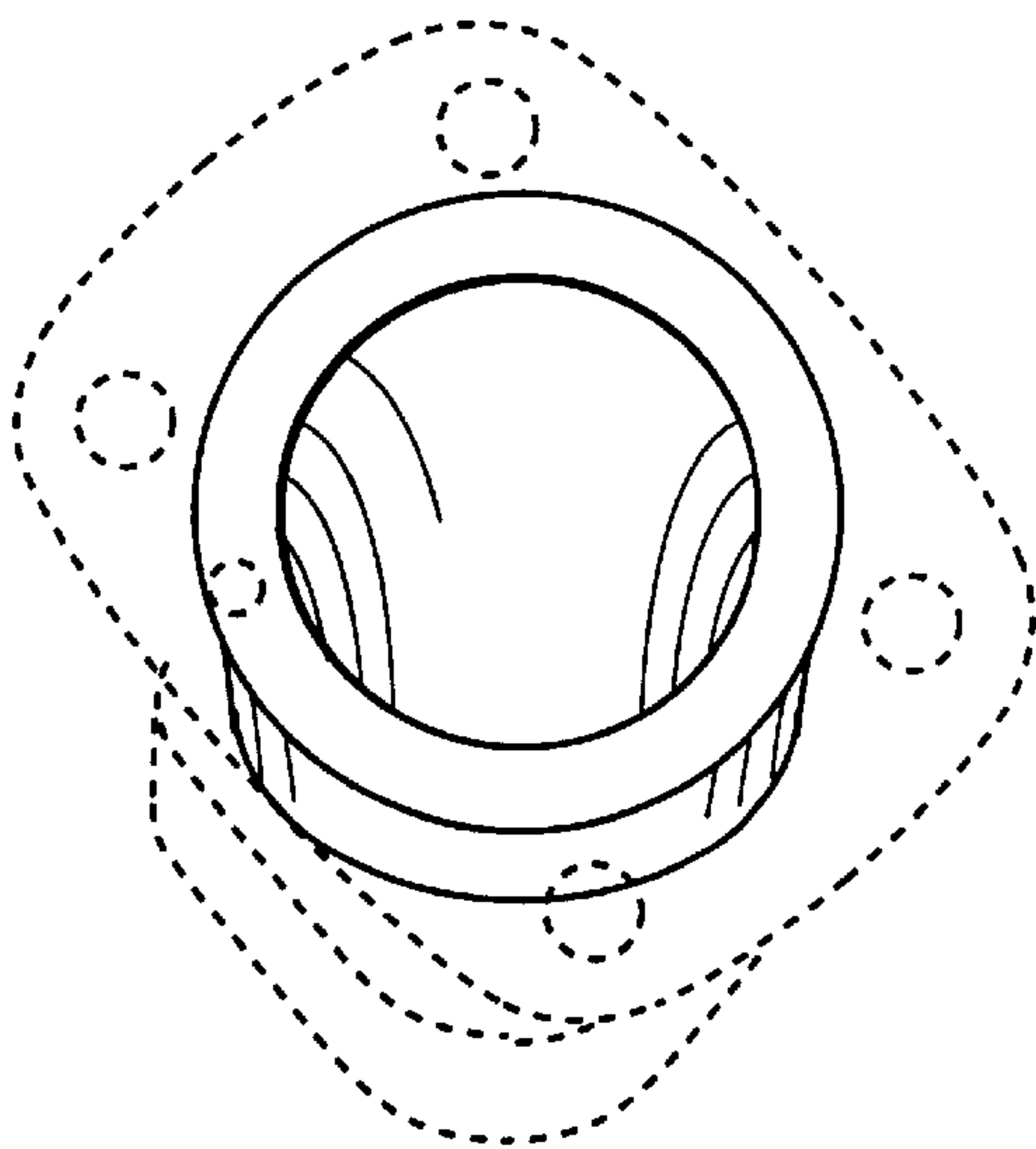

FIG. 3

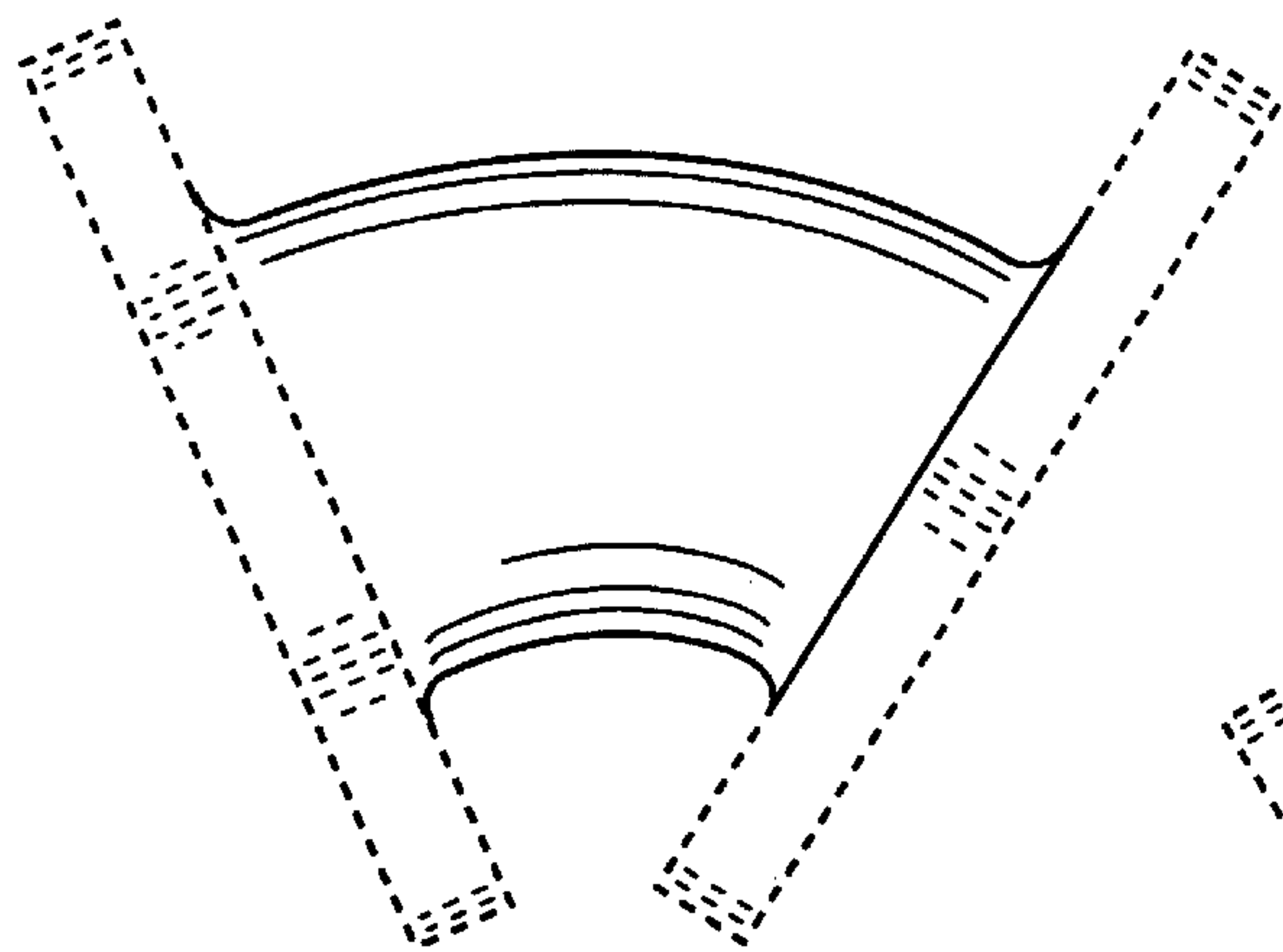

FIG. 4

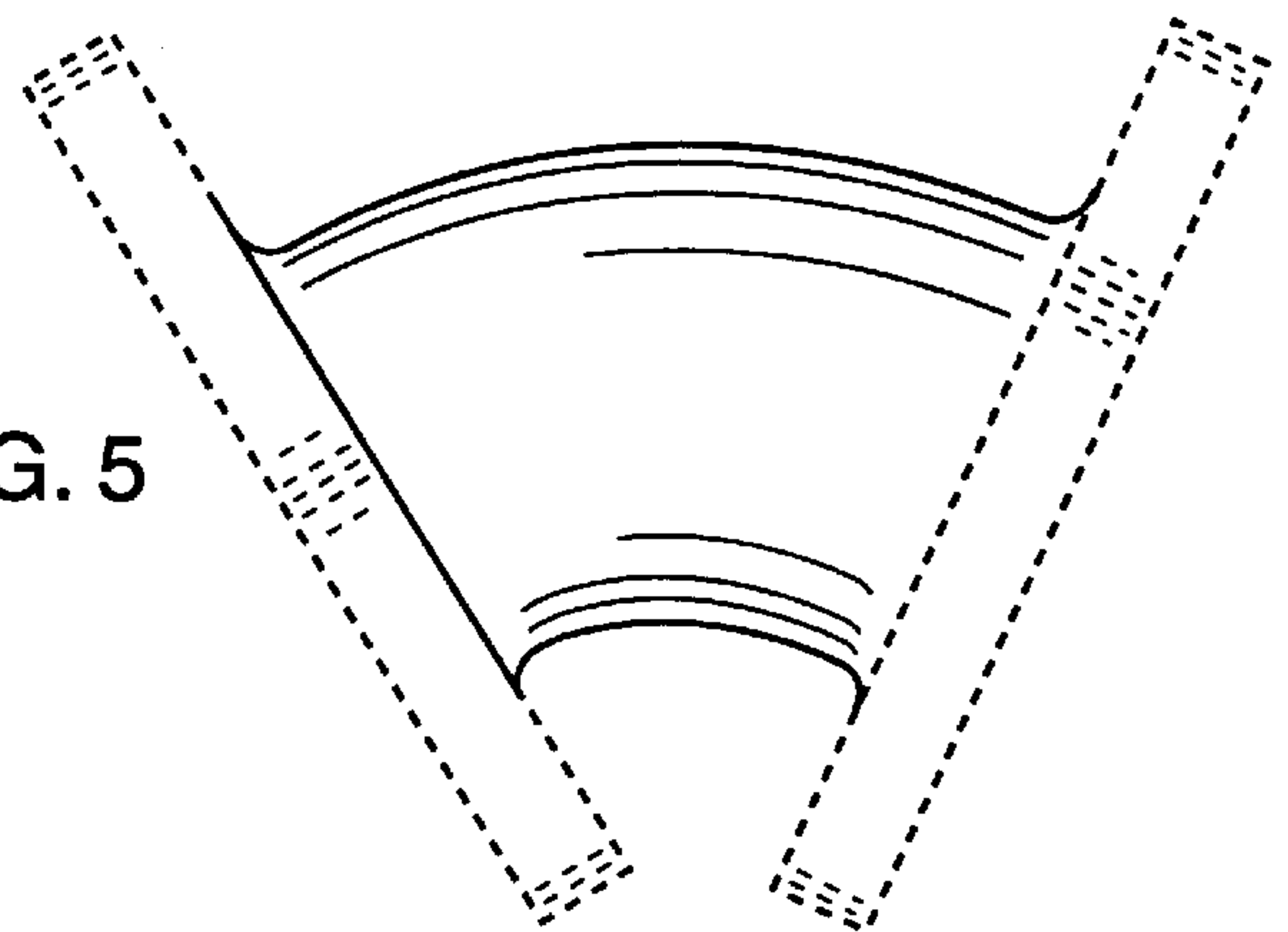

FIG. 5

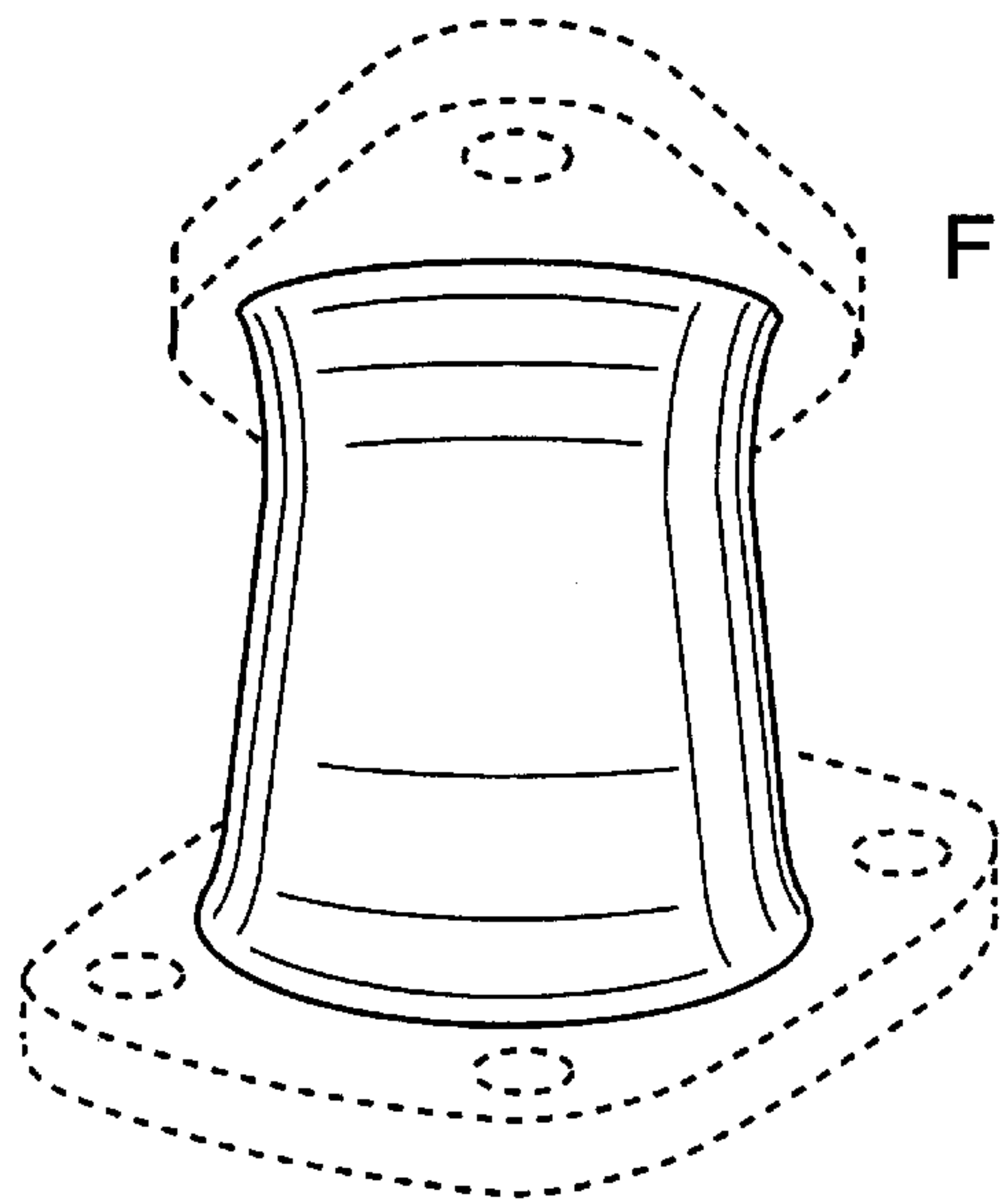

FIG. 6

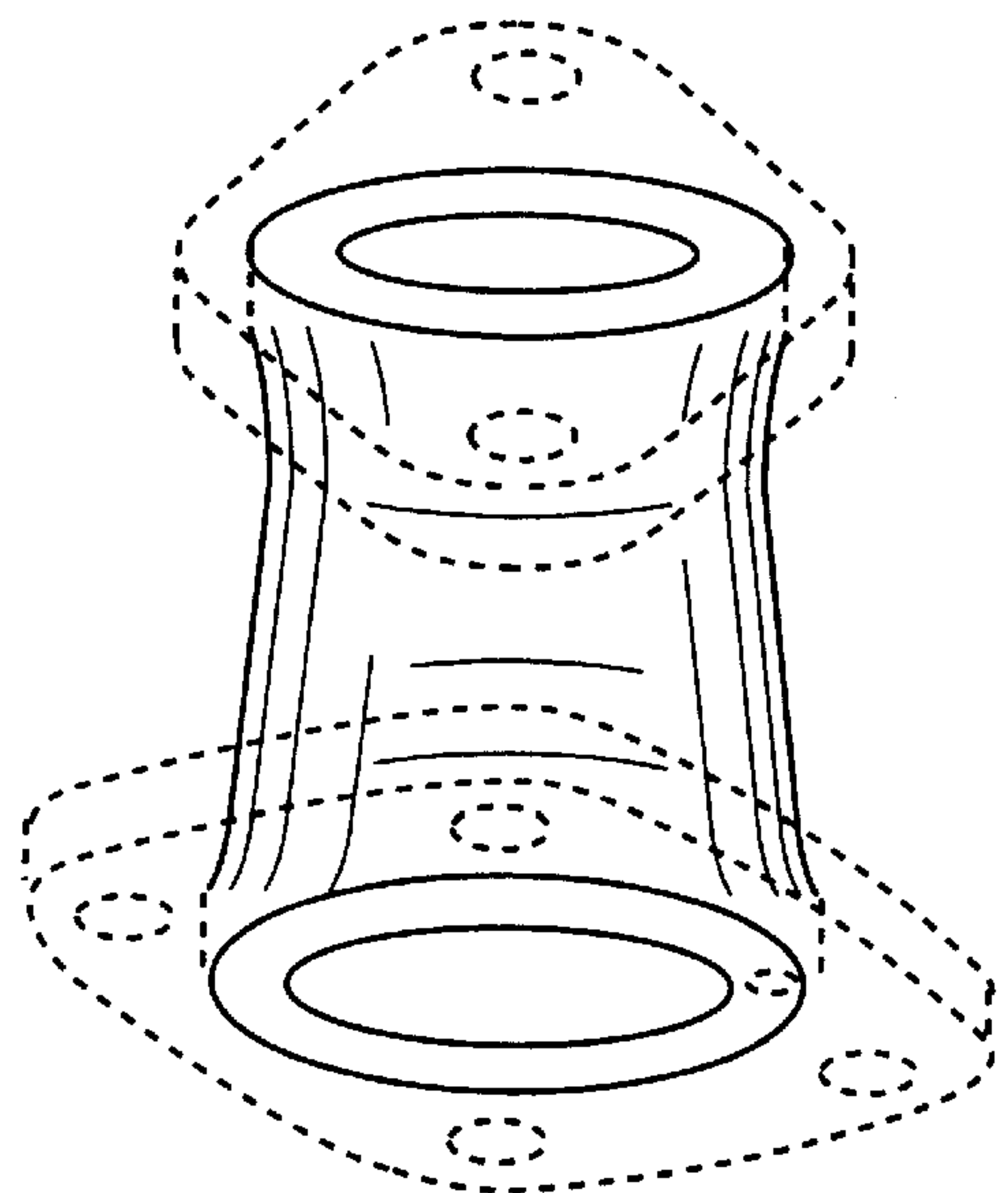

FIG. 7