



US00D451739B1

(12) **United States Design Patent**  
**Yeh**

(10) **Patent No.:** **US D451,739 S**

(45) **Date of Patent:** **\*\* Dec. 11, 2001**

(54) **TOWEL BAR SUPPORT**

(76) **Inventor:** **Hsien-Min Yeh**, 7F-2, No.2, Sec.2,  
Chung Shan Road, Chang Hua City  
(TW)

(\*\*) **Term:** **14 Years**

(21) **Appl. No.:** **29/133,061**

(22) **Filed:** **Nov. 22, 2000**

(51) **LOC (7) Cl.** ..... **06-04**

(52) **U.S. Cl.** ..... **D6/550**

(58) **Field of Search** ..... D6/546-50, 518,  
D6/522-24; D8/300, 315-21, 354, 363,  
373, 380; 108/28-29; 211/13.1, 16, 60.1,  
86.01, 87.01, 88.04, 100, 105.1-105.2,  
123, 181.1, 182; 248/175, 176.1, 251, 302;  
16/110.1, 412, 415; 242/570, 590, 595-598;  
206/389

(56) **References Cited**

**U.S. PATENT DOCUMENTS**

- D. 385,735 \* 11/1997 Hundley et al. .... D6/524
- D. 417,989 \* 12/1999 Moore et al. .... D6/524
- D. 431,139 \* 9/2000 Chen ..... D6/524

**OTHER PUBLICATIONS**

Paul Associates Catalogue p. 38, item 901 Hook.\*  
Baldwin Bath "Epic Accessories" Catalogue Palm Spring  
bracket.\*

\* cited by examiner

*Primary Examiner*—Brian N. Vinson  
(74) *Attorney, Agent, or Firm*—Dougherty & Troxell

(57) **CLAIM**

The ornamental design for a towel bar support, as shown and  
described.

**DESCRIPTION**

FIG. 1 is a front view of a towel bar support showing my  
new design;  
FIG. 2 is a rear view thereof;  
FIG. 3 is a left view thereof;  
FIG. 4 is a right view thereof;  
FIG. 5 is a top view thereof;  
FIG. 6 is a bottom view thereof;  
FIG. 7 is an elevational view thereof; and,  
FIG. 8 is a perspective view thereof, the broken-line dis-  
closure of the second support and the towel bar are for  
illustrative purposes only and form no part of the claimed  
design.

**1 Claim, 3 Drawing Sheets**

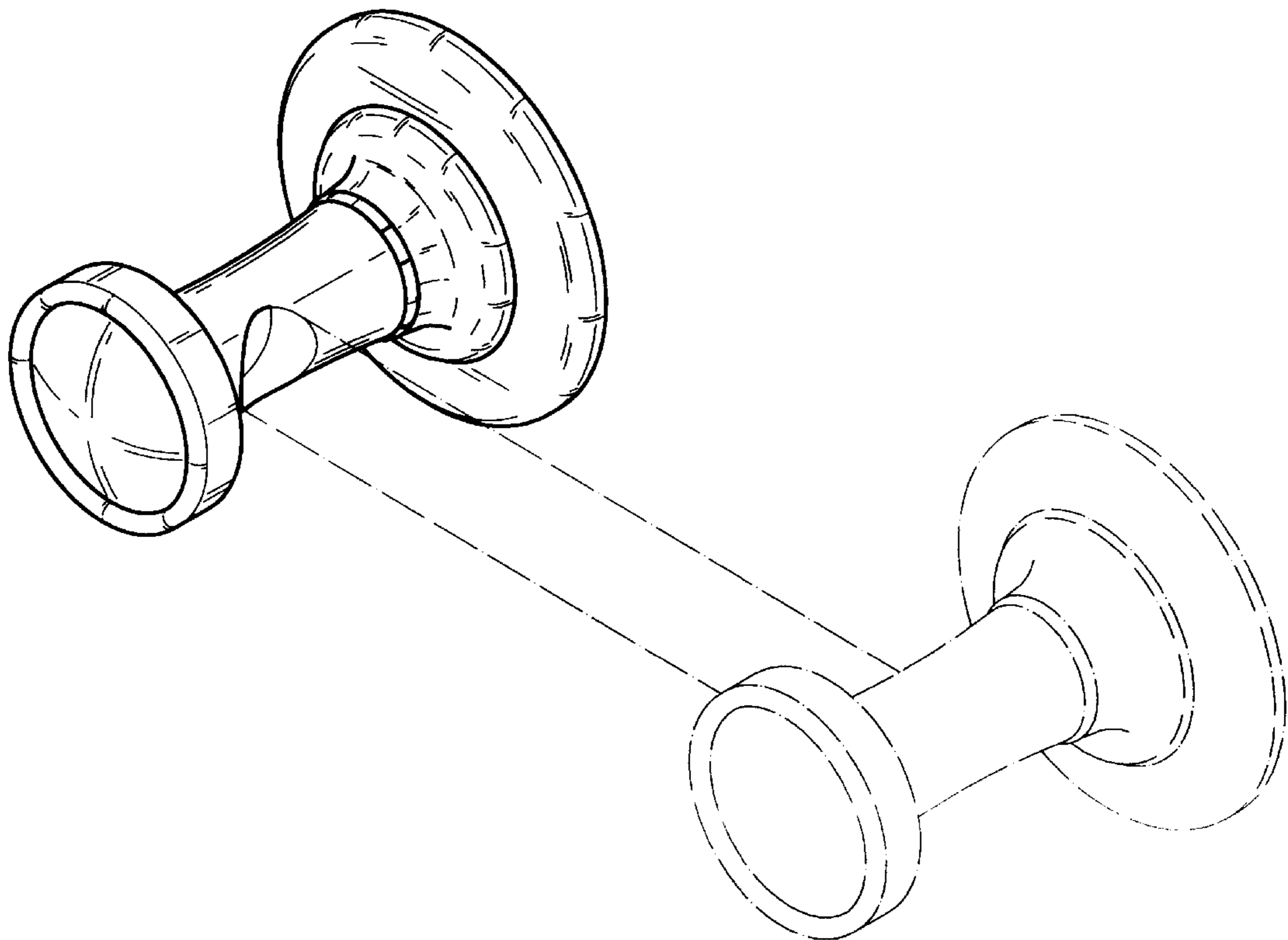

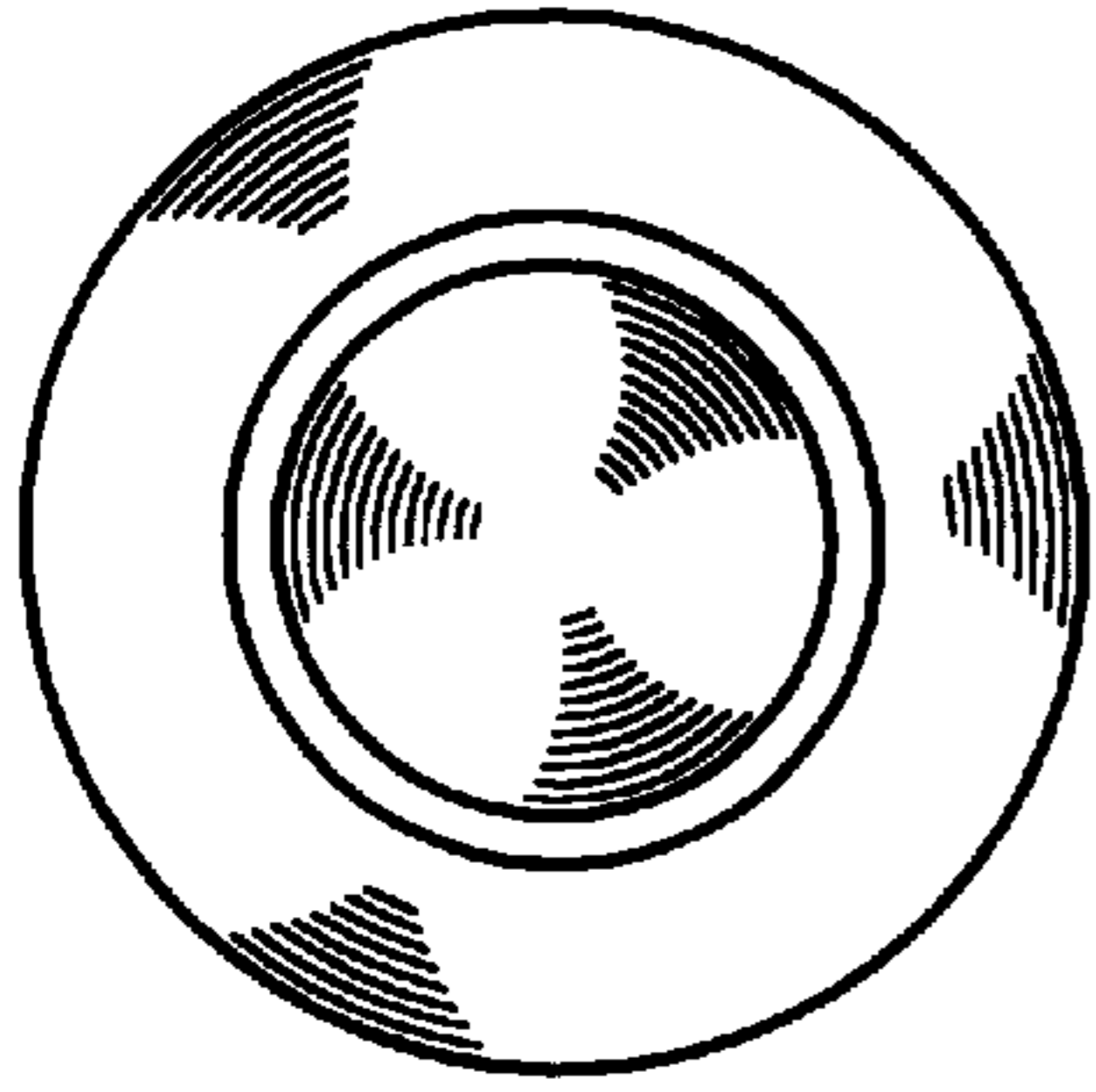

FIG5

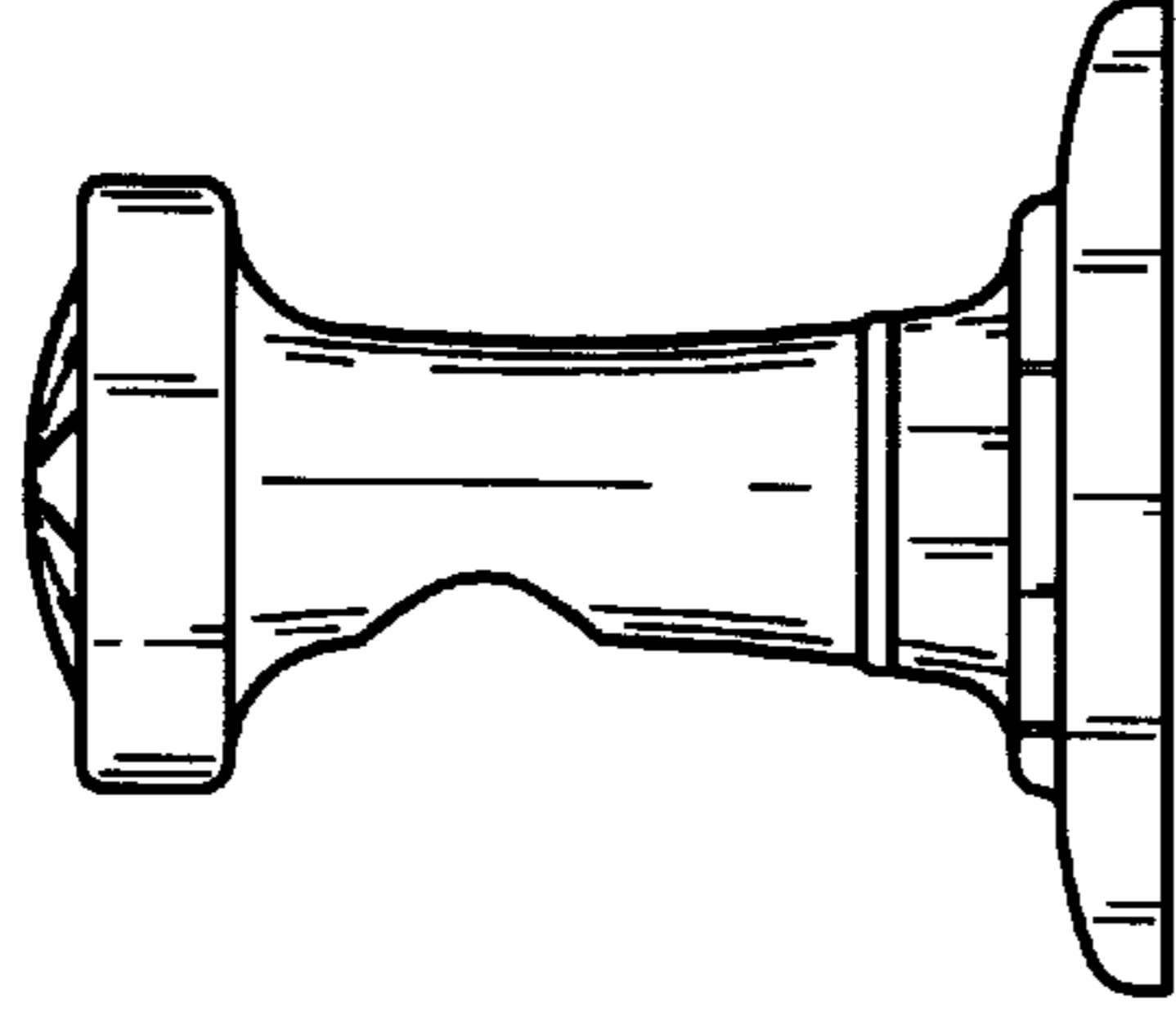

FIG4

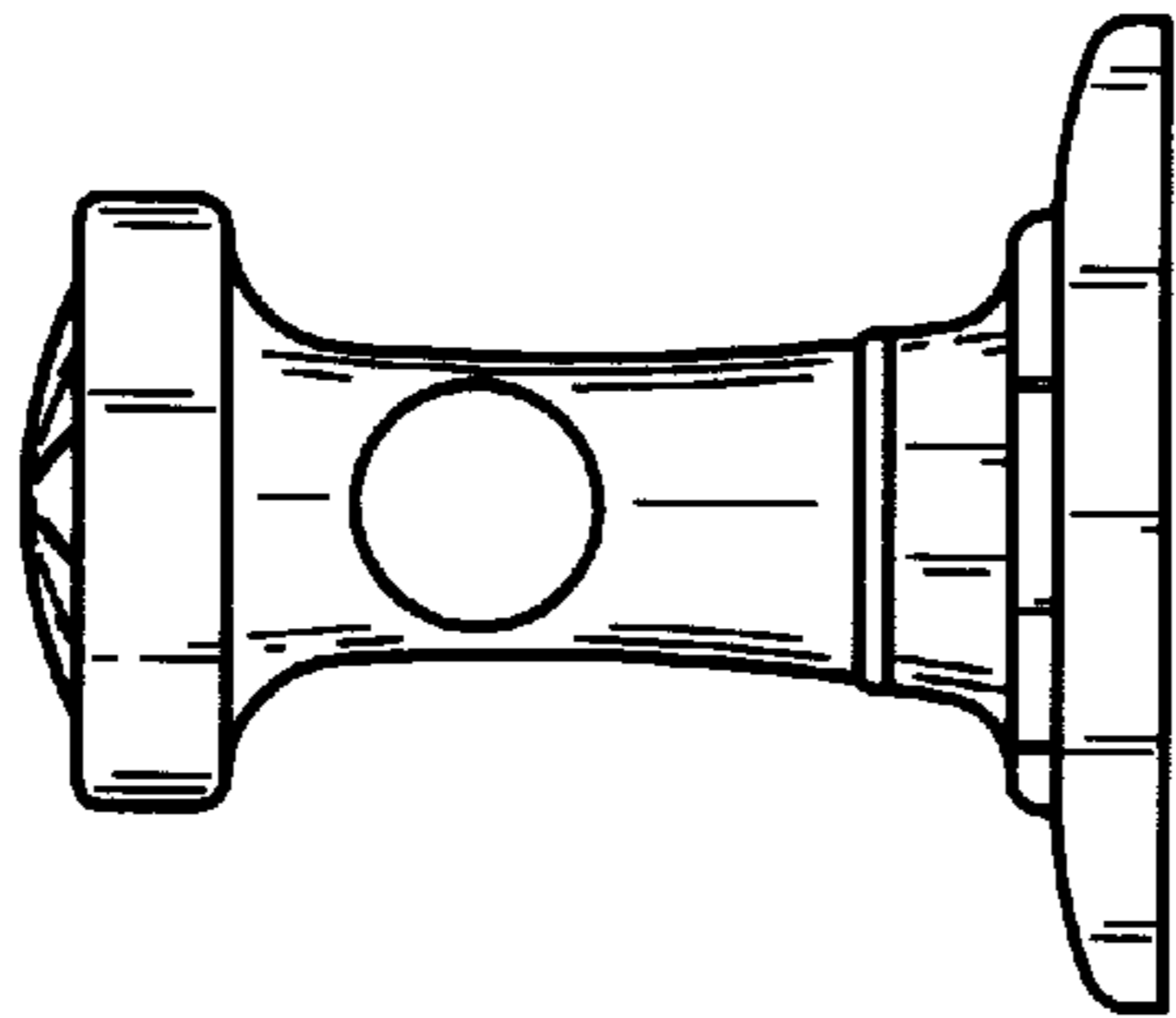

FIG1

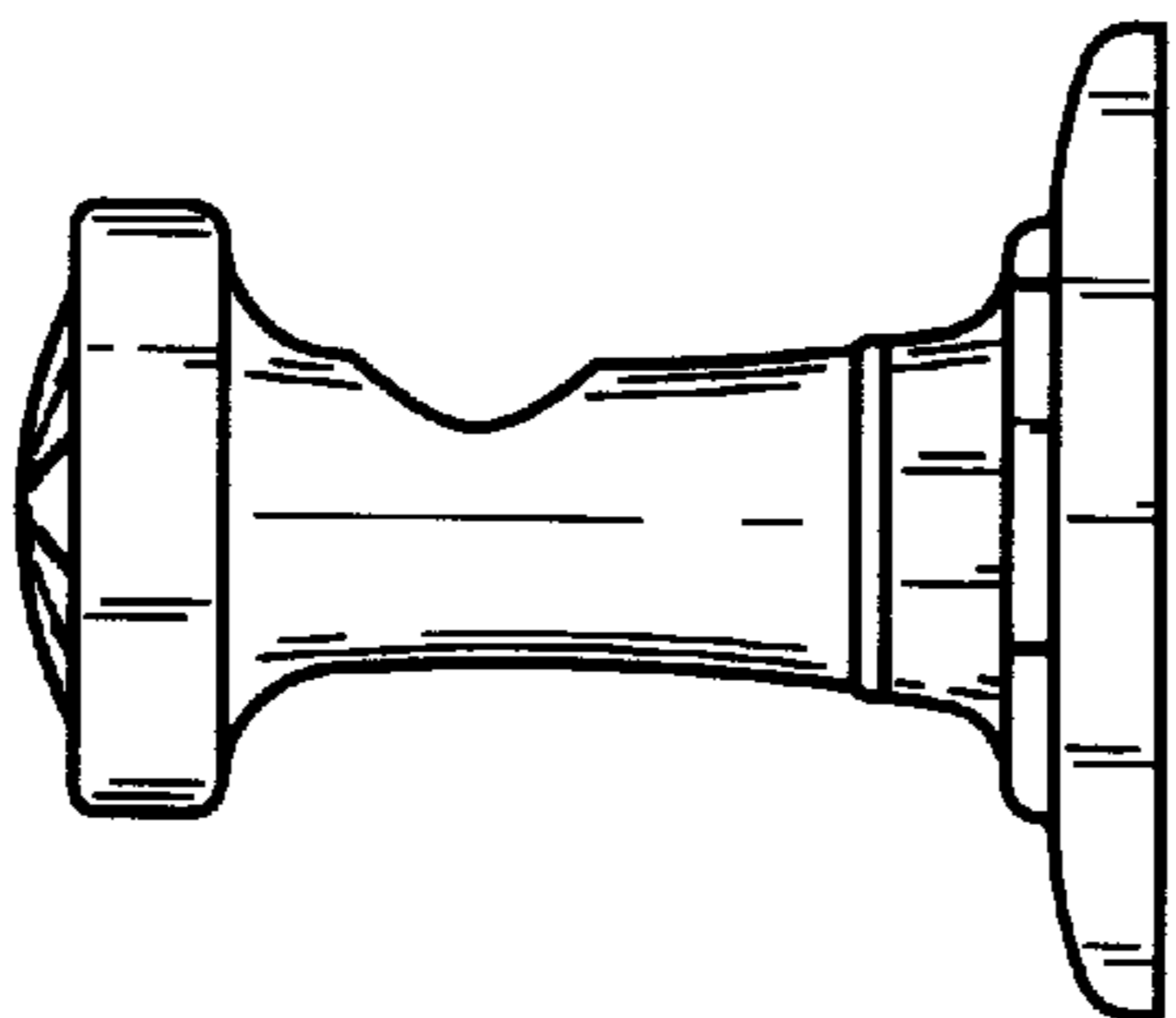

FIG3

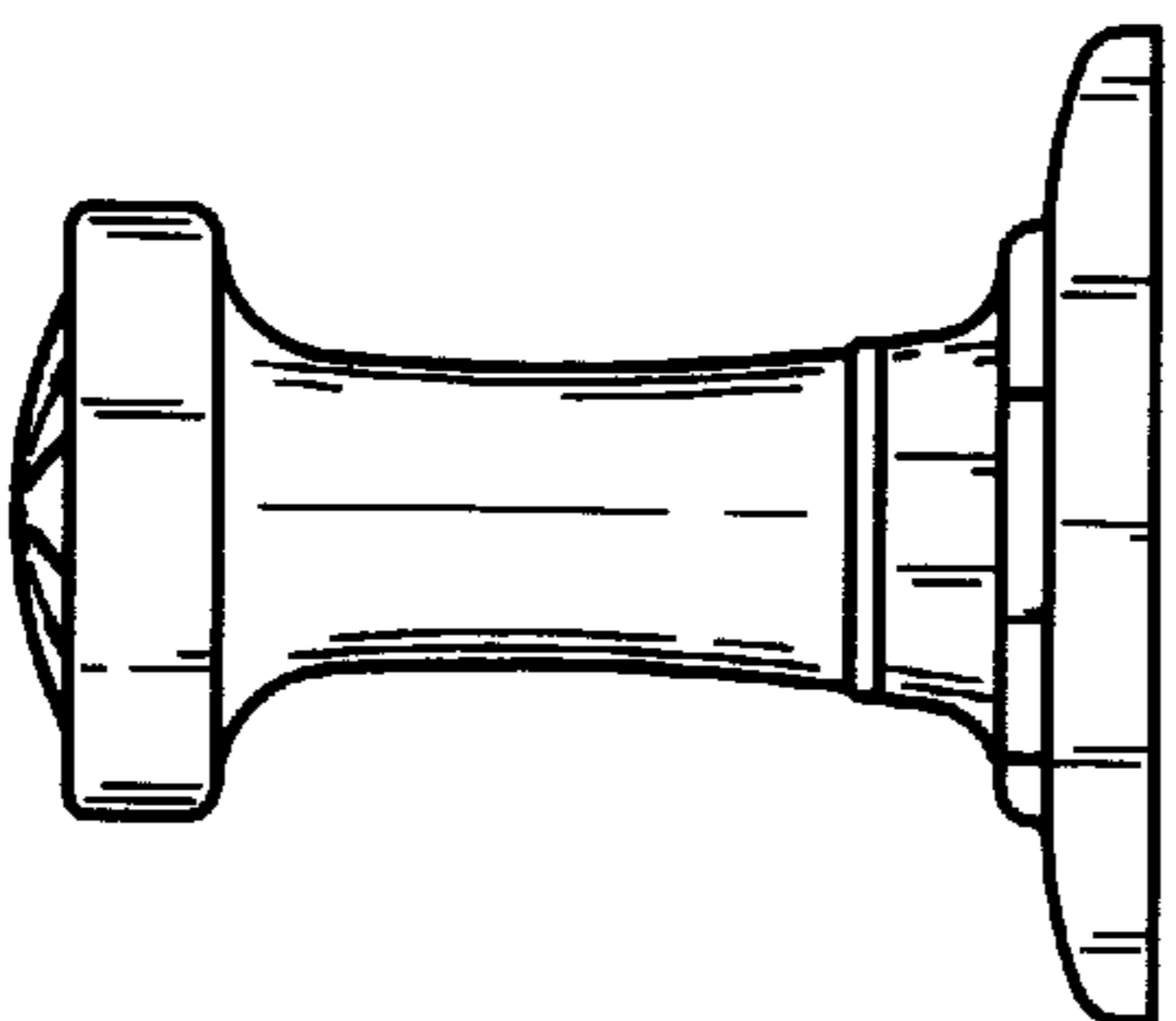

FIG2

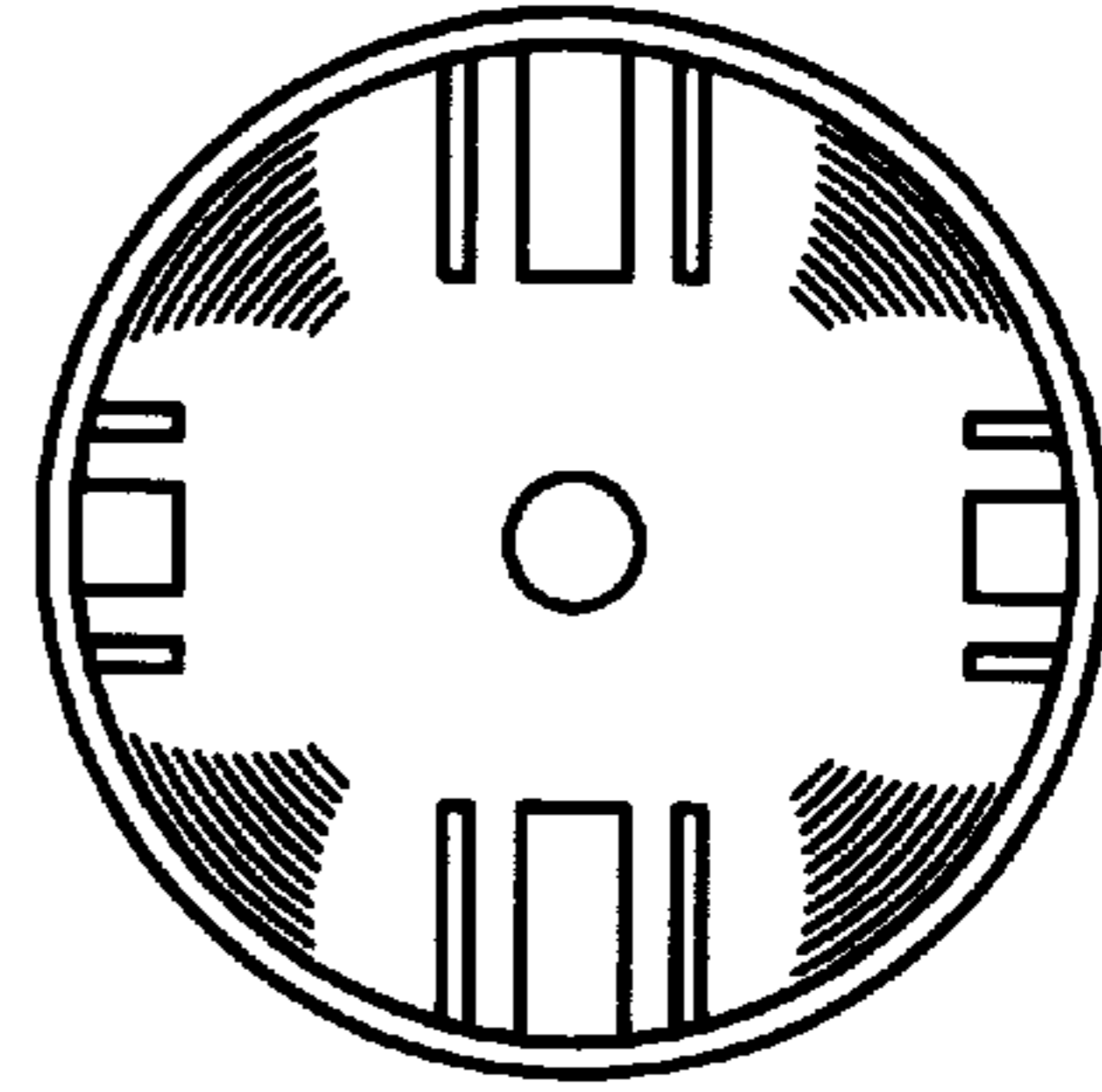

FIG6

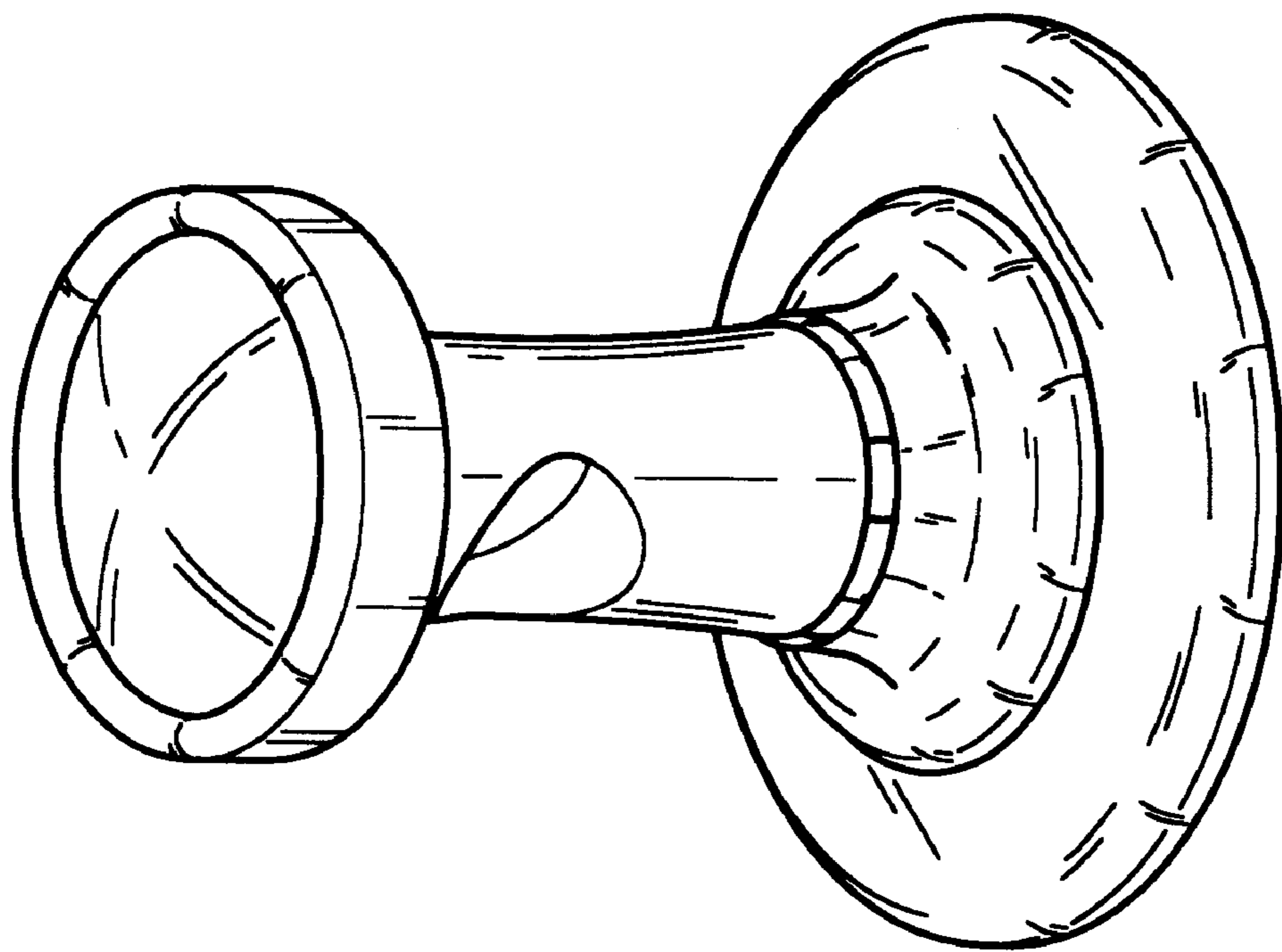

FIG7

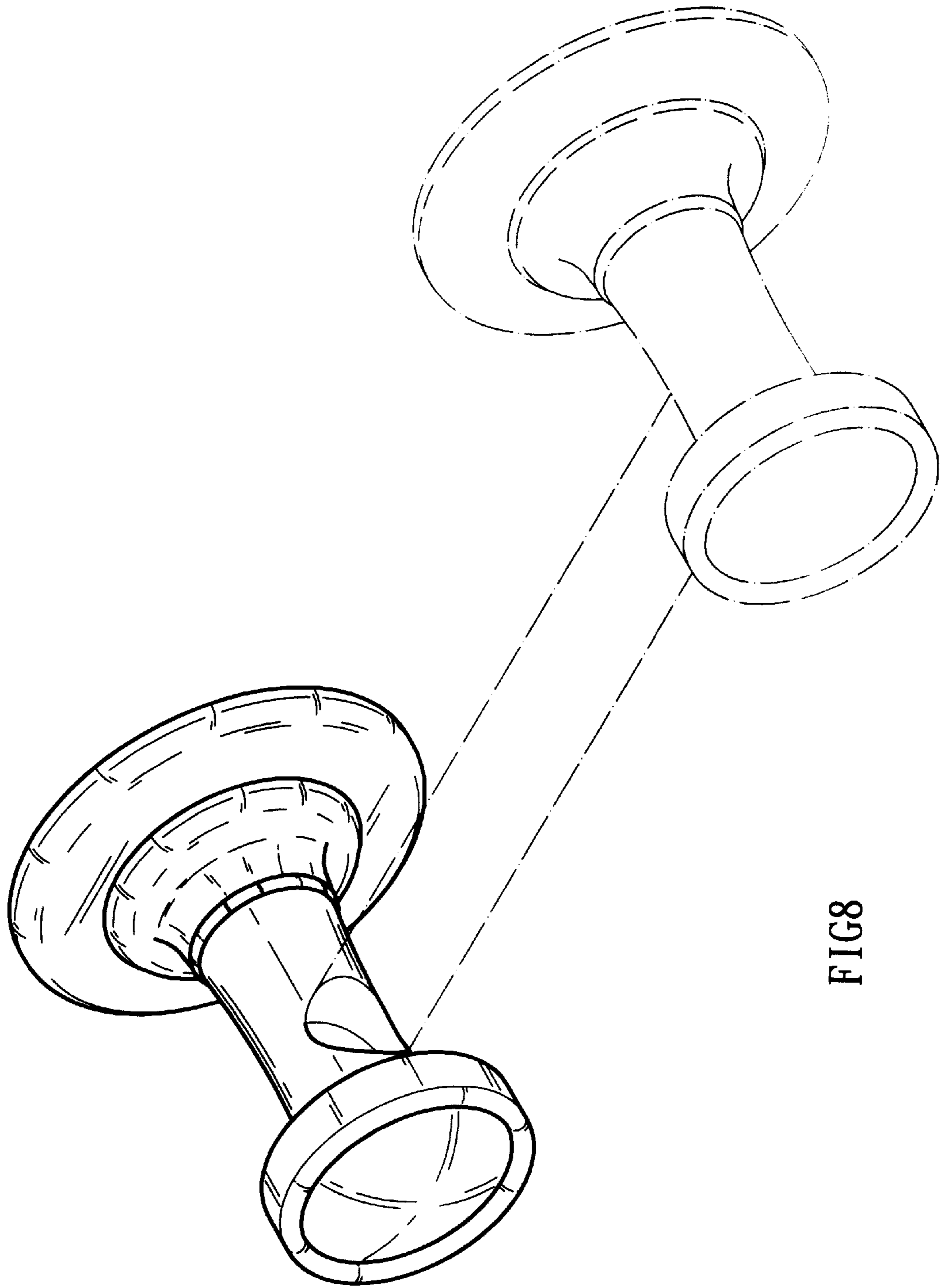

FIG 8