



US00D450966B1

(12) **United States Design Patent**
Gottwald

(10) **Patent No.:** **US D450,966 S**

(45) **Date of Patent:** **** Nov. 27, 2001**

(54) **SOAP-DISH HOLDER**

(75) Inventor: **Adolf Gottwald**, Iserlohn (DE)

(73) Assignee: **Friedrich Grohe AG & Co. KG**,
Hemer (DE)

(**) Term: **14 Years**

(21) Appl. No.: **29/142,602**

(22) Filed: **May 30, 2001**

(30) **Foreign Application Priority Data**

Dec. 1, 2000 (DE) 4 00 11 471

(51) **LOC (7) Cl.** **23-02**

(52) **U.S. Cl.** **D6/540**

(58) **Field of Search** D6/524, 529, 532,
D6/536, 540; D27/102, 104; 248/309.1;
206/77.1; 211/13.1, 86.01, 88.01, 126.1,
125.5, 134

(56) **References Cited**

U.S. PATENT DOCUMENTS

D. 416,153 * 11/1999 Chen D6/524

D. 416,730 * 11/1999 Chen D6/540

D. 440,801 * 4/2001 Gottwald D6/540

D. 441,236 * 5/2001 Gottwald D6/540

D. 441,237 * 5/2001 Gottwald D6/540

* cited by examiner

Primary Examiner—Brian N. Vinson

(74) *Attorney, Agent, or Firm*—Herbert Dubno

(57) **CLAIM**

The ornamental design for a soap-dish holder, as shown and described.

DESCRIPTION

FIG. 1 is a top, front, left-side perspective view of a soap-dish holder showing my new design;

FIG. 2 is a front elevational view thereof;

FIG. 3 is a rear elevational view thereof;

FIG. 4 is a top plan view thereof, the bottom plan view being identical thereto; and,

FIG. 5 is a right side elevational view thereof, the left side elevational view being mirror symmetrical thereto.

1 Claim, 2 Drawing Sheets

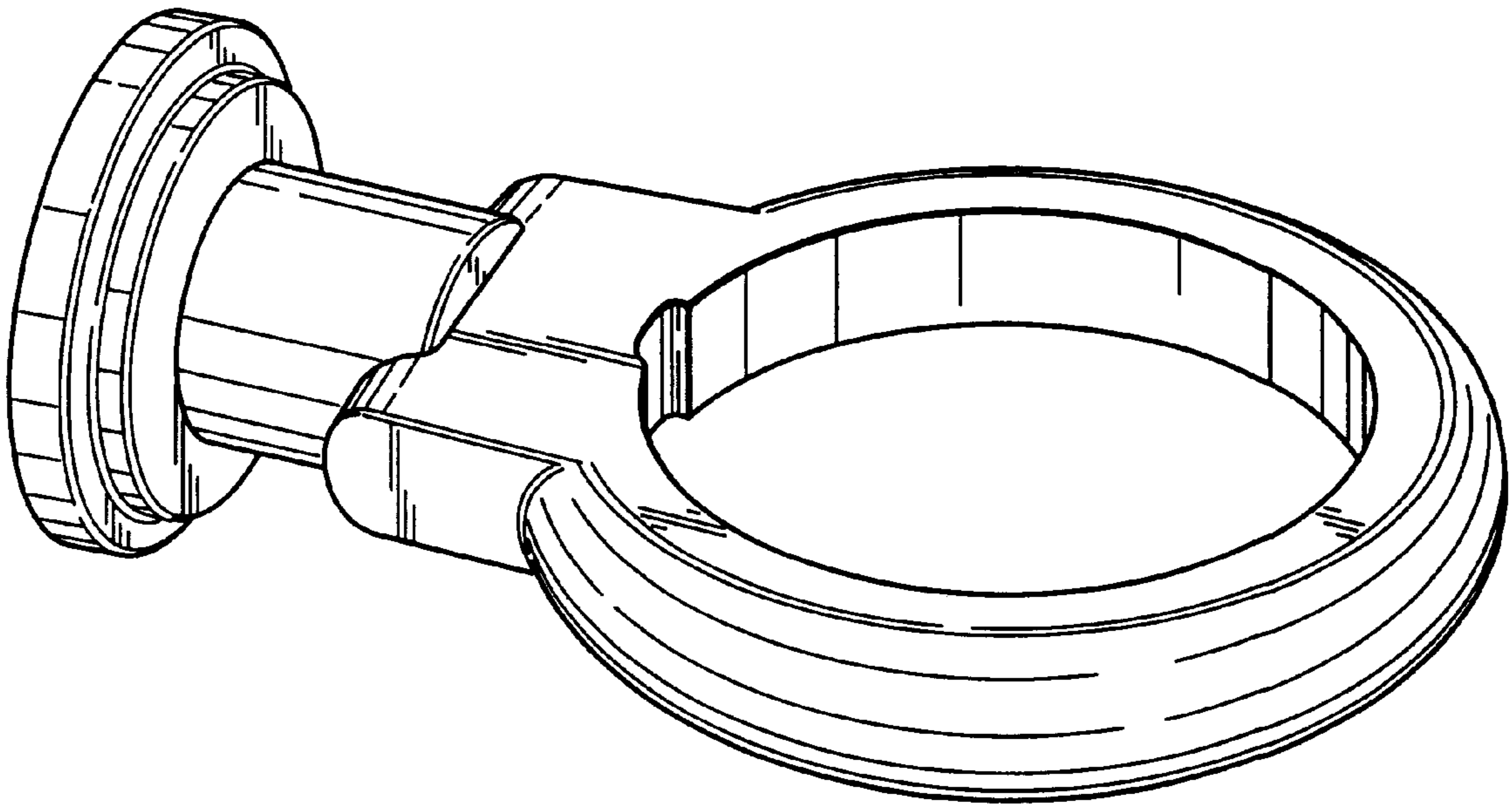

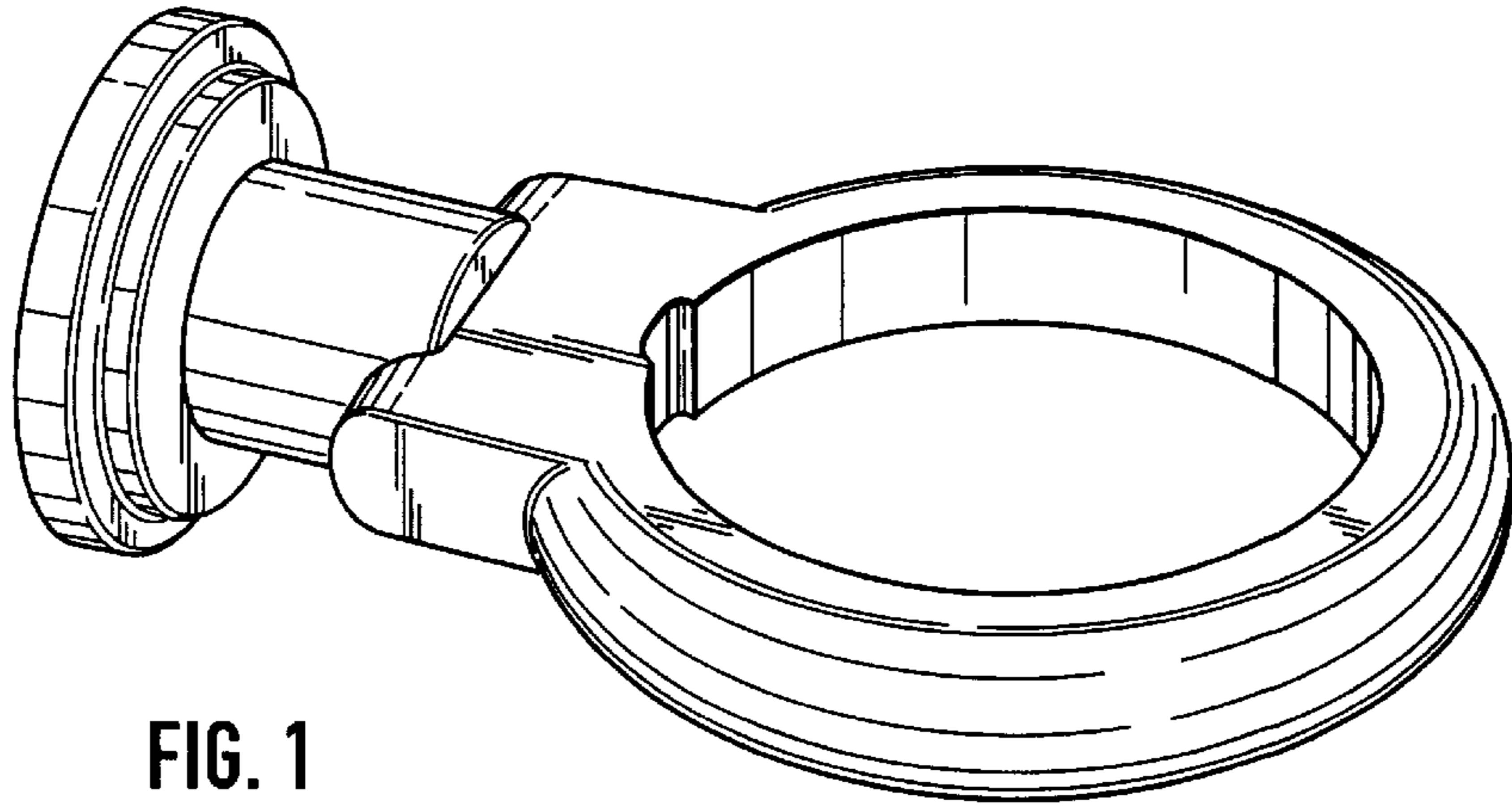

FIG. 1

FIG. 2

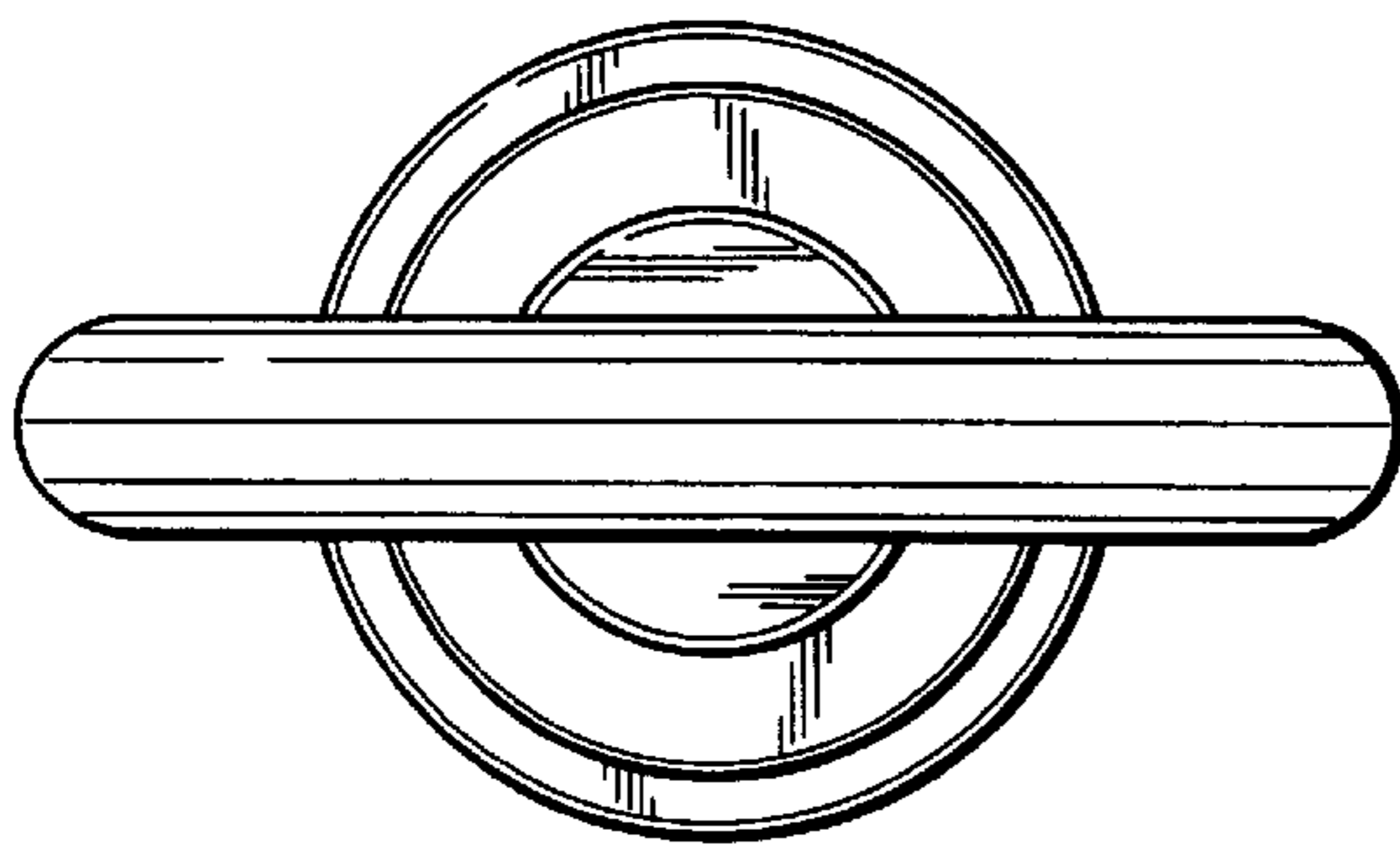

FIG. 3

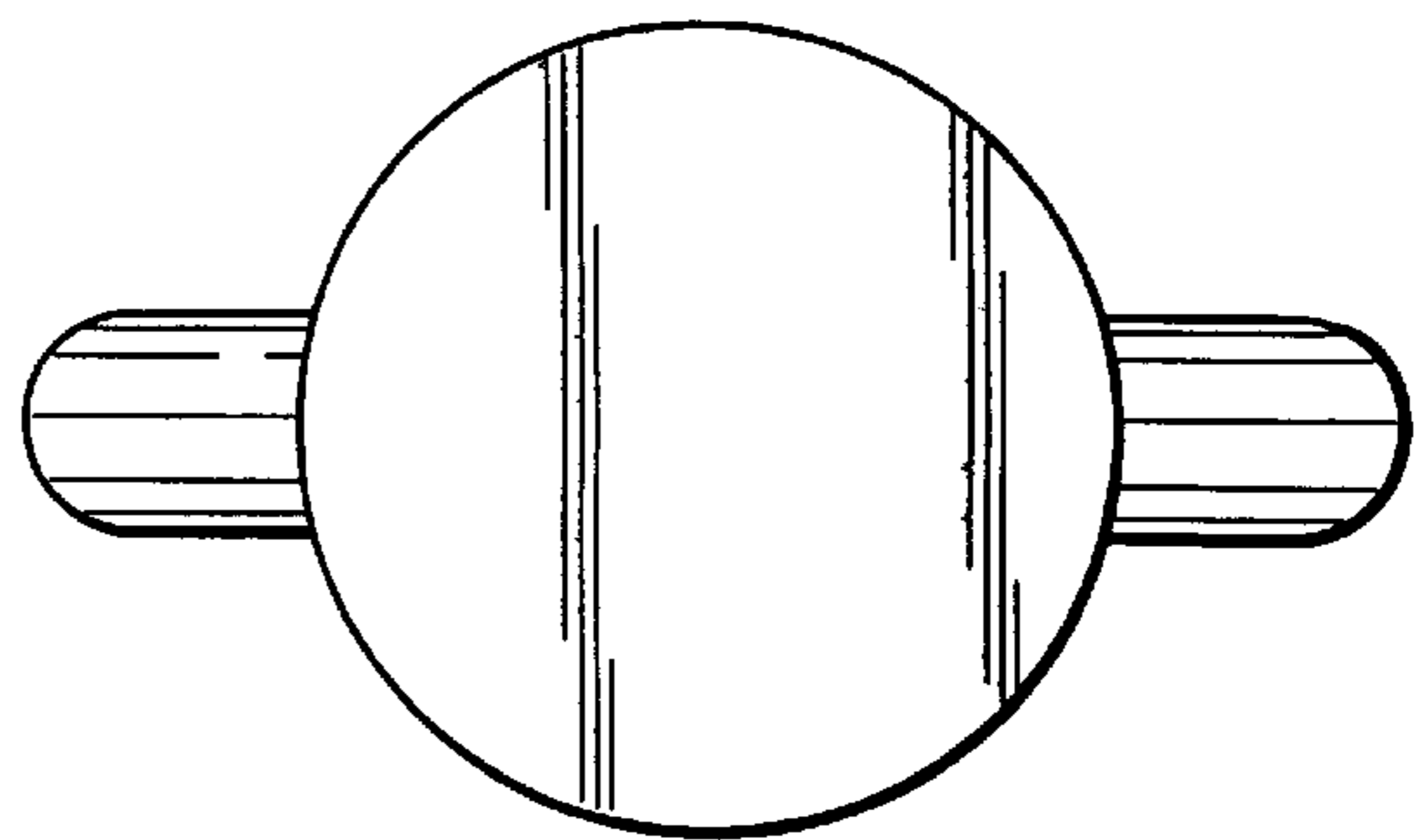

FIG. 4

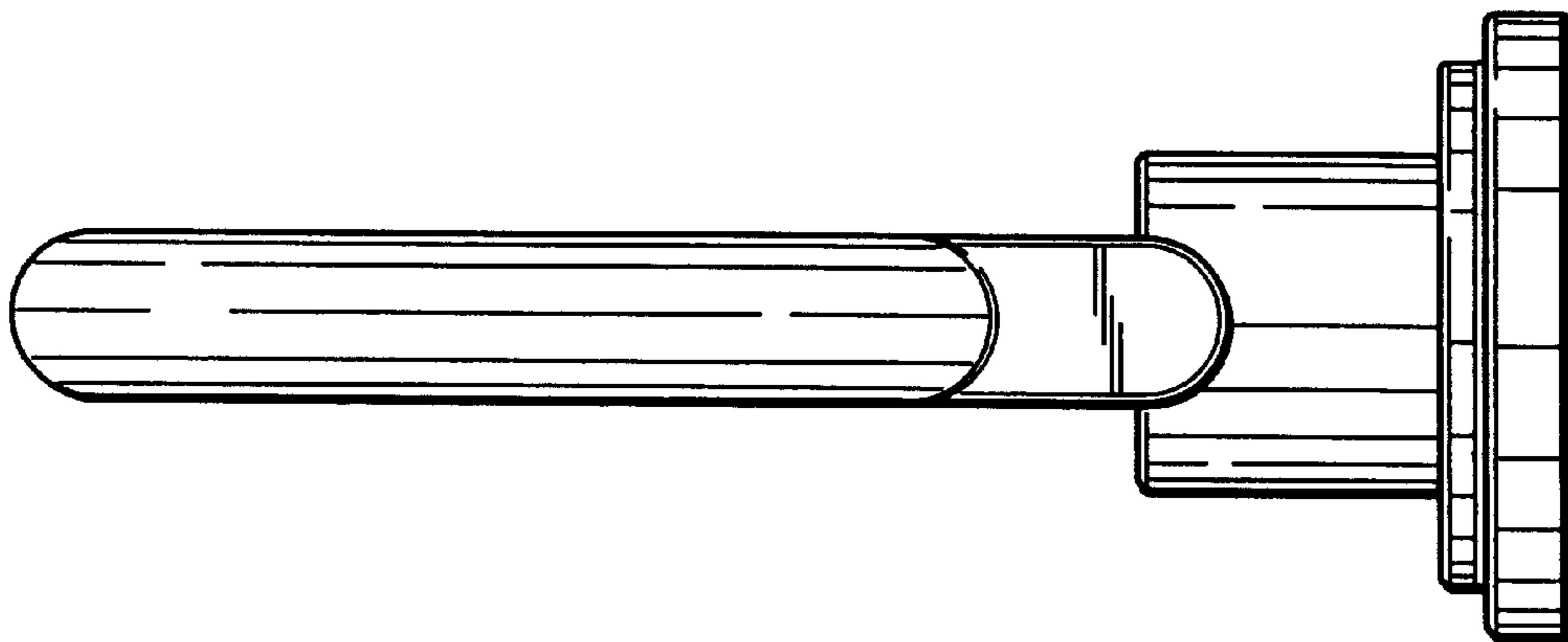
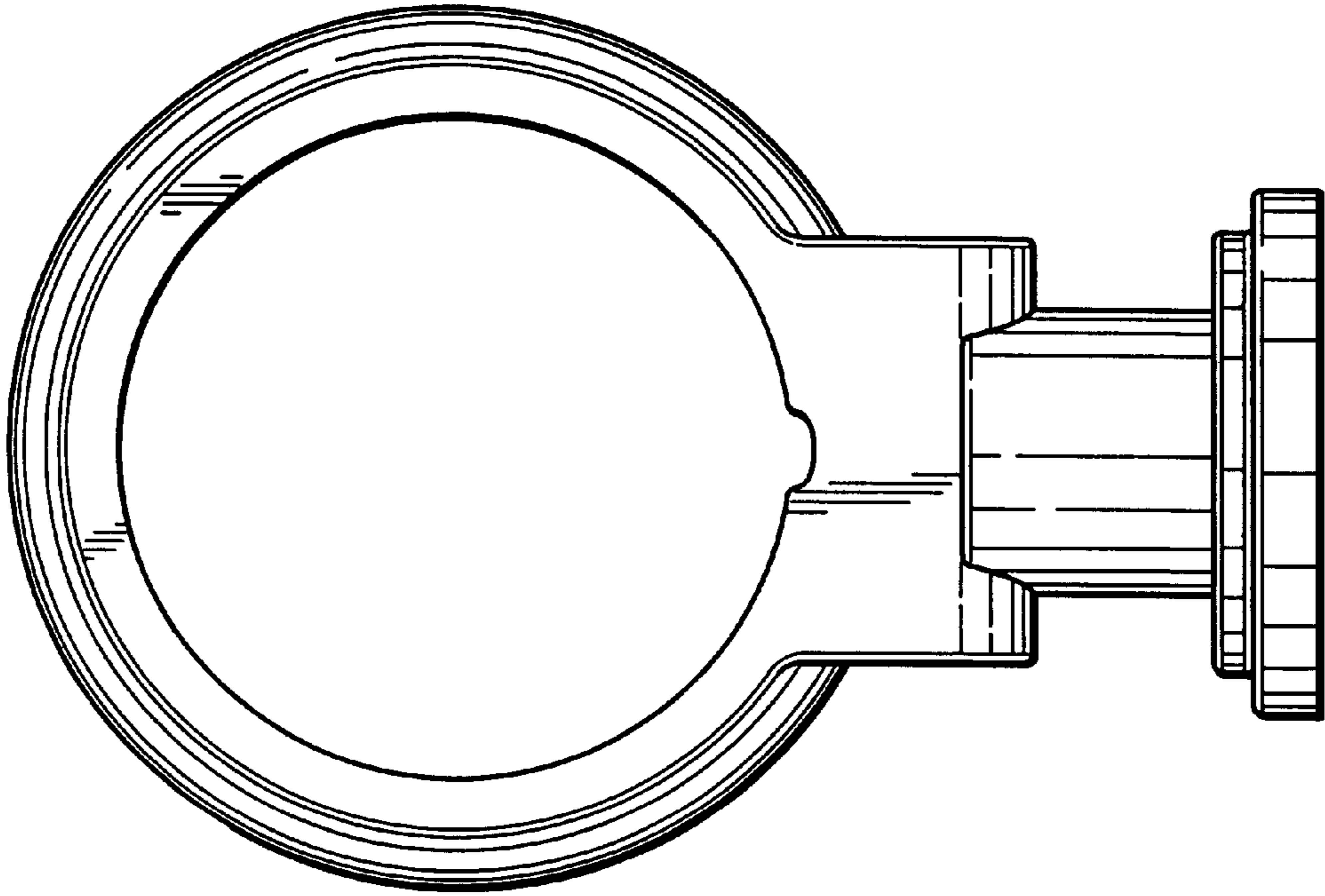

FIG. 5