



US00D446122S

(12) **United States Design Patent**  
**Weinstein et al.**

(10) **Patent No.:** **US D446,122 S**

(45) **Date of Patent:** **\*\* Aug. 7, 2001**

(54) **TUBULAR PACKAGING FOR DOOR  
HARDWARE**

(75) Inventors: **Michael Weinstein**, Santa Ana; **Eric E. Thompson**, Costa Mesa, both of CA (US)

(73) Assignee: **Emhart Inc.**, Newark, DE (US)

(\*\*) Term: **14 Years**

(21) Appl. No.: **29/119,032**

(22) Filed: **Feb. 22, 2000**

(51) **LOC (7) Cl.** ..... **09-03**

(52) **U.S. Cl.** ..... **D9/504; D9/428**

(58) **Field of Search** ..... D9/428, 422, 501, D9/414, 500, 337, 424, 504, 503; D3/273, 905; 206/525, 321, 775-783, 769, 770, 771, 756; 220/505, 662, 8; 229/162, 4.5, 5.5

(56) **References Cited**

**U.S. PATENT DOCUMENTS**

D. 244,259	*	5/1977	Bergstein	.....	D9/428
D. 289,143	*	4/1987	Guillaume	.....	D9/501
D. 299,114		12/1988	Klinge	.	
D. 315,095		3/1991	Wright	.	
D. 315,302	*	3/1991	Kistler	.....	D9/415
D. 320,469		10/1991	Hoening	.	
D. 328,248		7/1992	Ruff	.	
D. 350,460	*	9/1994	Picozza et al.	.....	D9/504
D. 362,801	*	10/1995	Milroy	.....	D9/428
D. 367,226		2/1996	Ransbottom	.	
D. 394,384		5/1998	Humphrey	.	
D. 400,787	*	11/1998	Keener	.....	D9/504
D. 405,370		2/1999	Humphrey	.	
D. 406,056		2/1999	Flores et al.	.	
D. 406,528		3/1999	Flores et al.	.	
D. 414,108		9/1999	Humphrey	.	

D. 424,427		5/2000	Saputo et al.	.	
D. 434,980	*	12/2000	Suzuki	.....	D9/428
3,406,816	*	10/1968	Green et al.	.....	206/756
4,099,612	*	7/1978	Hanson	.....	206/783
4,307,803	*	12/1981	Johnson	.....	206/461
4,359,182		11/1982	Perkins, Jr.	.	
4,993,623		2/1991	Kelly et al.	.	
5,064,056		11/1991	Gresh	.	
5,350,058	*	9/1994	Keough	.....	220/662
5,718,335		2/1998	Boudreaux	.	
5,816,411		10/1998	Smith	.	
5,890,593		4/1999	Humphrey	.	

\* cited by examiner

*Primary Examiner*—Prabhakar Deshmukh

(74) *Attorney, Agent, or Firm*—Harness, Dickey & Pierce, P.L.C.

(57) **CLAIM**

The ornamental design of a tubular packaging for door hardware, as shown and described.

**DESCRIPTION**

FIG. 1 is a perspective view of a tubular packaging in accordance with the present invention;

FIG. 2 is an exploded perspective view illustrating the components of the tubular packaging of the present invention shown in FIG. 1;

FIG. 3 is a front elevational view of the present invention shown in FIG. 1, it being understood that the rear elevational view, left side elevational view and right side elevational view are identical thereto; and,

FIG. 4 is a top plan view of the present invention shown in FIG. 1, it being understood that the bottom plan view is identical thereto.

Various components of the door hardware is shown in phantom but does not form any part of the ornamental design.

**1 Claim, 3 Drawing Sheets**

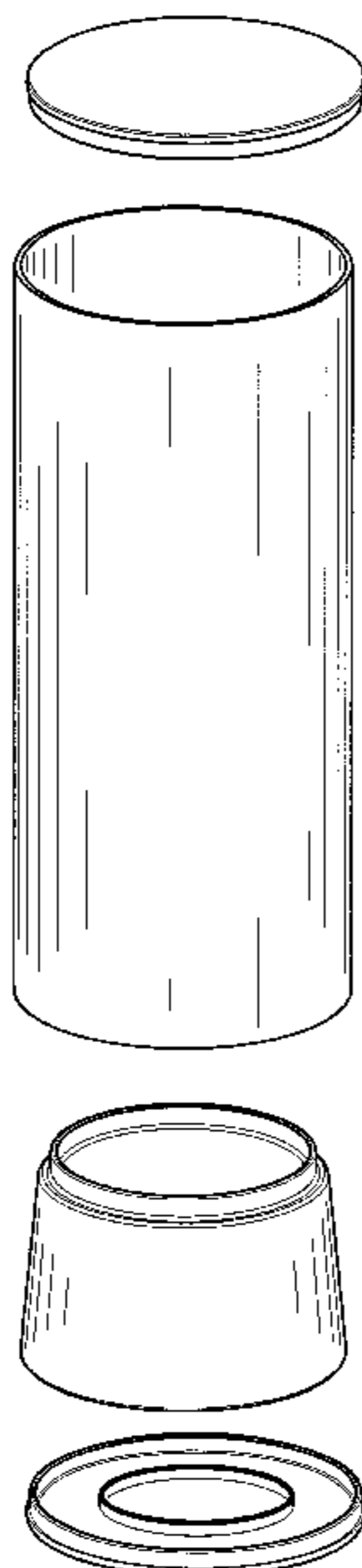

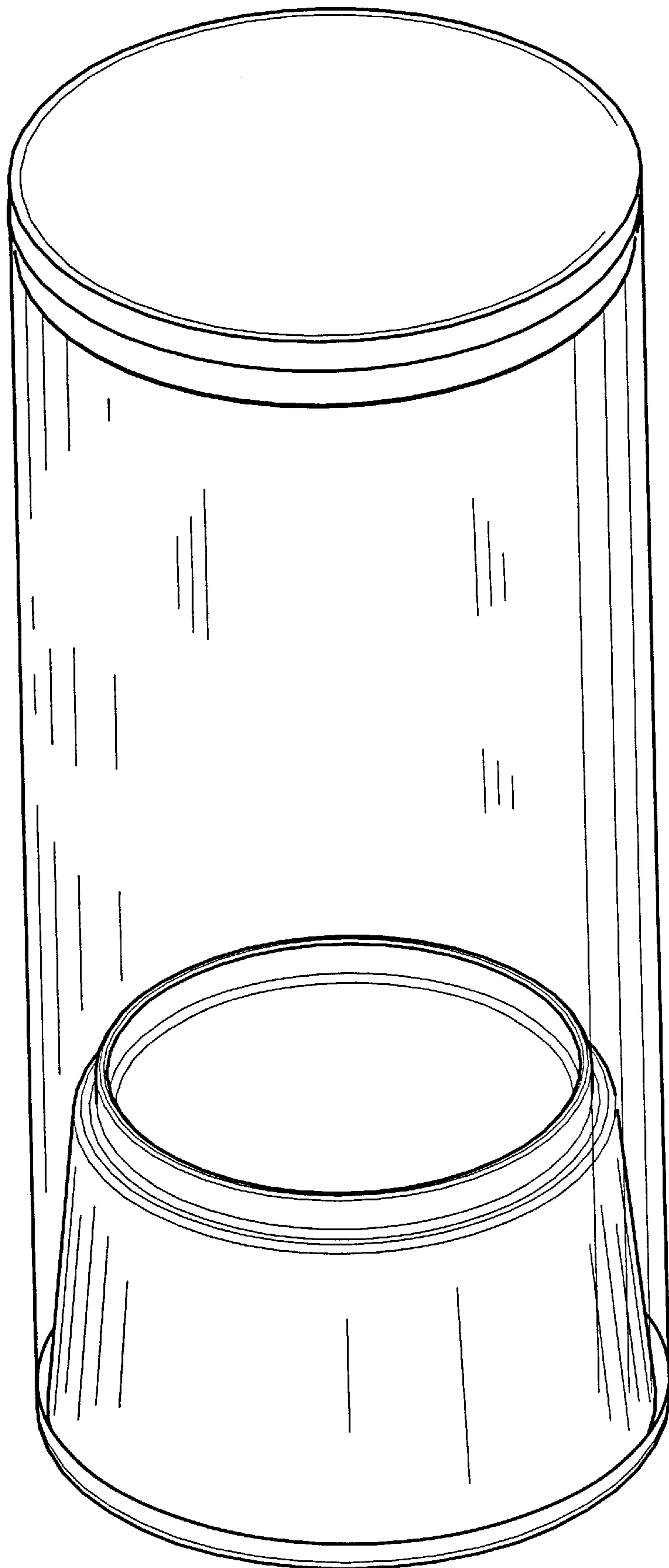

Figure - 1

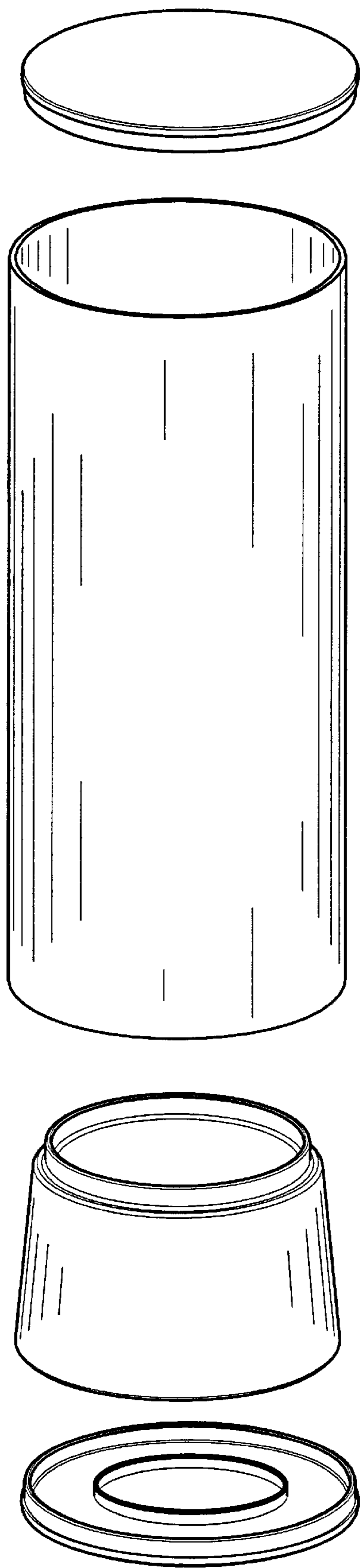

Figure - 2

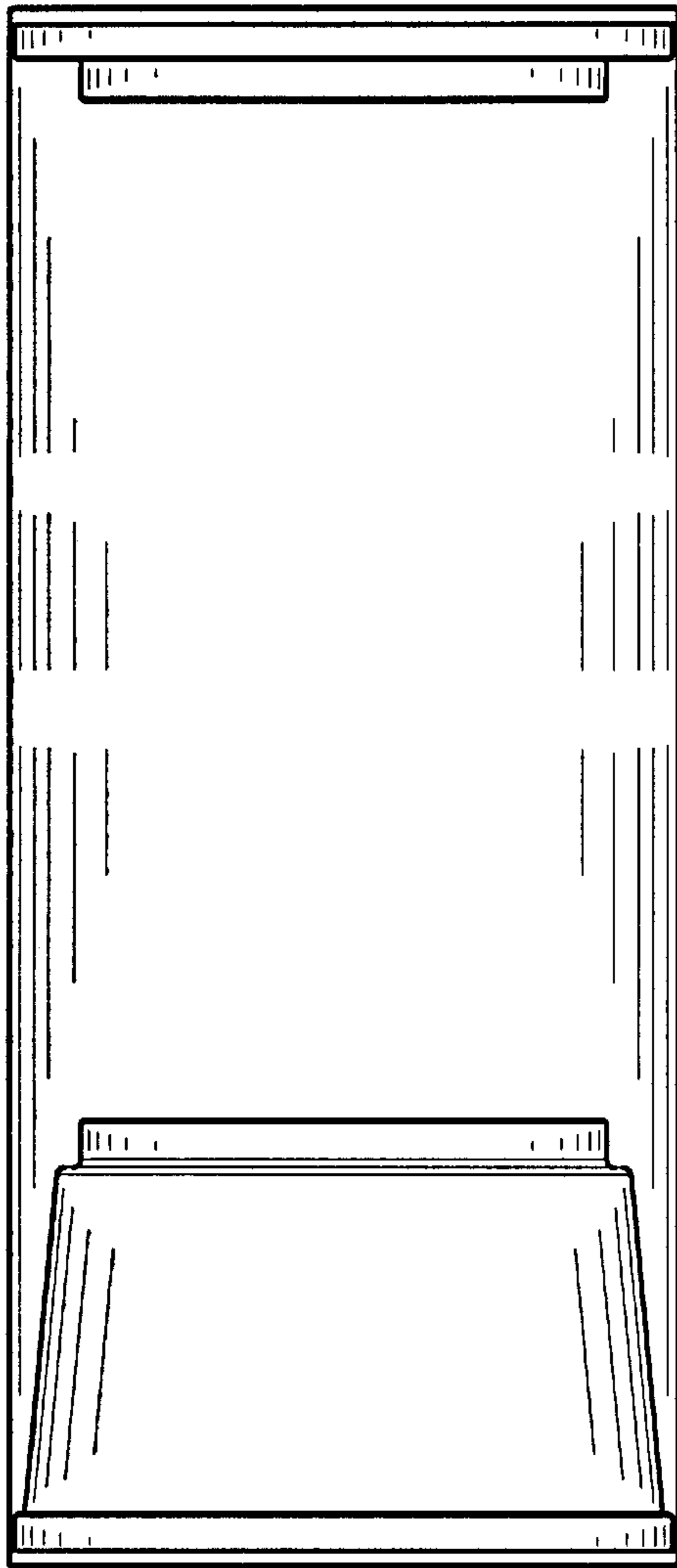

Figure - 3

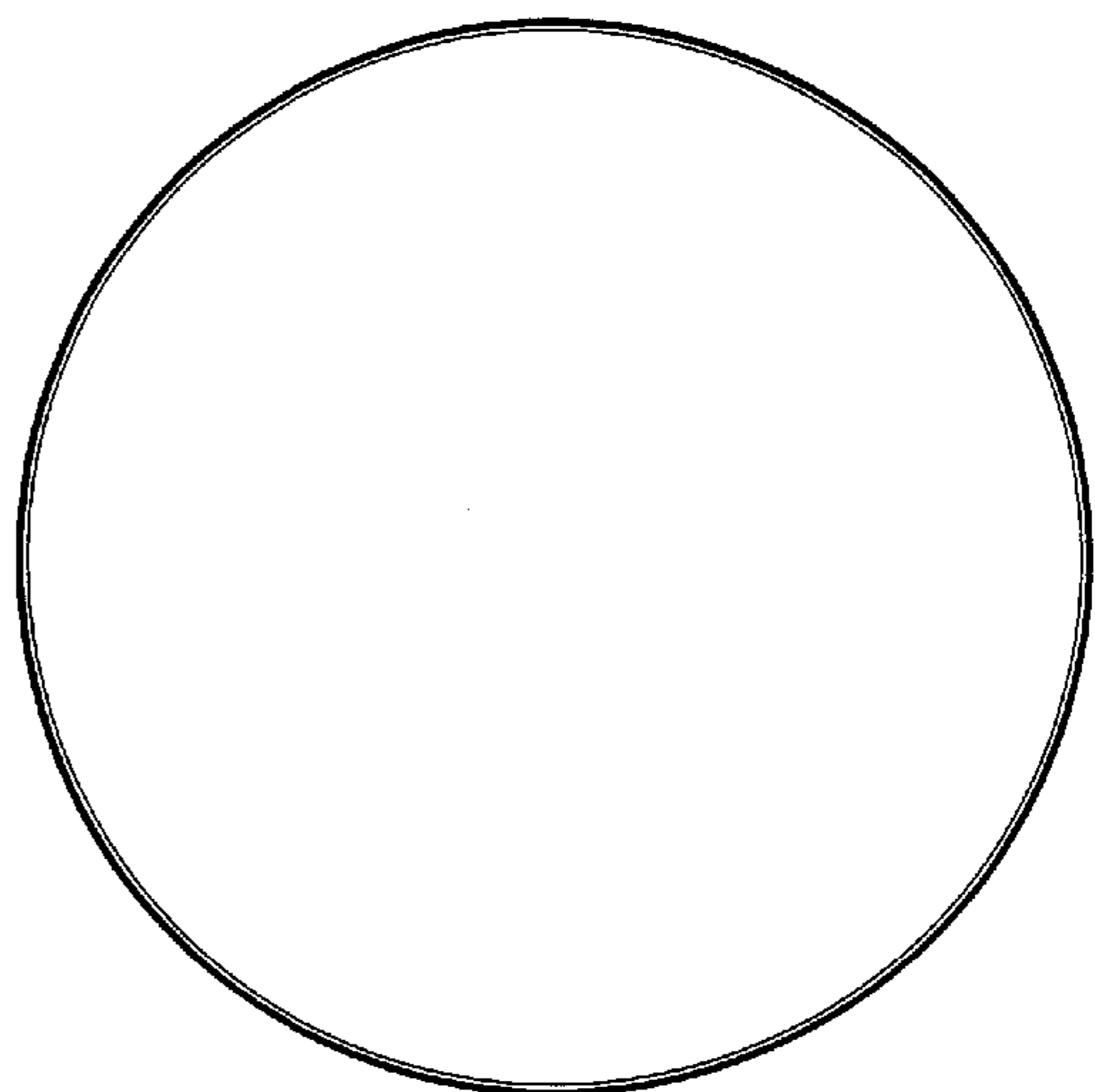

Figure - 4