



US00D445805S

(12) **United States Design Patent**  
**Bruns**

(10) **Patent No.:** **US D445,805 S**

(45) **Date of Patent:** **\*\* Jul. 31, 2001**

(54) **COMBINE PLATFORM AUGER FINGER GUIDE**

(76) **Inventor:** **Mark W. Bruns**, Box 33, Gibbon, MN (US) 55335

(\*\*) **Term:** **14 Years**

(21) **Appl. No.:** **29/021,723**

(22) **Filed:** **Apr. 22, 1994**

(51) **LOC (7) Cl.** ..... **15-03**

(52) **U.S. Cl.** ..... **D15/28**

(58) **Field of Search** ..... D8/350, 397; D15/10, D15/11, 12, 27-29, 32; 56/10.26, 14.6; 37/420; 198/613, 693

(56) **References Cited**

**U.S. PATENT DOCUMENTS**

D. 243,207	*	1/1977	Van der Lely	.....	D15/29
D. 248,557	*	7/1978	Gobin et al.	.....	D15/17
D. 284,165	*	6/1986	Brilando et al.	.....	D8/350
D. 300,223	*	3/1989	Livingstone	.....	D15/29
D. 302,162	*	7/1989	Rutherford	.....	D15/28
2,286,095		6/1942	Innes	.....	56/364
2,633,231		3/1953	Pilcher	.	
2,644,292		7/1953	Oberholtz et al.	.....	56/400
2,701,634		2/1955	Carroll	.....	198/211
2,748,921		6/1956	White	.....	198/211
2,849,103		8/1958	Scheffter et al.	.....	198/104
3,142,375		7/1964	Luke	.....	198/211

3,215,259	*	11/1965	Evans	.....	198/613
3,282,408	*	11/1966	Lohrentz	.....	198/613
3,411,615		11/1968	Schwalm	.....	198/211
4,271,956		6/1981	Hutchinson et al.	.....	198/613
4,539,801	*	9/1985	Field	.....	198/613
5,293,730	*	3/1994	Bich et al.	.....	56/10.26

**OTHER PUBLICATIONS**

Modern Machine—The Fasteners Book, Sep. 29, 1960 p. 124. Hi-Stress locknut, top.\*

Elastic Stop Nut Division, General Product Bulletin No. 6820, p. 3. Stop Nut, NA1, top and Stop Nut ZA1 bottom.\*

\* cited by examiner

*Primary Examiner*—Sandra L. Morris

(57) **CLAIM**

The ornamental design for the combine platform auger finger guide, as shown and described.

**DESCRIPTION**

FIG. 1 is a perspective view of the combine platform auger finger guide showing my new design;

FIG. 2 is a top plan view thereof;

FIG. 3 is a front side elevational view thereof;

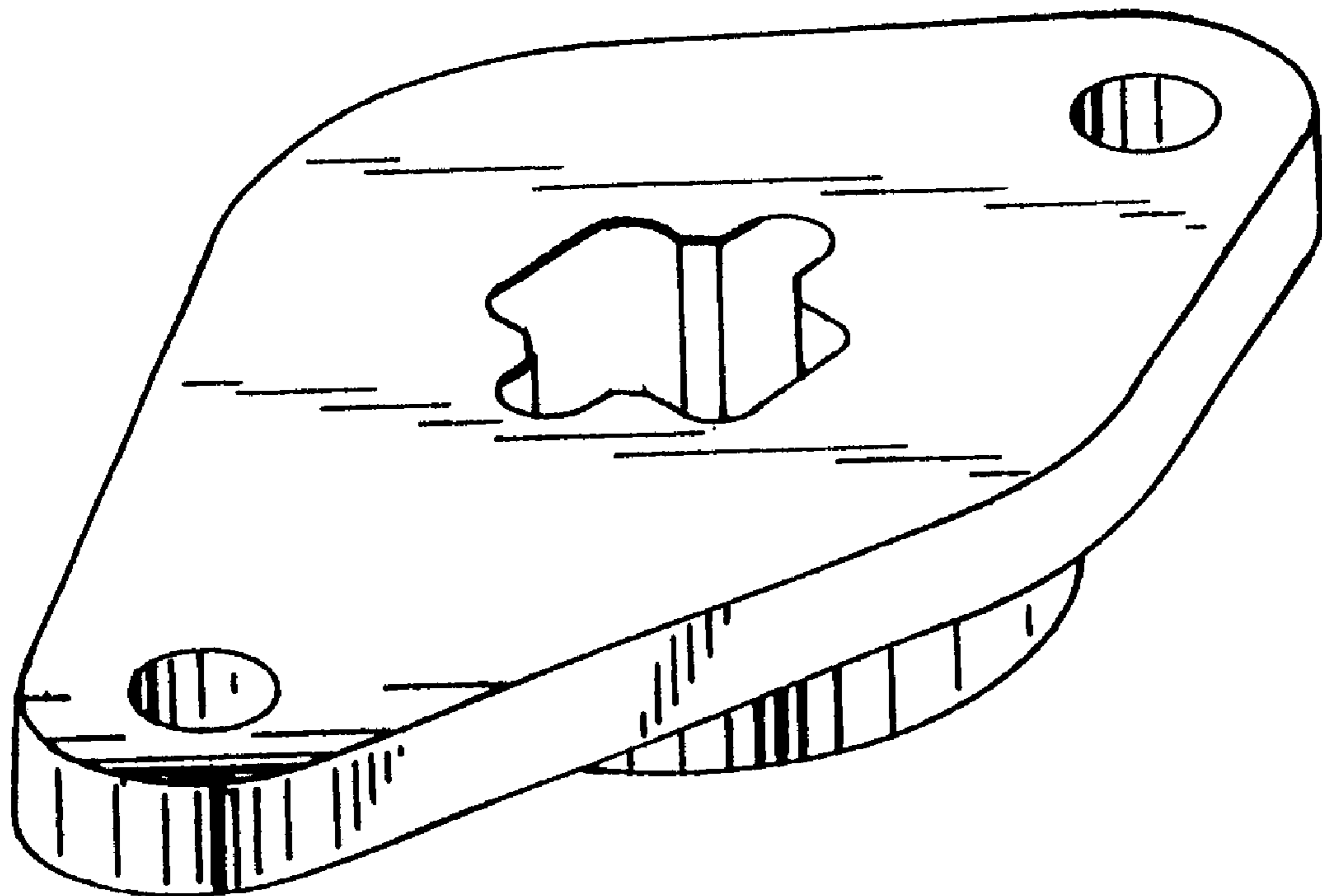
FIG. 4 is a left side elevational view thereof;

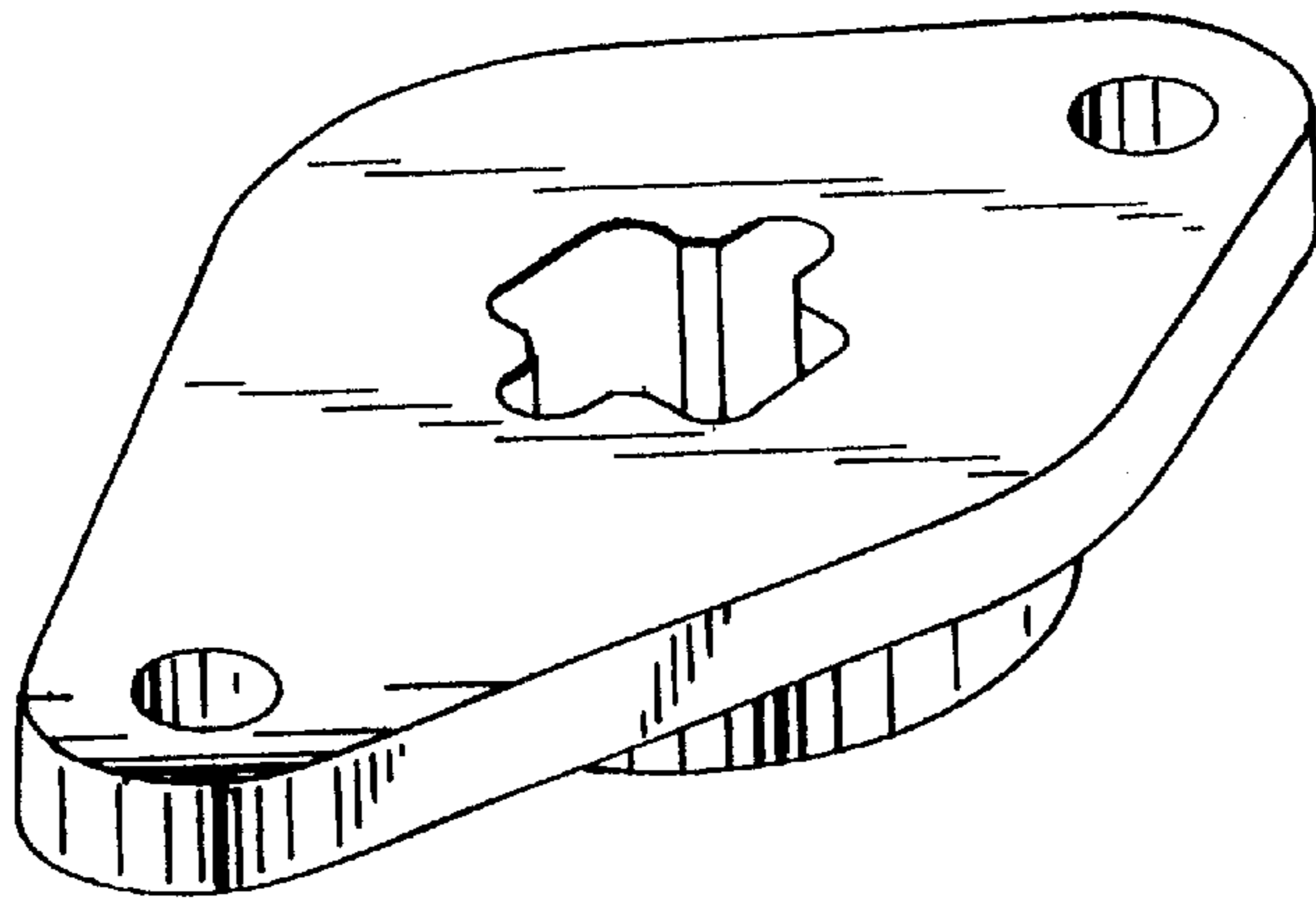
FIG. 5 is a right side elevational view thereof;

FIG. 6 is a rear elevational view thereof; and,

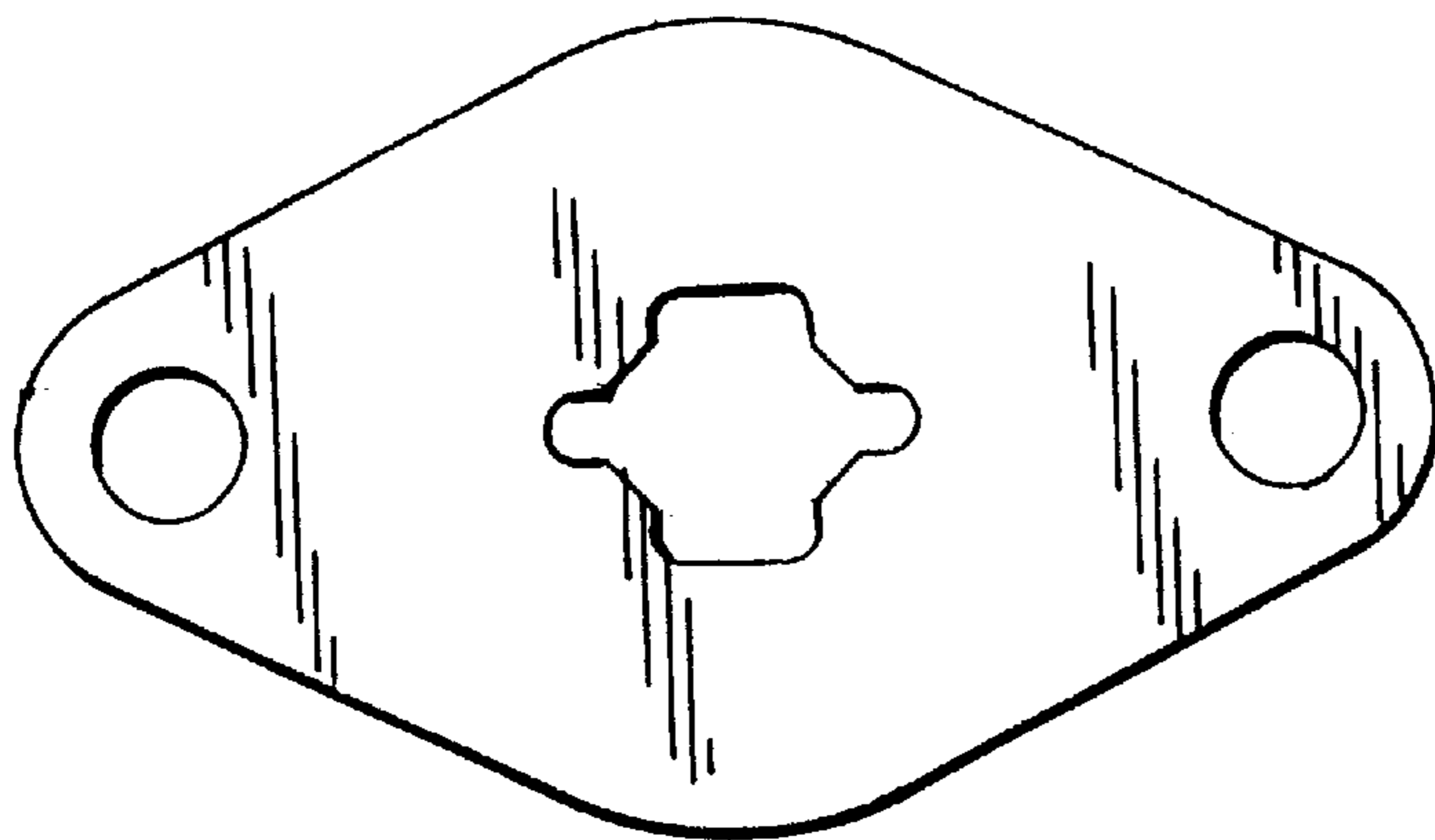
FIG. 7 is a bottom plan view thereof.

**1 Claim, 2 Drawing Sheets**

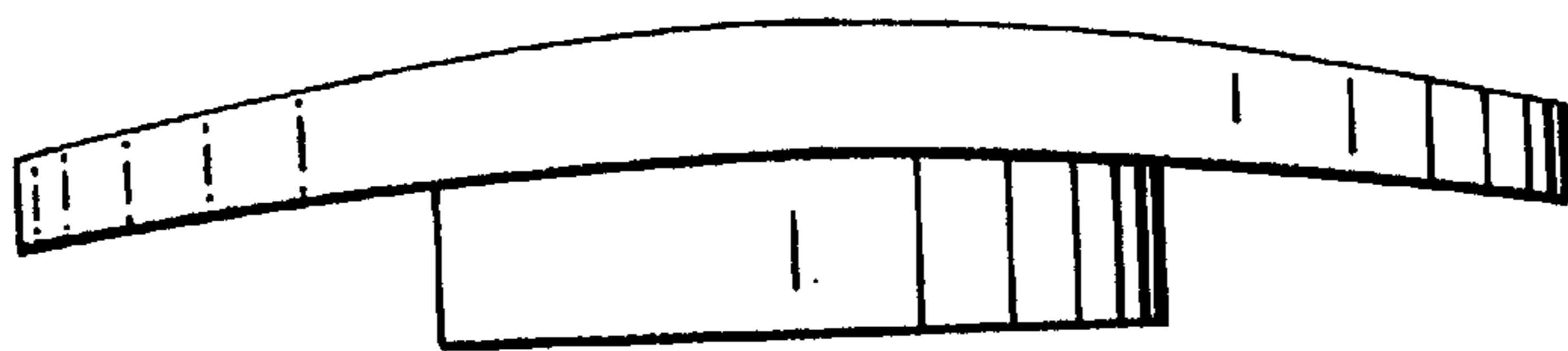




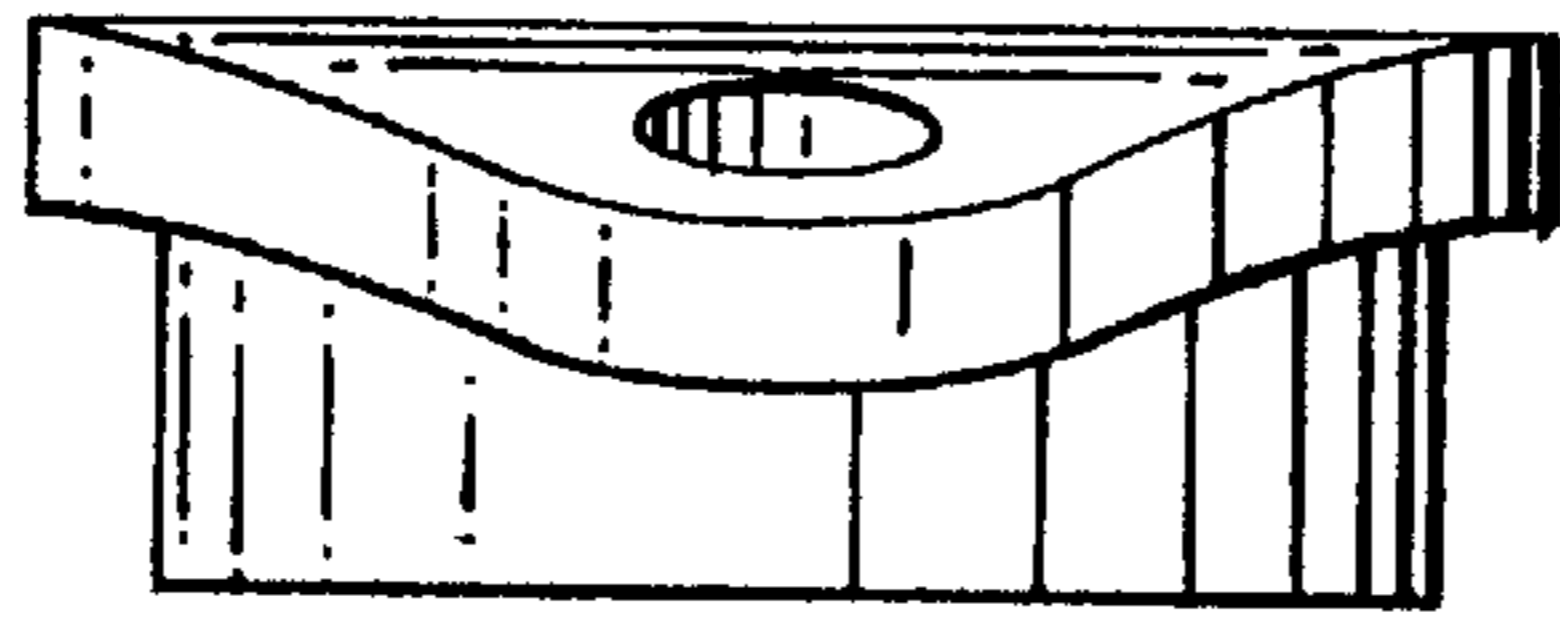
*Fig. 1*



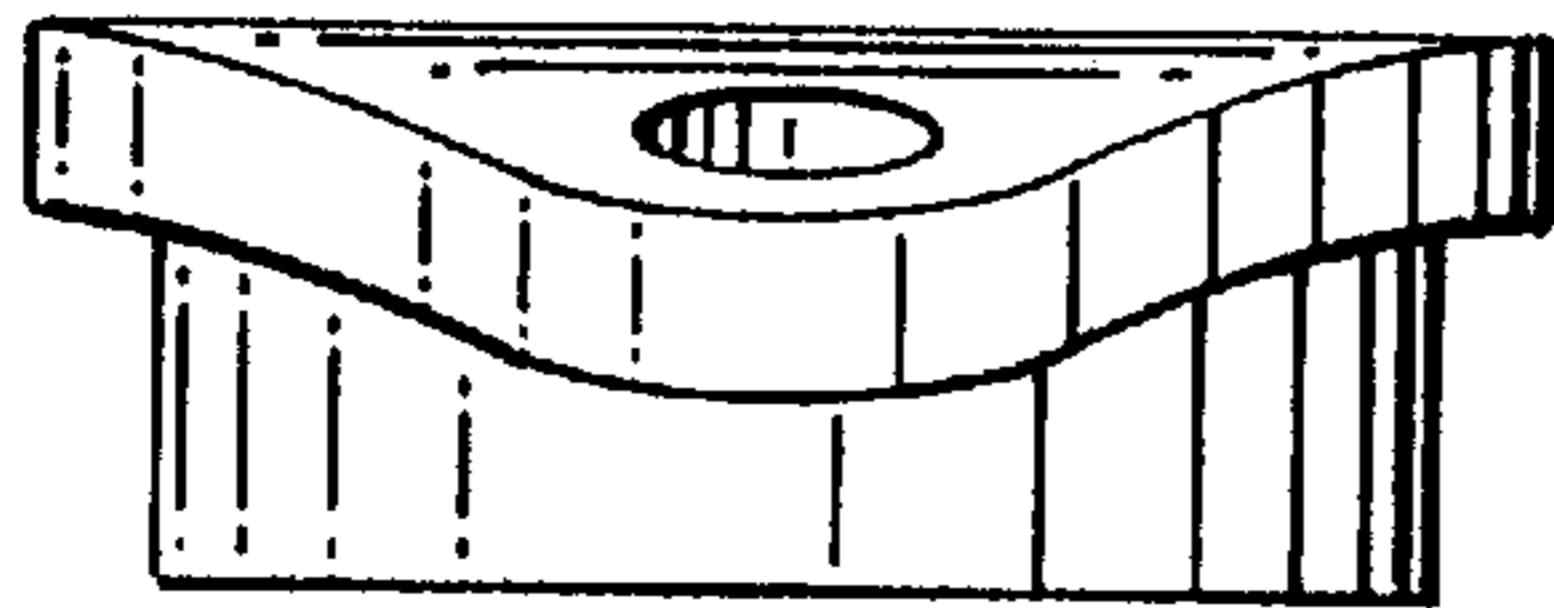
*Fig. 2*



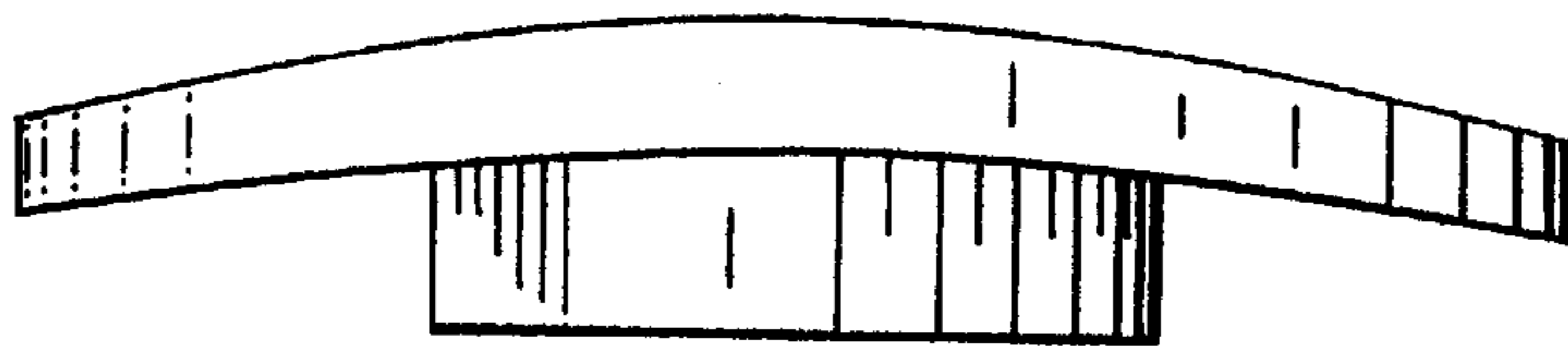
*Fig. 3*



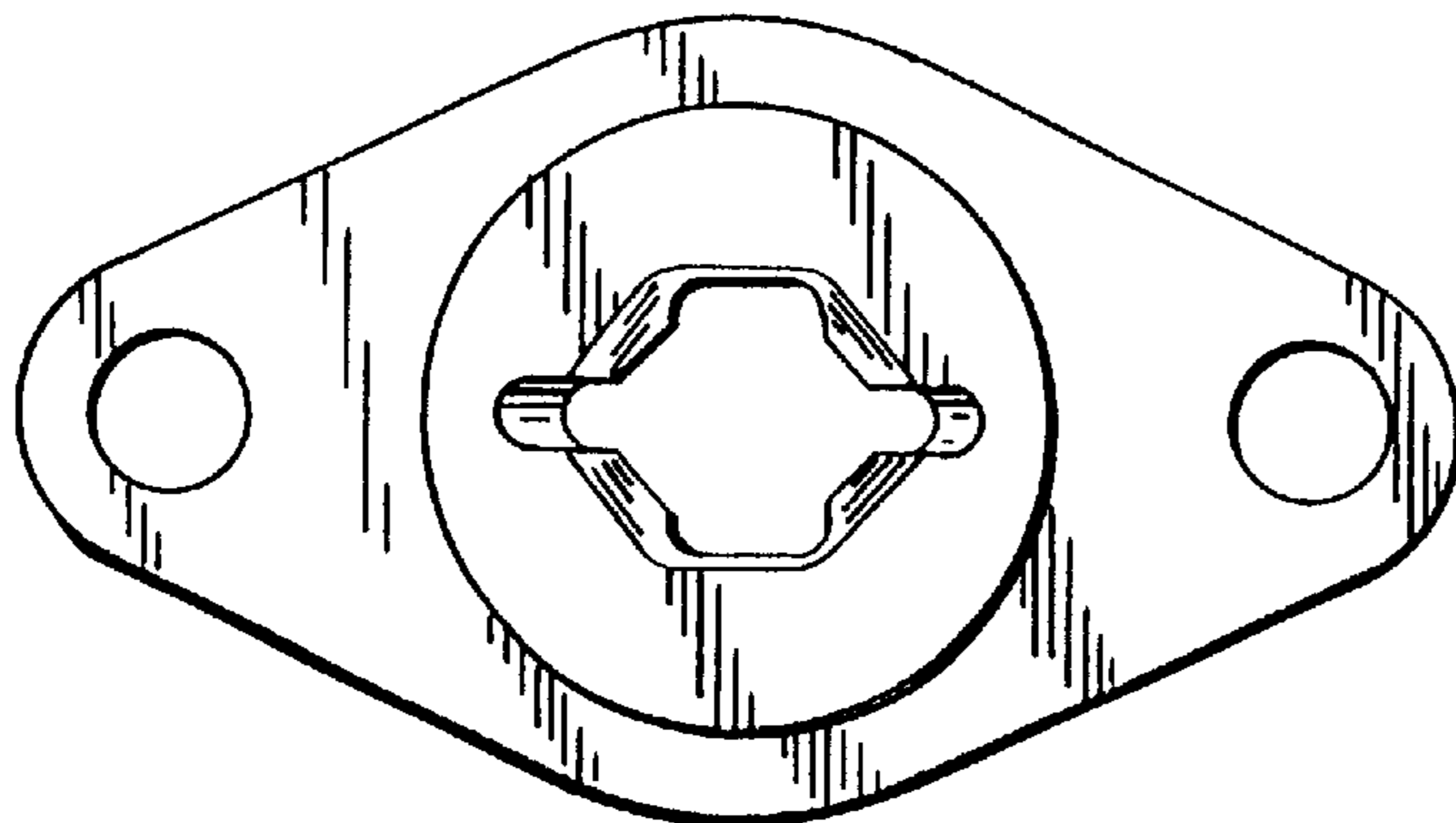
*Fig. 4*



*Fig. 5*



*Fig. 6*



*Fig. 7*