



US00D444488S

(12) **United States Design Patent**
Selic et al.

(10) **Patent No.:** **US D444,488 S**

(45) **Date of Patent:** **** Jul. 3, 2001**

(54) **ROBOT ARM**

(75) Inventors: **Mario Selic; Andre Reekers; Annett Steinacker**, all of Augsburg (DE)

(73) Assignee: **KUKA Roboter GmbH**, Augsburg (DE)

(**) Term: **14 Years**

(21) Appl. No.: **29/128,911**

(22) Filed: **Sep. 6, 2000**

(30) **Foreign Application Priority Data**

Mar. 15, 2000 (DE) 400 02 626

(51) **LOC (7) Cl.** **15-09**

(52) **U.S. Cl.** **D15/199**

(58) **Field of Search** D15/199; 33/503;
219/639, 124.34; 74/409.02, 490.01, 490.02,
490.03, 490.05; 318/560; 700/99; 702/150;
73/7; 364/191

(56) **References Cited**

U.S. PATENT DOCUMENTS

D. 410,477	*	6/1999	Nihei et al.	D15/199
D. 423,534	*	4/2000	Raab et al.	D15/199
5,328,095	*	7/1994	Wickenhaver	239/113
5,495,410	*	2/1996	Graf	364/191
5,564,312	*	10/1996	Brunman et al.	74/490.02
5,880,956	*	3/1999	Graf	364/191
5,901,613	*	5/1999	Forslund	74/490.03

5,906,761	*	5/1999	Gilliland et al.	219/124.34
6,014,909	*	1/2000	Flora	74/490.02
6,131,436	*	10/2000	O'Bannon et al.	73/7
6,145,403	*	11/2000	Aschenbrenner et al.	74/490.01
6,160,247	*	12/2000	Storm et al.	219/639
6,166,504	*	12/2000	Iida et al.	318/560
6,185,469	*	2/2001	Lewis et al.	700/99

* cited by examiner

Primary Examiner—Antoine Duval Davis

(74) *Attorney, Agent, or Firm*—Paul Vincent

(57) **CLAIM**

The ornamental design for a robot arm, as shown.

DESCRIPTION

FIG. 1 shows a front perspective view of the robot arm in accordance with the invention;
 FIG. 2 shows a back perspective view of the robot arm in accordance with the invention;
 FIG. 3 shows a back side view of the robot arm in accordance with the invention;
 FIG. 4 shows a front side view of the robot arm in accordance with the invention;
 FIG. 5 shows a back end view of the robot arm in accordance with the invention;
 FIG. 6 shows a front end view of the robot arm in accordance with the invention; and,
 FIG. 7 shows a top view of the robot arm in accordance with the invention.

1 Claim, 7 Drawing Sheets

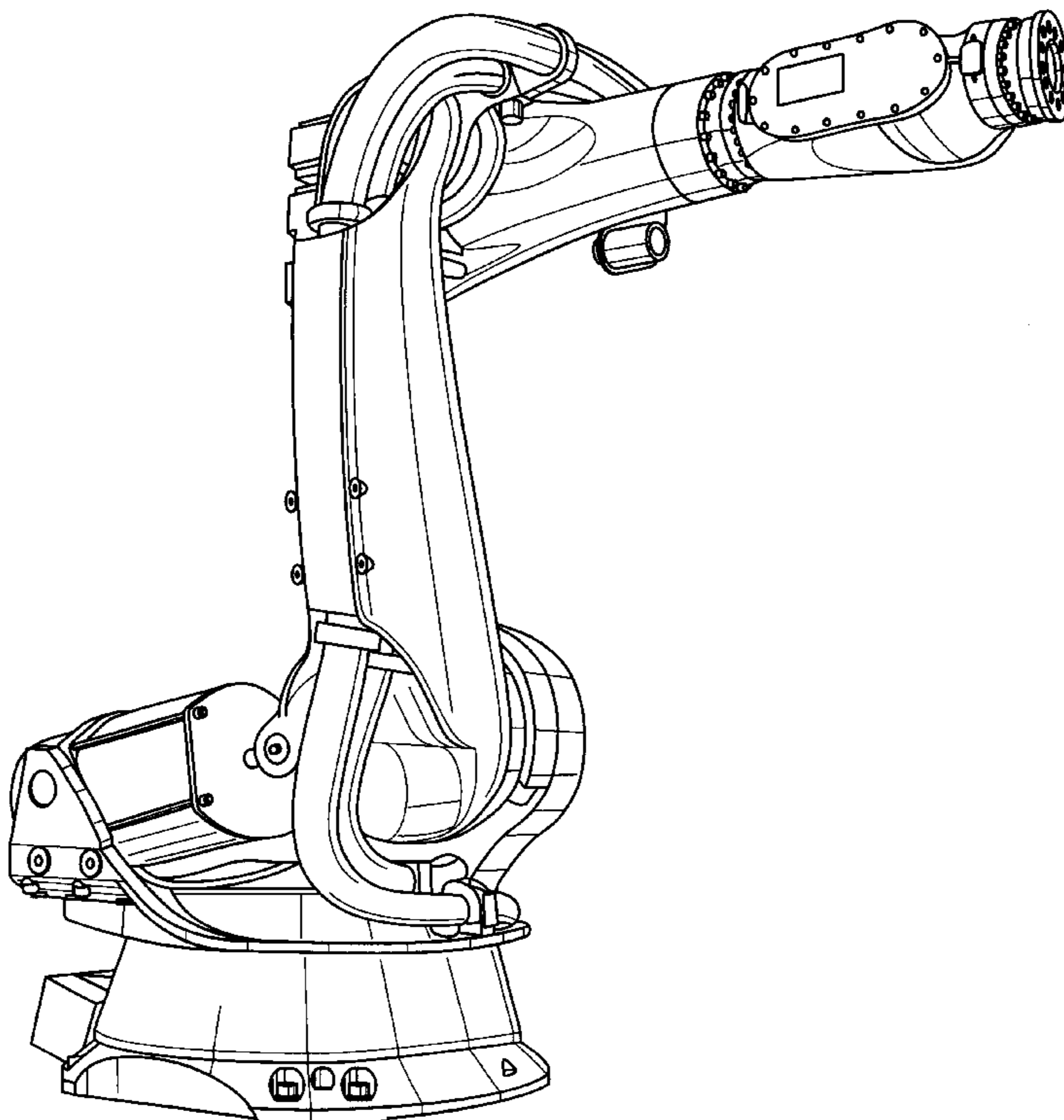

Fig. 1

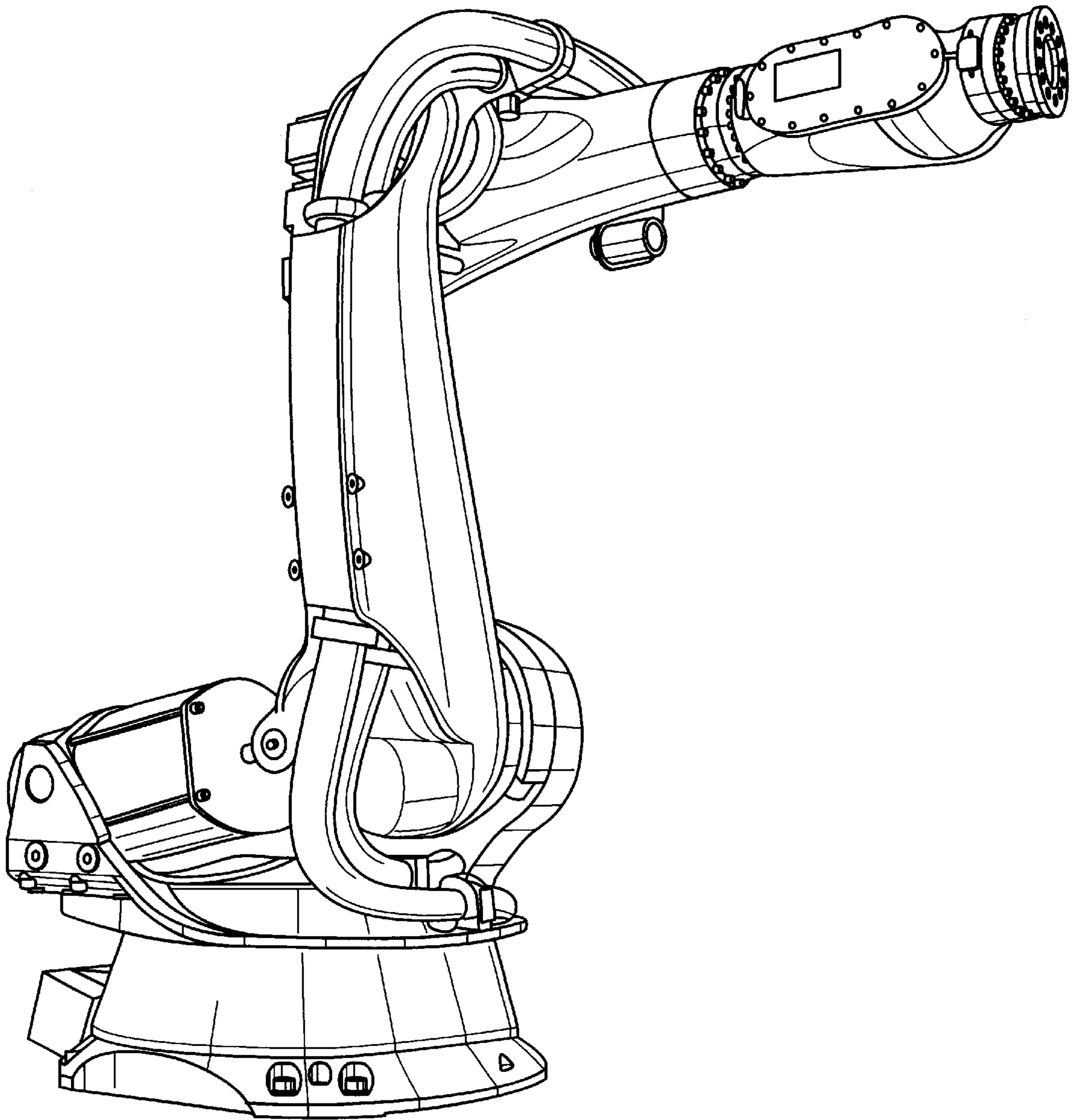
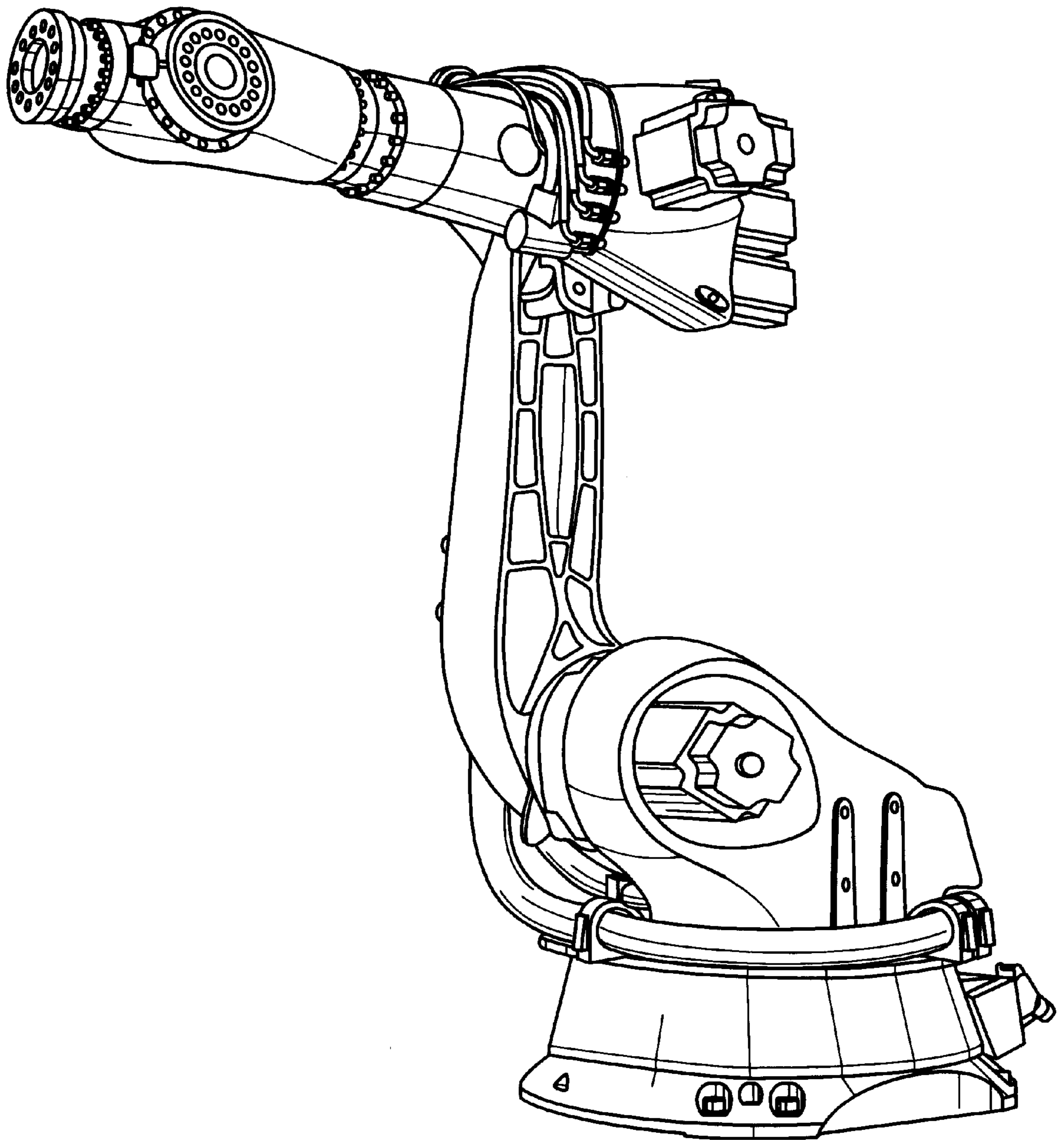

Fig. 2



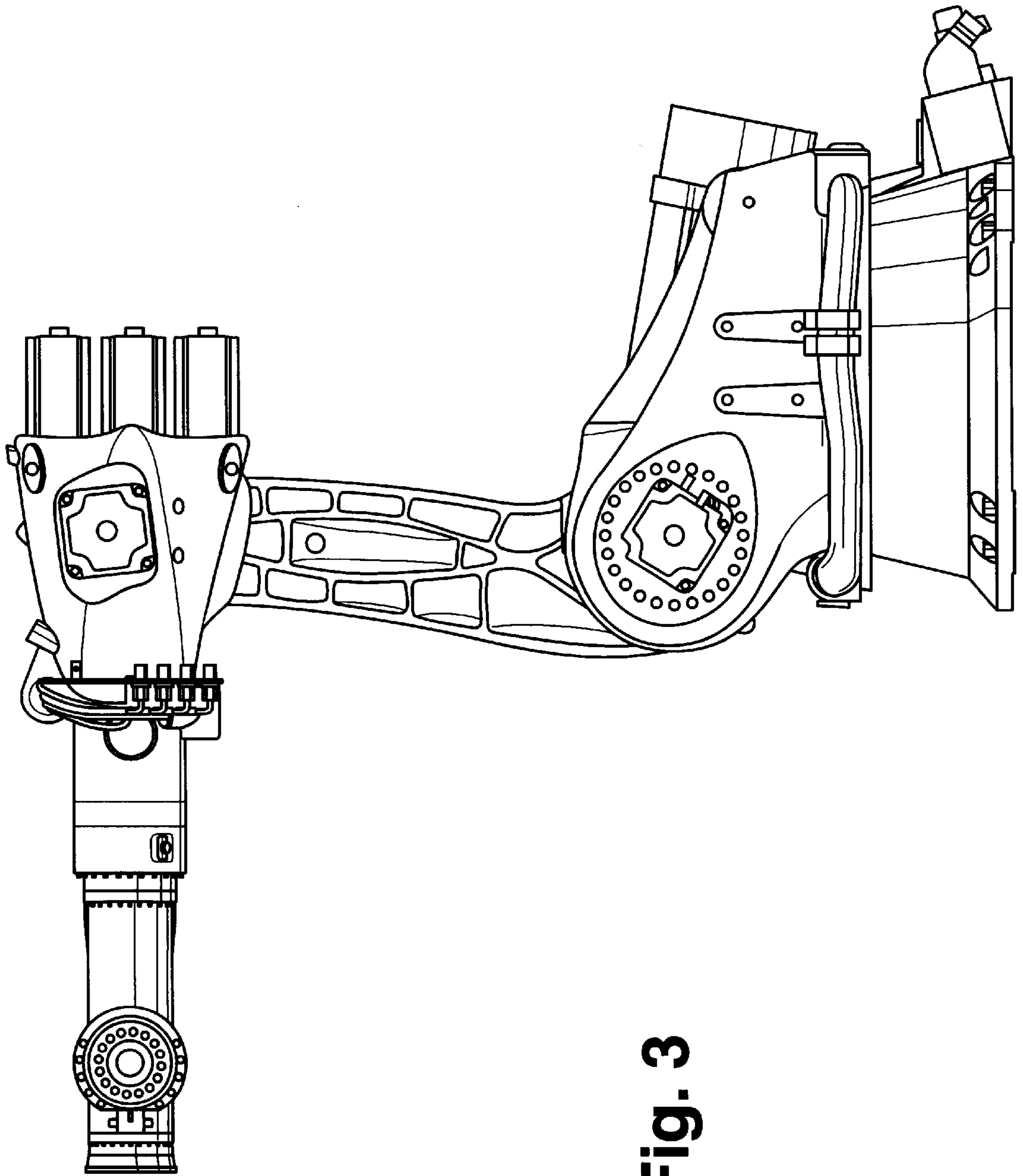

Fig. 3

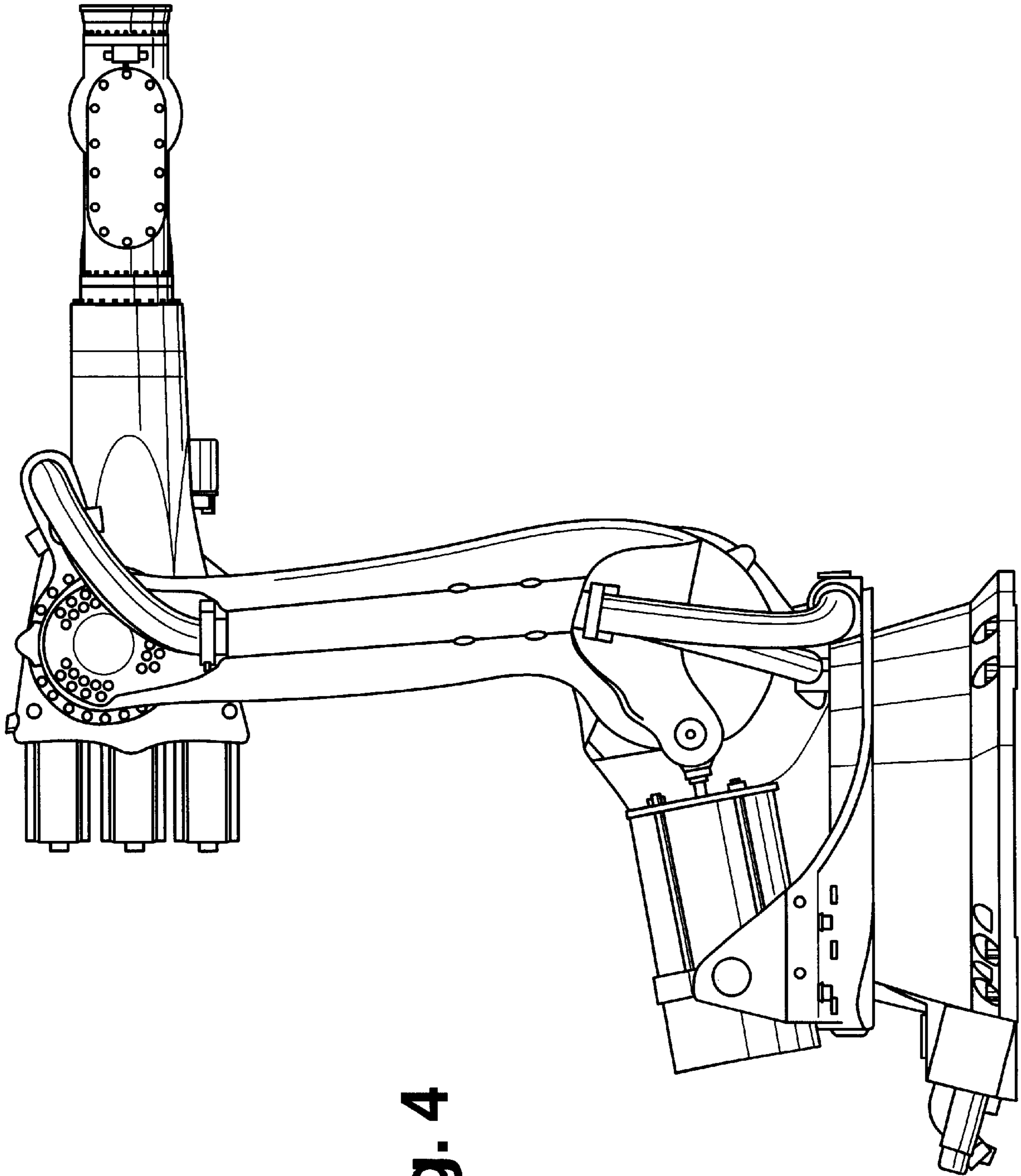

Fig. 4

Fig. 5

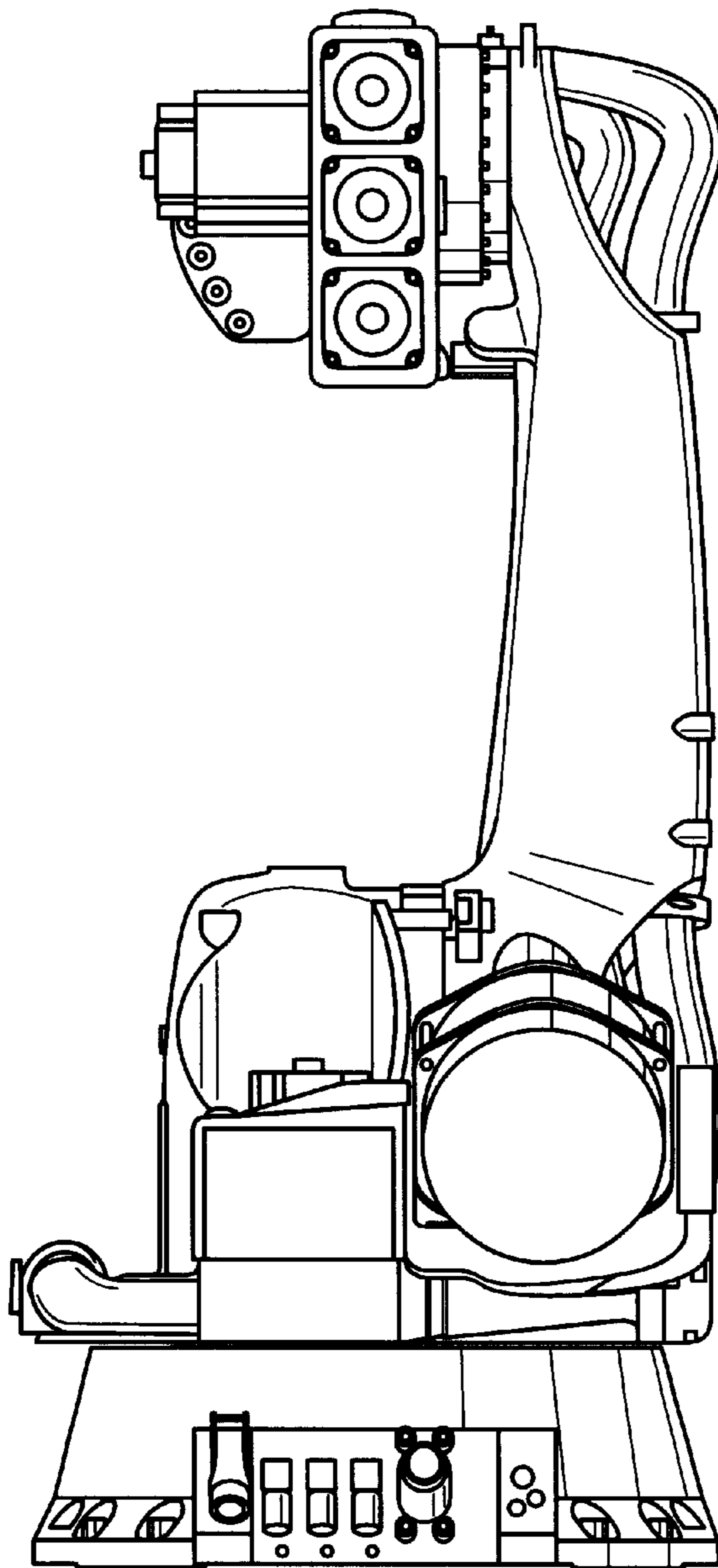

Fig. 6

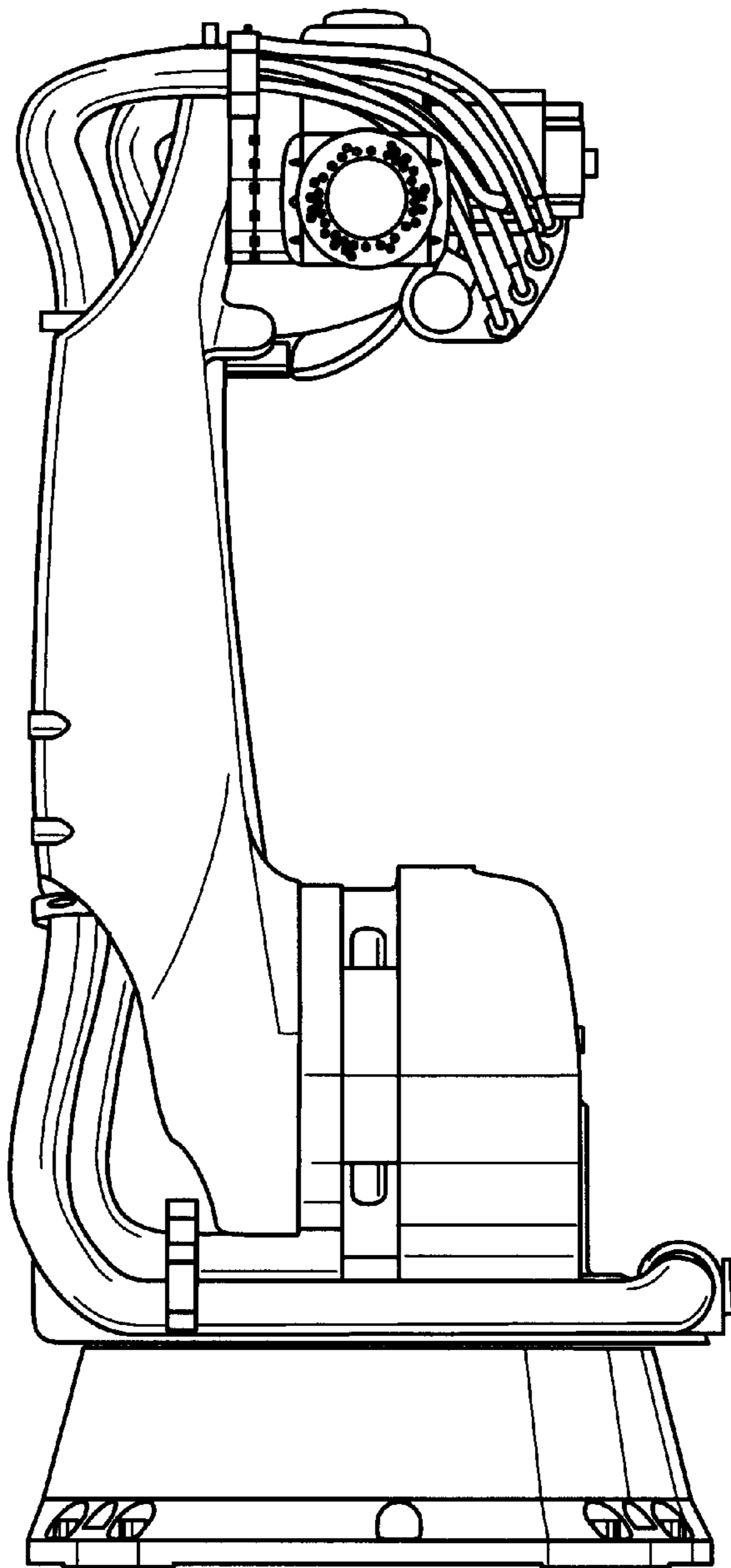

Fig. 7

