



US00D440869S

(12) **United States Design Patent**
Leach

(10) **Patent No.:** **US D440,869 S**

(45) **Date of Patent:** **** Apr. 24, 2001**

(54) **BOTTLE**

D. 138,472 8/1944 Gerson D9/328
D. 300,408 3/1989 Couri D9/328

(76) Inventor: **Ray Leach**, 3536 Glenbrook Dr.,
Norton, OH (US) 44203

(**) Term: **14 Years**

Primary Examiner—Terry A. Wallace
(74) *Attorney, Agent, or Firm*—Roger D. Emerson;
Emerson & Skeriotis; Daniel A. Thomson

(21) Appl. No.: **29/113,942**

(57) **CLAIM**

(22) Filed: **Nov. 15, 1999**

The ornamental design for a bottle, as shown.

Related U.S. Application Data

DESCRIPTION

(63) Continuation-in-part of application No. 29/103,218, filed on
Apr. 9, 1999, now abandoned.

FIG. 1 is a front view of the bottle;

(51) **LOC (7) Cl.** **09-01**

FIG. 2 is a side view thereof;

(52) **U.S. Cl.** **D9/328**

FIG. 3 is a back view of thereof;

(58) **Field of Search** D9/328, 307, 516;
D17/14, 18; 206/457; 215/379-384, 400

FIG. 4 is an opposite side view thereof;

FIG. 5 is a top view thereof; and,

FIG. 6 is a bottom view thereof.

(56) **References Cited**

U.S. PATENT DOCUMENTS

D. 107,353 12/1937 Henshel D9/328

1 Claim, 6 Drawing Sheets

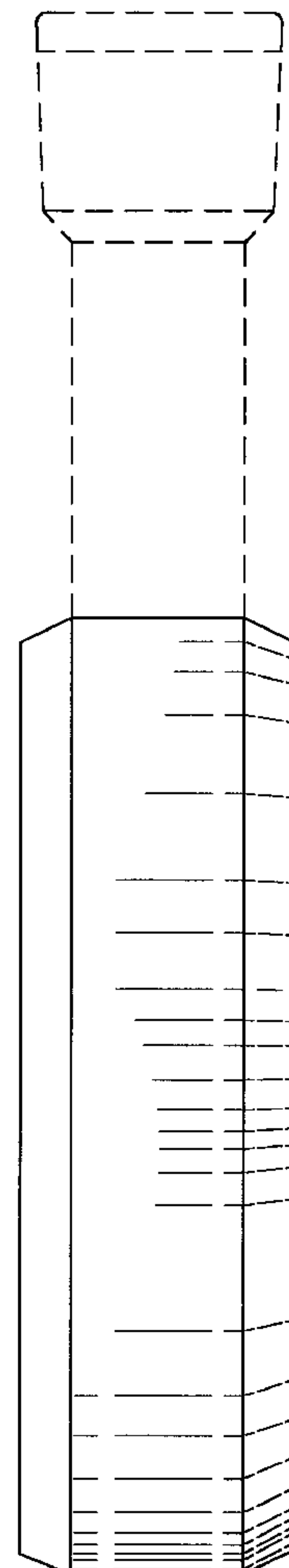
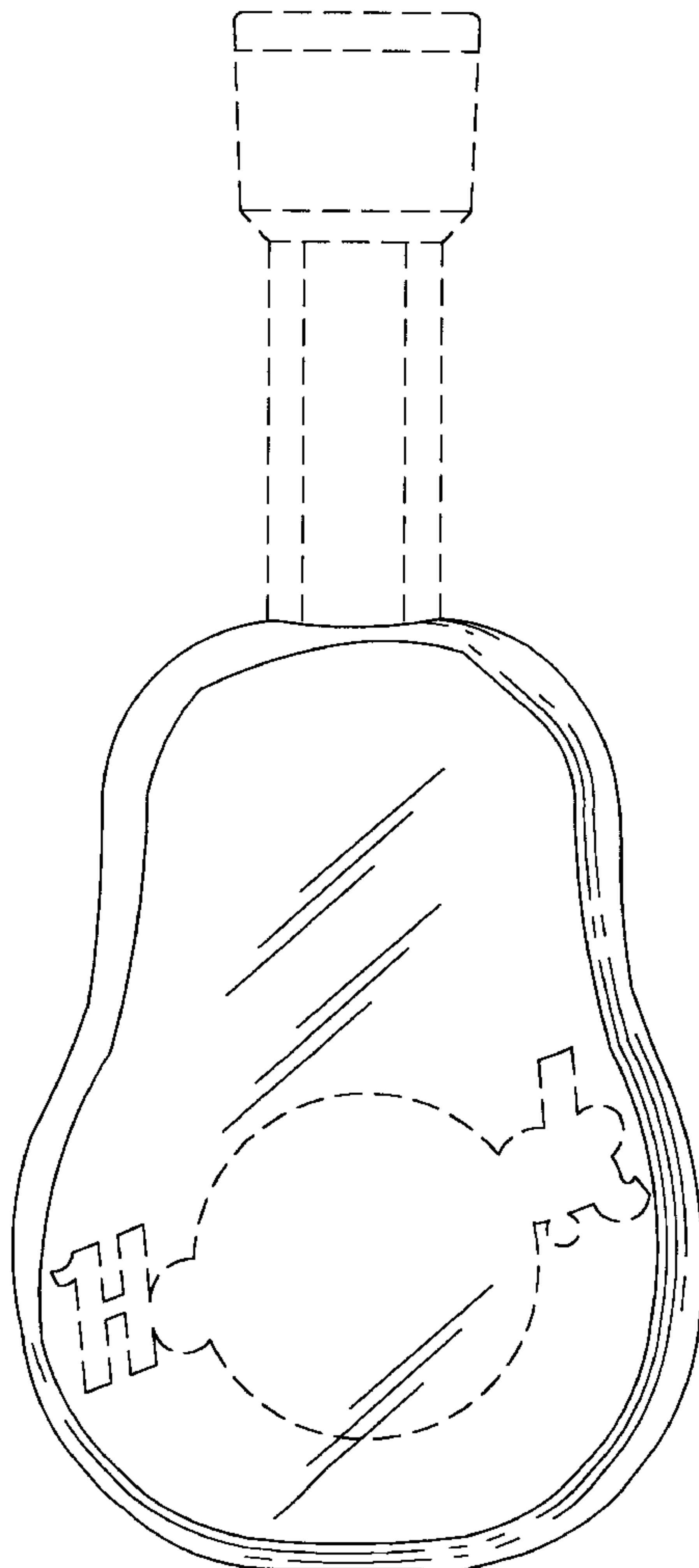

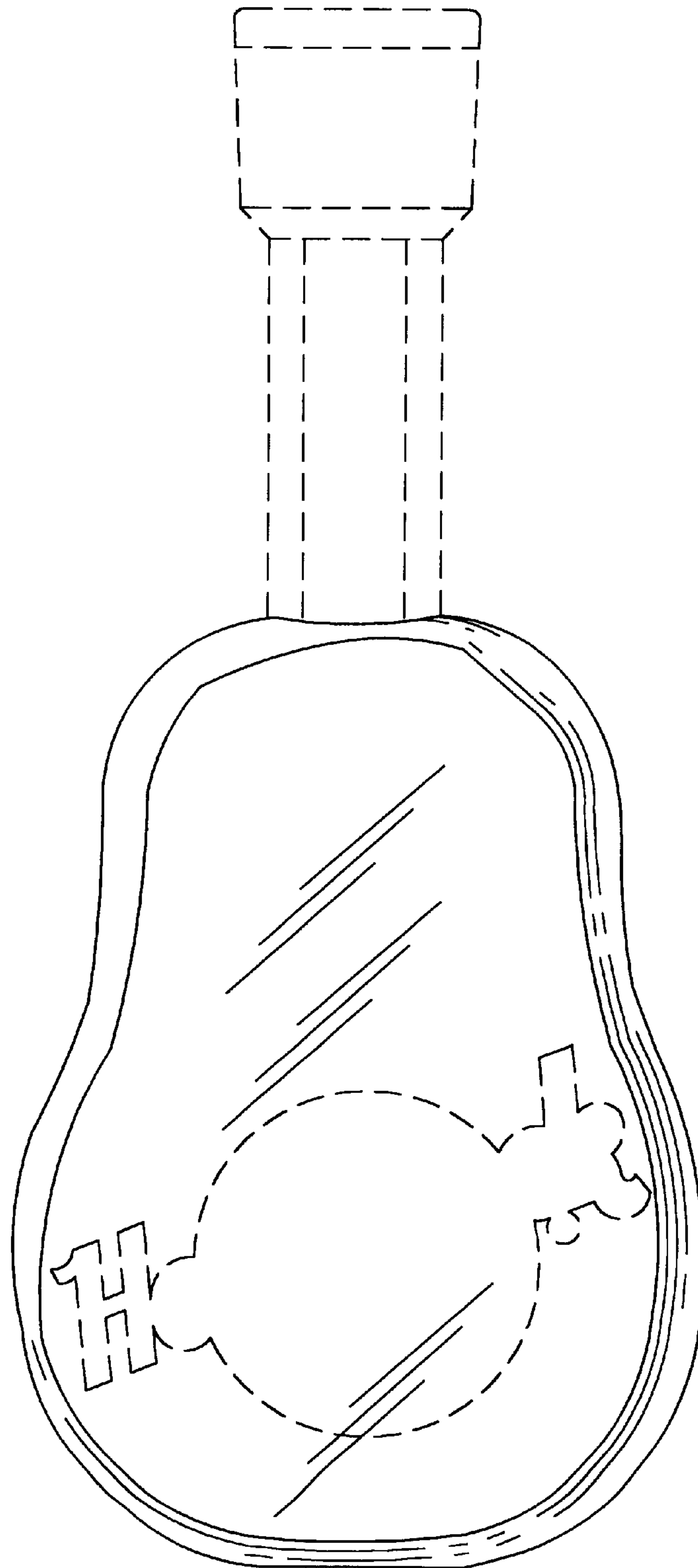

FIG-1

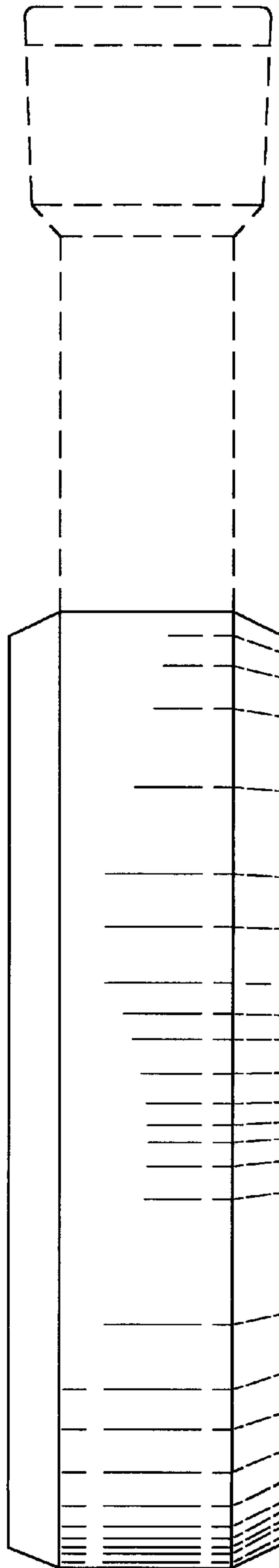

FIG-2

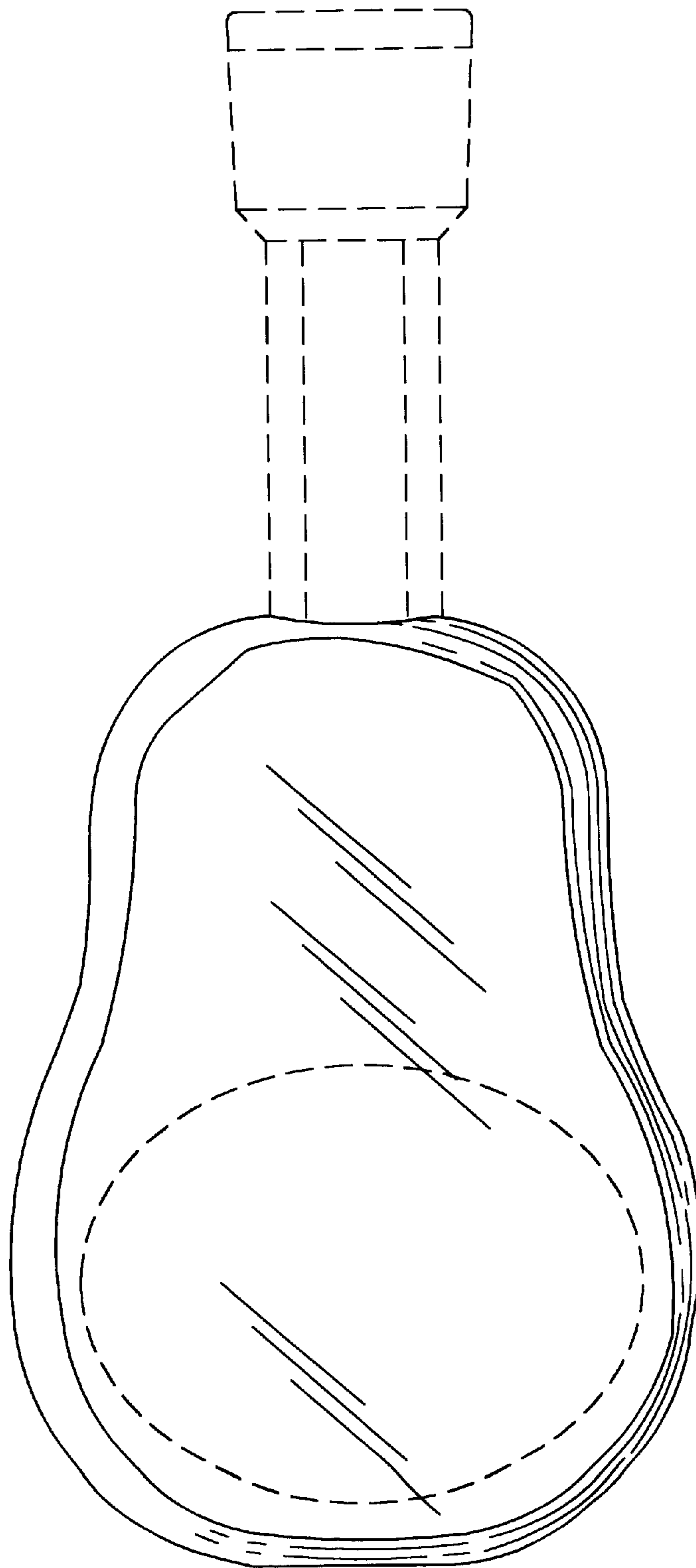

FIG-3

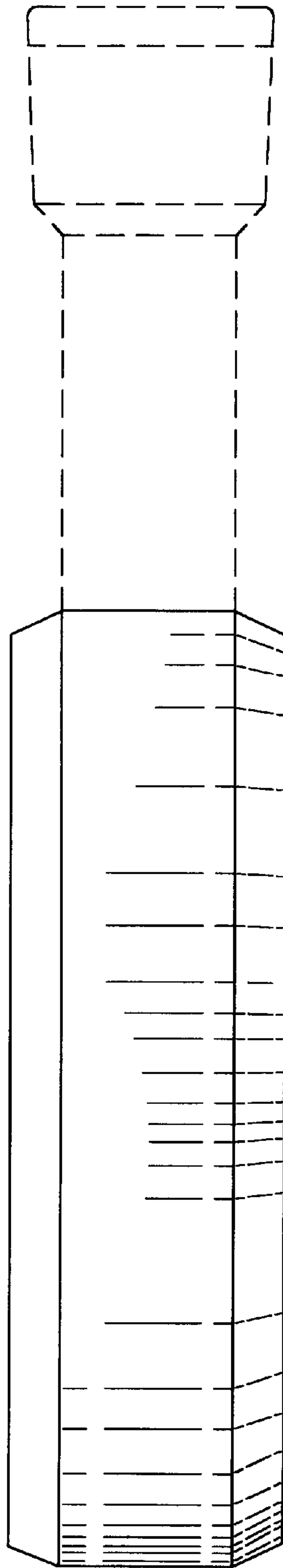

FIG-4

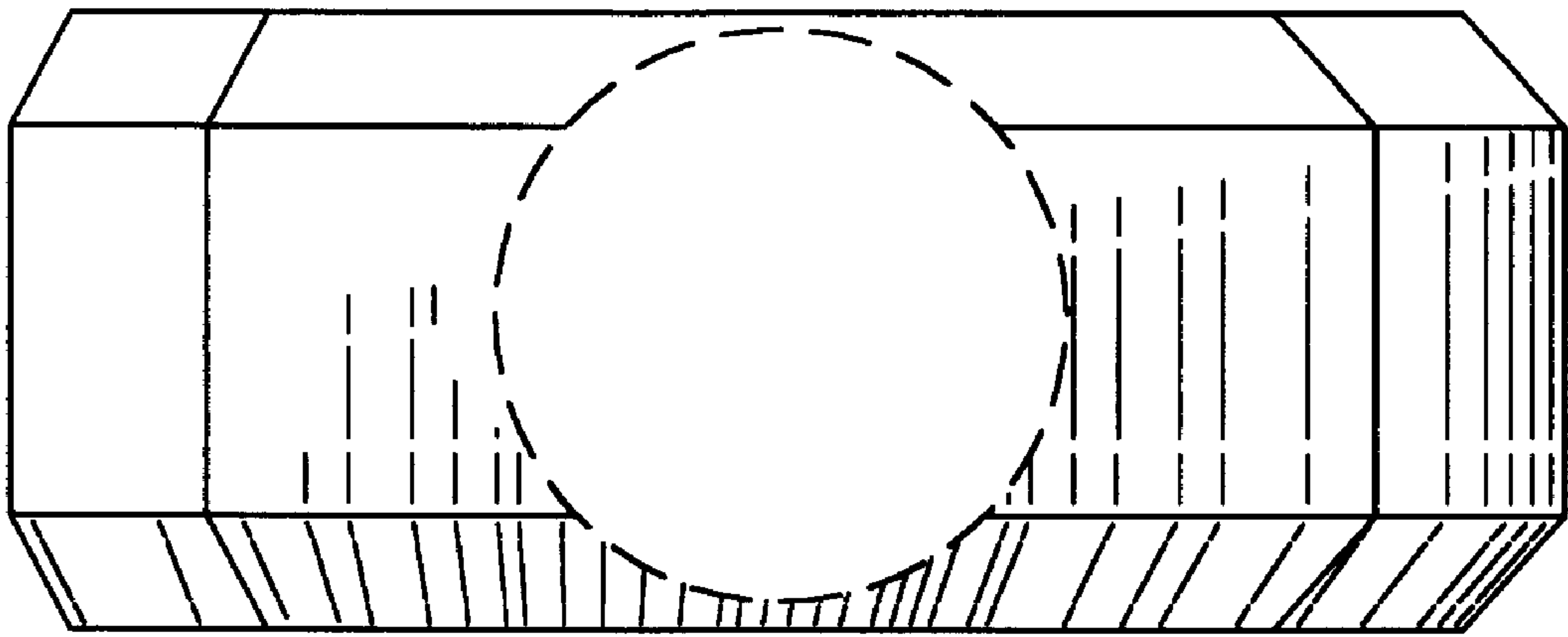

FIG-5

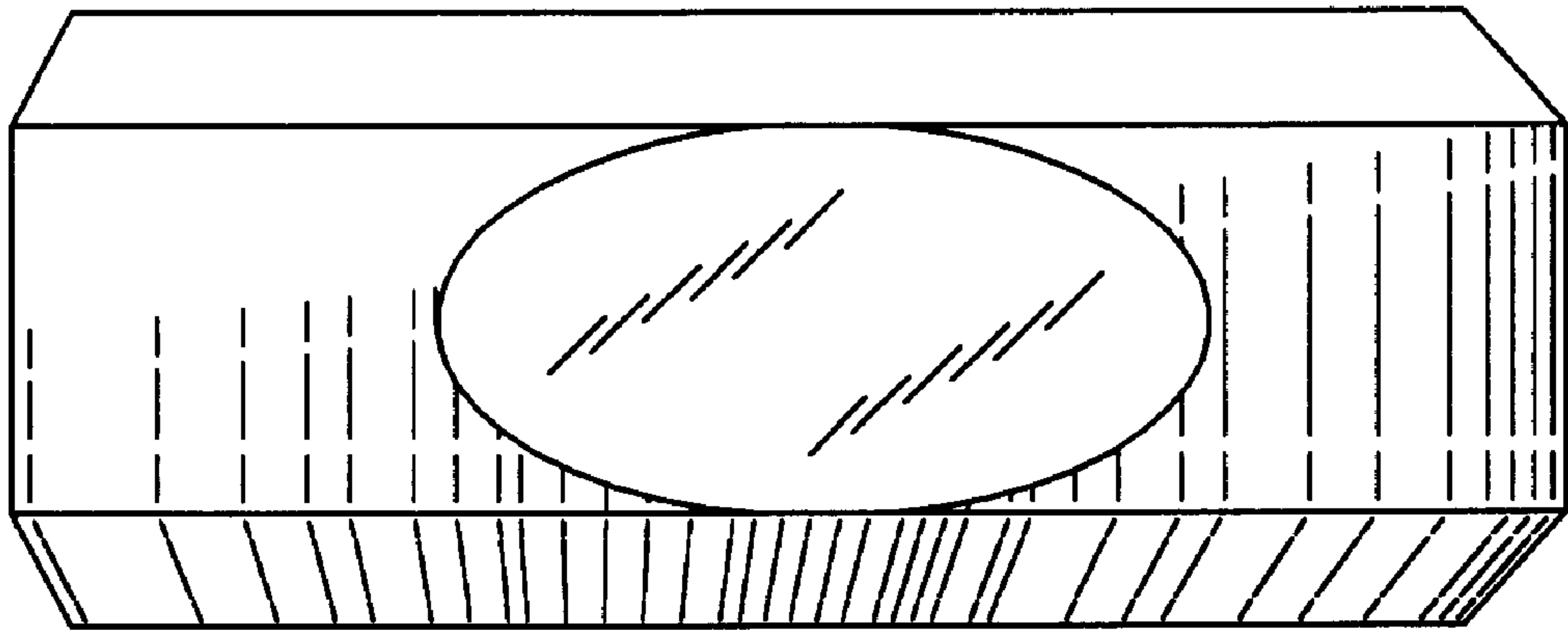

FIG-6