



US00D440620S

(12) **United States Design Patent**
Ellis-Coyne

(10) **Patent No.:** **US D440,620 S**

(45) **Date of Patent:** **** Apr. 17, 2001**

(54) **CHILDREN'S DRIVE-THRU PLAY CENTER**

(57) **CLAIM**

(76) Inventor: **Leanne Ellis-Coyne**, 491 Miller Street,
Meaford, Ontario (CA), N4L 1L1

The ornamental design for a children's drive-thru play center, as shown.

(**) Term: **14 Years**

DESCRIPTION

(21) Appl. No.: **29/124,422**

FIG. 1 is a perspective view from the front of the children's drive-thru play center.

(22) Filed: **Jun. 6, 2000**

FIG. 2 is a first perspective view from the rear of the children's drive-thru play center.

(51) **LOC (7) Cl.** **21-03**

FIG. 3 is a second perspective view from the rear of the children's drive-thru play center.

(52) **U.S. Cl.** **D21/811**

FIG. 4 is an elevation view from the front of the children's drive-thru play center.

(58) **Field of Search** D21/811, 814,
D21/506, 512, 509; 472/116, 136; 482/35,
36; 446/102, 487

FIG. 5 is an elevation view from the first outer side of the children's drive-thru play center.

(56) **References Cited**

FIG. 6 is an elevation view from a second outer side of the children's drive-thru play center.

U.S. PATENT DOCUMENTS

FIG. 7 is a top plan view of the children's drive-thru play center.

D. 346,420 * 4/1994 Cacciola et al. D21/816

FIG. 8 is an elevation view from the rear of the children's drive-thru play center; and,

D. 397,188 * 8/1998 Bro et al. D21/814

FIG. 9 is a bottom plan view of the children's drive-thru play center.

5,580,316 * 12/1996 Hill et al. 472/116

* cited by examiner

Primary Examiner—Mitchell Siegel

1 Claim, 4 Drawing Sheets

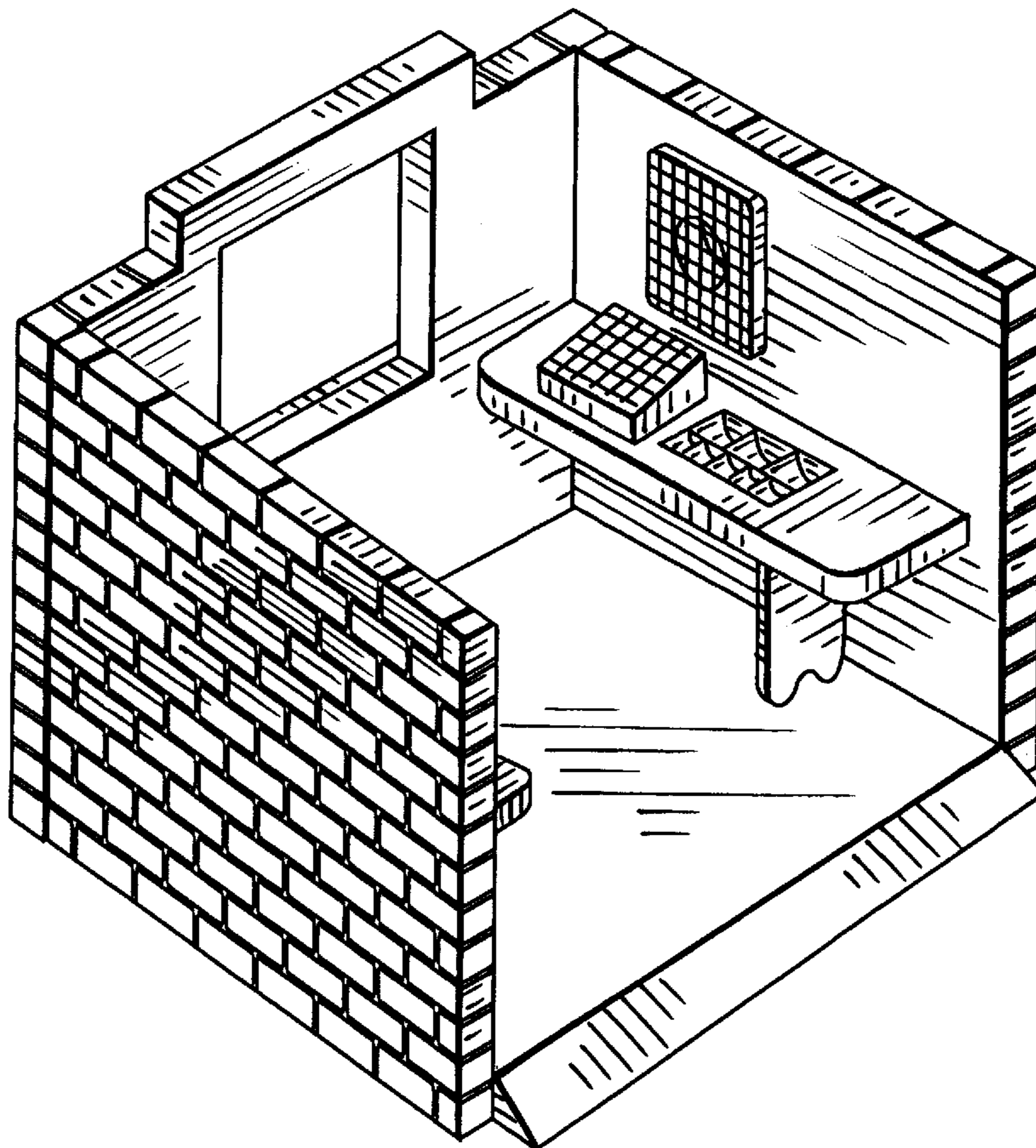

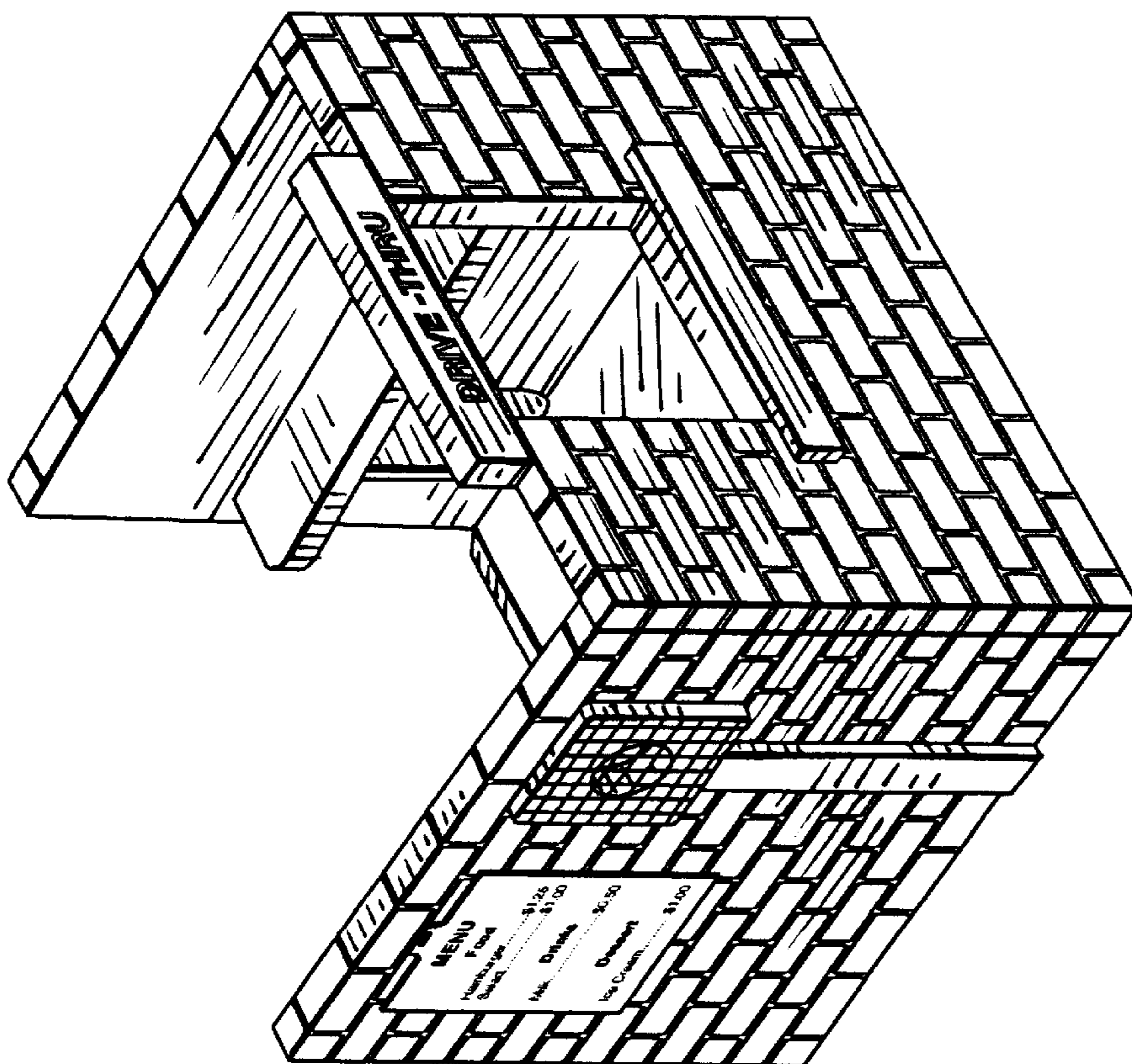

FIG. 1

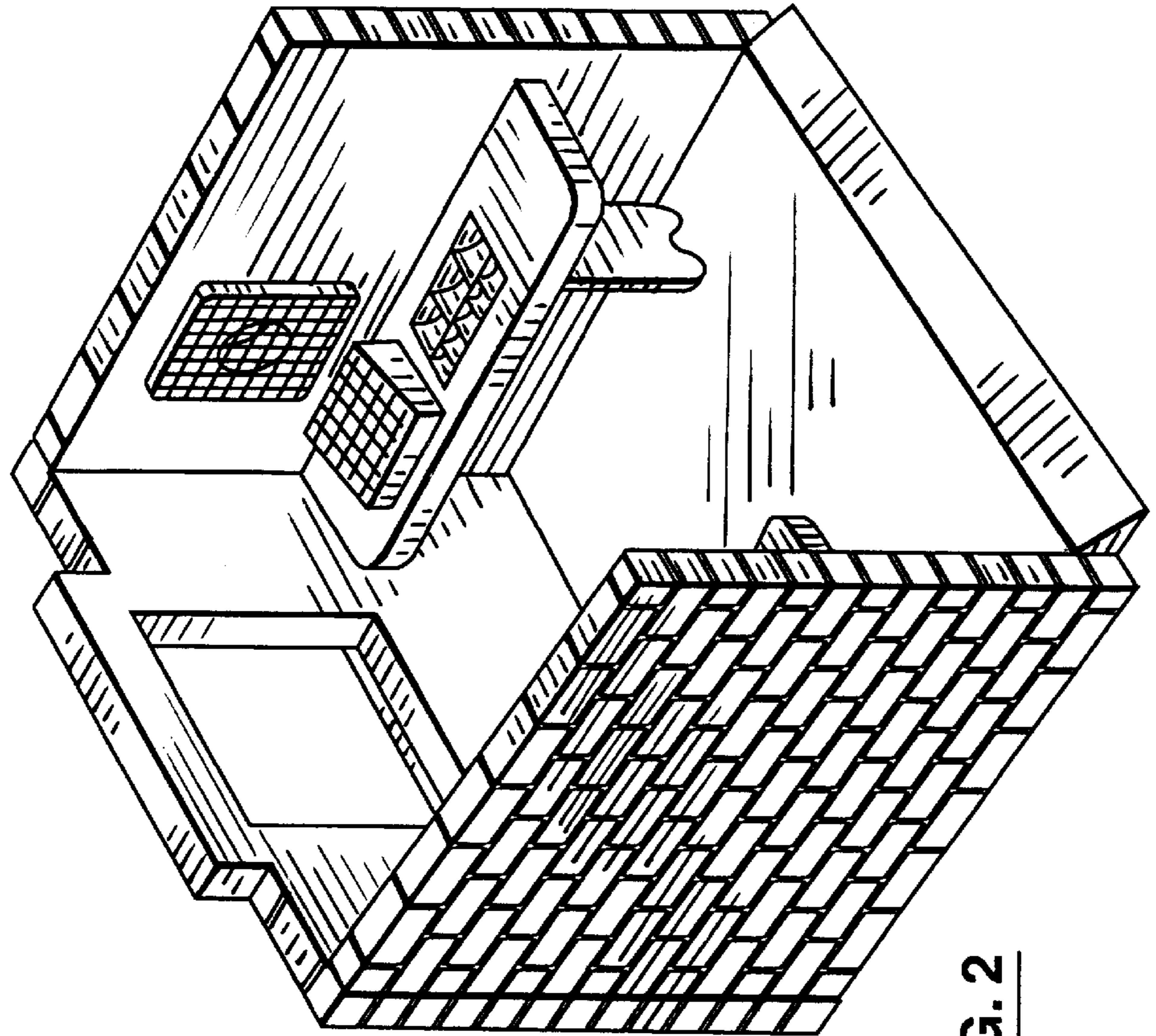

FIG. 2

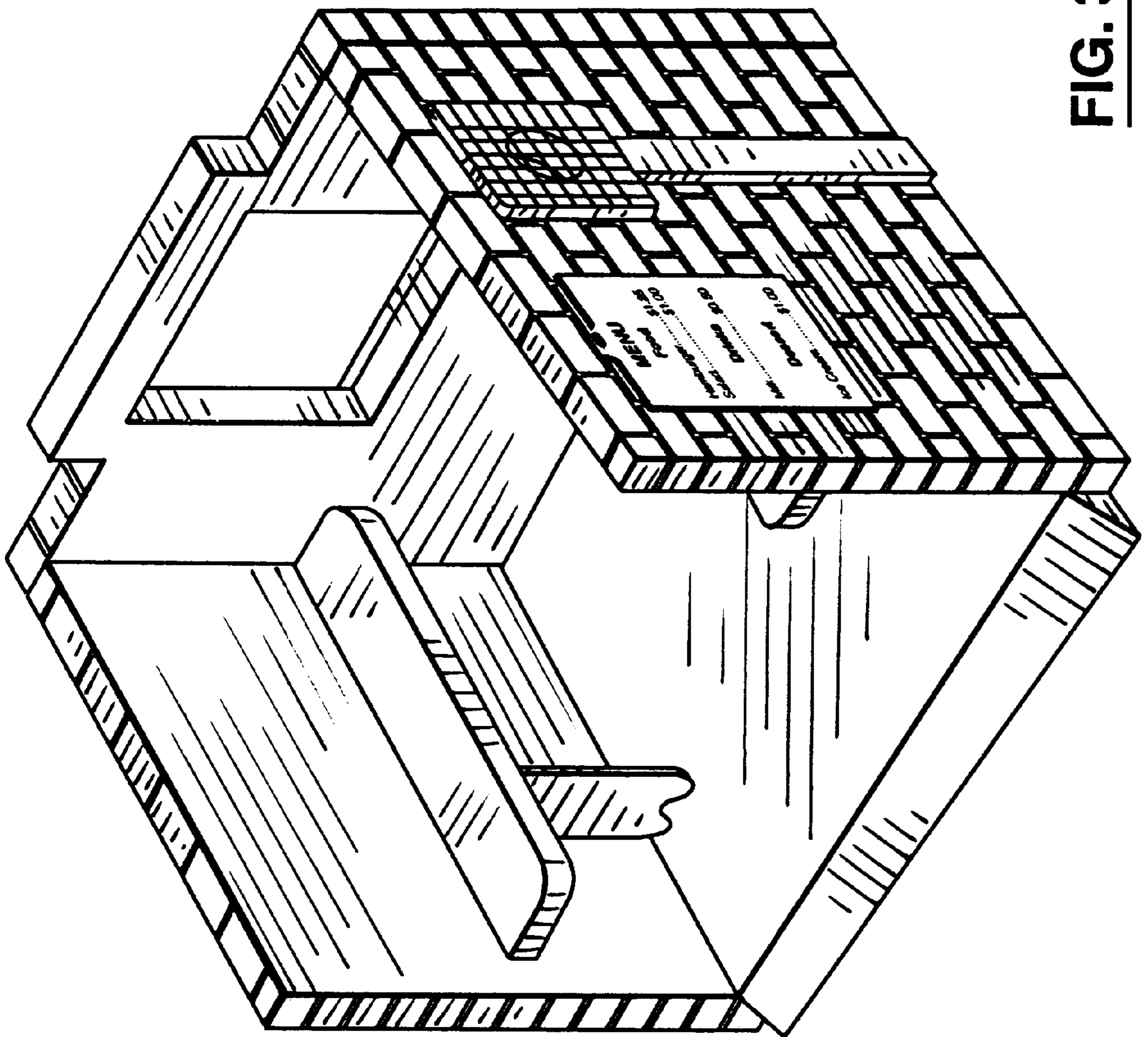

FIG. 3

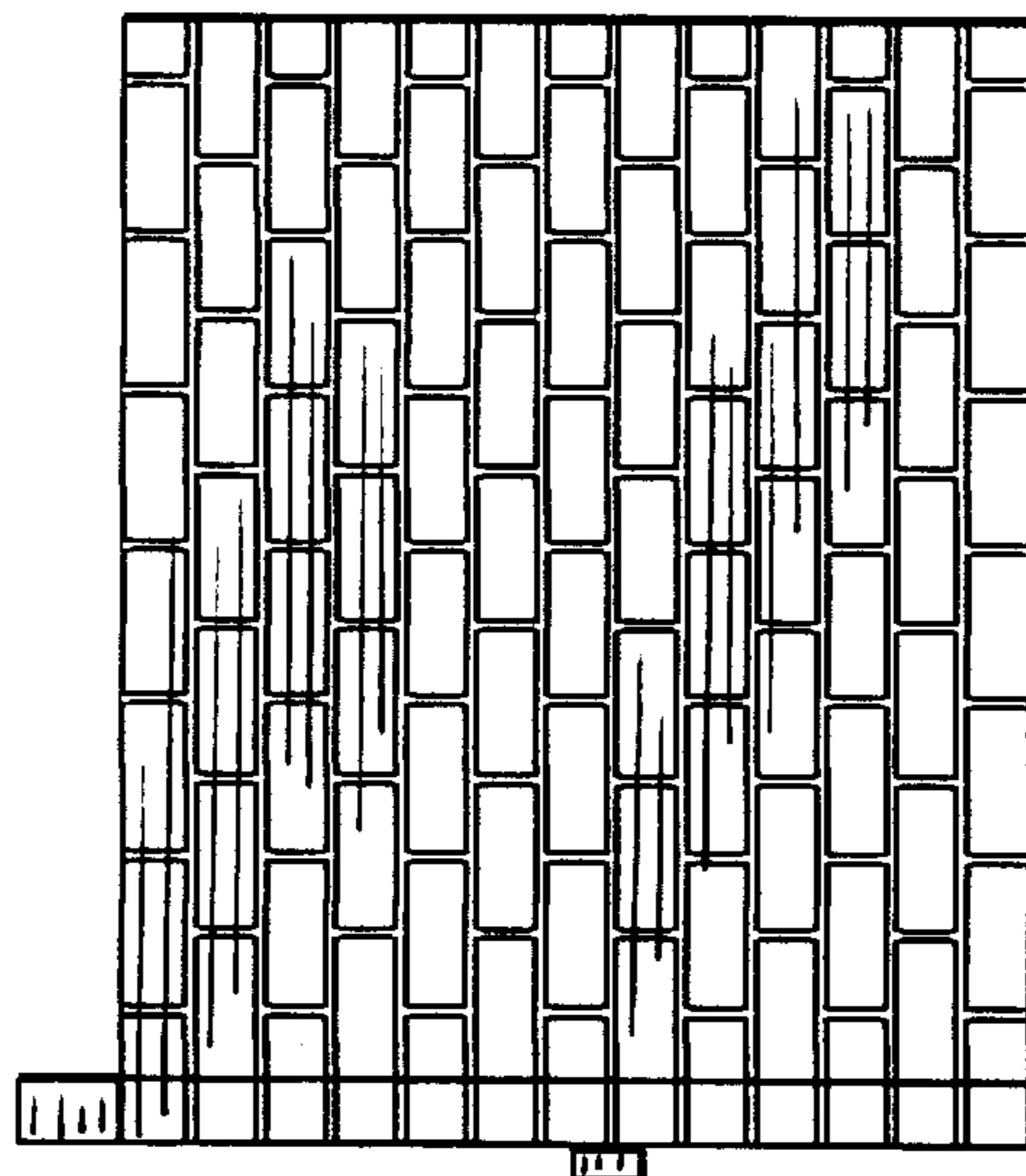

FIG. 6

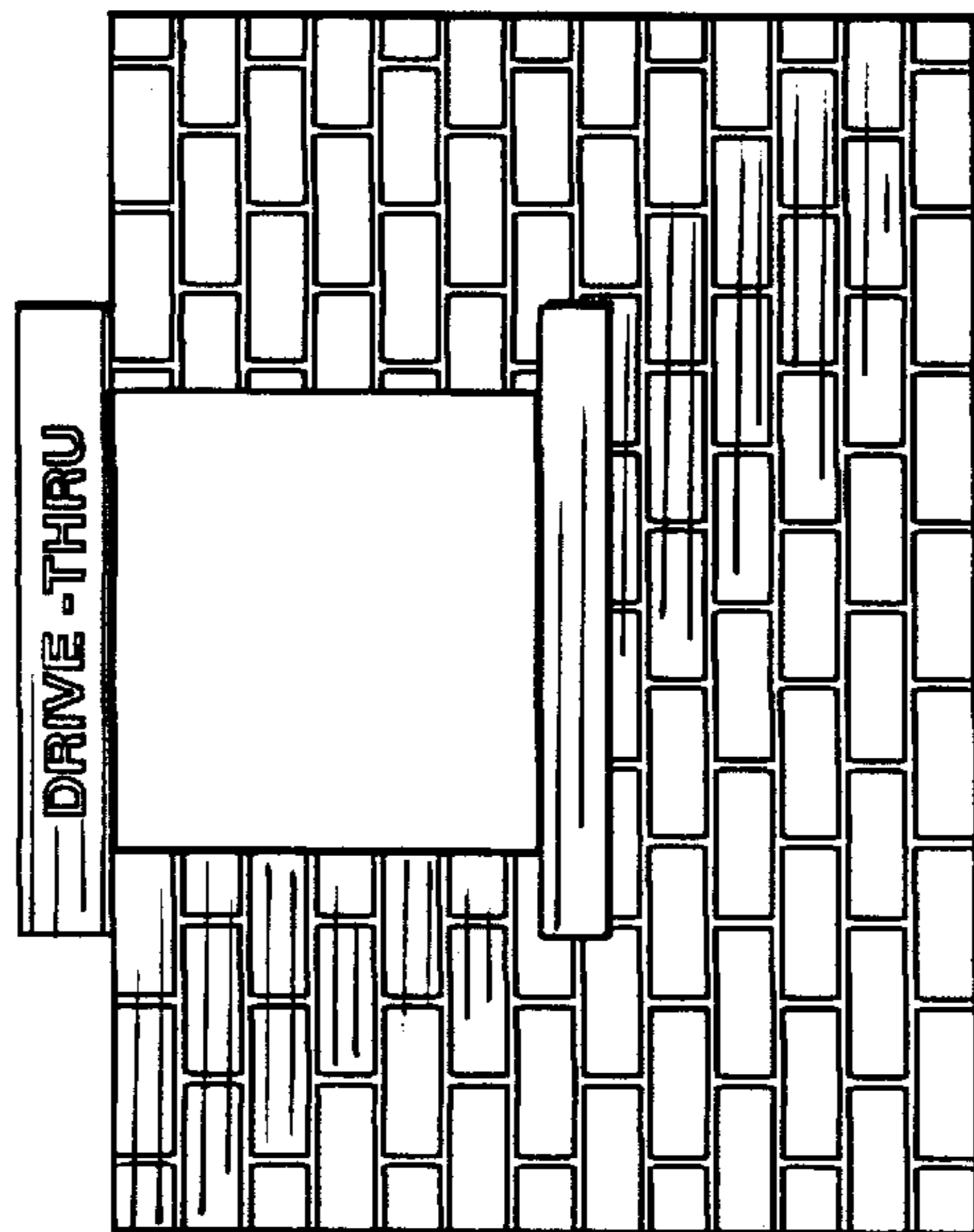

FIG. 4

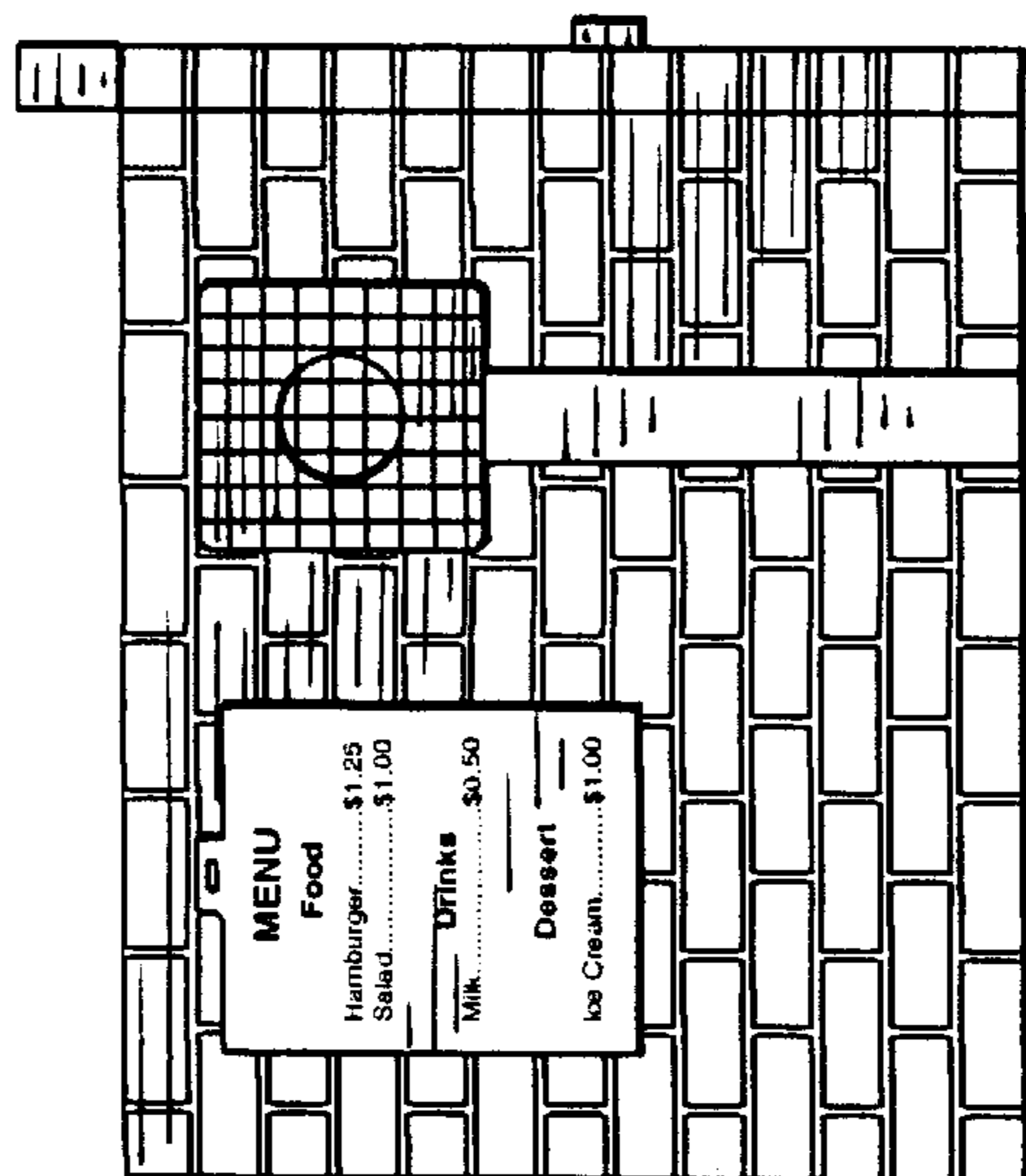

FIG. 5

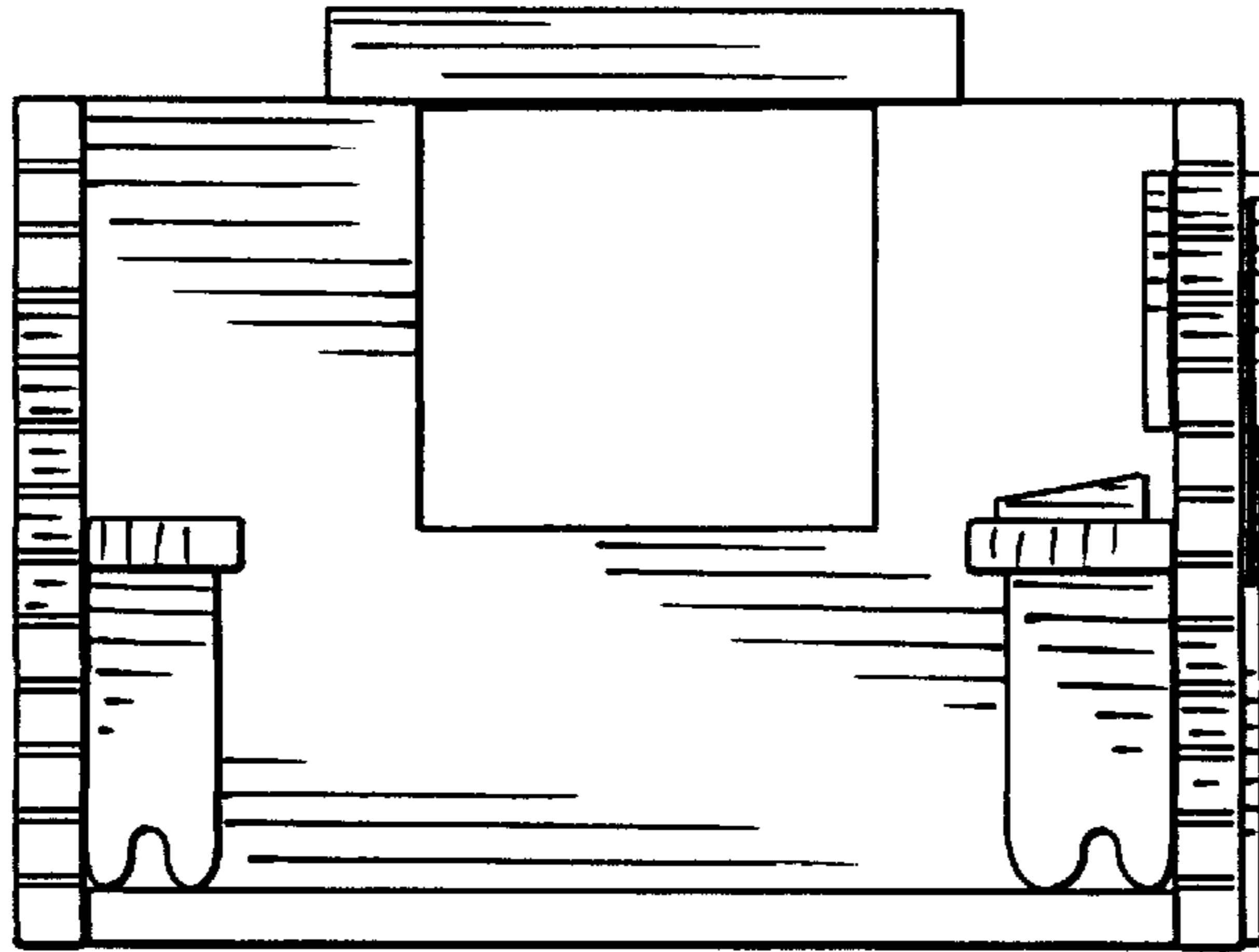

FIG. 8

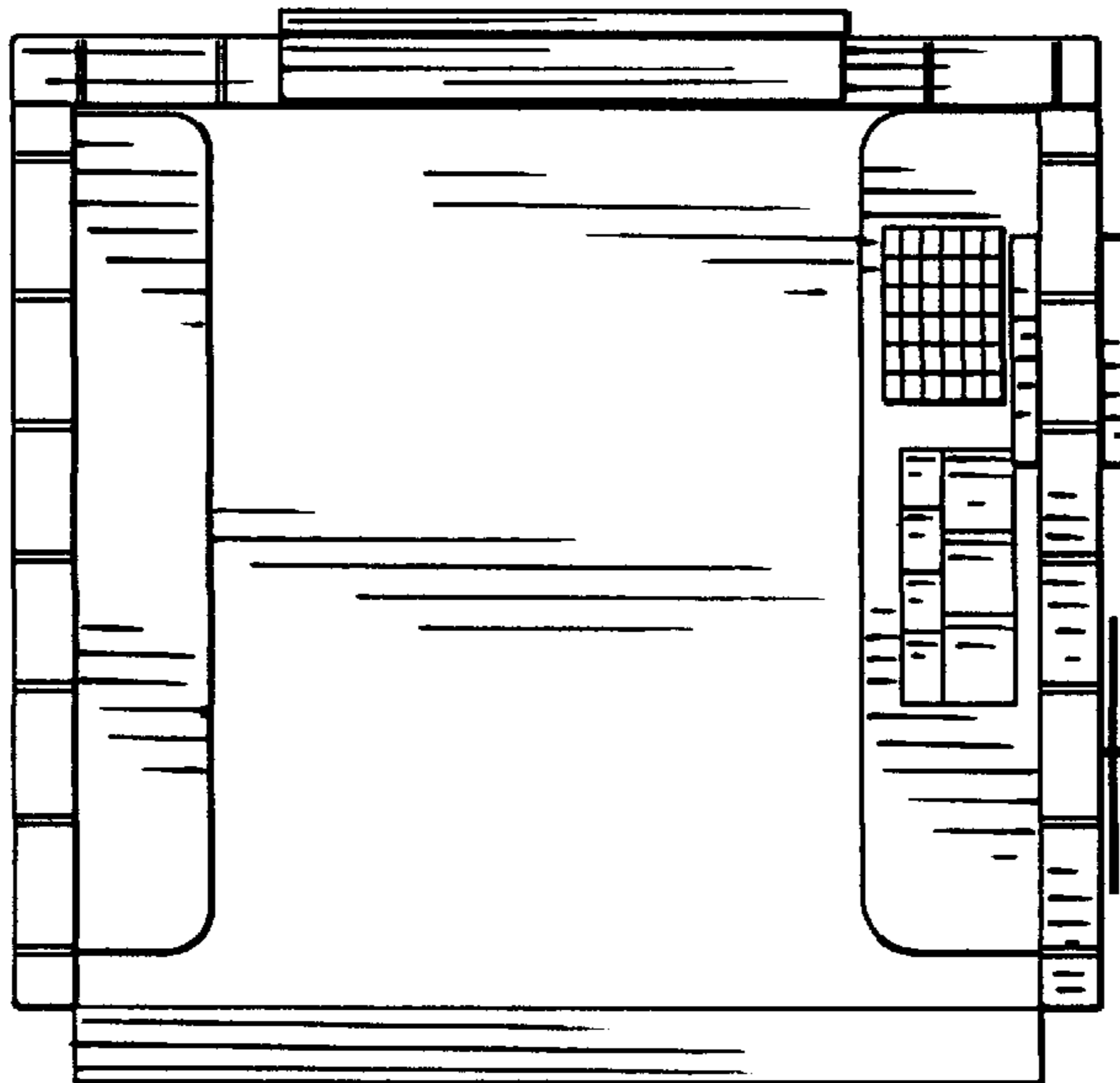

FIG. 7

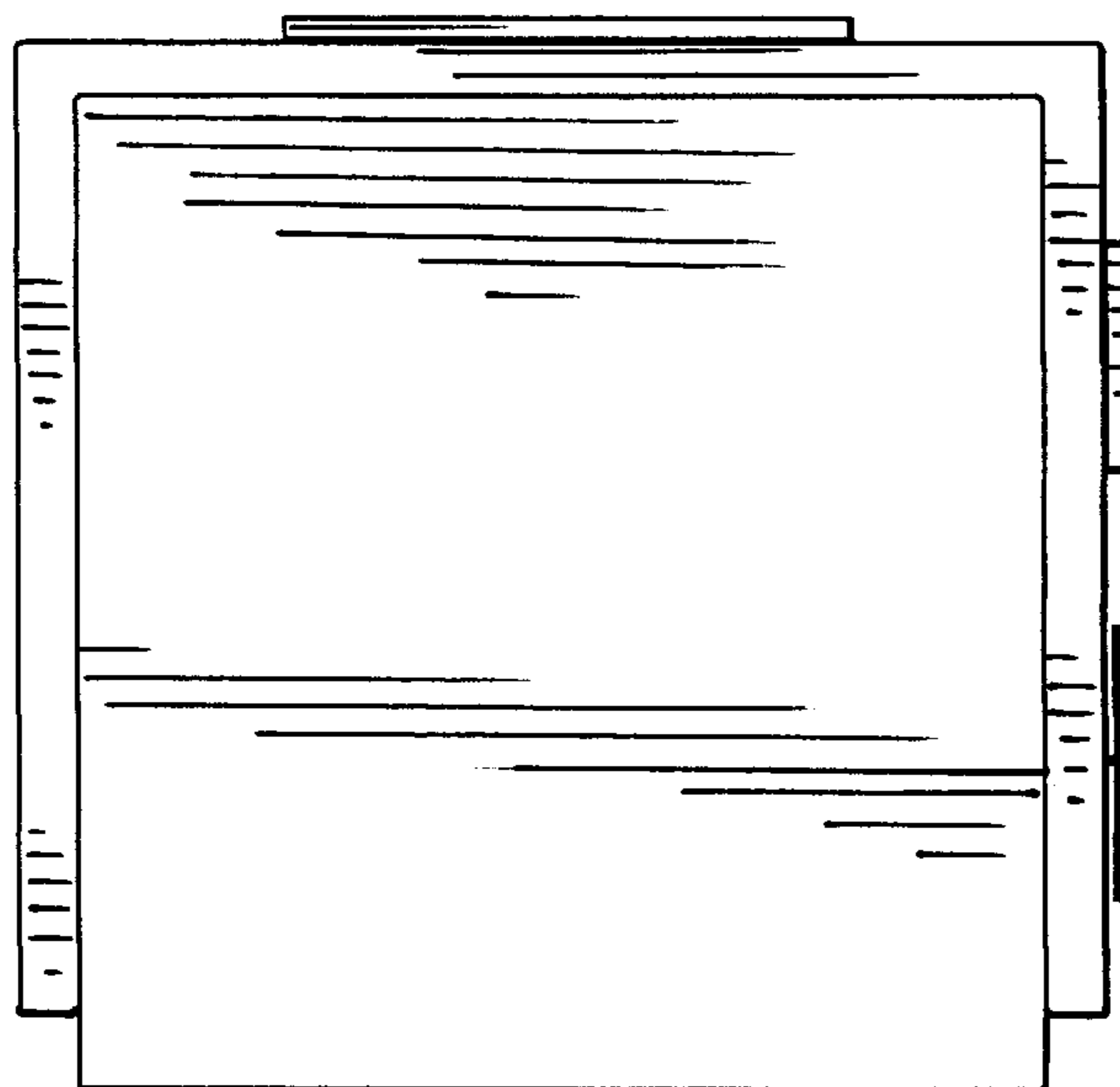

FIG. 9