



US00D440427S

(12) **United States Design Patent**
Melillo

(10) **Patent No.:** **US D440,427 S**

(45) **Date of Patent:** **** Apr. 17, 2001**

(54) **VANITY CABINET**

D. 386,917 * 12/1997 Blevio D6/445
D. 412,629 * 8/1999 Zaidman D6/445

(75) Inventor: **Timothy Melillo**, Middlefield, OH (US)

OTHER PUBLICATIONS

(73) Assignee: **Kraftmaid Cabinetry, Inc.**,
Middlefield, OH (US)

Ikea Catalog, Adel Cabinet Doors, p. 120, 1997.*

(**) Term: **14 Years**

* cited by examiner

(21) Appl. No.: **29/118,358**

Primary Examiner—Cathron Brooks

(22) Filed: **Feb. 7, 2000**

(74) *Attorney, Agent, or Firm*—Edgar A. Zarins; Lloyd D. Doigan

(51) **LOC (7) Cl.** **06-04**

(52) **U.S. Cl.** **D6/445**

(58) **Field of Search** D6/432, 436, 438,
D6/439, 445, 446, 448, 555, 559, 560,
561; 312/198, 199, 200, 209, 351.2

(57) **CLAIM**

The ornamental design for a vanity cabinet, as shown and described.

(56) **References Cited**

DESCRIPTION

U.S. PATENT DOCUMENTS

- D. 223,374 * 4/1972 Firdmann D6/445
- D. 311,649 * 10/1990 Keller D6/445
- D. 312,361 * 11/1990 Palka D6/447
- D. 340,819 * 11/1993 Hutchinson D6/439

FIG. 1 is a perspective view of a vanity cabinet showing my design;
FIG. 2 is a front elevational view thereof;
FIG. 3 is a top plan view thereof;
FIG. 4 is a left side view thereof; and,
FIG. 5 is a right side view thereof.

1 Claim, 2 Drawing Sheets

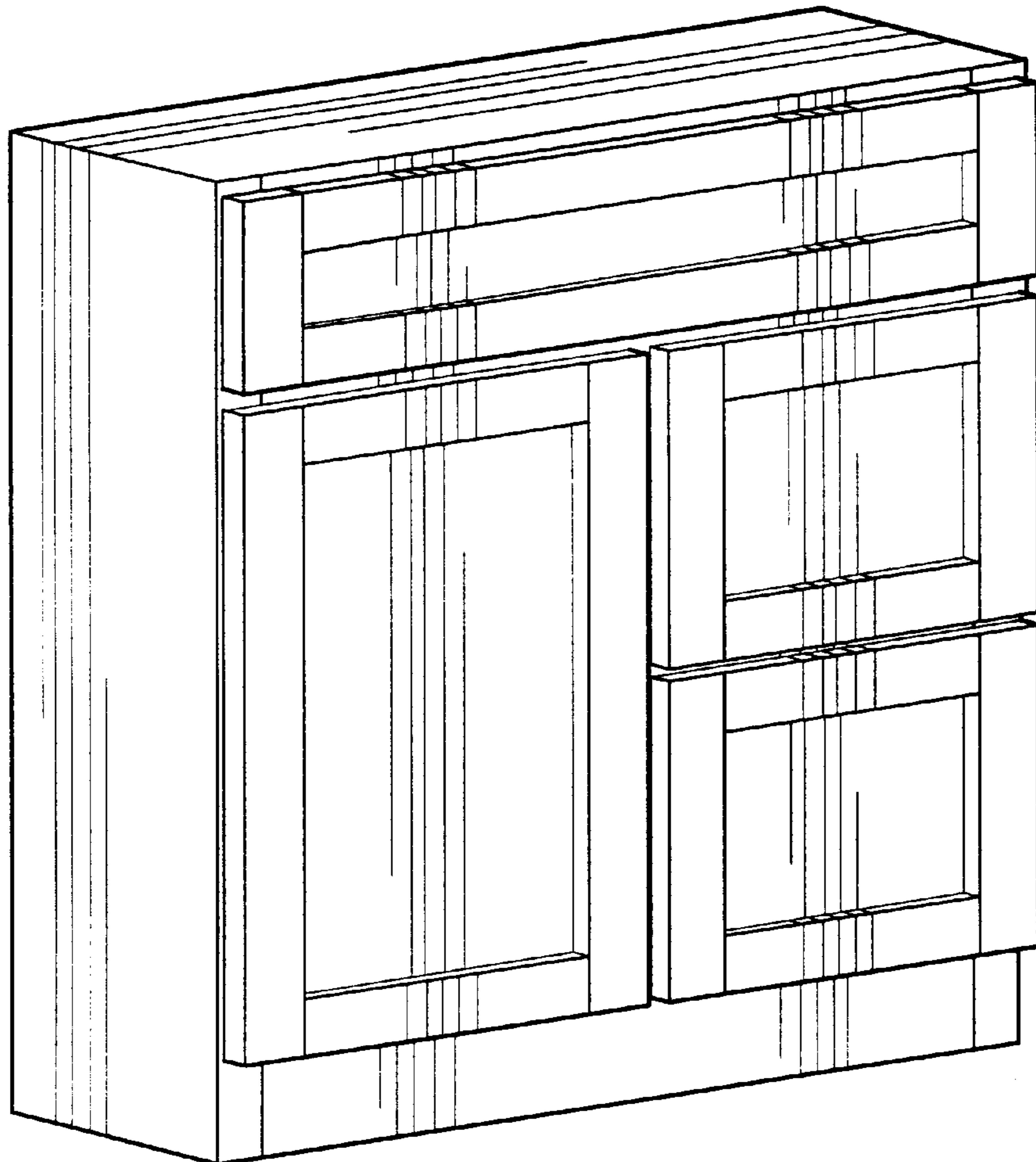

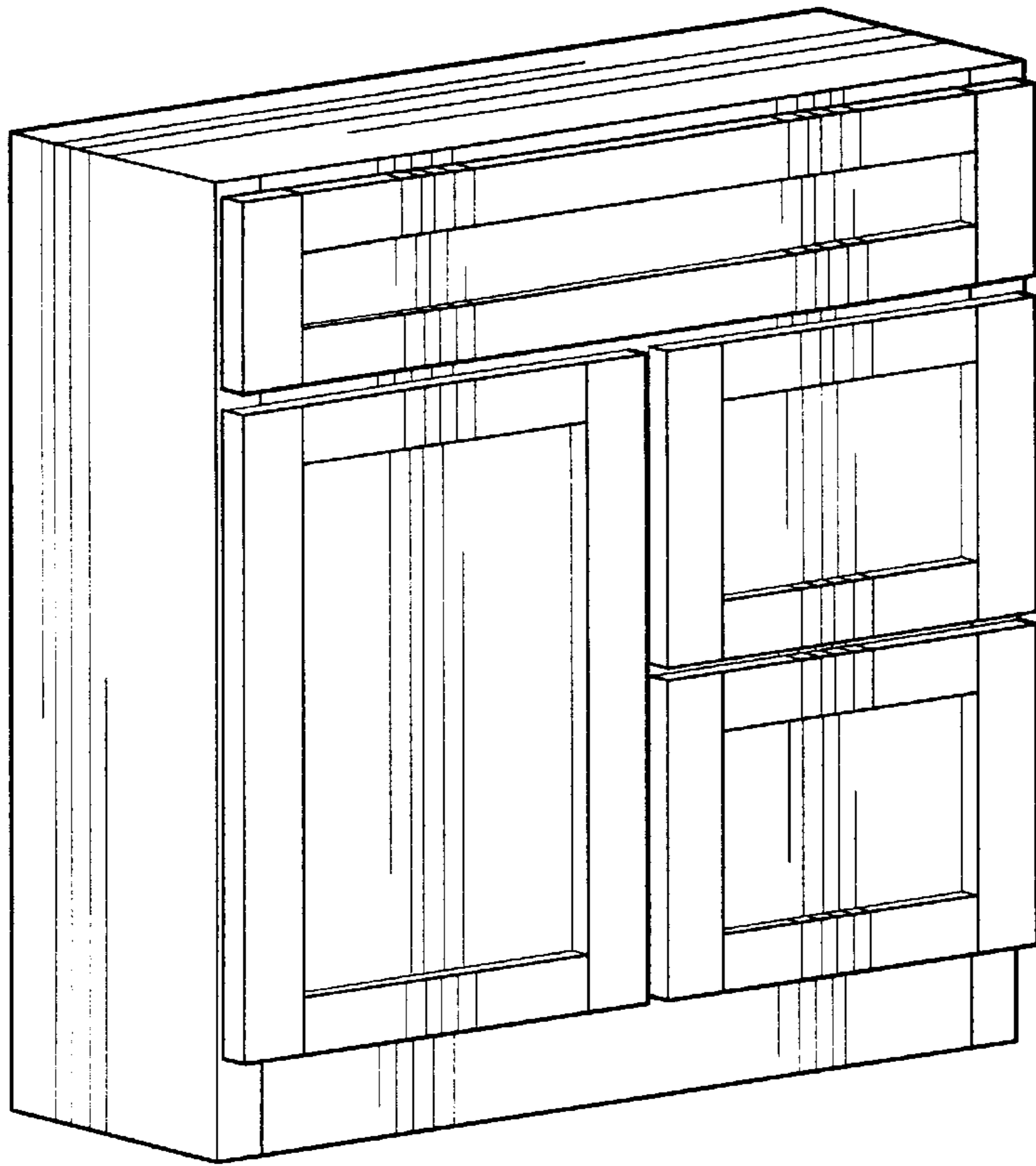

Fig-1

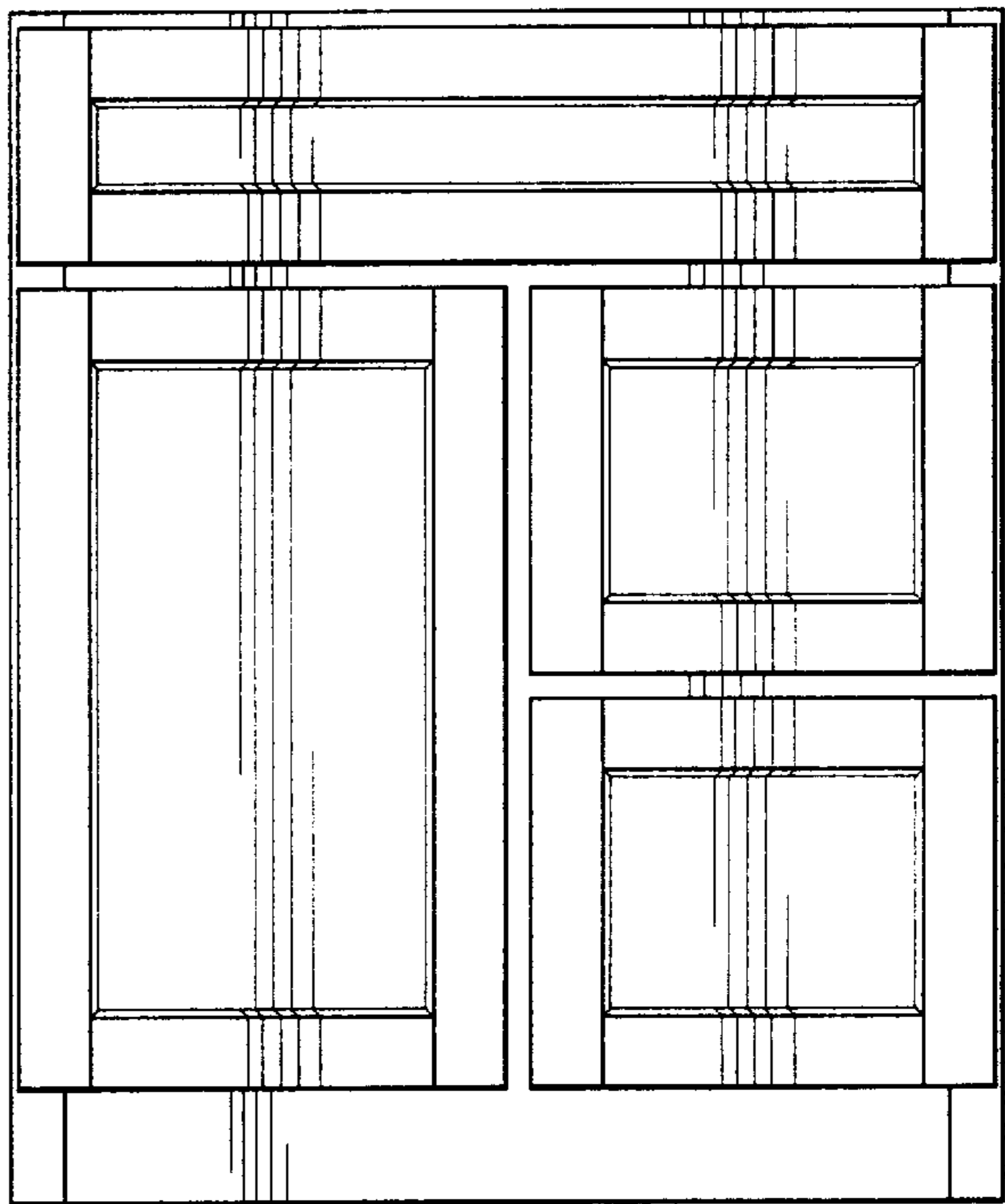

Fig-2

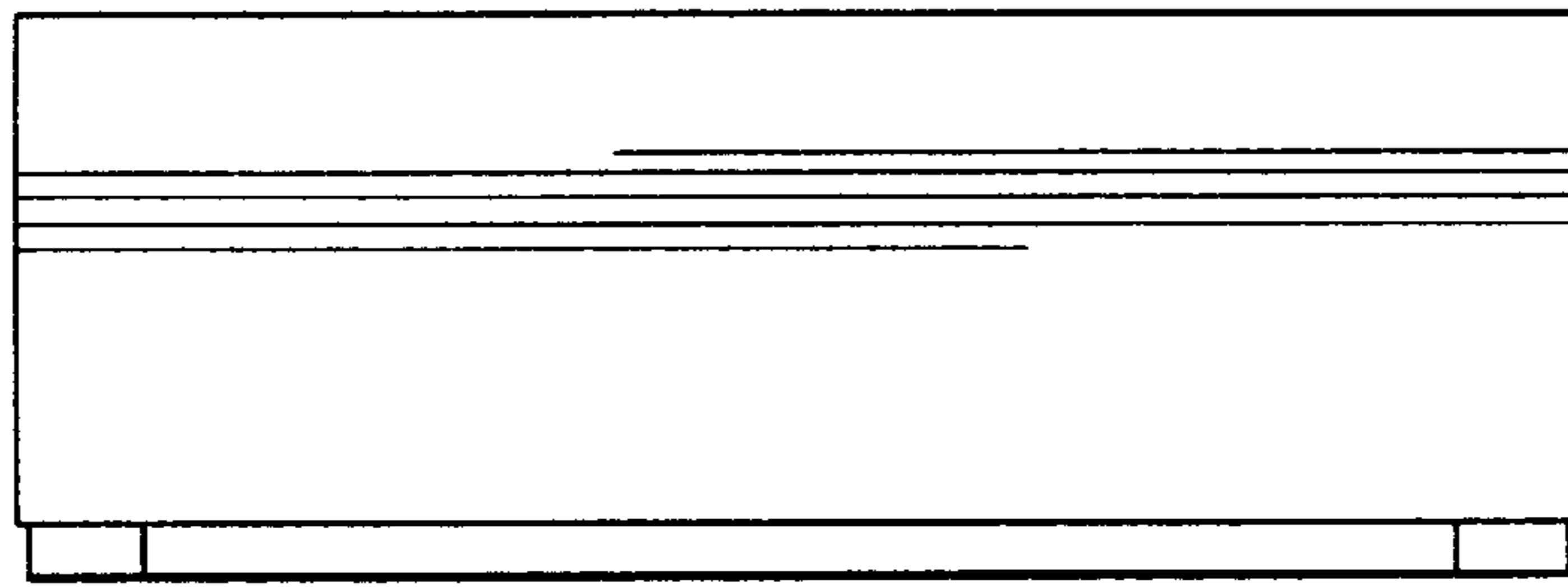

Fig-3

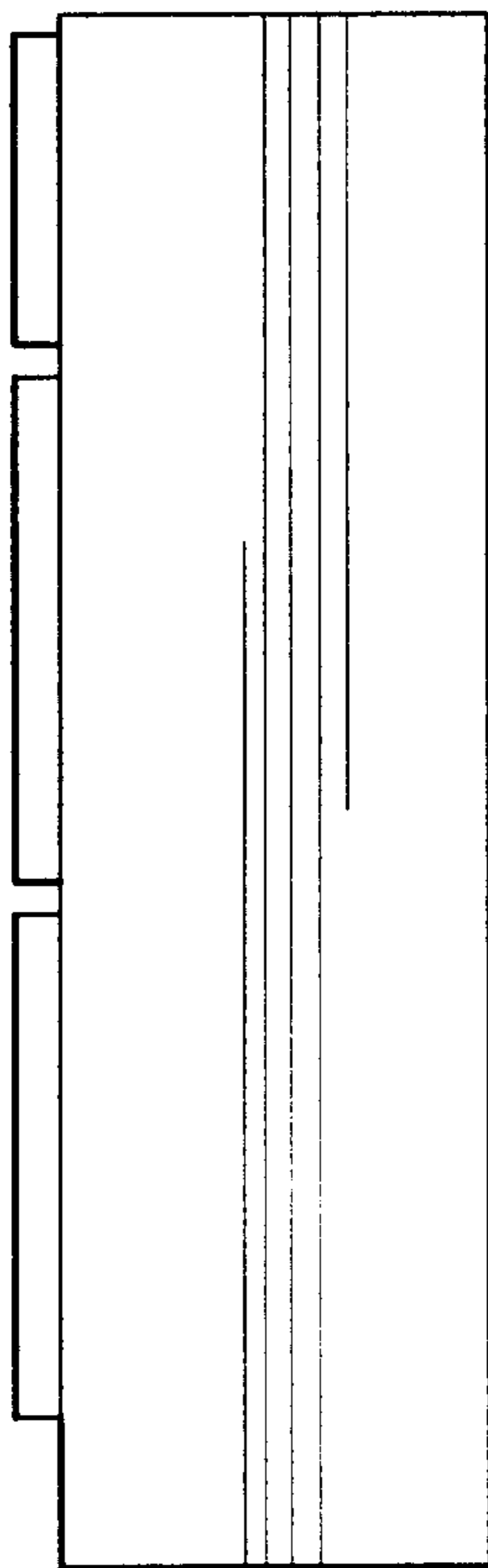

Fig-4

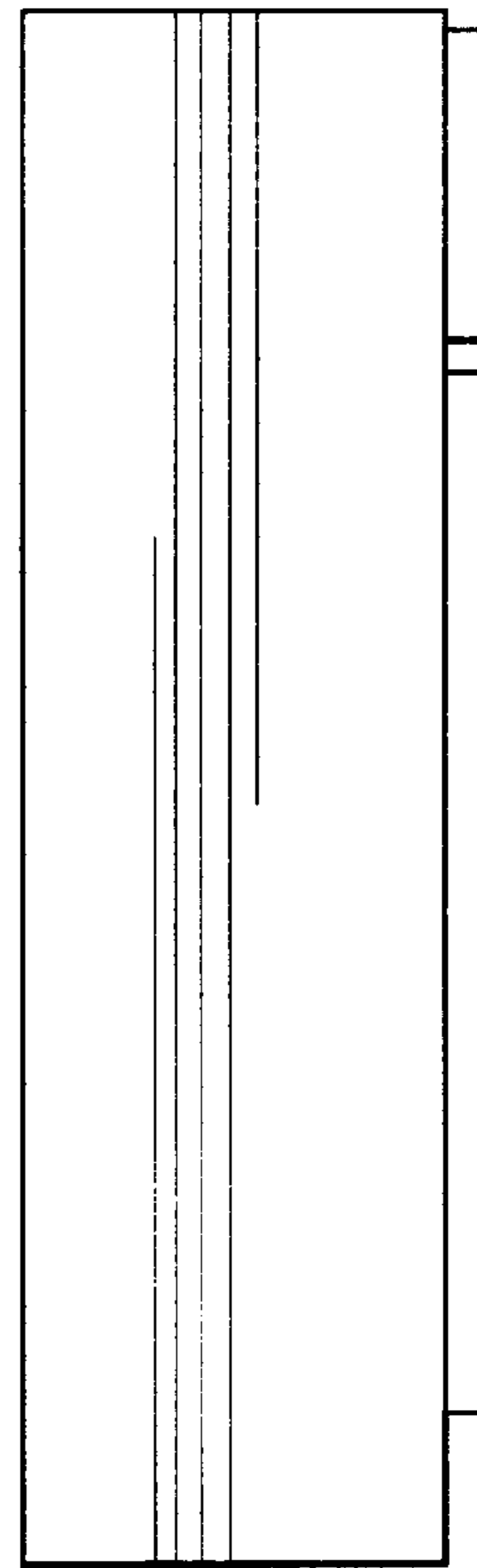

Fig-5