



US00D440240S

(12) **United States Design Patent**  
**Buch**

(10) **Patent No.:** **US D440,240 S**

(45) **Date of Patent:** **\*\* Apr. 10, 2001**

(54) **RACK AND PINION STEERING GEAR FOR MOTOR VEHICLES**

(76) **Inventor:** **Terry C. Buch**, 8900 Castle Park Dr.,  
Elk Grove, CA (US) 95624

(\*\*) **Term:** **14 Years**

(21) **Appl. No.:** **29/121,106**

(22) **Filed:** **Apr. 3, 2000**

(51) **LOC (7) Cl.** ..... **15-09**

(52) **U.S. Cl.** ..... **D15/149**

(58) **Field of Search** ..... D15/148, 149;  
74/388 R, 388 PS

(56) **References Cited**

**U.S. PATENT DOCUMENTS**

6,021,685 \* 2/2000 Sonoda et al. .... 74/388 PS  
6,026,924 \* 2/2000 Godek ..... 74/388 R X

\* cited by examiner

*Primary Examiner*—Antoine Duval Davis

(74) *Attorney, Agent, or Firm*—R. Michael West; Boutin,  
Dentino, Gibson, Di Giusto, Hodell, & West

(57) **CLAIM**

The ornamental design for a rack and pinion steering gear for motor vehicles, as shown and described.

**DESCRIPTION**

FIG. 1 is a perspective view of a rack and pinion steering gear for motor vehicles, showing my new design;  
FIG. 2 is an elevational view of the left side, thereof;  
FIG. 3 is an elevational view of the right side, thereof;  
FIG. 4 is a top plan view, thereof;  
FIG. 5 is a rear elevational view, thereof;  
FIG. 6 is a bottom plan view, thereof;  
FIG. 7 is a front elevational view, thereof;  
FIG. 8 is a perspective view of an alternative embodiment of a rack and pinion steering gear for motor vehicles;  
FIG. 9 is an elevational view of the left side, thereof;  
FIG. 10 is an elevational view of the right side, thereof;  
FIG. 11 is a top plan view, thereof;  
FIG. 12 is a rear elevational view, thereof;  
FIG. 13 is a bottom plan view, thereof; and,  
FIG. 14 is a front elevational view, thereof.

**1 Claim, 6 Drawing Sheets**

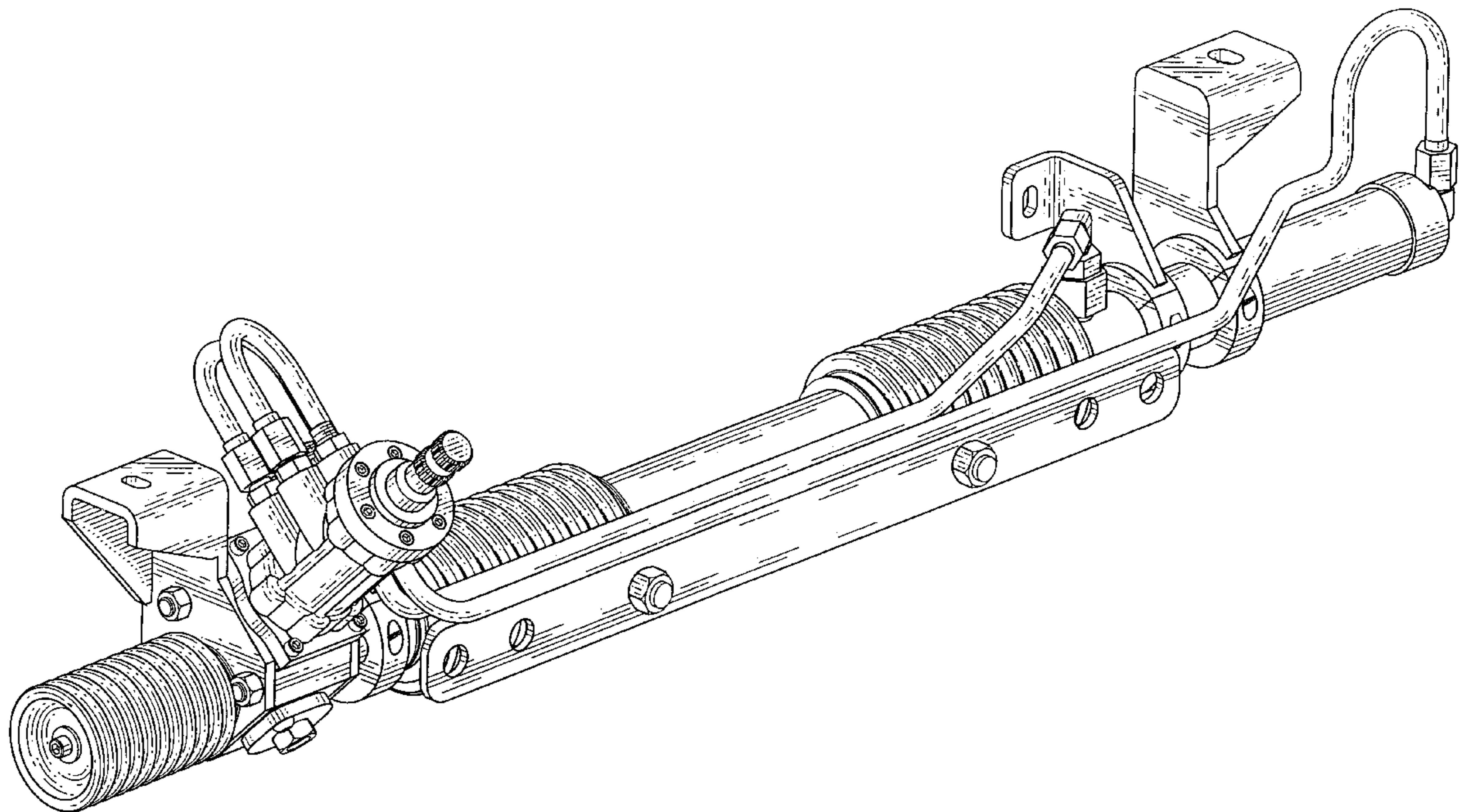

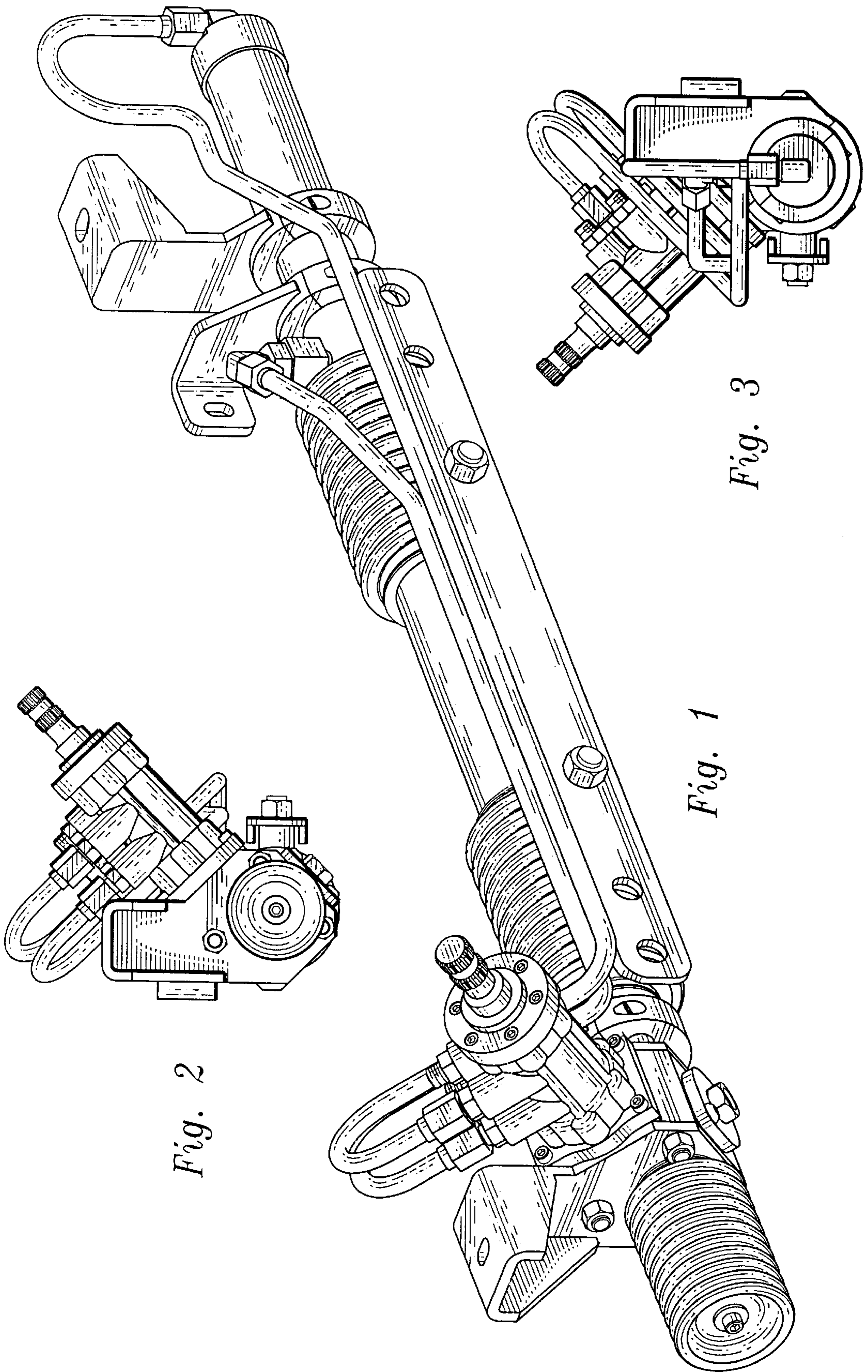
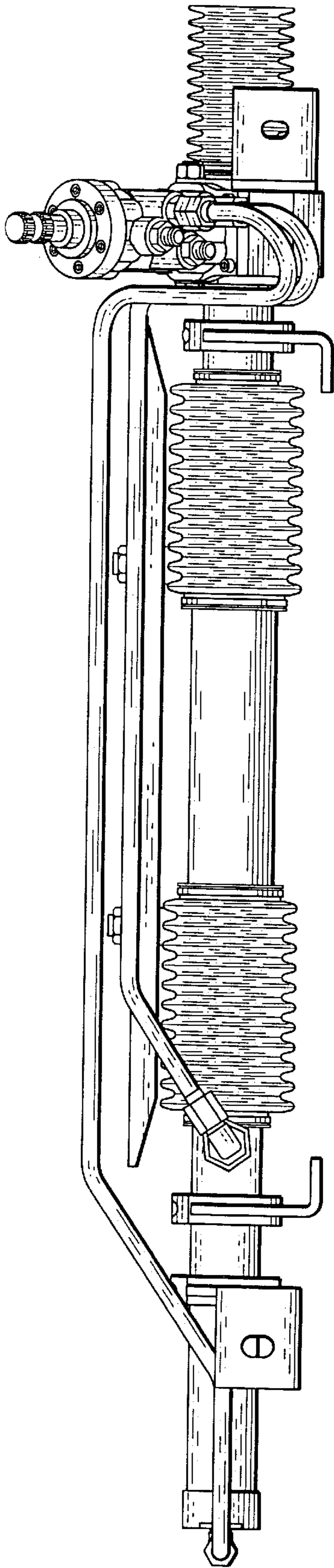

Fig. 2

Fig. 1

Fig. 3



*Fig. 4*

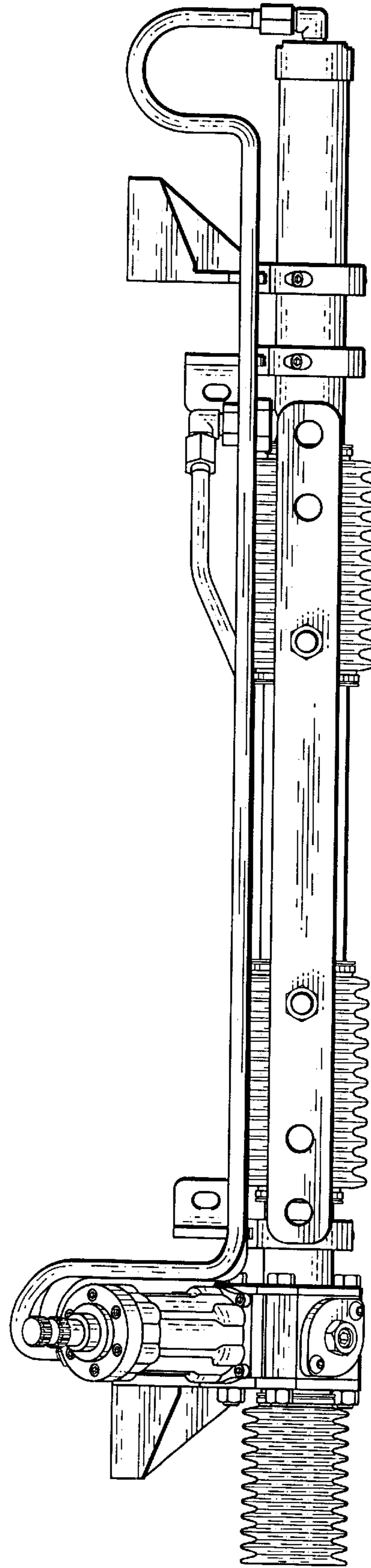

*Fig. 5*

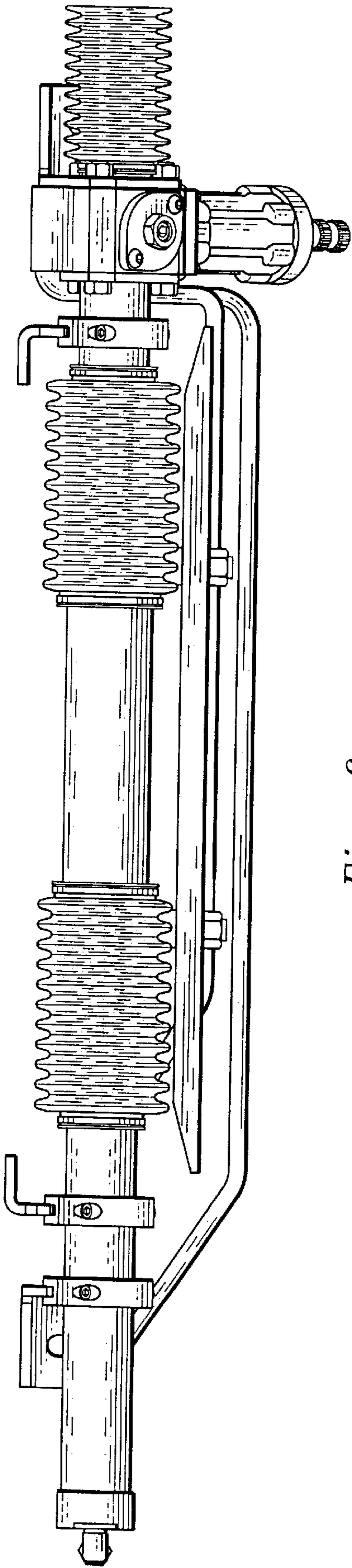

*Fig. 6*

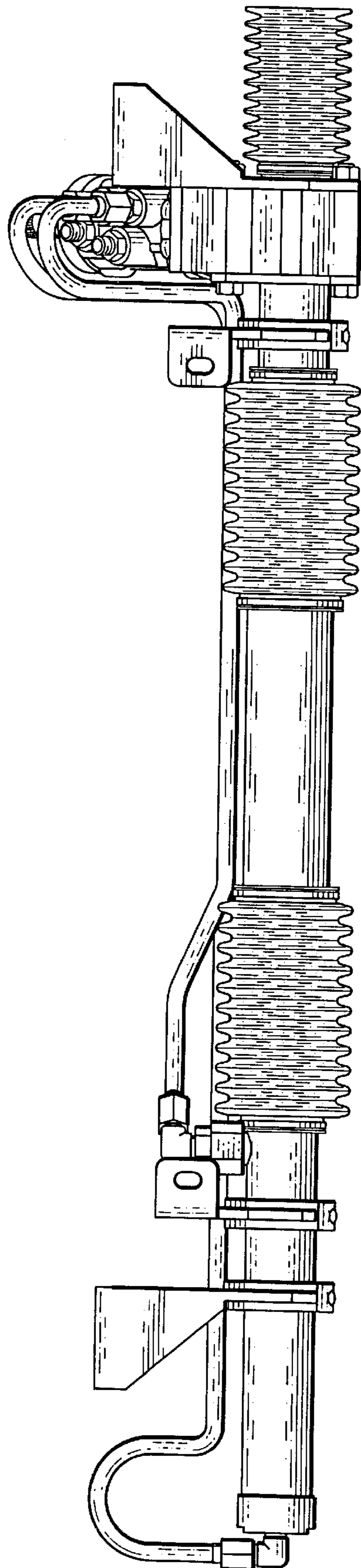

*Fig. 7*

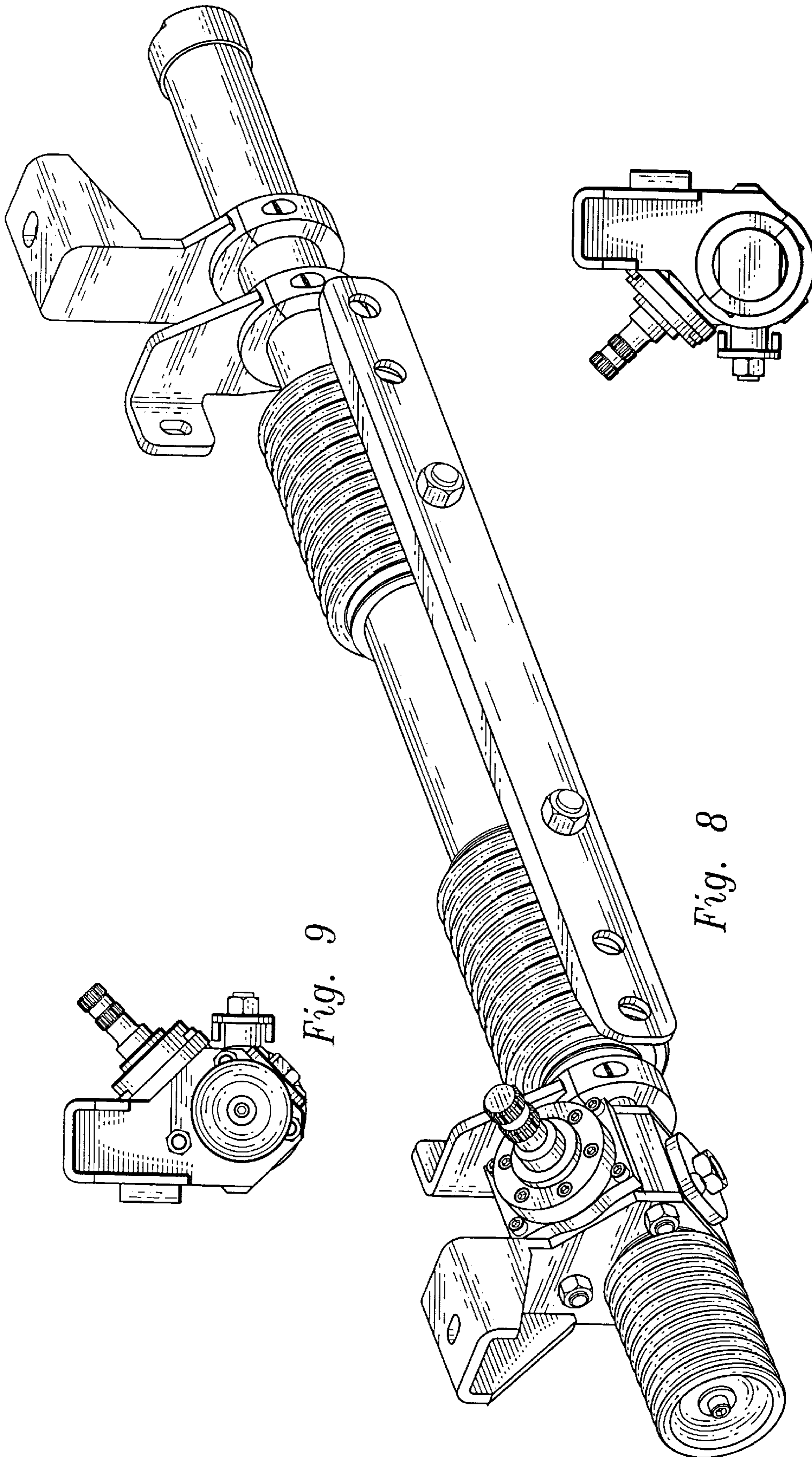

*Fig. 9*

*Fig. 8*

*Fig. 10*

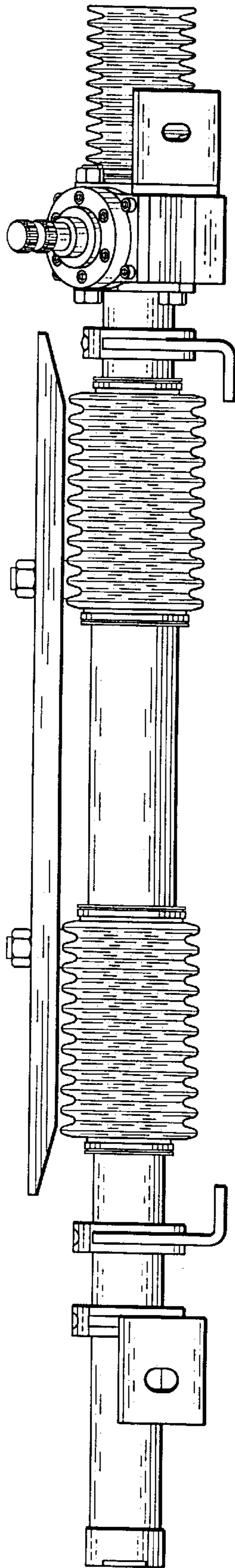

*Fig. 11*

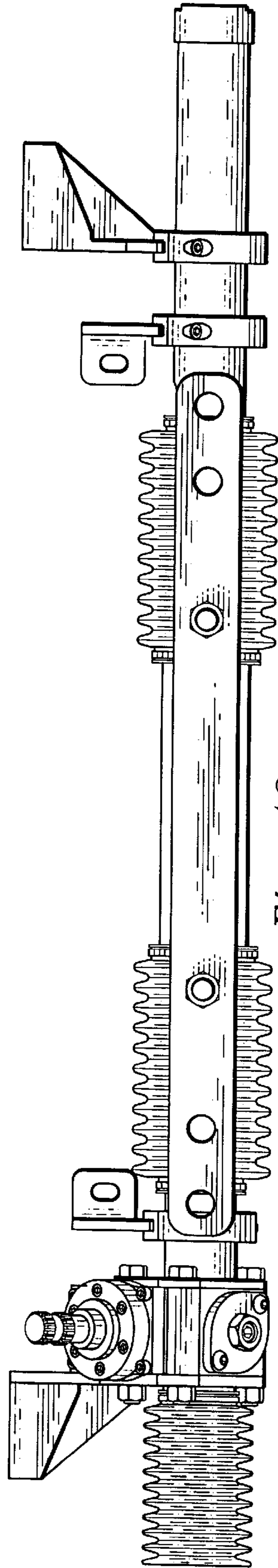

*Fig. 12*

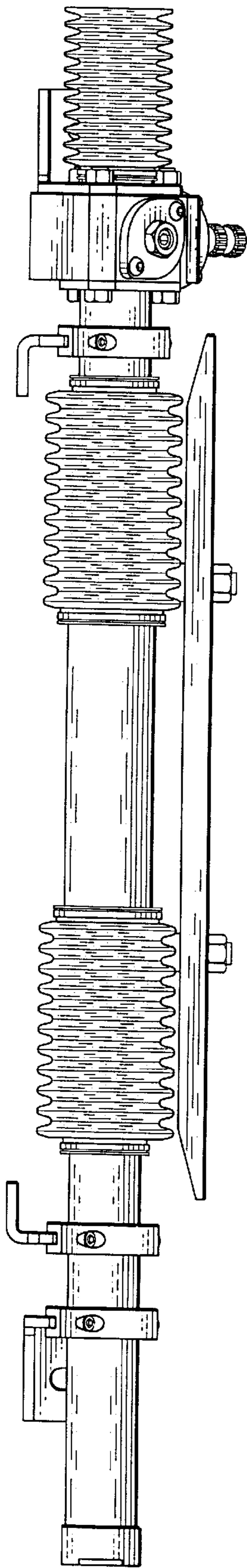

*Fig. 13*

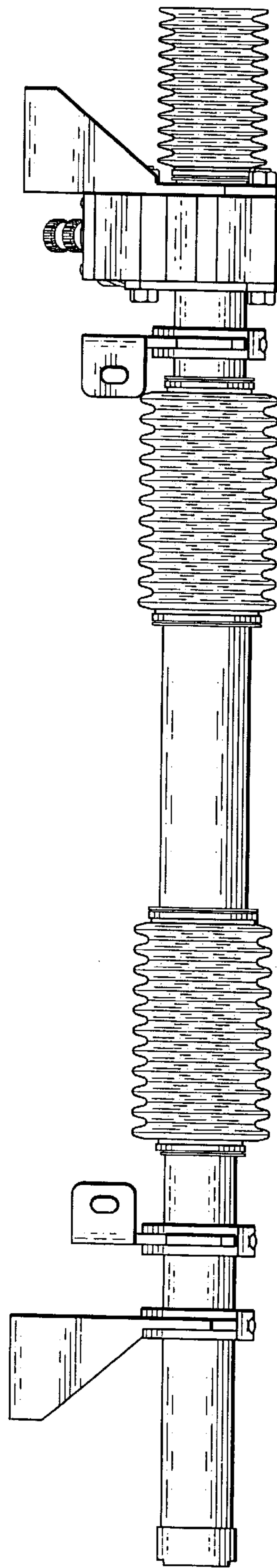

*Fig. 14*