



US00D439914S

(12) **United States Design Patent**  
**Trulaske, Sr.**

(10) **Patent No.: US D439,914 S**

(45) **Date of Patent: \*\* Apr. 3, 2001**

(54) **DOUBLE DOOR MERCHANDISER GRILL**

(75) **Inventor: Steven L. Trulaske, Sr., Ladue, MO (US)**

(73) **Assignee: True Manufacturing Co, Inc., O'Fallon, MO (US)**

(\*\*) **Term: 14 Years**

(21) **Appl. No.: 29/114,311**

(22) **Filed: Nov. 22, 1999**

**Related U.S. Application Data**

(62) **Division of application No. 29/086,259, filed on Apr. 9, 1998, now Pat. No. Des. 416,713.**

(51) **LOC (7) Cl. .... 15-07**

(52) **U.S. Cl. .... D15/89; D6/470**

(58) **Field of Search .... D6/470-472; D15/79, D15/81, 85, 88, 89; 312/116, 117, 236, 401, 407, 407.1**

(56) **References Cited**

**U.S. PATENT DOCUMENTS**

- D. 117,375 \* 10/1939 Knight ..... D15/89
- D. 164,829 \* 10/1951 Walter ..... D15/88
- D. 191,927 \* 12/1961 Trulaske ..... D15/85

- D. 334,201 \* 3/1993 Purkapile ..... D15/89
- D. 341,598 \* 11/1993 Purkapile ..... D15/89
- D. 363,398 \* 10/1995 Branz et al. .... D6/472
- D. 377,800 \* 2/1997 Branz et al. .... D15/85
- D. 379,467 \* 5/1997 Martin et al. .... D15/89
- D. 398,791 \* 9/1998 Brancheau et al. .... D6/470
- 4,932,224 \* 6/1990 Katterhenry et al. .... 62/440

\* cited by examiner

*Primary Examiner*—Sandra L. Morris

(74) *Attorney, Agent, or Firm*—Cohn, Powell & Hind

(57) **CLAIM**

I claim the ornamental design for a double door merchandiser grill, as shown and described.

**DESCRIPTION**

FIG. 1 is a perspective view of a for double door merchandiser grill front showing my new design;  
 FIG. 2 is a front elevational view of FIG. 1;  
 FIG. 3 is a top plan view of FIG. 1;  
 FIG. 4 is a left side elevational view of FIG. 1;  
 FIG. 5 is a right side elevational view of FIG. 1;  
 FIG. 6 is a rear elevational view of FIG. 1; and,  
 FIG. 7 is a bottom plan view of FIG. 1.

The broken line showing is for illustrative purposes only and forms no part of the design.

**1 Claim, 6 Drawing Sheets**

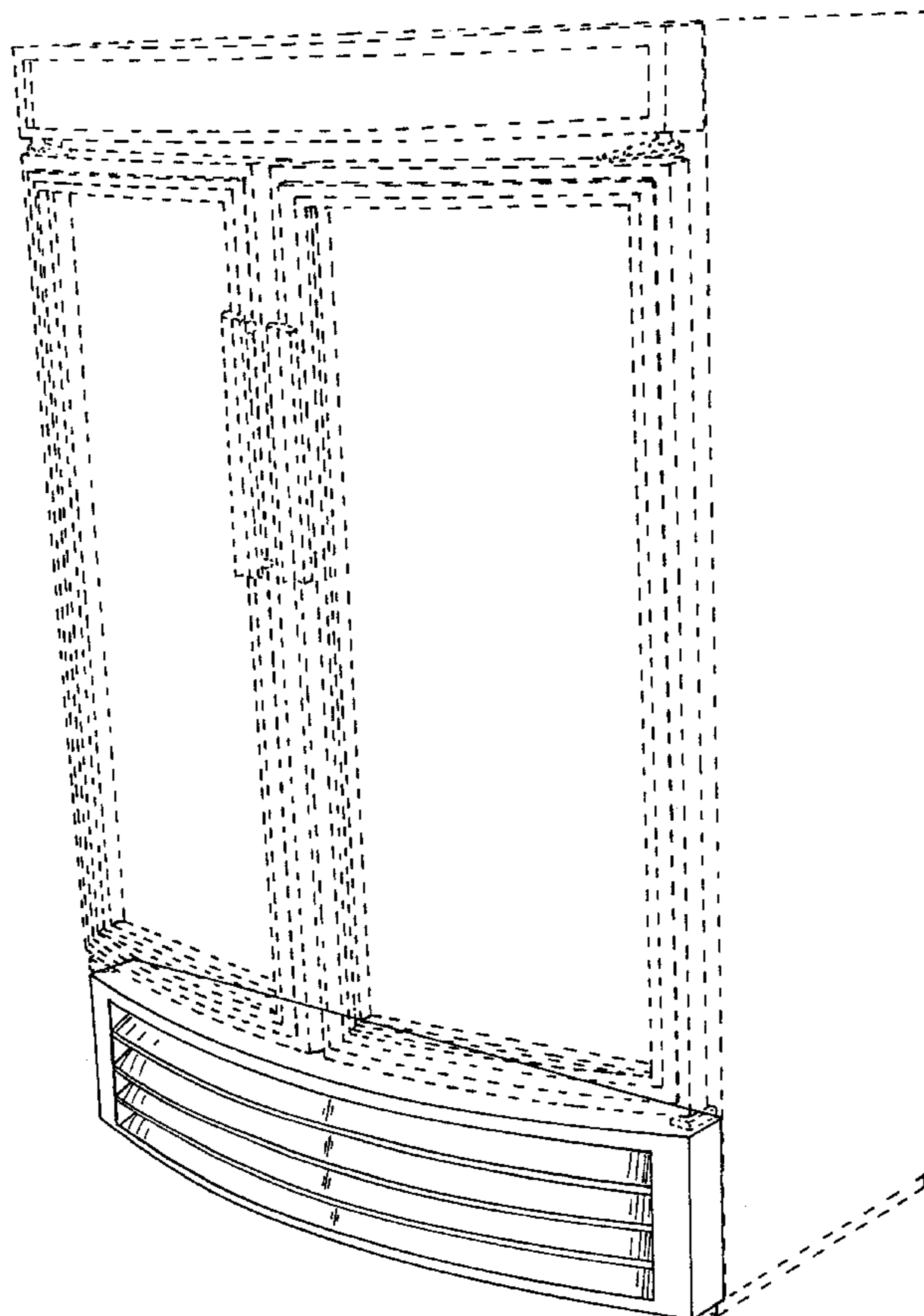

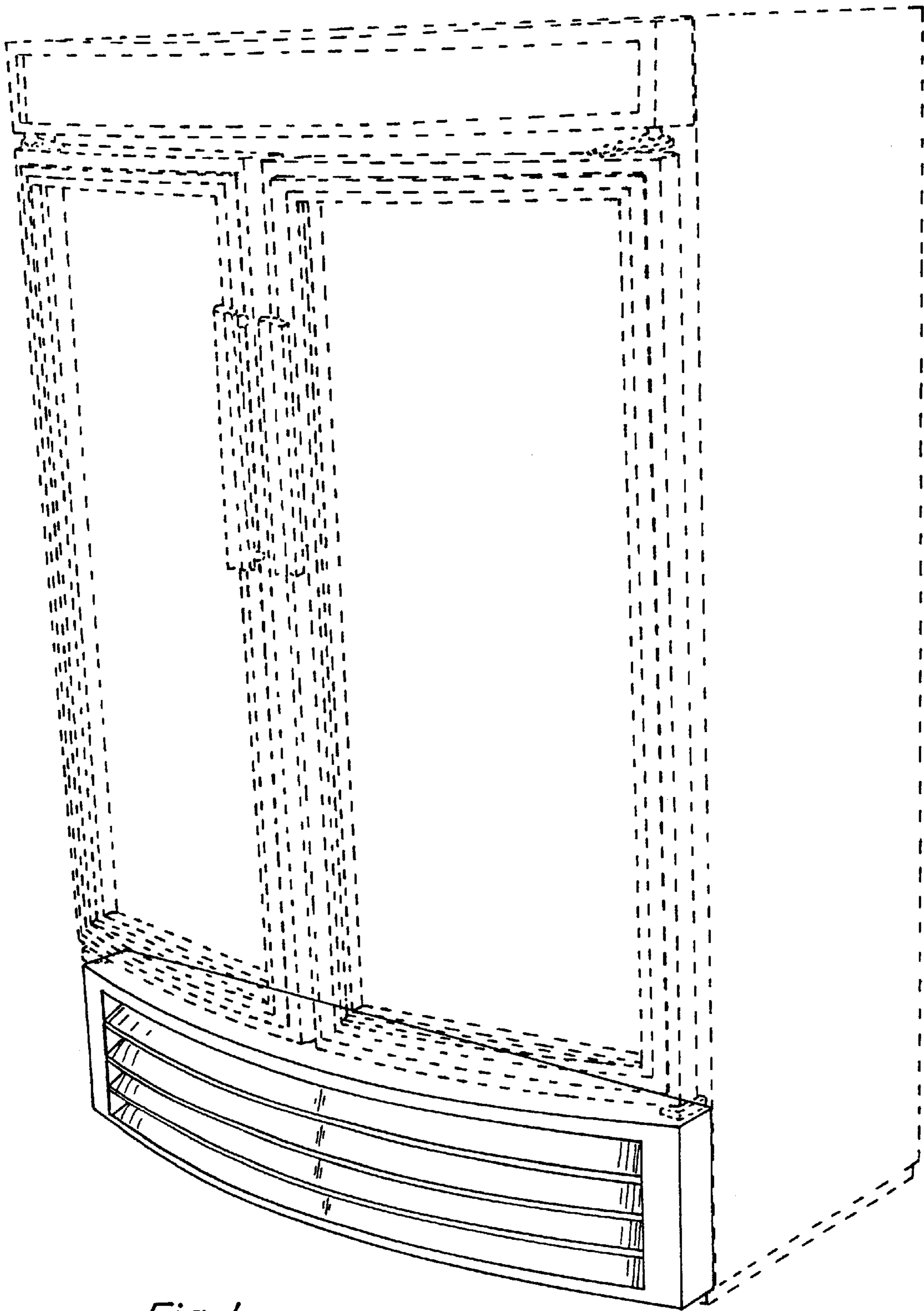

*Fig. 1*

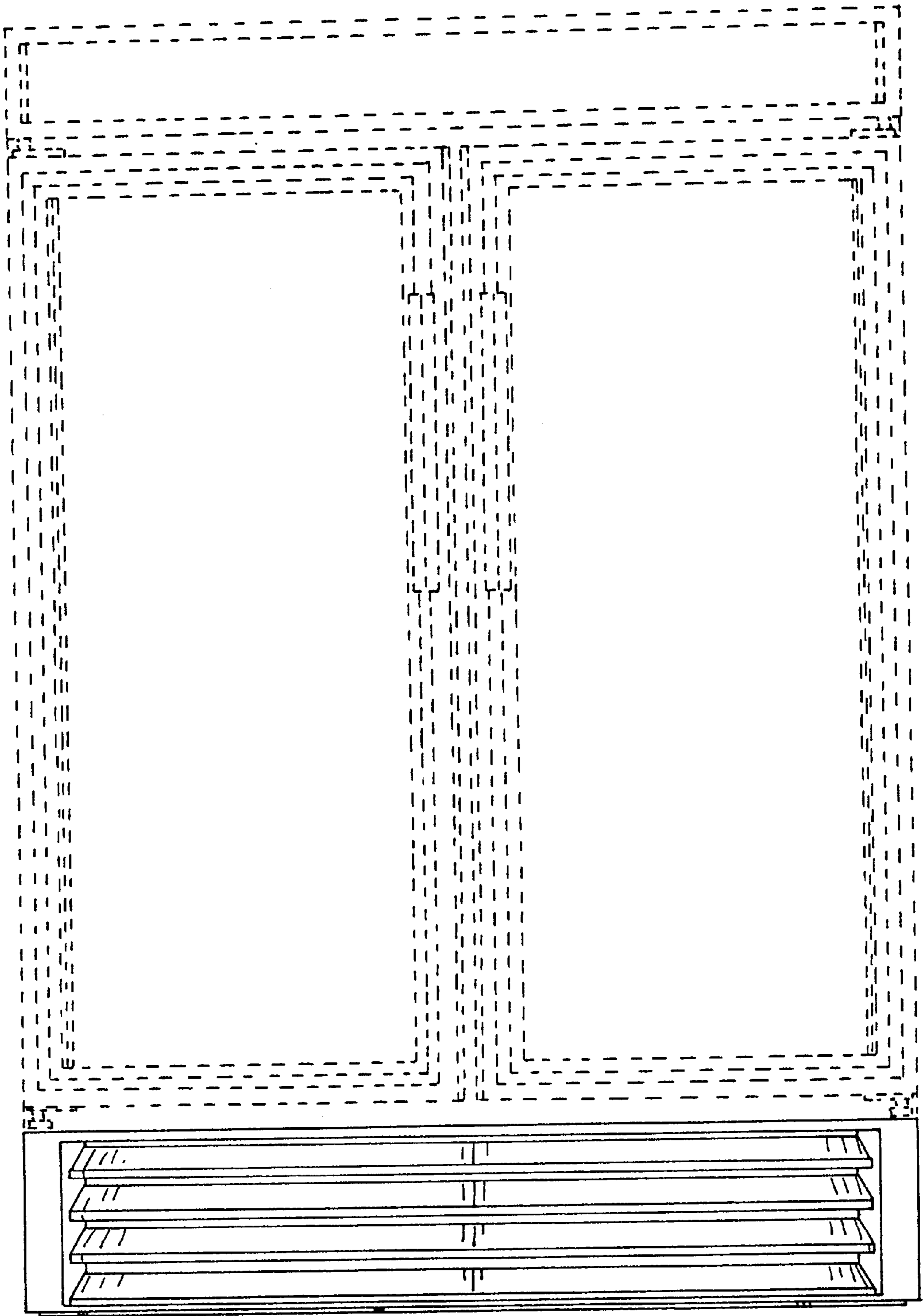
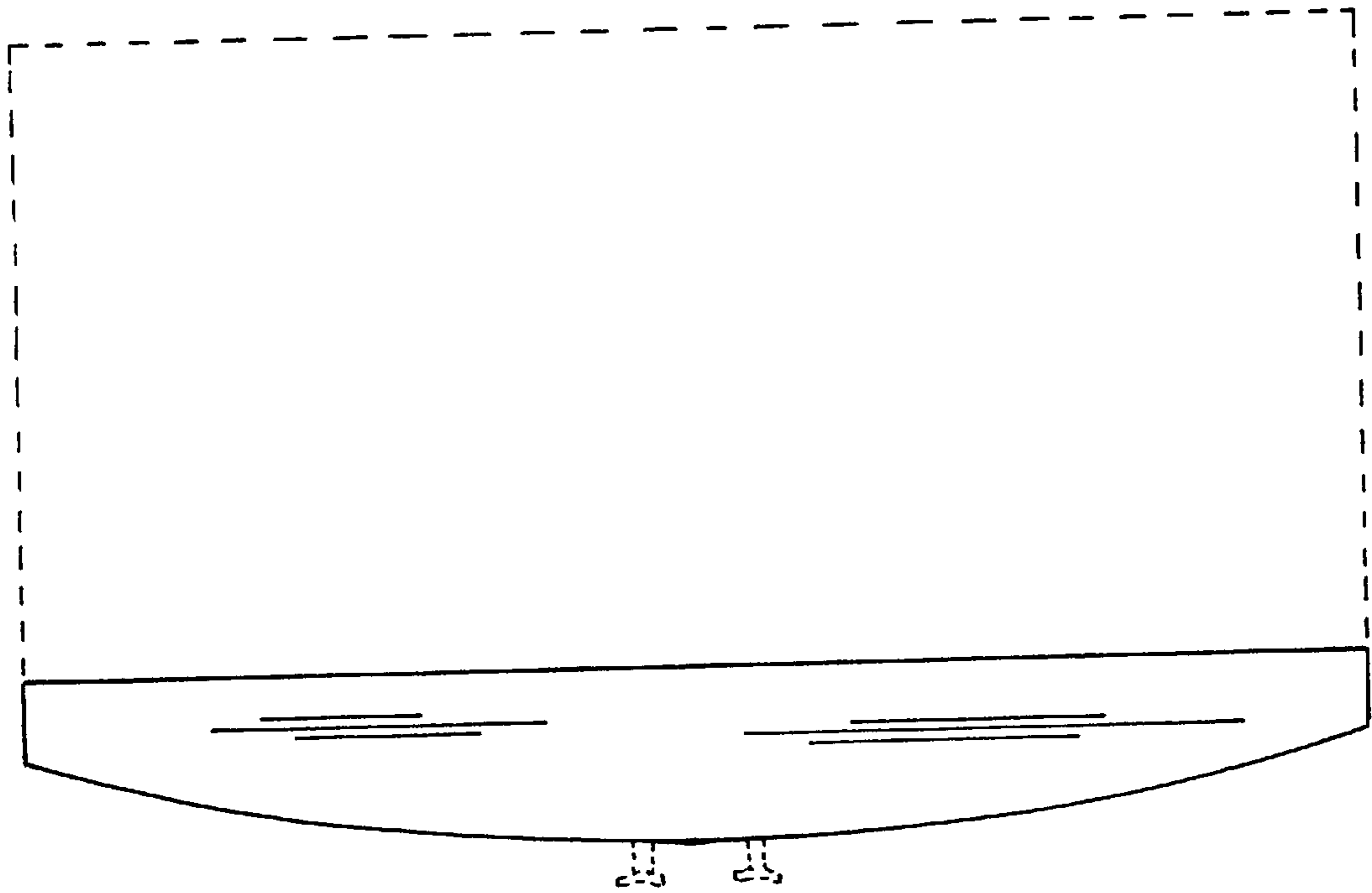
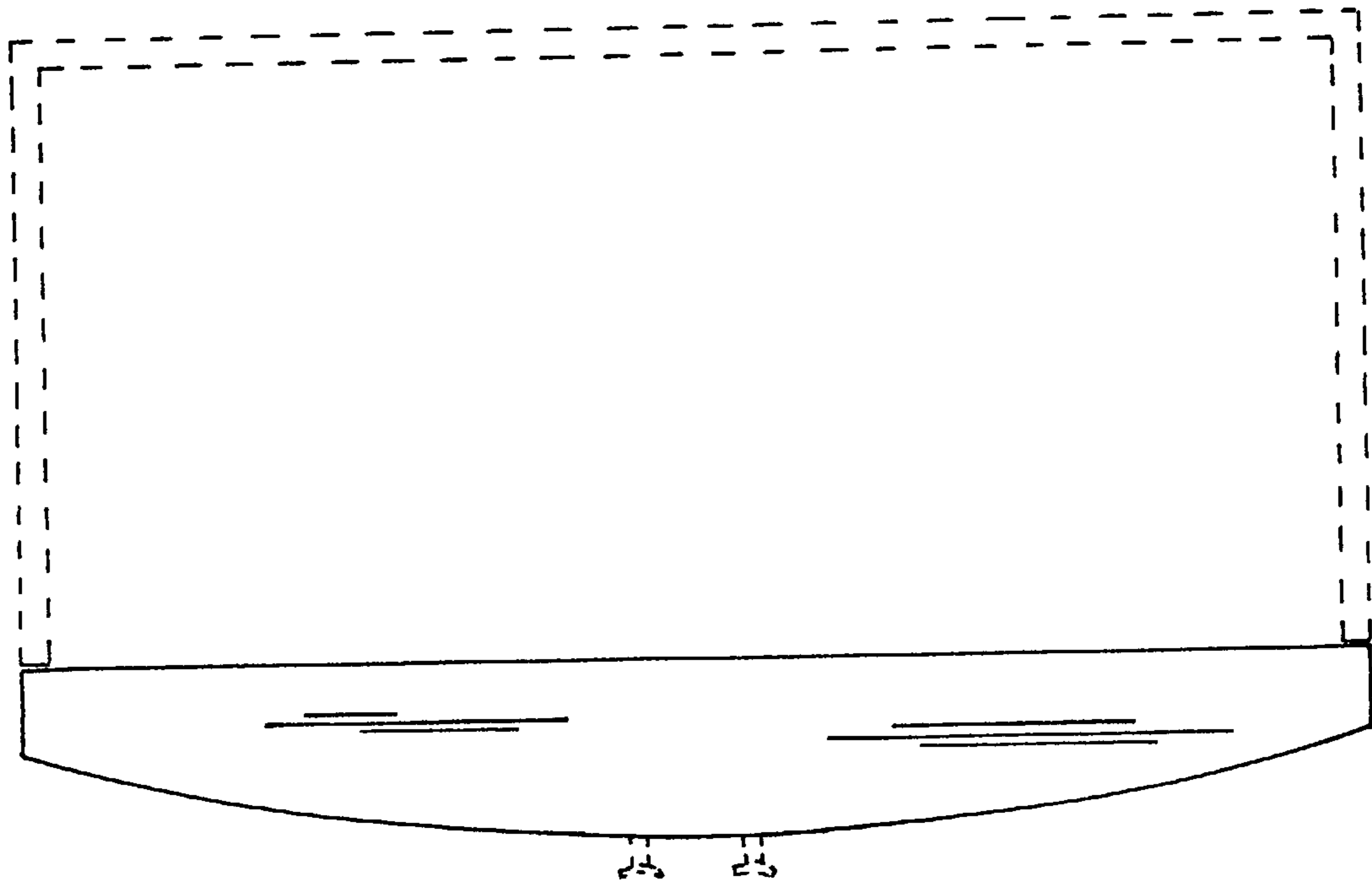

Fig. 2



*Fig. 3*



*Fig. 7*

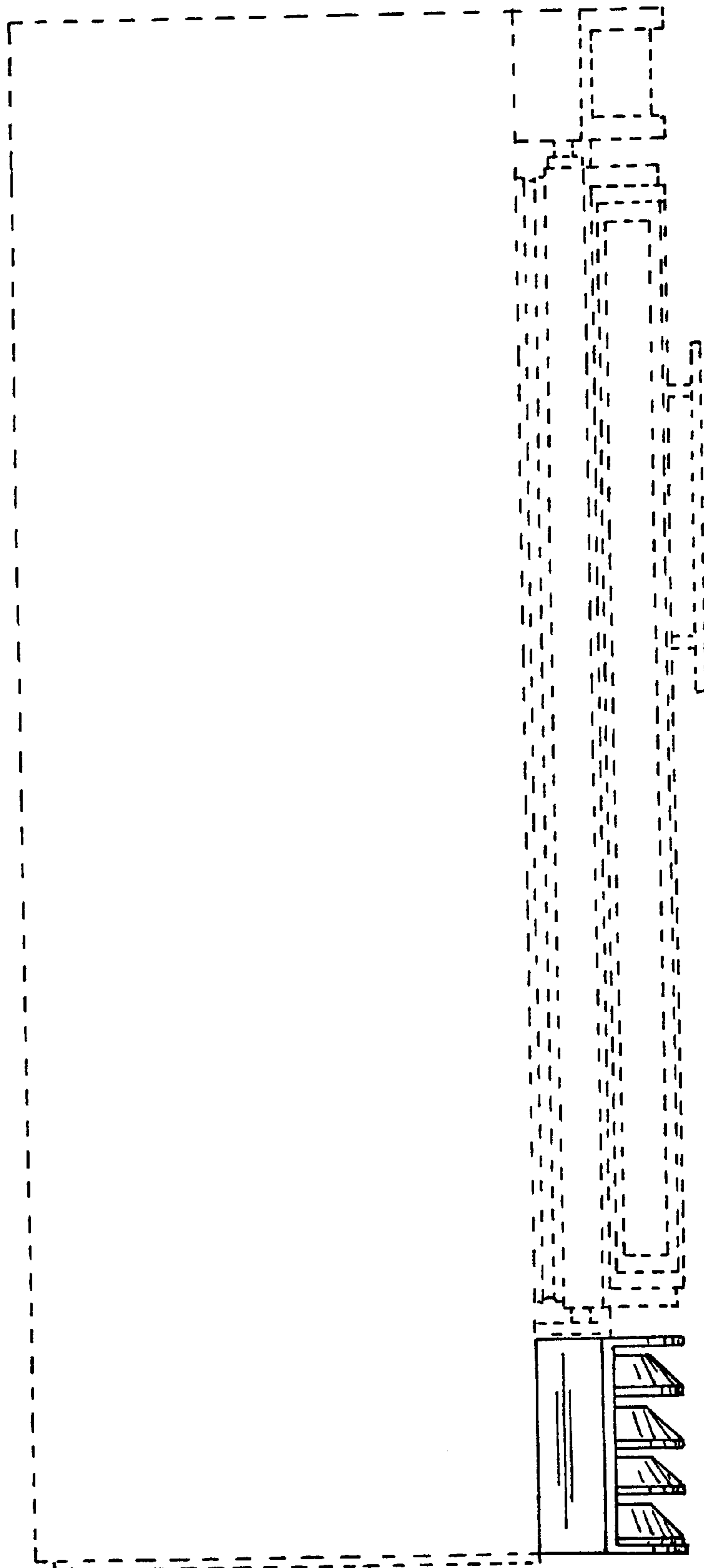

*Fig. 4*

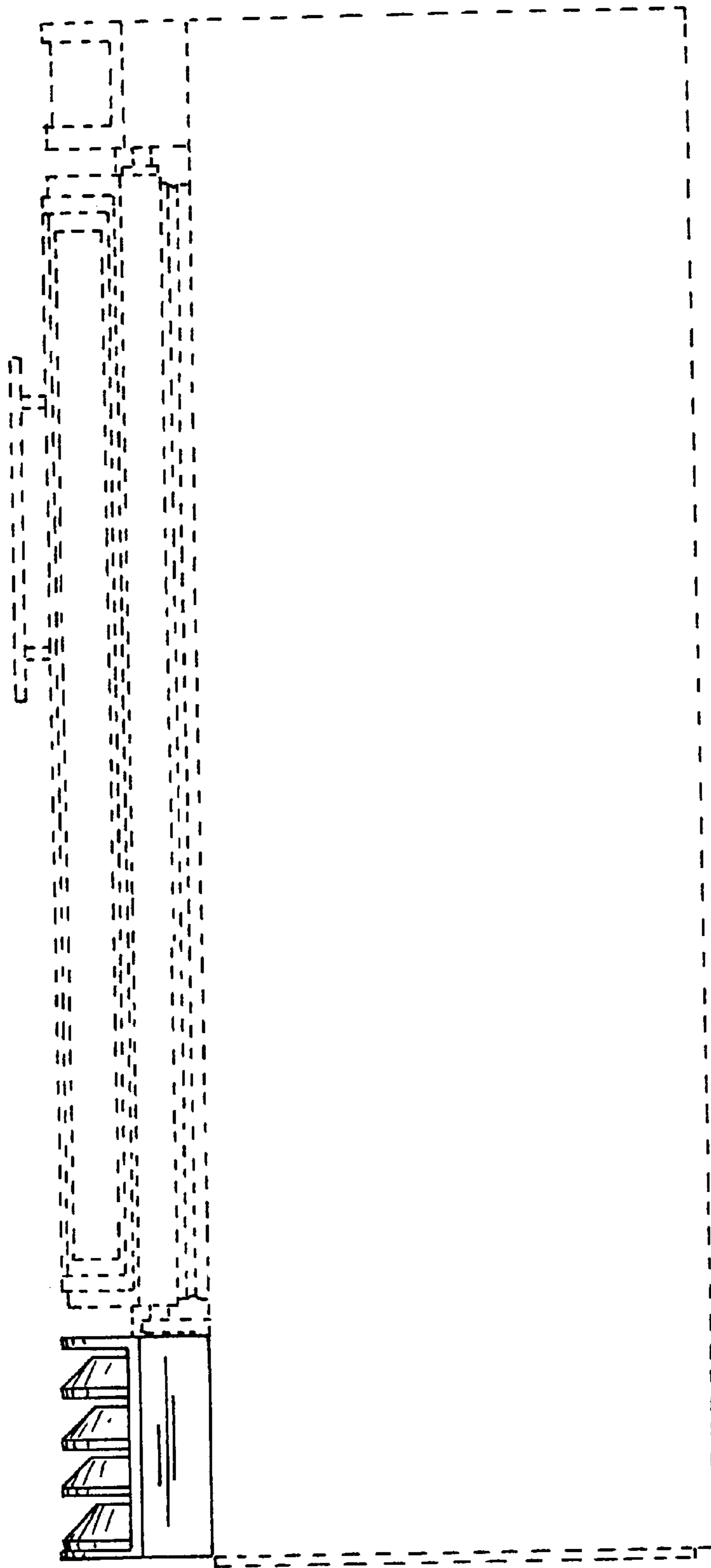

*Fig. 5*

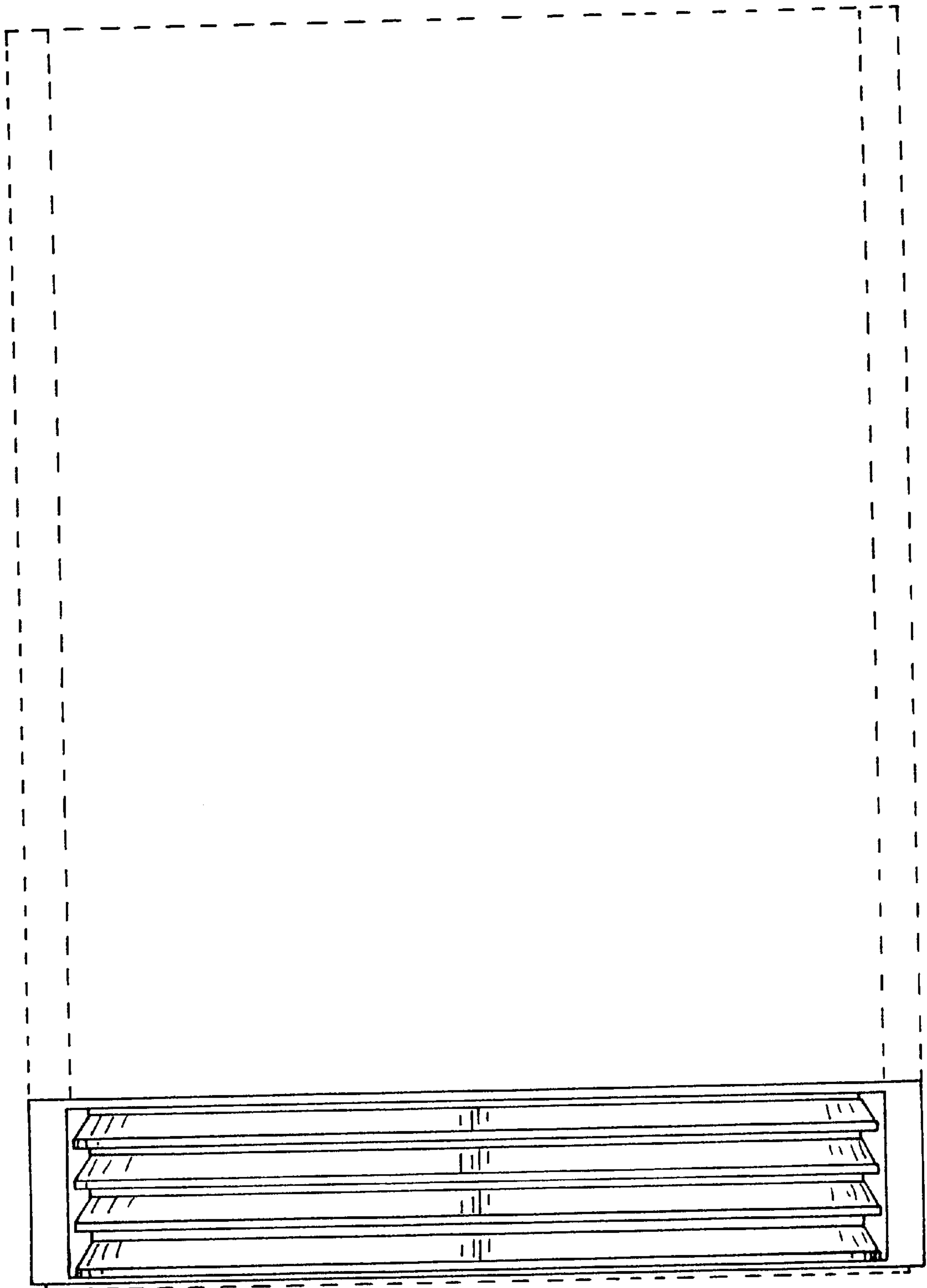

*Fig. 6*