



US00D439529S

(12) **United States Design Patent**
Versace

(10) **Patent No.:** **US D439,529 S**

(45) **Date of Patent:** **** Mar. 27, 2001**

(54) **WATCH**

(75) Inventor: **Donatella Versace**, Milan (IT)

(73) Assignee: **Gianni Versace SpA**, Milan (IT)

(**) Term: **14 Years**

(21) Appl. No.: **29/120,596**

(22) Filed: **Mar. 22, 2000**

(51) **LOC (7) Cl.** **10-02**

(52) **U.S. Cl.** **D10/32; D10/39**

(58) **Field of Search** **D10/1-40, 122-132;**
D11/3-25; 63/1.1, 3, 5, 11; 368/276-277,
280-282, 285

(56) **References Cited**

U.S. PATENT DOCUMENTS

D. 412,445 * 8/1999 Bodino D10/32
1,405,851 * 2/1922 Lewis .

OTHER PUBLICATIONS

Hong Kong Enterprise—Jan. 1984—p.175—watch # AQQ
808 nerar top.*

* cited by examiner

Primary Examiner—Nelson C. Holtje

(74) *Attorney, Agent, or Firm*—Eric Bleich

(57) **CLAIM**

I claim the ornamental design for the watch, as shown and described.

DESCRIPTION

FIG. 1 is a front perspective view of the new ornamental watch of the present invention.

FIG. 2 is a front view thereof.

FIG. 3 is a back view thereof.

FIG. 4 is a top view thereof.

FIG. 5 is a bottom view thereof.

FIG. 6 is a right side view thereof; and,

FIG. 7 is a left side view thereof.

1 Claim, 2 Drawing Sheets



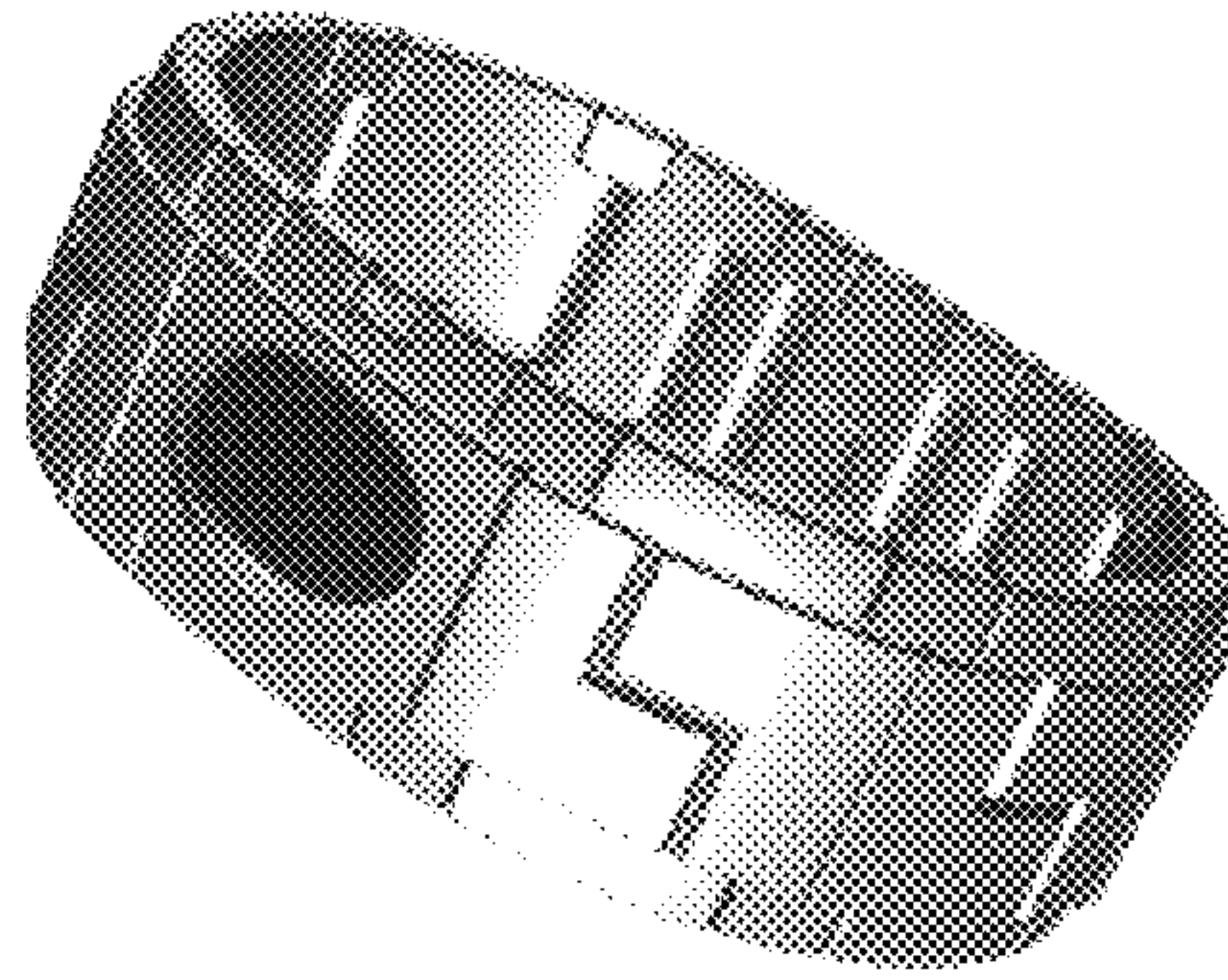

Fig. 1

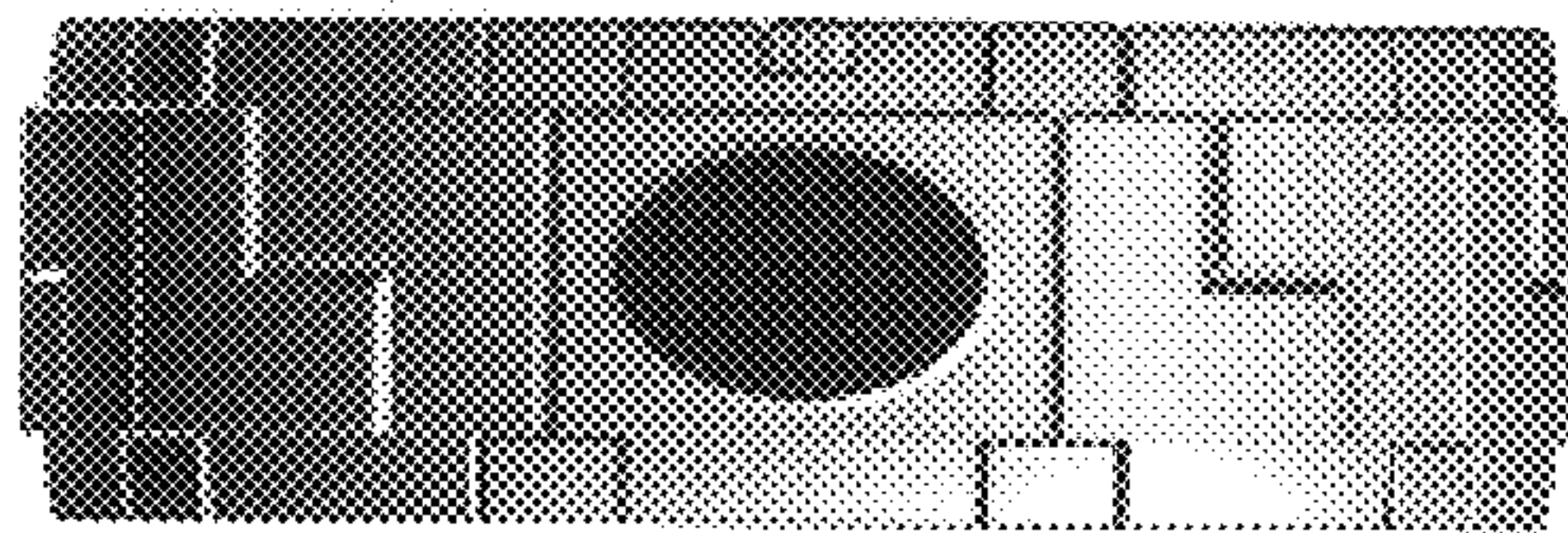

Fig. 2

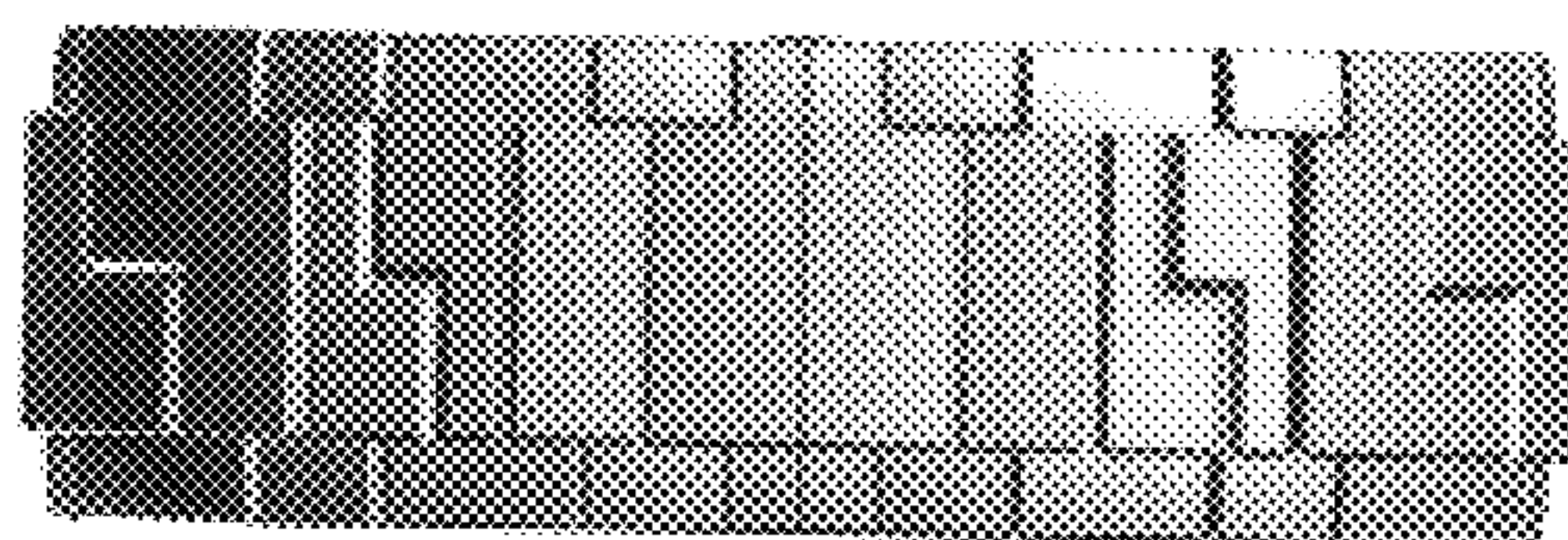

Fig. 3

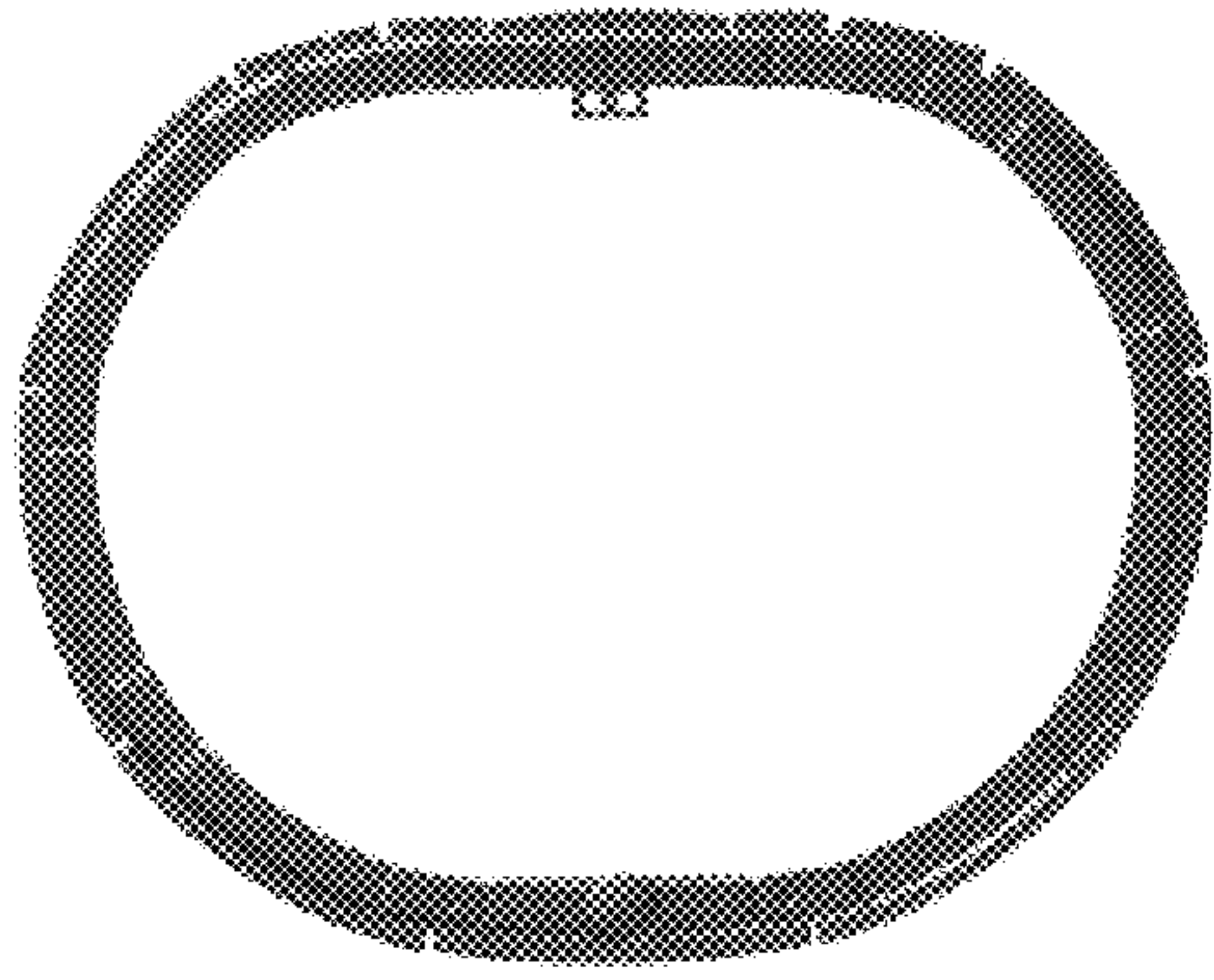

Fig. 4

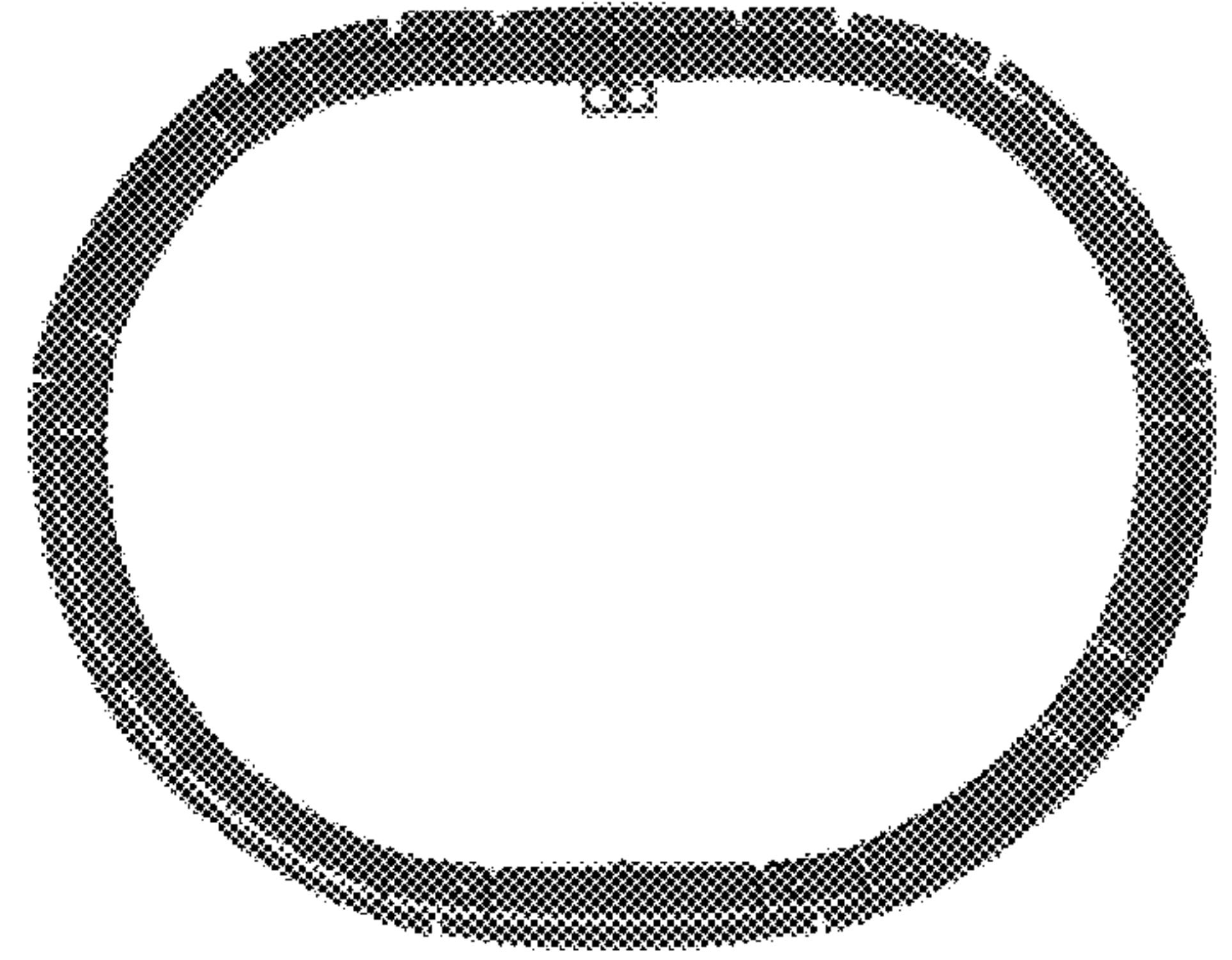

Fig. 5

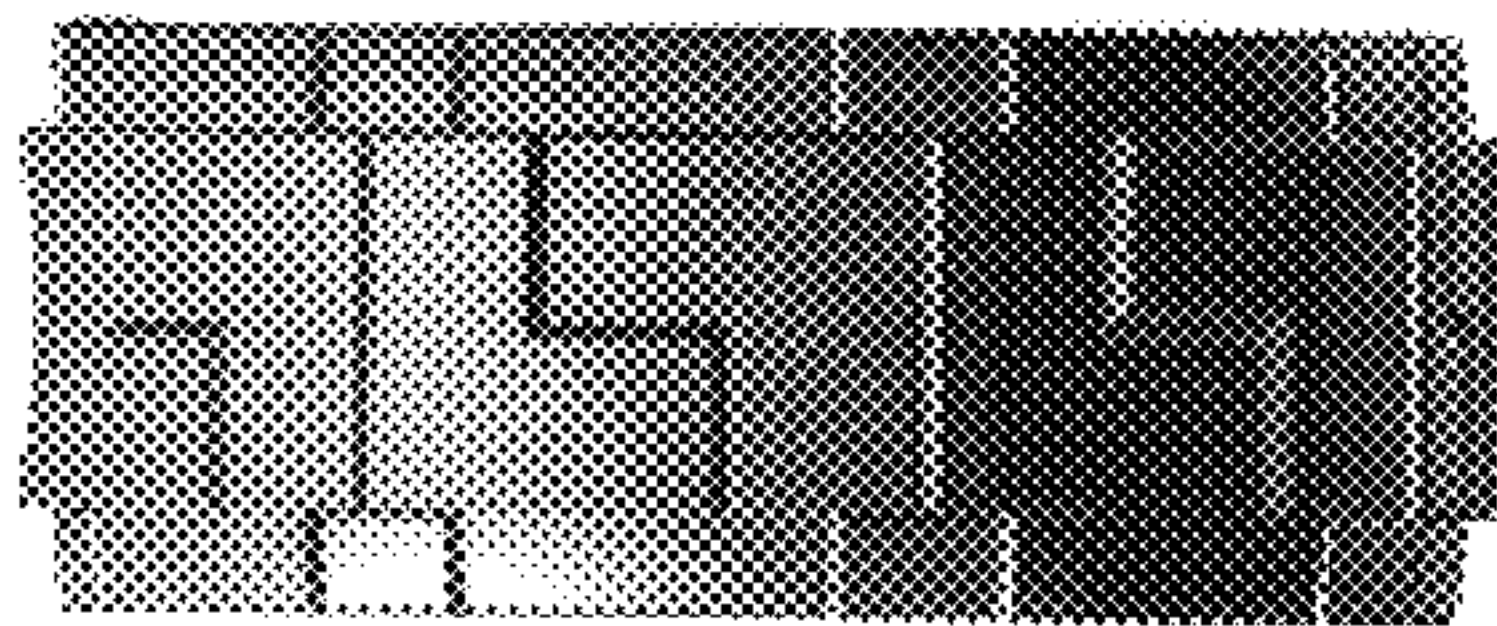

Fig. 6

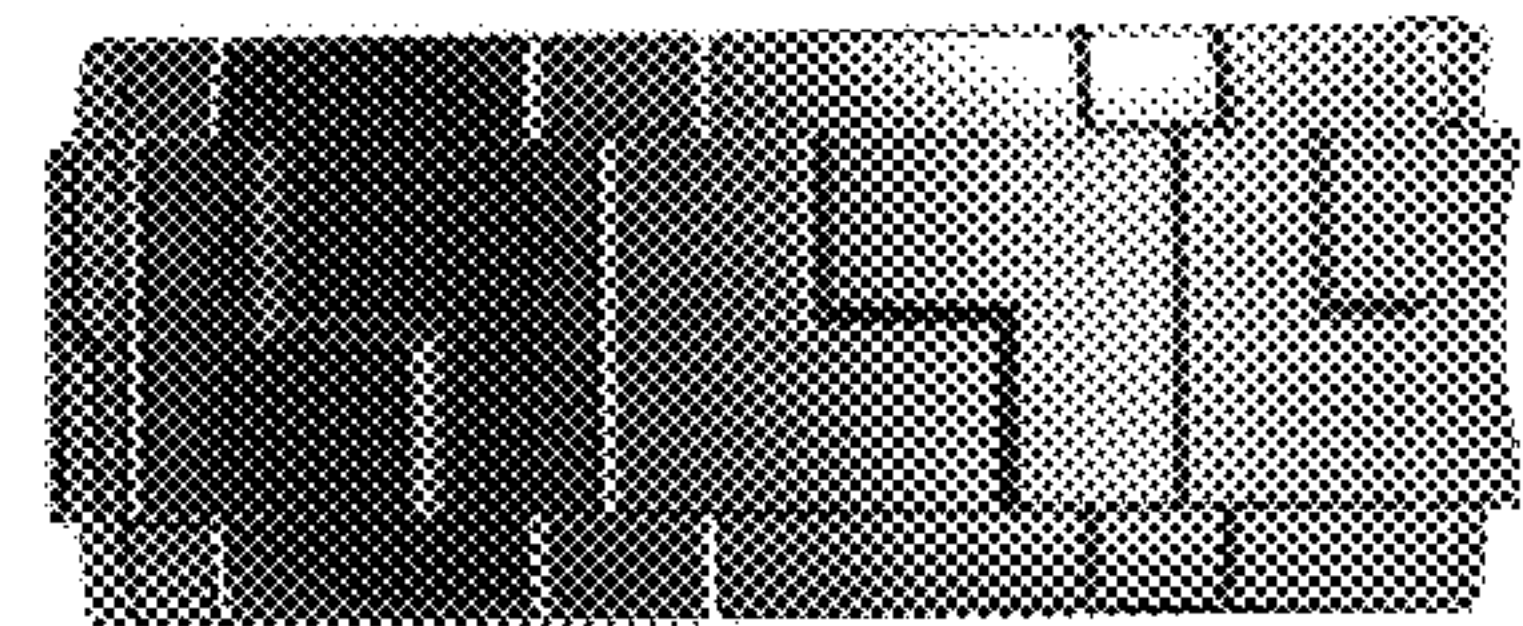

Fig. 7