



US00D439068S

(12) **United States Design Patent**  
**Vanderbyl**

(10) **Patent No.:** **US D439,068 S**

(45) **Date of Patent:** **\*\* Mar. 20, 2001**

(54) **SEAT**

(75) **Inventor:** **Michael J. Vanderbyl**, San Francisco, CA (US)

(73) **Assignee:** **McGuire Furniture Company**, San Francisco, CA (US)

(\*\*) **Term:** **14 Years**

(21) **Appl. No.:** **29/112,191**

(22) **Filed:** **Oct. 12, 1999**

(51) **LOC (7) Cl.** ..... **06-01**

(52) **U.S. Cl.** ..... **D6/379; D6/381**

(58) **Field of Search** ..... D6/334, 360, 369,  
D6/370, 374, 379, 380, 381, 500-502;  
297/232, 452.46

(56) **References Cited**

**U.S. PATENT DOCUMENTS**

|            |   |         |            |       |            |
|------------|---|---------|------------|-------|------------|
| D. 49,176  | * | 6/1916  | Cutler     | ..... | D6/379     |
| D. 93,967  | * | 12/1934 | Brower     | ..... | D6/379     |
| D. 174,592 | * | 4/1955  | Pettibone  | ..... | 297/452.46 |
| D. 177,072 | * | 3/1956  | Smilow     | ..... | D6/379     |
| D. 211,171 | * | 5/1968  | Blier      | ..... | D6/379     |
| D. 211,869 | * | 8/1968  | Doner      | ..... | D6/379     |
| D. 274,295 | * | 6/1984  | Saiger     | ..... | D6/379     |
| D. 287,672 | * | 1/1987  | Holl       | ..... | D6/370     |
| D. 331,518 | * | 12/1992 | Grosfillex | ..... | D6/379     |
| D. 338,115 | * | 8/1993  | Grosfillex | ..... | D6/379     |
| D. 341,728 | * | 11/1993 | Grosfillex | ..... | D6/379     |
| D. 345,869 | * | 4/1994  | Grosfillex | ..... | D6/381     |
| D. 358,041 | * | 5/1995  | Watts      | ..... | D6/379     |
| D. 366,774 | * | 2/1996  | Frnier     | ..... | D6/379     |
| D. 380,105 |   | 6/1997  | Diaz-Azcuy | .     |            |
| D. 386,912 |   | 12/1997 | Diaz-Azcuy | .     |            |
| D. 390,031 |   | 2/1998  | Diaz-Azcuy | .     |            |

(List continued on next page.)

**OTHER PUBLICATIONS**

“Hugonet Paris for JANUS et Cie”, from JANUS et Cie catalog, 11 pages (Date Unknown).

*Primary Examiner*—Doris V. Coles

*Assistant Examiner*—Mimosa De

(74) *Attorney, Agent, or Firm*—Merchant & Gould P.C.

(57) **CLAIM**

The ornamental design for seat, as shown and described.

**DESCRIPTION**

FIG. 1 is a perspective view taken from the top, front and left side of a seat embodying my new design in the form of a chair;

FIG. 2 is a front elevational view thereof;

FIG. 3 is a rear elevational view thereof;

FIG. 4 is a left side elevational view thereof, the right side elevational view being the mirror image thereof;

FIG. 5 is a top plan view thereof;

FIG. 6 is a bottom plan view thereof;

FIG. 7 is a perspective view taken from the top, front and left side of a second embodiment of my new design in the form of a chair wherein the difference is substantially a matter of length.

FIG. 8 is a front elevational view thereof;

FIG. 9 is a rear elevational view thereof;

FIG. 10 is a left side elevational view thereof, the right side elevational view being the mirror image thereof;

FIG. 11 is a top plan view thereof; and

FIG. 12 is a bottom plan view thereof

FIG. 13 is a perspective view taken from the top, front and left side of a third embodiment of my new design in the form of a sofa wherein the difference is substantially a matter of length and an additional support member.

FIG. 14 is a front elevational view thereof;

FIG. 15 is a rear elevational view thereof;

FIG. 16 is a left side elevational view thereof, the right side elevational view being the mirror image thereof;

FIG. 17 is a top plan view thereof; and,

FIG. 18 is a bottom plan view thereof.

**1 Claim, 18 Drawing Sheets**

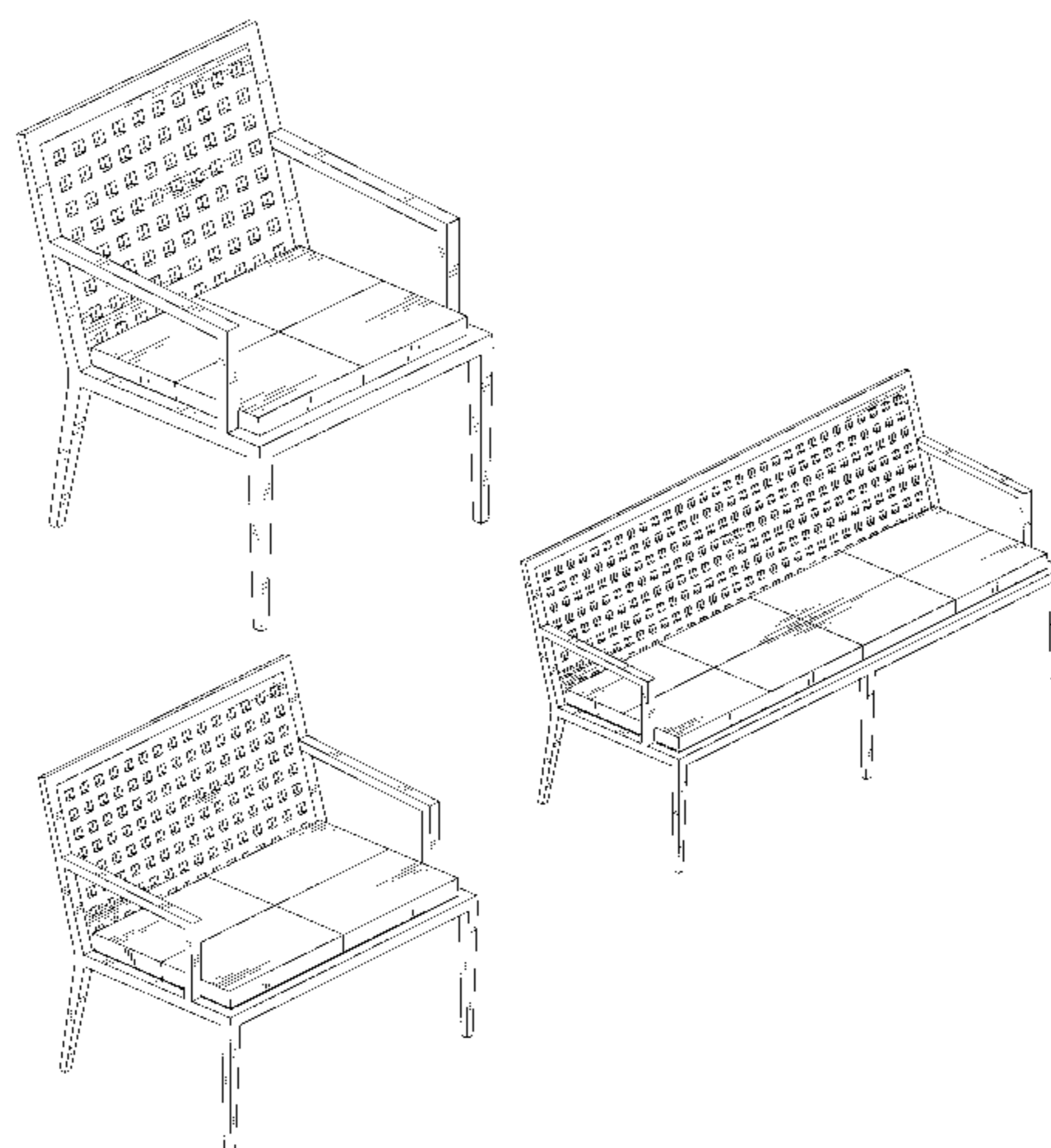

# US D439,068 S

Page 2

---

## U.S. PATENT DOCUMENTS

|            |   |        |              |       |        |            |   |         |             |       |            |
|------------|---|--------|--------------|-------|--------|------------|---|---------|-------------|-------|------------|
| D. 396,365 | * | 7/1998 | Lizell       | ..... | D6/370 | D. 421,851 | * | 3/2000  | Tihany      | ..... | D6/369     |
| D. 410,344 | * | 6/1999 | Lewis et al. | ..... | D6/381 | D. 422,156 | * | 4/2000  | Black       | ..... | D6/381     |
| D. 418,687 | * | 1/2000 | Tihany       | ..... | D6/369 | D. 425,718 | * | 5/2000  | Van Valeren | ..... | D6/670     |
| D. 420,825 | * | 2/2000 | Lin          | ..... | D6/370 | 5,454,623  | * | 10/1995 | Parks       | ..... | 297/452.46 |

\* cited by examiner

FIG. 1

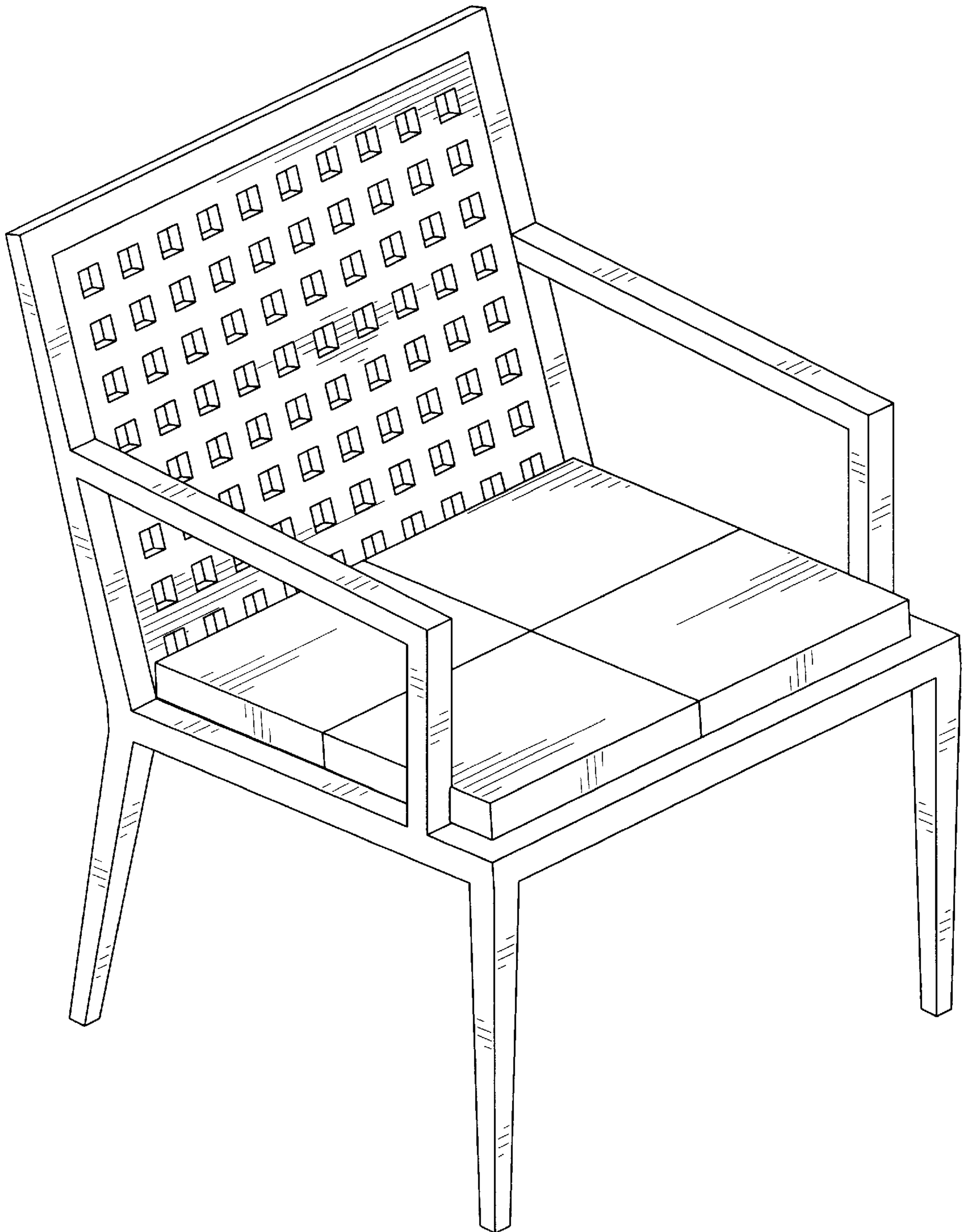

FIG. 2

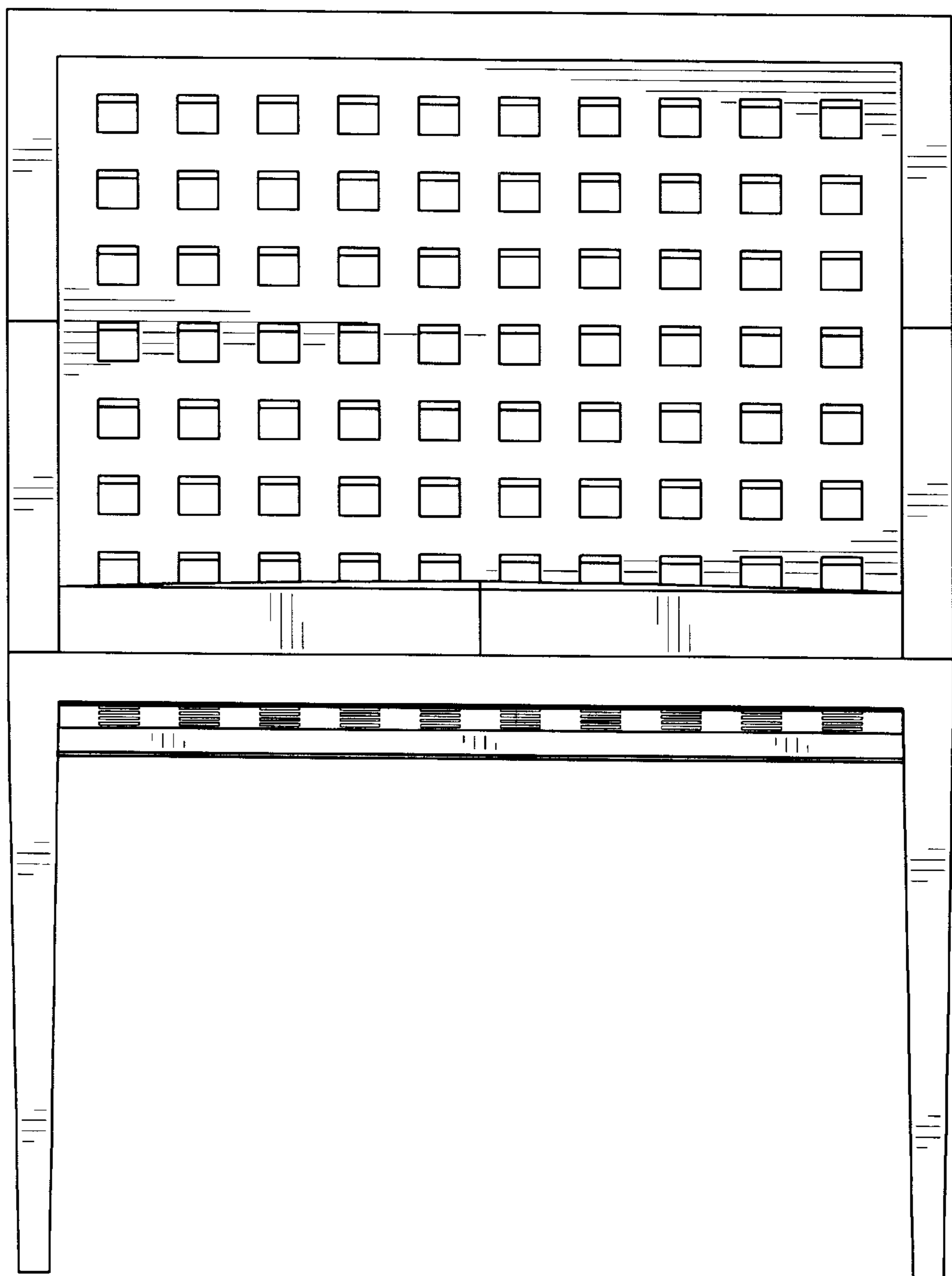

FIG. 3

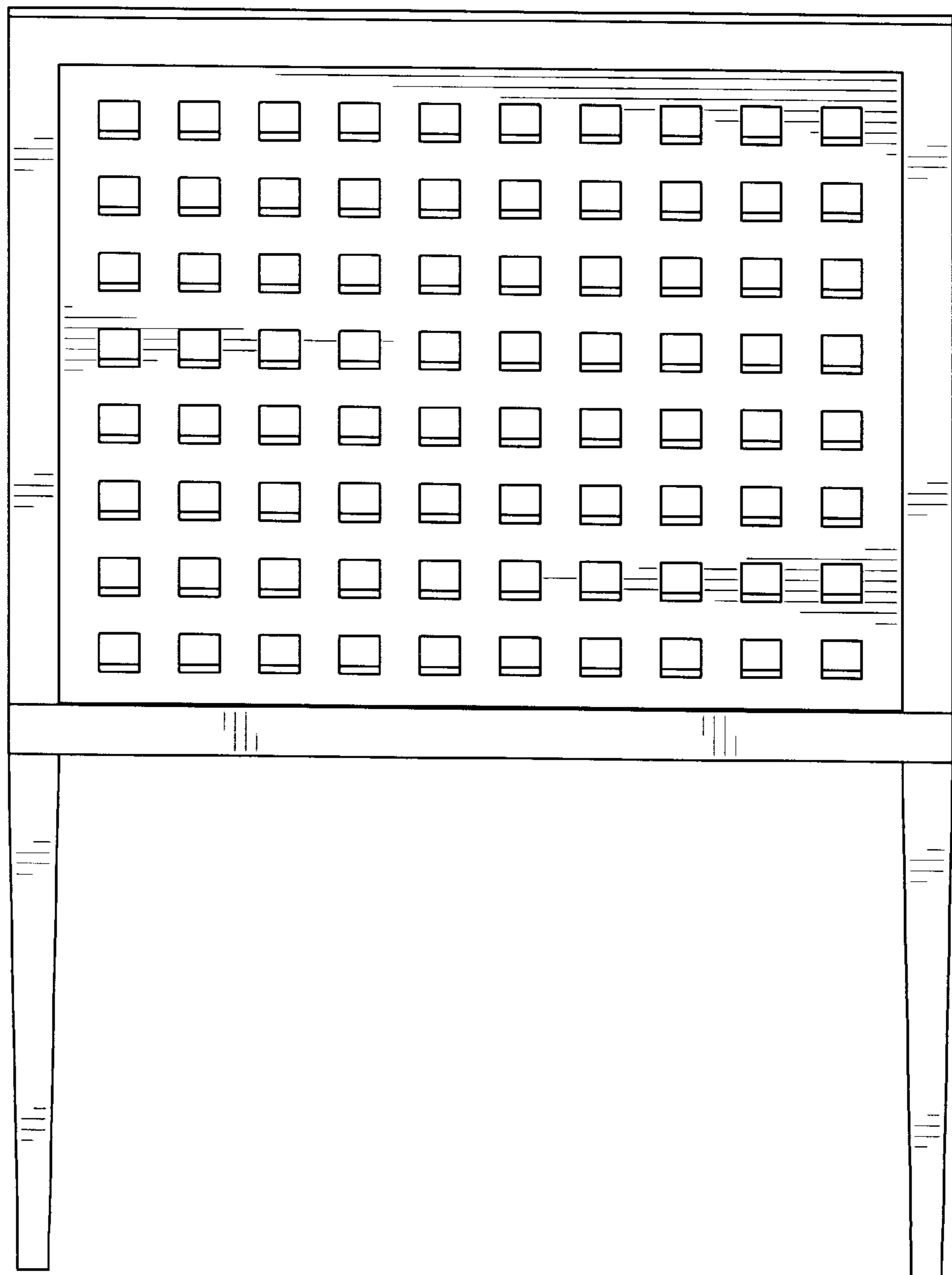

FIG. 4

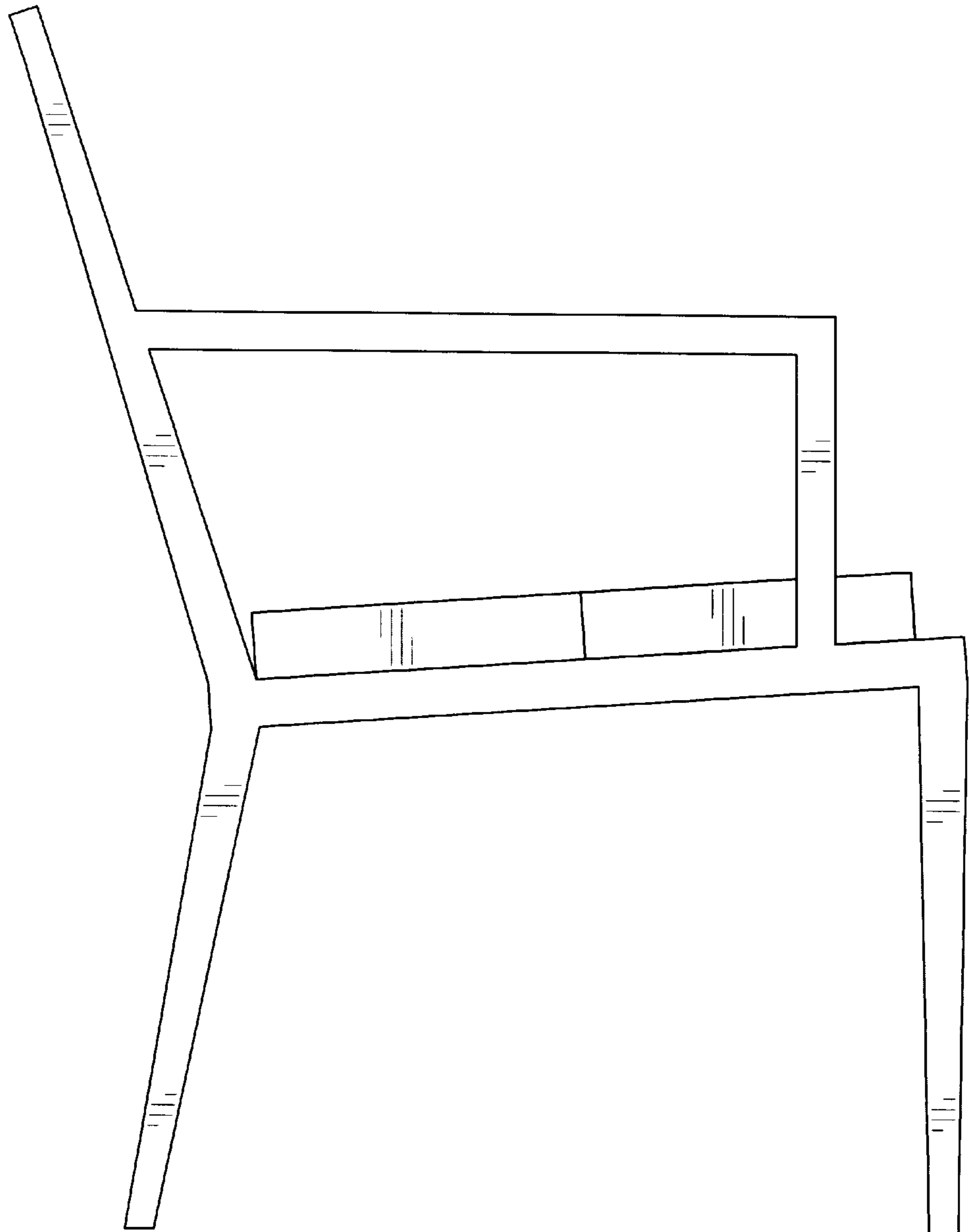

FIG. 5

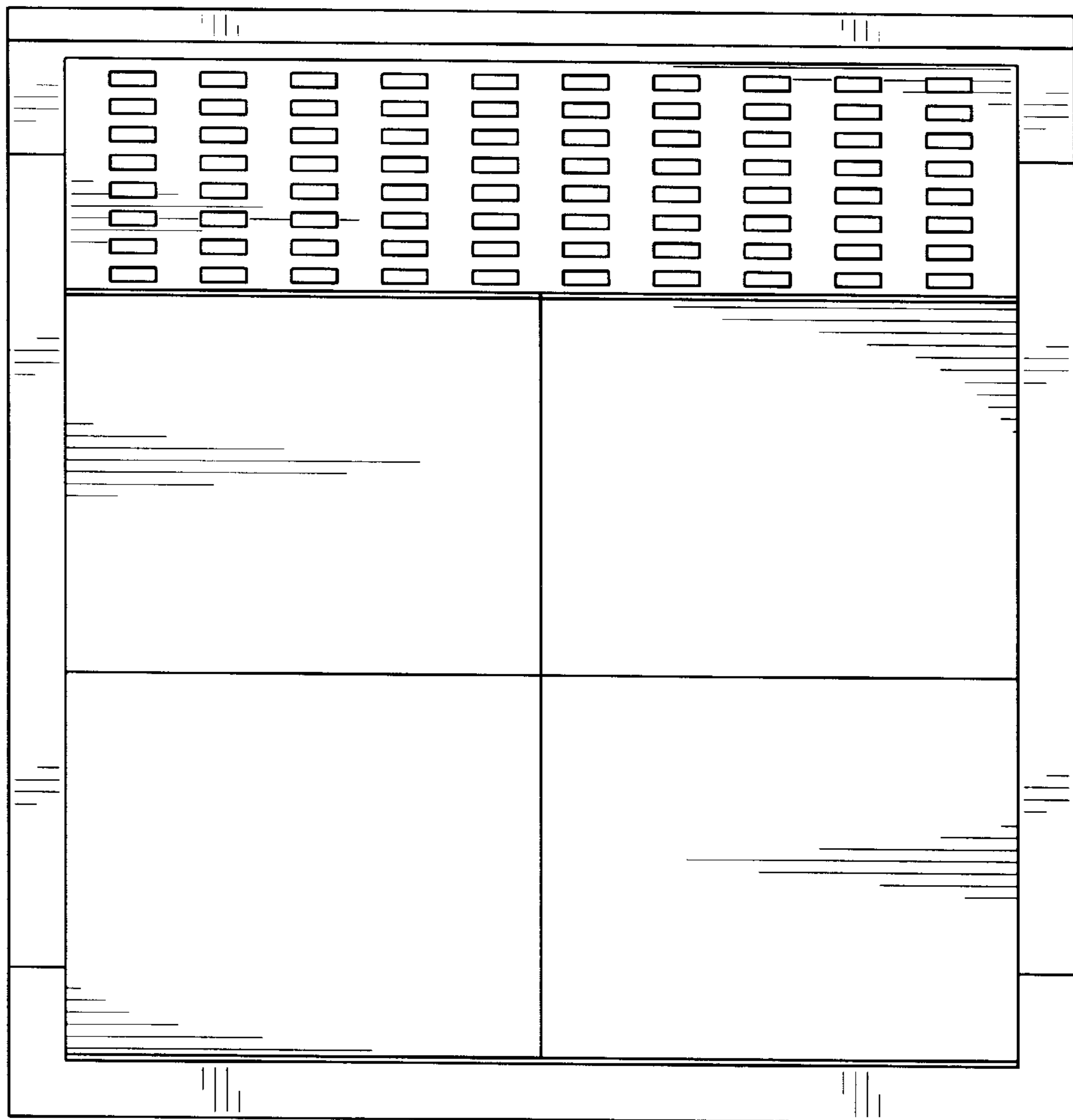
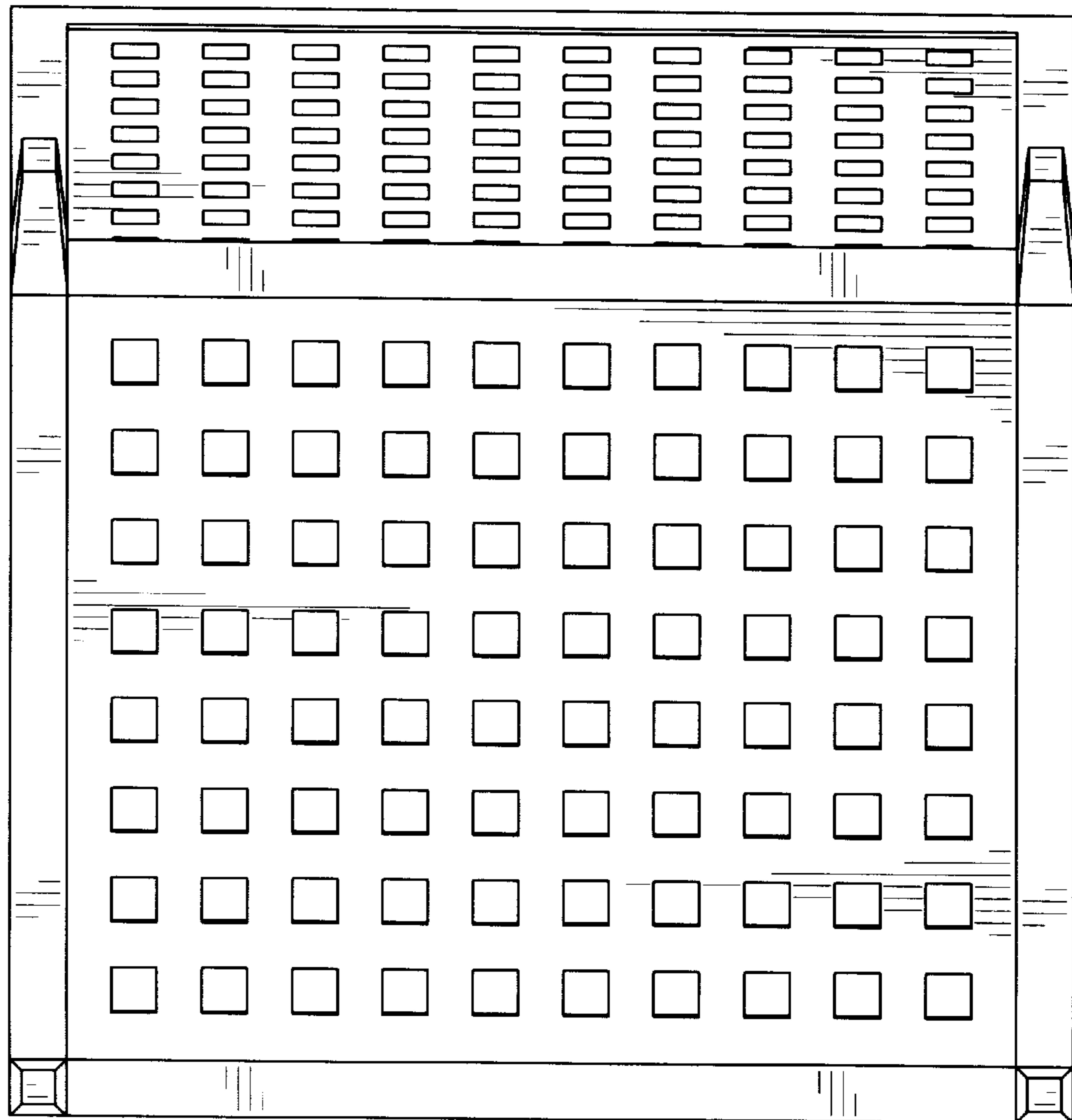



FIG. 6





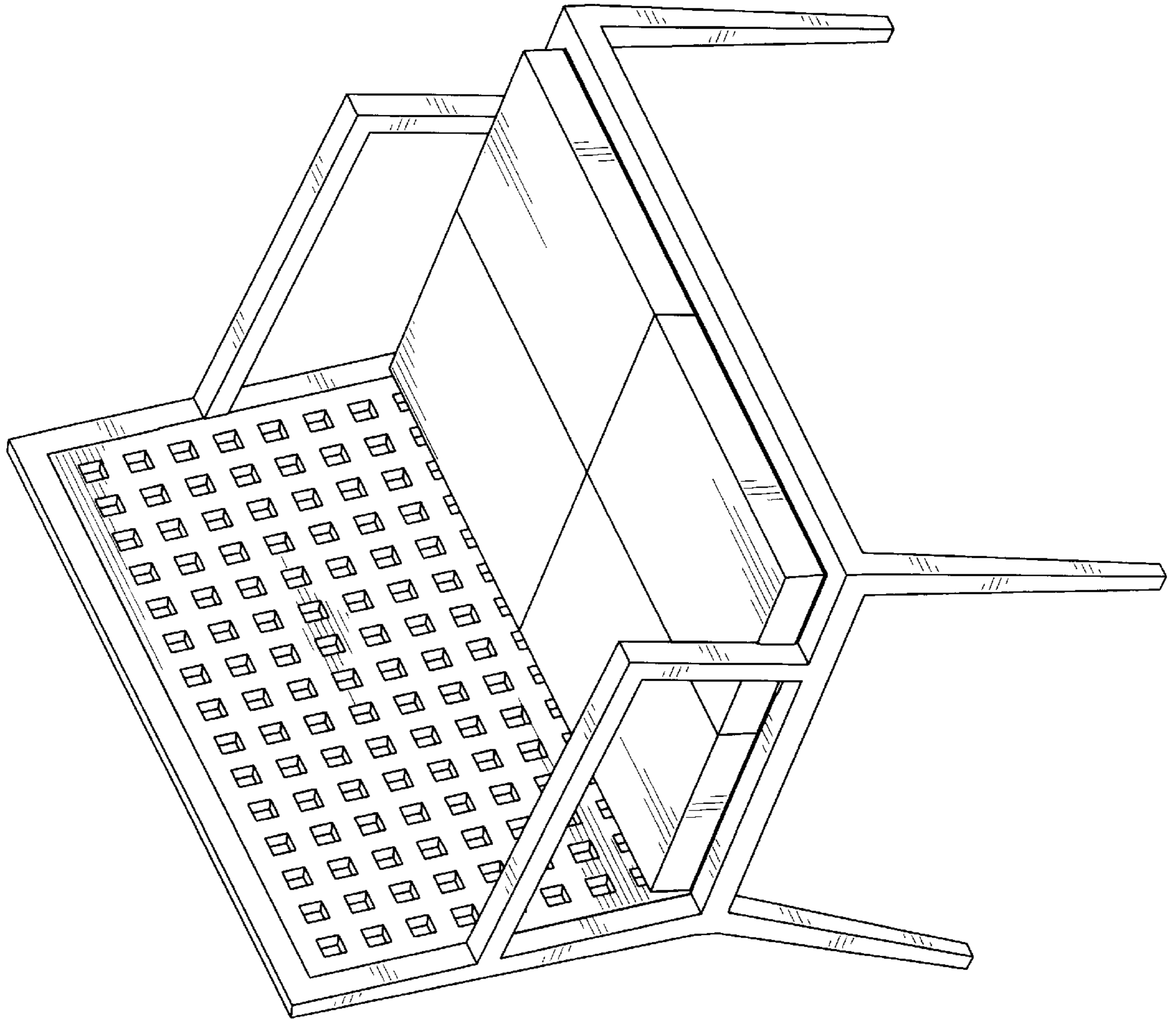

FIG. 7

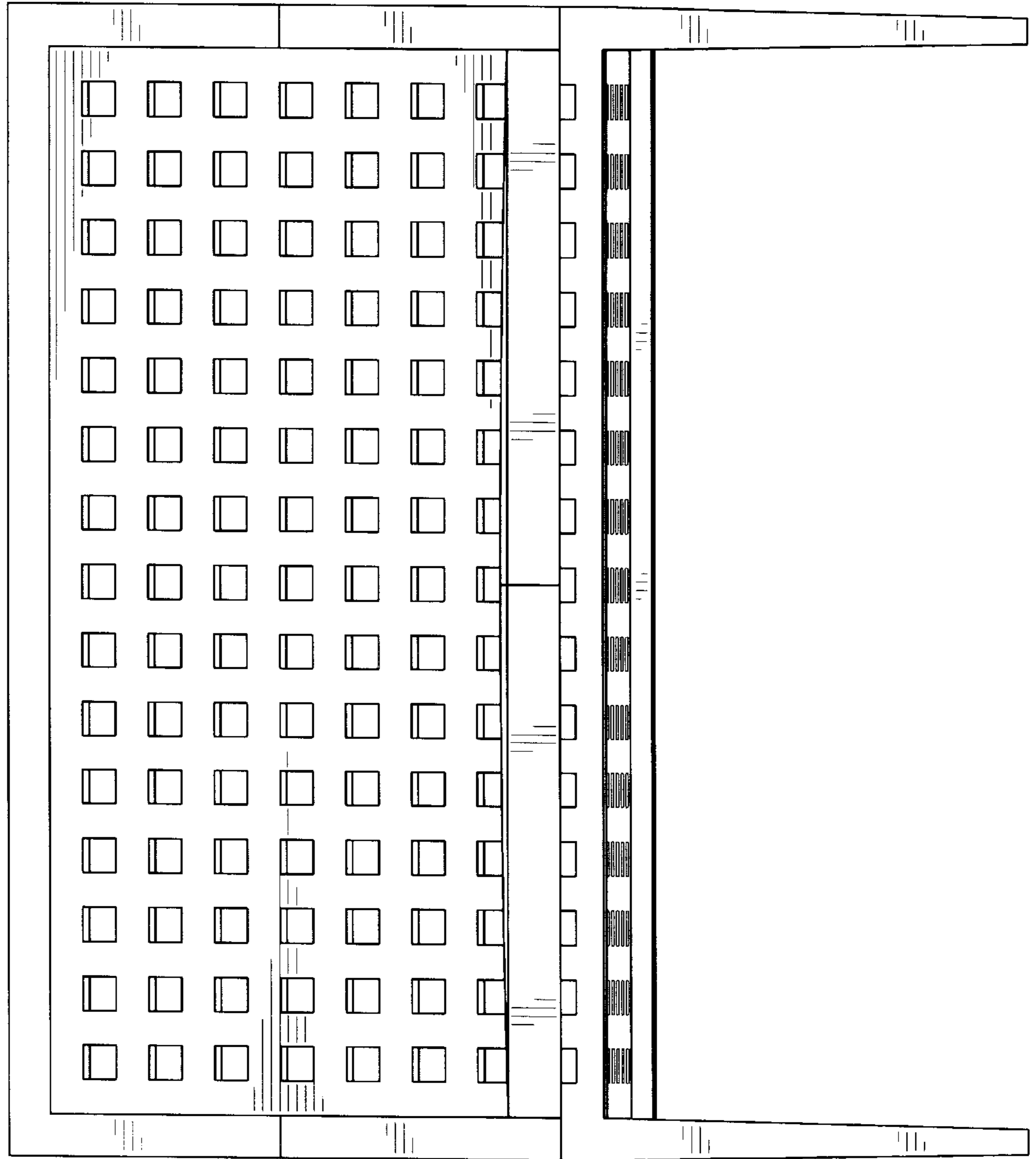

FIG. 8

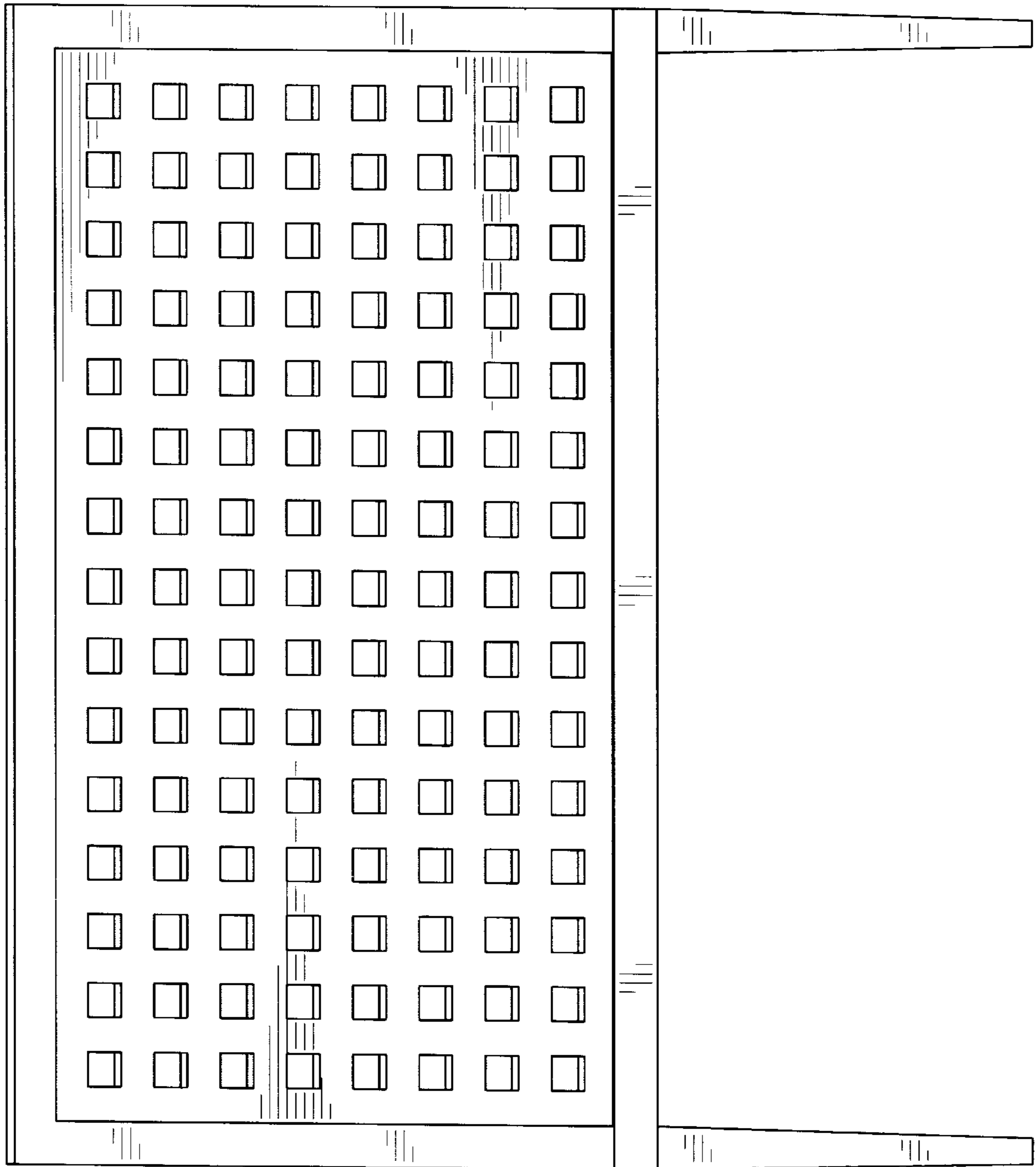

FIG. 9

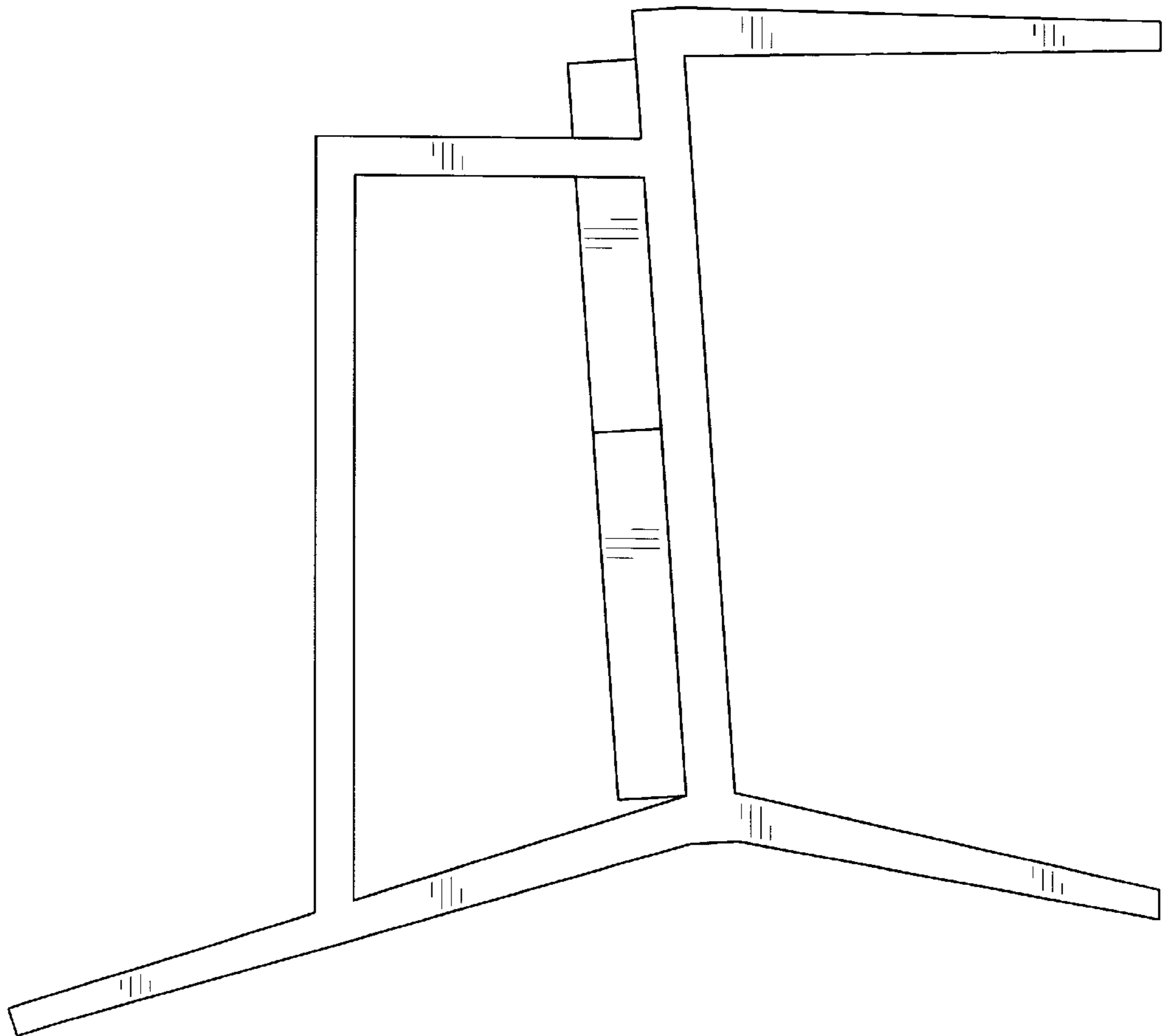

FIG. 10

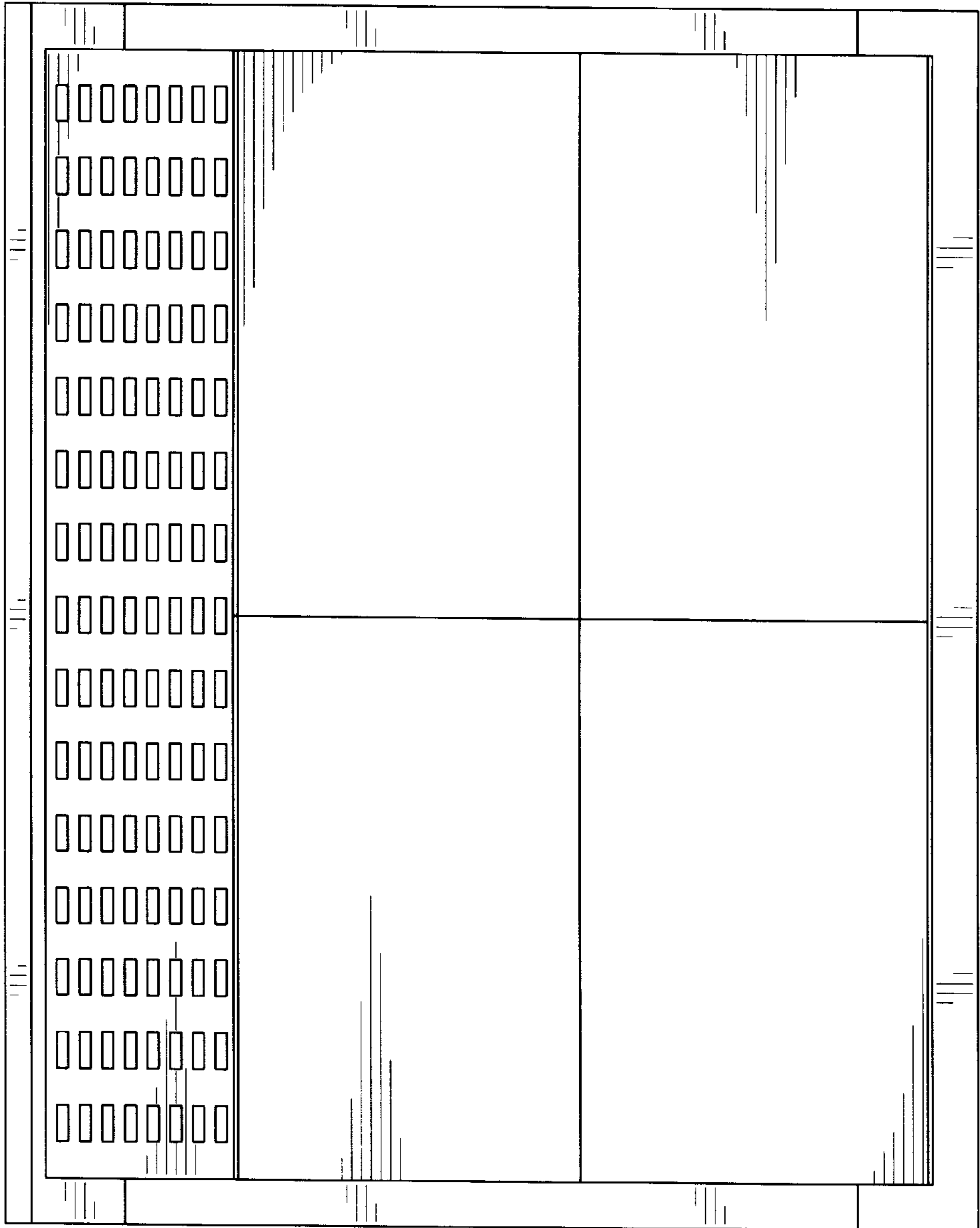

FIG. 11

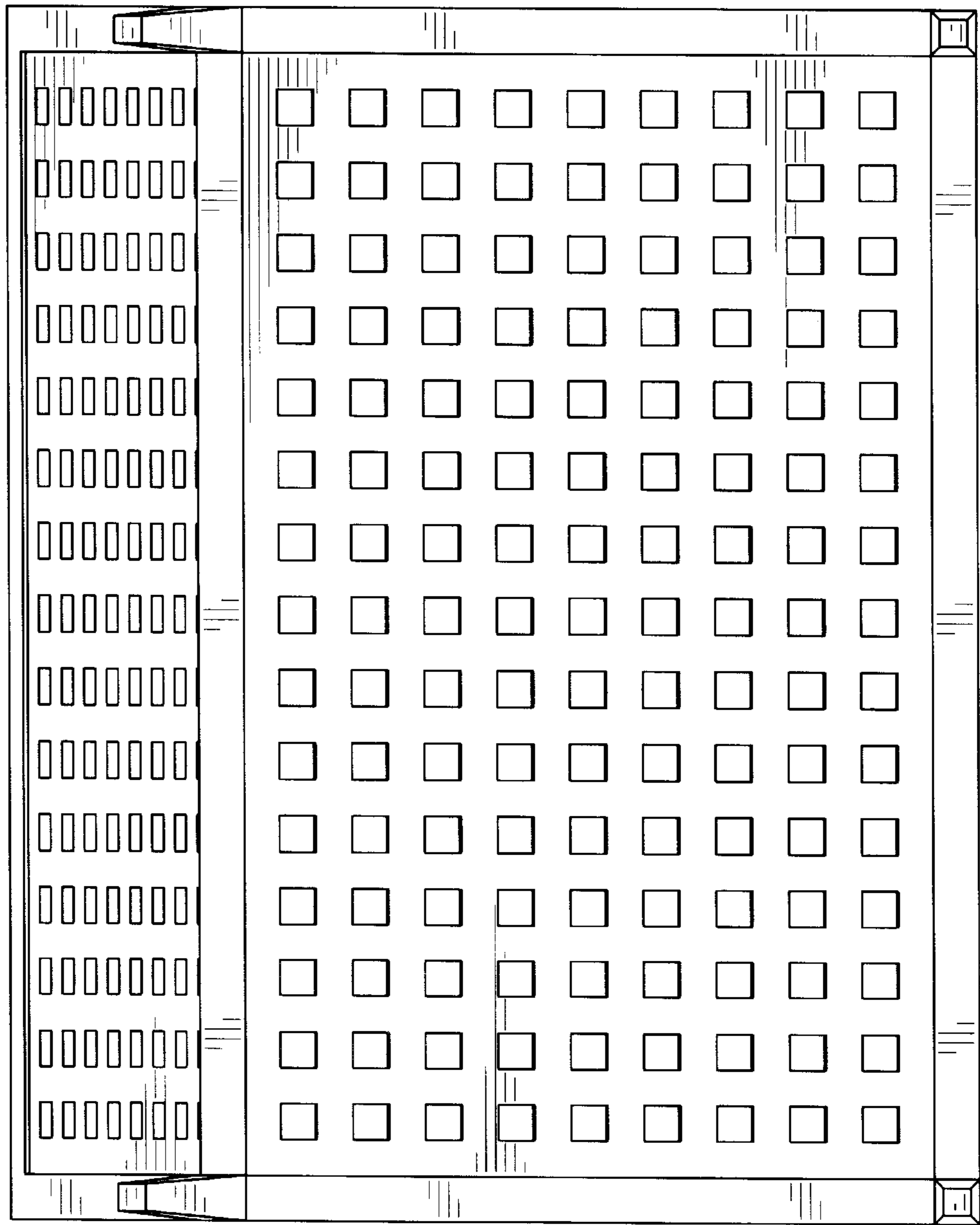

FIG. 12

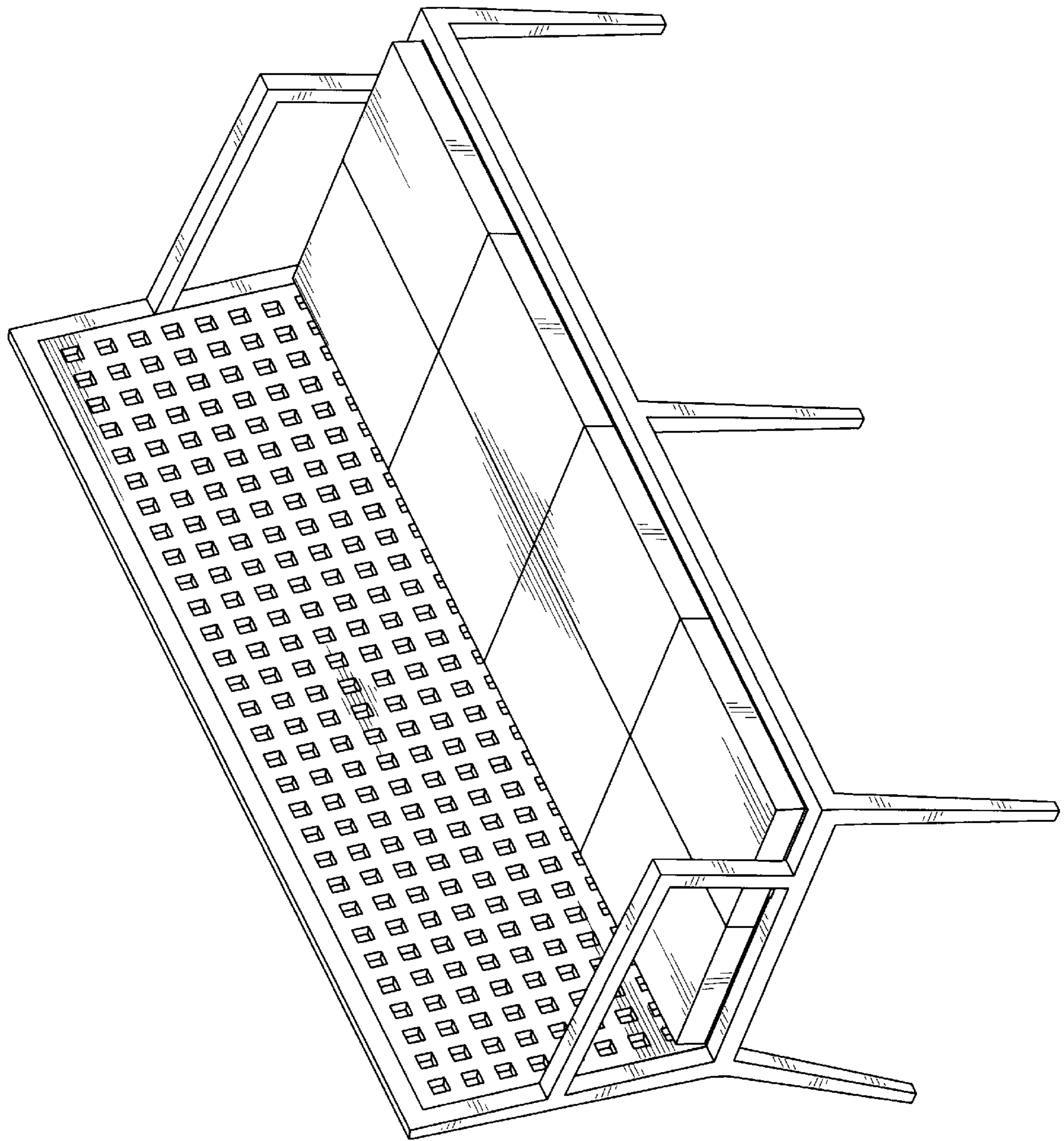

FIG. 13



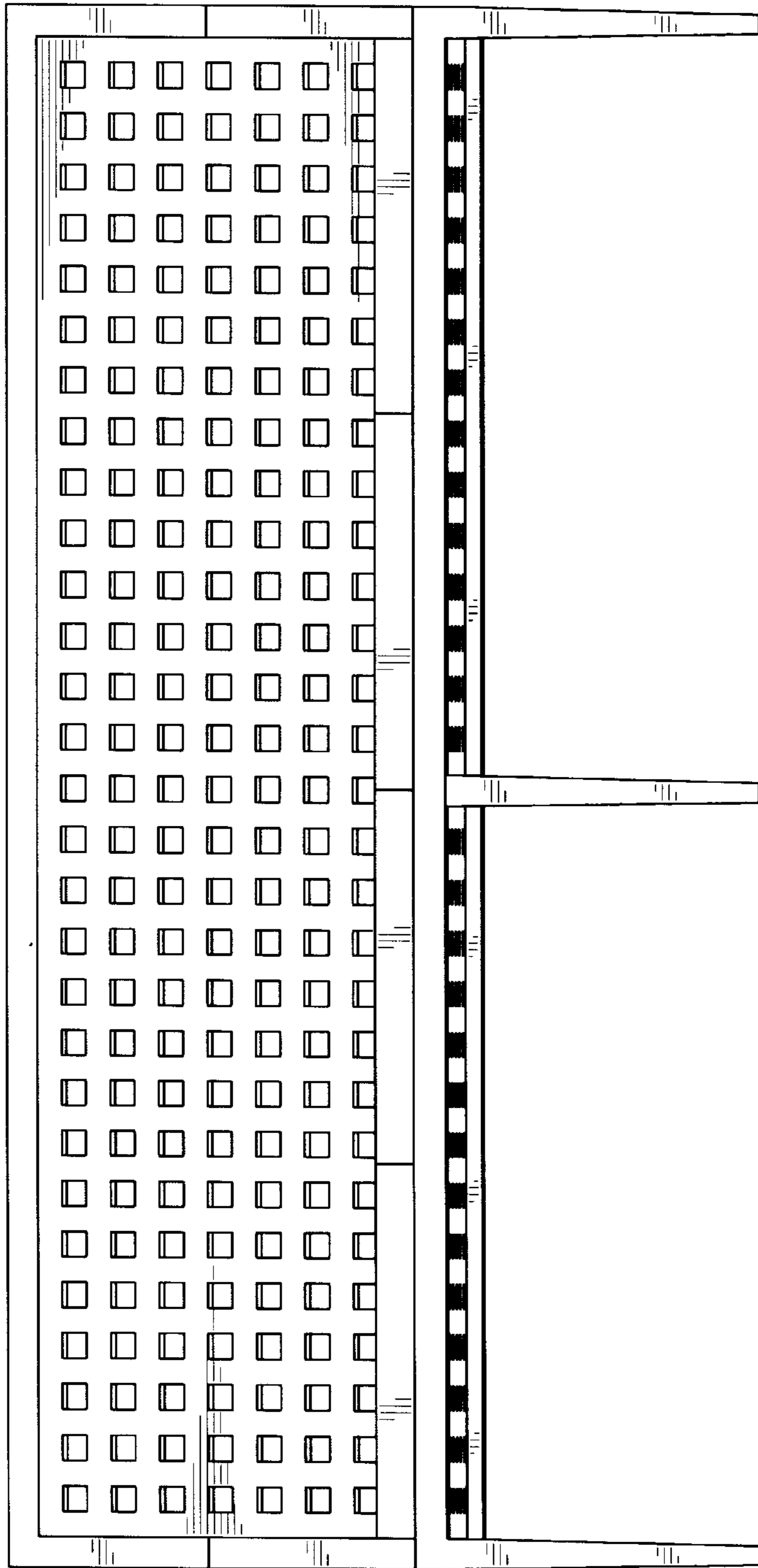

FIG. 14

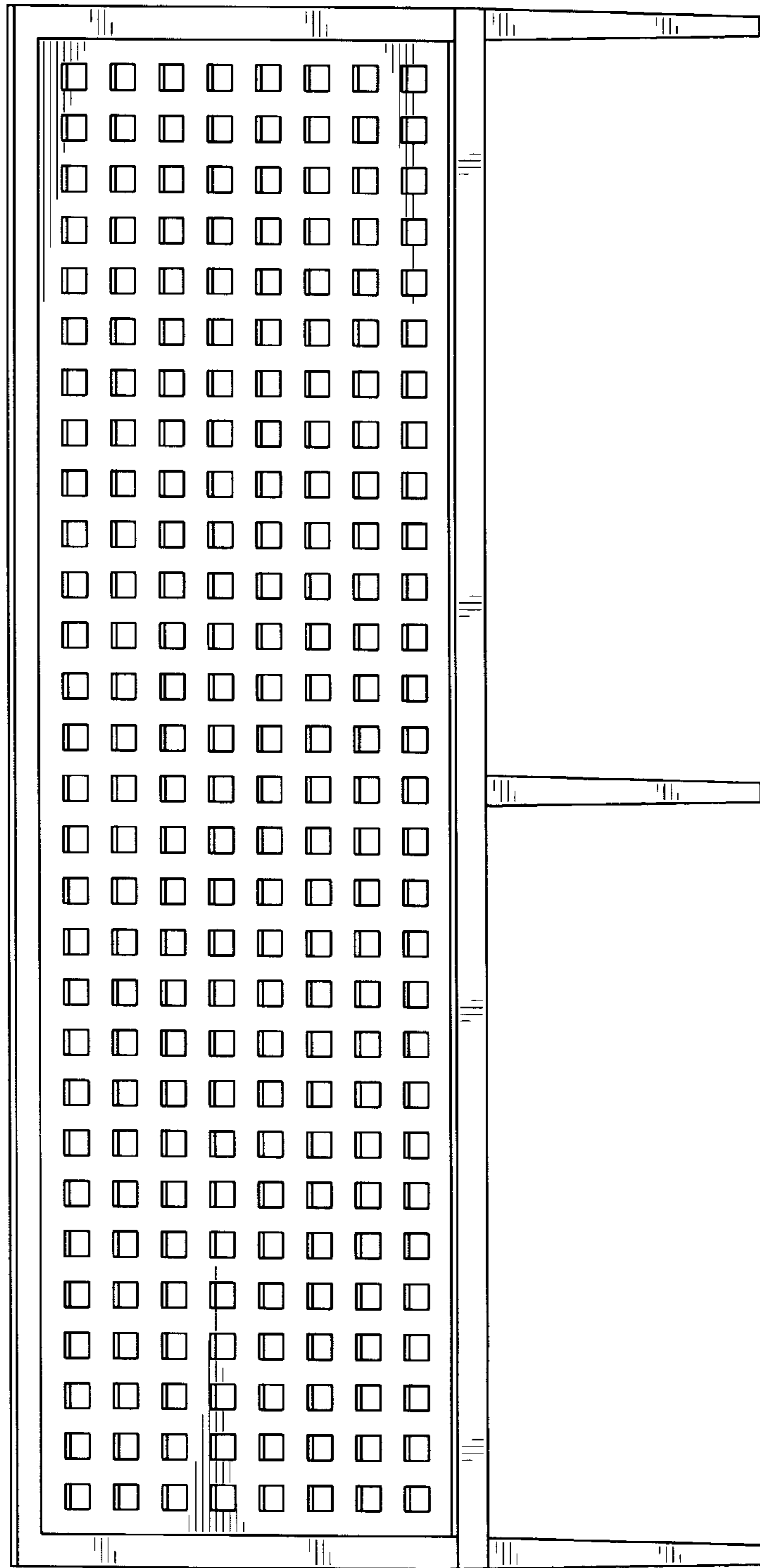

FIG. 15

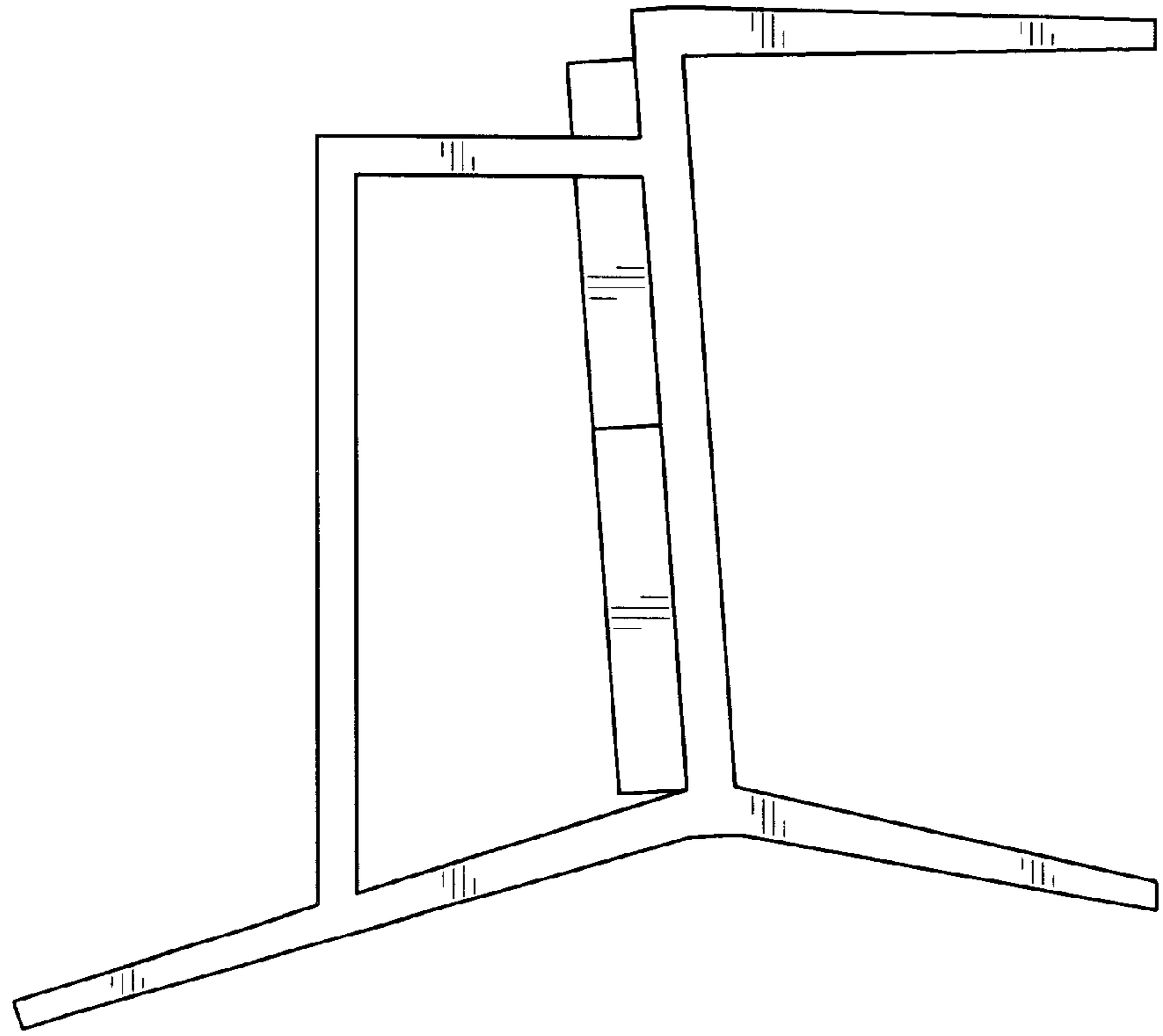

FIG. 16

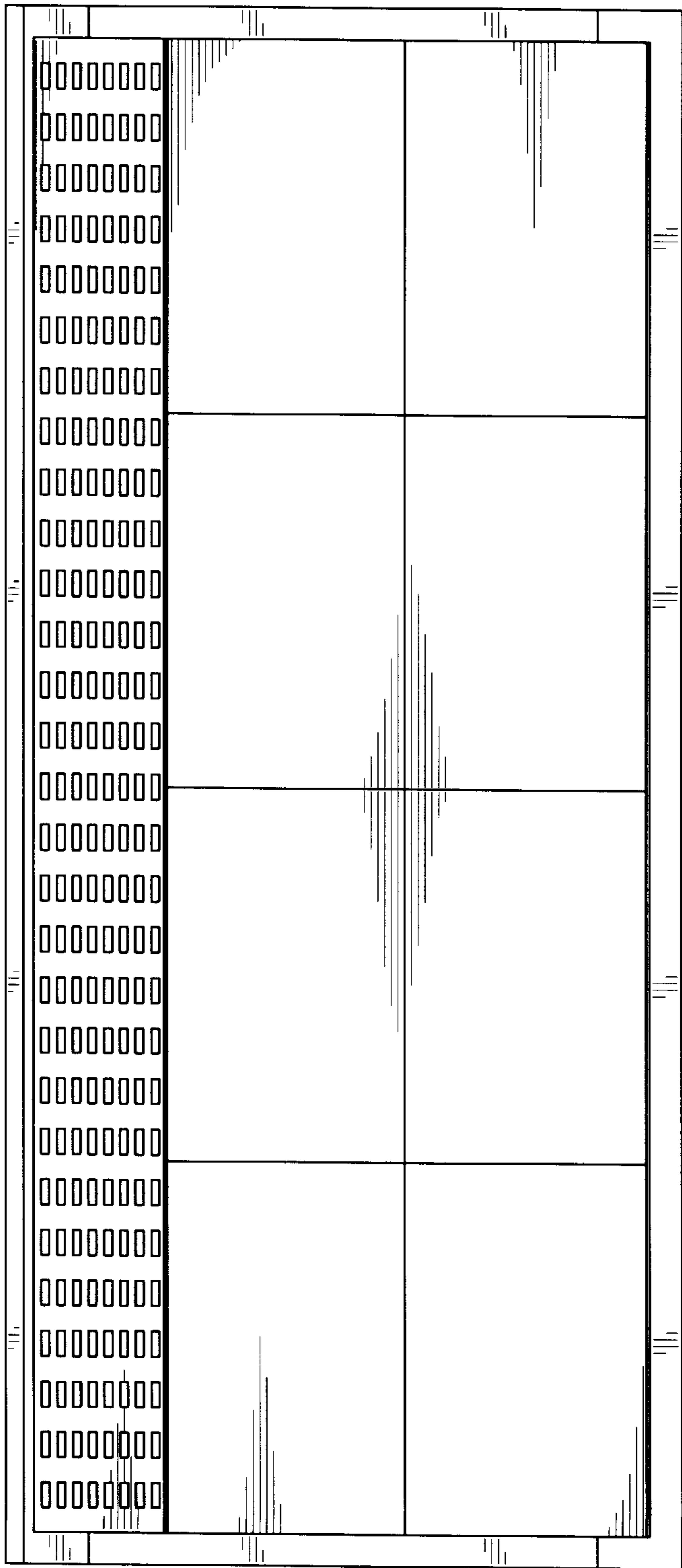

FIG. 17

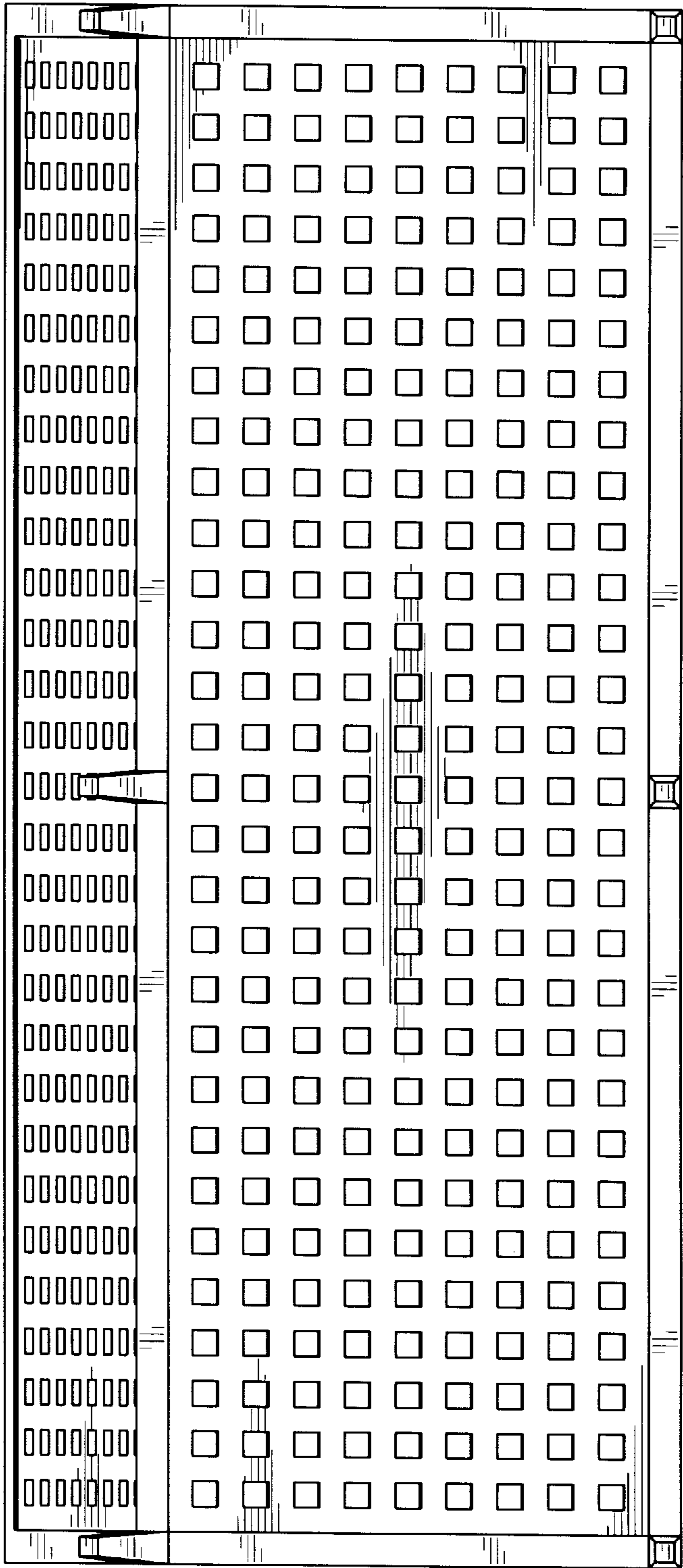

FIG. 18