



US00D438494S

(12) **United States Design Patent**  
**Charmat et al.**

(10) **Patent No.:** **US D438,494 S**

(45) **Date of Patent:** **\*\* Mar. 6, 2001**

(54) **GUIDE PIN AND BEARING FOR A DISC BRAKE**

(75) **Inventors:** **Djamel Charmat; Sigmar Micke**, both of South Bend, IN (US); **Darwin Hostetler**, Barrien Springs, MI (US); **Gerard LeDeit**, Courtry; **Jean Louis Gerard**, Bagnolet, both of (FR)

(73) **Assignee:** **Robert Bosch Corporation**, Broadview, IL (US)

(\*\*) **Term:** **14 Years**

(21) **Appl. No.:** **29/098,852**

(22) **Filed:** **Jan. 7, 1999**

(51) **LOC (7) Cl.** ..... **12-16**

(52) **U.S. Cl.** ..... **D12/180; D8/387**

(58) **Field of Search** ..... **D12/180, 114; 188/73.44, 73.35; D8/387; 74/18.2; 411/378, 411, 427; 439/810-815, 797**

(56) **References Cited**

**U.S. PATENT DOCUMENTS**

D. 265,174 \* 6/1982 Boyle ..... D8/387

D. 296,188 \* 6/1988 Herzog ..... D8/387  
D. 310,956 \* 10/1990 Huska ..... D8/387  
5,562,187 \* 10/1996 Tribuzio et al. .... 188/73.45  
5,931,267 \* 8/1999 Iwata et al. .... 188/73.45  
6,026,938 \* 2/2000 Demoise, Jr. et al. .... 188/73.44

\* cited by examiner

*Primary Examiner*—Alan P. Douglas

*Assistant Examiner*—Linda Brooks

(74) *Attorney, Agent, or Firm*—Leo H McCormick, Jr.; Warren Comstock

(57) **CLAIM**

The ornamental design for a guide pin and bearing for a disc brake, as shown and described.

**DESCRIPTION**

FIG. 1 is a perspective view of a guide pin and bearing for a disc brake showing our new design; FIG. 2 is a side elevation view of FIG. 1; FIG. 3 is a rear end elevation view of FIG. 1; FIG. 4 is a top elevation view of FIG. 1; and, FIG. 5 is a front end view of FIG. 1.

**1 Claim, 1 Drawing Sheet**

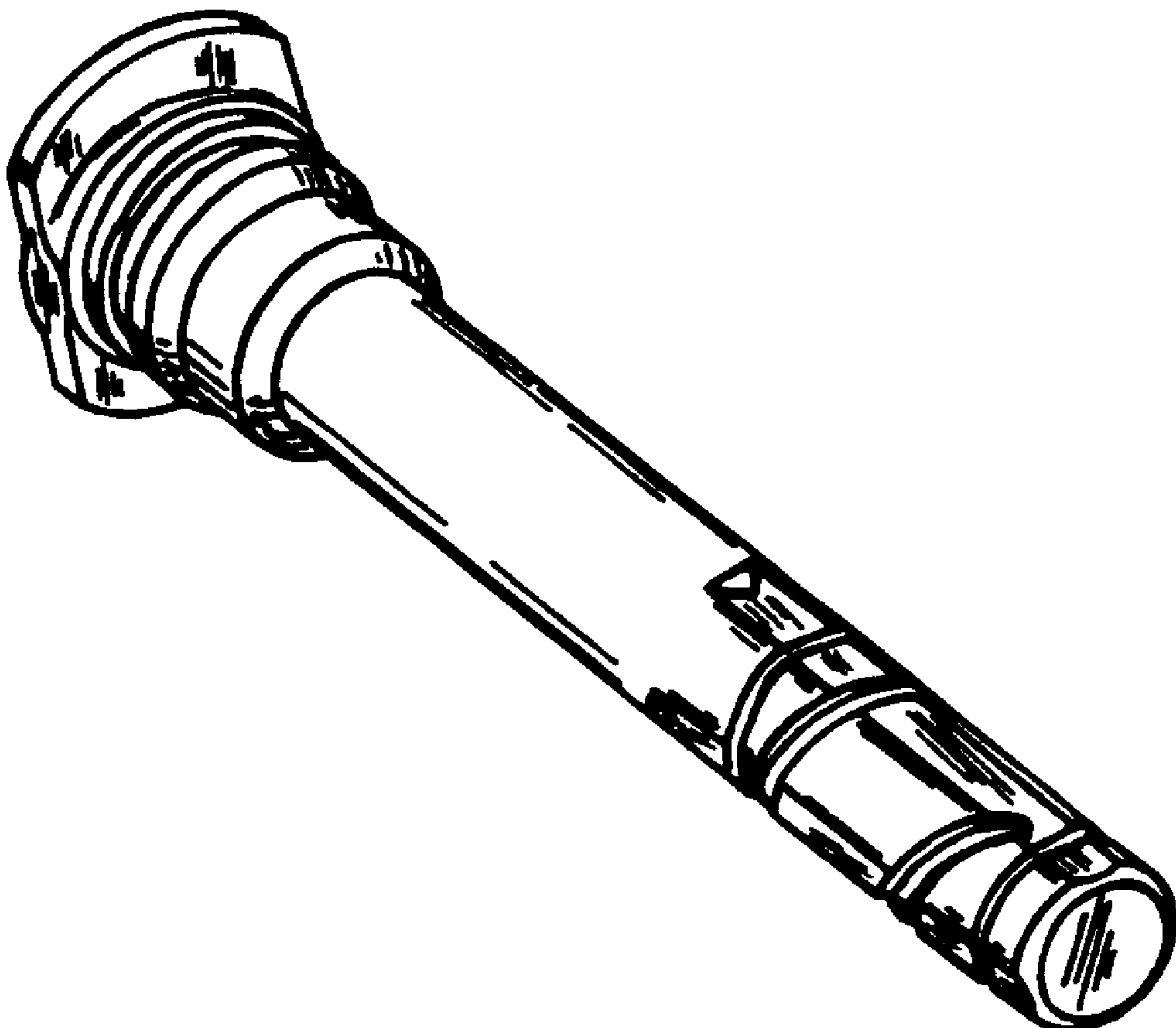

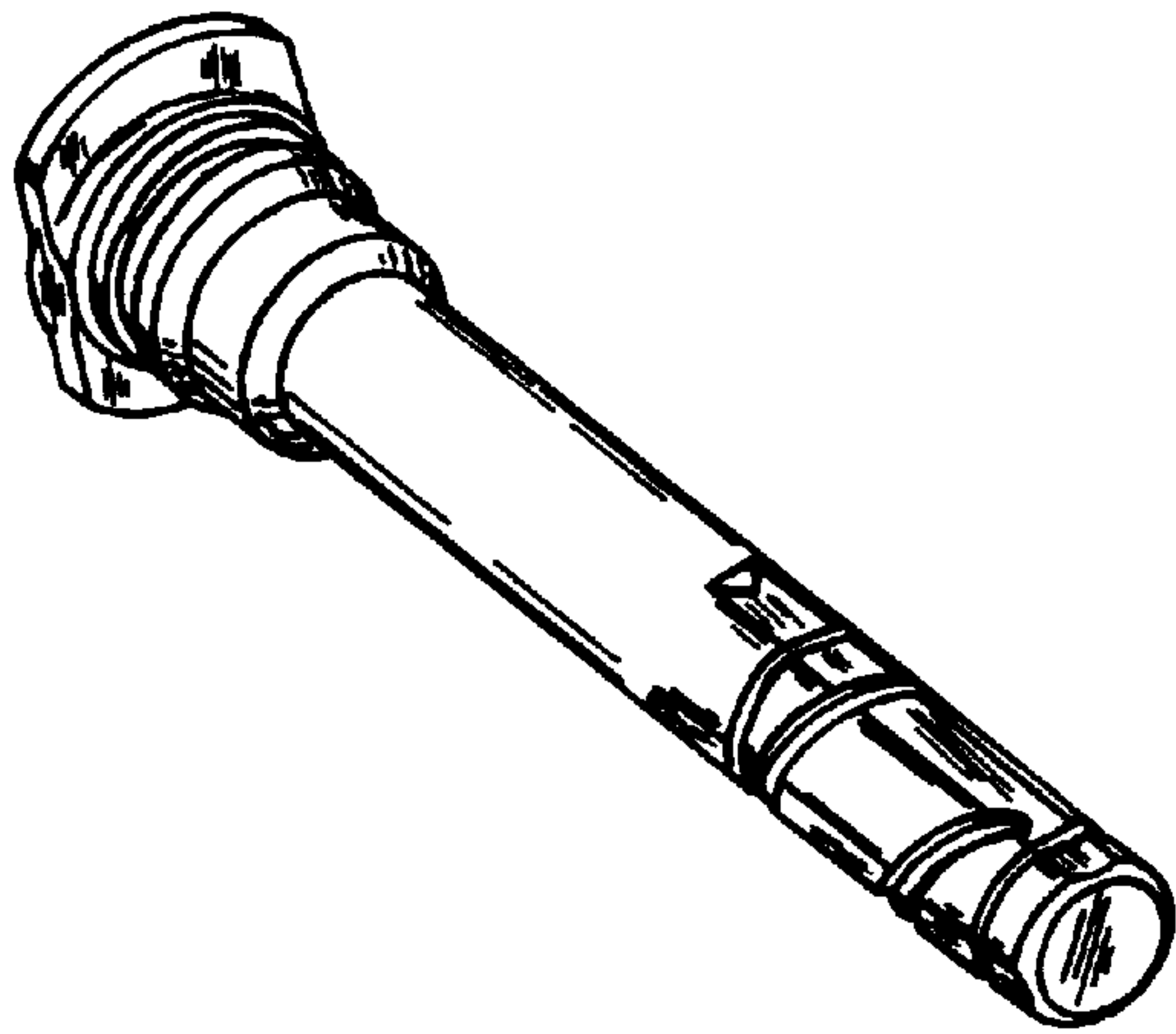

FIG. 1

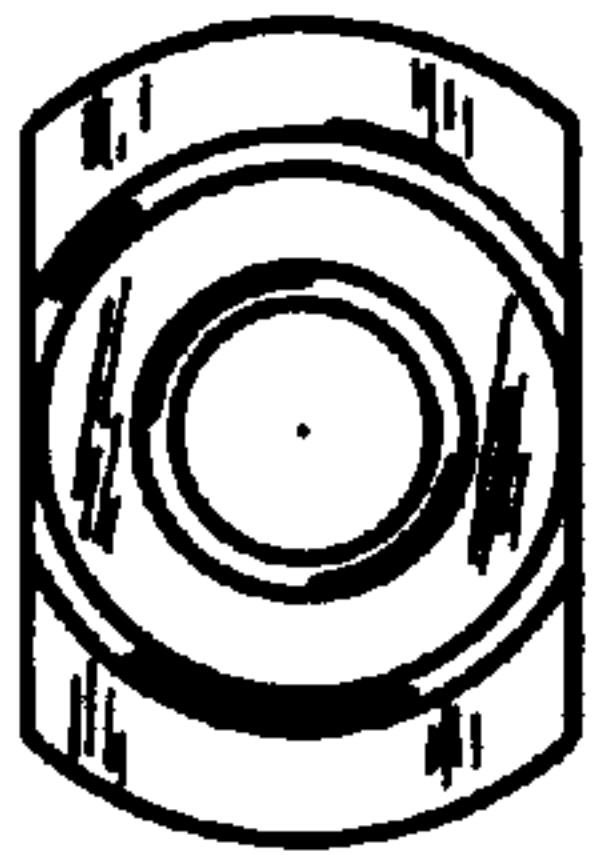

FIG. 3

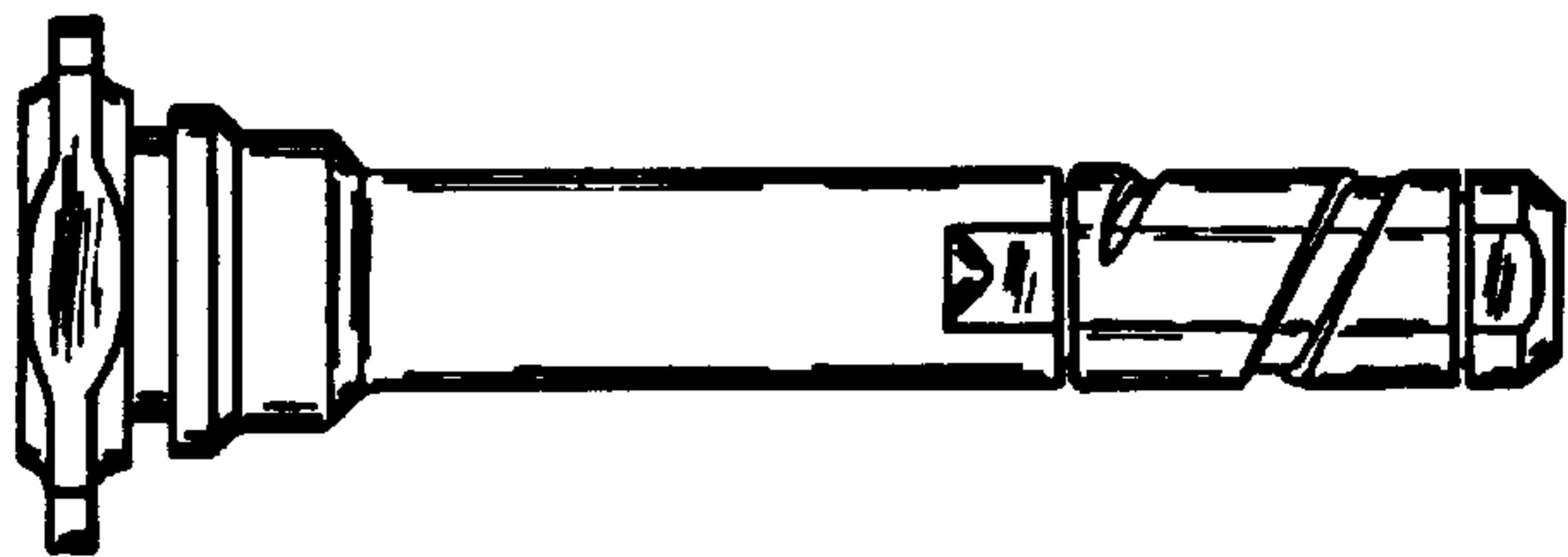

FIG. 2

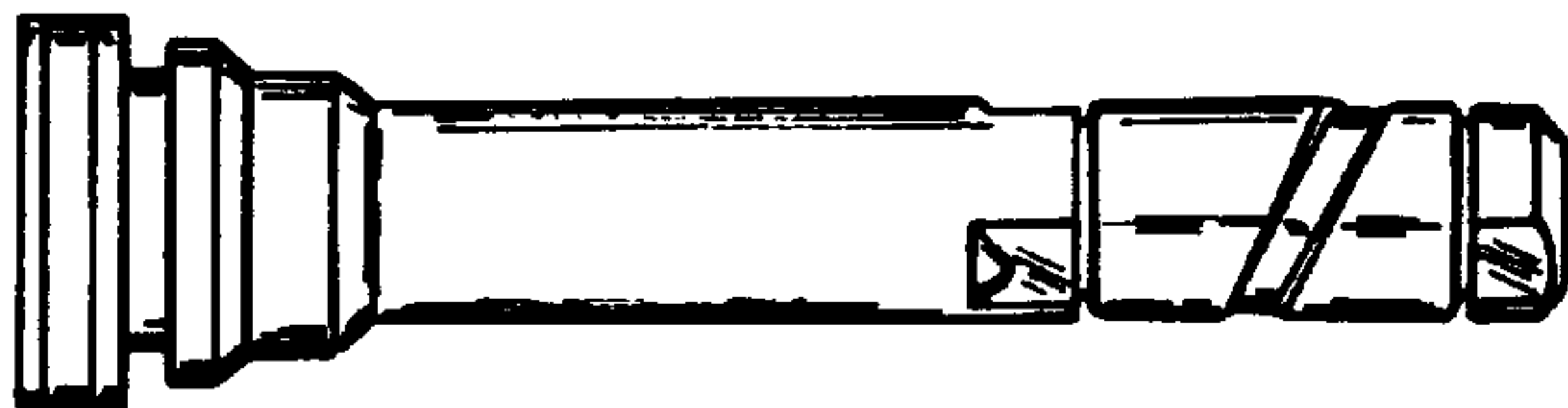

FIG. 4

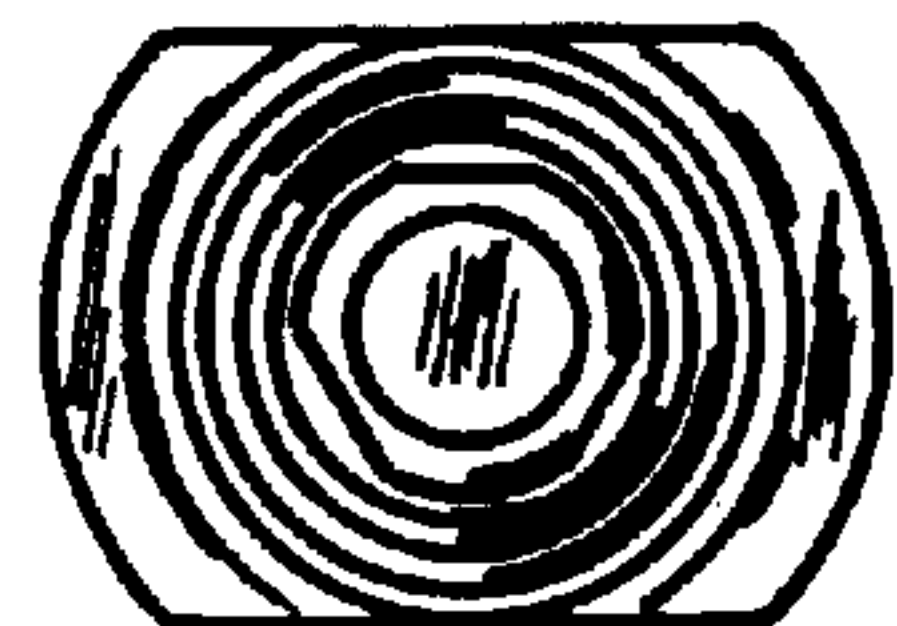

FIG. 5