



US00D438464S

(12) **United States Design Patent**
Newhouse et al.

(10) **Patent No.:** **US D438,464 S**
(45) **Date of Patent:** **** Mar. 6, 2001**

(54) **CONTAINER AND DISPENSER ASSEMBLY FOR TOOL BITS**

3,179,244 * 4/1965 Kuhn 206/216
5,396,985 * 3/1995 Seki 206/457

(75) Inventors: **Debbie A. Newhouse**, Prospect, KY (US); **Mathew S. Taylor**, Shelby, OH (US)

* cited by examiner

Primary Examiner—Philip S. Hyder

(74) *Attorney, Agent, or Firm*—Maginot, Addison & Moore

(73) Assignee: **Credo Tool Company**, Woodburn, OR (US)

(57) **CLAIM**

(**) Term: **14 Years**

The ornamental design for a container and dispenser assembly for tool bits, as shown and described.

(21) Appl. No.: **29/111,240**

DESCRIPTION

(22) Filed: **Sep. 23, 1999**

FIG. 1 is a perspective view of a container and dispenser assembly for tool bits showing my new design;

(51) **LOC (7) Cl.** **09-03**

(52) **U.S. Cl.** **D9/417; D8/71; D3/273**

FIG. 2 is a front elevational view showing the design for the container and dispenser assembly for tool bits of FIG. 1;

(58) **Field of Search** **D3/273; D9/416, D9/417, 433, 414; 229/113, 213, 114, 214**

FIG. 3 is a back elevational view showing the design for the container and dispenser assembly for tool bits of FIG. 1;

(56) **References Cited**

U.S. PATENT DOCUMENTS

D. 263,116	*	2/1982	Cain	D9/327
2,288,914	*	7/1942	Monroe	229/213
2,444,104	*	6/1948	Marken	229/213
2,457,822	*	1/1949	Jones	229/213
2,459,130	*	1/1949	Jones	229/213
2,661,138	*	12/1953	Leonard	229/213

FIG. 4 is a left side elevational view showing the design for the container and dispenser assembly for tool bits of FIG. 1;

FIG. 5 is a right side elevational view showing the design for the container and dispenser assembly for tool bits of FIG. 1;

FIG. 6 is a top elevational view showing the design for the container and dispenser assembly for tool bits of FIG. 1; and,

FIG. 7 is a bottom elevational view showing the design for the container and dispenser assembly for tool bits of FIG. 1.

1 Claim, 4 Drawing Sheets

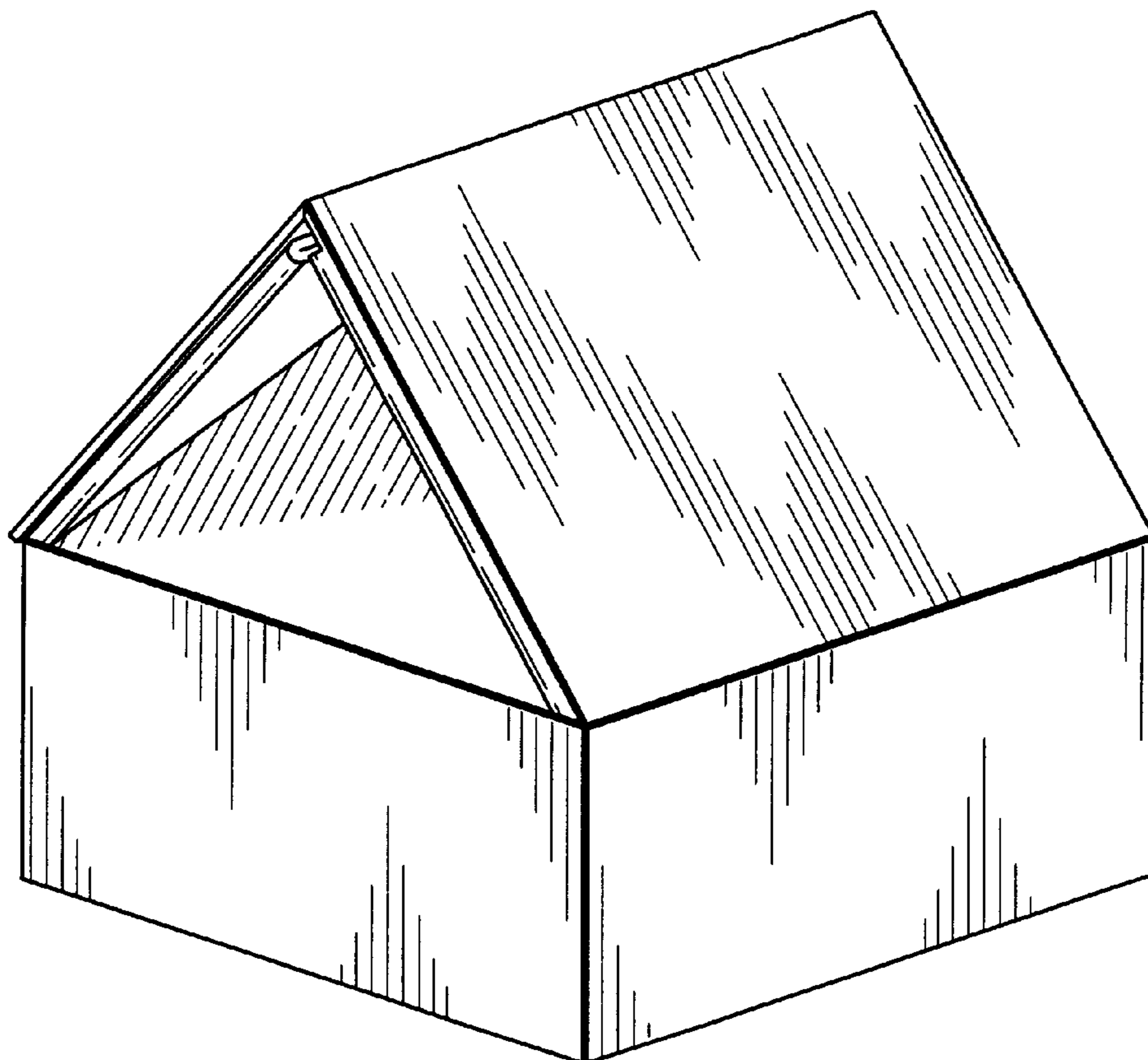

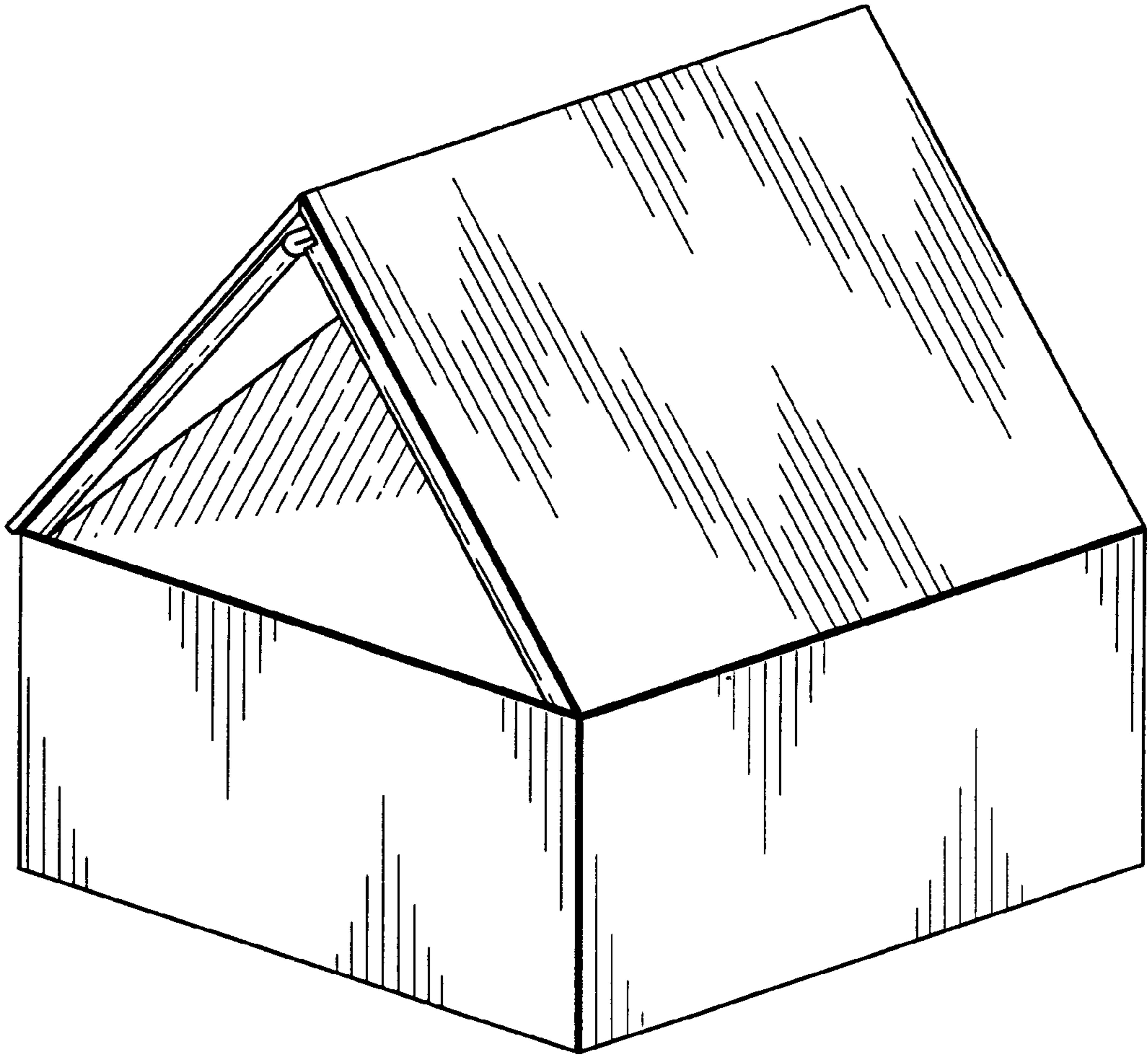

Fig. 1

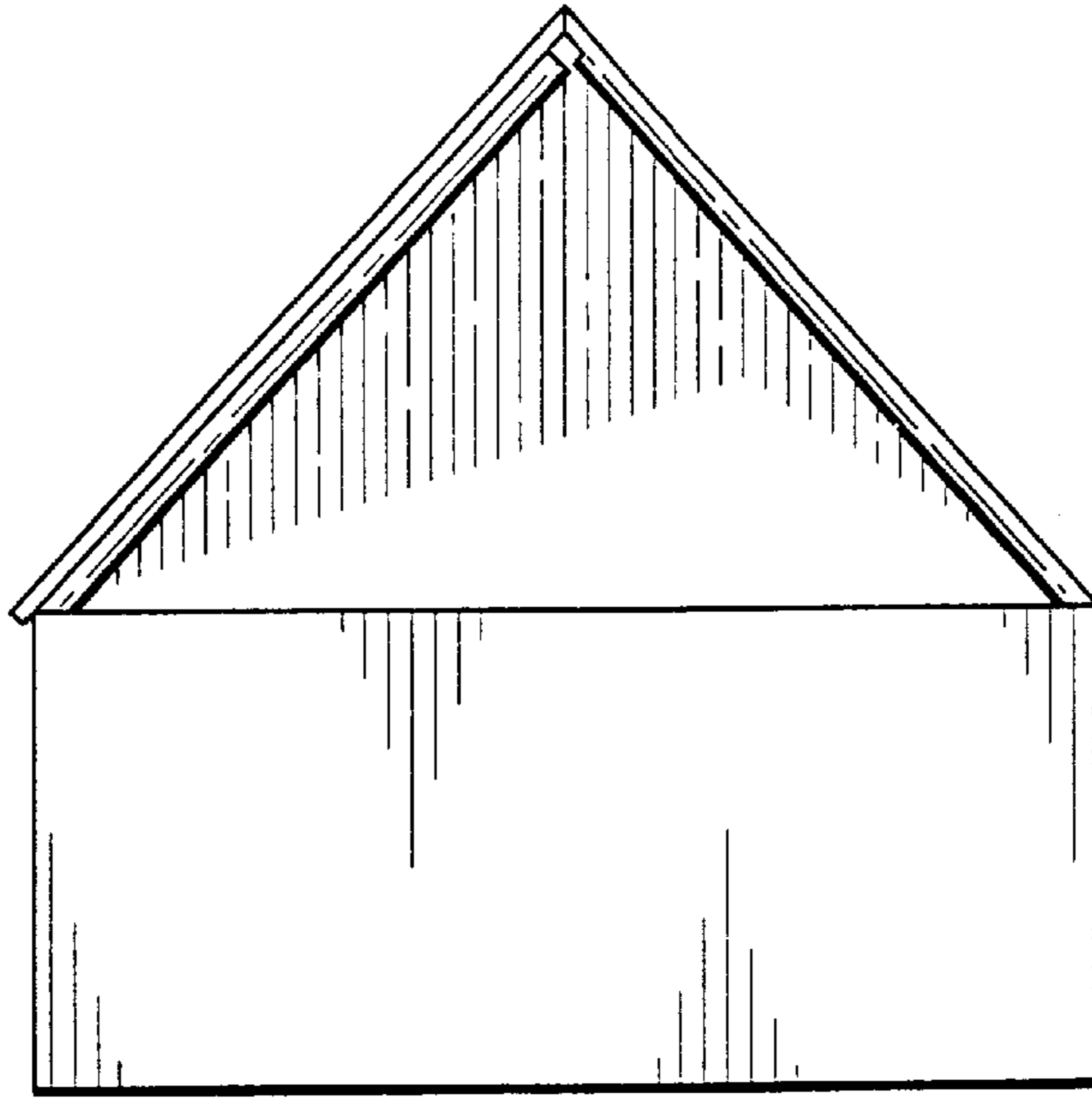

Fig. 2

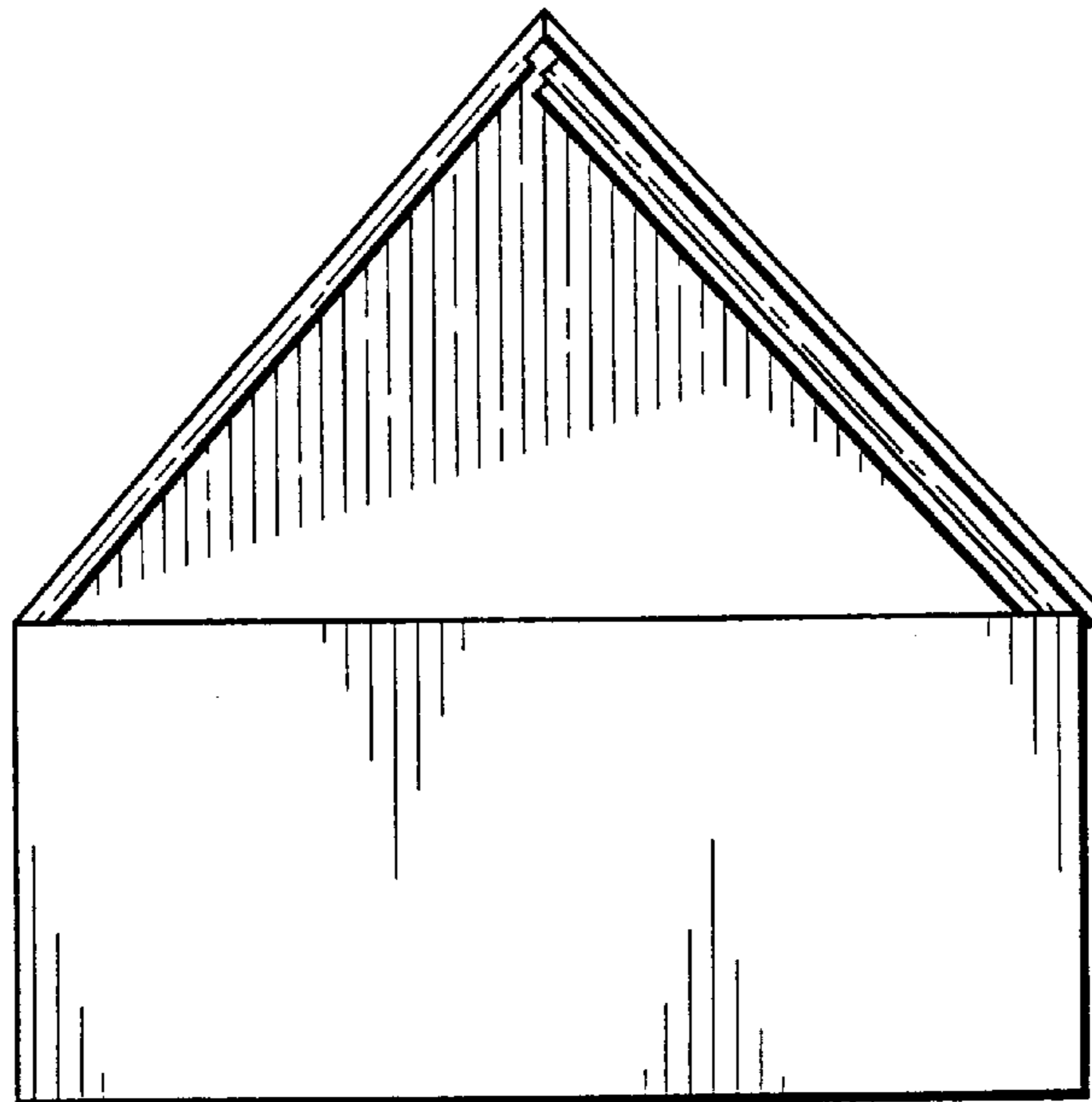

Fig. 3

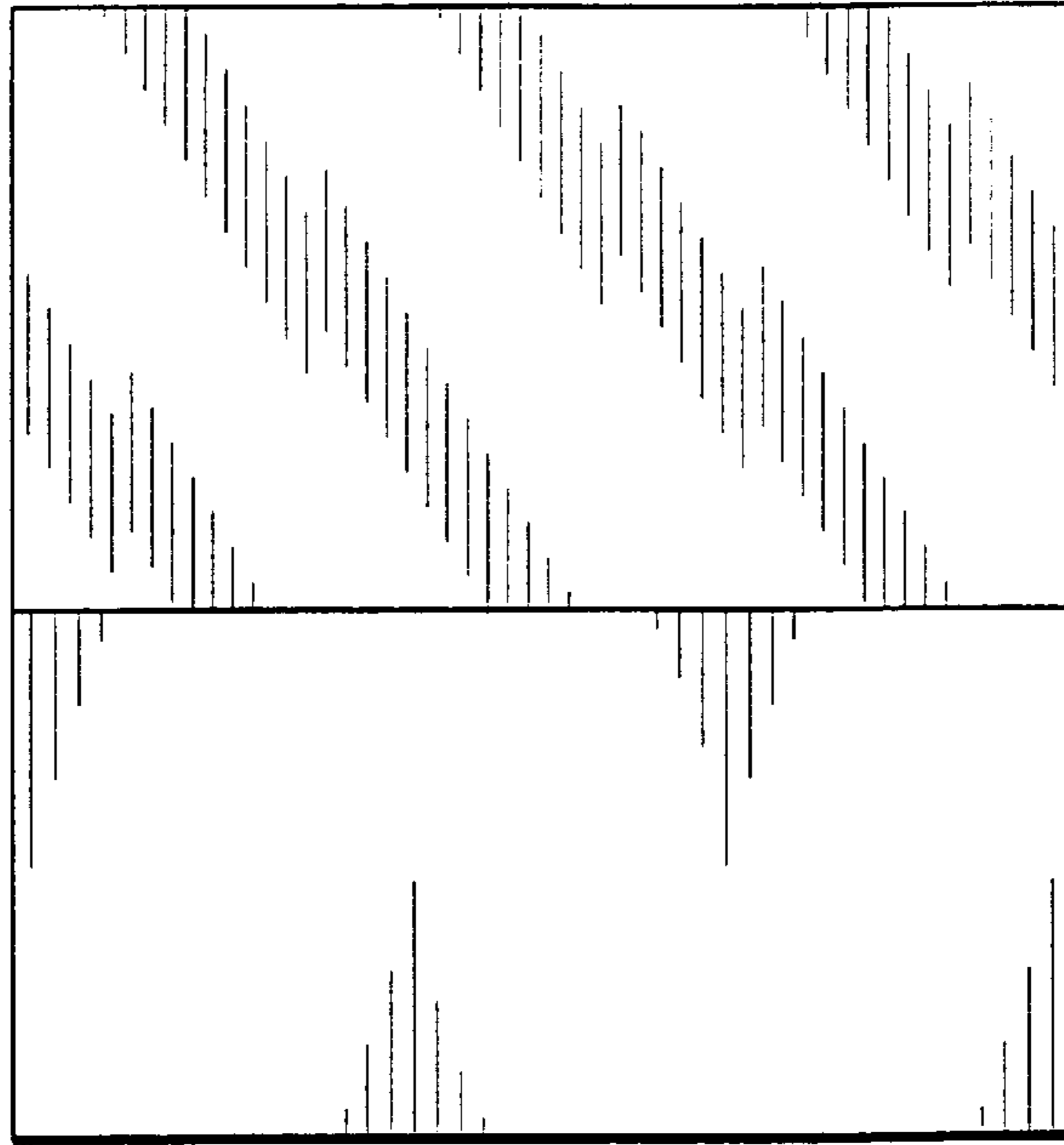

Fig. 4

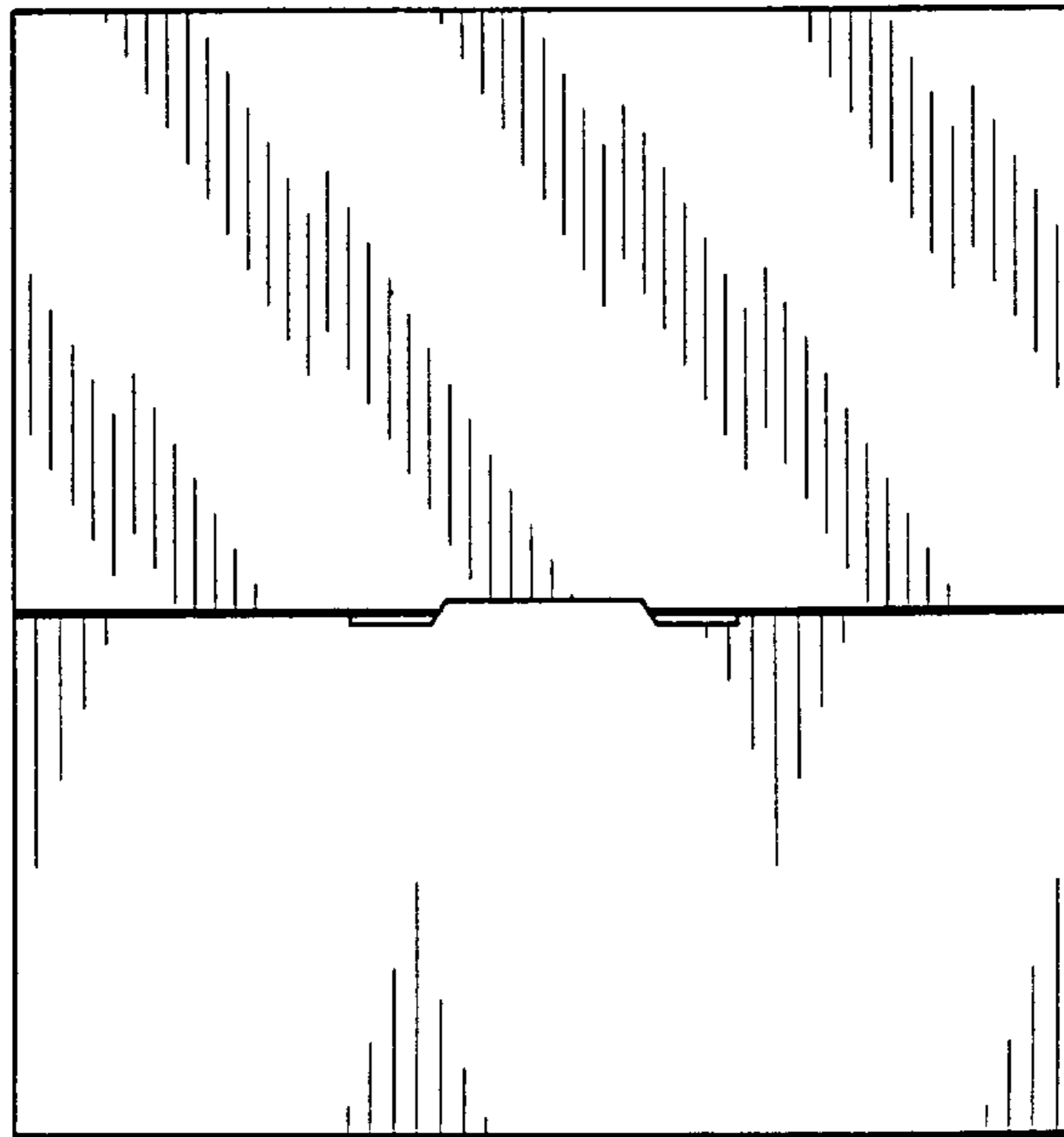

Fig. 5

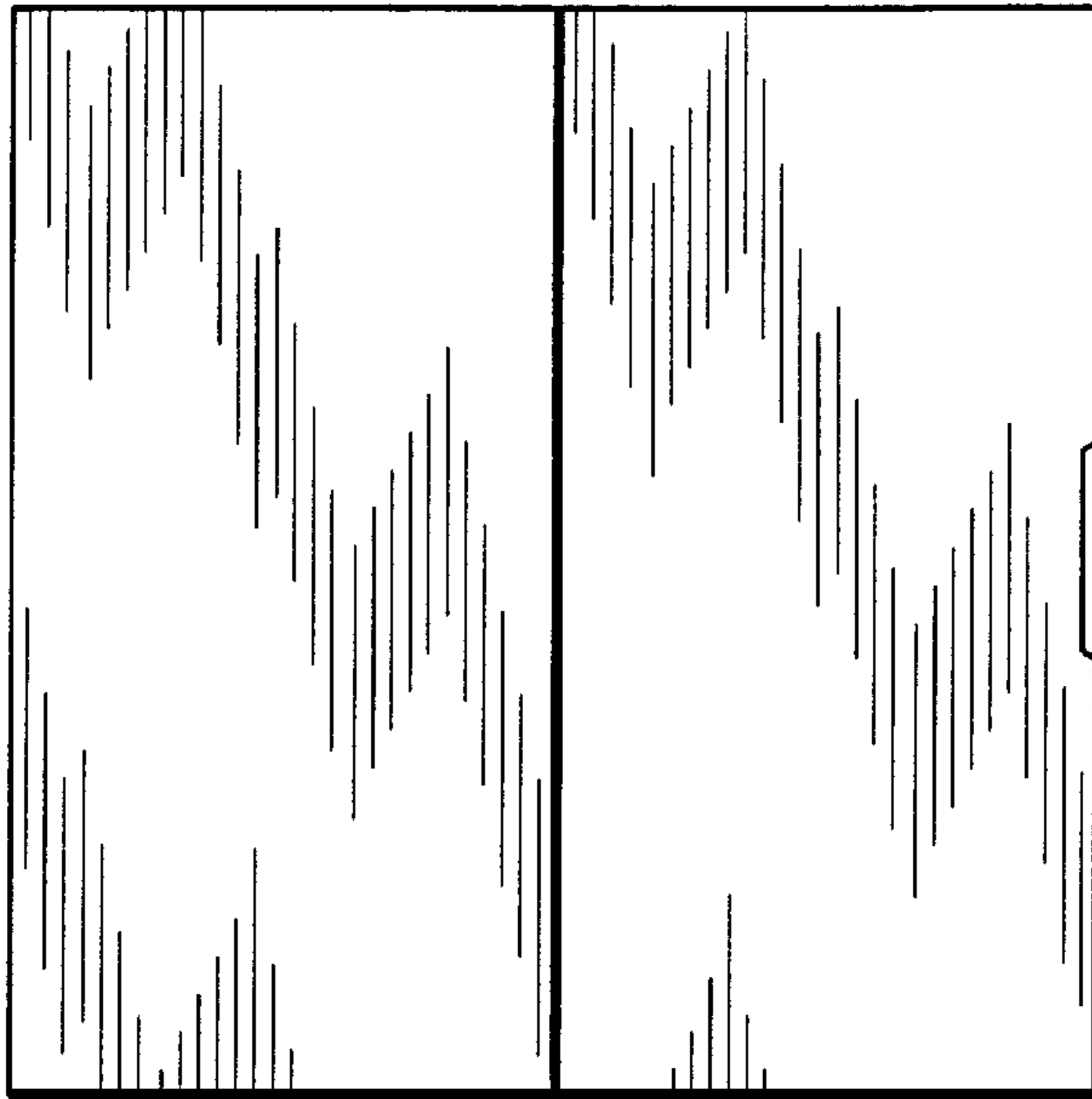

Fig. 6

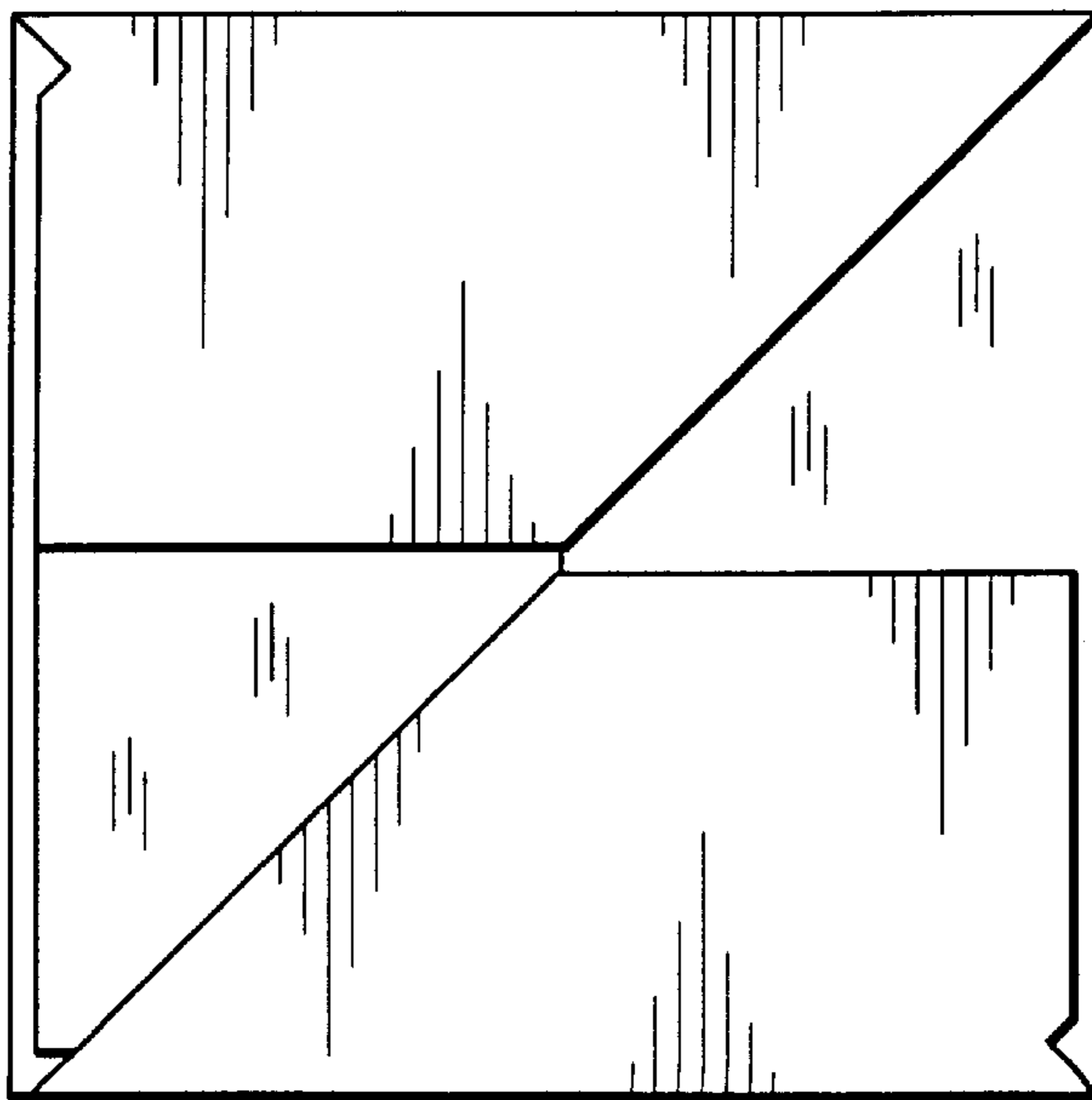

Fig. 7