



US00D437466S

(12) **United States Design Patent**  
**Song**

(10) **Patent No.:** **US D437,466 S**

(45) **Date of Patent:** **\*\* Feb. 6, 2001**

(54) **FILTER CAP FOR ELECTRIC CLEANER**

4,179,768 \* 12/1979 Sawyer ..... 15/352  
5,660,493 \* 8/1997 Stephens ..... 15/328

(76) Inventor: **Seung-Wook Song**, 5-103 Kaepo  
1-cha Woosung Apt., 503 Daechi-dong,  
Kangnam-gu, Seoul (KR), 135-280

\* cited by examiner

(\*\*) Term: **14 Years**

*Primary Examiner*—Mitchell Siegel  
(74) *Attorney, Agent, or Firm*—R. Neil Sudol; Henry D.  
Coleman; William J. Sapone

(21) Appl. No.: **29/116,089**

(57) **CLAIM**

(22) Filed: **Dec. 27, 1999**

The ornamental design for a filter cap for electric cleaner, as  
shown and described.

(30) **Foreign Application Priority Data**

Dec. 27, 1996 (JP) ..... 8-351689

**DESCRIPTION**

(51) **LOC (7) Cl.** ..... **15-05**

FIG. 1 is a perspective view of a filter cap for electric cleaner  
showing my new design;

(52) **U.S. Cl.** ..... **D32/25**

FIG. 2 is a front view thereof;

(58) **Field of Search** ..... D32/23, 25; D23/365;

FIG. 3 is a rear view thereof;

15/323, 326, 327 R, 327 F, 327 B, 327 E,  
352, 353, 347; 415/213.1

FIG. 4 is a left-side view thereof;

FIG. 5 is a right-side view thereof;

FIG. 6 is a top view thereof; and

FIG. 7 is a bottom view thereof.

(56) **References Cited**

**U.S. PATENT DOCUMENTS**

- D. 287,895 \* 1/1987 Berfield et al. .... D32/23
- D. 383,264 \* 9/1997 Balz ..... D32/30
- D. 384,448 \* 9/1997 Stephens et al. .... D32/23
- D. 425,677 \* 5/2000 Williamson ..... D32/25
- 2,956,734 \* 10/1960 Doyle ..... 415/213.1

FIG. 8 is an exploded perspective view thereof; and,

FIG. 9 is a perspective view thereof, the broken line showing  
being for illustrative purposes only and forming no part of  
the claimed design.

**1 Claim, 6 Drawing Sheets**

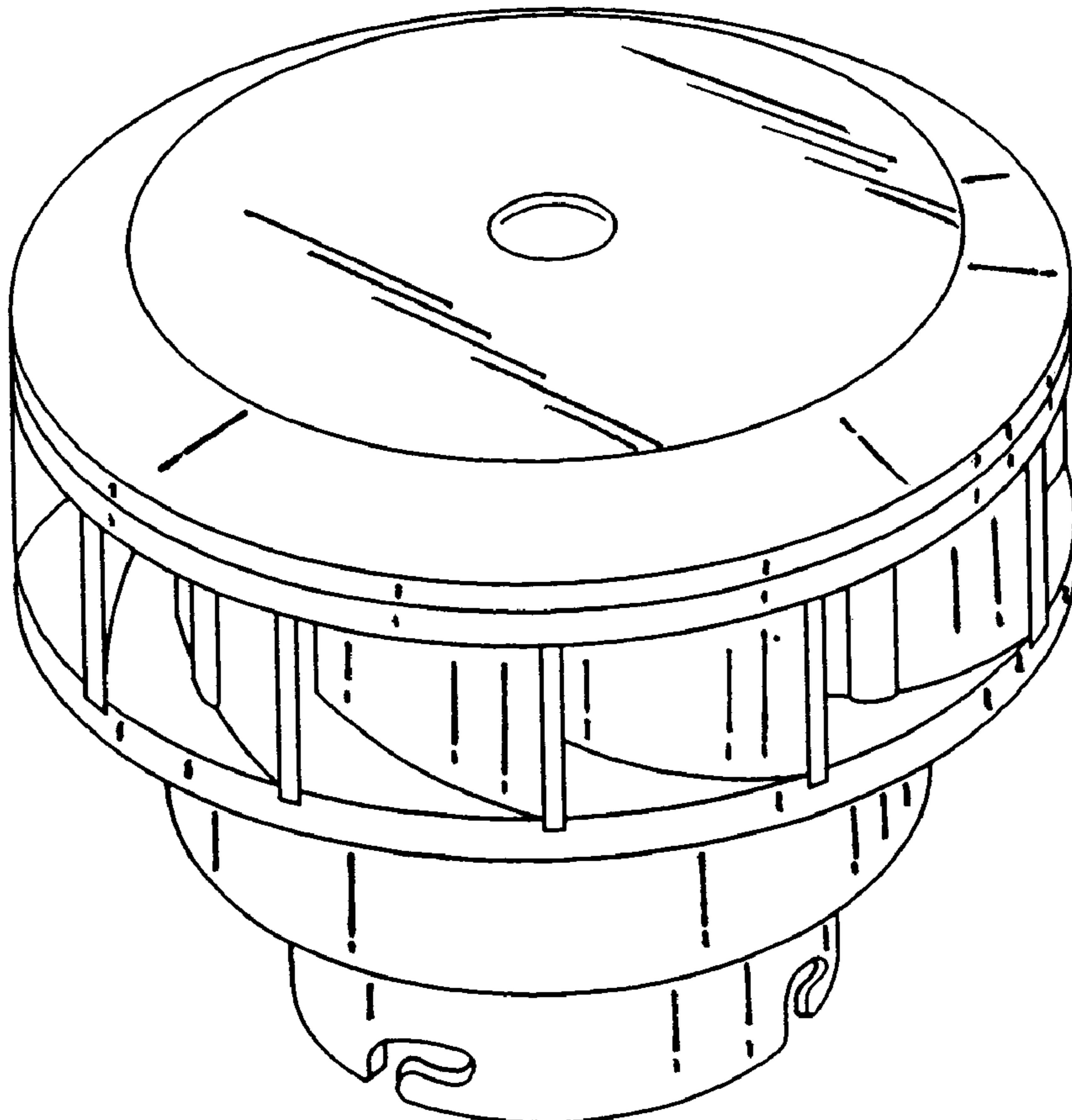

FIG. 1

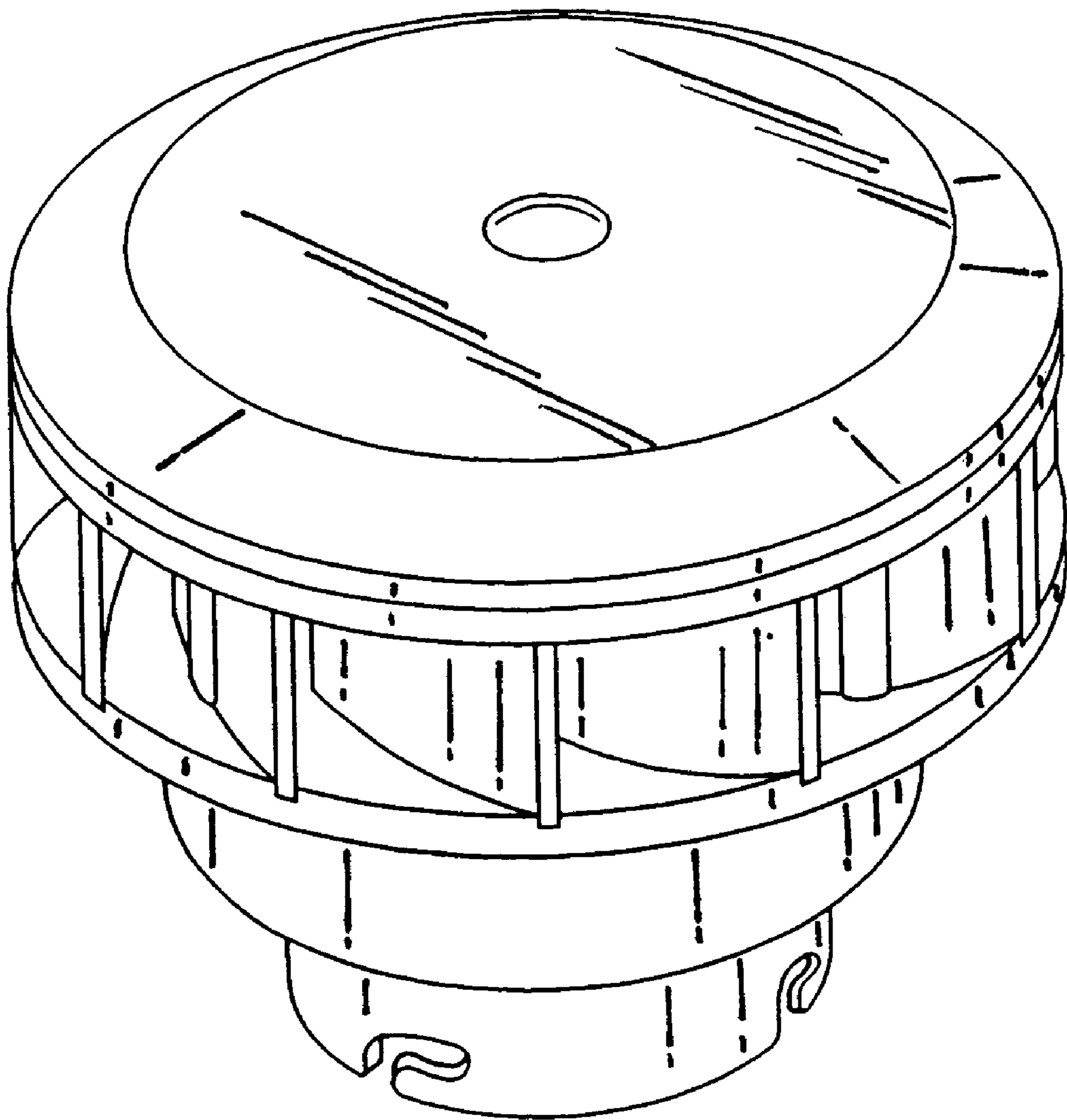

FIG. 2

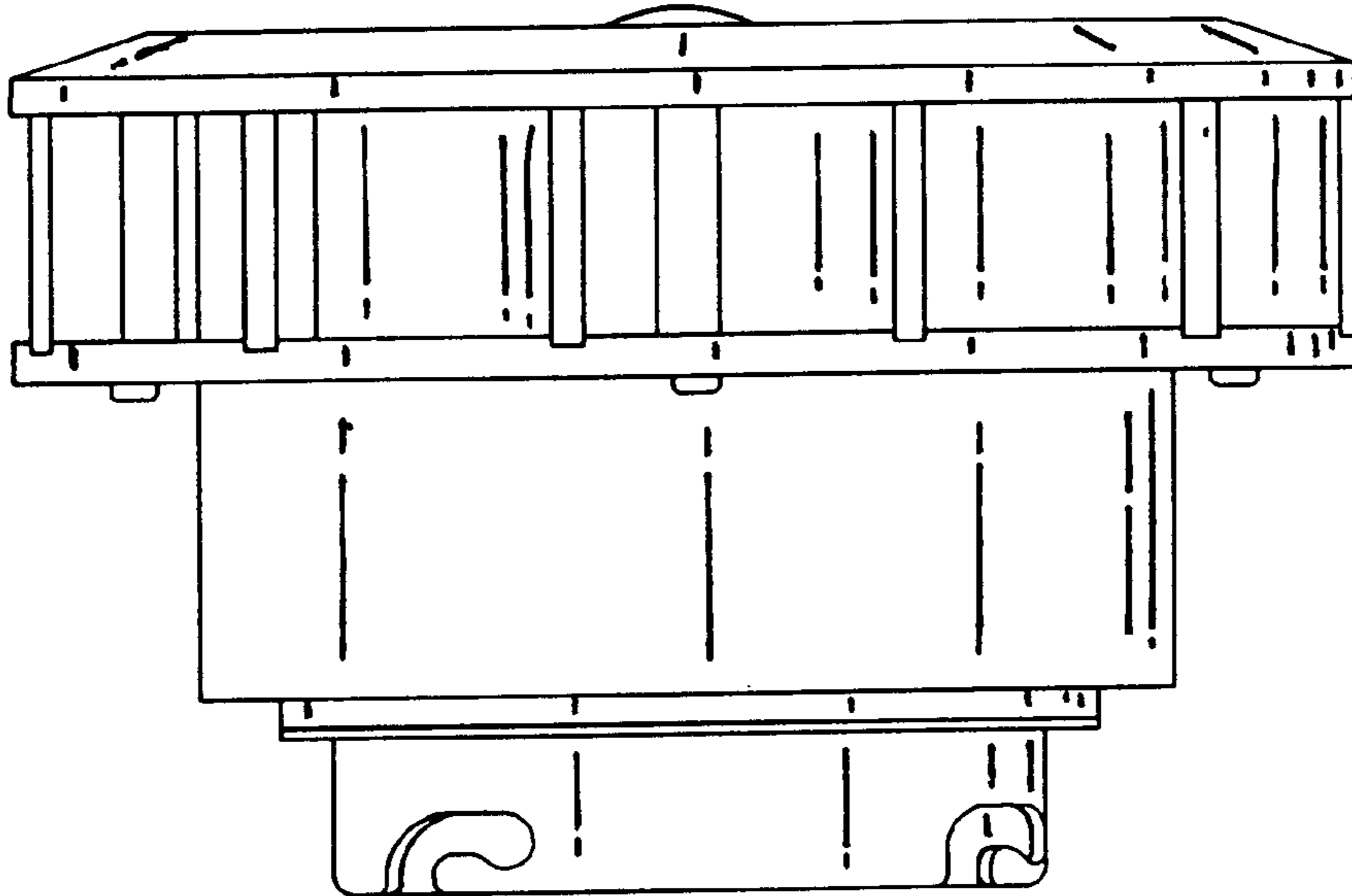

FIG. 3

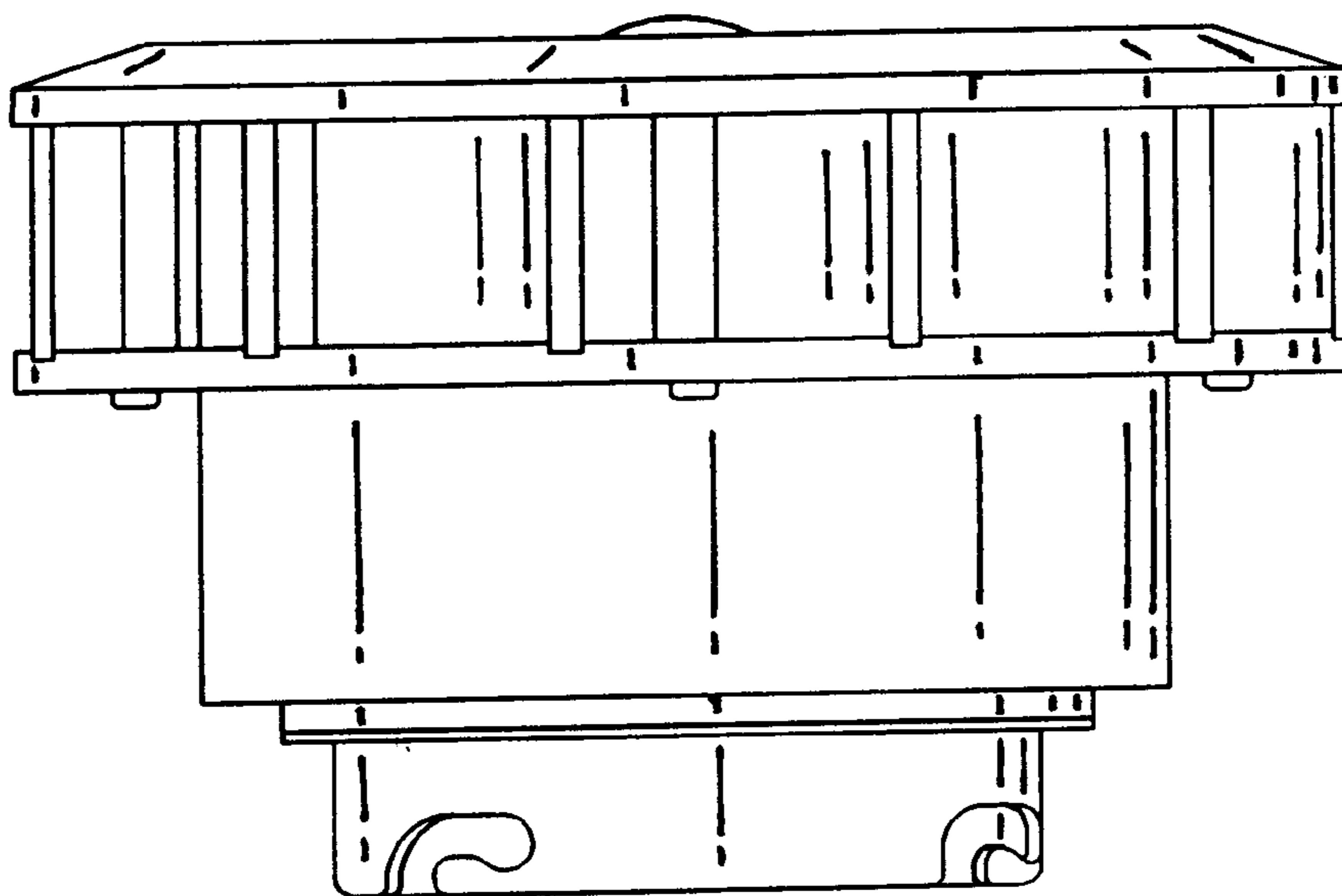

FIG. 4

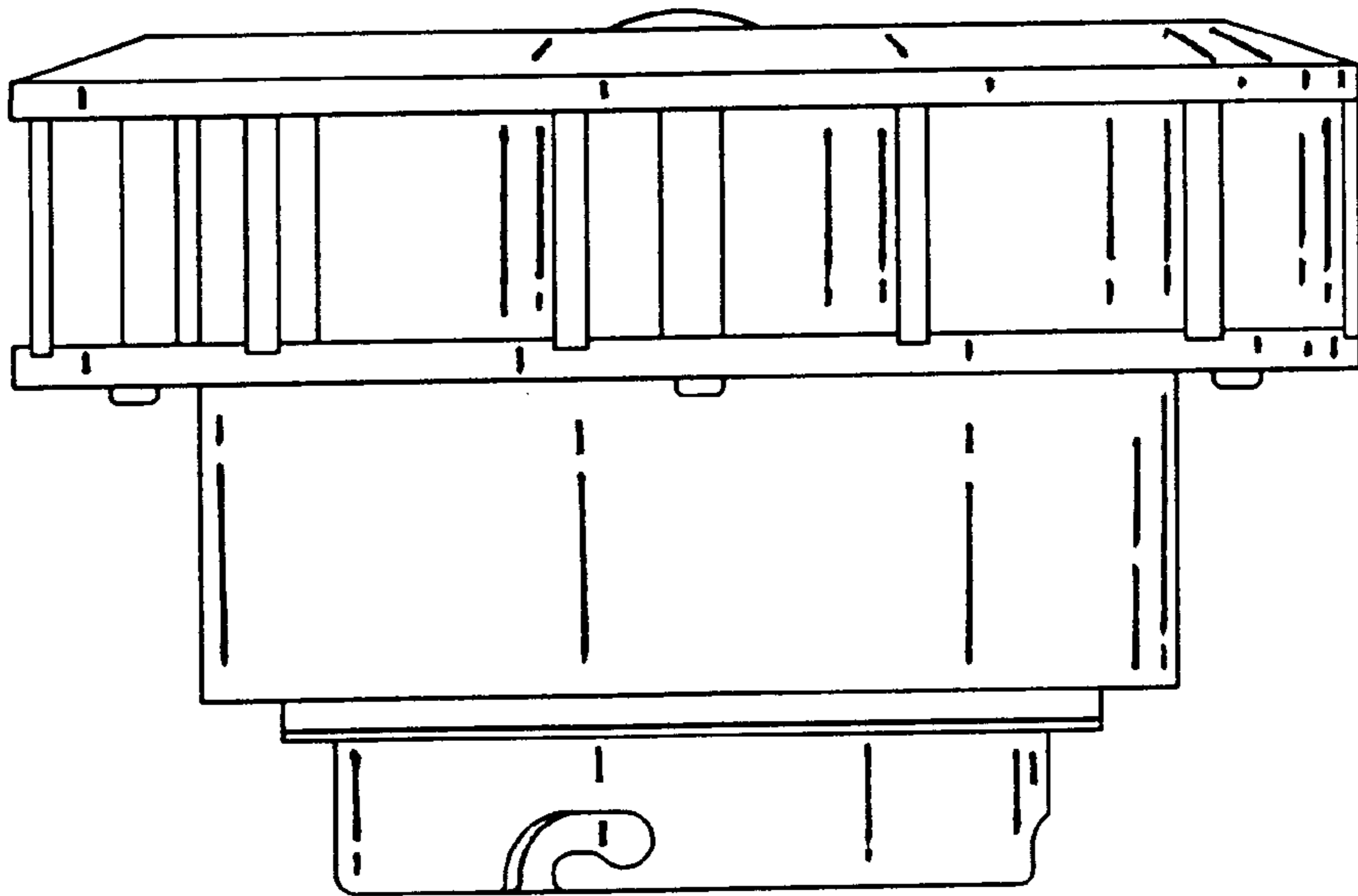

FIG. 5

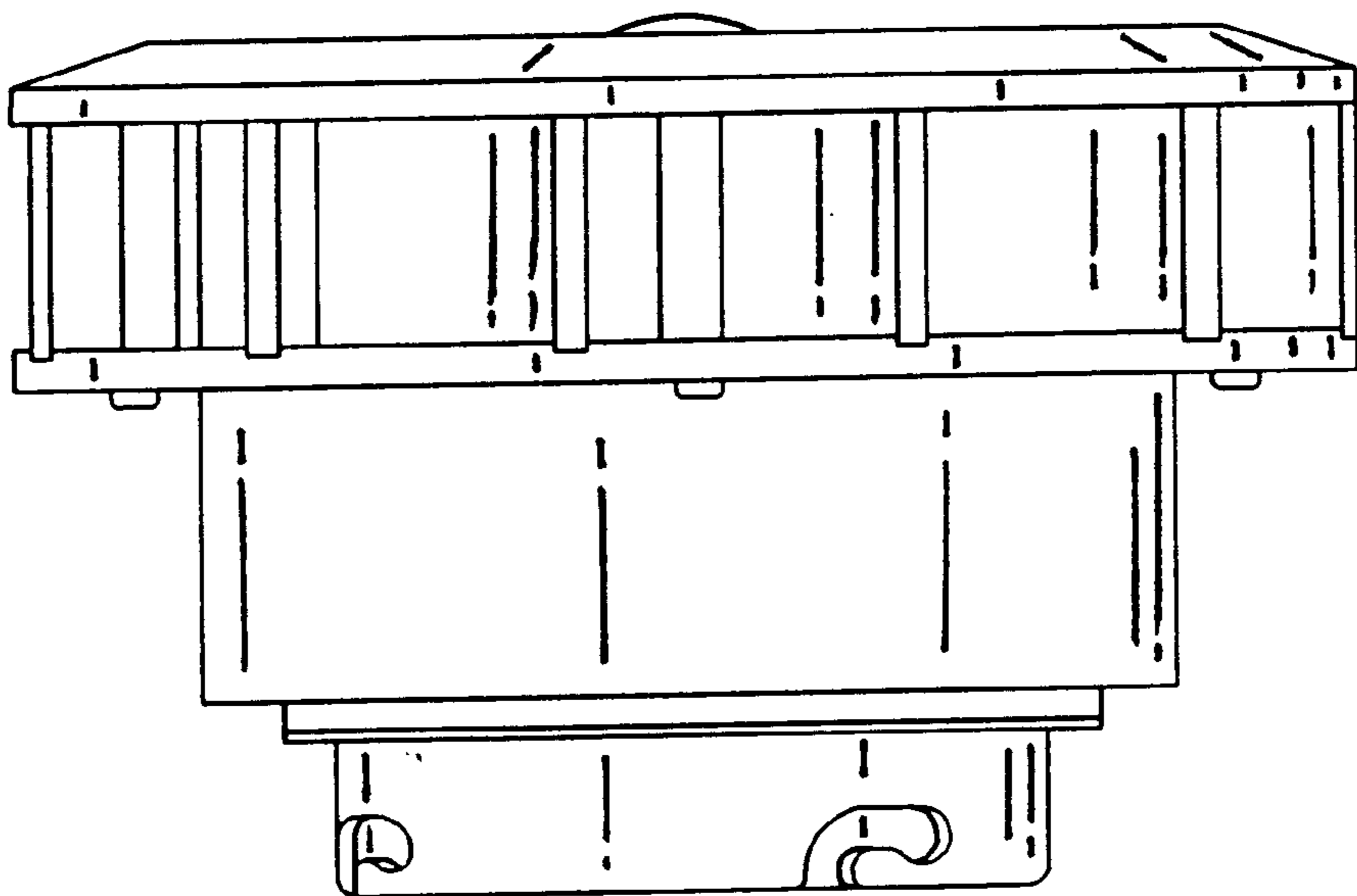

FIG. 6

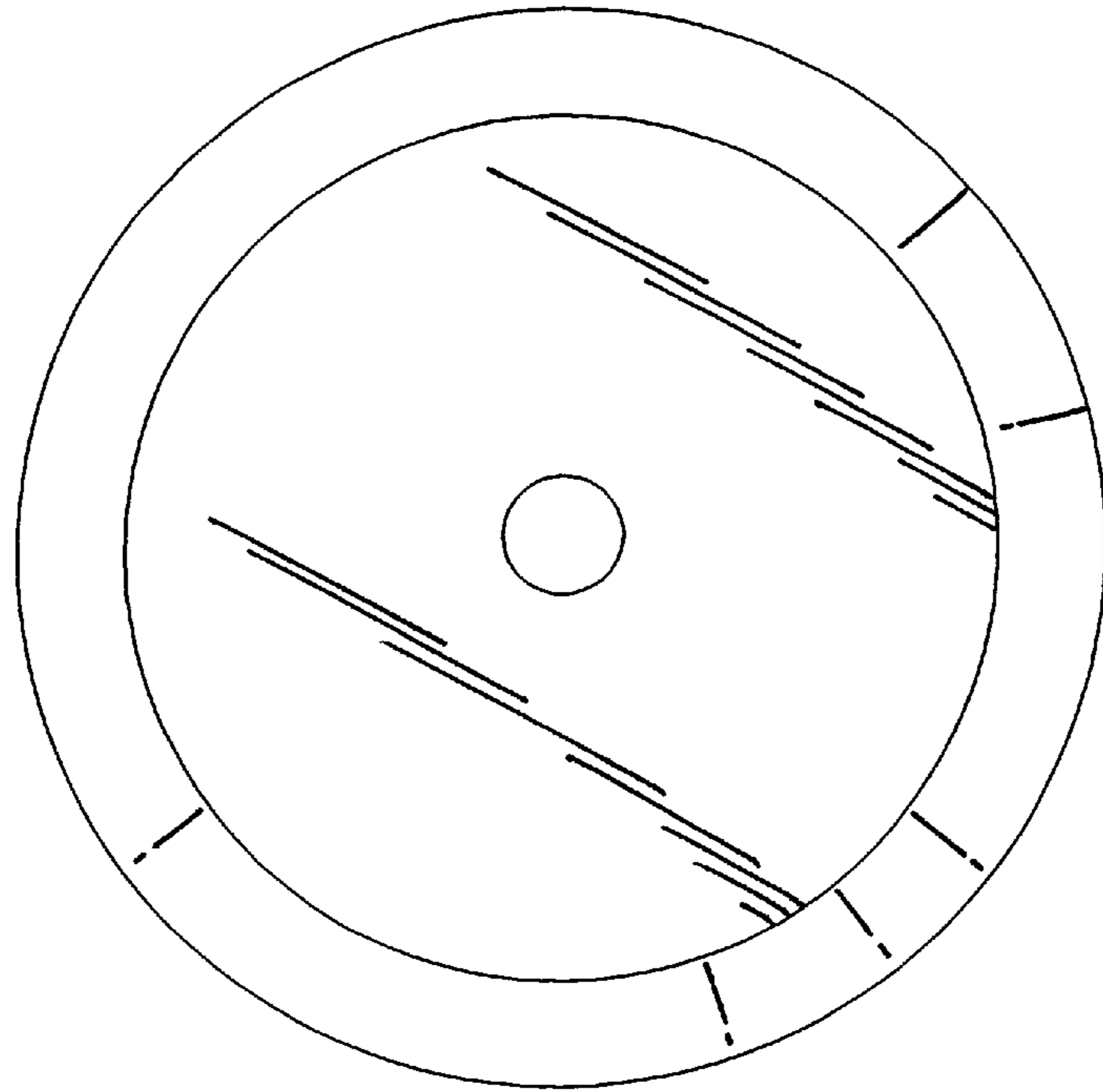

FIG. 7

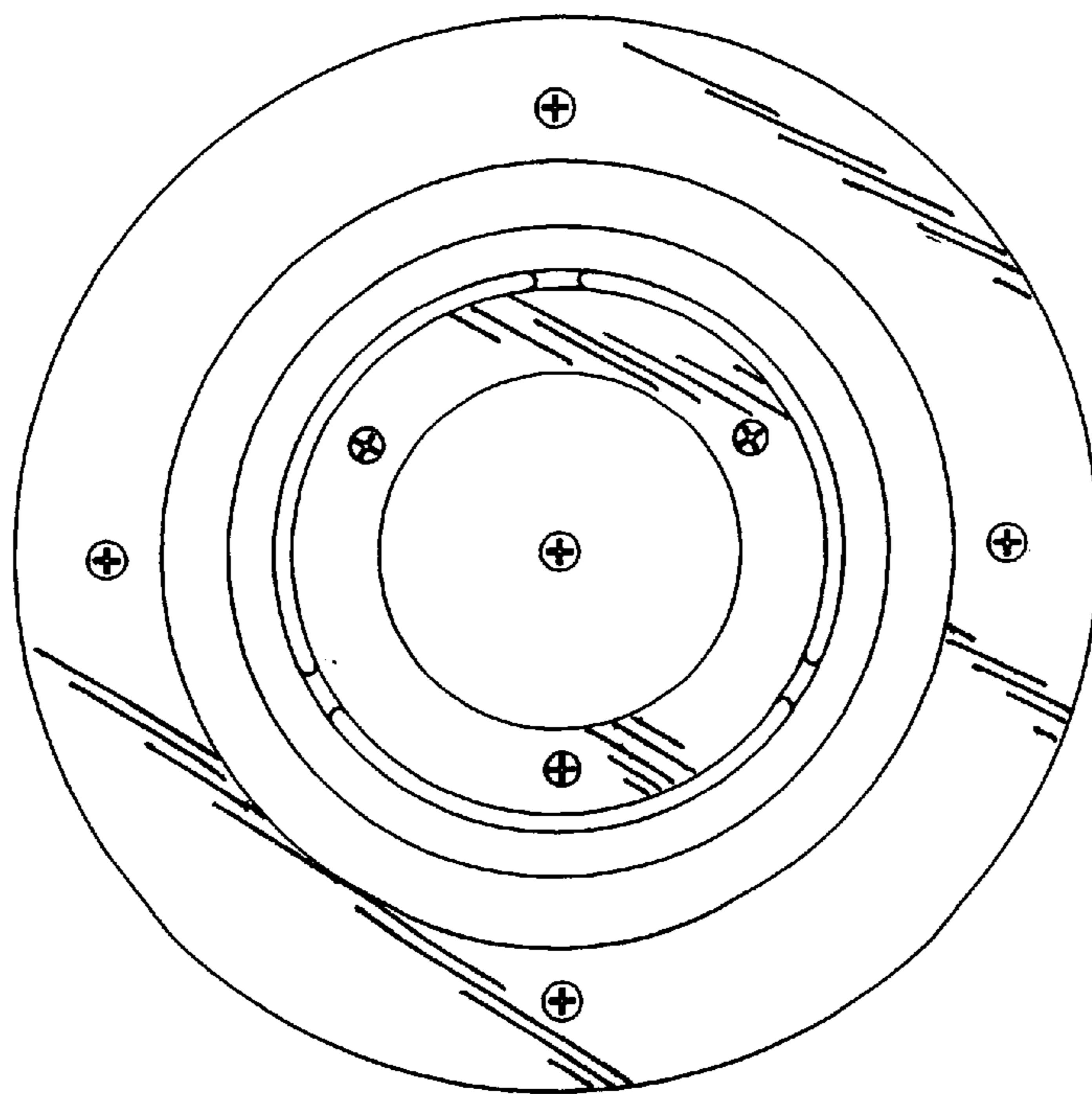

FIG. 8

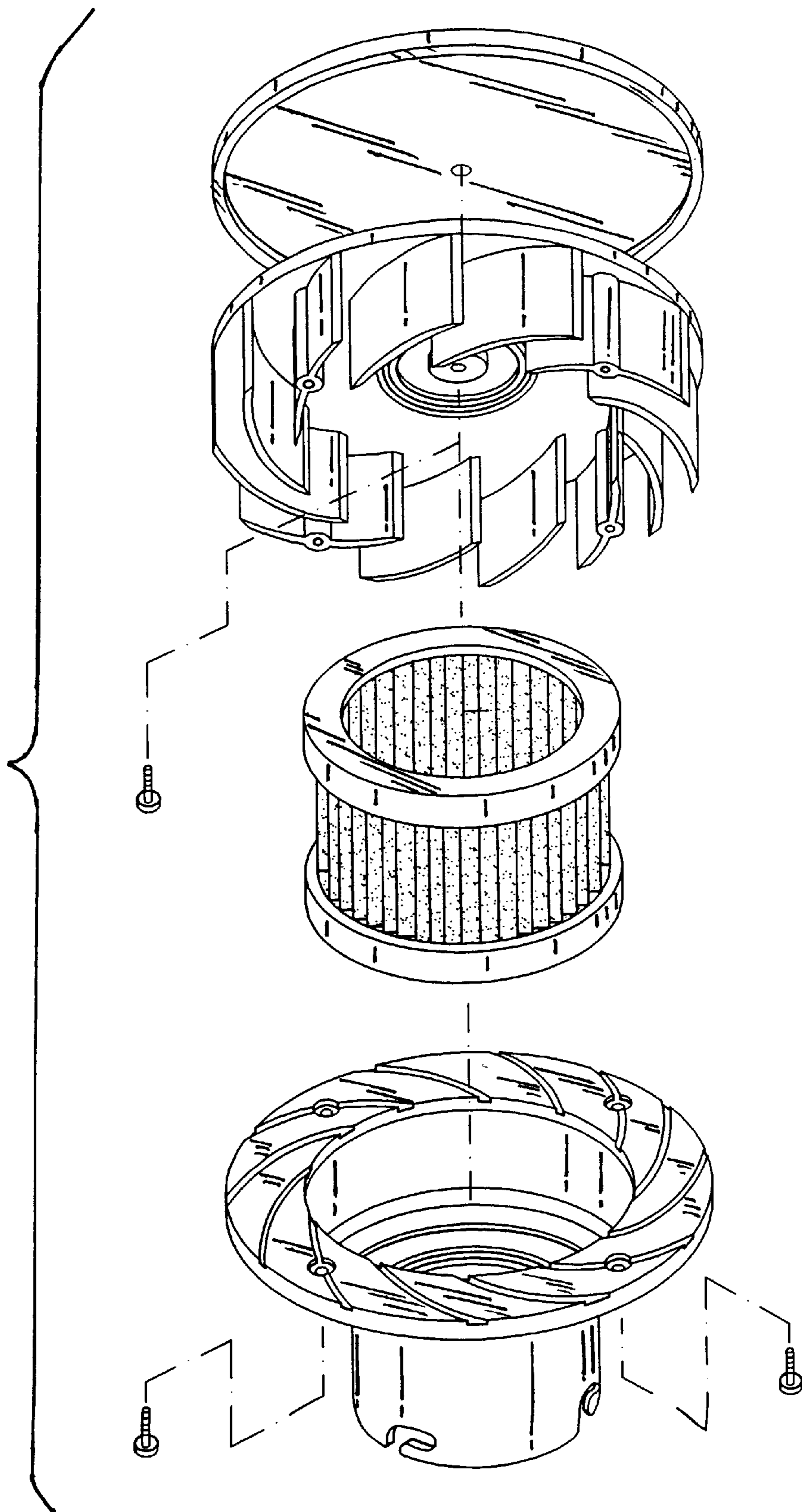

FIG. 9

