



US00D436337S

(12) **United States Design Patent**
Yu

(10) **Patent No.:** **US D436,337 S**

(45) **Date of Patent:** **** Jan. 16, 2001**

(54) **WHEEL HUB**

(76) Inventor: **Mark Yu**, 9F, No. 83,
Wu-Chuan-Hsi-San St., Hsi Dist.,
Taichung City (TW)

(**) Term: **14 Years**

(21) Appl. No.: **29/128,656**

(22) Filed: **Aug. 29, 2000**

(51) **LOC (7) Cl.** **12-16**

(52) **U.S. Cl.** **D12/207**

(58) **Field of Search** D12/204, 207,
D12/111, 115, 59-61; 301/105.1, 110.5,
124.2; 192/64; 280/250.1, 279

(56) **References Cited**

U.S. PATENT DOCUMENTS

- D. 23,742 * 10/1894 Bretz D12/207
- D. 157,539 * 2/1950 Rosten D12/207
- D. 340,888 * 11/1993 Ringle et al. D12/207 X
- D. 350,922 * 9/1994 Inatani D12/207 X
- D. 364,842 * 12/1995 Hoepfner et al. D12/207
- D. 365,310 * 12/1995 Chen D12/115
- D. 369,336 * 4/1996 Zemlicka et al. D12/207

- D. 381,310 * 7/1997 Zemlicka et al. D12/207
- D. 430,093 * 8/2000 Muraoka D12/207

* cited by examiner

Primary Examiner—Stacia Cadmus

(74) *Attorney, Agent, or Firm*—Ladas & Parry

(57) **CLAIM**

The ornamental design for a wheel hub, as shown and described.

DESCRIPTION

FIG. 1 is a perspective view of wheel hub showing my new design;
 FIG. 2 is a front elevational view thereof;
 FIG. 3 is a rear elevational view thereof;
 FIG. 4 is a left side elevational view thereof;
 FIG. 5 is a right side elevational view thereof;
 FIG. 6 is a top plan view thereof;
 FIG. 7 is a bottom plan view thereof; and,
 FIG. 8 is a reduced perspective view when in use.
 The broken line showing of environment is for illustrative purposes only and forms no part of the claimed design.

1 Claim, 5 Drawing Sheets

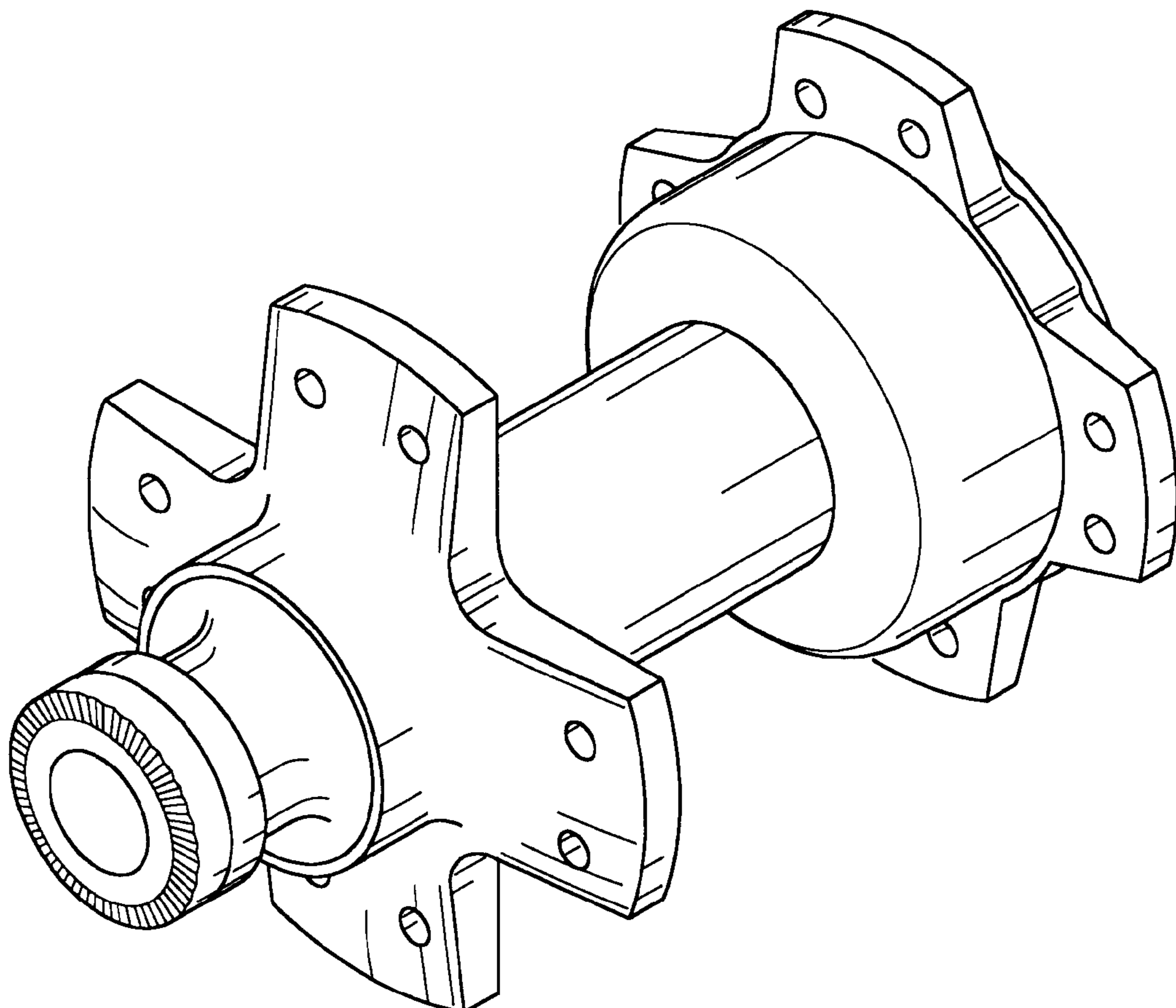

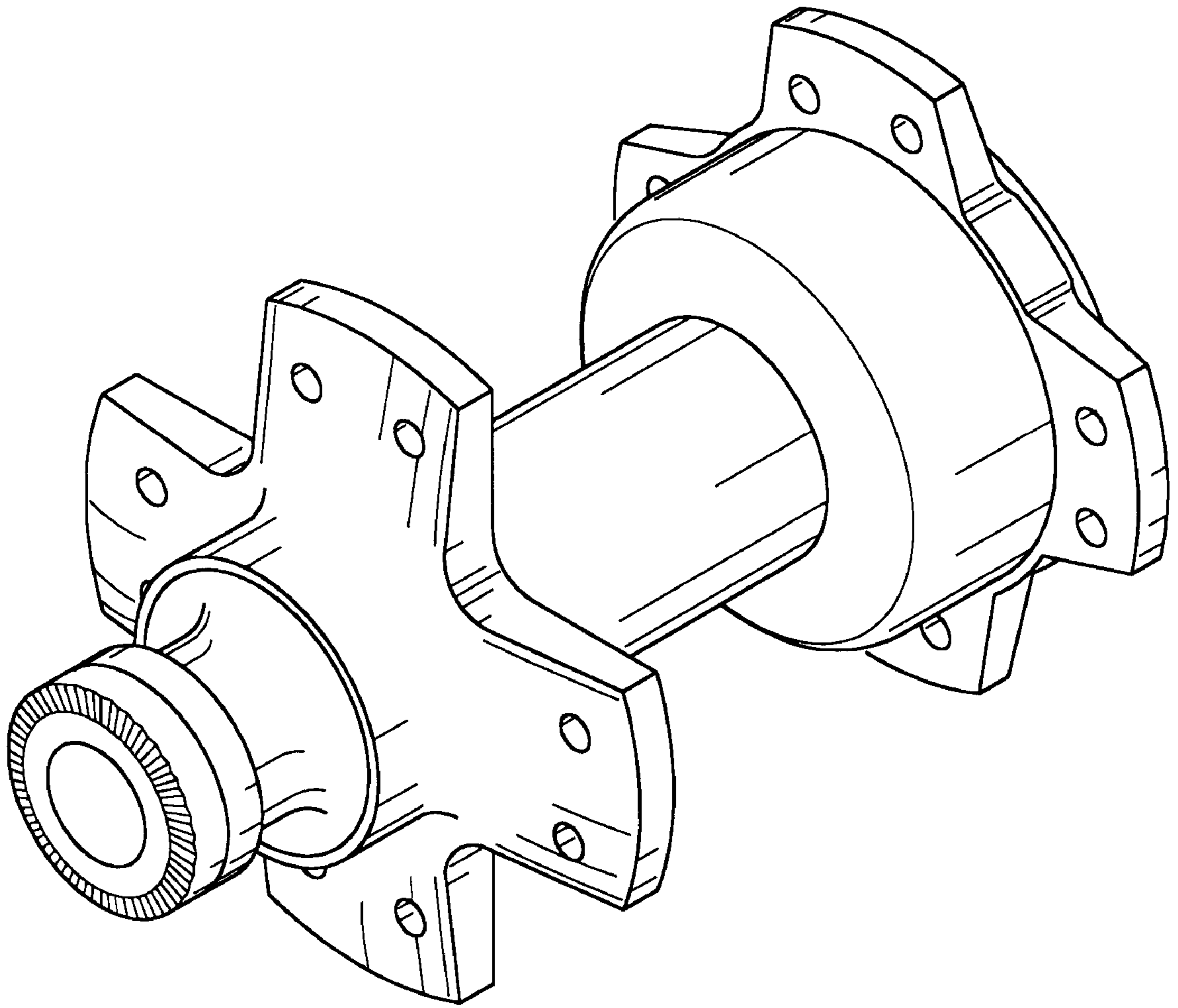

FIG. 1

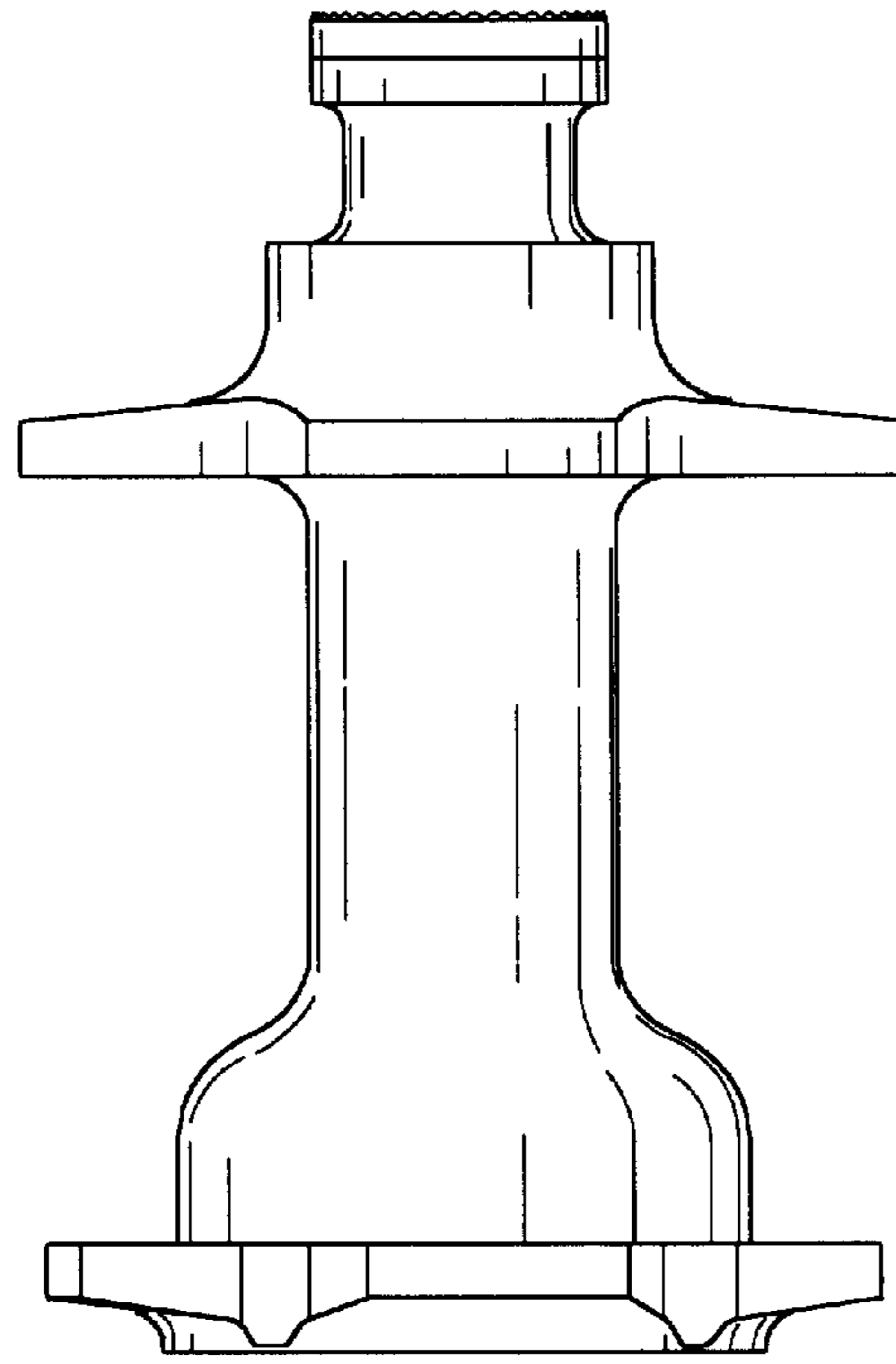

FIG. 3

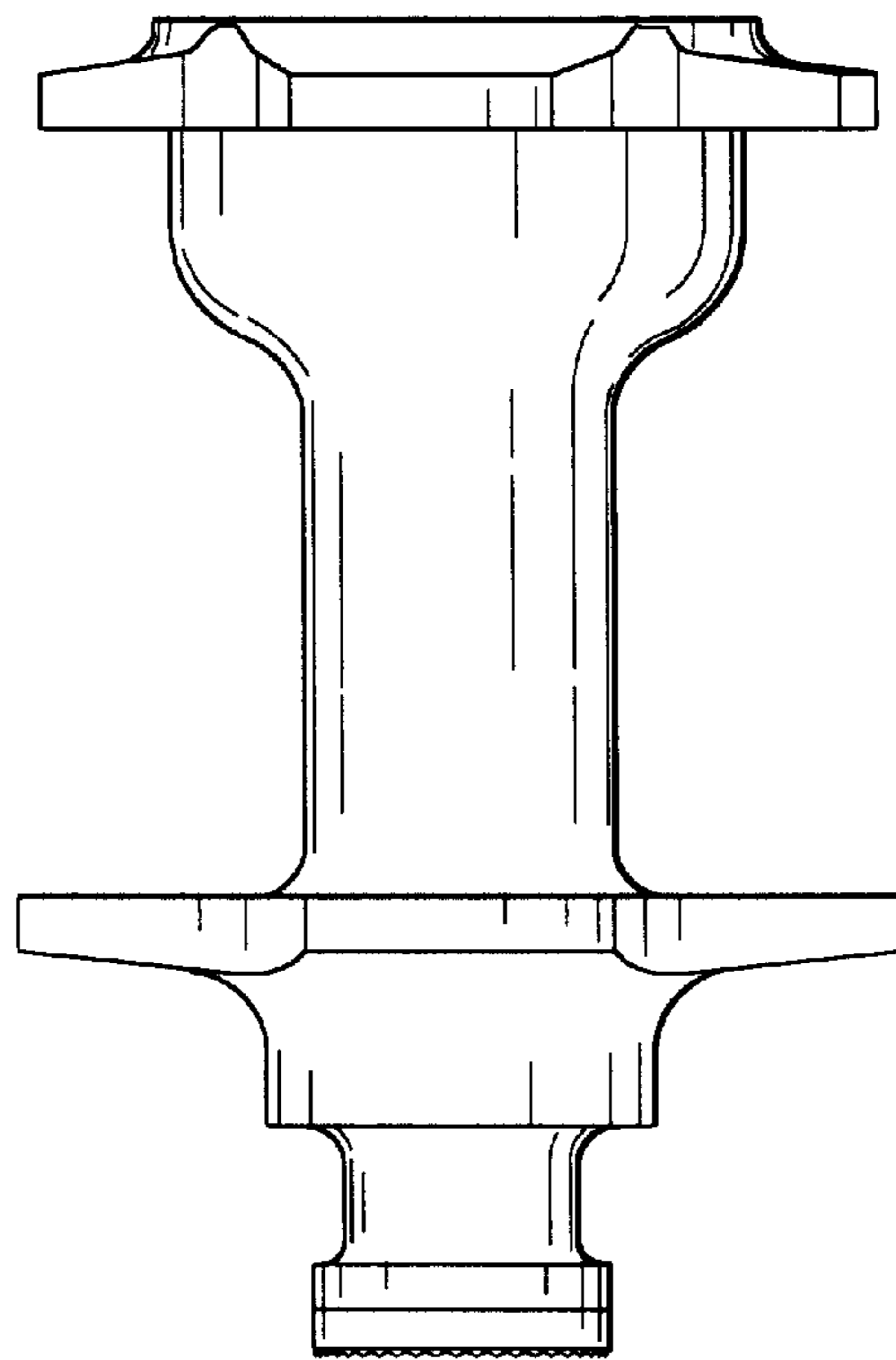

FIG. 2

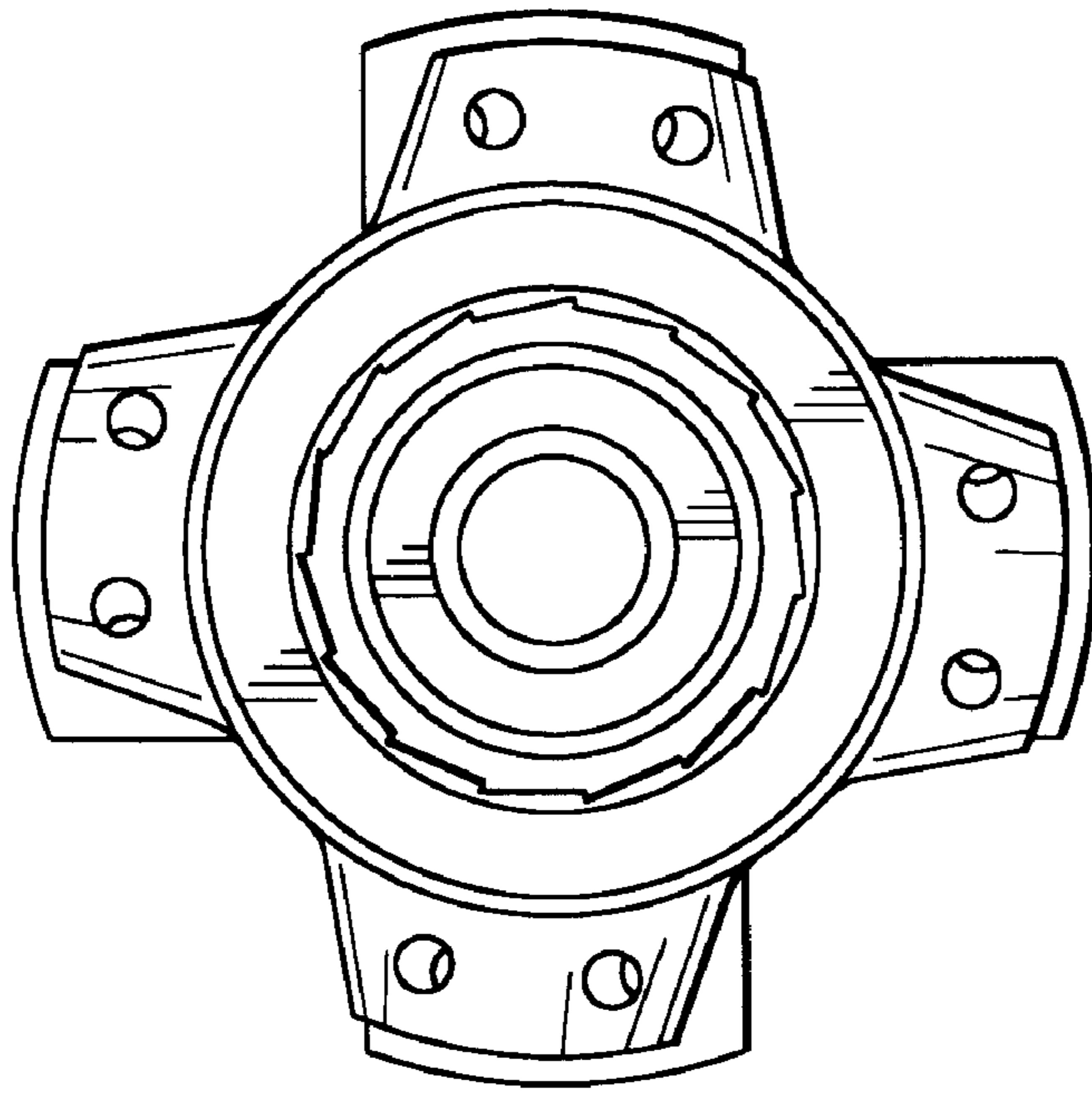

FIG. 5

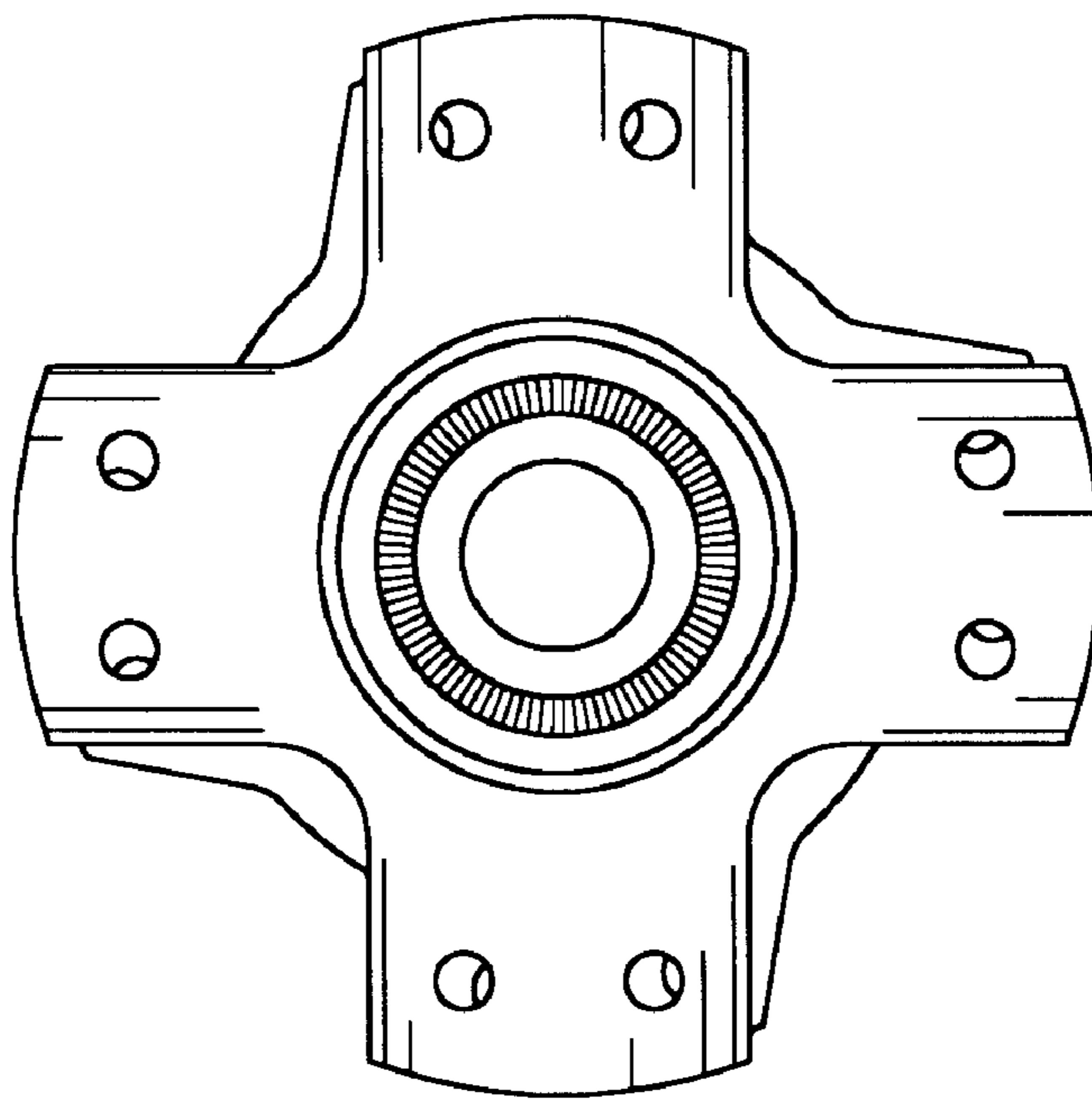

FIG. 4

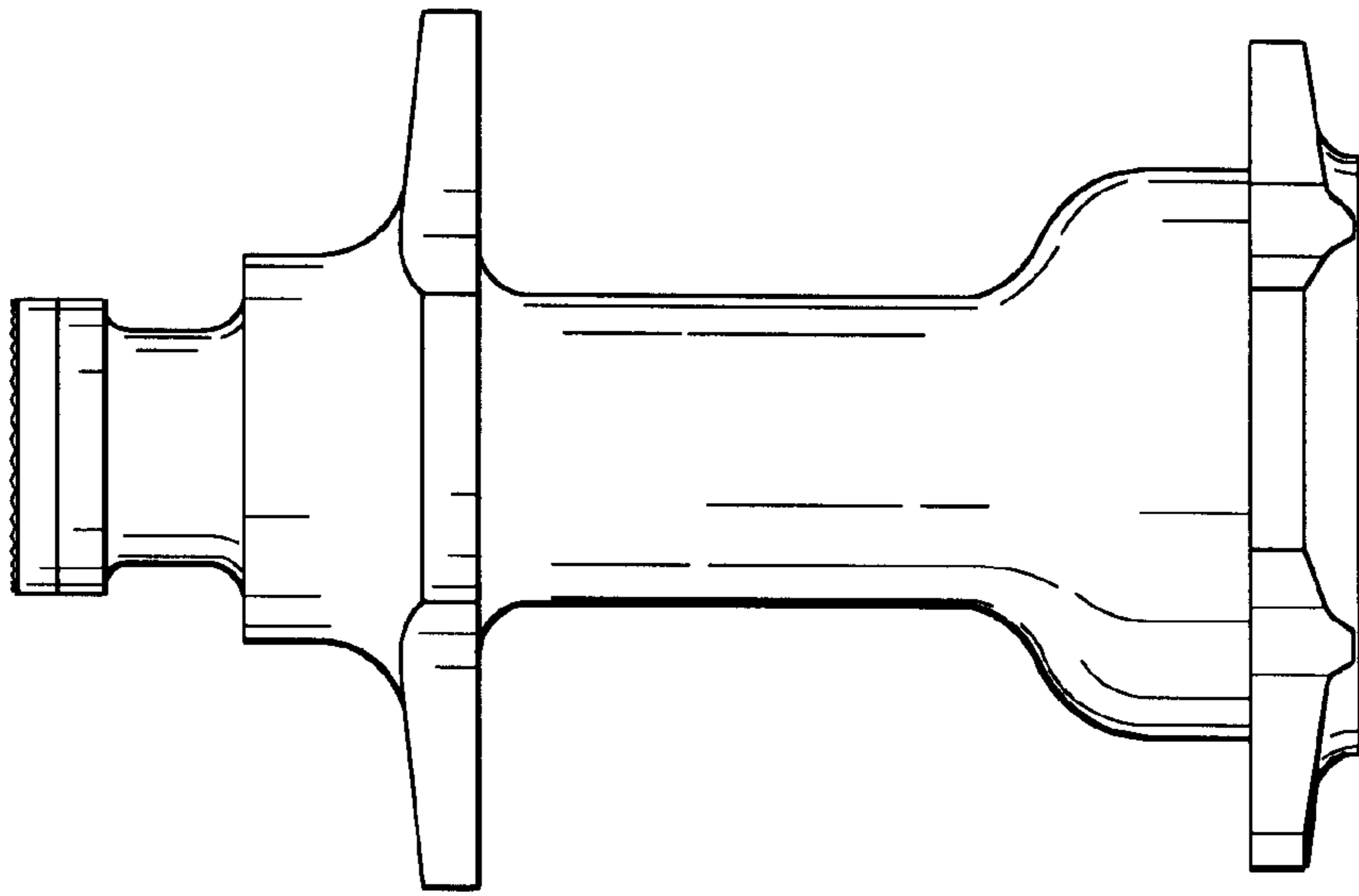

FIG. 6

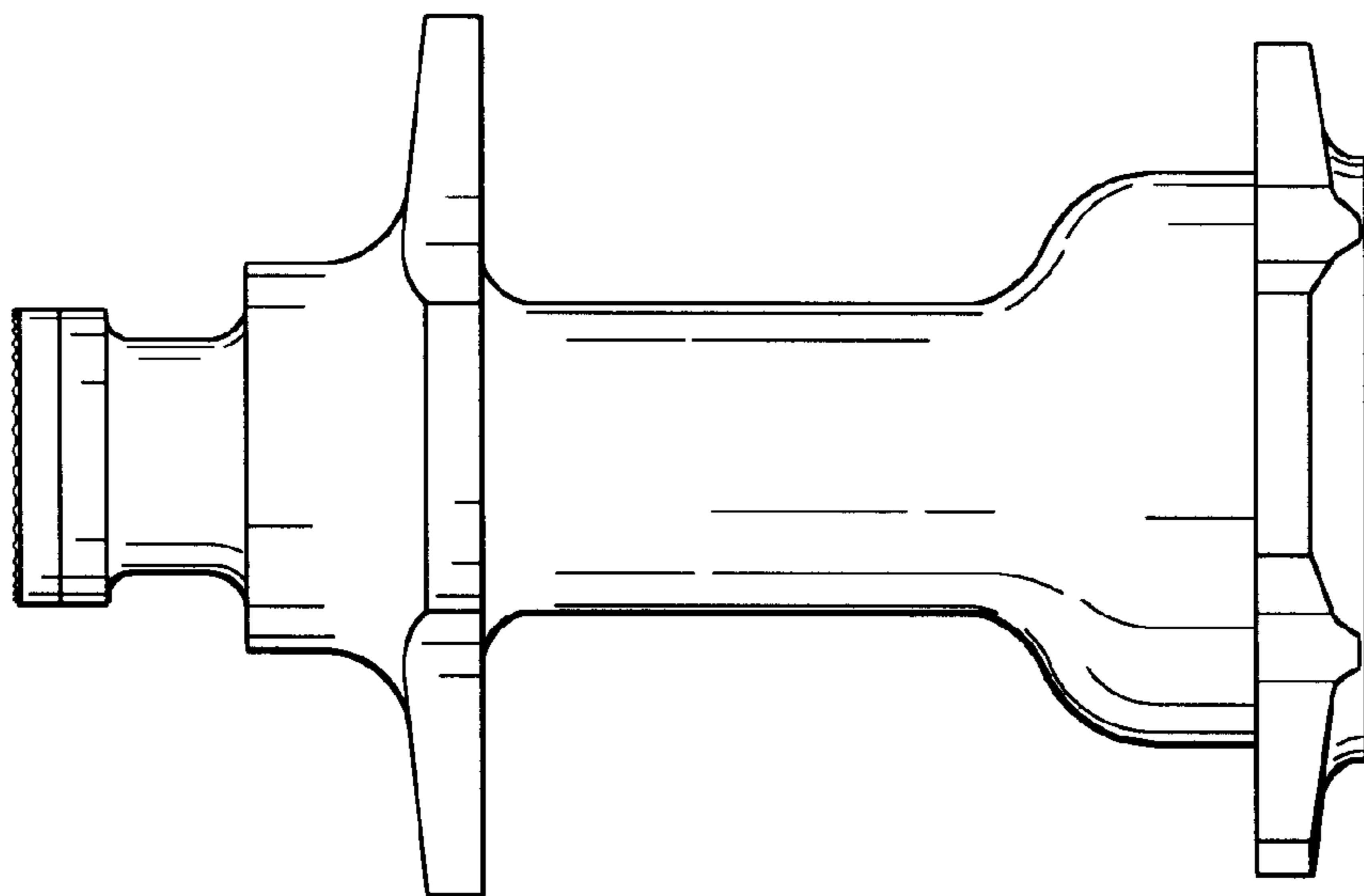

FIG. 7

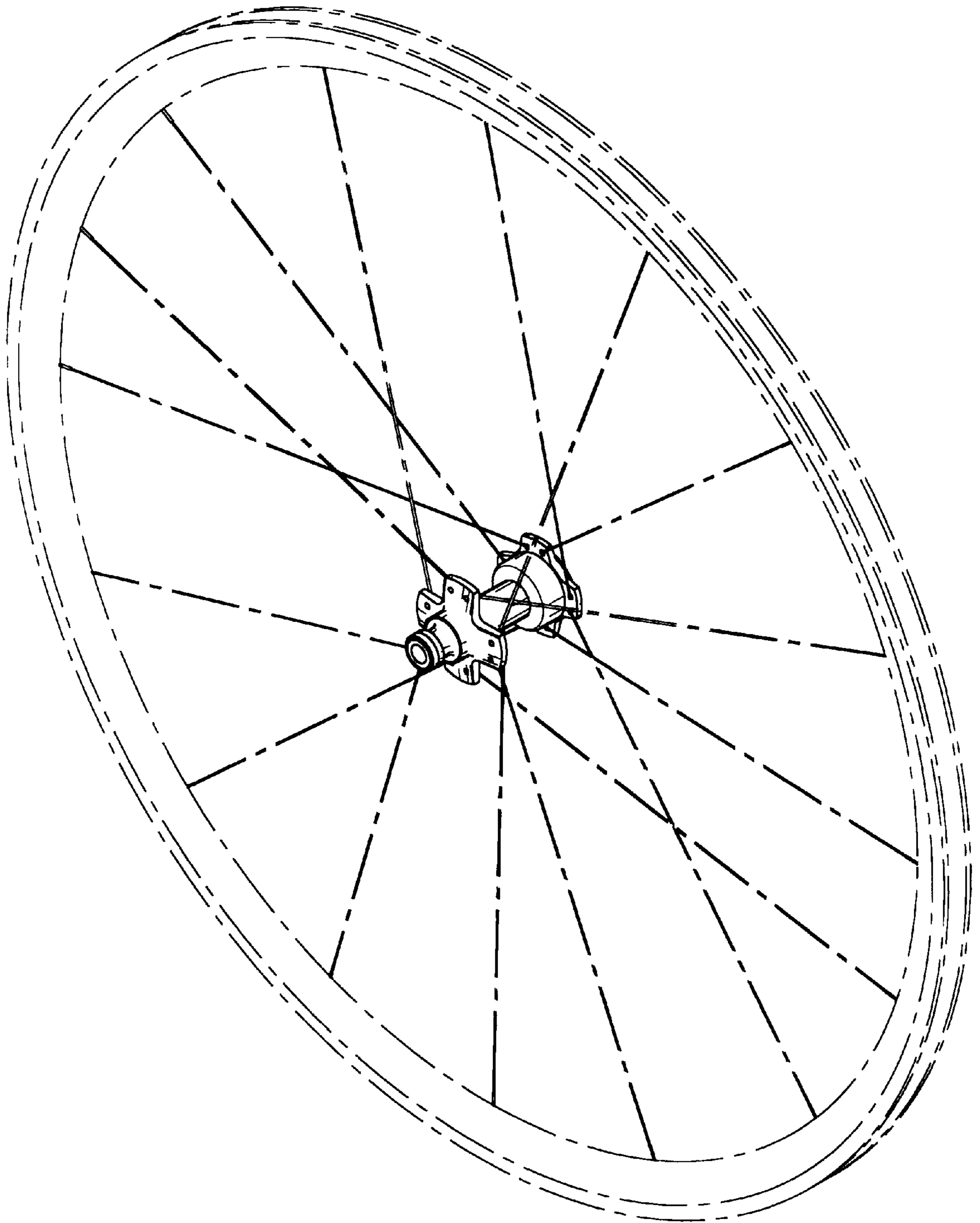

FIG. 8