



US00D436141S

(12) **United States Design Patent**
Lerch

(10) **Patent No.:** **US D436,141 S**

(45) **Date of Patent:** **** Jan. 9, 2001**

(54) **CHILDREN'S RIDE-ON VEHICLE**

5,106,150 4/1992 Litwicki .

(75) Inventor: **Karl D. Lerch**, East Aurora, NY (US)

5,294,153 3/1994 Nolan .

5,409,263 4/1995 Klawitter .

(73) Assignee: **Mattel, Inc.**, El Segundo, CA (US)

OTHER PUBLICATIONS

(**) Term: **14 Years**

Fisher-Price Toy Fair Catalog, p. 86, 1998.

(21) Appl. No.: **29/118,427**

* cited by examiner

(22) Filed: **Feb. 7, 2000**

Primary Examiner—Raphael Barkai

(51) **LOC (7) Cl.** **21-01**

(74) *Attorney, Agent, or Firm*—Kolisch, Hartwell,
Dickinson, McCormack & Heuser

(52) **U.S. Cl.** **D21/433**

(58) **Field of Search** D21/419-435,
D21/533, 537, 548-552; D12/1, 87, 88,
90-92; 446/447, 428, 456, 465, 470; 280/1.13,
87.01, 87.021, 828, 796, 263, 281.1, 282;
180/72

(57) **CLAIM**

The ornamental design for a children's ride-on vehicle, as shown and described.

(56) **References Cited**

DESCRIPTION

U.S. PATENT DOCUMENTS

D. 345,394	*	3/1994	Chen	D21/433
D. 408,869	*	4/1999	Patmont	D21/433
D. 410,258	*	5/1999	Lerch	D21/433
D. 410,502	*	6/1999	Harrod	D21/433
3,887,210	*	6/1975	Funke	280/87.01
4,629,023		12/1986	Carpanelli et al.	.	
4,799,708		1/1989	Handa et al.	.	
5,094,313		3/1992	Mauws	.	

FIG. 1 is a front perspective view of a children's ride-on vehicle showing the claimed design.

FIG. 2 is a right side elevation view of the vehicle of FIG. 1.

FIG. 3 is a left side elevation view of the vehicle of FIG. 1.

FIG. 4 is a top plan view of the vehicle of FIG. 1.

FIG. 5 is a front elevation view of the vehicle of FIG. 1; and,

FIG. 6 is a rear elevation view of the vehicle of FIG. 1.

In the drawings, the bottom of the vehicle forms no part of the claimed design.

1 Claim, 6 Drawing Sheets

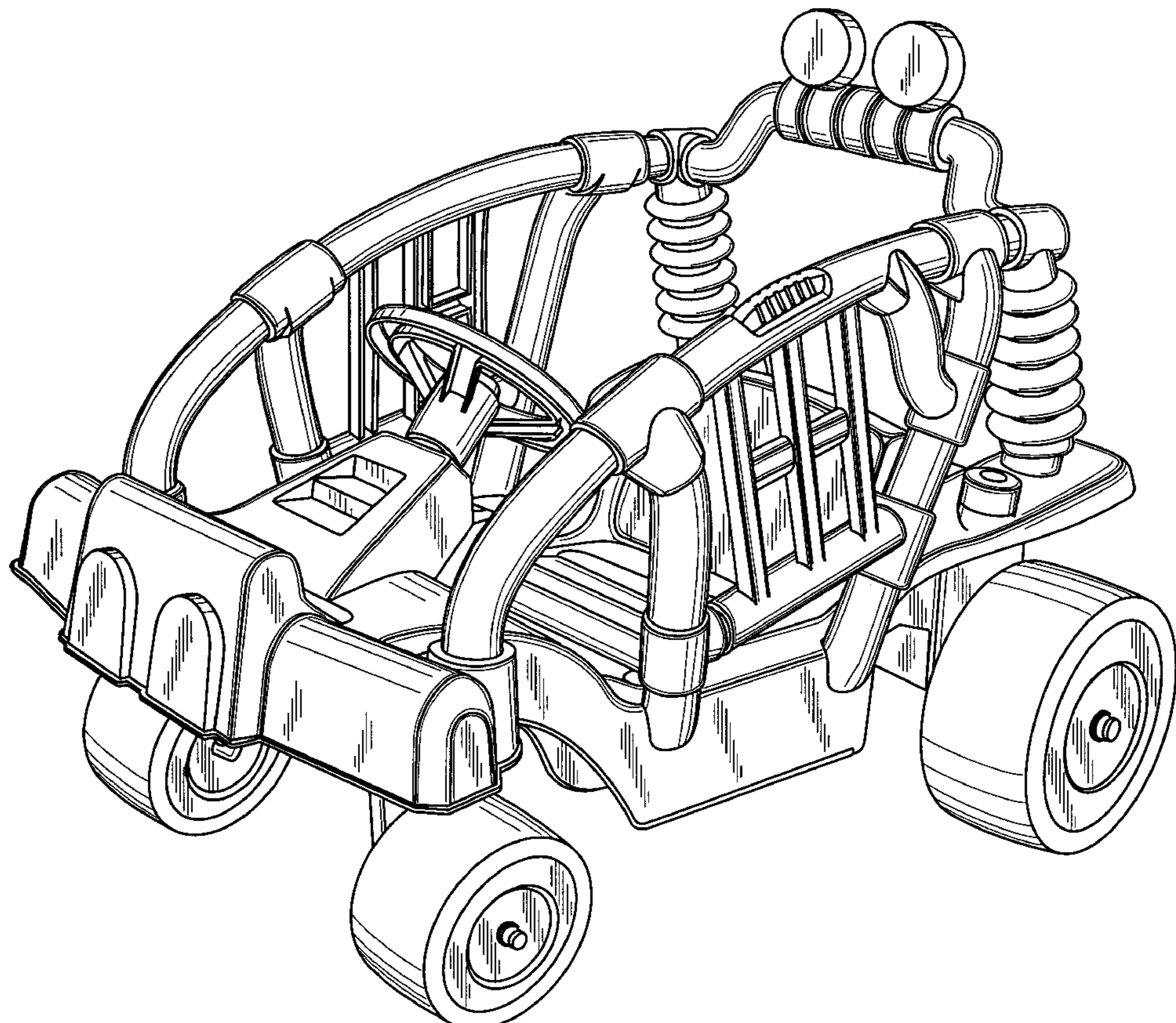

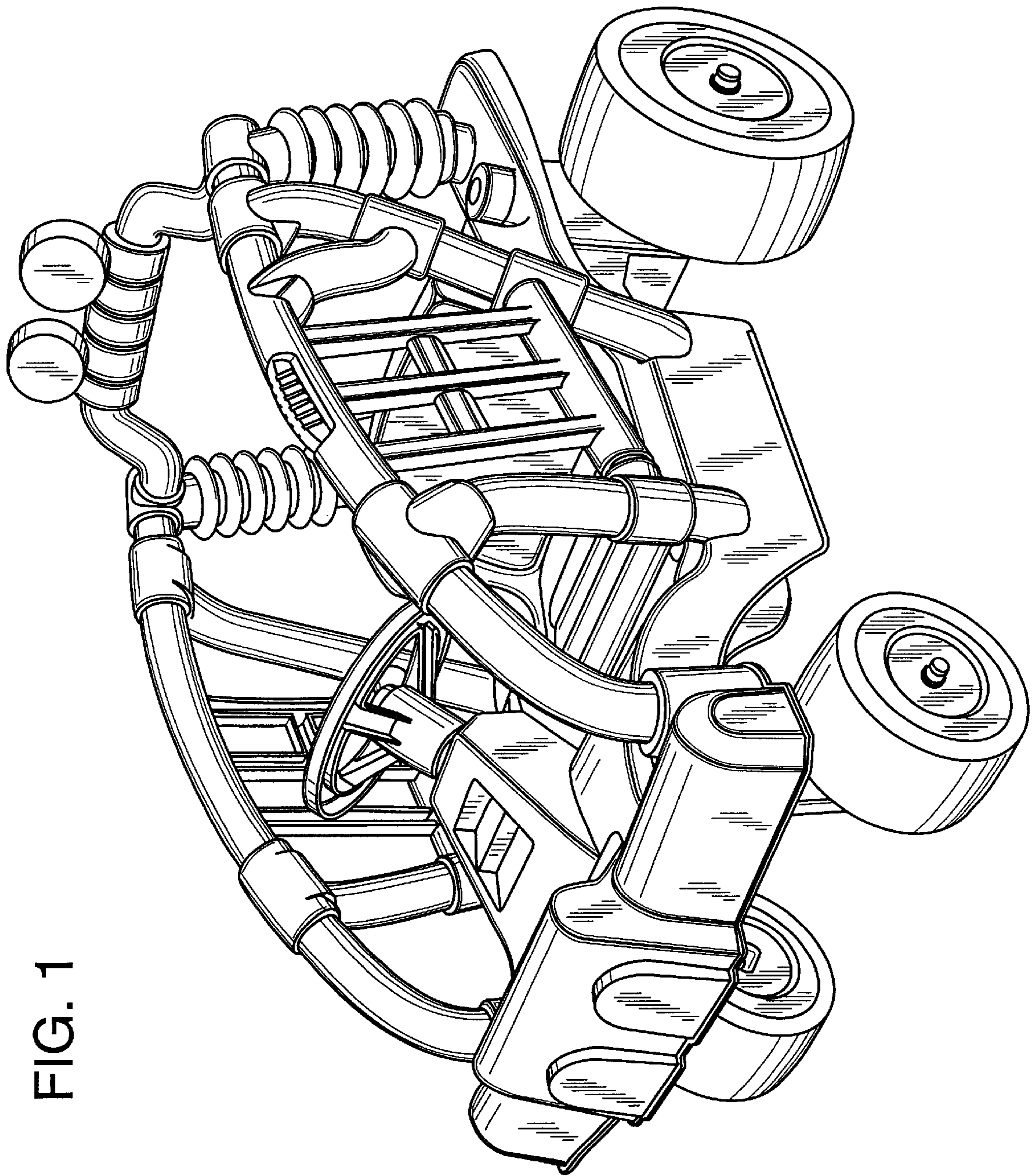
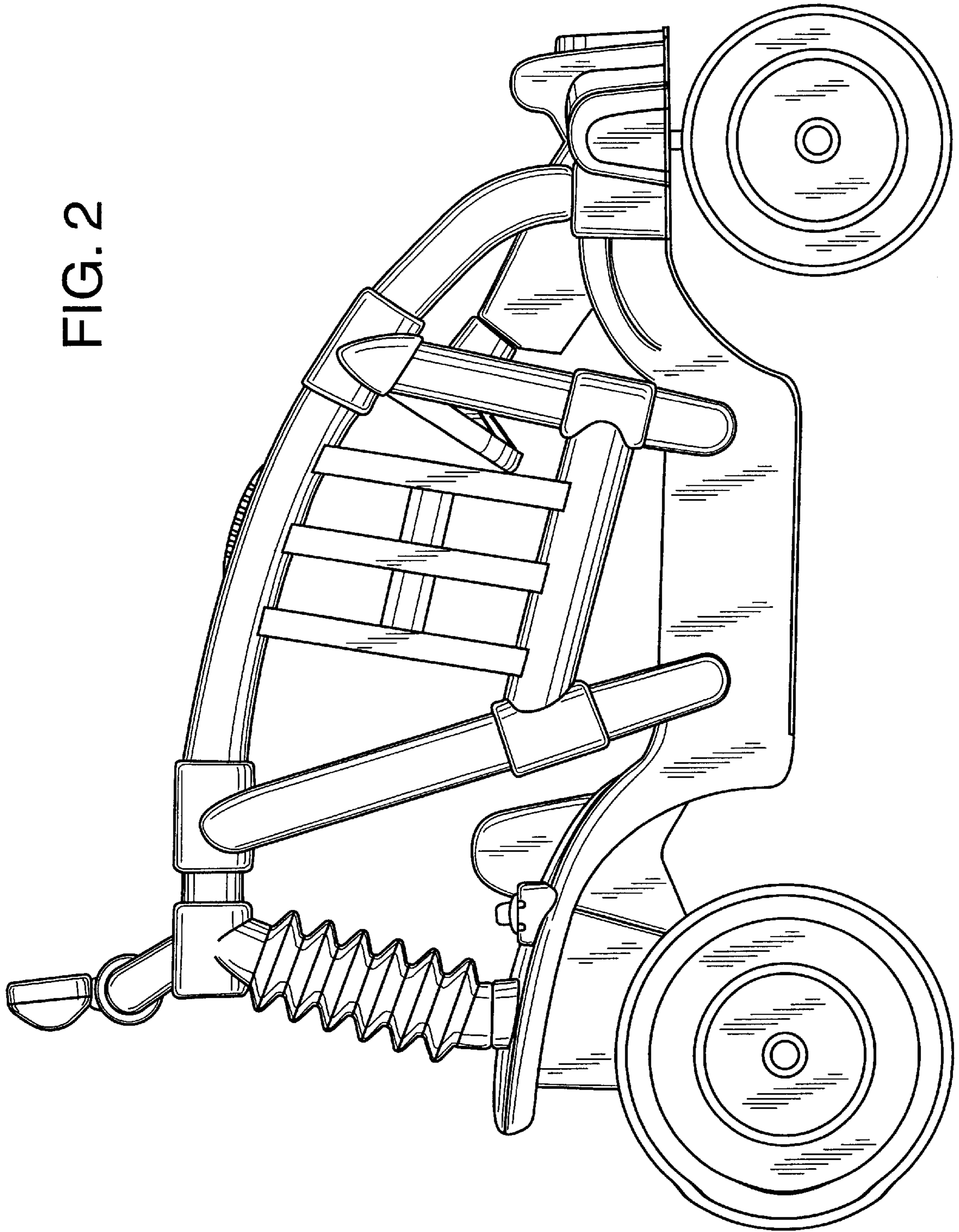

FIG. 1

FIG. 2



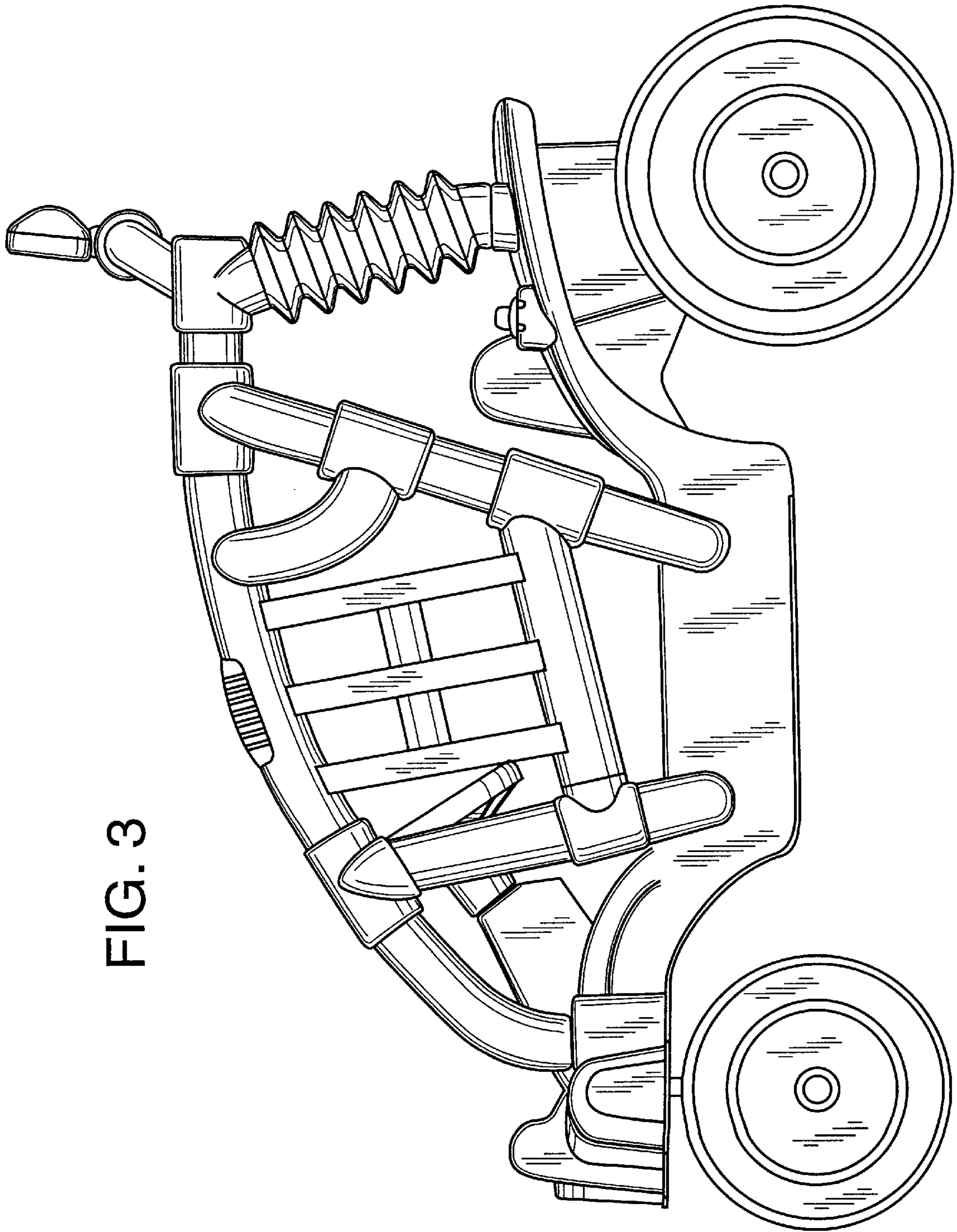

FIG. 3

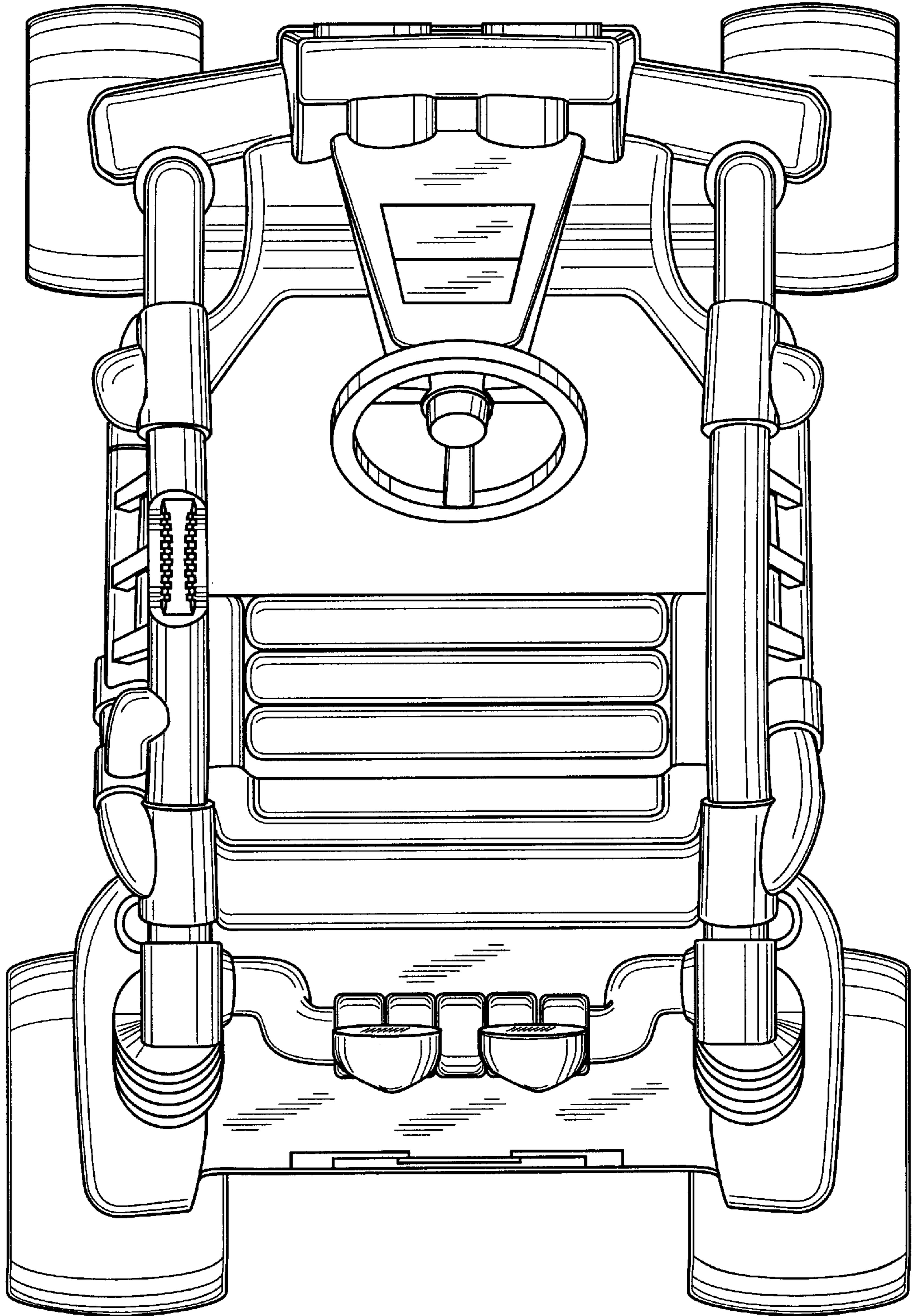

FIG. 4

FIG. 5

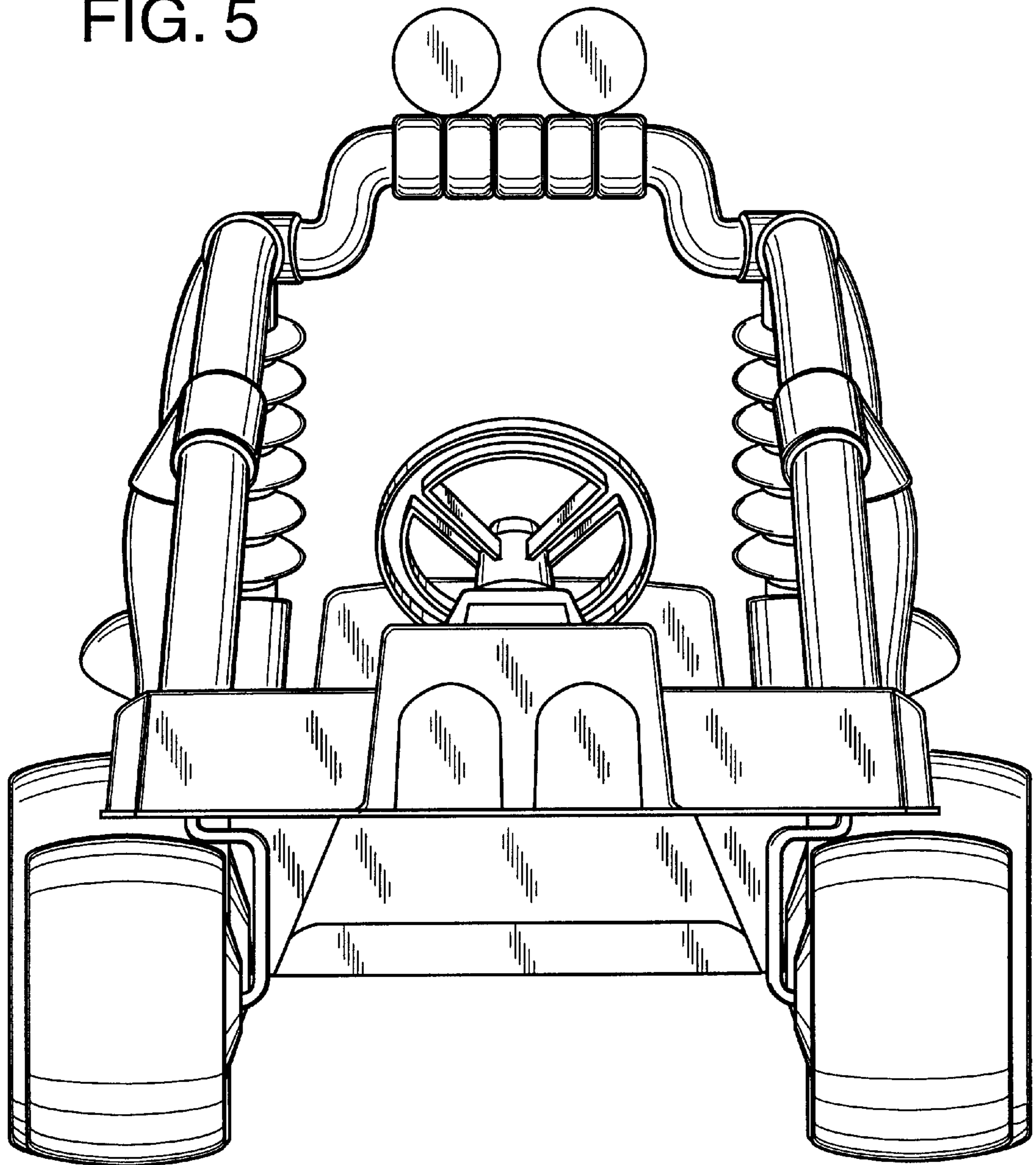

FIG. 6

