



US00D435565S

United States Patent [19]
Barani

[11] **Patent Number: Des. 435,565**

[45] **Date of Patent: ** Dec. 26, 2000**

[54] **LINK FOR TRACK OF VEHICLE**

[75] Inventor: **Stefano Barani**, Spilamberto, Italy

[73] Assignee: **Italtractor ITM S.p.A.**, Castelvetro, Italy

[**] Term: **14 Years**

[21] Appl. No.: **29/096,427**

[22] Filed: **Nov. 12, 1998**

[30] **Foreign Application Priority Data**

May 14, 1998 [IT] Italy BO9800022

[51] **LOC (7) Cl.** **15-04**

[52] **U.S. Cl.** **D15/28**

[58] **Field of Search** D15/10, 22-26,
D15/28; 59/80; 305/185-187, 199

[56] **References Cited**

U.S. PATENT DOCUMENTS

D. 338,020	8/1993	Taft	D15/28
4,222,616	9/1980	Brewer	305/187
4,449,357	5/1984	Balitch	59/30
4,553,791	11/1985	Blair	305/186
5,887,958	3/1999	Bissi et al.	305/185

OTHER PUBLICATIONS

Caterpillar 1990 Brochure, p. 3. Link.

Primary Examiner—Sandra L. Morris

Attorney, Agent, or Firm—Guido Modiano; Albert Josif; Daniel O'Byrne

[57] **CLAIM**

The ornamental design for the link for track of vehicle, as shown and described.

DESCRIPTION

FIG. 1 is a side view of a right-hand link for track of vehicle, showing my new design;

FIG. 2 is a view of the opposite side thereof;

FIG. 3 is a top plan view thereof, taken along the line III—III of FIG. 1;

FIG. 4 is a bottom plan view thereof, taken along the line IV—IV of FIG. 2;

FIG. 5 is a sectional view thereof, taken along the line V—V of FIG. 1;

FIG. 6 is a sectional view thereof, taken along the line VI—VI of FIG. 1;

FIG. 7 is a sectional view thereof, taken along the line VII—VII of FIG. 2;

FIG. 8 is a sectional view thereof, taken along the line VIII—VIII of FIG. 1;

FIG. 9 is a sectional view thereof, taken along the line IX—IX of FIG. 2;

FIG. 10 is a sectional view thereof, taken along the line X—X of FIG. 1; and,

FIG. 11 is a sectional view thereof, taken along the line XI—XI of FIG. 1.

The broken line showing in FIG. 2 is for illustrative purposes only, and forms no part of the claimed design.

1 Claim, 6 Drawing Sheets

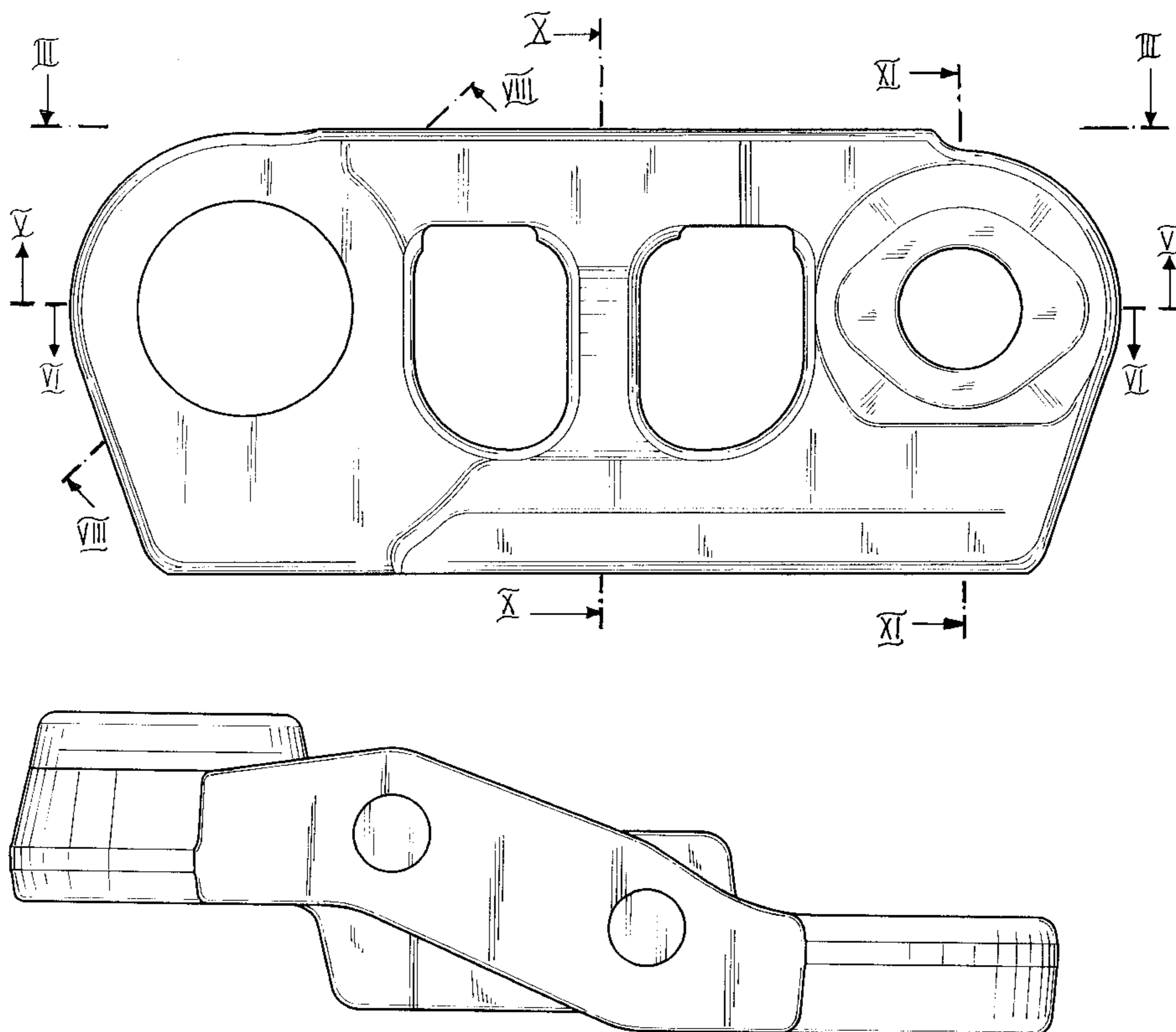

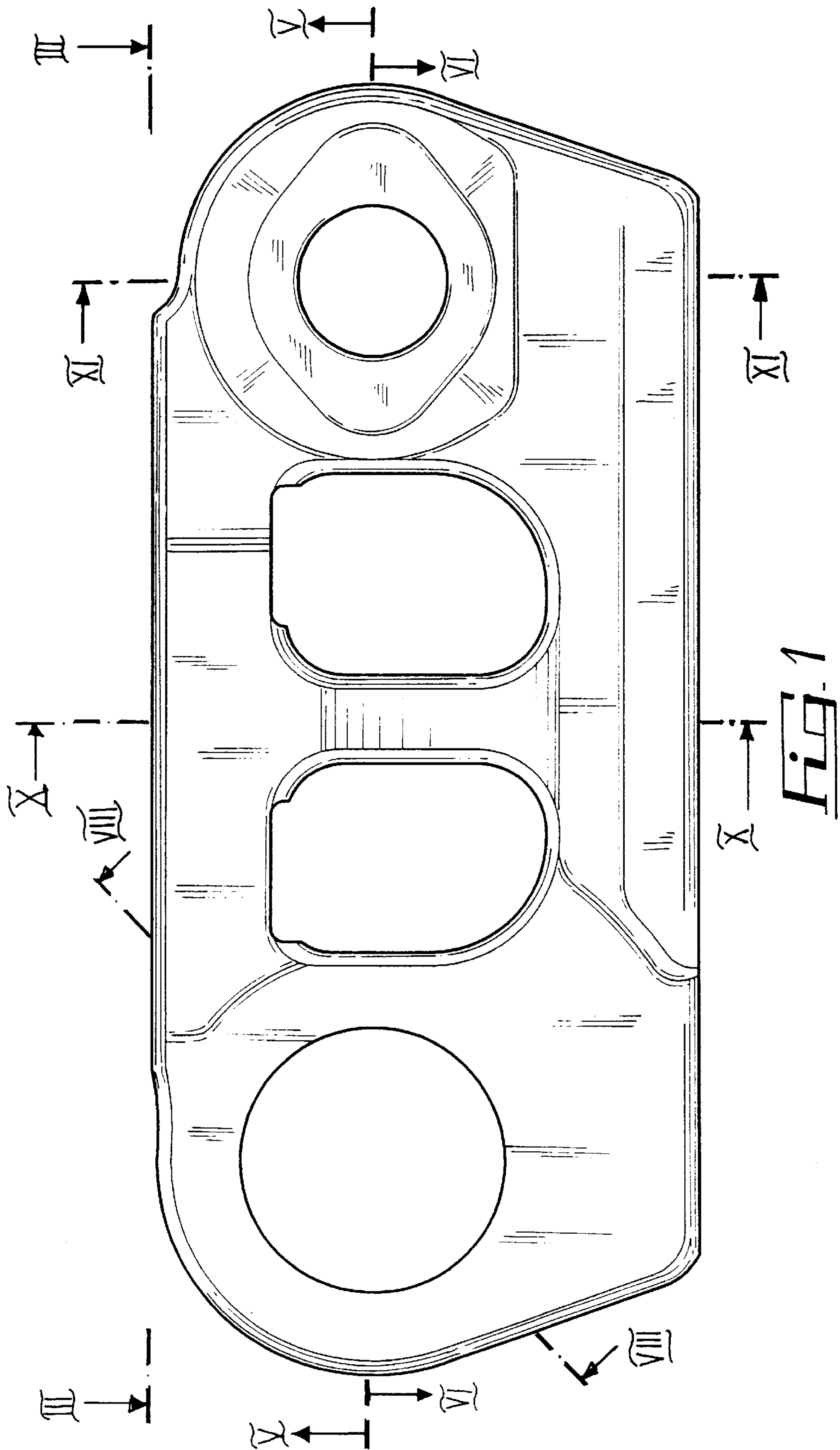

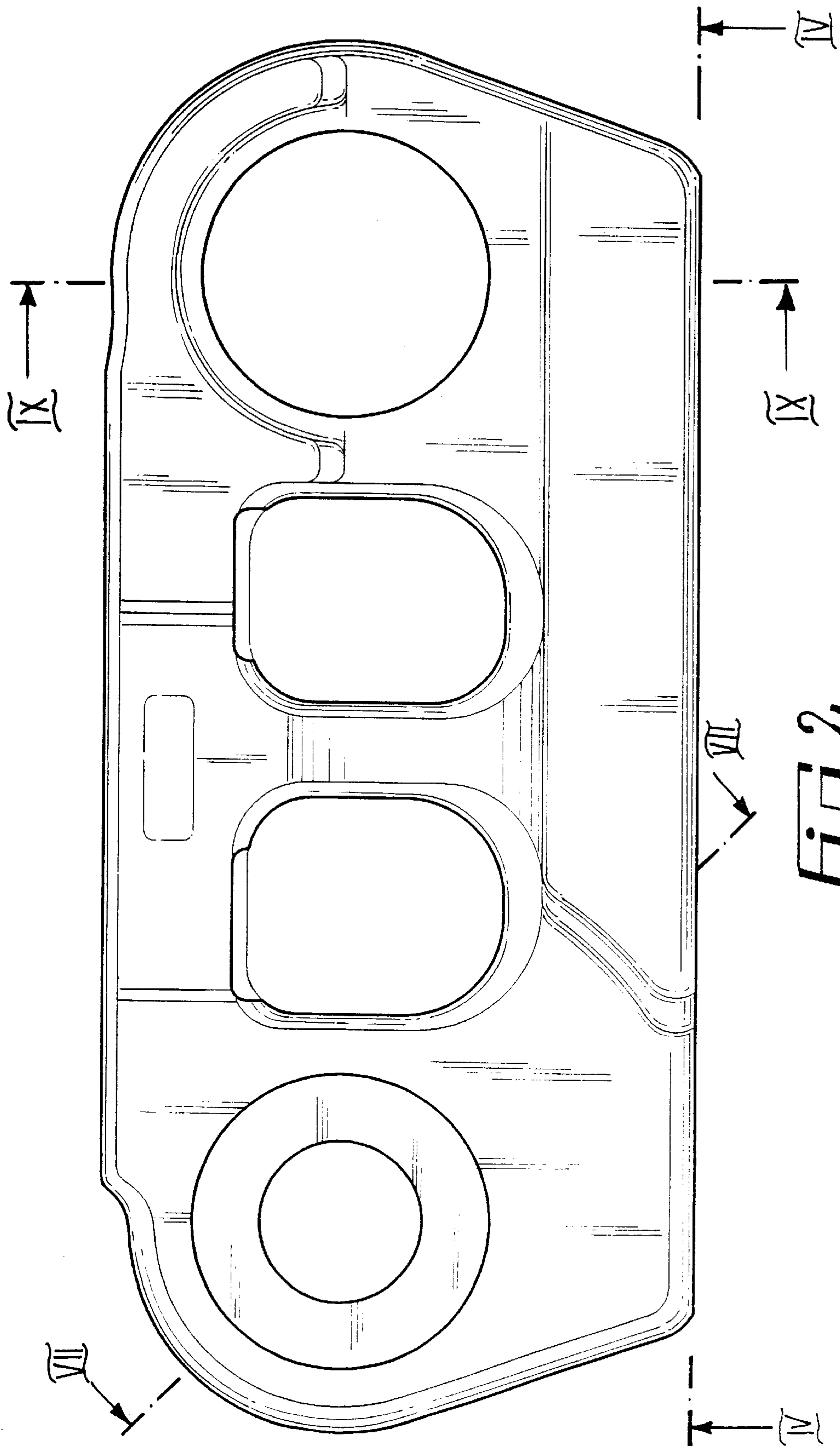
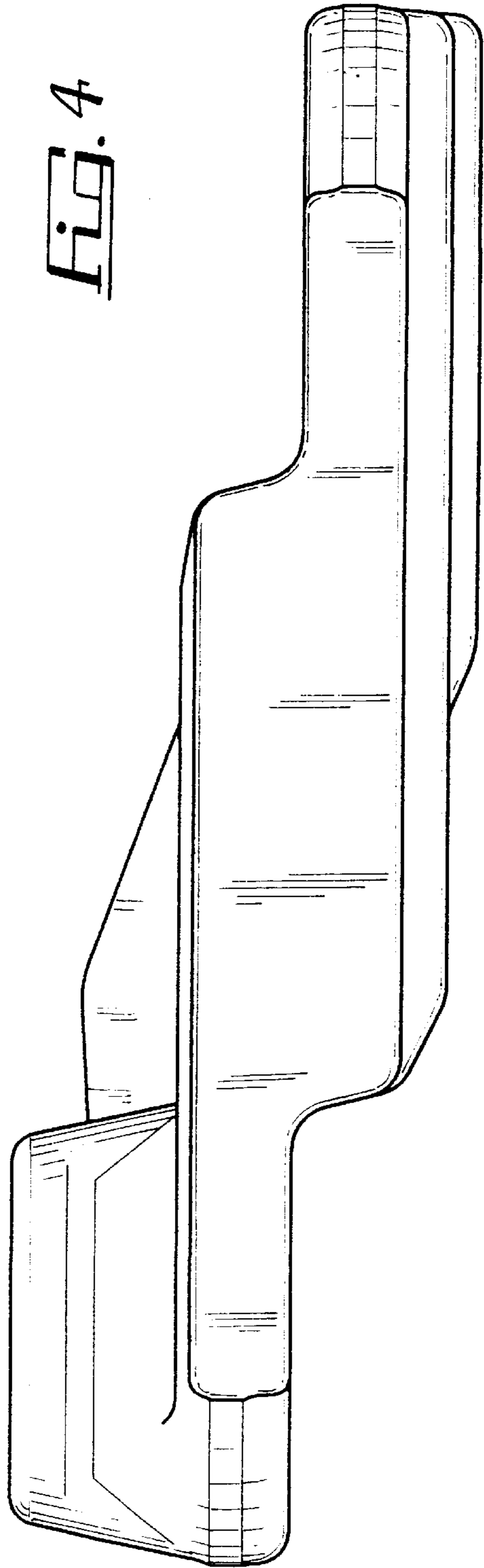
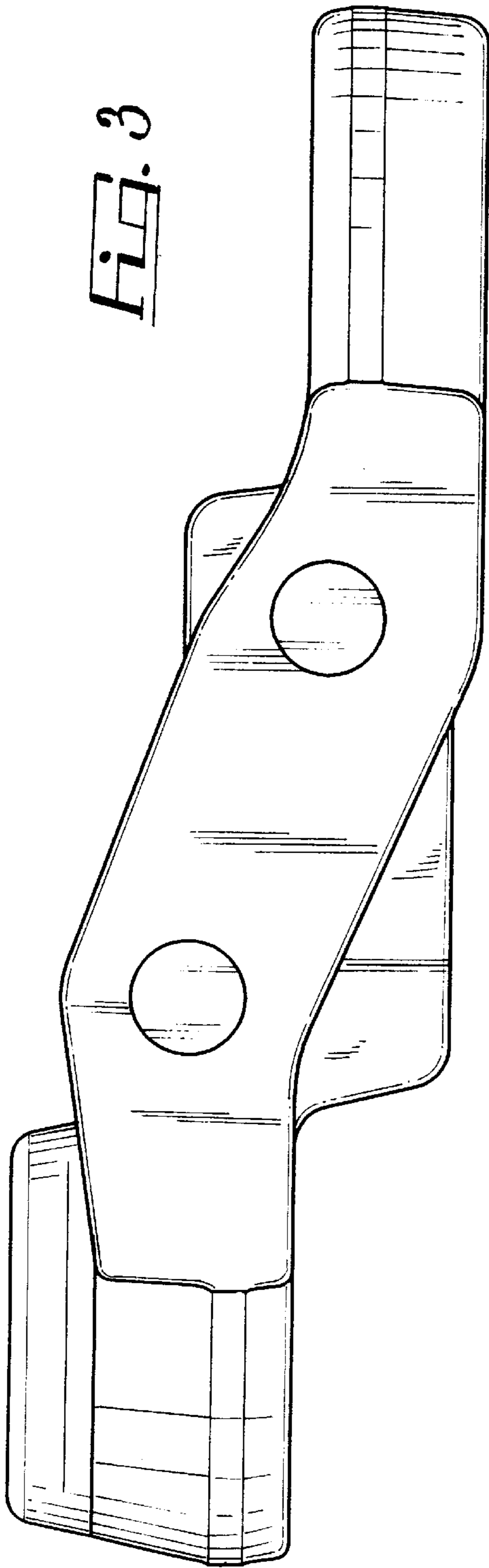

FIG. 2



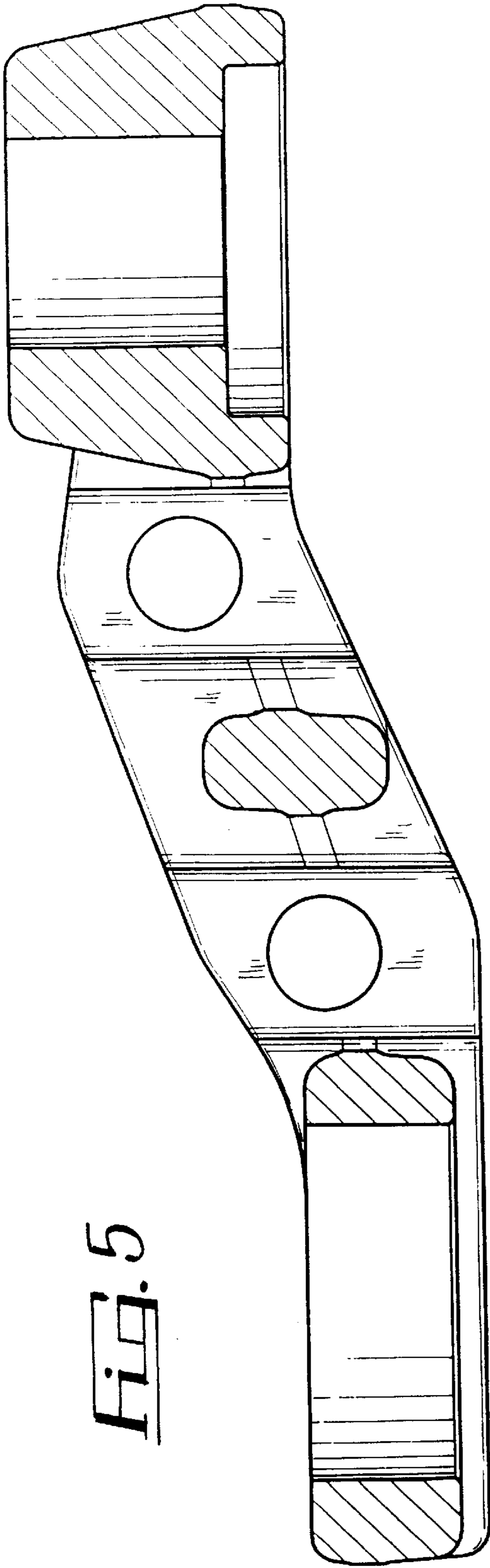

Fig. 5

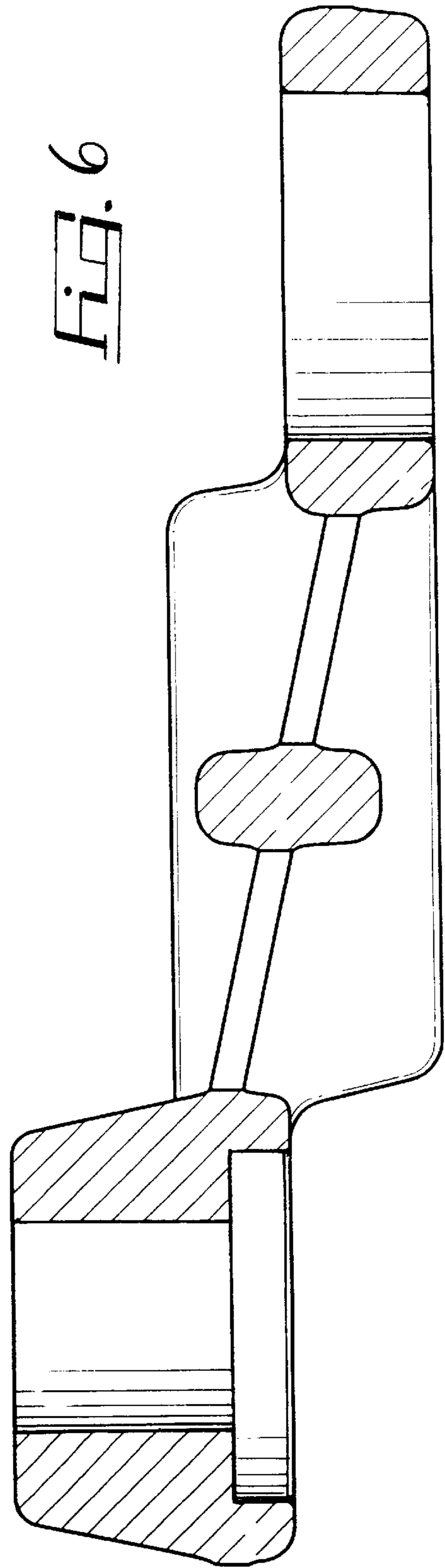

Fig. 6

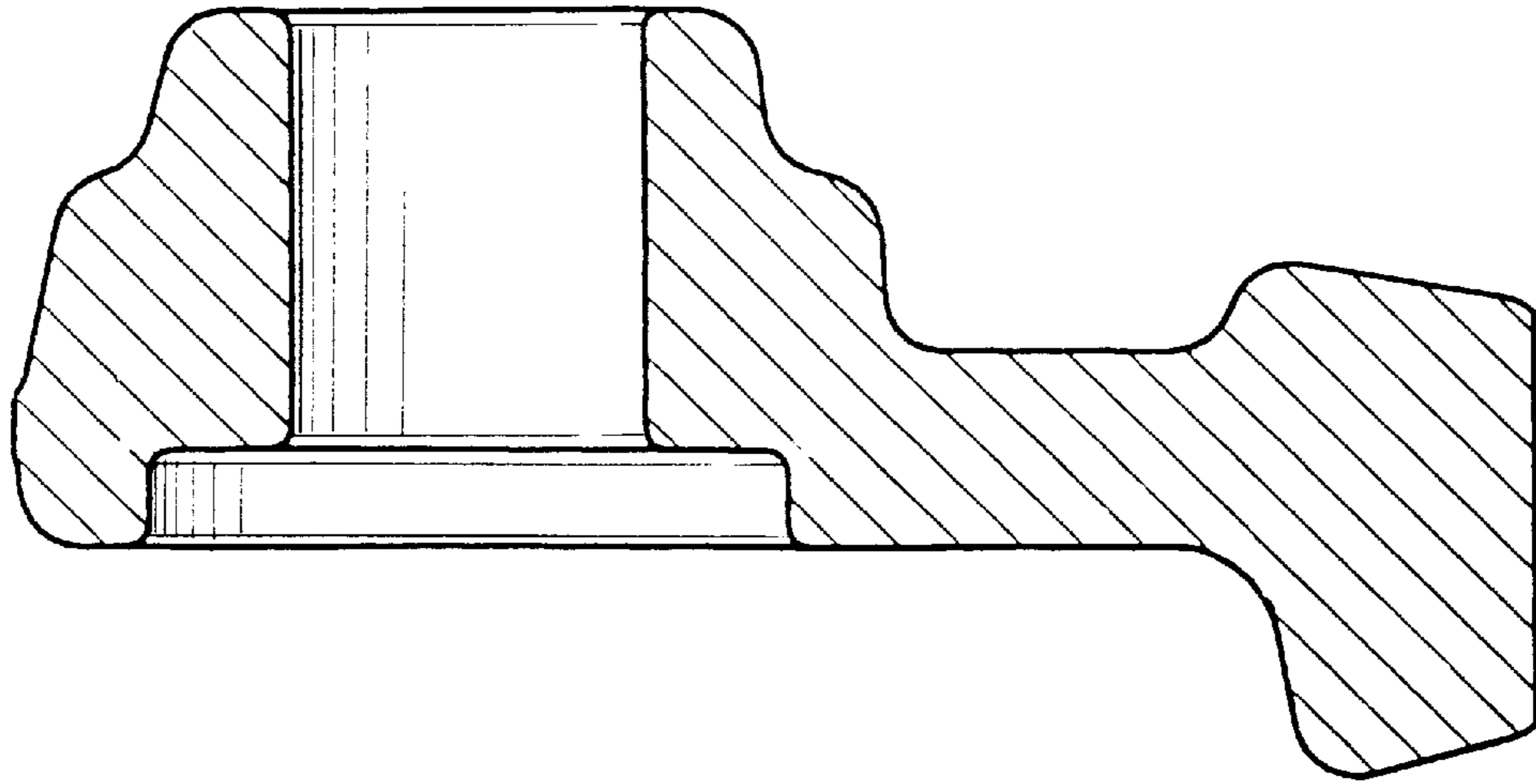

Fig. 7

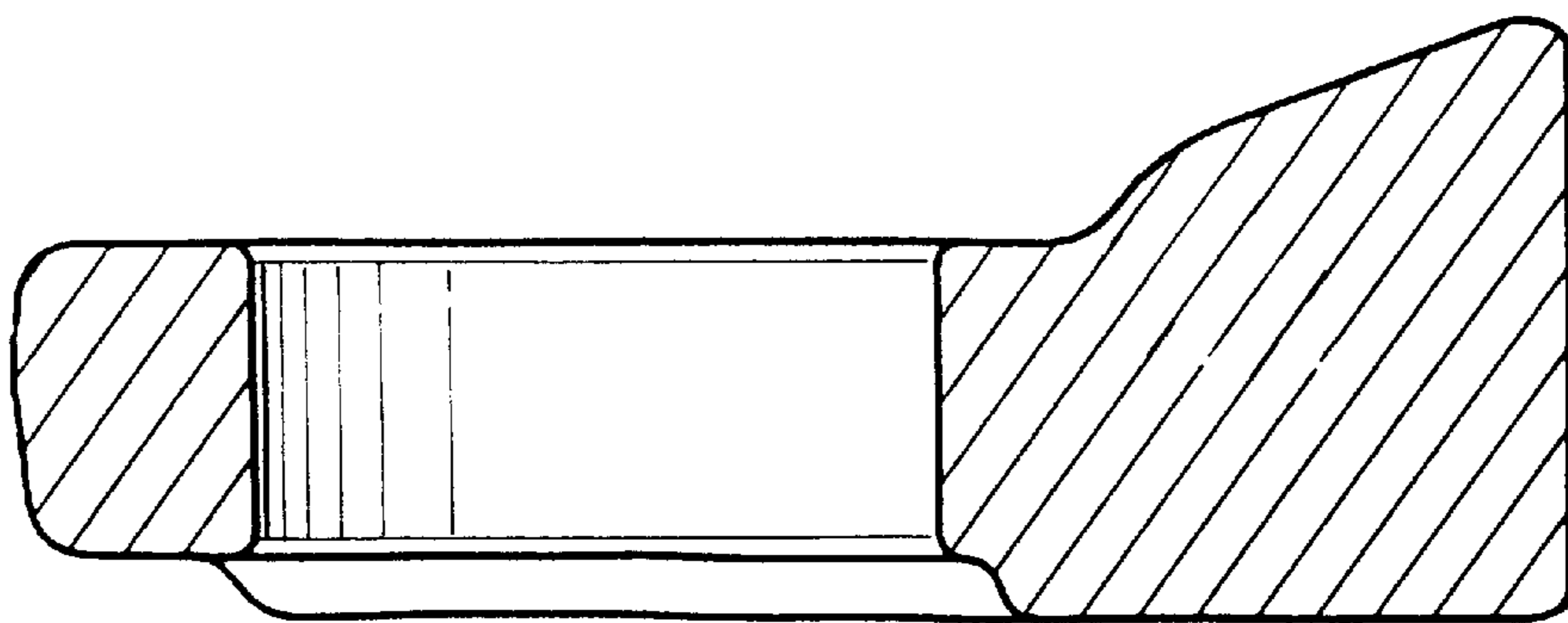

Fig. 8

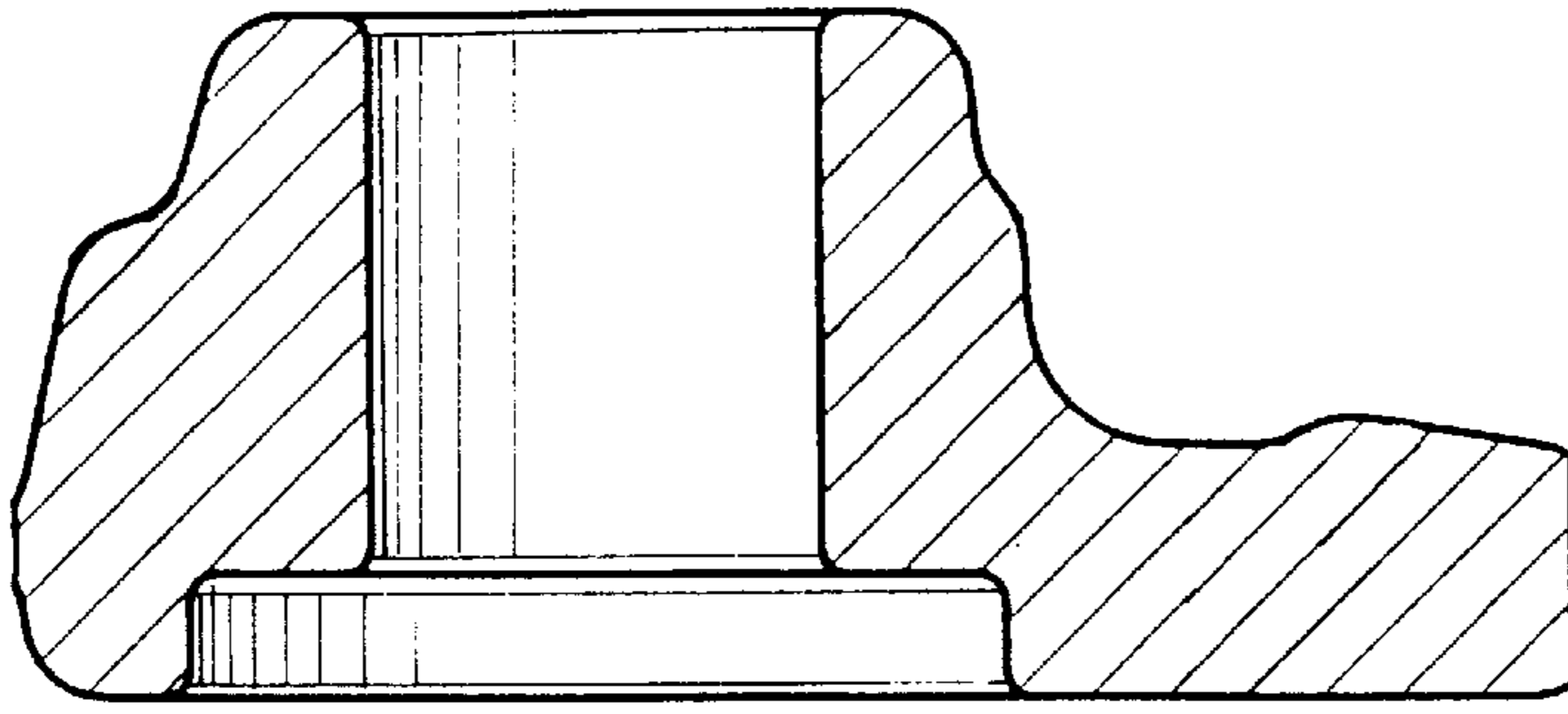

Fig. 11

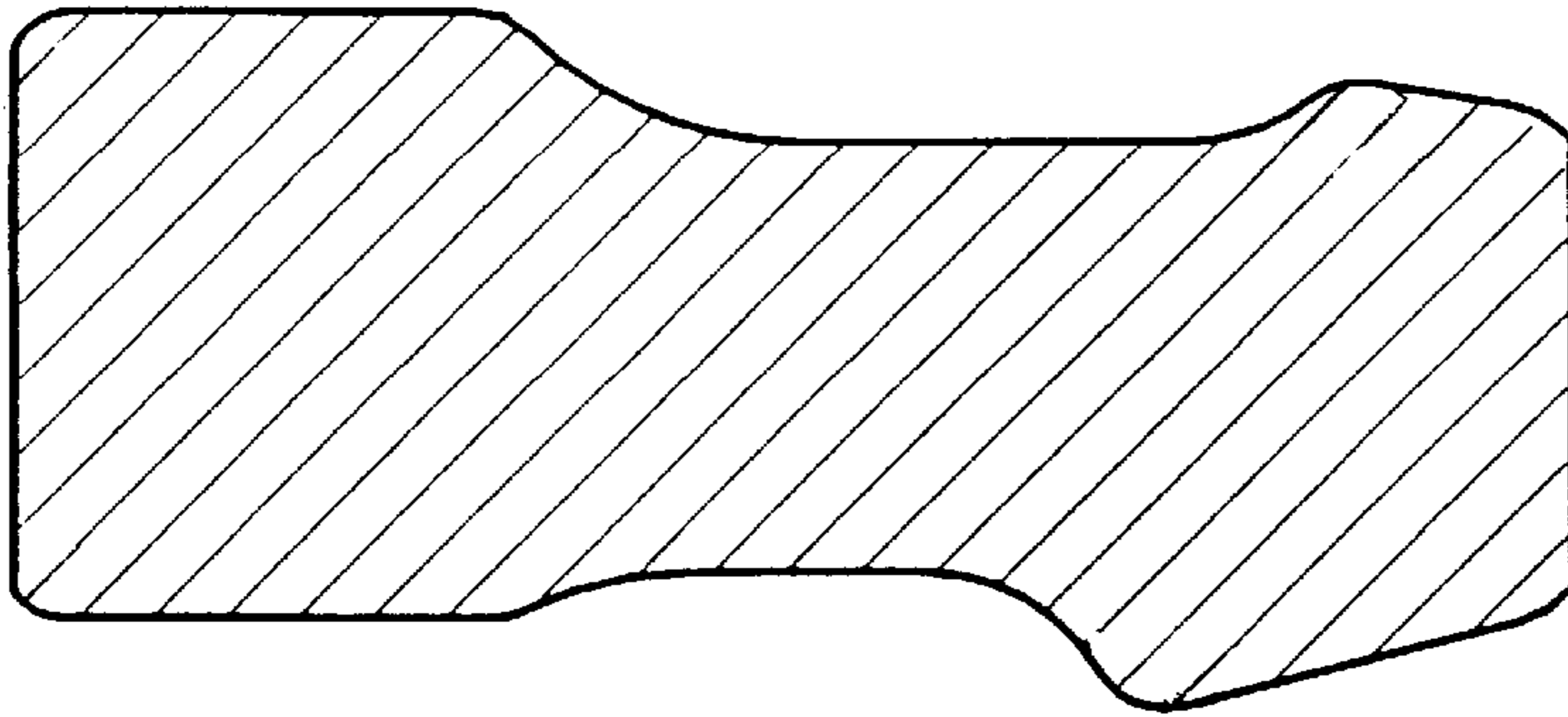

Fig. 10

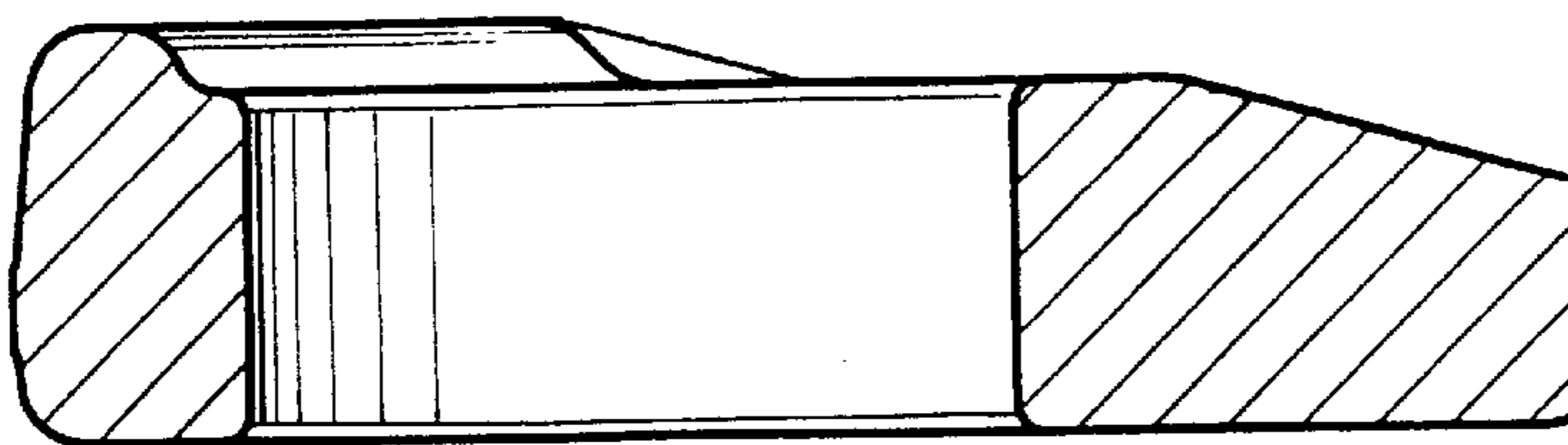

Fig. 9