



US00D431108S

United States Patent [19]

Lewis et al.

[11] Patent Number: **Des. 431,108**

[45] Date of Patent: **** Sep. 26, 2000**

[54] **MITRE SAW AND ACCESSORIES STORAGE CASE**

[75] Inventors: **Daniel Robert Lewis, Buford; Edward Howe Rushworth, Suwanee, both of Ga.**

[73] Assignee: **Makita Corporation, Aichi-ken, Japan**

[**] Term: **14 Years**

[21] Appl. No.: **29/113,873**

[22] Filed: **Nov. 15, 1999**

[51] **LOC (7) Cl. 03-01**

[52] **U.S. Cl. D3/276; D3/281; D3/291; D3/905**

[58] **Field of Search D3/272, 273, 276, D3/281, 282, 291, 294, 905; 206/349, 372, 373, 314; 190/100, 107, 115, 110**

[56] **References Cited**

U.S. PATENT DOCUMENTS

D. 183,990	11/1958	Lorenz	D3/272
D. 234,273	2/1975	Wilson	D3/272
D. 328,188	7/1992	Jacobsen et al.	D3/272

D. 337,657	7/1993	March et al.	D3/272
D. 347,113	5/1994	Bornhorst et al.	D3/272
D. 347,324	5/1994	Dickinson	D3/272
D. 402,462	12/1998	Sanderson	D3/276
5,806,673	9/1998	Sanderson	206/314

Primary Examiner—Philip S. Hyder
Attorney, Agent, or Firm—Rodgers & Rodgers

[57] **CLAIM**

The ornamental design for a mitre saw and accessories storage case, as shown and described.

DESCRIPTION

FIG. 1 is a perspective view of a mitre saw and accessories storage case showing our new design; FIG. 2 is a front elevational view thereof; FIG. 3 is a top plan view thereof; FIG. 4 is a right side elevational view thereof, the opposite side being a mirror image thereof; FIG. 5 is a rear elevational view thereof; FIG. 6 is a bottom plan view thereof; FIG. 7 is a front elevational view thereof with the top and front panels open; and, FIG. 8 is a top plan view with the top and front panels open.

1 Claim, 5 Drawing Sheets

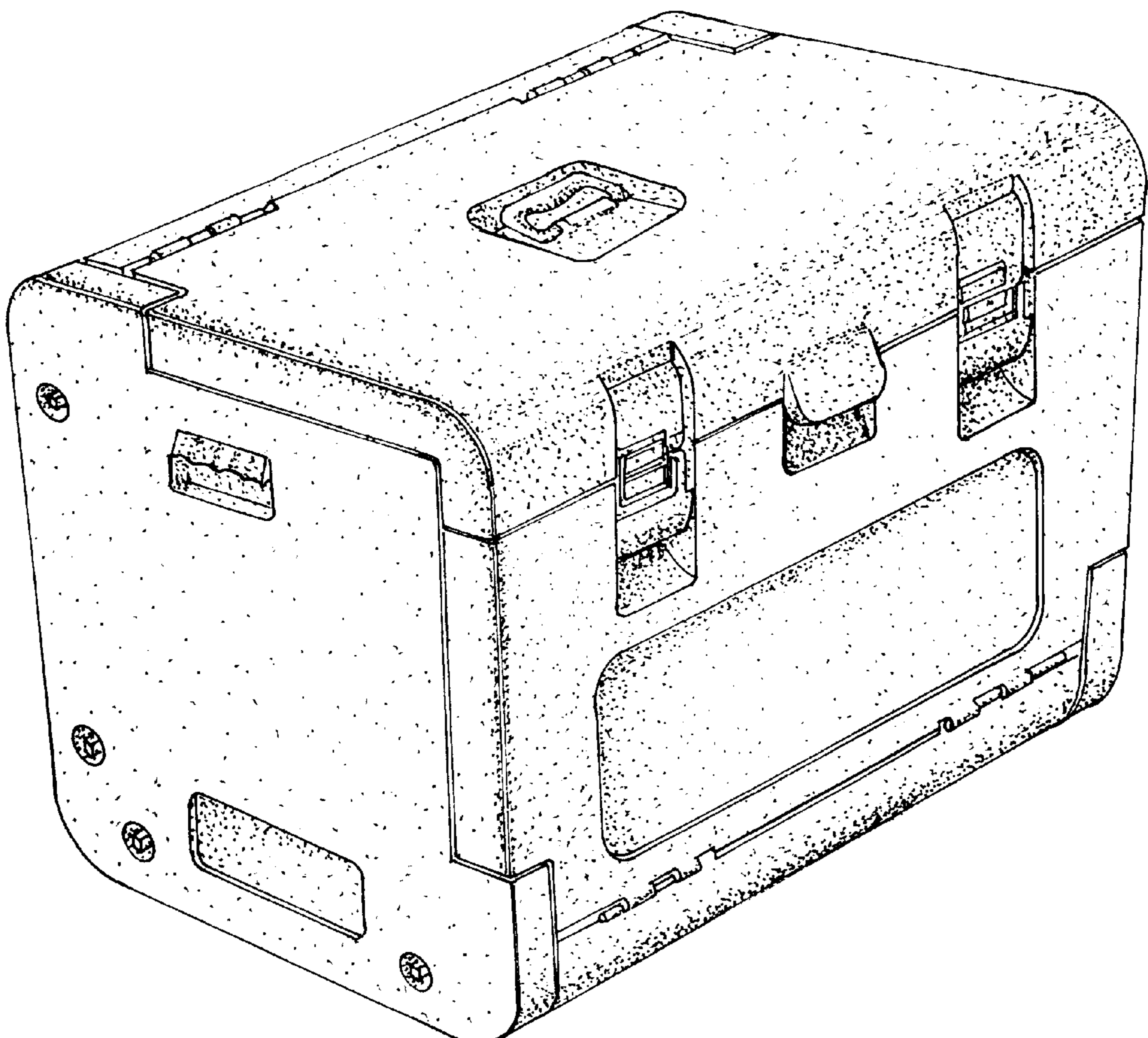

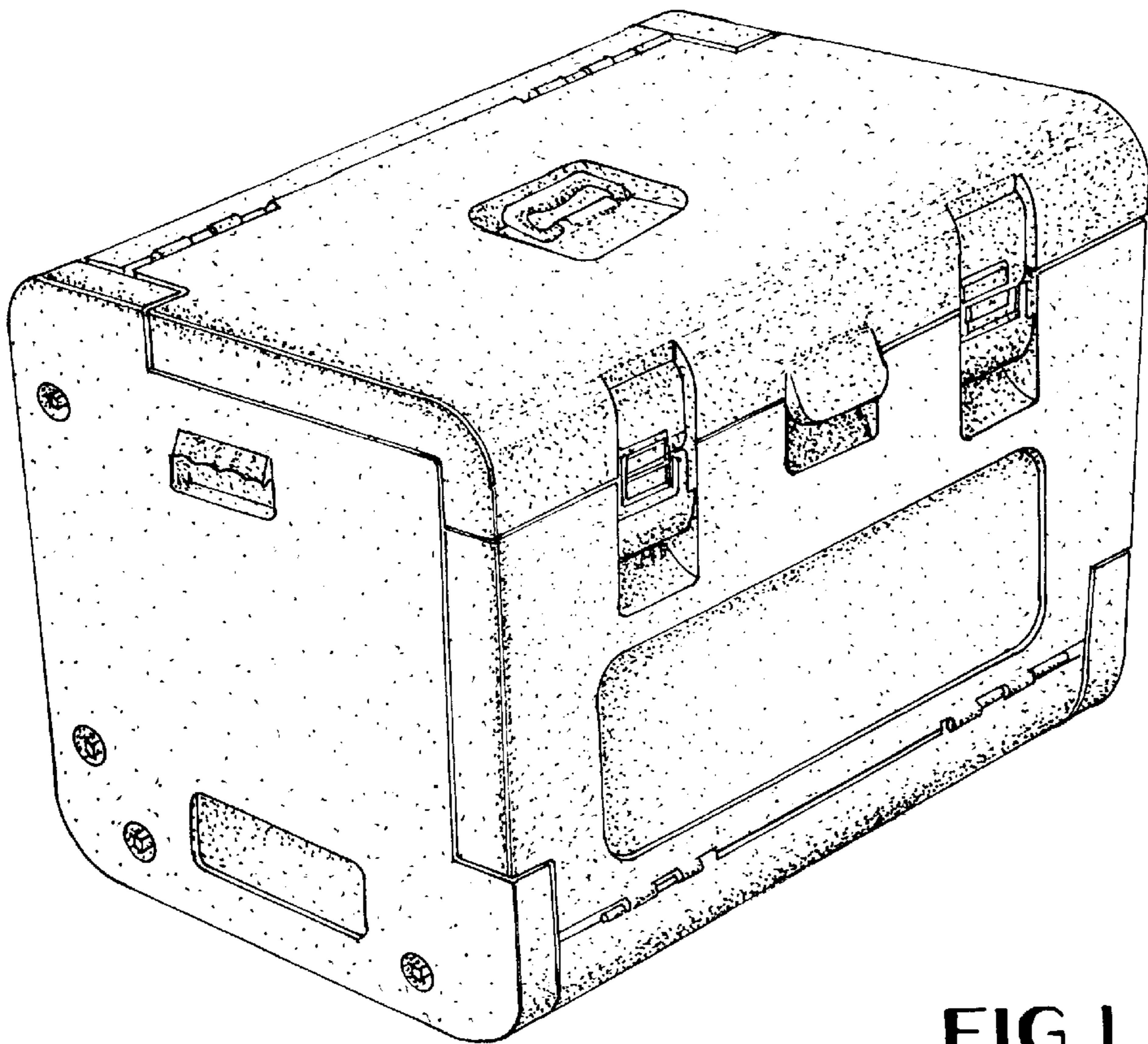

FIG. 1

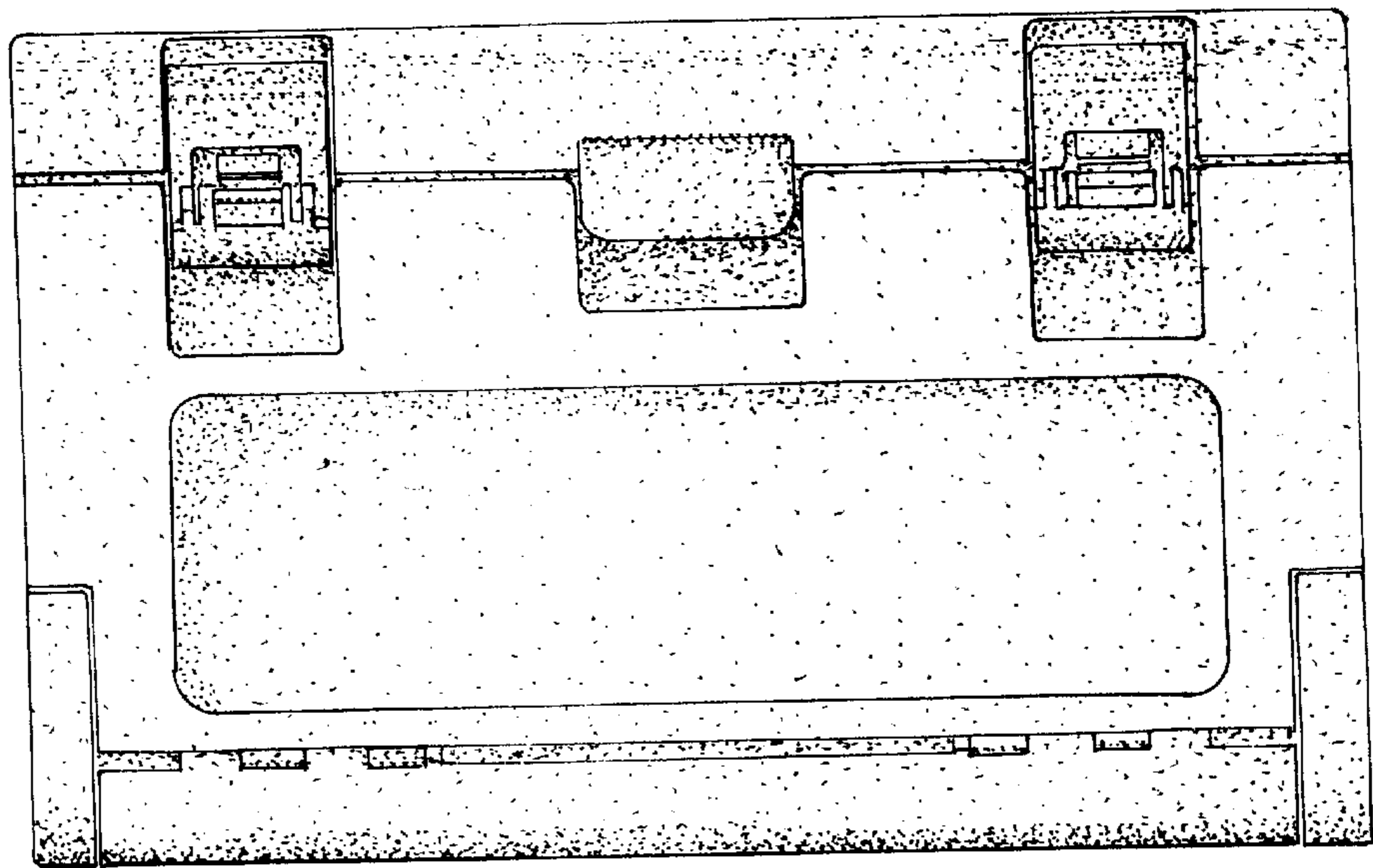

FIG. 2

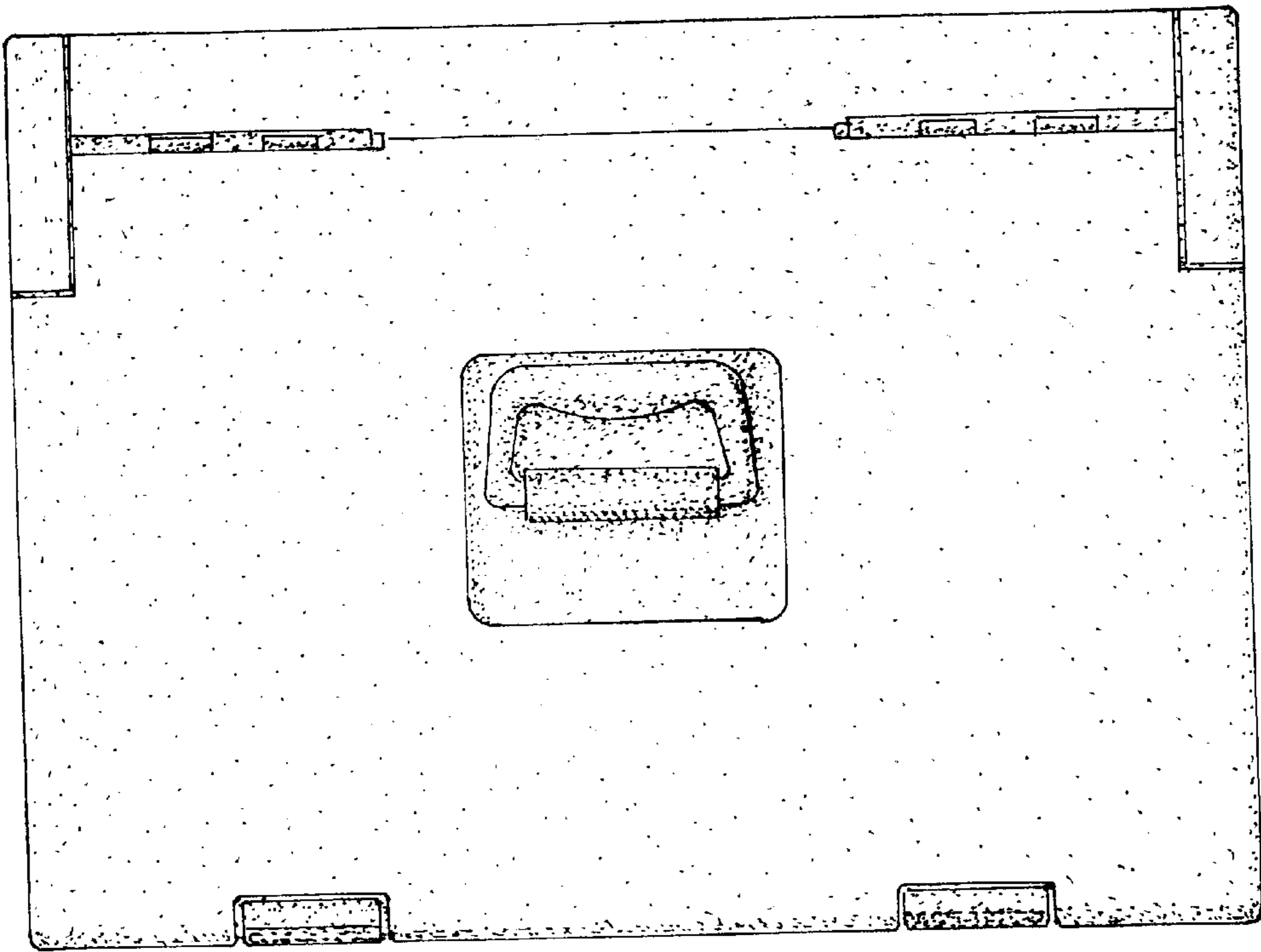

FIG. 3

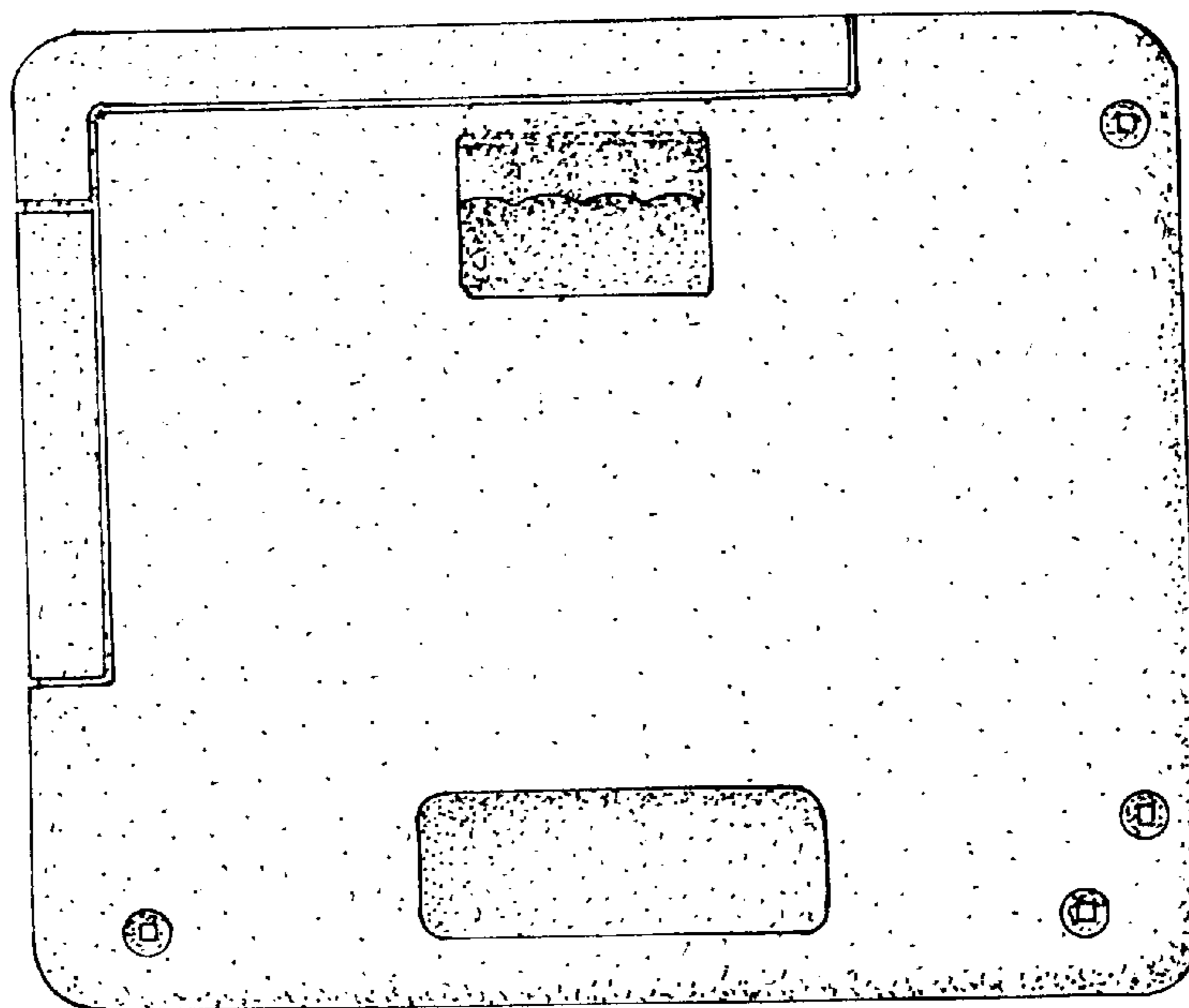

FIG. 4

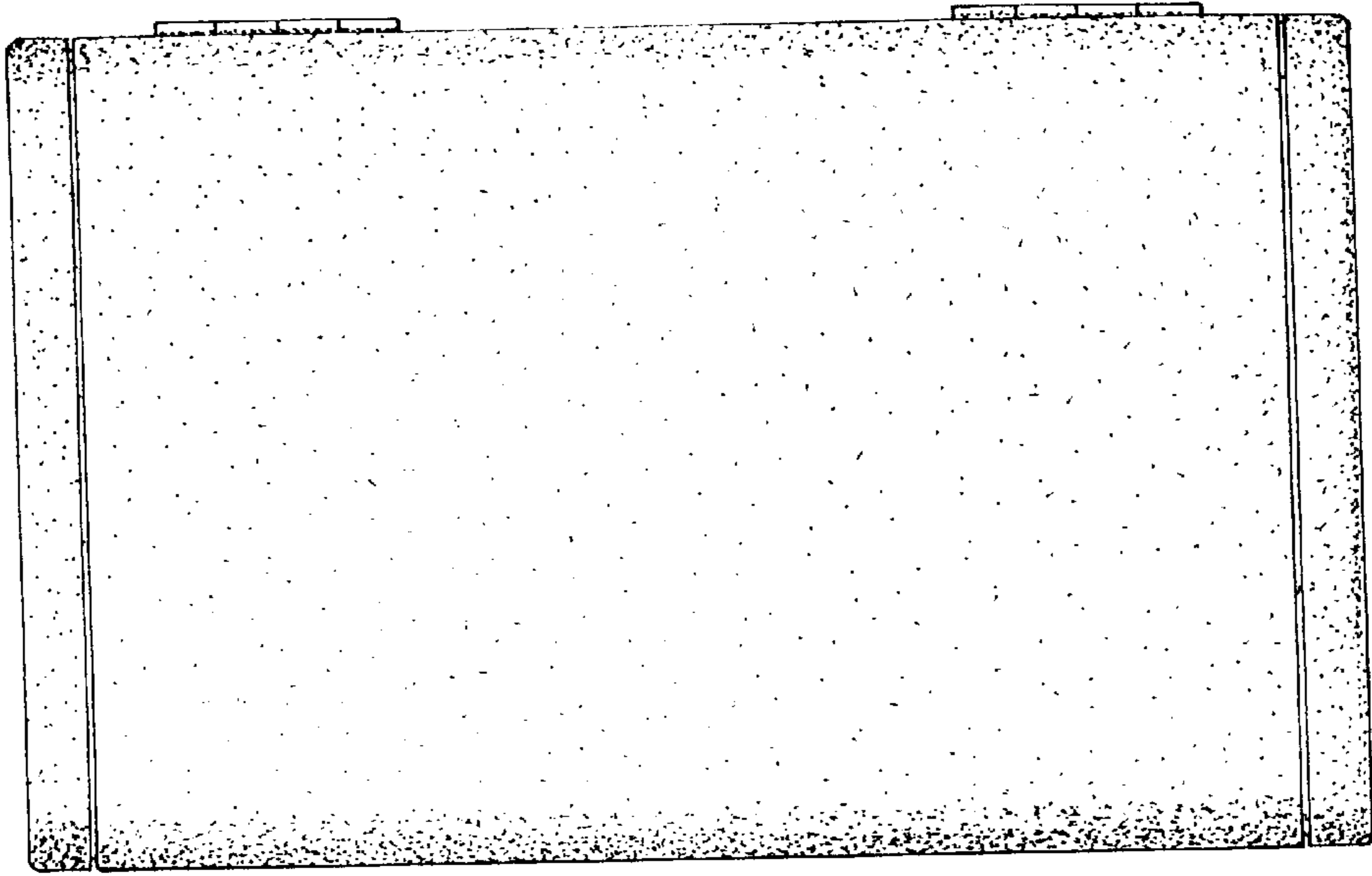

FIG. 5

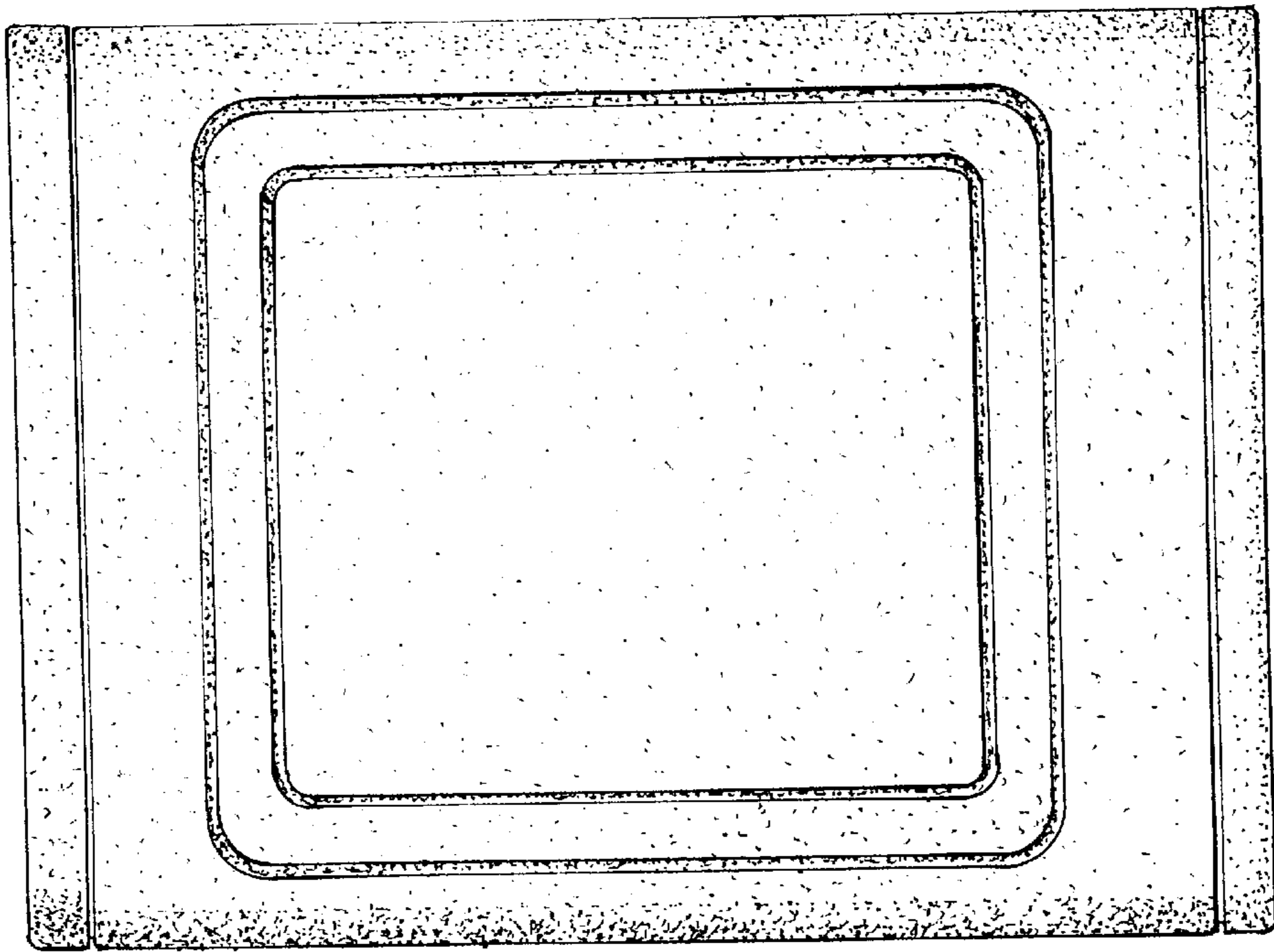

FIG. 6

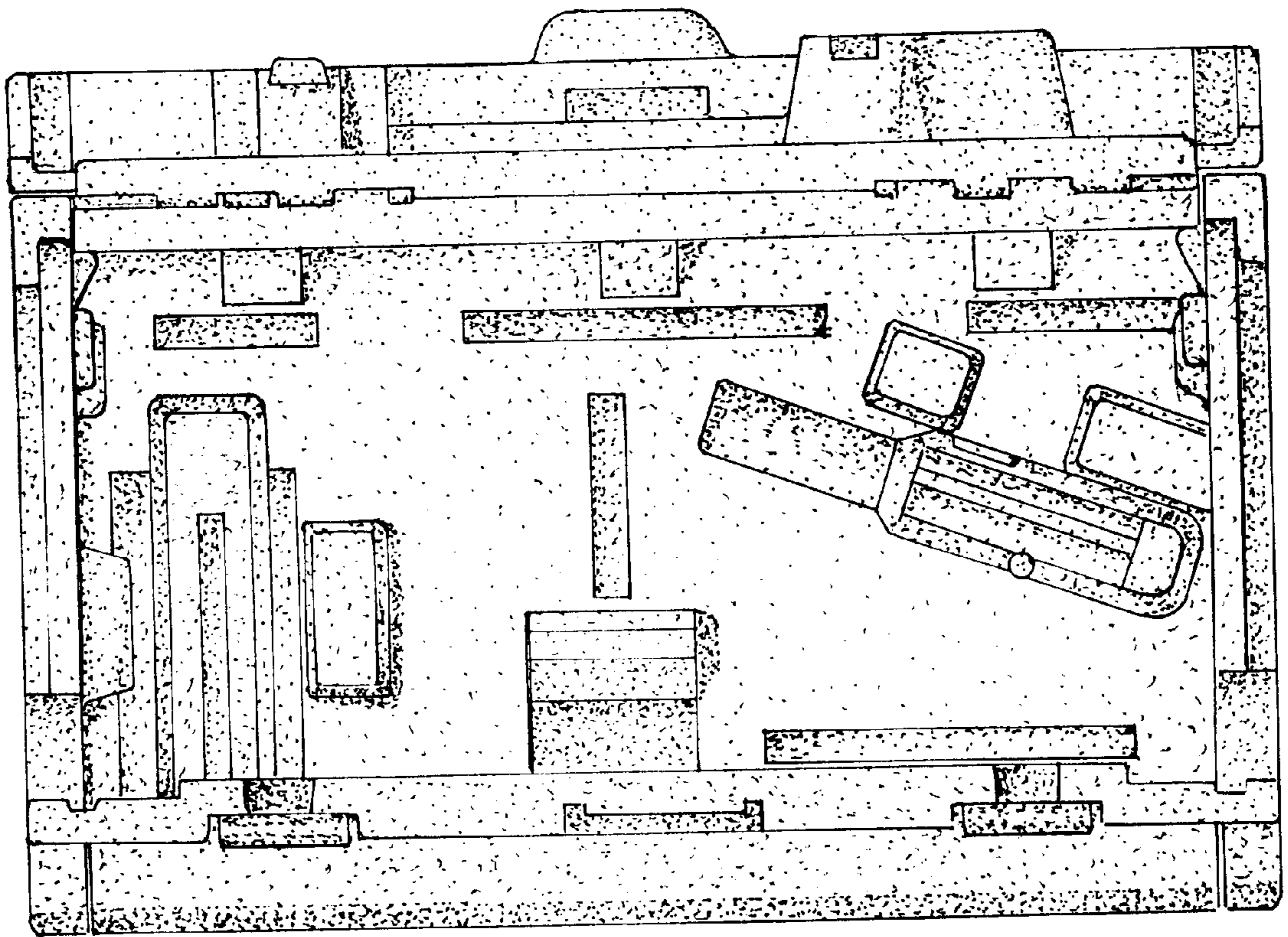

FIG. 7

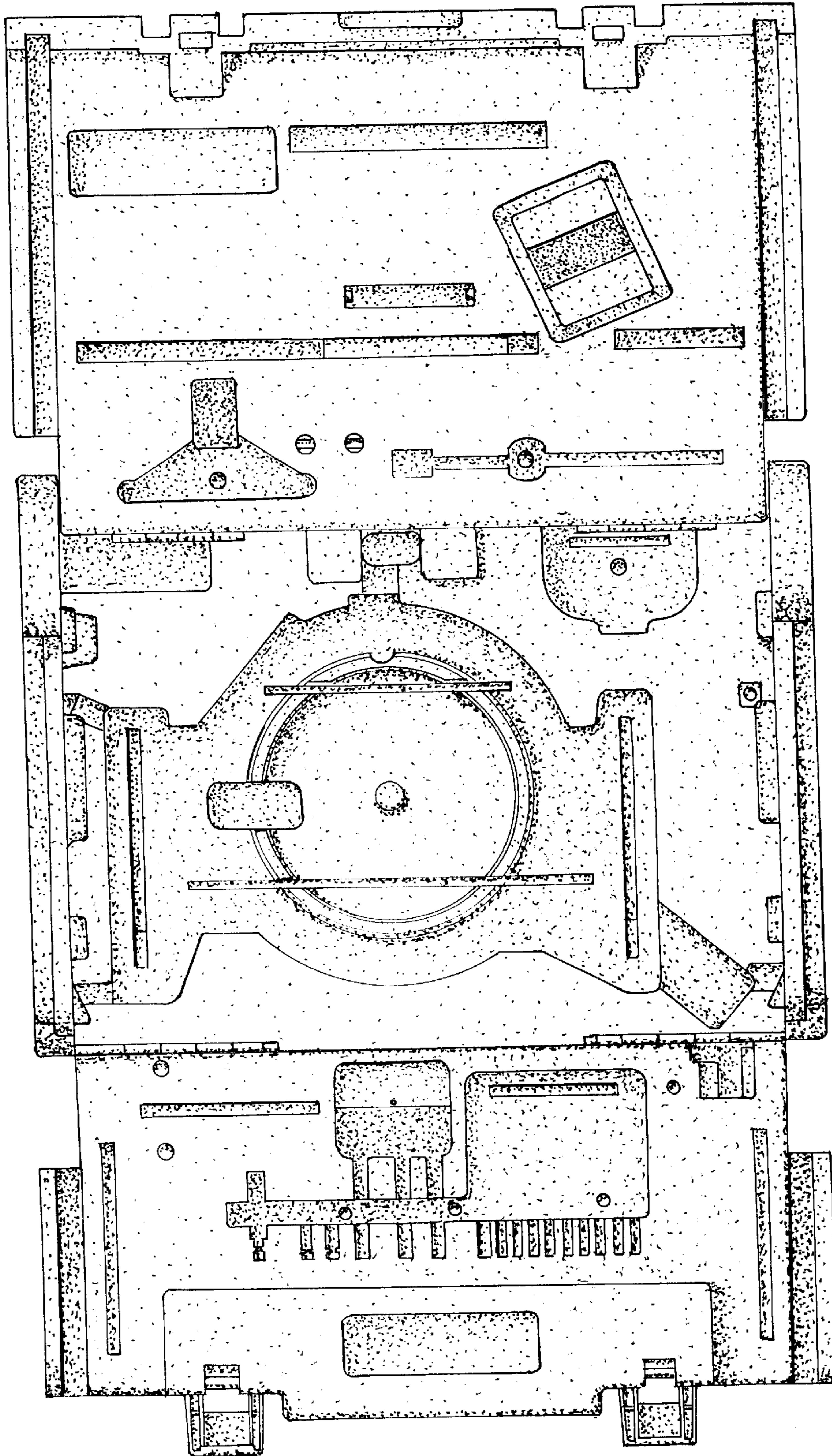

FIG 8