



US00D425575S

United States Patent [19] Cyrus

[11] Patent Number: **Des. 425,575**

[45] Date of Patent: **** May 23, 2000**

[54] **CONNECTORS FOR DIAGONAL TOY BUILDING PIECES**

[75] Inventor: **Peter Cyrus**, Seattle, Wash.

[73] Assignee: **Parvia Corporation**, Seattle, Wash.

[**] Term: **14 Years**

[21] Appl. No.: **29/101,188**

[22] Filed: **Feb. 26, 1999**

[51] **LOC (7) Cl.** **21-01**

[52] **U.S. Cl.** **D21/505; D21/484; D21/489**

[58] **Field of Search** **D21/484-505; 446/85, 108-116, 120-125, 128**

[56] **References Cited**

U.S. PATENT DOCUMENTS

D. 311,939	11/1990	Andersen	D21/505
D. 380,020	6/1997	Nielsen	D21/489
D. 380,792	7/1997	Gabriel	D21/489
D. 409,675	5/1999	Krog	D21/504
1,985,032	12/1934	Hoult	.	

3,168,793	2/1965	Gibson	.	
3,234,683	2/1966	Christiansen	.	
3,667,153	6/1972	Christiansen	.	
4,726,515	2/1988	Bolli et al.	.	
5,826,394	10/1998	Barton, Jr.	446/128

Primary Examiner—Raphael Barkai
Attorney, Agent, or Firm—Christensen O'Connor Johnson & Kindness PLLC

[57] **CLAIM**

I claim the ornamental design for connectors for diagonal toy building pieces, as shown and described.

DESCRIPTION

FIG. 1 is a left, front perspective view of the connectors for a diagonal toy building piece, with the remainder of the toy building piece in phantom to show environment; FIG. 2 is a left view thereof; FIG. 3 is a right view thereof; FIG. 4 is a front view thereof; FIG. 5 is a top view thereof; and, FIG. 6 is a bottom view thereof.

1 Claim, 4 Drawing Sheets

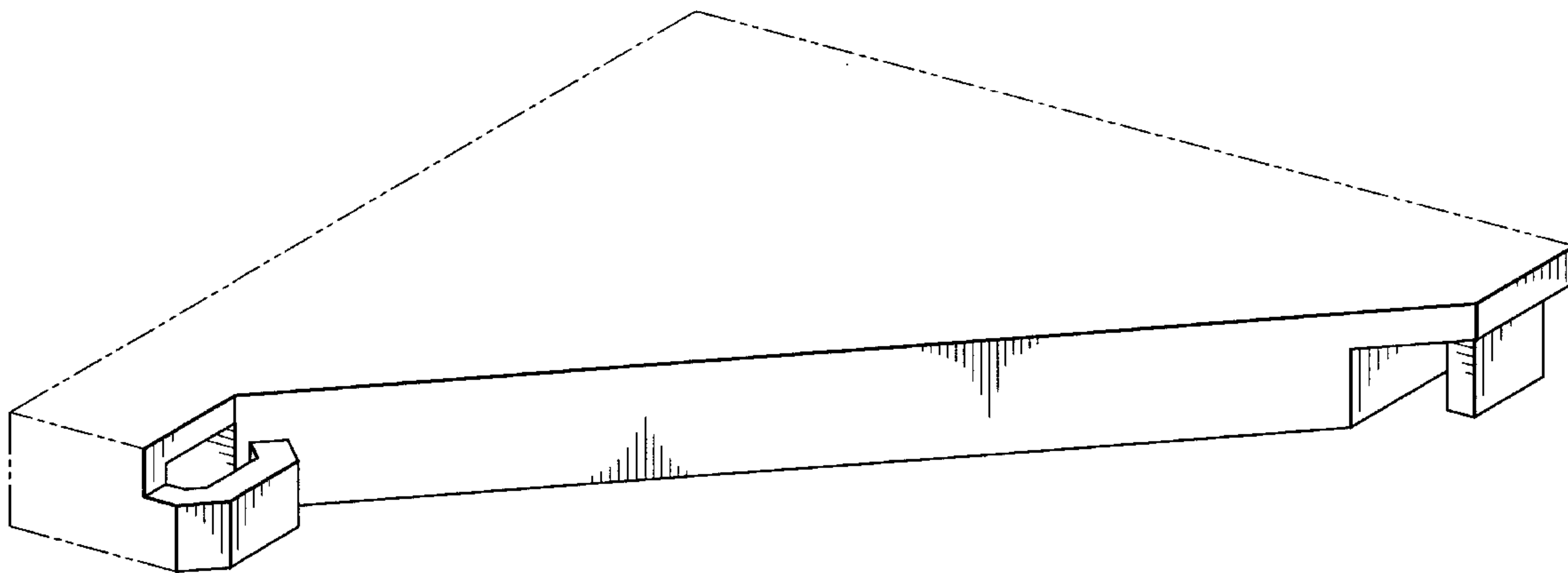

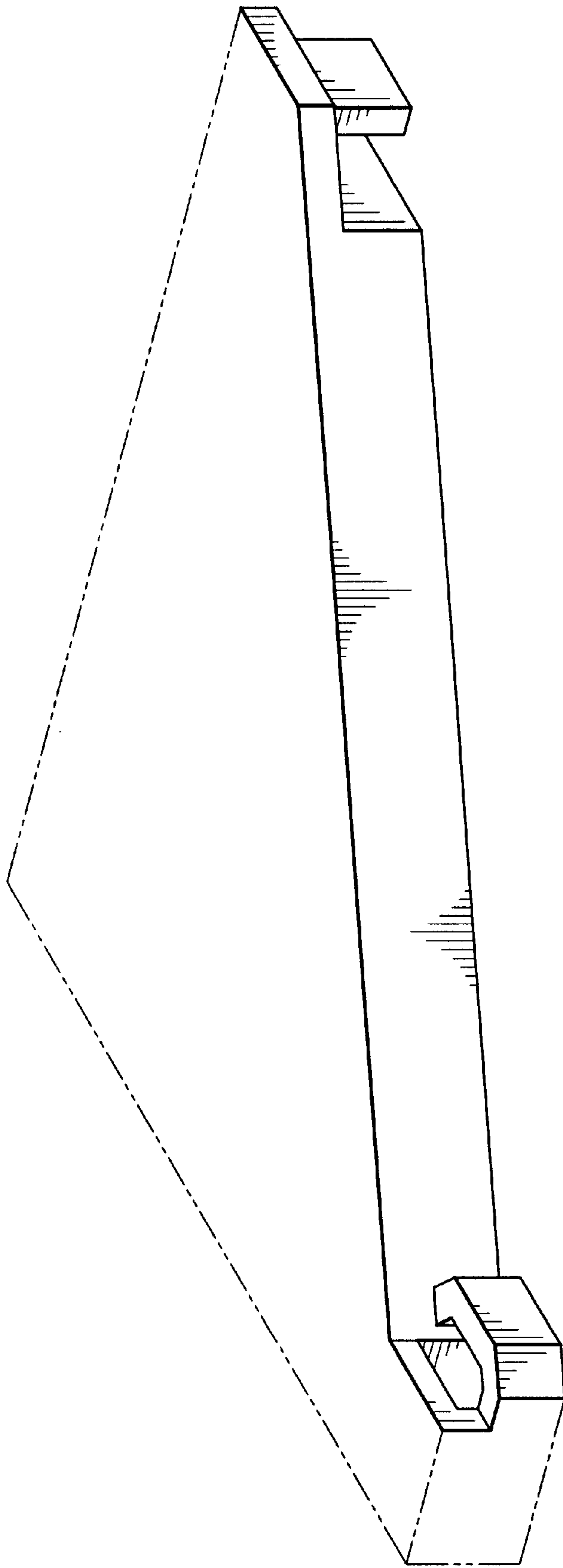

Fig. 1.

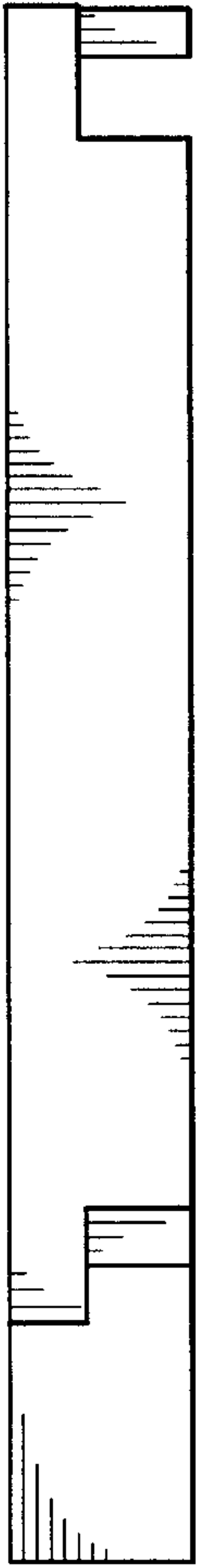

Fig. 2.

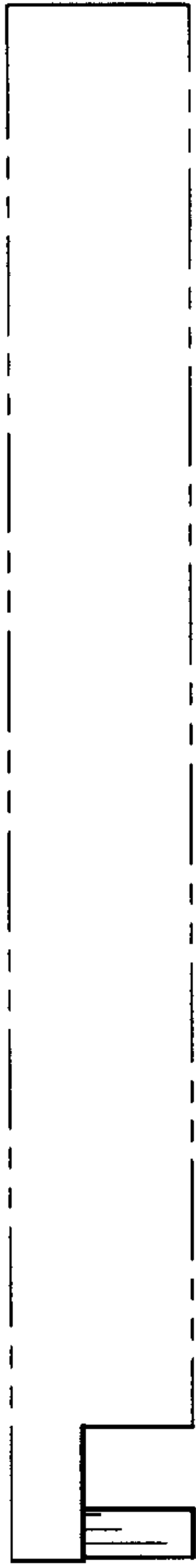

Fig. 3.

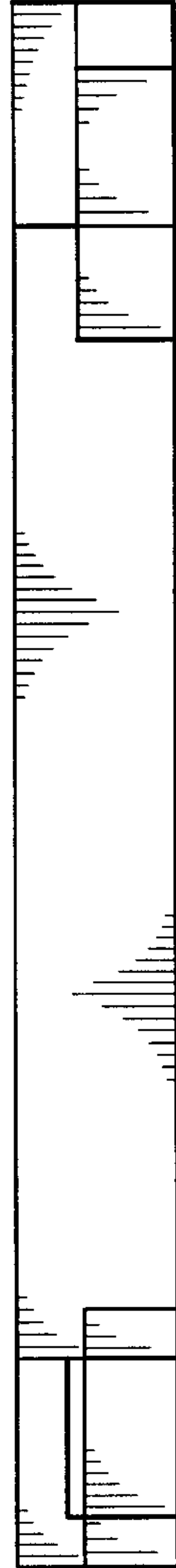

Fig. 4.

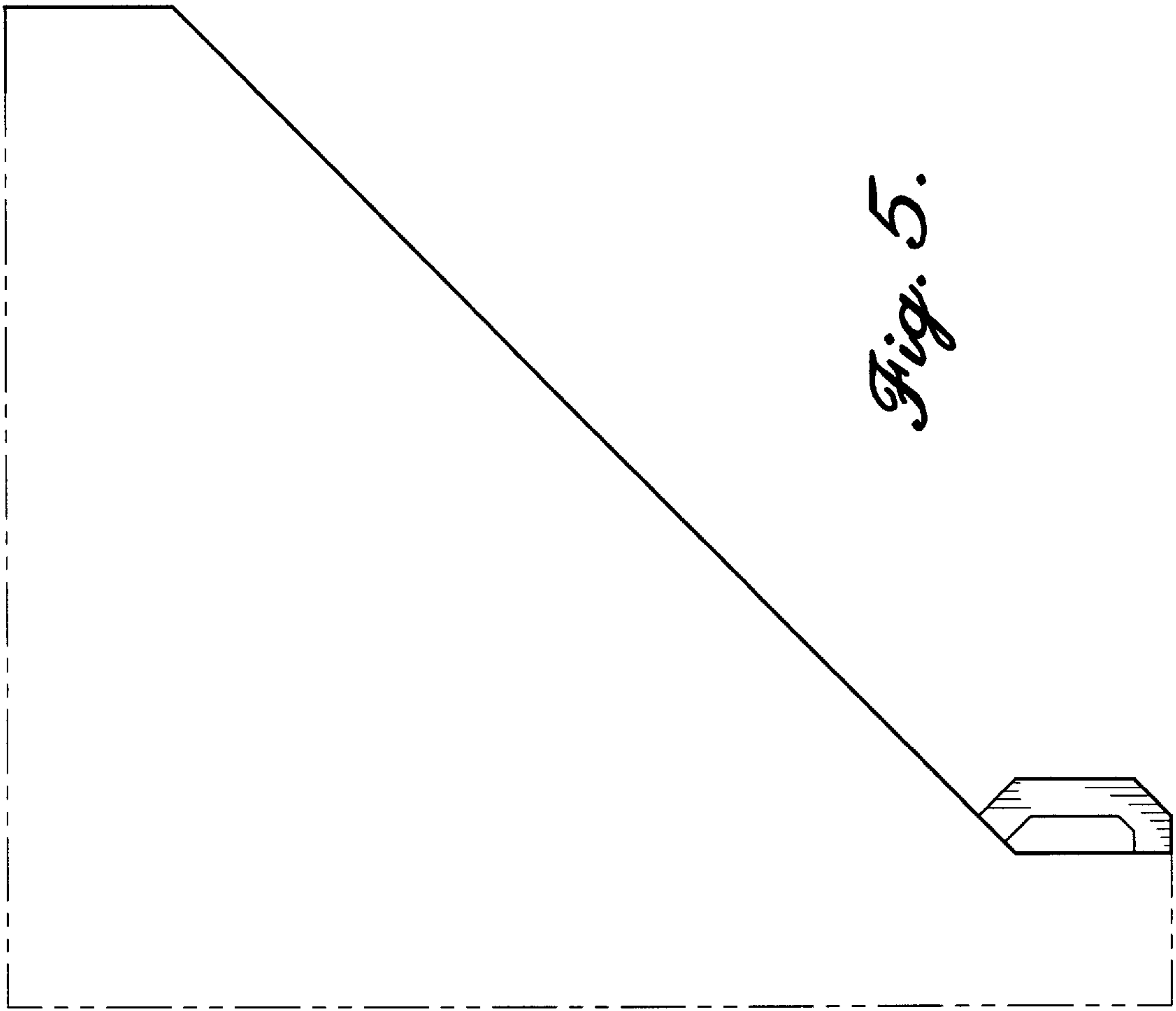

Fig. 5.

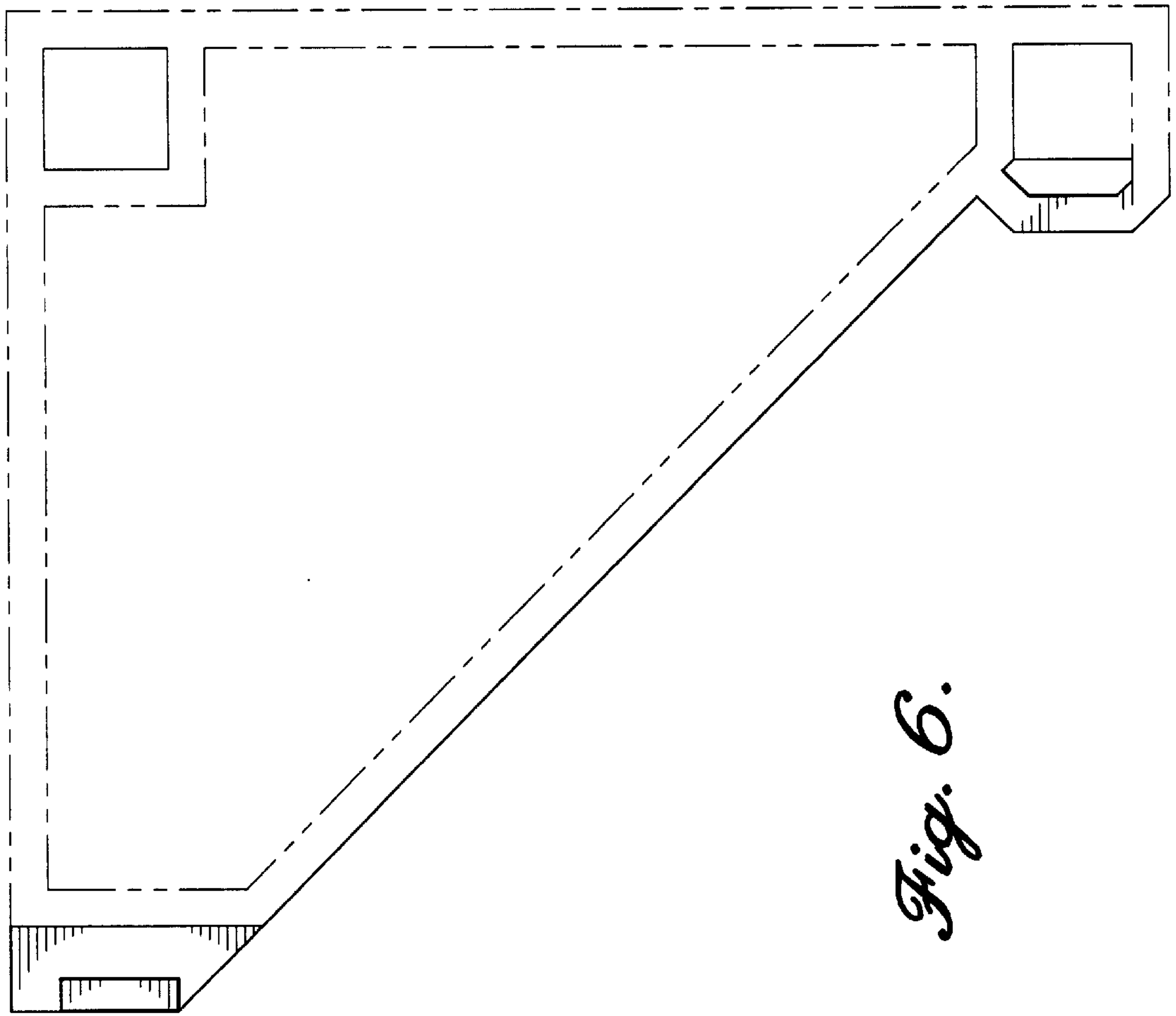

Fig. 6.