



US00D421707S

United States Patent [19]
Gregory

[11] **Patent Number: Des. 421,707**

[45] **Date of Patent: ** Mar. 21, 2000**

[54] **SPARE TIRE SECURITY LOCK**

[76] Inventor: **Edwin H. Gregory**, 712 Arkansas Ave.,
Mountain Home, Ark. 72653

[**] Term: **14 Years**

[21] Appl. No.: **29/097,364**

[22] Filed: **Dec. 4, 1998**

[51] **LOC (6) Cl.** **08-07**

[52] **U.S. Cl.** **D8/341; D8/331**

[58] **Field of Search** D8/330, 331, 339,
D8/341; 70/14, 32, 33, 225, 226, 258, 259,
260; 224/42.25

[56] **References Cited**

U.S. PATENT DOCUMENTS

D. 399,122	10/1998	Princell	D8/339
1,858,893	3/1932	Heyer	70/259
1,937,848	12/1933	Shinn	70/259 X
5,345,794	9/1994	Jenks	70/14
5,426,963	6/1995	Tafoya et al.	70/259
5,487,288	1/1996	Frantz	70/259

Primary Examiner—Susan J. Lucas
Assistant Examiner—Jennifer Rivard
Attorney, Agent, or Firm—Trent C. Keisling; Head, Johnson
& Kachigian

[57] **CLAIM**

The ornamental design for a spare tire security lock, as shown and described.

DESCRIPTION

FIG. 1 is a partially exploded perspective view of a spare tire security lock showing my new design, with phantom lines indicating an intended environment for the invention; FIG. 2 is a perspective view of the invention taken generally from the front; FIG. 3 is a perspective view of the invention taken generally from the rear and opposite to FIG. 2; FIG. 4 is a side elevational view, with the opposite side being a mirror image thereof; FIG. 5 is a front elevational view; FIG. 6 is a rear elevational view; and, FIG. 7 is a top plan view with the opposite side being a mirror image thereof. The phantom lines are shown for illustrative purposes only and form no part of the claimed design.

1 Claim, 2 Drawing Sheets

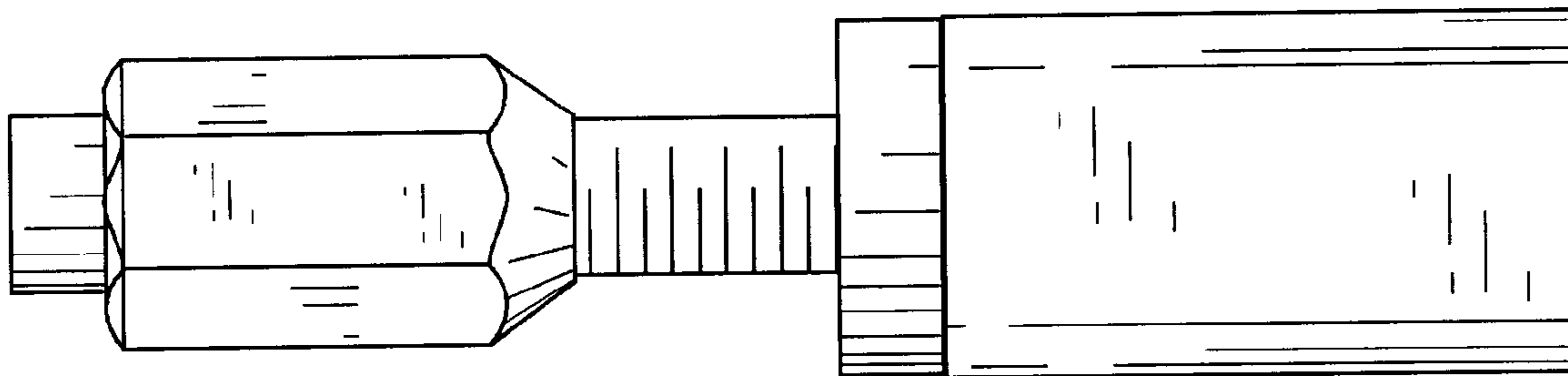

FIG. 1

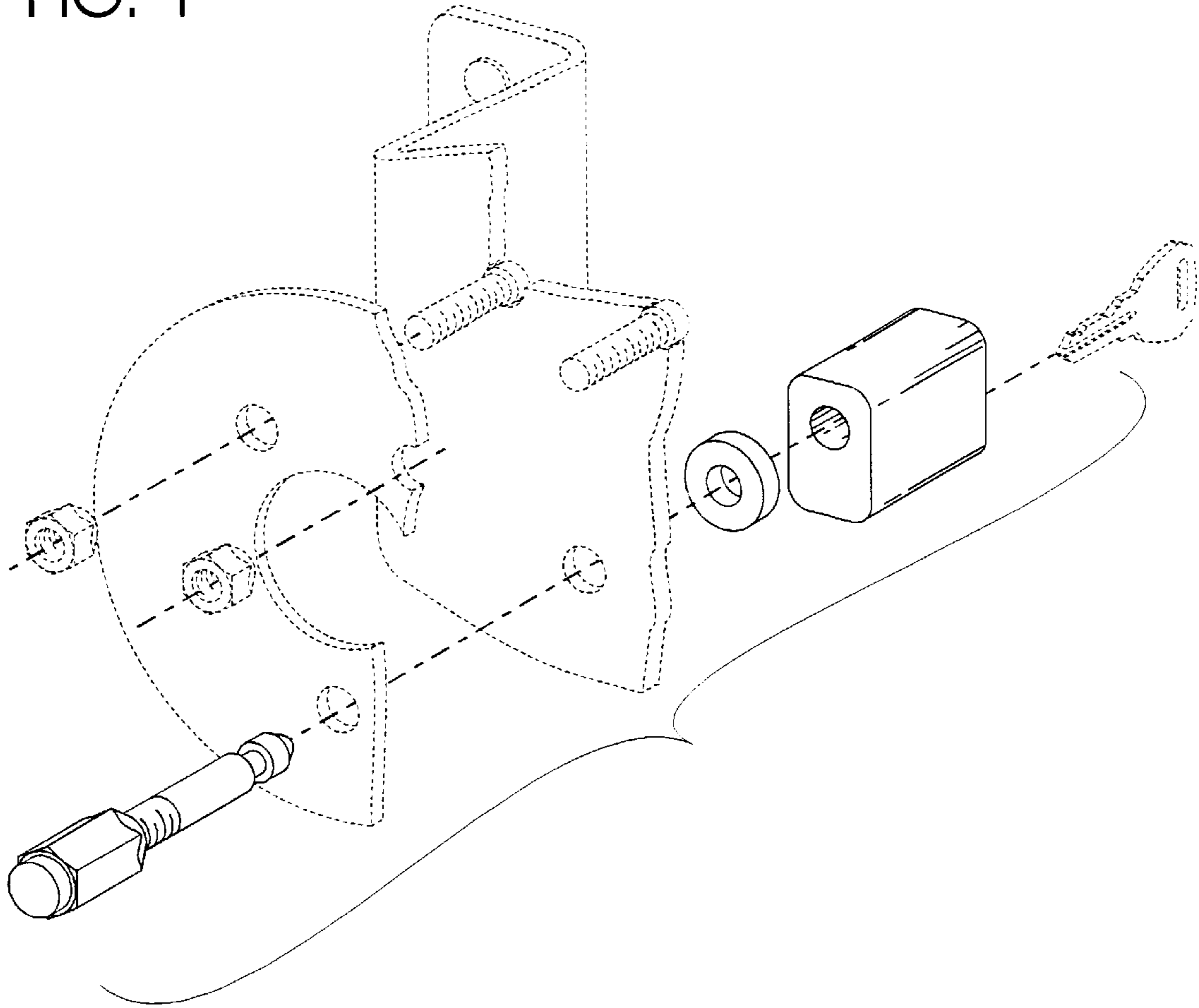

FIG. 2

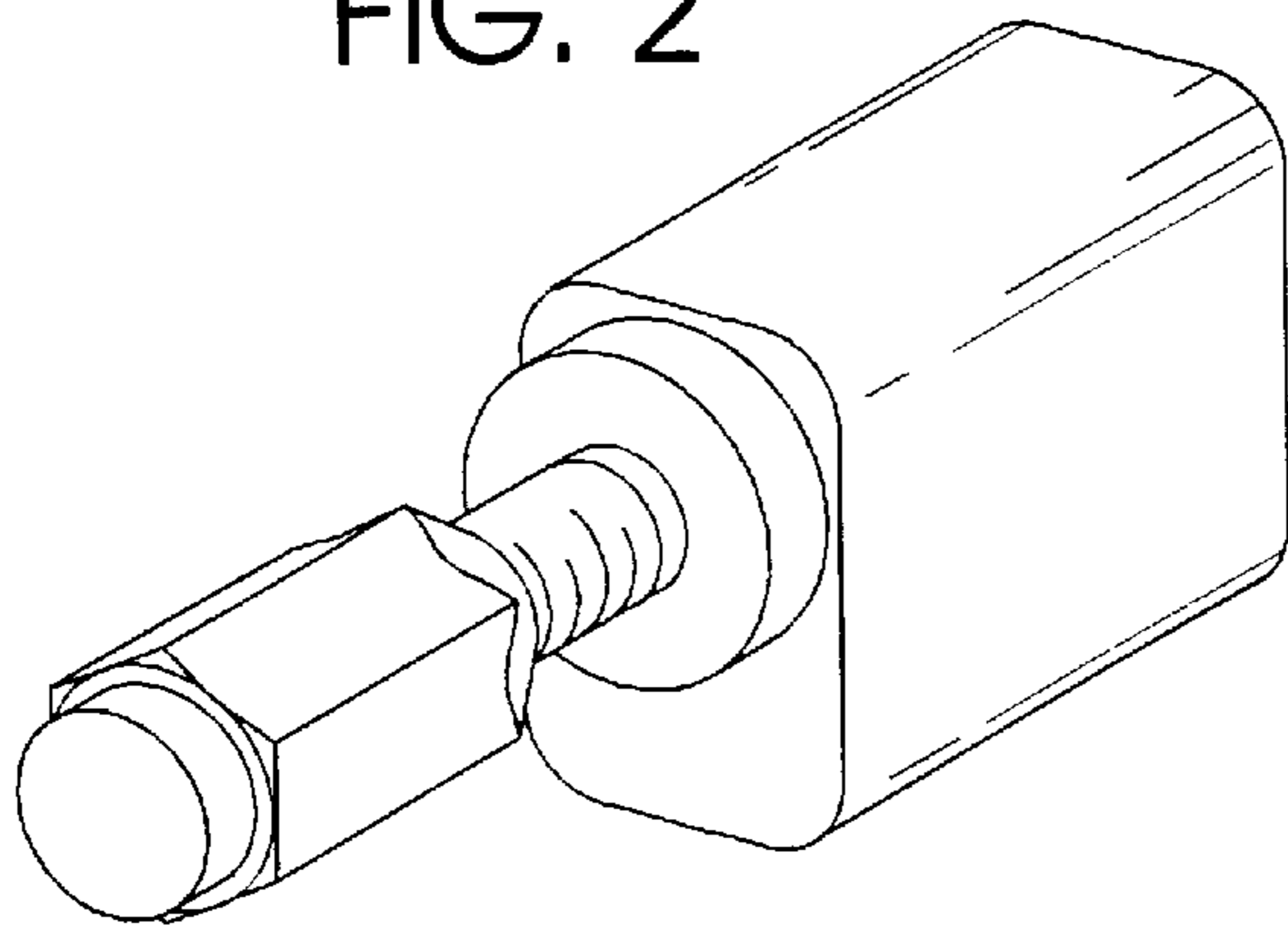

FIG. 3

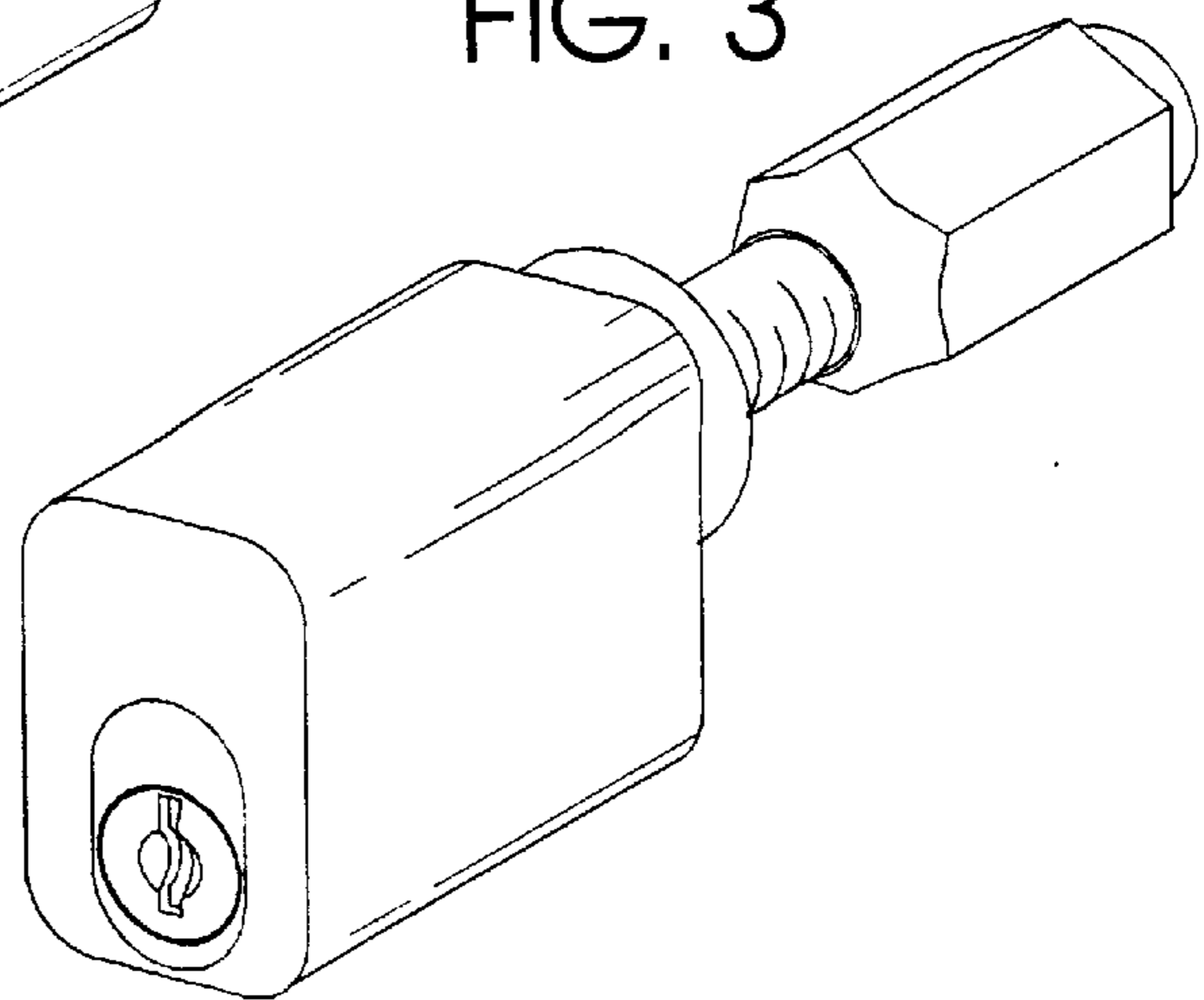

FIG. 4

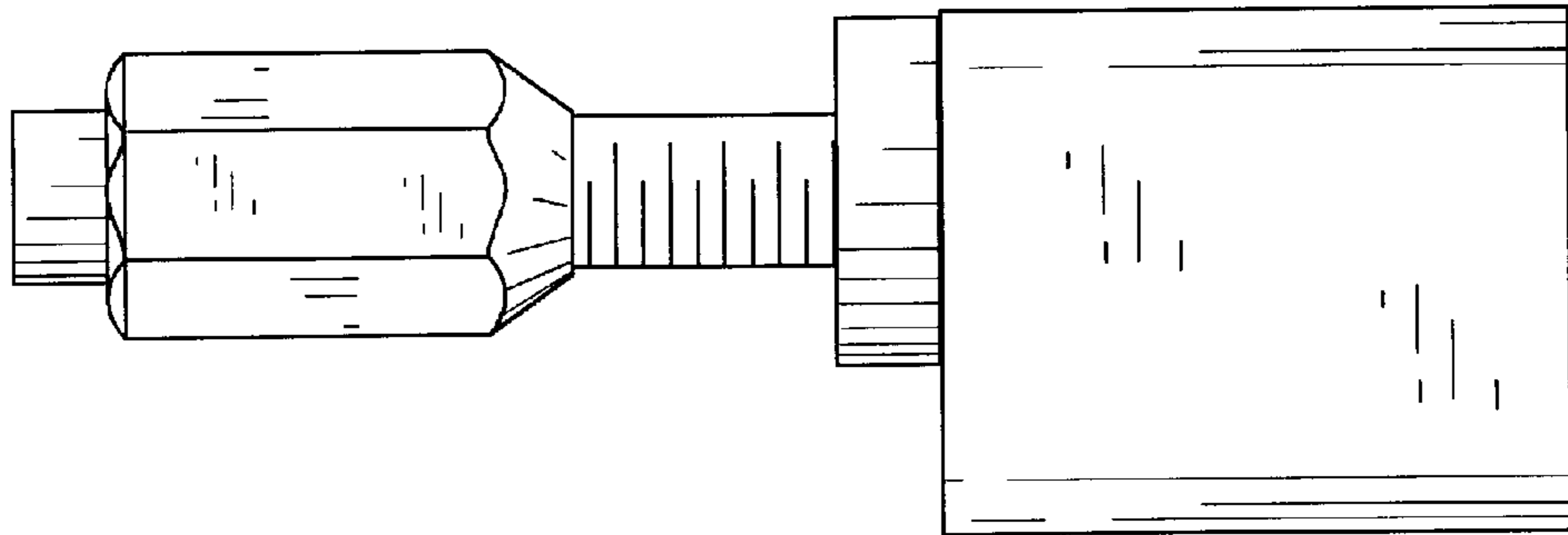

FIG. 5

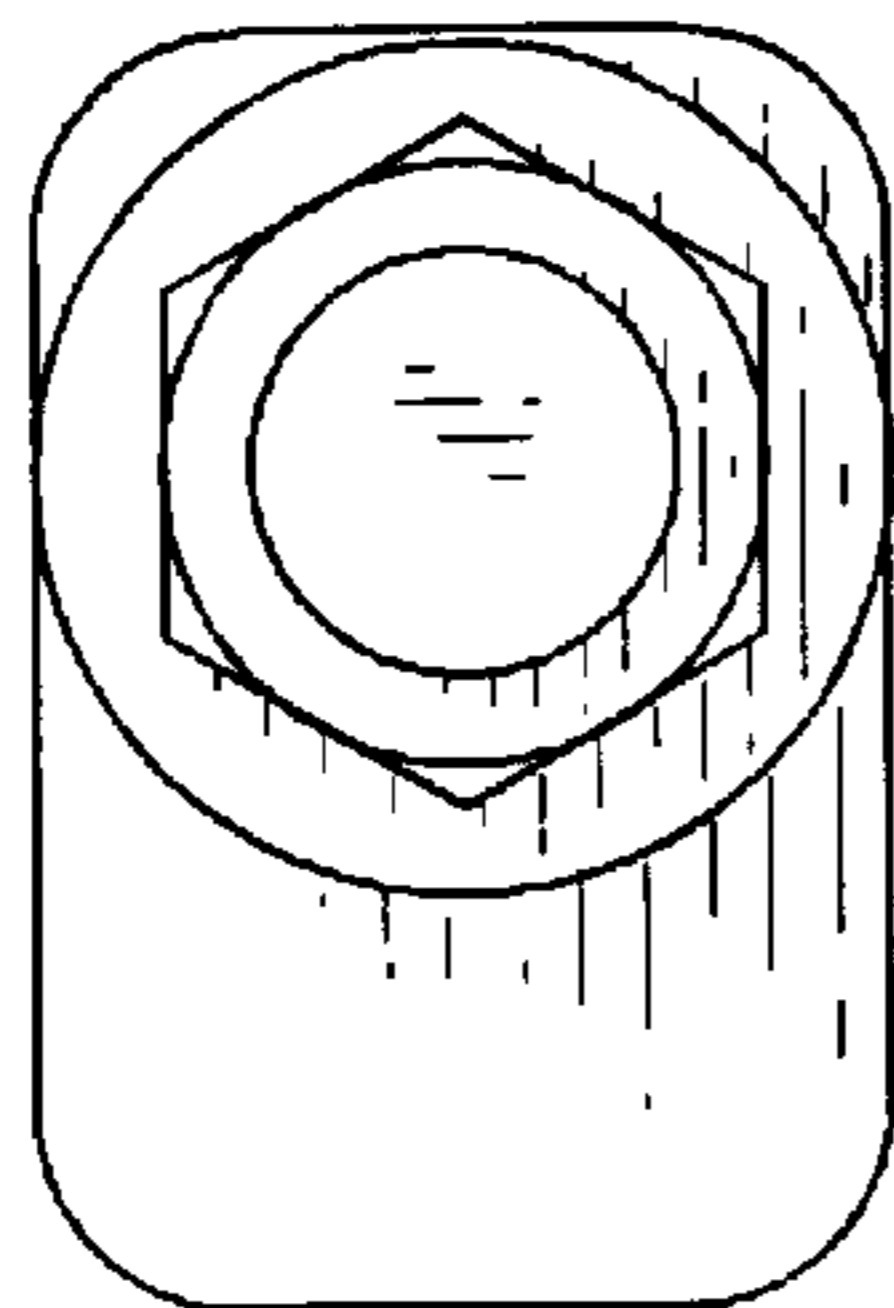

FIG. 6

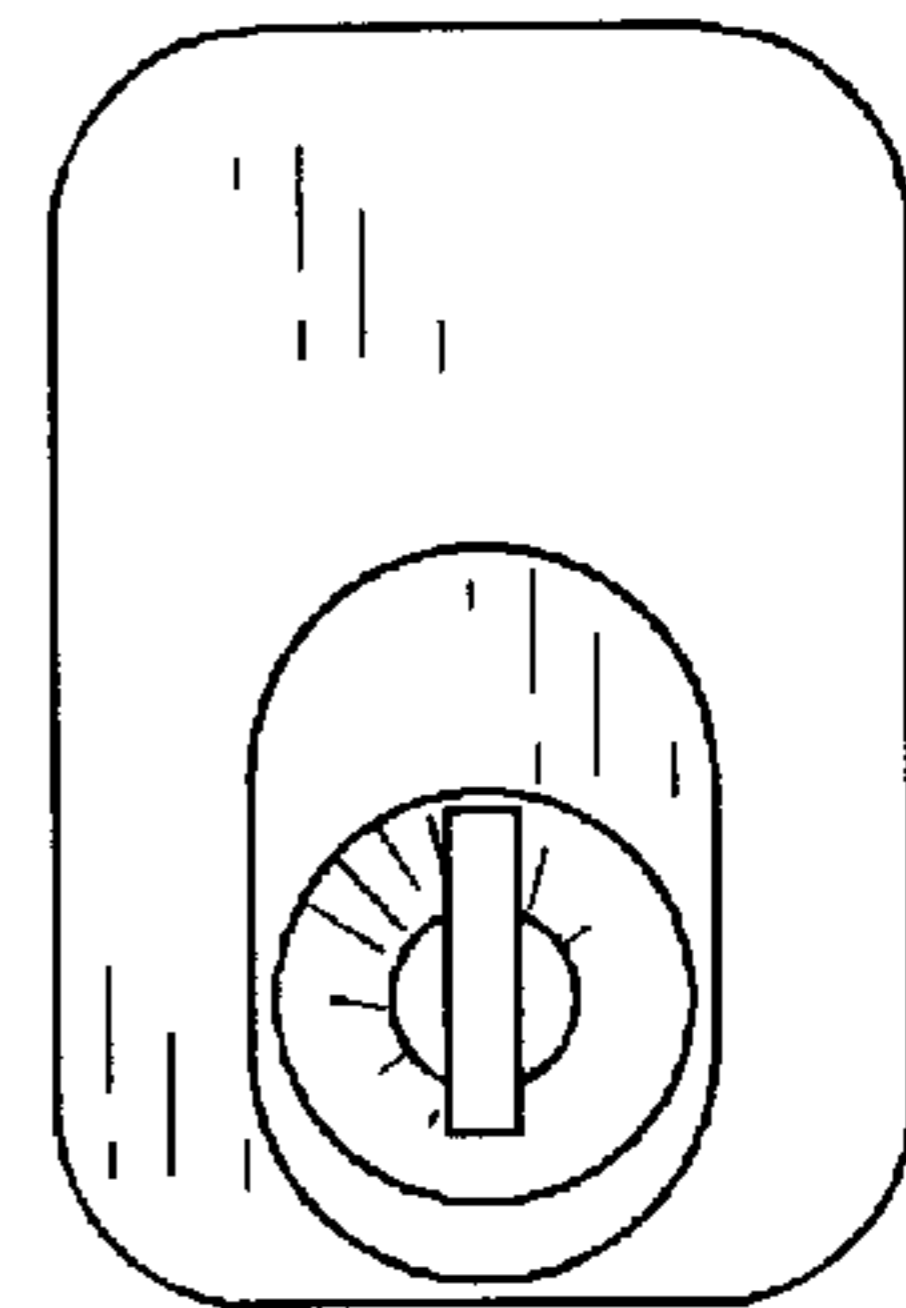

FIG. 7

