



US00D421127S

**United States Patent** [19]  
**Garcia**

[11] **Patent Number: Des. 421,127**

[45] **Date of Patent: \*\* Feb. 22, 2000**

[54] **BABY BOTTLE NIPPLE**

5,209,372 5/1993 Norwood ..... 220/666  
5,878,899 3/1999 Manganiello et al. .... 215/11.6

[76] Inventor: **Guillermo Garcia**, 2908 Southwest Dr.,  
Los Angeles, Calif. 90043

*Primary Examiner*—Stella Reid  
*Attorney, Agent, or Firm*—Goldstein & Canino

[\*\*] Term: **14 Years**

[57] **CLAIM**

[21] Appl. No.: **29/105,582**

The ornamental design for a baby bottle nipple, as shown  
and described.

[22] Filed: **May 28, 1999**

**DESCRIPTION**

[51] **LOC (7) Cl.** ..... **07-01**

[52] **U.S. Cl.** ..... **D24/196**

[58] **Field of Search** ..... D24/196, 193,  
D24/194, 197; 215/11.1, 11.2, 11.3, 11.4,  
11.5, 11.6

FIG. 1 is a perspective view of a nursing bottle nipple,  
showing my new design, the broken line showing of the  
baby bottle being for illustrative purposes only and forming  
no part of the claimed design.

FIG. 2 is another perspective view thereof.

FIG. 3 is a left side elevational view thereof.

FIG. 4 is a right side elevational view thereof.

FIG. 5 is a front elevational view thereof, the rear elevational  
view being a mirror image of the front view.

FIG. 6 is a top plan view thereof; and,

FIG. 7 is a bottom plan view thereof.

[56] **References Cited**

**U.S. PATENT DOCUMENTS**

|            |         |               |       |          |
|------------|---------|---------------|-------|----------|
| D. 294,735 | 3/1988  | Morano et al. | ..... | D24/196  |
| D. 310,567 | 9/1990  | Fitzpatrick   | ..... | D24/197  |
| D. 314,431 | 2/1991  | Bielefeldt    | ..... | D24/197  |
| 3,075,666  | 1/1963  | Hoffstien     | ..... | 215/11.3 |
| 4,979,629  | 12/1990 | Askerneese    | ..... | 215/11.1 |
| 5,129,532  | 7/1992  | Martin        | ..... | 215/11.1 |

**1 Claim, 3 Drawing Sheets**

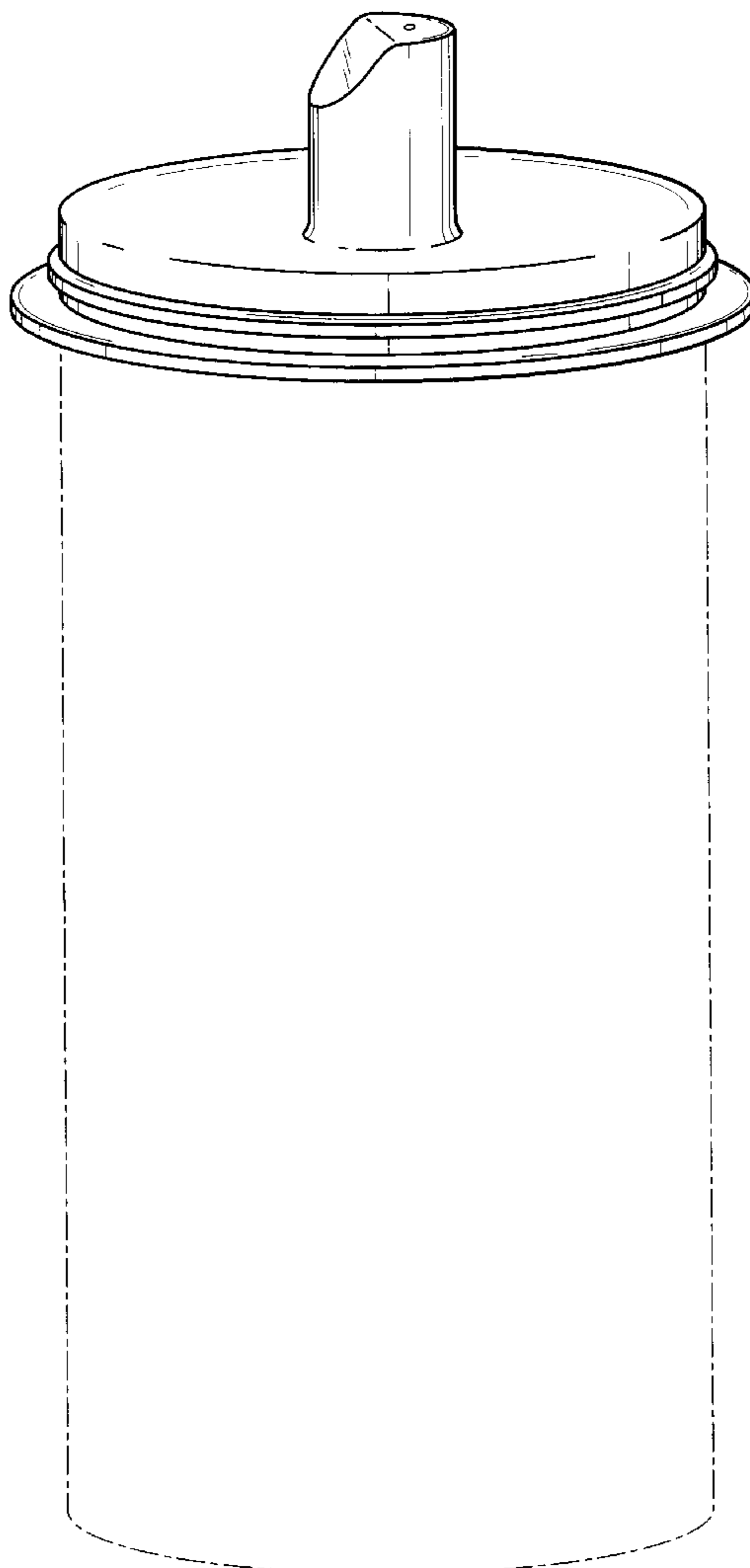

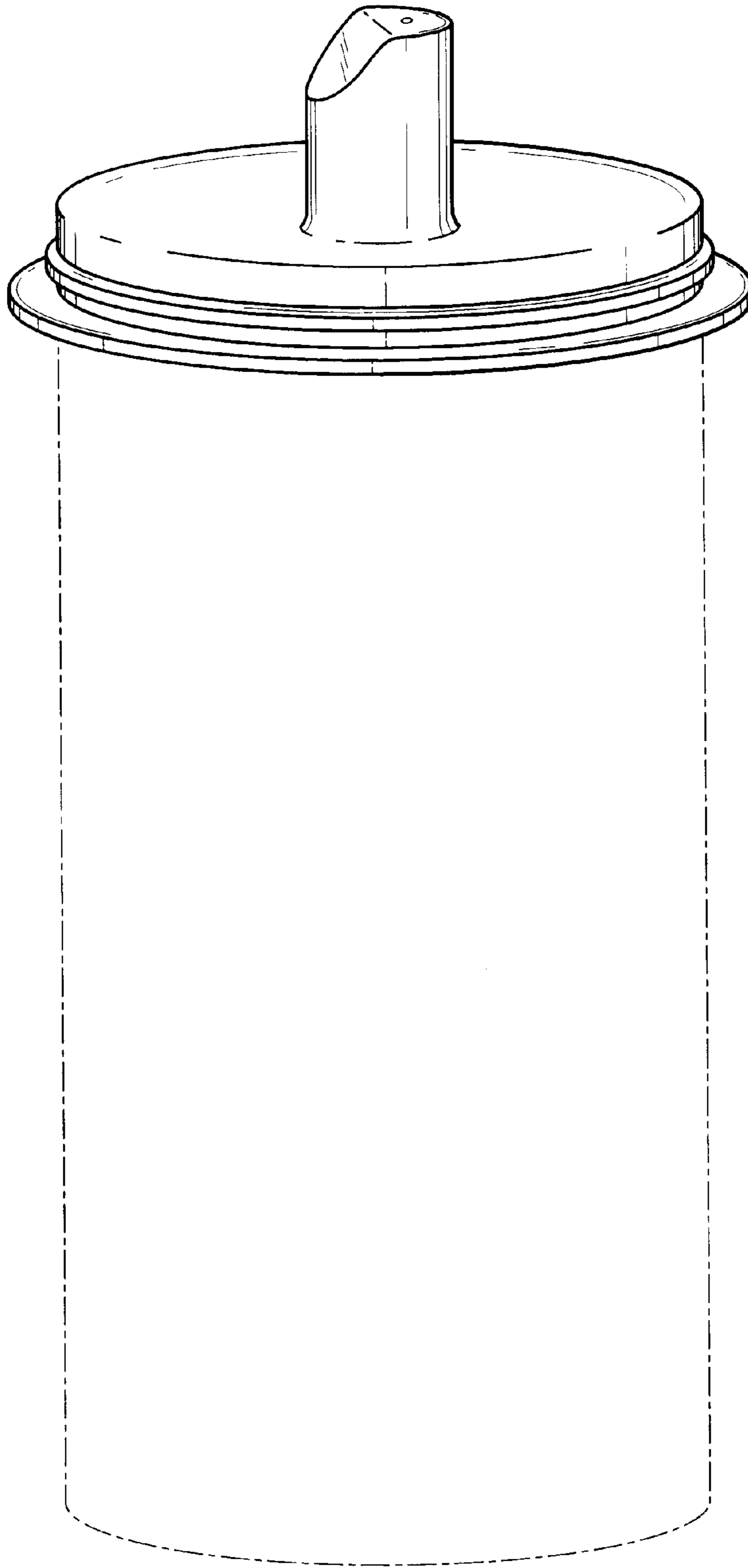

FIG. 1

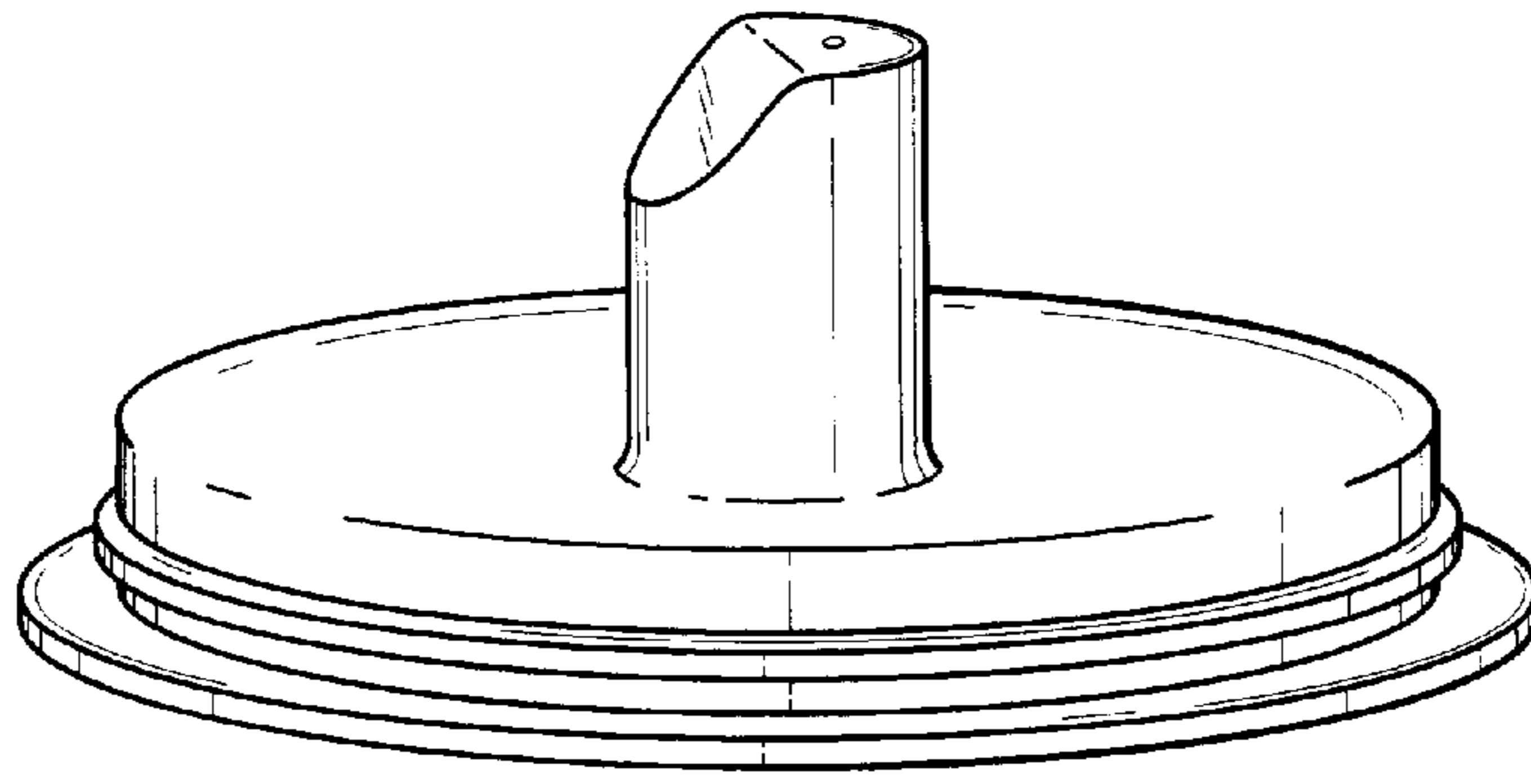

FIG. 2

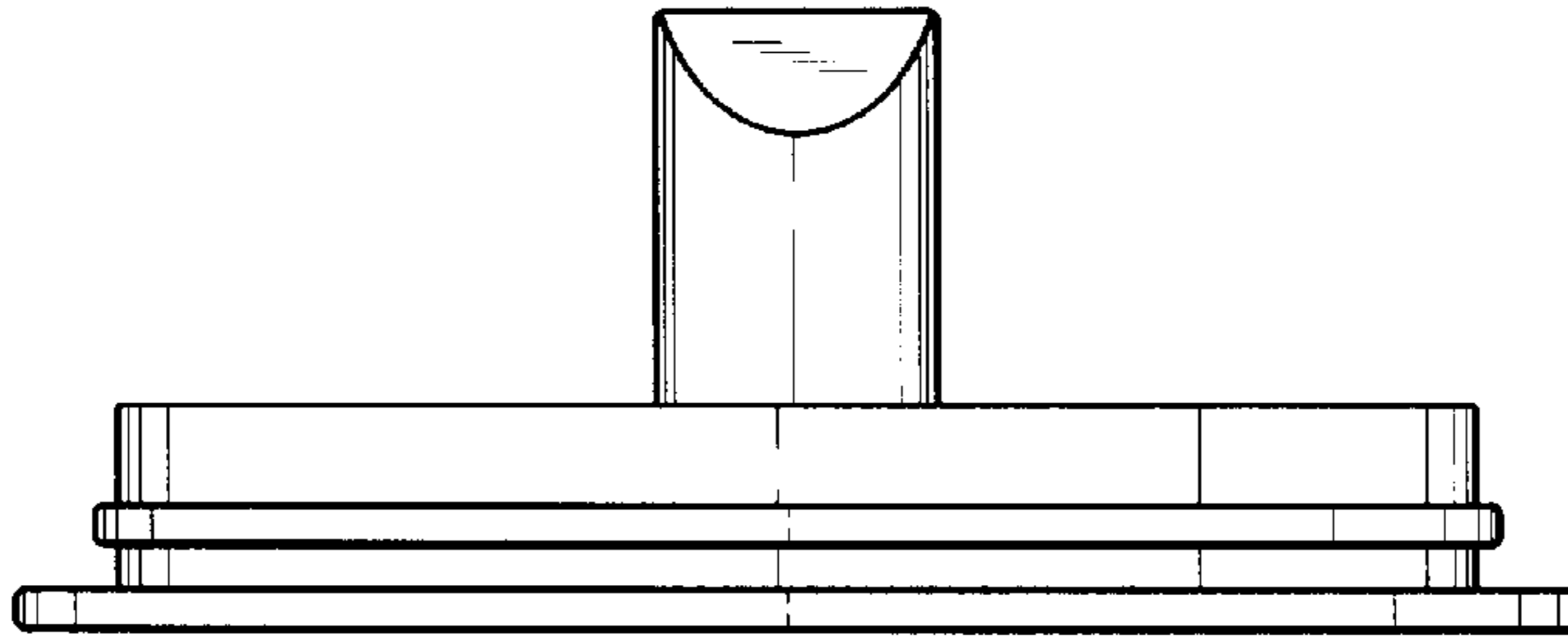

FIG. 3

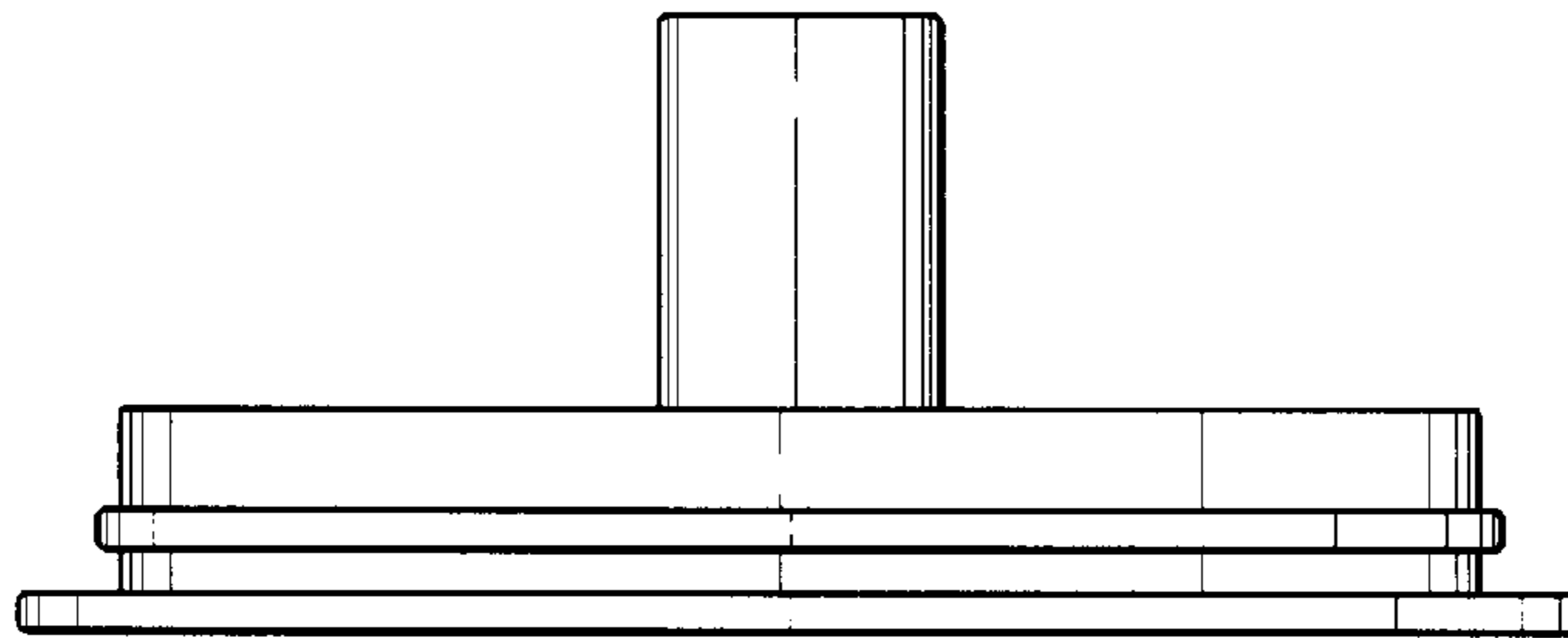

FIG. 4

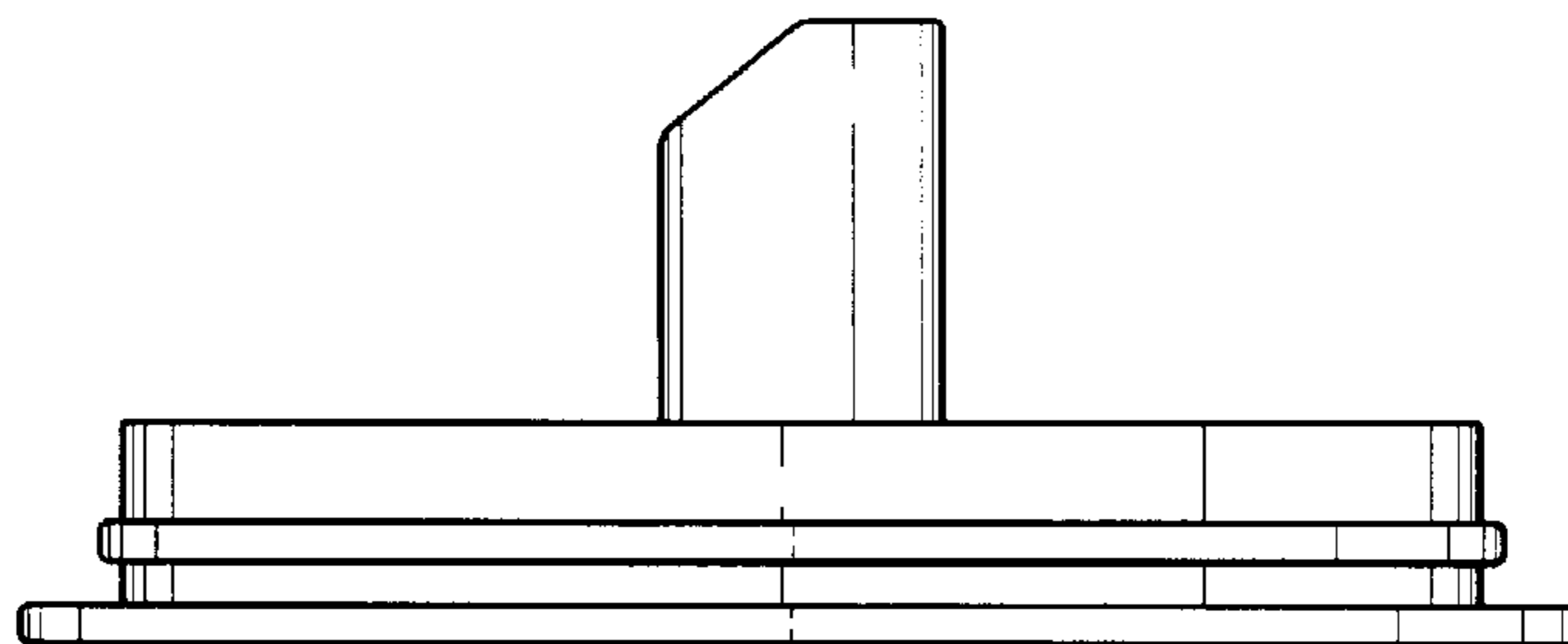

FIG. 5

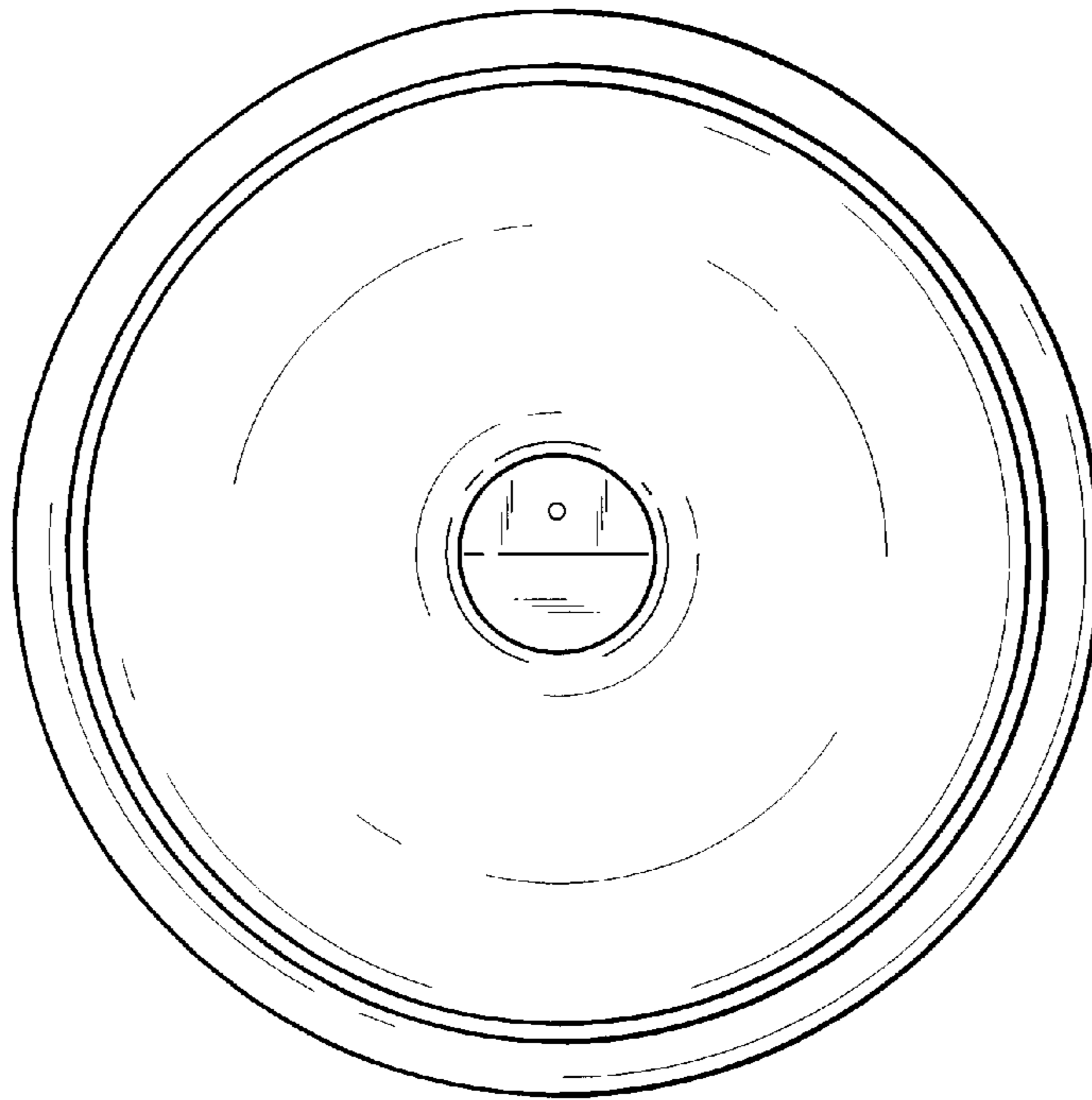

FIG. 6

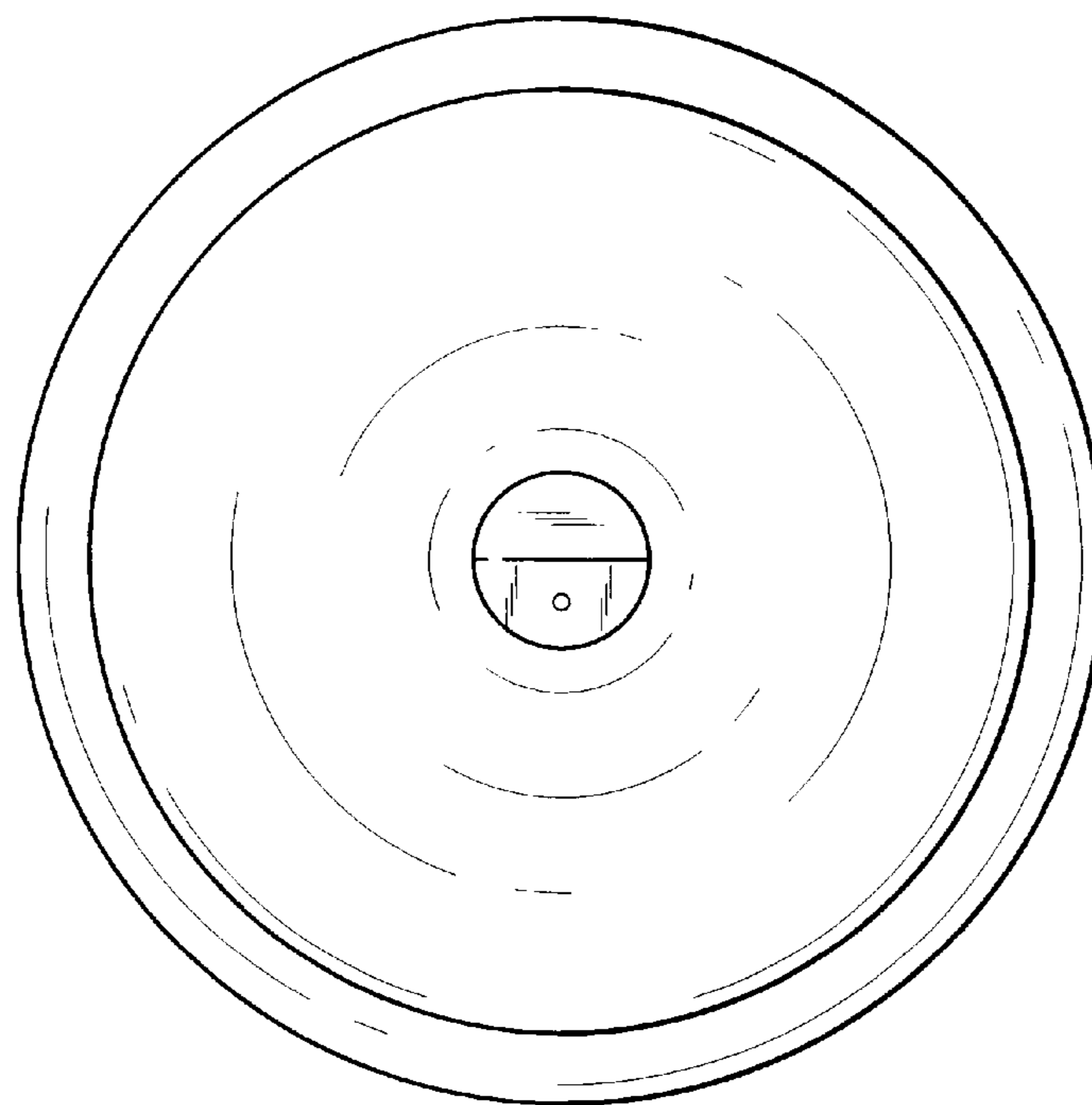

FIG. 7