



US00D418210S

**United States Patent** [19]  
**Roesch**

[11] **Patent Number: Des. 418,210**  
[45] **Date of Patent: \*\* Dec. 28, 1999**

[54] **CONDUIT FITTING**

[75] Inventor: **Mark A. Roesch**, Brecksville, Ohio

[73] Assignee: **The Lamson & Sessions Co.**,  
Cleveland, Ohio

[\*\*] Term: **14 Years**

[21] Appl. No.: **29/093,018**

[22] Filed: **Sep. 1, 1998**

[51] **LOC (6) Cl.** ..... **23-01**

[52] **U.S. Cl.** ..... **D23/262**

[58] **Field of Search** ..... D23/259, 262;  
D24/129; 285/34, 35, 148.1, 144.1, 333,  
390, 238

[56] **References Cited**

**U.S. PATENT DOCUMENTS**

D. 122,386 9/1940 Cafiero ..... D23/259

D. 222,469 10/1971 Plummer ..... D23/262  
D. 320,841 10/1991 Breadmont ..... D23/262  
2,790,680 4/1957 Rosholt ..... 285/238  
3,154,632 10/1964 Browne ..... 285/148.1  
3,650,549 3/1972 Pepper ..... 285/148.1

*Primary Examiner*—Alan P. Douglas  
*Assistant Examiner*—Reid Hecker  
*Attorney, Agent, or Firm*—Jones, Day, Reavis & Pogue

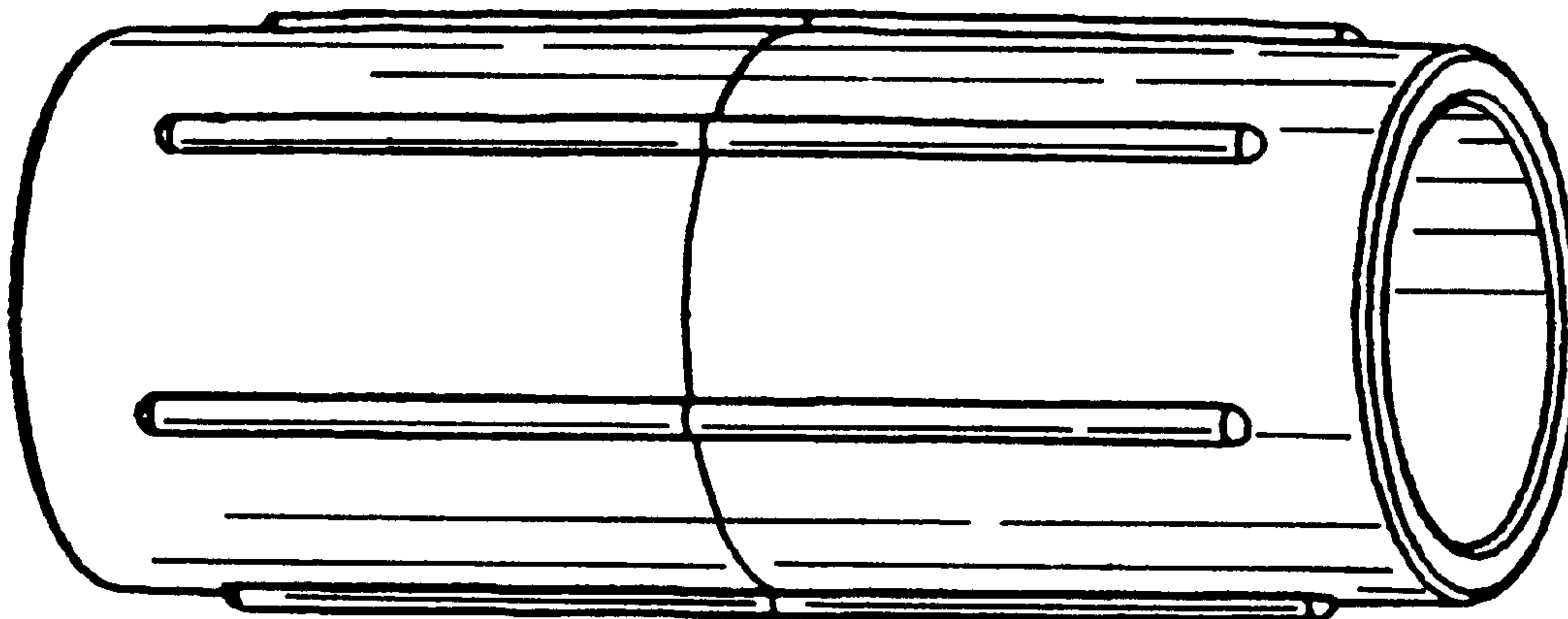
[57] **CLAIM**

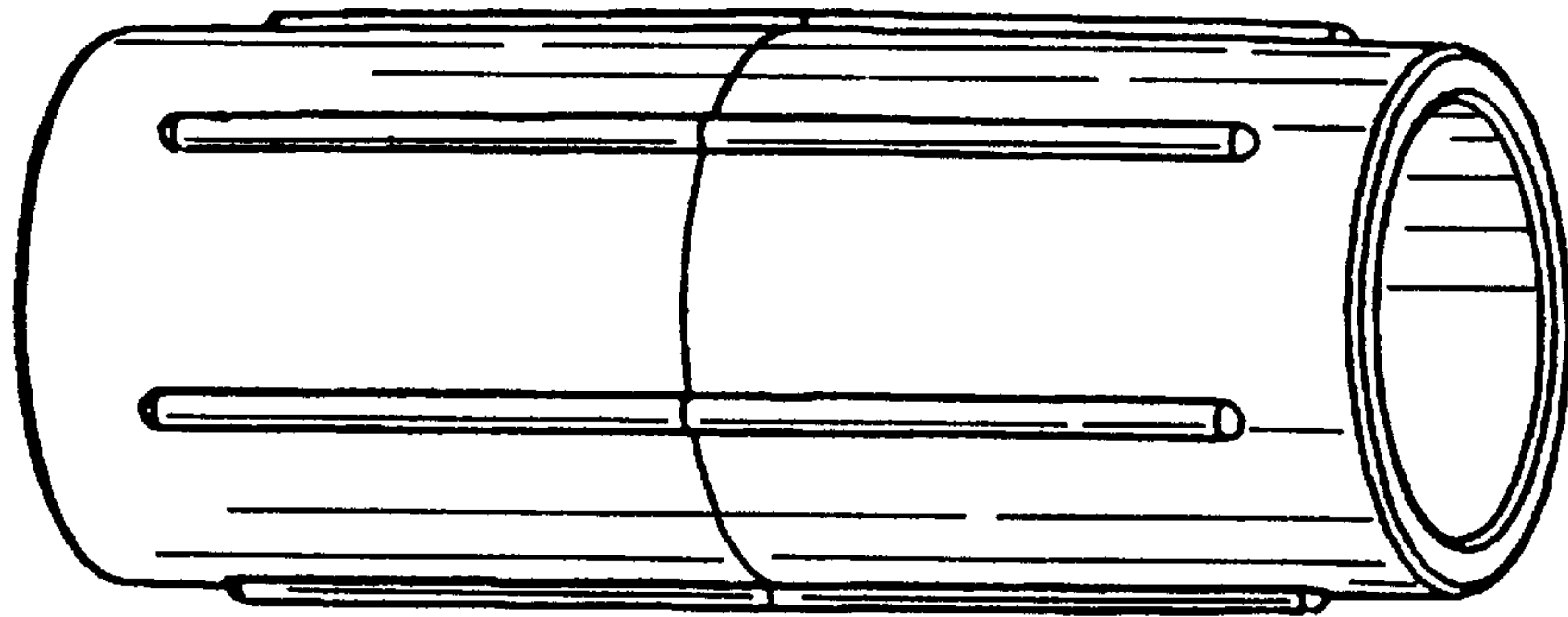
The ornamental design for a conduit fitting, as shown and described.

**DESCRIPTION**

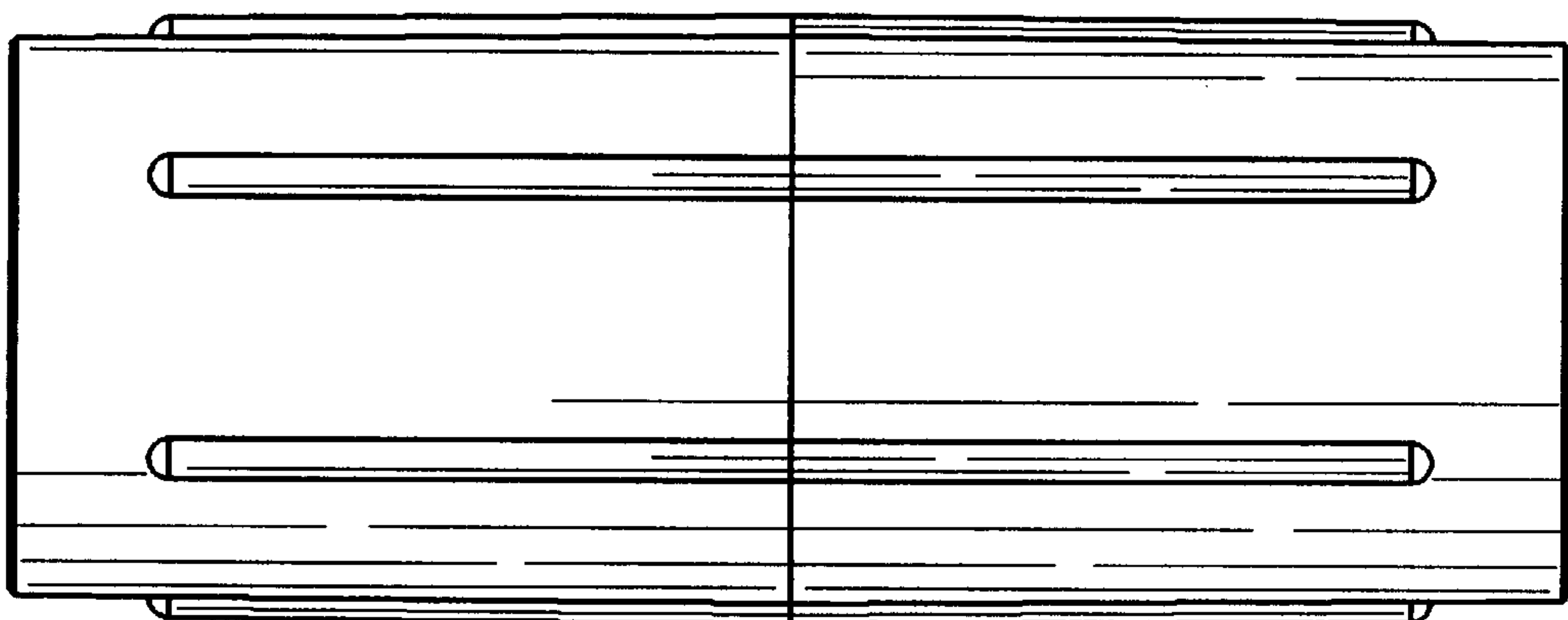
FIG. 1 is an oblique view of the conduit fitting;  
FIG. 2 is a side view thereof; and,  
FIG. 3 is an end view thereof, it being understood that the  
opposite end is a mirror image thereof.

**1 Claim, 1 Drawing Sheet**

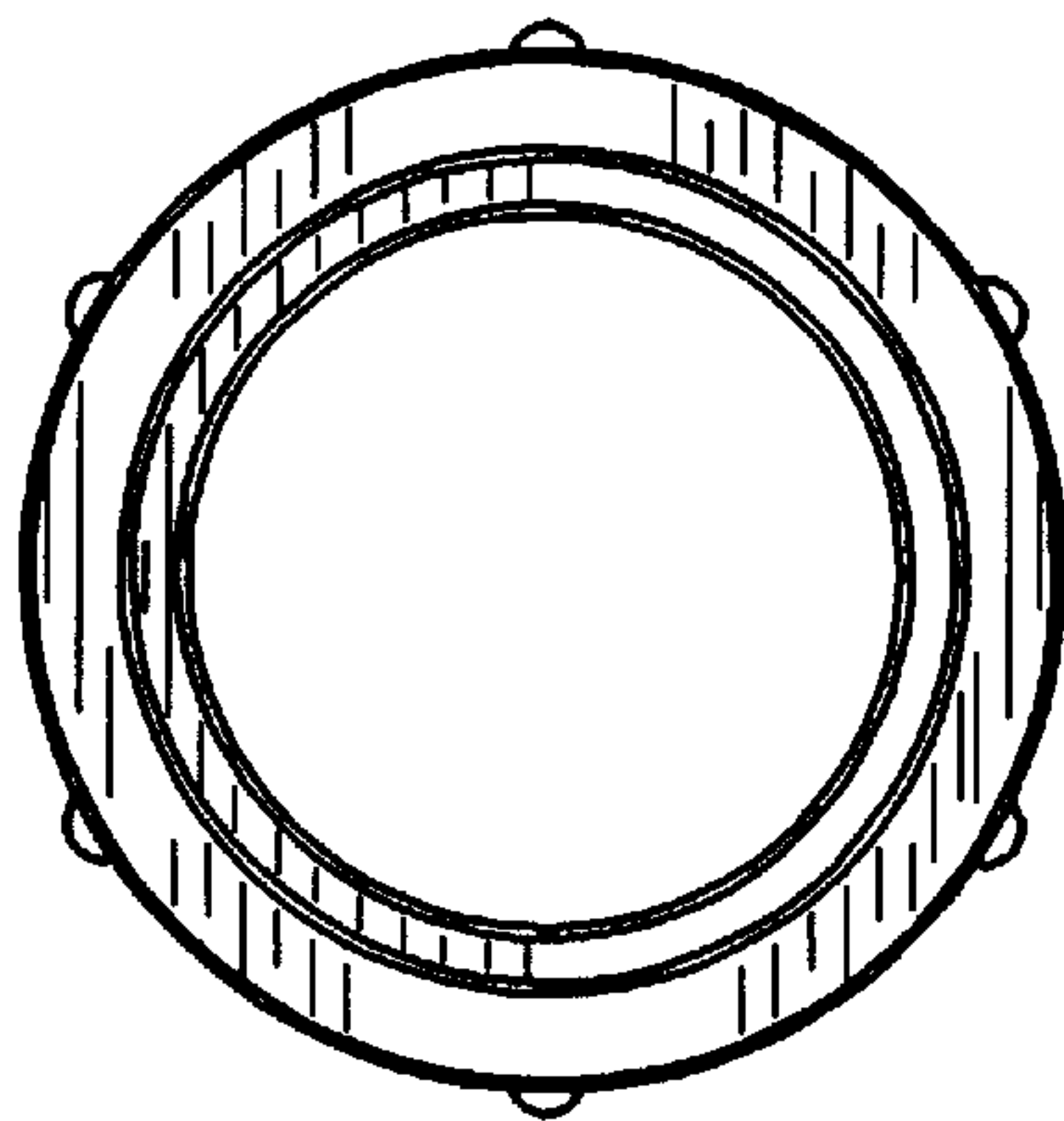




*Fig. 1*



*Fig. 2*



*Fig. 3*