



US00D416292S

United States Patent [19] Hsieh

[11] **Patent Number: Des. 416,292**

[45] **Date of Patent: ** Nov. 9, 1999**

[54] **TOY AQUARIUM**

[76] Inventor: **Chien-Chih Hsieh**, 7F, No. 218, Sec. 3, Ta-Tung Rd., Hsi-Chih Town Taipei Hsien, Taiwan

[**] Term: **14 Years**

[21] Appl. No.: **29/091,803**

[22] Filed: **Aug. 6, 1998**

[51] **LOC (6) Cl.** **21-01**

[52] **U.S. Cl.** **D21/483; D30/101**

[58] **Field of Search** D21/783; D30/101-105; 446/267; 119/245, 263, 265, 267, 269; 40/406, 408; 47/69

[56] **References Cited**

U.S. PATENT DOCUMENTS

D. 356,404	3/1995	Hashimoto	D30/101
D. 366,350	1/1996	Ichikawa	D30/101
3,232,272	2/1966	Dosamantes De Jose	119/269
4,578,044	3/1986	Saitoh	446/267
4,967,694	11/1990	Waldman	47/69
5,603,176	2/1997	Eddins, et al.	40/406

Primary Examiner—Raphael Barkai
Attorney, Agent, or Firm—Ware, Fressola, Van Der Sluys & Adolphson LLP

[57] **CLAIM**

The ornamental design for toy aquarium, as shown in described.

DESCRIPTION

FIG. 1 is a perspective view of a toy aquarium showing my design;
FIG. 2 is a front elevational view of the toy aquarium of FIG. 1;
FIG. 3 is a rear elevational view of the toy aquarium of FIG. 1;
FIG. 4 is a left side view of the toy aquarium of FIG. 1;
FIG. 5 is a right side view of the toy aquarium of FIG. 1;
FIG. 6 is a top plan view of the toy aquarium of FIG. 1; and, FIG. 7 is a bottom plan view of the toy aquarium of FIG. 1.
The broken lines shown in FIGS. 1, 2, 4 and 5 is for illustrative purposes only and form no part of the claimed design.

1 Claim, 7 Drawing Sheets

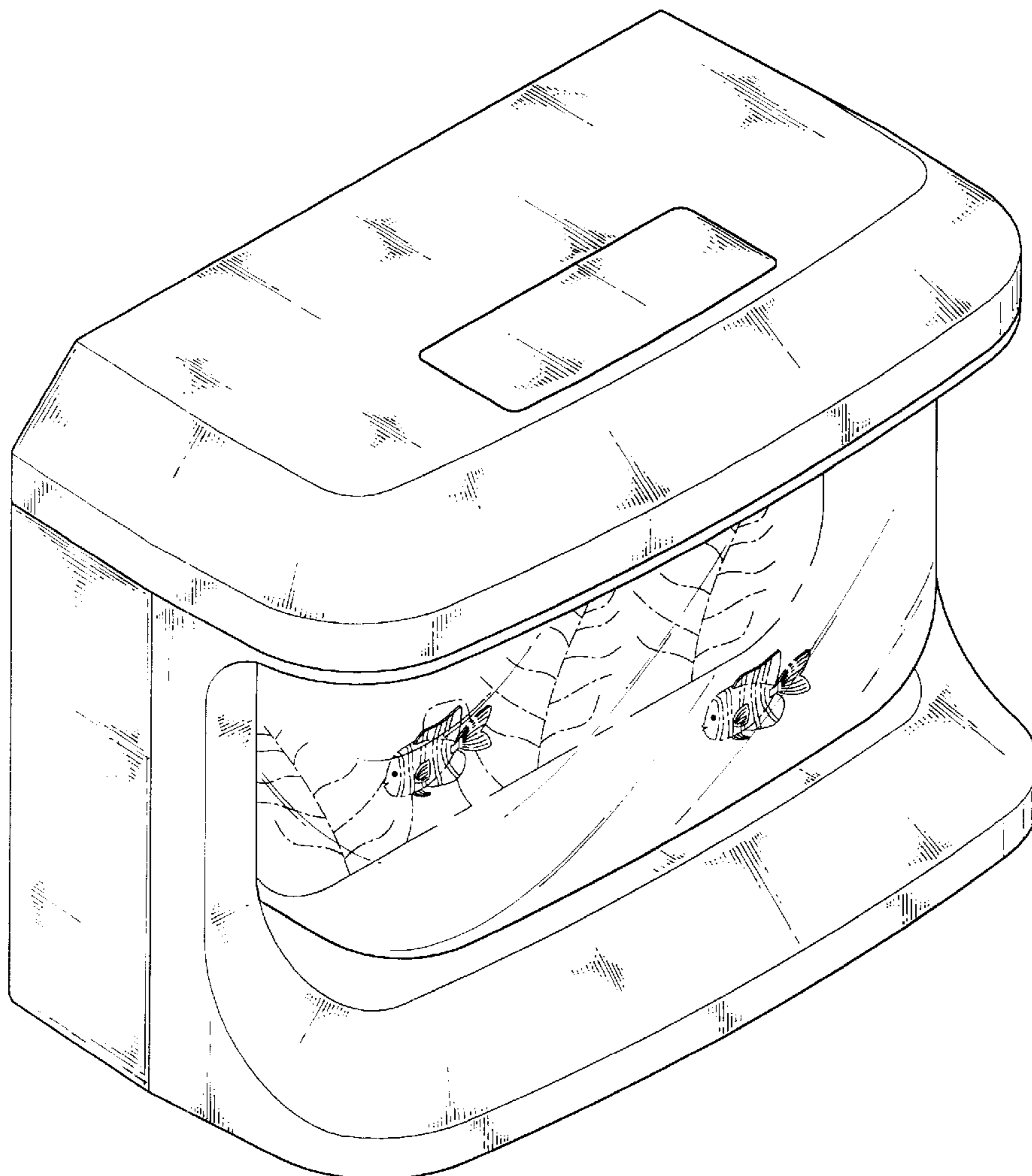

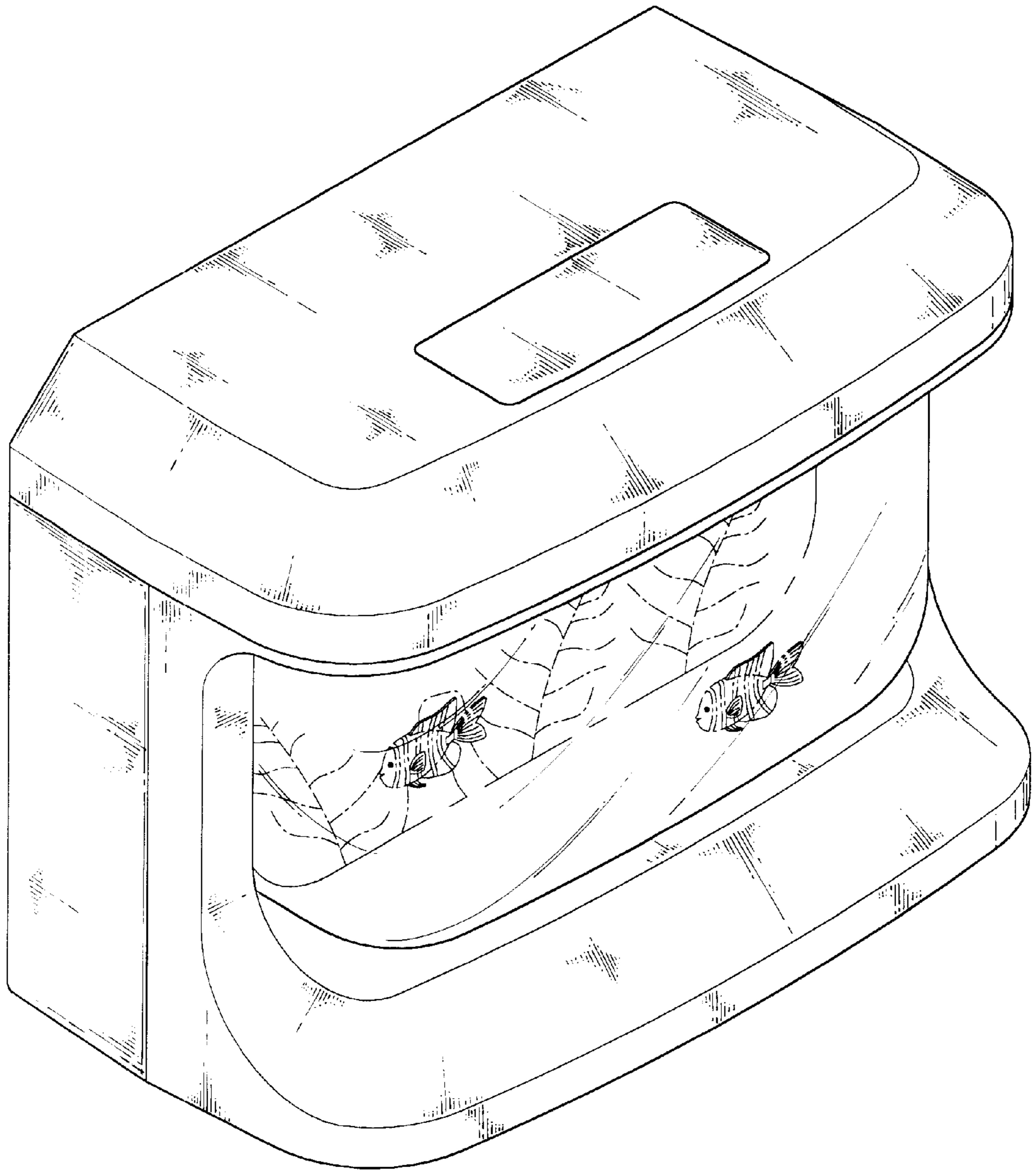

FIG. 1

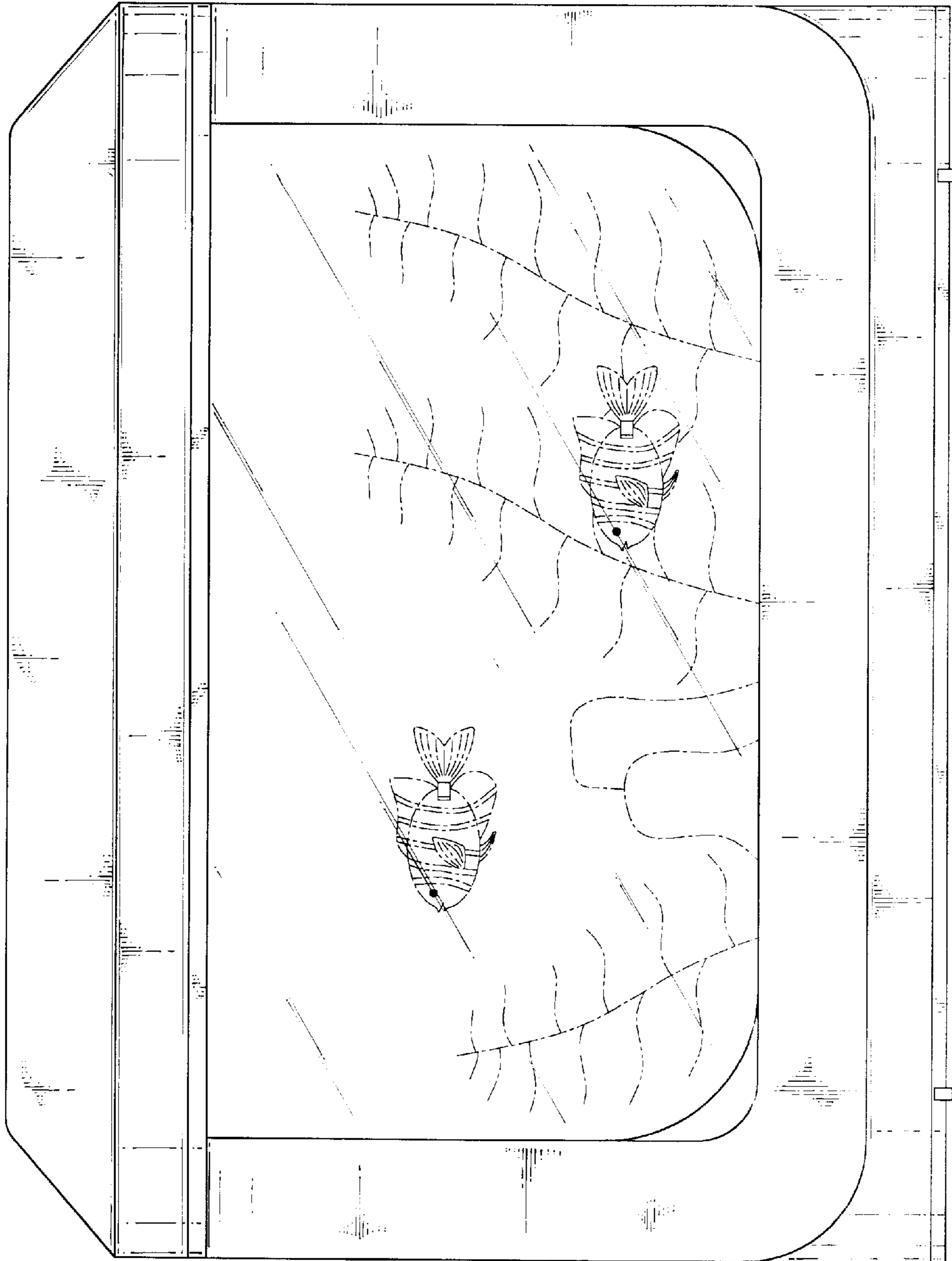

FIG.2

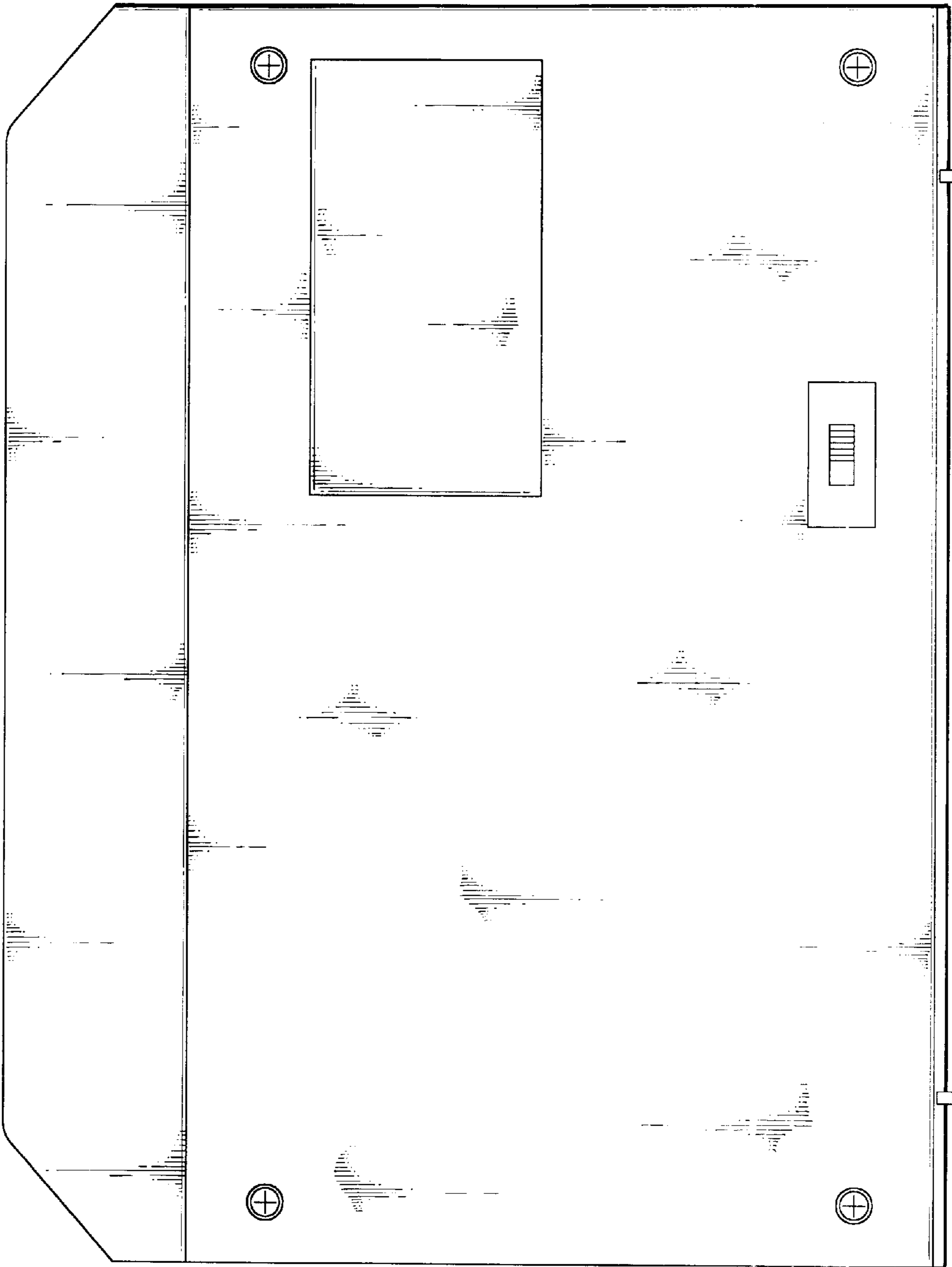

FIG.3

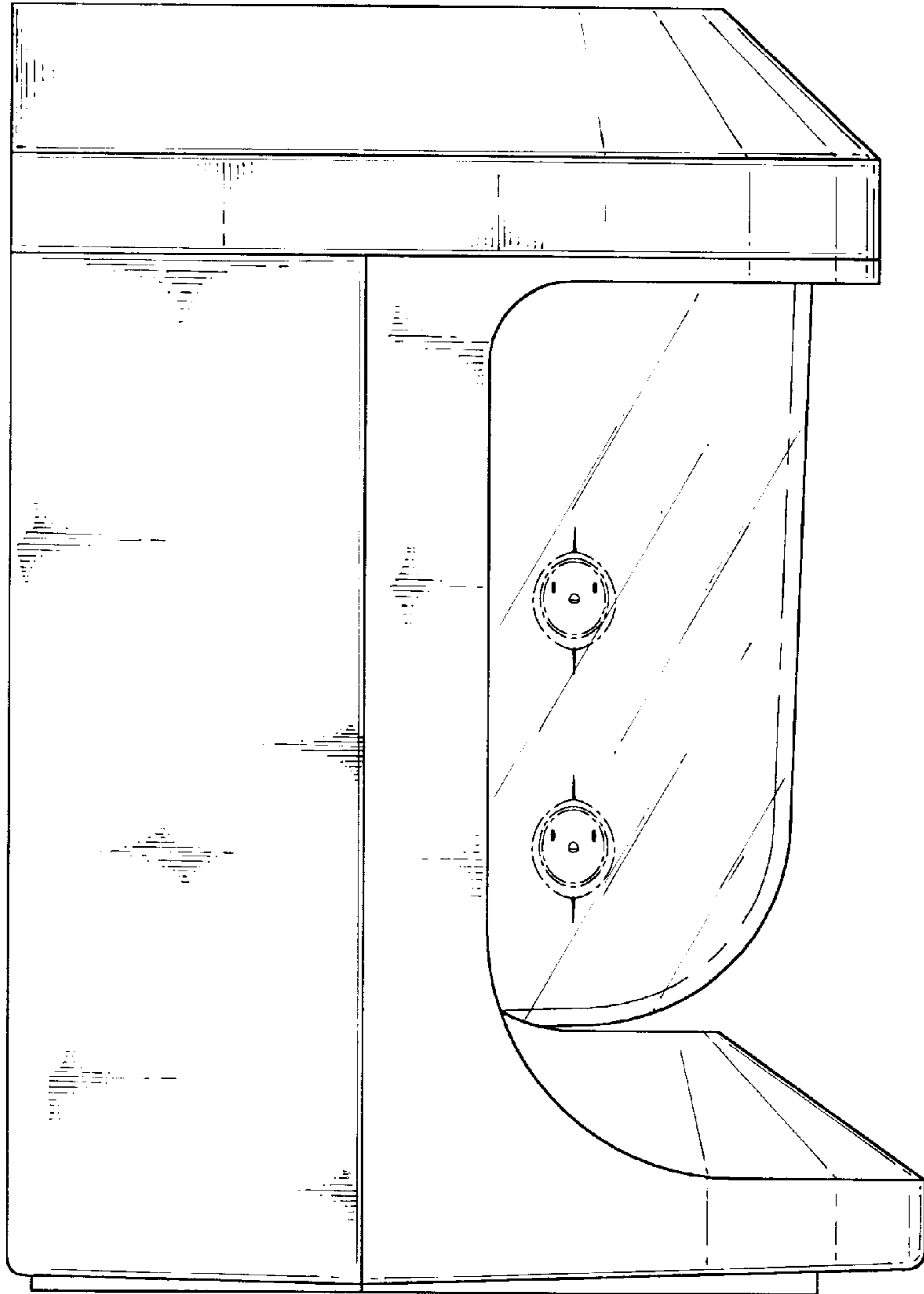

FIG.4

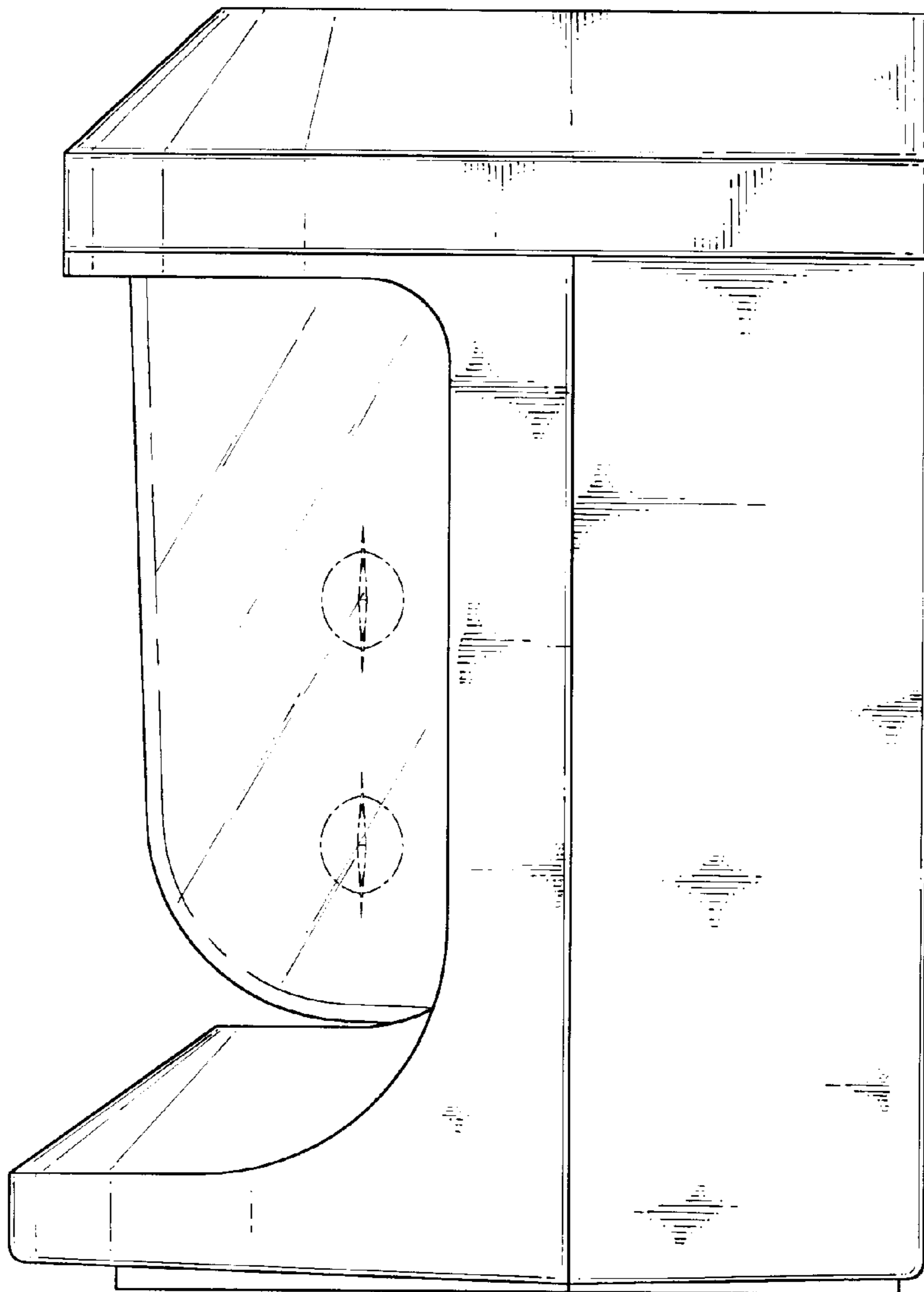

FIG. 5

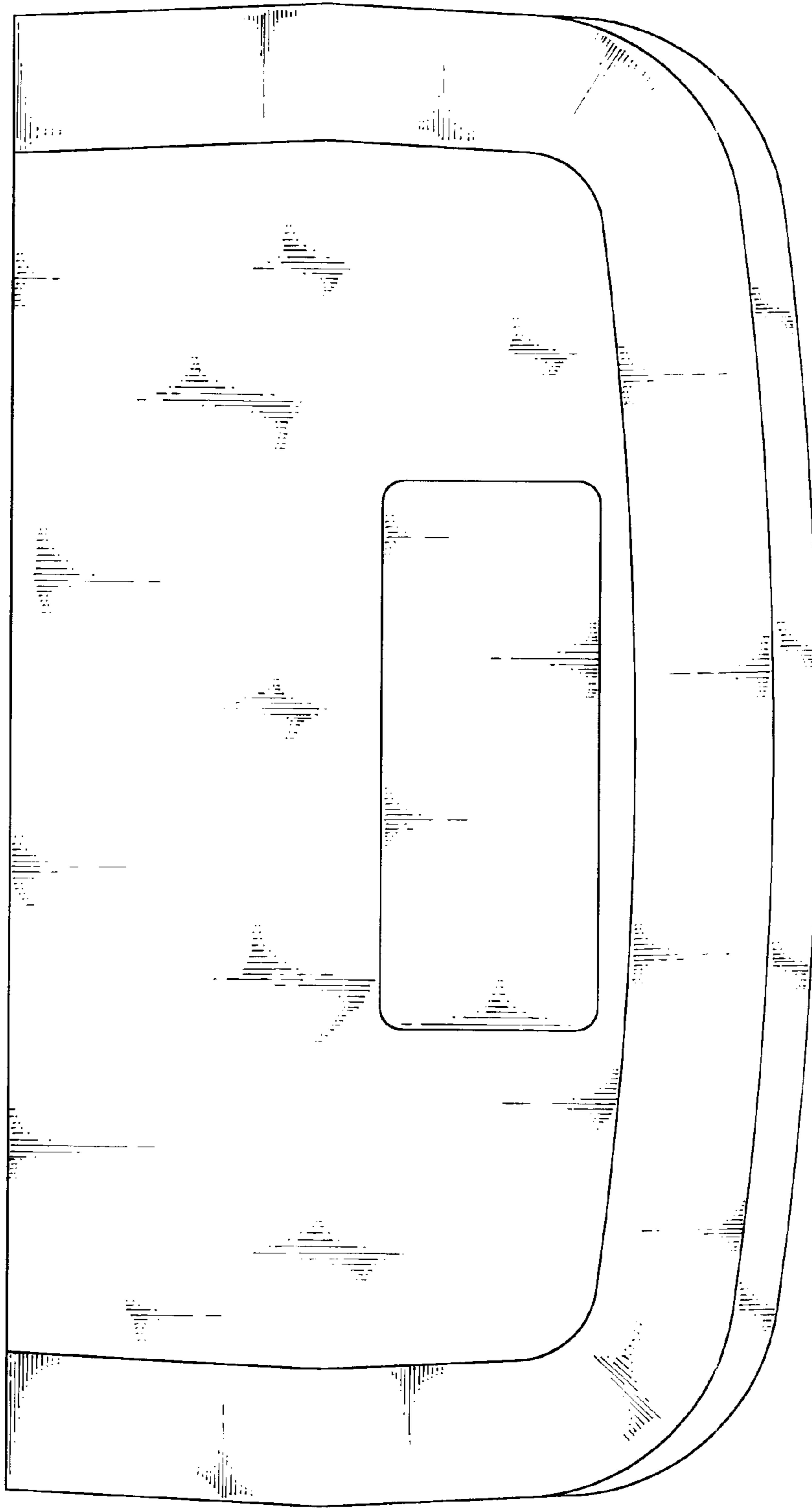

FIG. 6

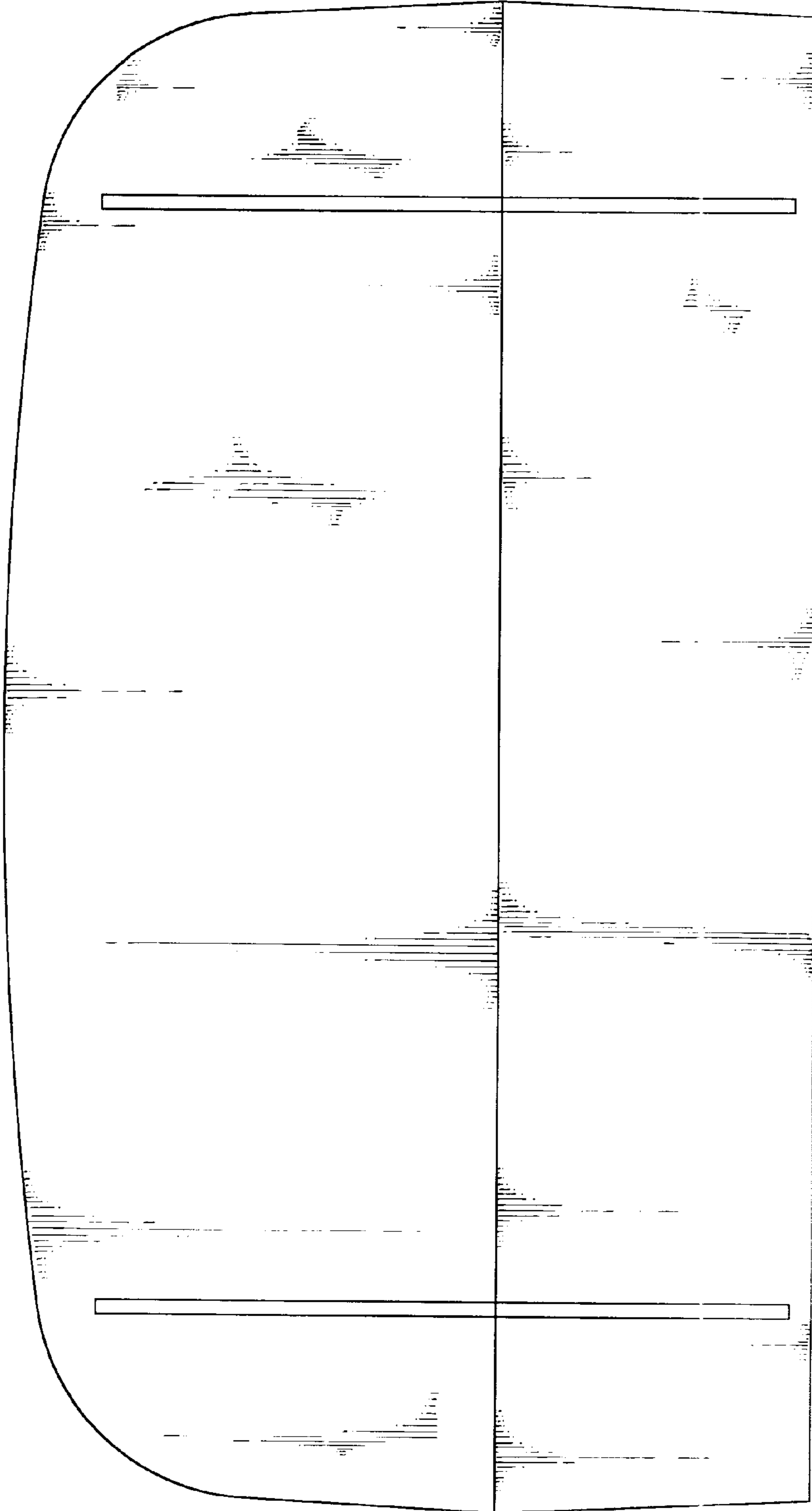

FIG. 7