



US00D416240S

United States Patent [19]

[11] Patent Number: Des. 416,240

Jensen et al.

[45] Date of Patent: ** Nov. 9, 1999

[54] GRAPHICAL INTERFACE IMAGE FOR A DISPLAY SCREEN

D. 399,836 10/1998 Wu et al. D14/114.2
D. 407,698 4/1999 Alexiev D14/114.1

[75] Inventors: Frank M. Jensen; Marie T. Harrington, both of LaJolla; Gerald P. Seeger; James Siegismonti, both of San Diego, all of Calif.

OTHER PUBLICATIONS

“Home, home of the Web: easy way to chronicle family, keep in touch” The Union Tribune Newspaper; Apr. 6, 1999 by Jane Clifford.

[73] Assignee: Binarylabs, Inc., San Diego, Calif.

2 page printout from Website www.familypoint.com on Apr. 9, 1999.

[**] Term: 14 Years

Primary Examiner—M. H. Tung
Attorney, Agent, or Firm—Lyon & Lyon LLP

[21] Appl. No.: 29/078,421

[57] CLAIM

[22] Filed: Oct. 24, 1997

The ornamental design for a graphical interface image for a display screen, as shown and described.

[51] LOC (6) Cl. 14-02

[52] U.S. Cl. D14/114.1

DESCRIPTION

[58] Field of Search D14/114, 114.1-114.9;
D18/24-33; D19/6; D20/11; D21/324.33;
345/326, 339-40, 347-57

FIG. 1 is a front view of a graphical interface image for a display screen, on a reduced scale, the broken line drawing of a display screen is for illustrative purposes only and forms no part of the claimed design;
FIG. 2 is a front view thereof, the image is shown separately for clarity of illustration;
FIG. 3 is a front view of a second embodiment thereof, the image is shown separately for clarity of illustration; and,
FIG. 4 is a front view of a third embodiment thereof, the image is shown separately for clarity of illustration.

[56] References Cited

U.S. PATENT DOCUMENTS

- D. 385,870 11/1997 Thomas D14/114.8
- D. 387,341 12/1997 Thomas D14/114.8
- D. 391,949 3/1998 Munson D14/114.5
- D. 398,298 9/1998 Giordano, III D14/114.2
- D. 398,300 9/1998 Yamamoto et al. D14/114.7
- D. 398,594 9/1998 Tullis D14/114.2
- D. 398,595 9/1998 Baer et al. D14/114.2

1 Claim, 4 Drawing Sheets

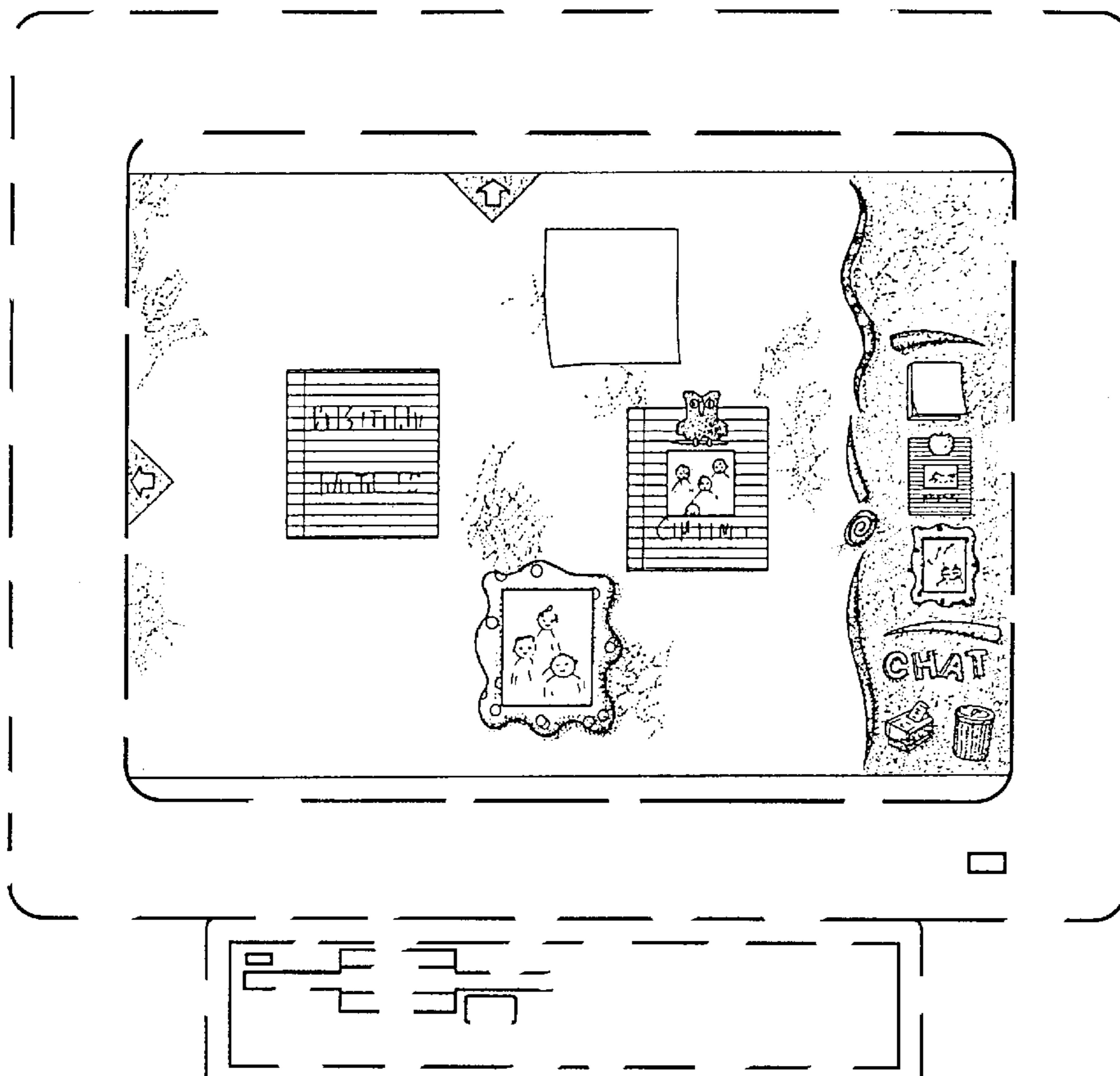

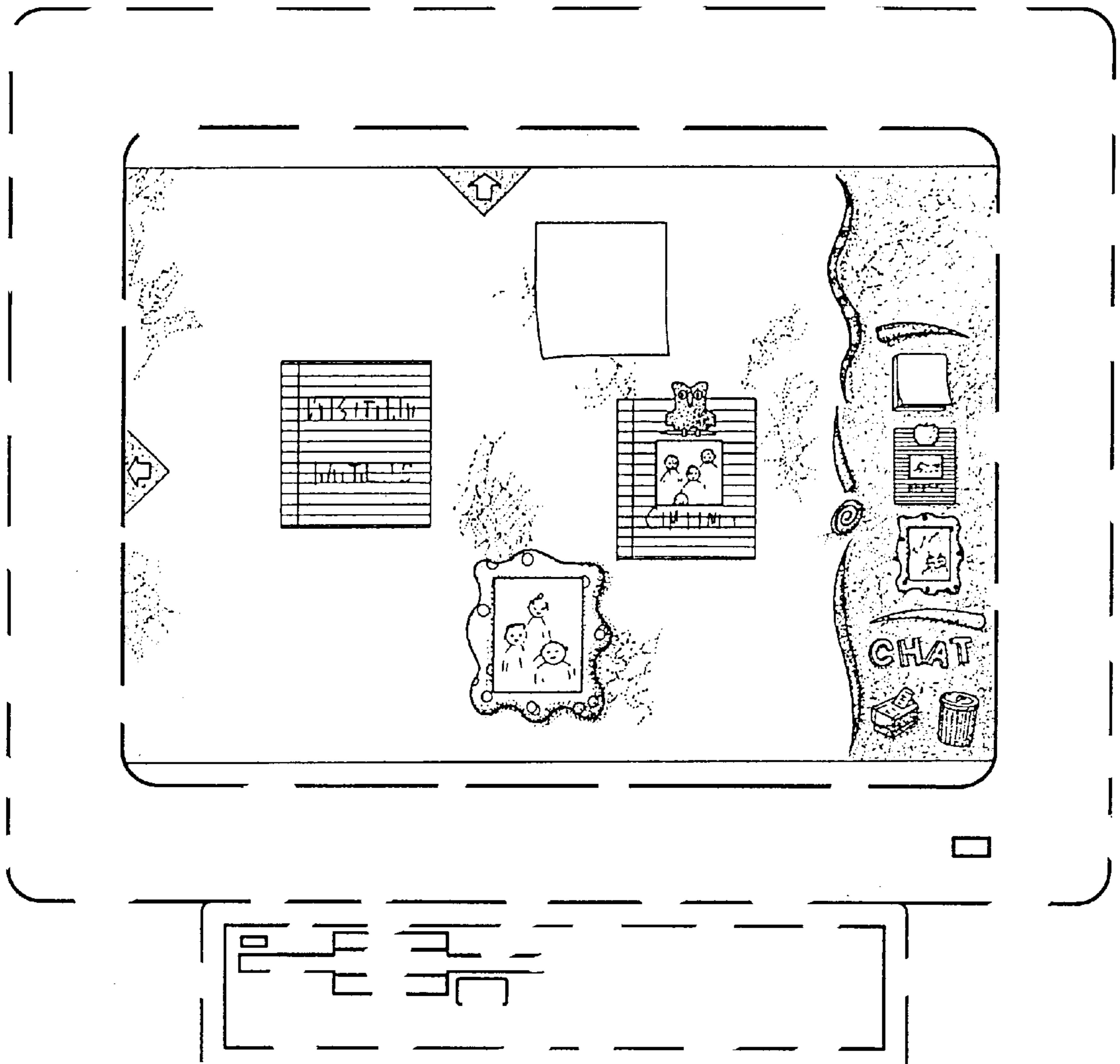

Fig. 1

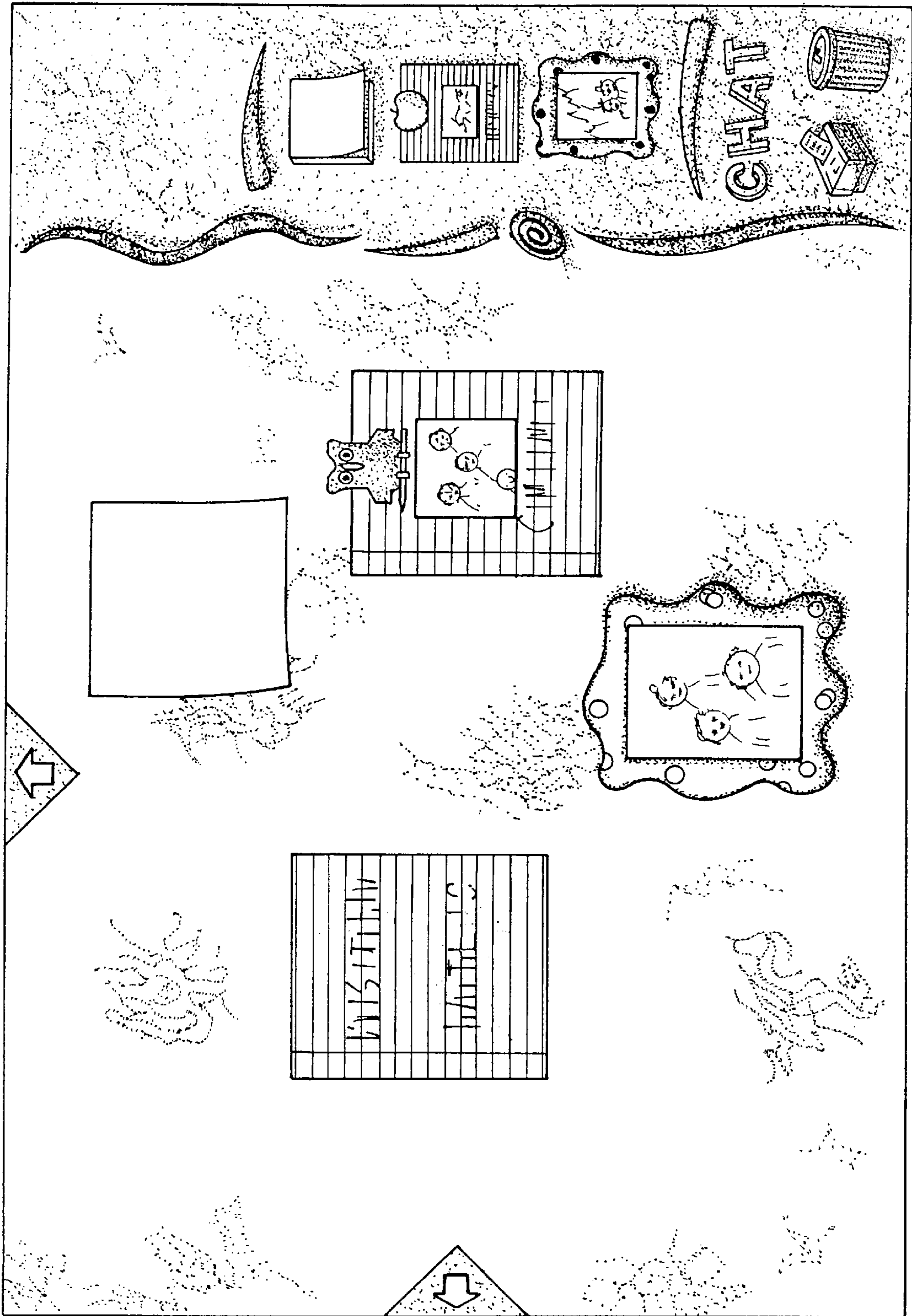

Fig. 2

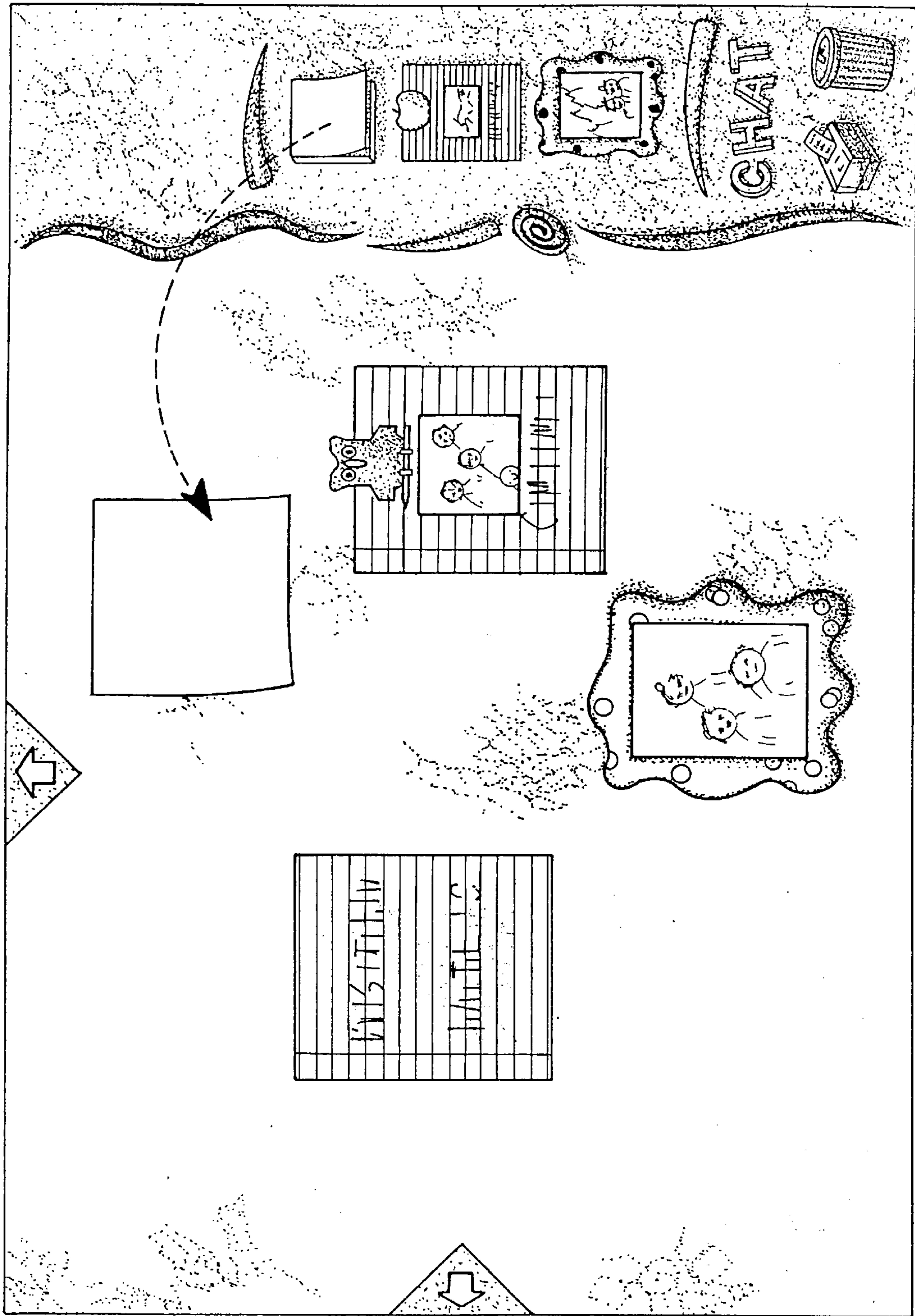

Fig. 3

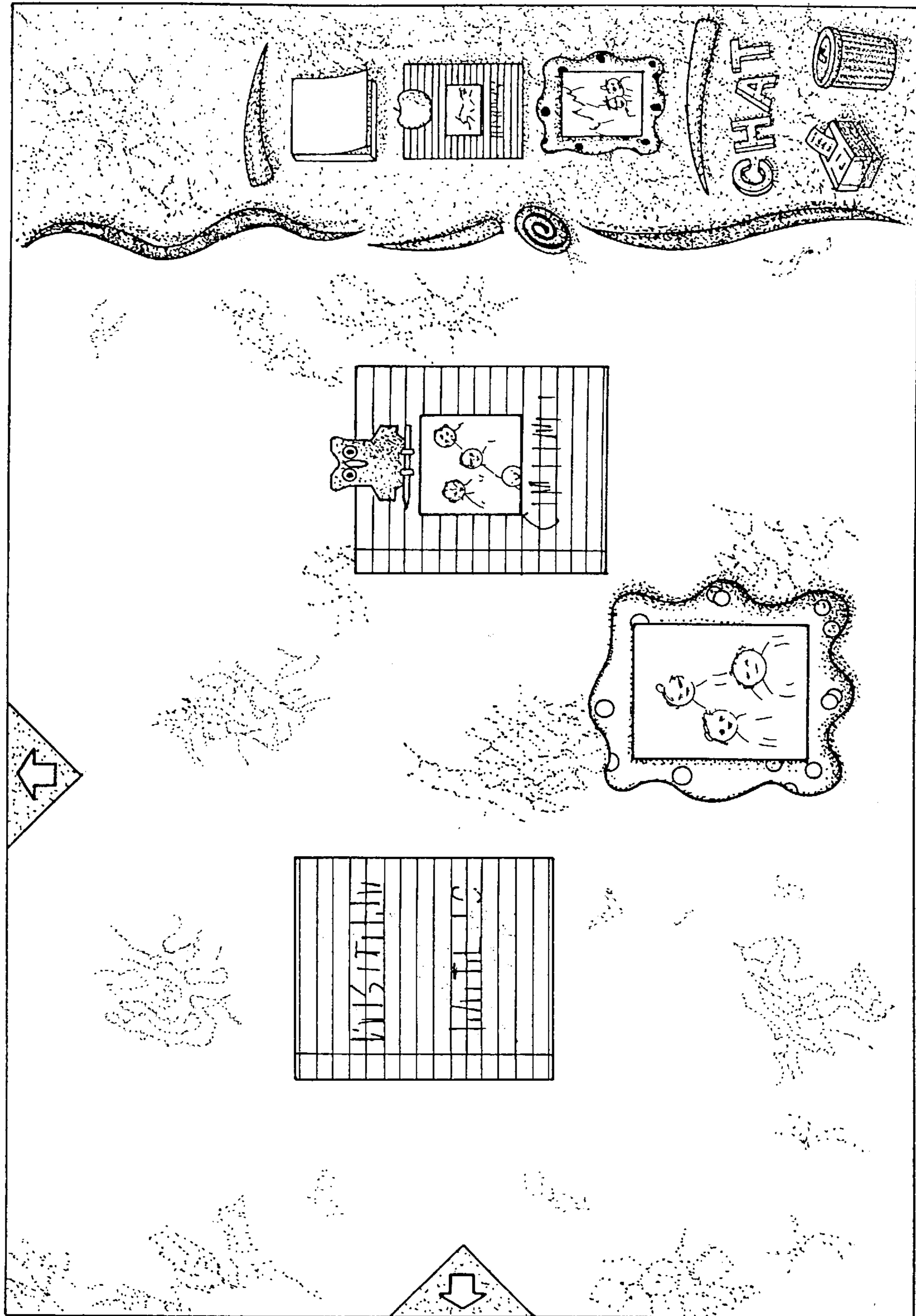

Fig. 4