



US00D415683S

# United States Patent [19] DuCorday

[11] **Patent Number: Des. 415,683**

[45] **Date of Patent: \*\* Oct. 26, 1999**

[54] **MEDIUM DUTY BAG CLOSURE WITH HANDLE**

[76] Inventor: **Gerard Marquis DuCorday**, 10871 Thorley Rd., Santa Ana, Calif. 92705

[\*\*] Term: **14 Years**

[21] Appl. No.: **29/082,256**

[22] Filed: **Jan. 20, 1998**

[51] **LOC (6) Cl.** ..... **09-07**

[52] **U.S. Cl.** ..... **D9/443; D9/434**

[58] **Field of Search** ..... D9/434, 443; D3/323, D3/324; D8/320; 383/12, 13, 16, 22, 23, 24, 78, 81, 92; D6/315, 317, 318, 319, 326

[56] **References Cited**

**U.S. PATENT DOCUMENTS**

D. 242,764	12/1976	Kamins	.....	D9/434
D. 255,332	6/1980	DuCorday	.	
3,282,493	11/1966	Kamins et al.	.	
3,310,224	3/1967	LaGuerre	.	
3,344,977	10/1967	Kamins et al.	.	
3,452,922	7/1969	Hart	.....	383/16 X
3,495,763	2/1970	Schmidt et al.	.....	383/13
4,000,768	1/1977	Siegel	.....	383/23
4,387,846	6/1983	DuCorday	.	

*Primary Examiner*—James Gandy  
*Assistant Examiner*—Cathron B. Matta  
*Attorney, Agent, or Firm*—Gene Scott; Patent Law & Venture Group

[57] **CLAIM**

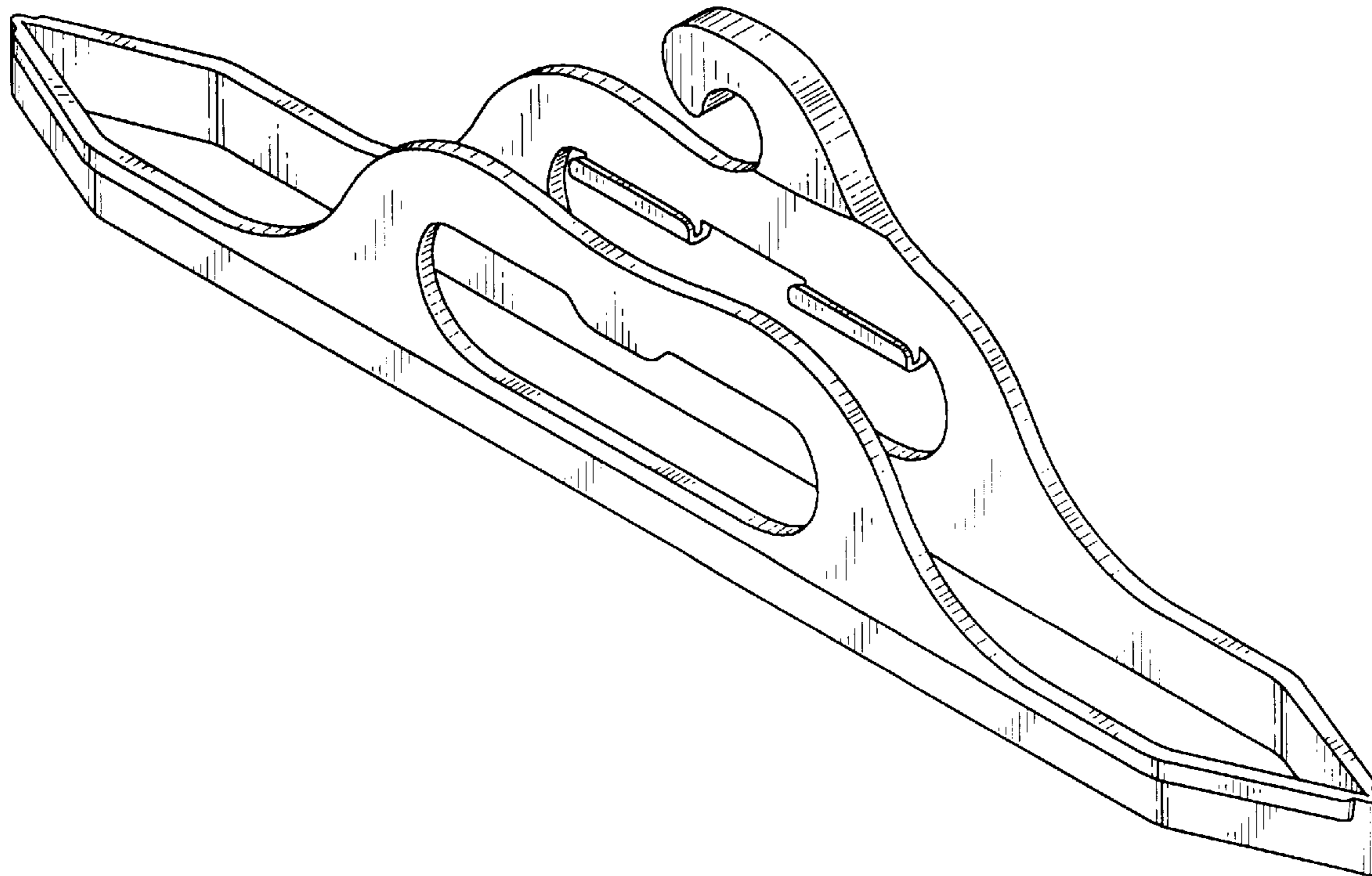
The ornamental design for a “medium duty bag closure with handle,” as shown and described.

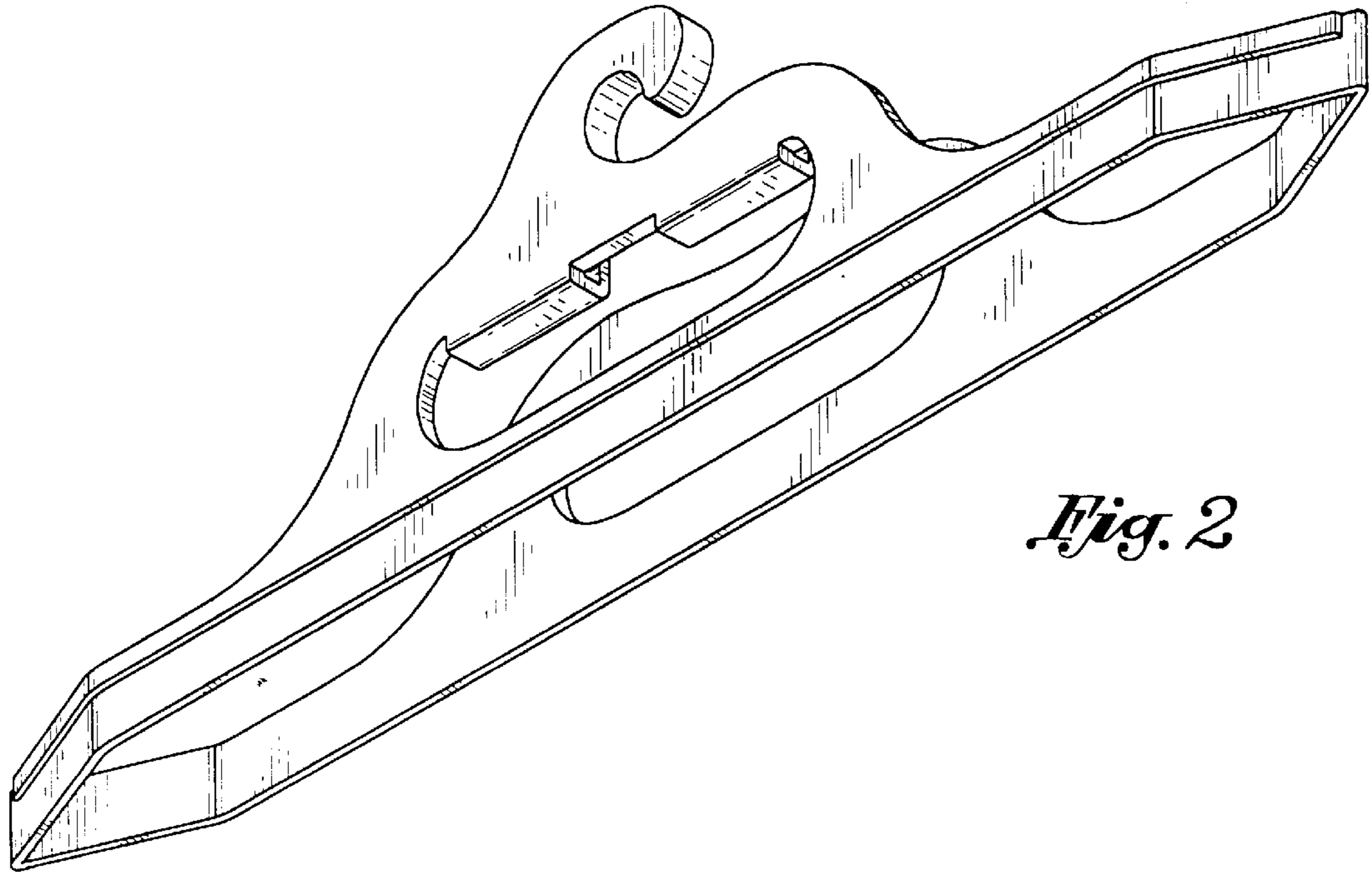
**DESCRIPTION**

FIG. 1 is a perspective view of a medium duty bag closure with handle, showing my new design from above and in an open state;  
FIG. 2 is a perspective view thereof, showing my new design from below and in an open state;  
FIG. 3 is a perspective view thereof, showing my new design from above and in closed state;  
FIG. 4 is a top plan view of FIG. 3;  
FIG. 5 is a front elevational view of FIG. 3;  
FIG. 6 is a bottom plan view of FIG. 3;  
FIG. 7 is a rear elevational view of FIG. 3;  
FIG. 8 is a left side elevational view of FIG. 3;  
FIG. 9 is a right side elevational view of FIG. 3; and,  
FIG. 10 is an enlarged sectional view taken along line 10—10 in FIG. 3.

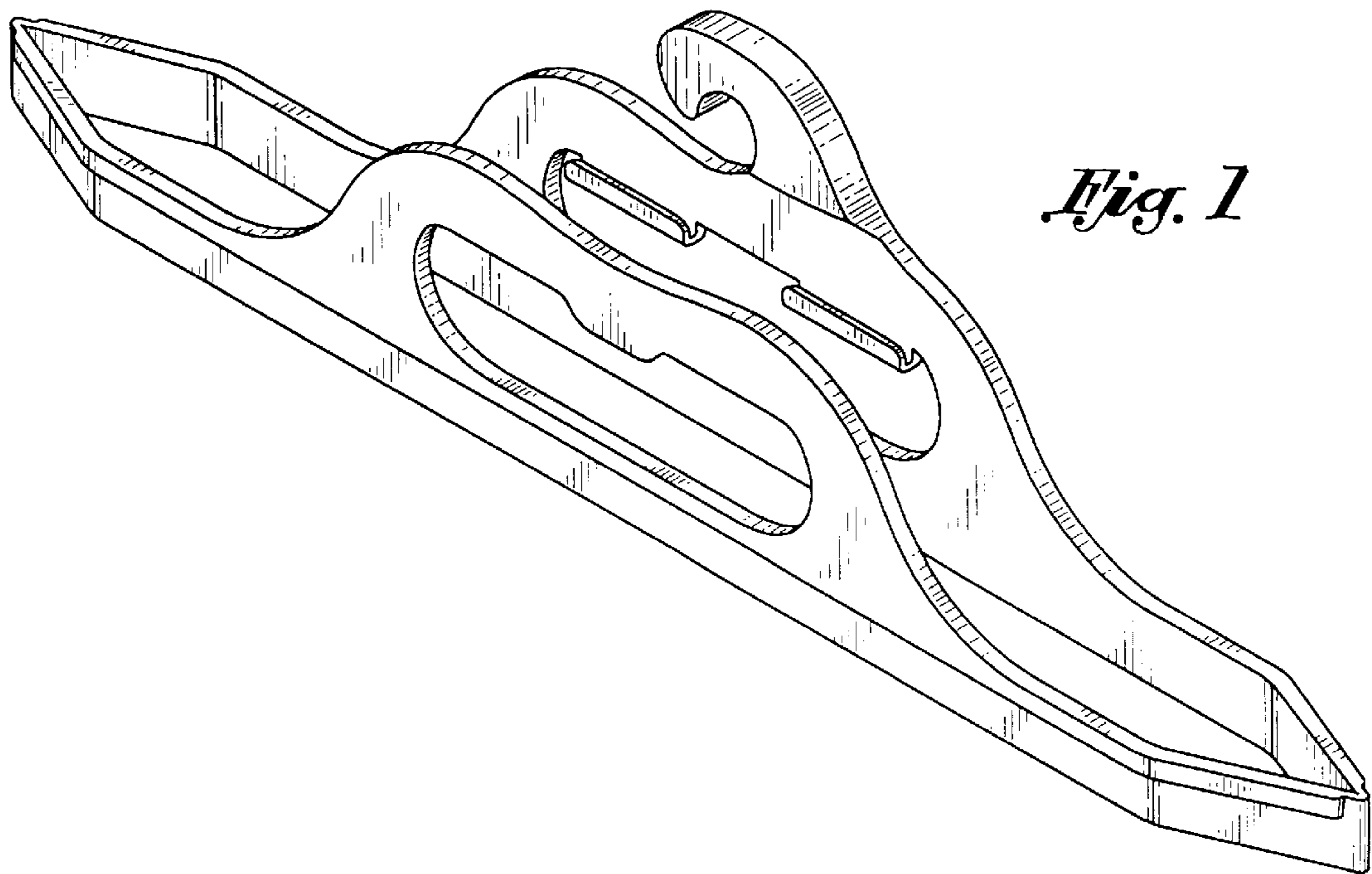
The broken line environmental structure is for illustrative purposes only and forms no part of the claimed design.

**1 Claim, 4 Drawing Sheets**



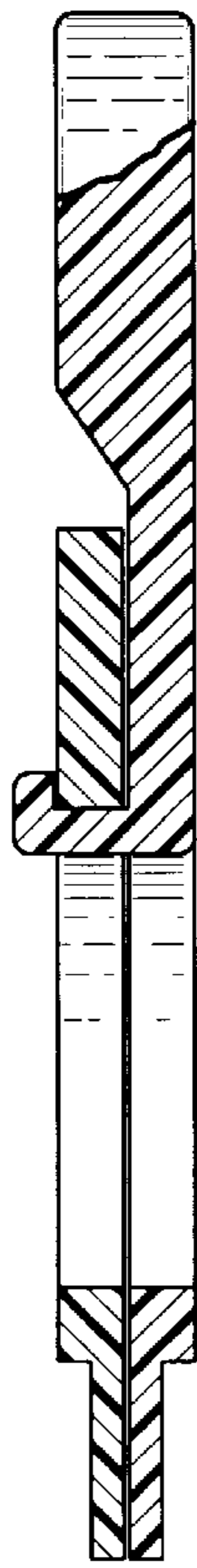
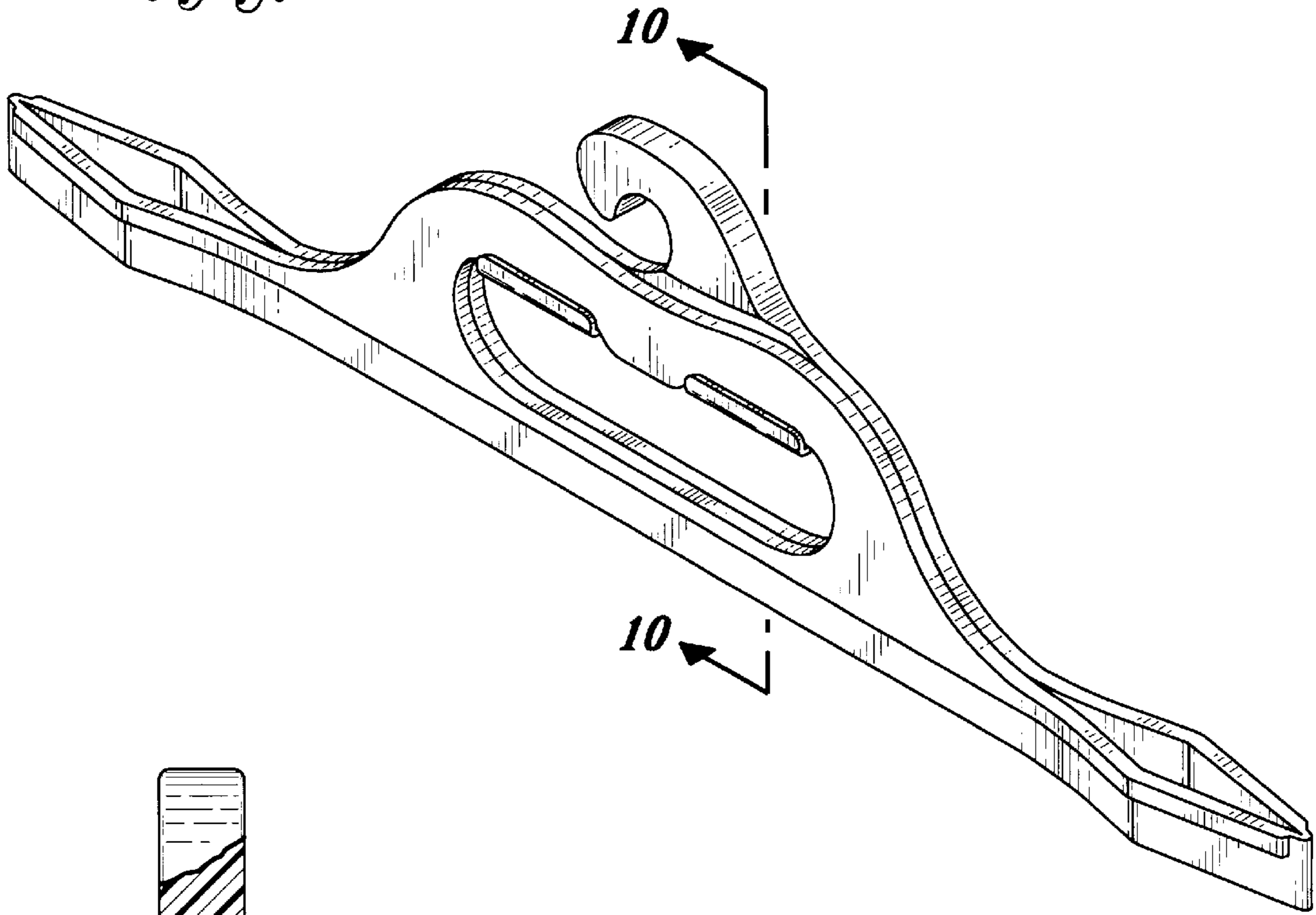


*Fig. 2*



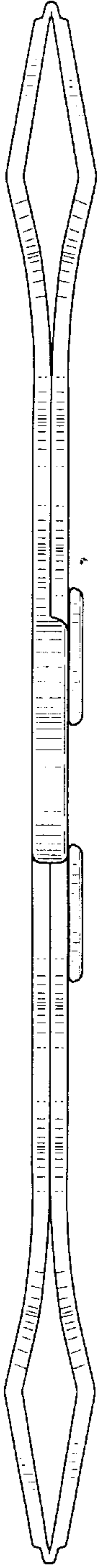
*Fig. 1*

*Fig. 3*

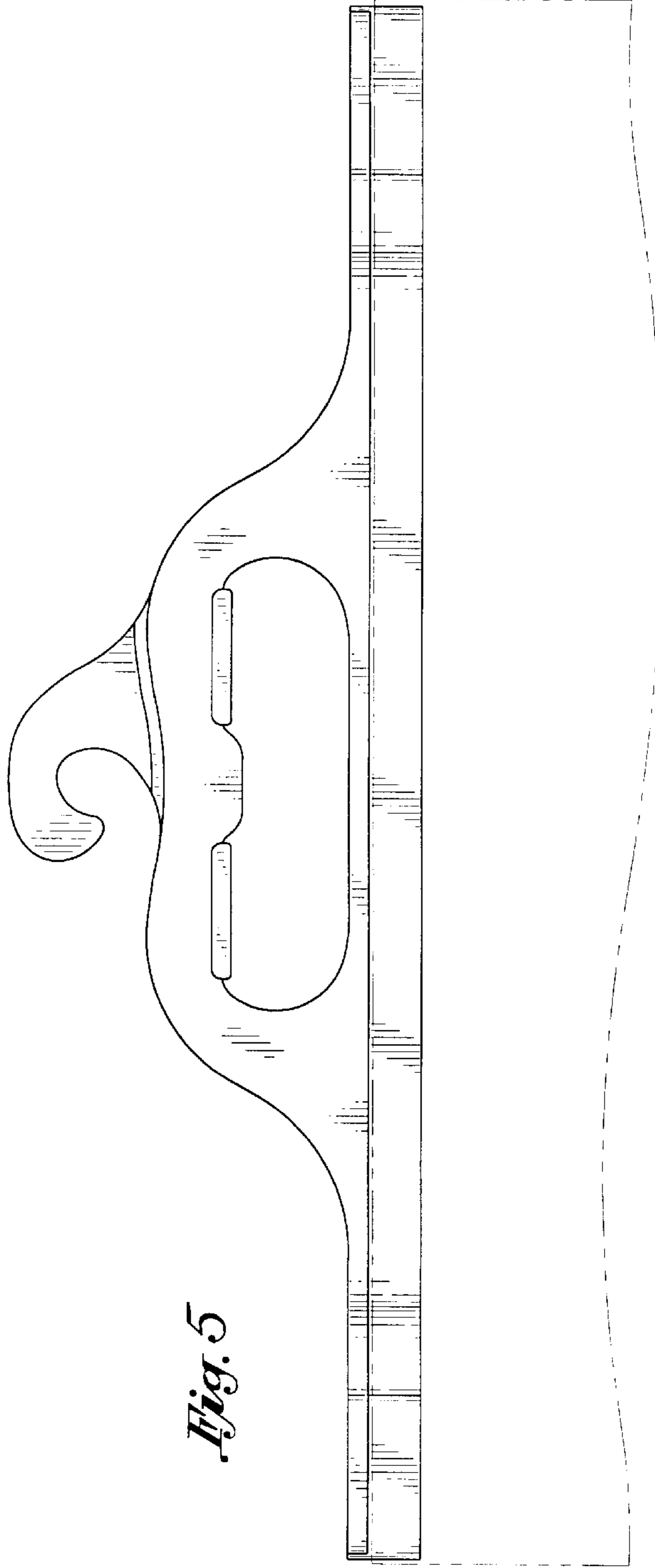


*Fig. 10*

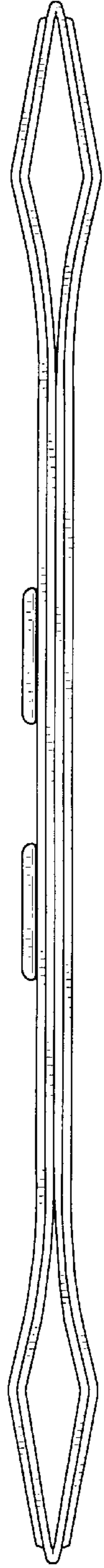
*Fig. 4*

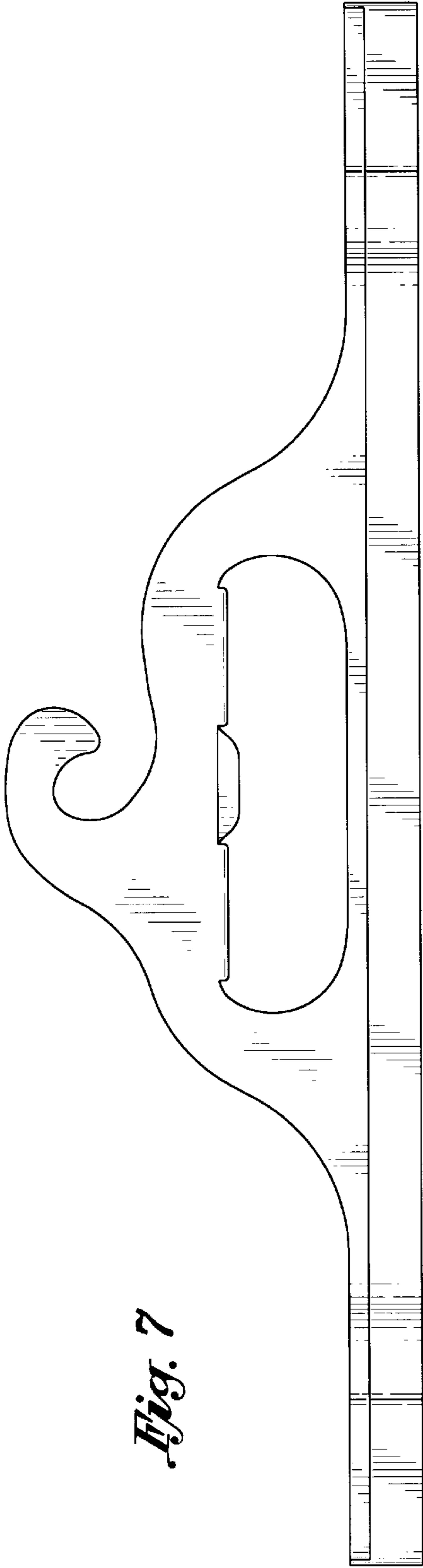


*Fig. 5*

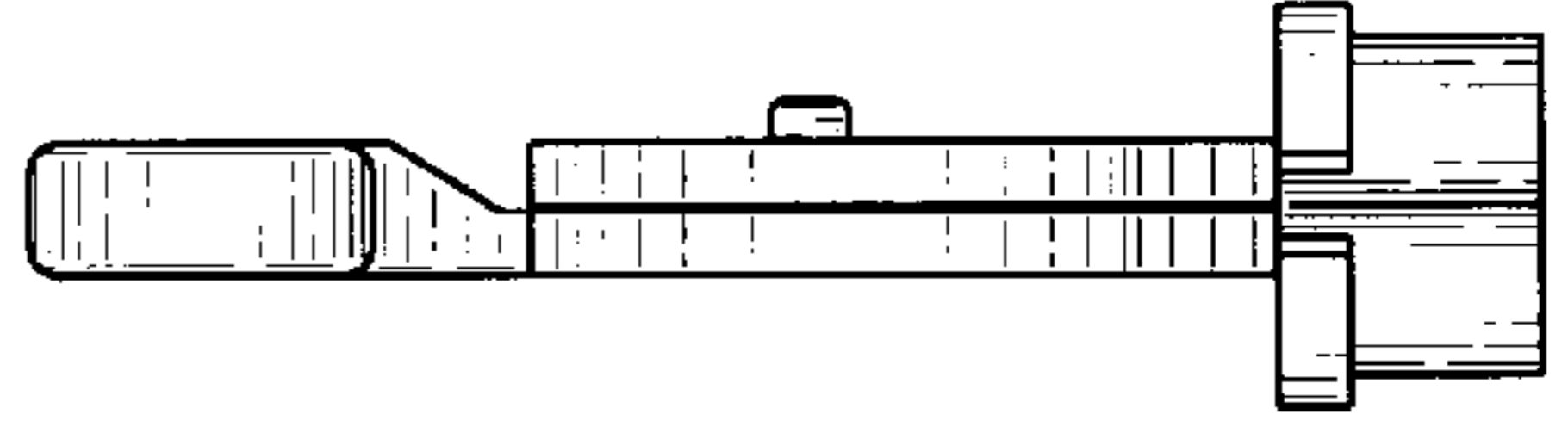


*Fig. 6*

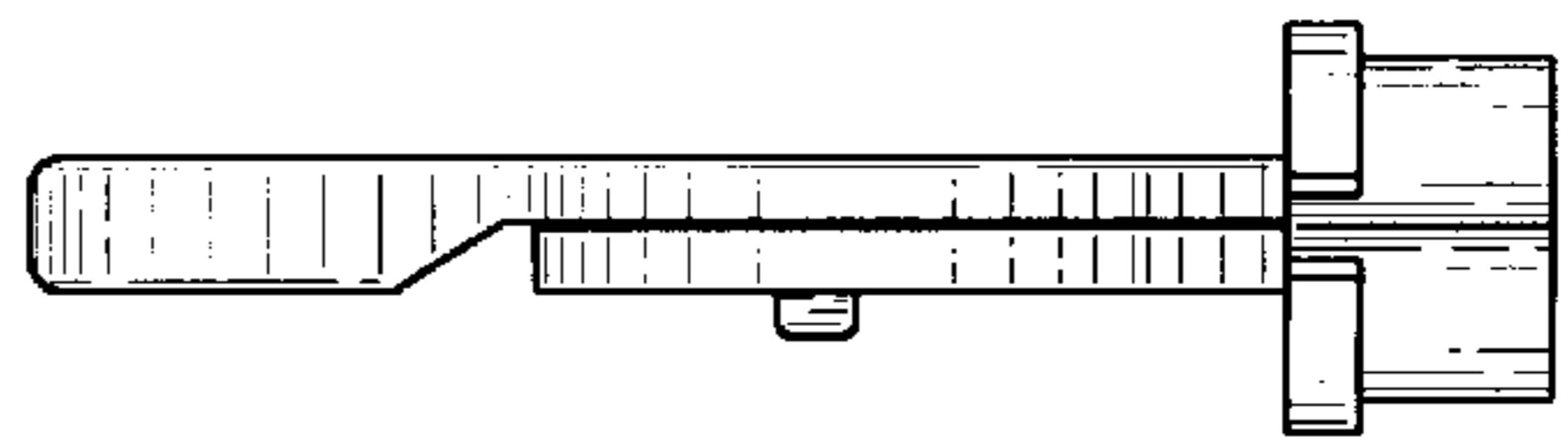




*Fig. 7*



*Fig. 9*



*Fig. 8*