



US00D415400S

United States Patent [19]

Mizutani et al.

[11] Patent Number: **Des. 415,400**

[45] Date of Patent: **** Oct. 19, 1999**

[54] **POWER SHEARS**

8138981 1/1993 Japan .

[75] Inventors: **Makoto Mizutani; Norifumi Niwa; Tadayoshi Tsuchiya**, all of Anjo, Japan

Primary Examiner—Nelson C. Holtje
Attorney, Agent, or Firm—Dennison, Meserole, Scheiner & Schultz

[73] Assignee: **Makita Corporation**, Anjo, Japan

[**] Term: **14 Years**

[57] CLAIM

[21] Appl. No.: **29/098,328**

The ornamental design for power shears, as shown and described.

[22] Filed: **Dec. 24, 1998**

DESCRIPTION

[30] Foreign Application Priority Data

Jun. 26, 1998	[JP]	Japan	10-18525
Jul. 8, 1998	[JP]	Japan	10-19873

[51] **LOC (6) Cl.** **08-05**

[52] **U.S. Cl.** **D8/69; D8/61**

[58] **Field of Search** **D8/61, 69, 70; 30/228, 206**

FIG. 1 is a perspective view of power shears showing our new design;

FIG. 2 is a front elevation view thereof;

FIG. 3 is a rear elevation view thereof;

FIG. 4 is a left side elevation view thereof;

FIG. 5 is a right side elevation view thereof;

FIG. 6 is a top plan view thereof;

FIG. 7 is a bottom plan view thereof;

FIG. 8 is a perspective view of a second embodiment of the power shears shown in FIG. 1;

FIG. 9 is a front elevation view thereof;

FIG. 10 is a rear elevation view thereof;

FIG. 11 is a left side elevation view thereof;

FIG. 12 is a right side elevation view thereof;

FIG. 12 is a right side elevation view thereof;

FIG. 13 is a top plan view thereof; and,

FIG. 14 is a bottom plan view thereof.

[56] References Cited

U.S. PATENT DOCUMENTS

D. 209,442	11/1967	Greene .	
D. 216,612	2/1970	Zuro D8/61
D. 295,516	5/1988	Clophus et al. D14/133
D. 308,809	6/1990	Kawabata D8/61
D. 347,560	6/1994	Kwong D8/57
D. 388,300	12/1997	Jeltsch D8/61
3,478,426	11/1969	Greene .	

FOREIGN PATENT DOCUMENTS

813898 6/1991 Japan .

1 Claim, 10 Drawing Sheets

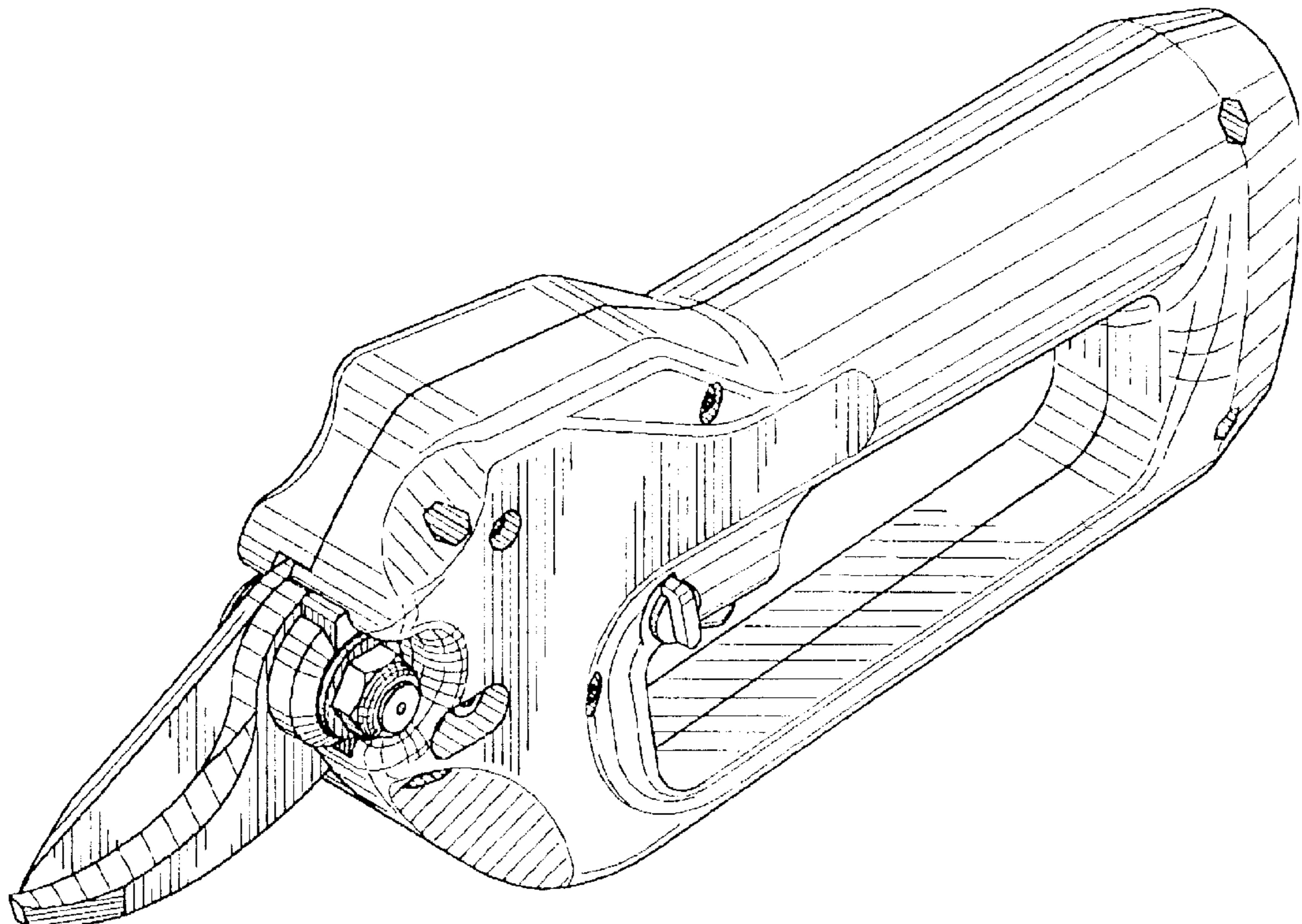

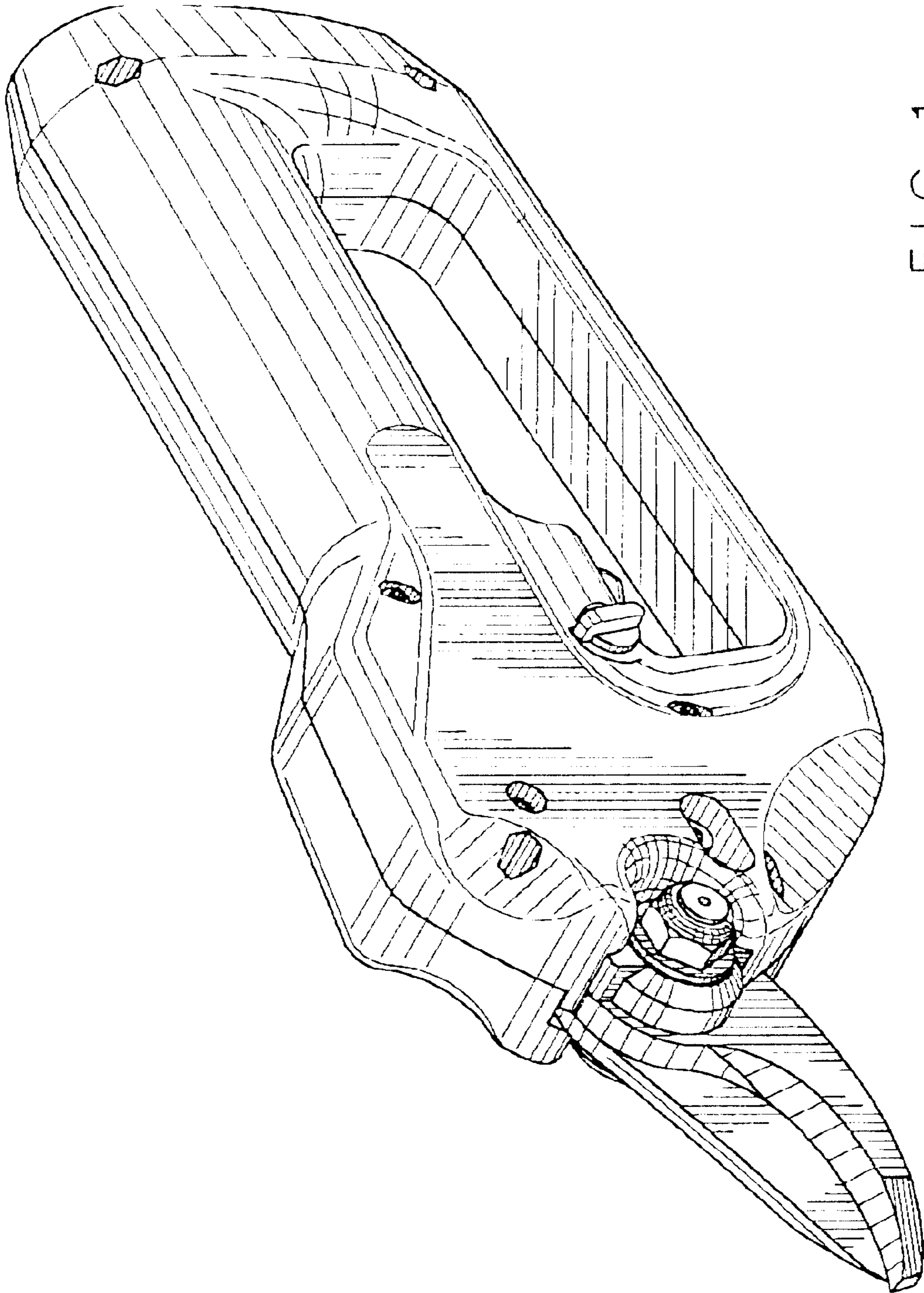

FIG. 1

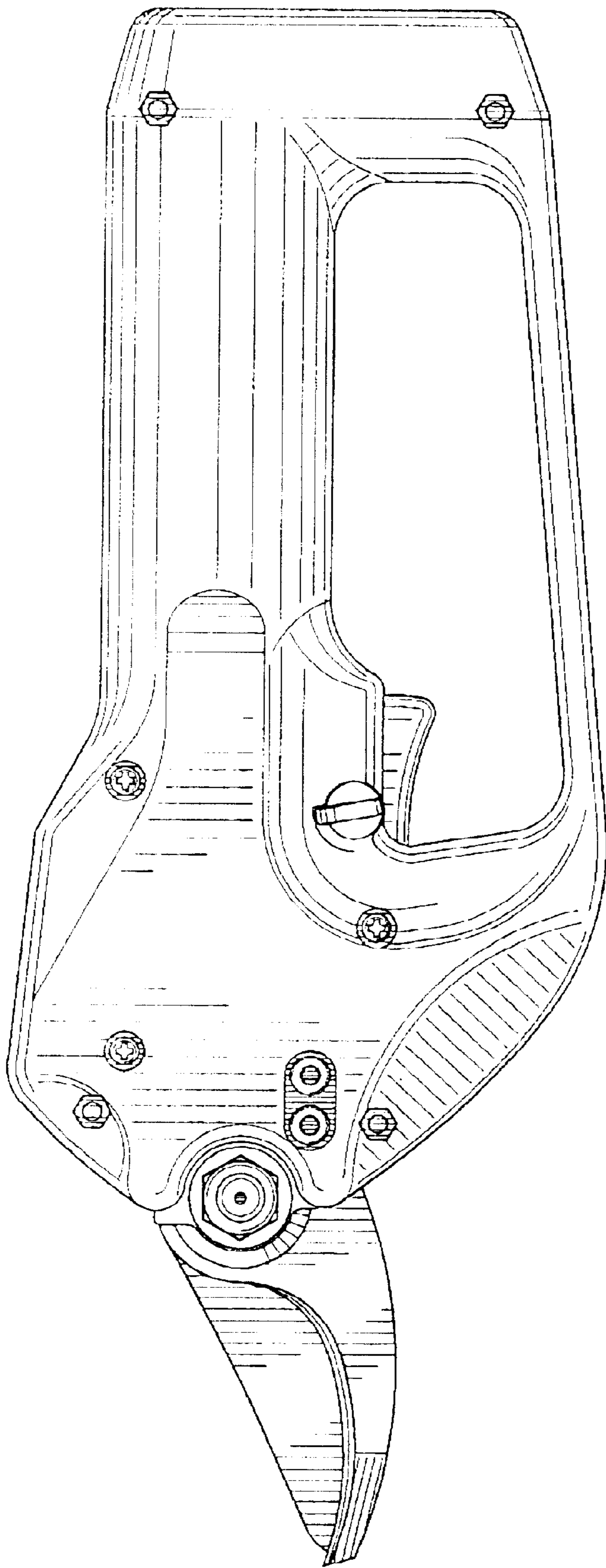

FIG. 2

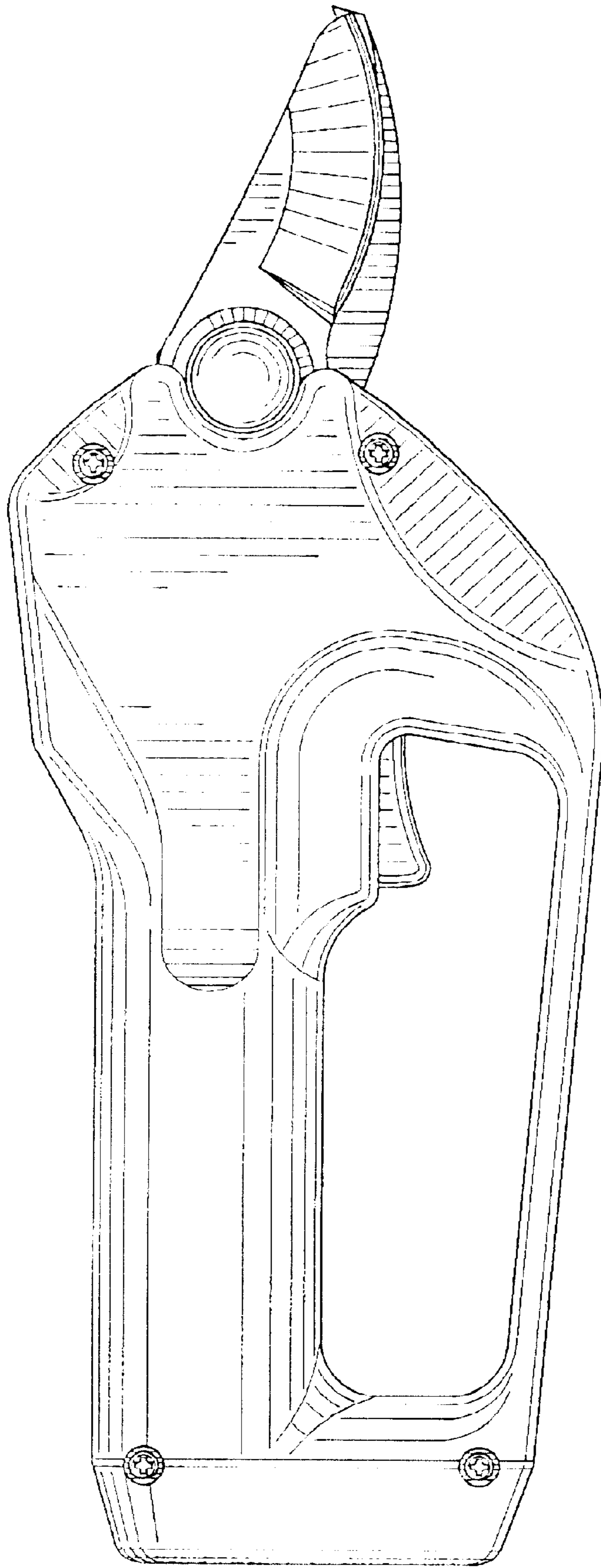

FIG. 3

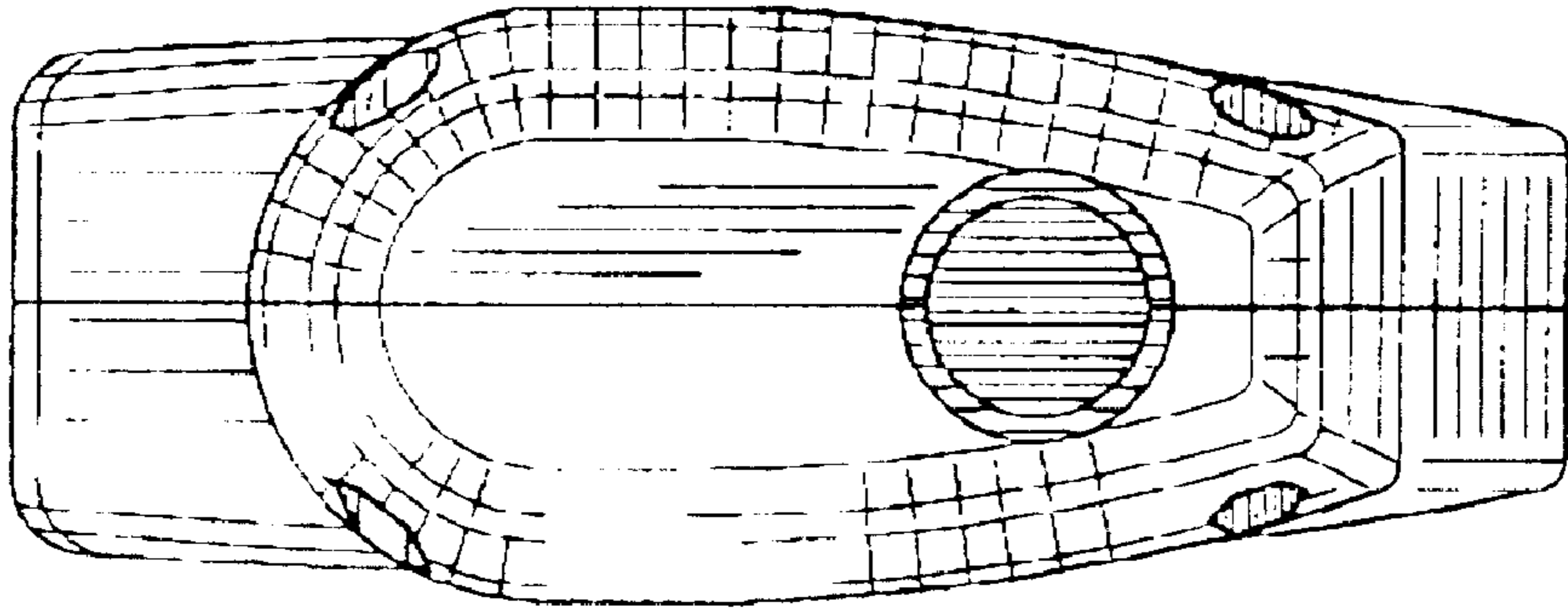

FIG. 5

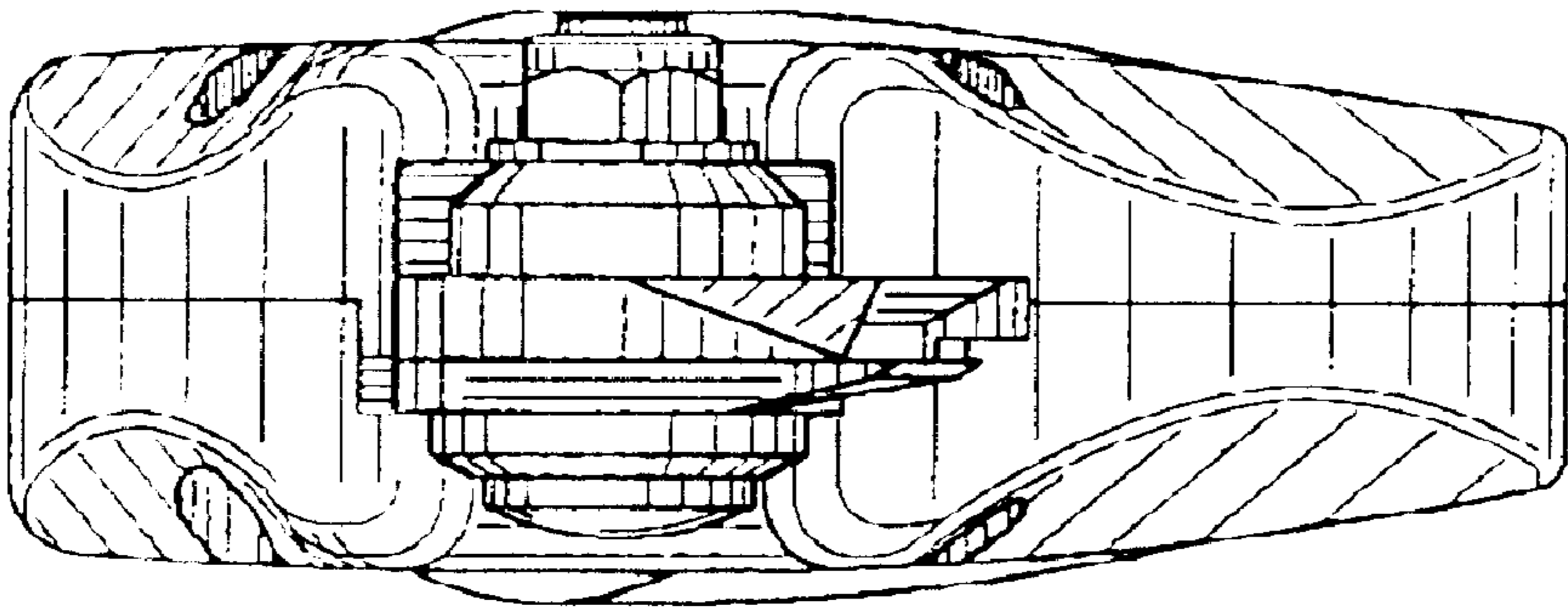

FIG. 4

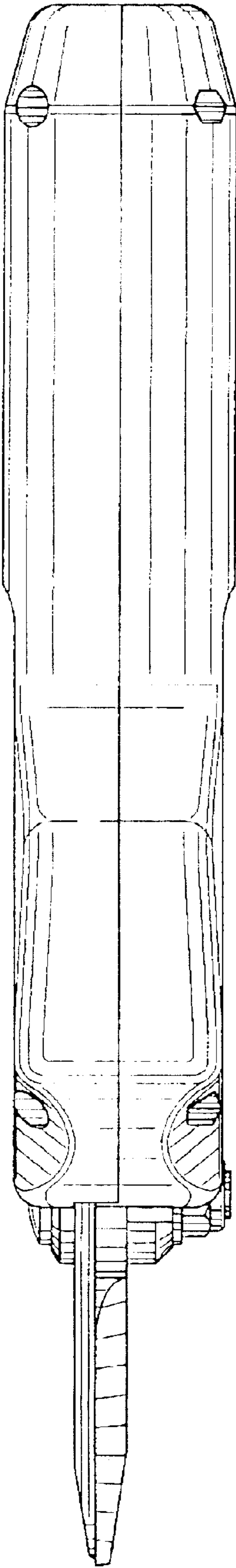

FIG. 6

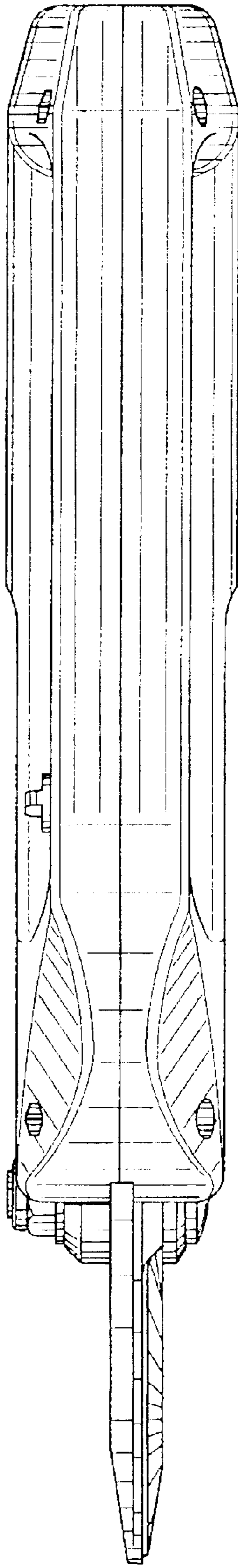

FIG. 7

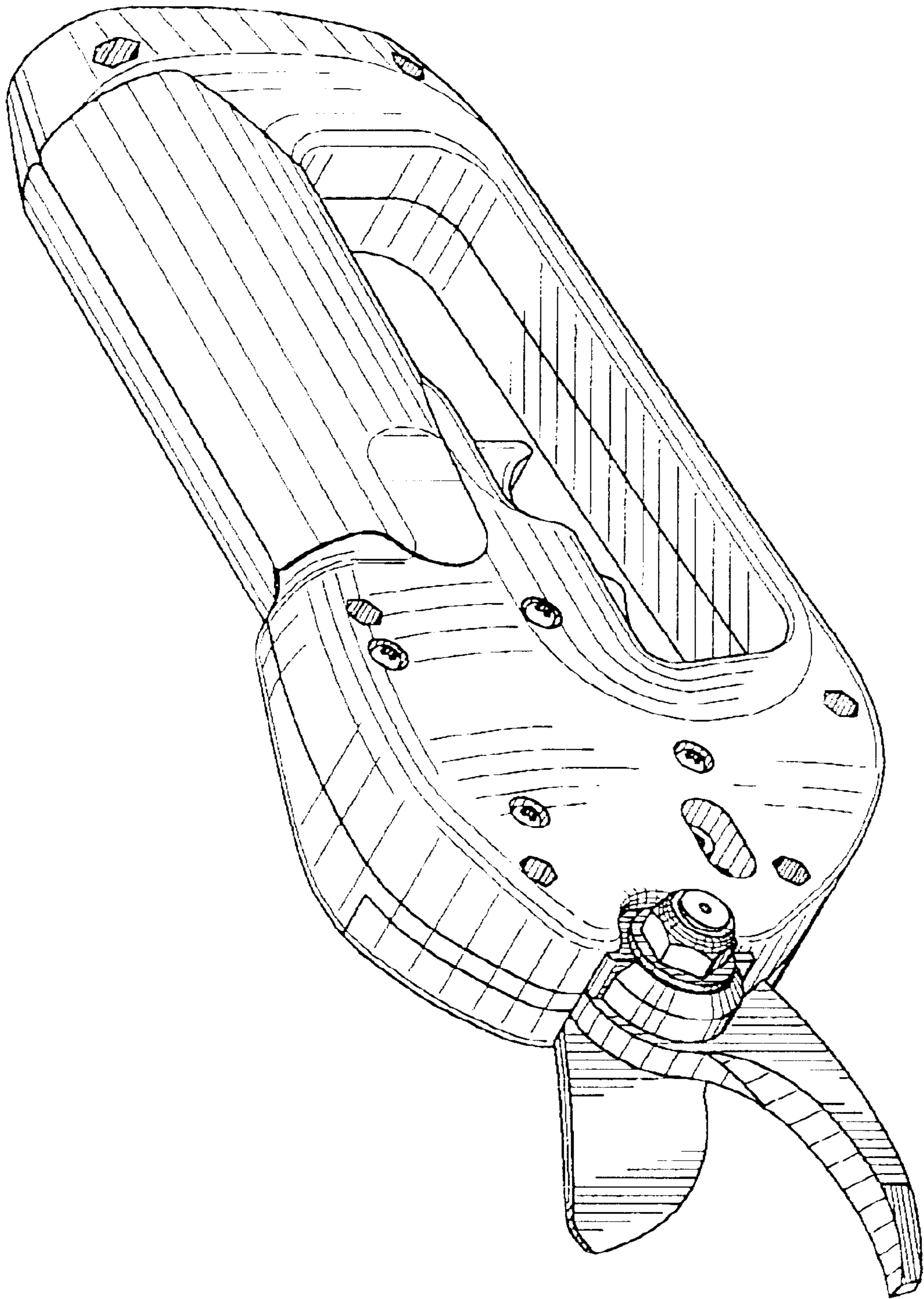

FIG. 8

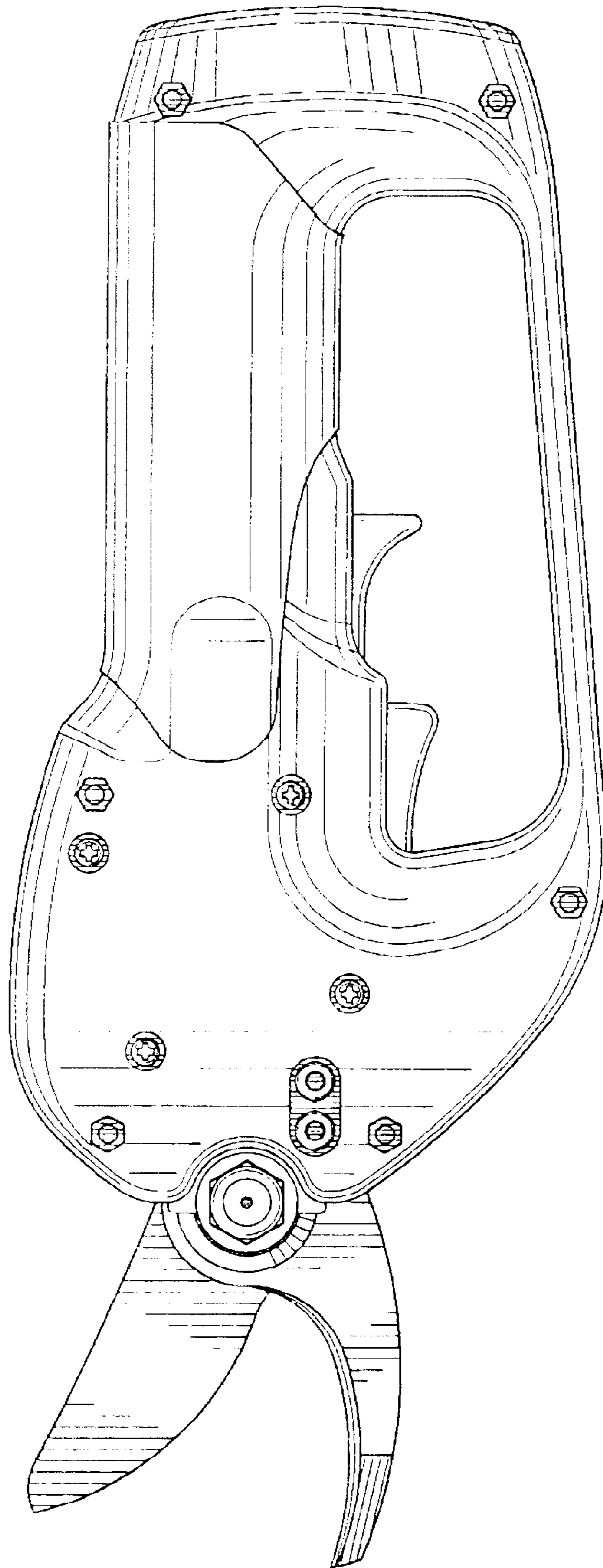

FIG. 9

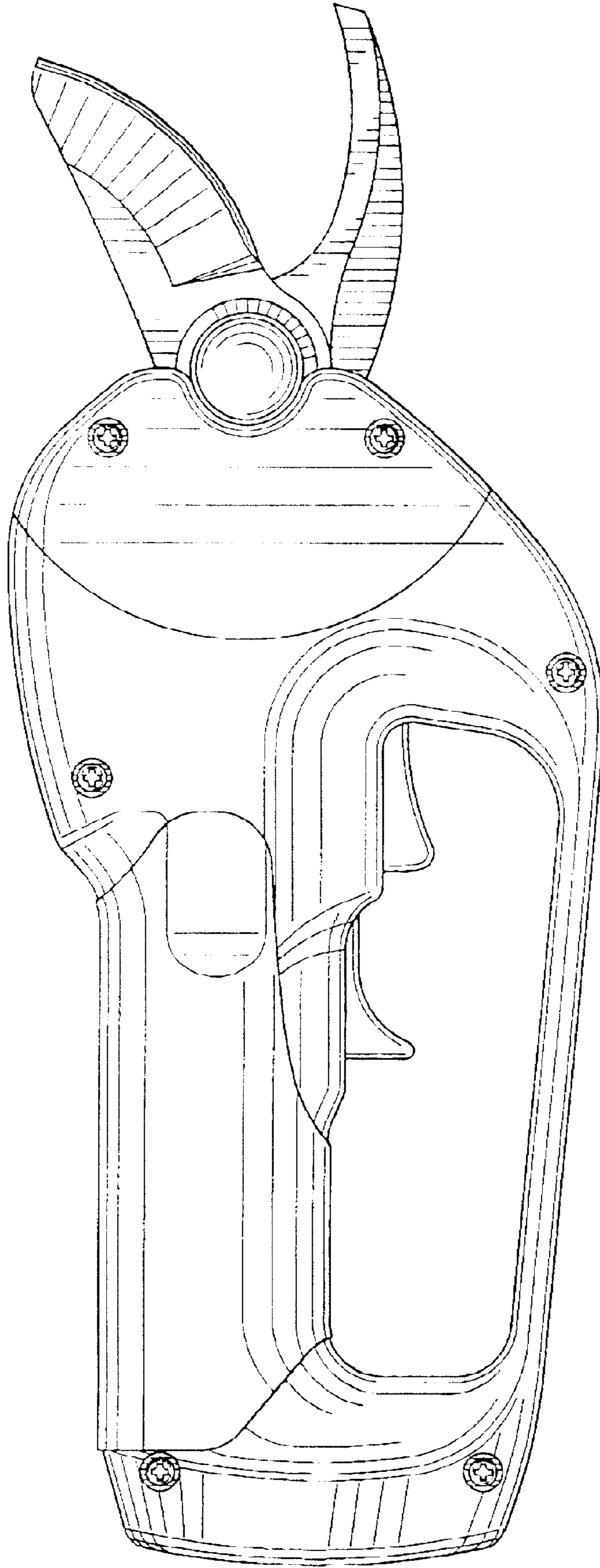

FIG. 10

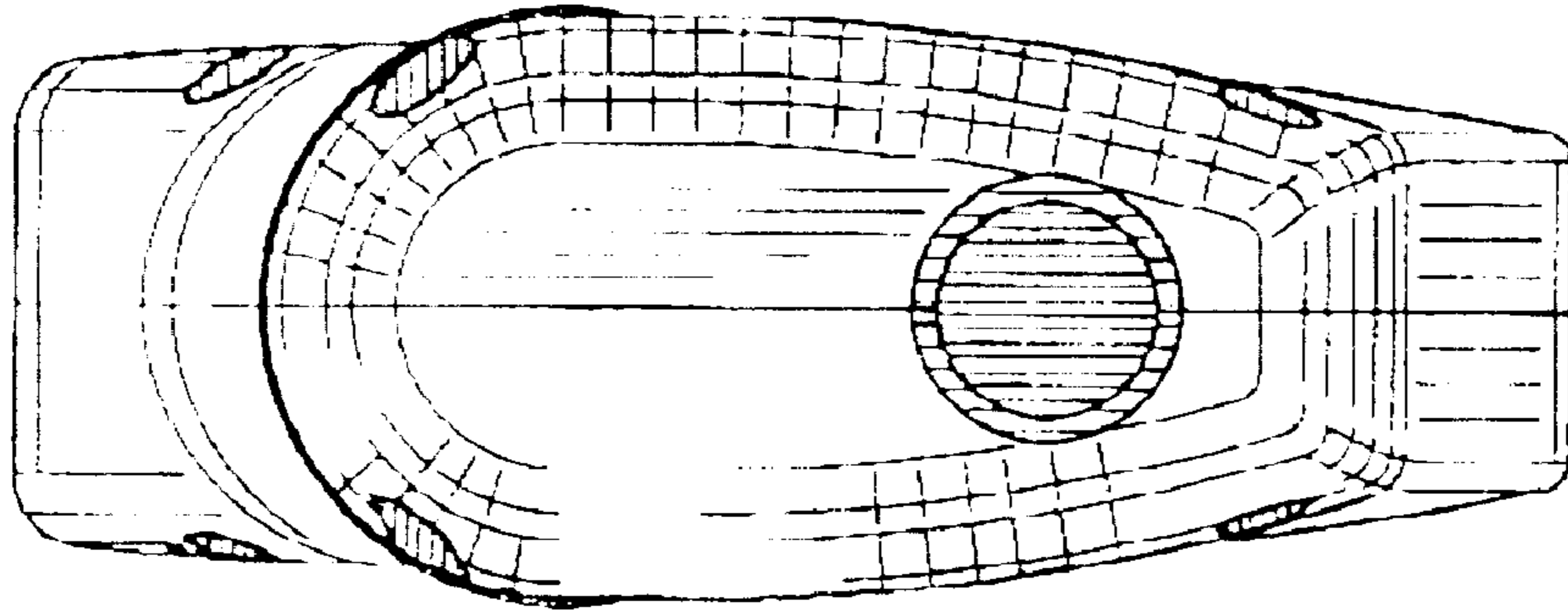

FIG. 12

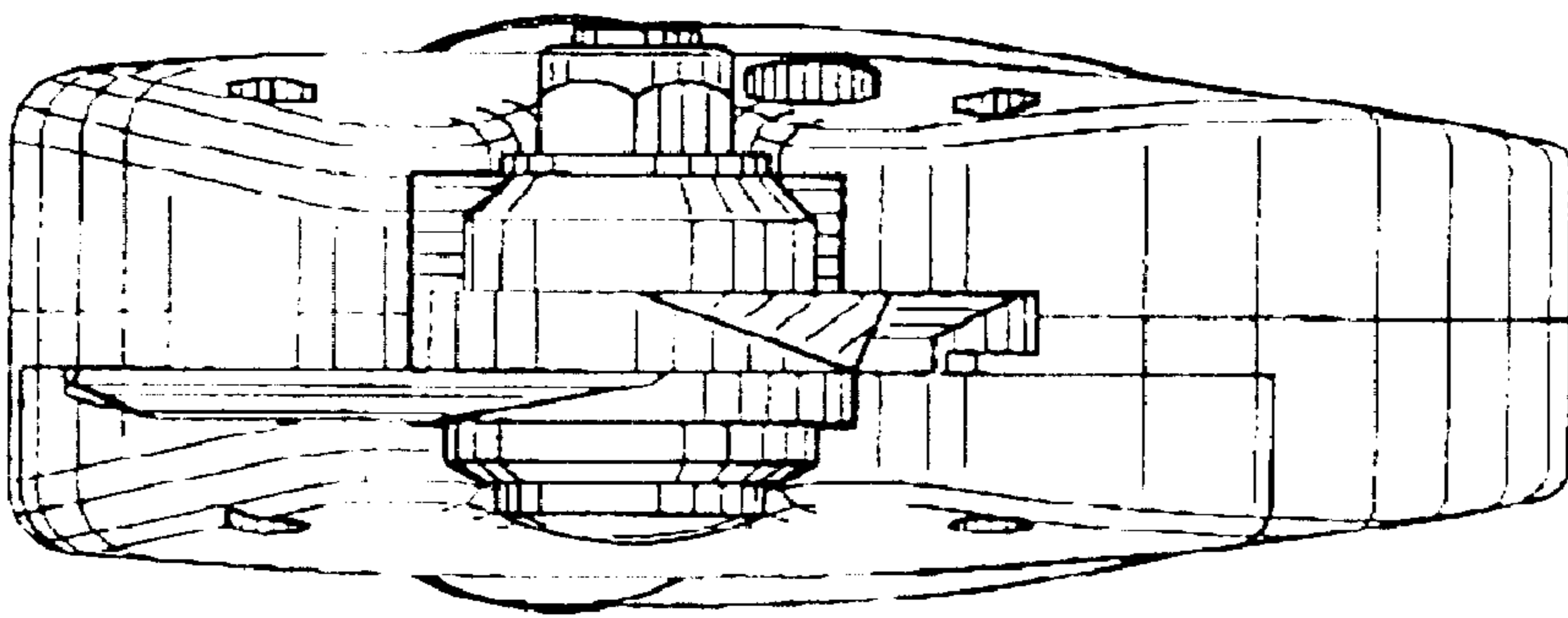

FIG. 11

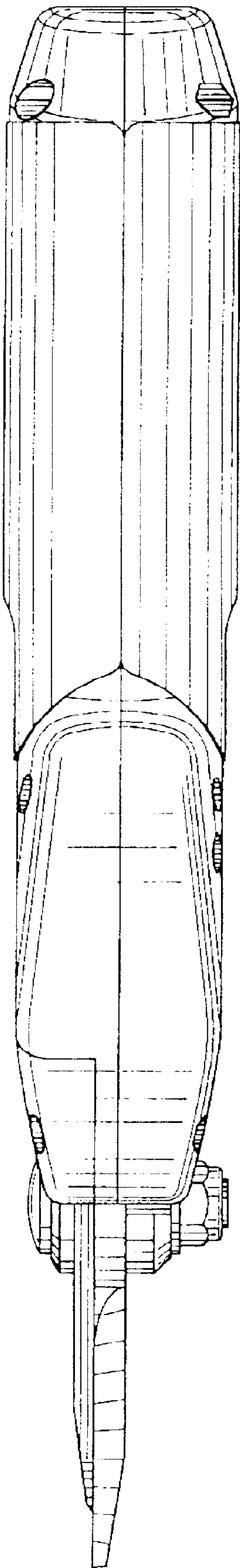

FIG. 13

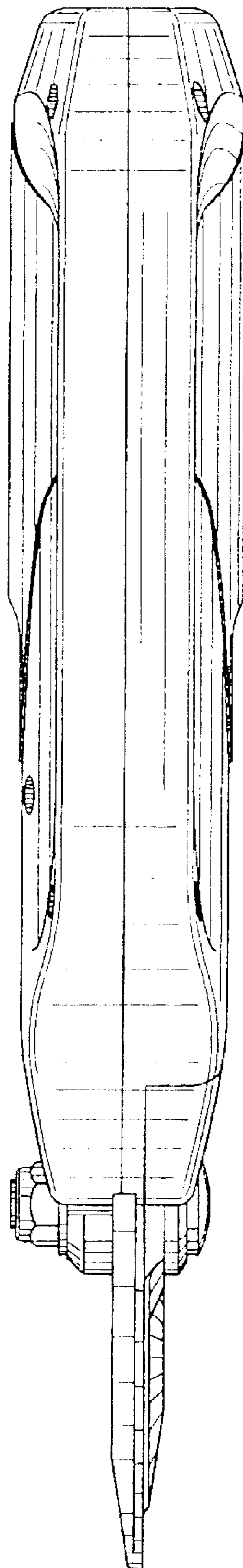

FIG. 14