



US00D410818S

# United States Patent [19]

[11] **Patent Number: Des. 410,818**

**Best**

[45] **Date of Patent: \*\* Jun. 8, 1999**

[54] **BASE FOR AN OUTDOOR GRILL**

[76] Inventor: **Willie H. Best**, 18-C The Heritage,  
1829 Senate St., Columbia, S.C. 29201

[\*\*] Term: **14 Years**

[21] Appl. No.: **29/080,556**

[22] Filed: **Dec. 3, 1997**

[51] **LOC (6) Cl. .... 07-02**

[52] **U.S. Cl. .... D7/403; D7/332**

[58] **Field of Search** ..... D7/332-337, 339-341,  
D7/347-348, 402-405; 126/9 R, 25 R,  
25 A-25 AA, 26, 29-30, 38, 39 B, 39 E,  
39 L, 40, 41 R, 50-51; 99/419-420, 421 R,  
421 H, 443 R-443 C, 422, 425, 444, 446;  
D6/451, 486, 419, 495, 432-433, 445-446,  
448-449; 248/346.01

[56] **References Cited**

**U.S. PATENT DOCUMENTS**

D. 188,448	7/1960	Freiberg	.....	D7/347
D. 266,050	9/1982	Best	.....	D7/108
D. 298,203	10/1988	Rock	.....	D7/334
D. 299,305	1/1989	Volborn	.....	D7/332
D. 300,487	4/1989	Dyer	.....	D6/446

D. 357,781	4/1995	Crinion	.....	D34/19
D. 372,604	8/1996	Frederiks	.....	D6/432
D. 386,917	12/1997	Blevio	.....	D6/445
3,933,144	1/1976	Bandy	.....	126/25 R
4,321,857	3/1982	Best	.....	99/430

**OTHER PUBLICATIONS**

Market Forge "The versatile tilting skillet", Oct. 1986.

*Primary Examiner*—Ruth McInroy

*Attorney, Agent, or Firm*—Womble Carlyle Sandridge & Rice, PLLC

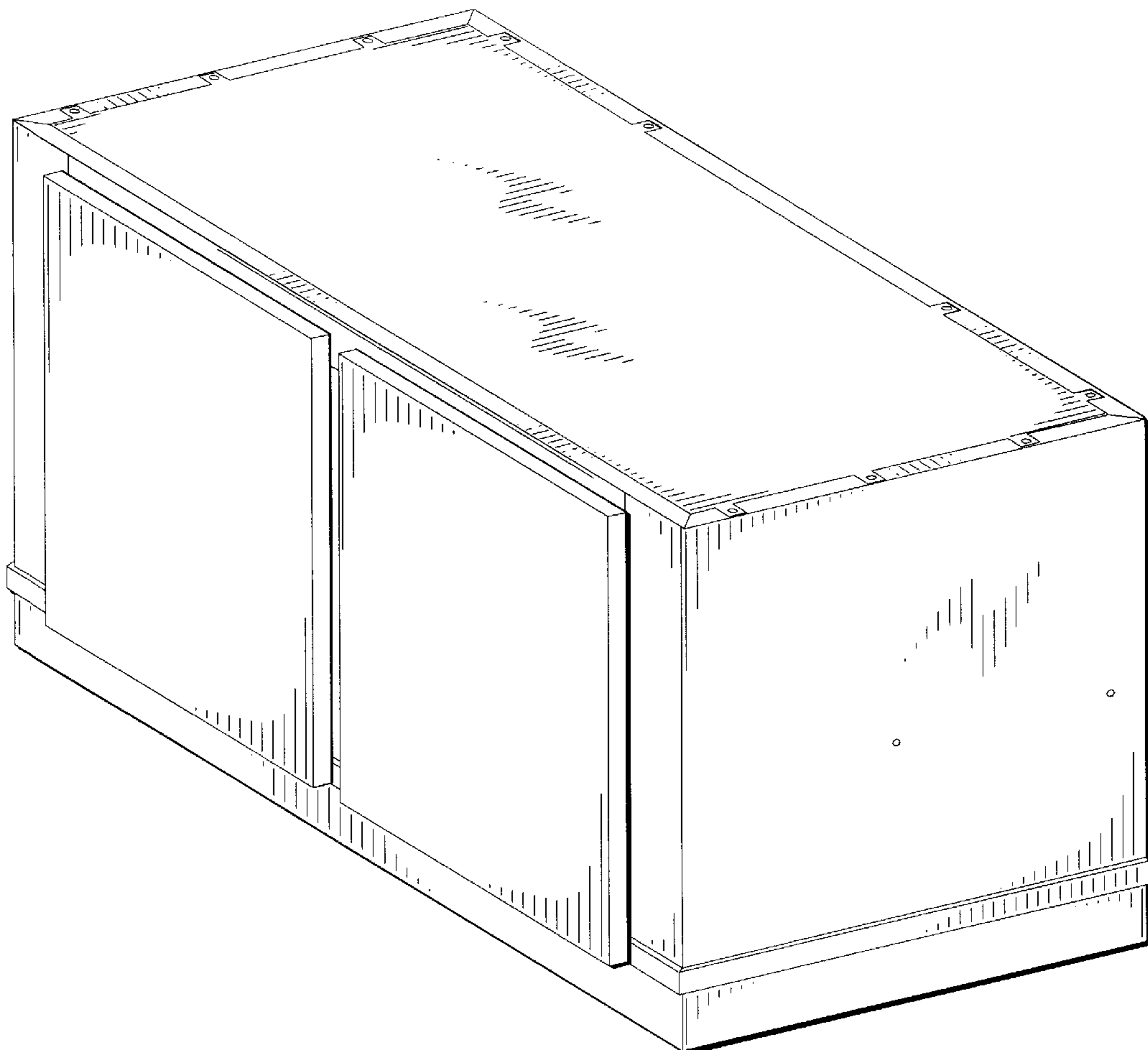
[57] **CLAIM**

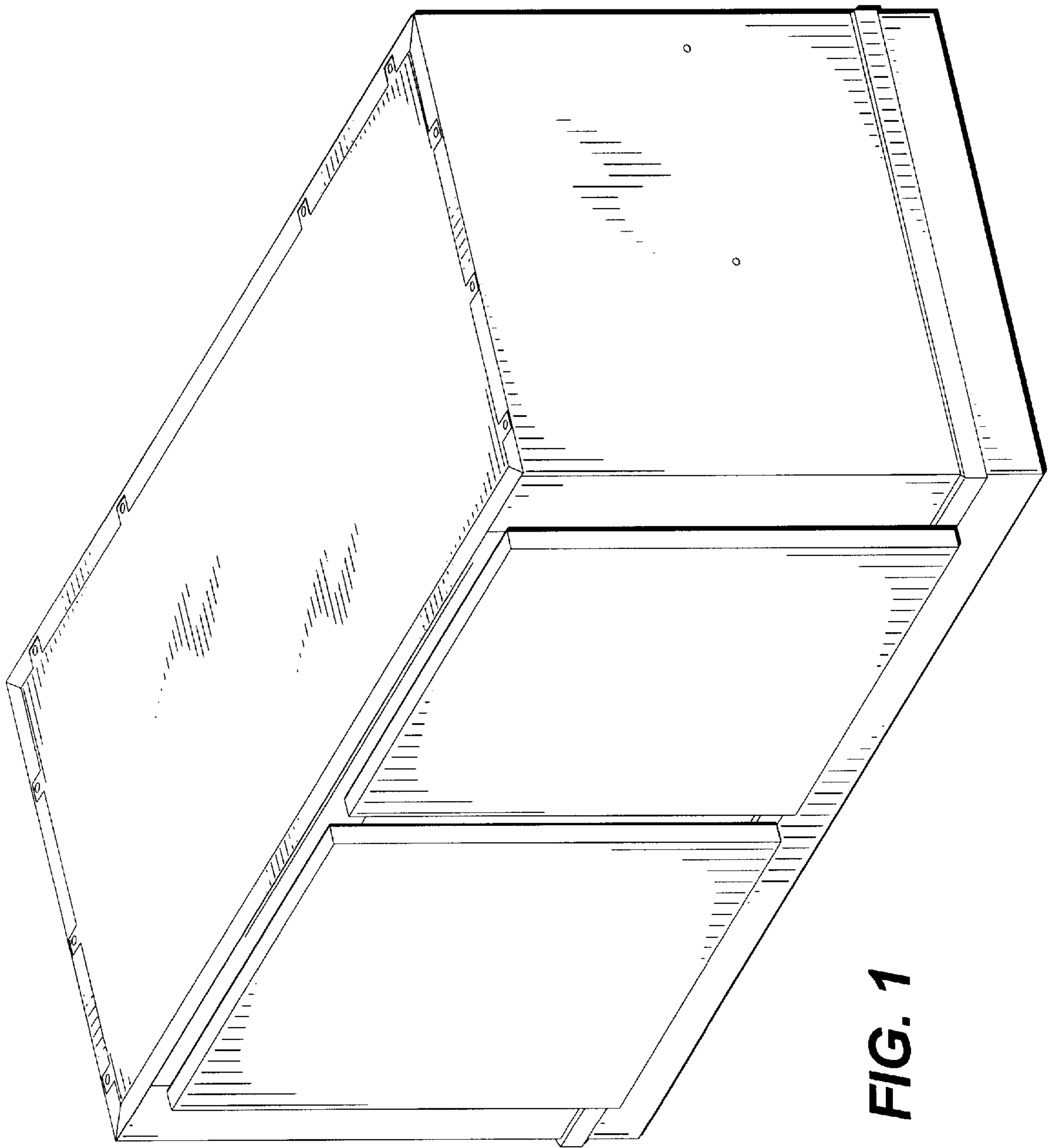
The ornamental design for a base for an outdoor grill, as shown.

**DESCRIPTION**

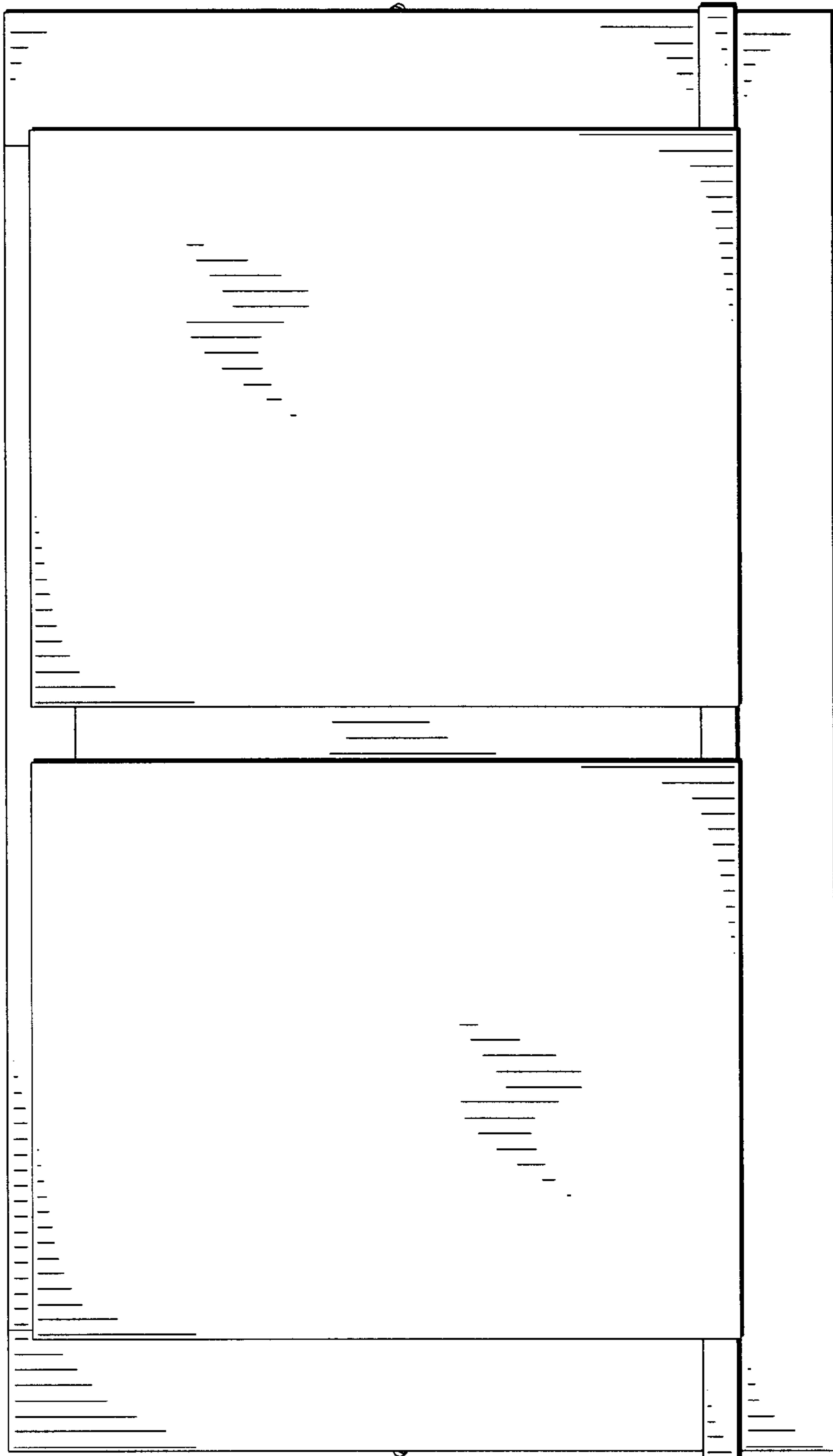
FIG. 1 is a top, front, and left side perspective view of a base for an outdoor grill showing my new design; FIG. 2 is a front elevational view thereof; FIG. 3 is a rear elevational view thereof; FIG. 4 is a right side elevational view thereof; FIG. 5 is a left side elevational view thereof; FIG. 6 is a top plan view thereof; and, FIG. 7 is a bottom plan view thereof.

**1 Claim, 6 Drawing Sheets**

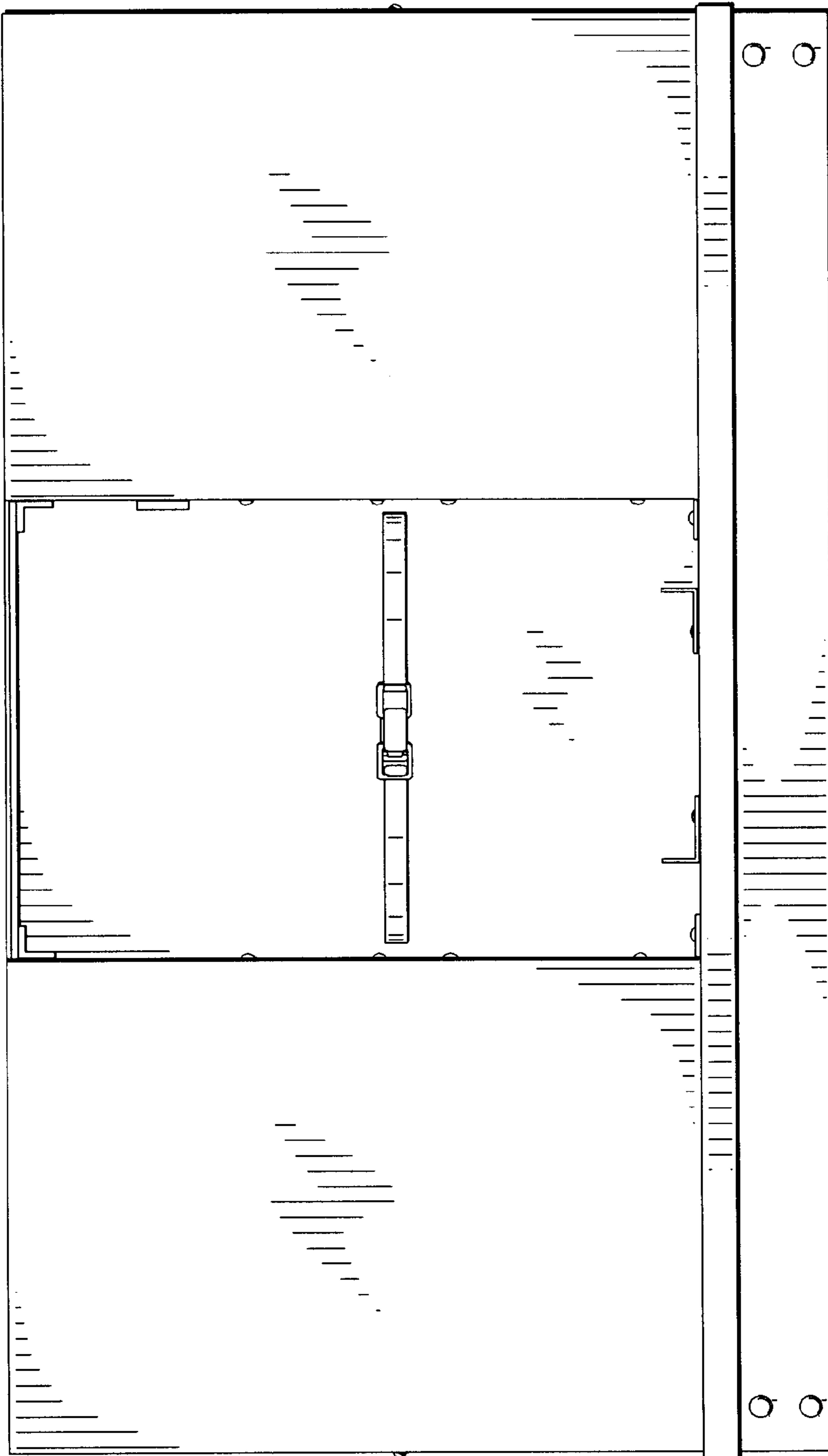




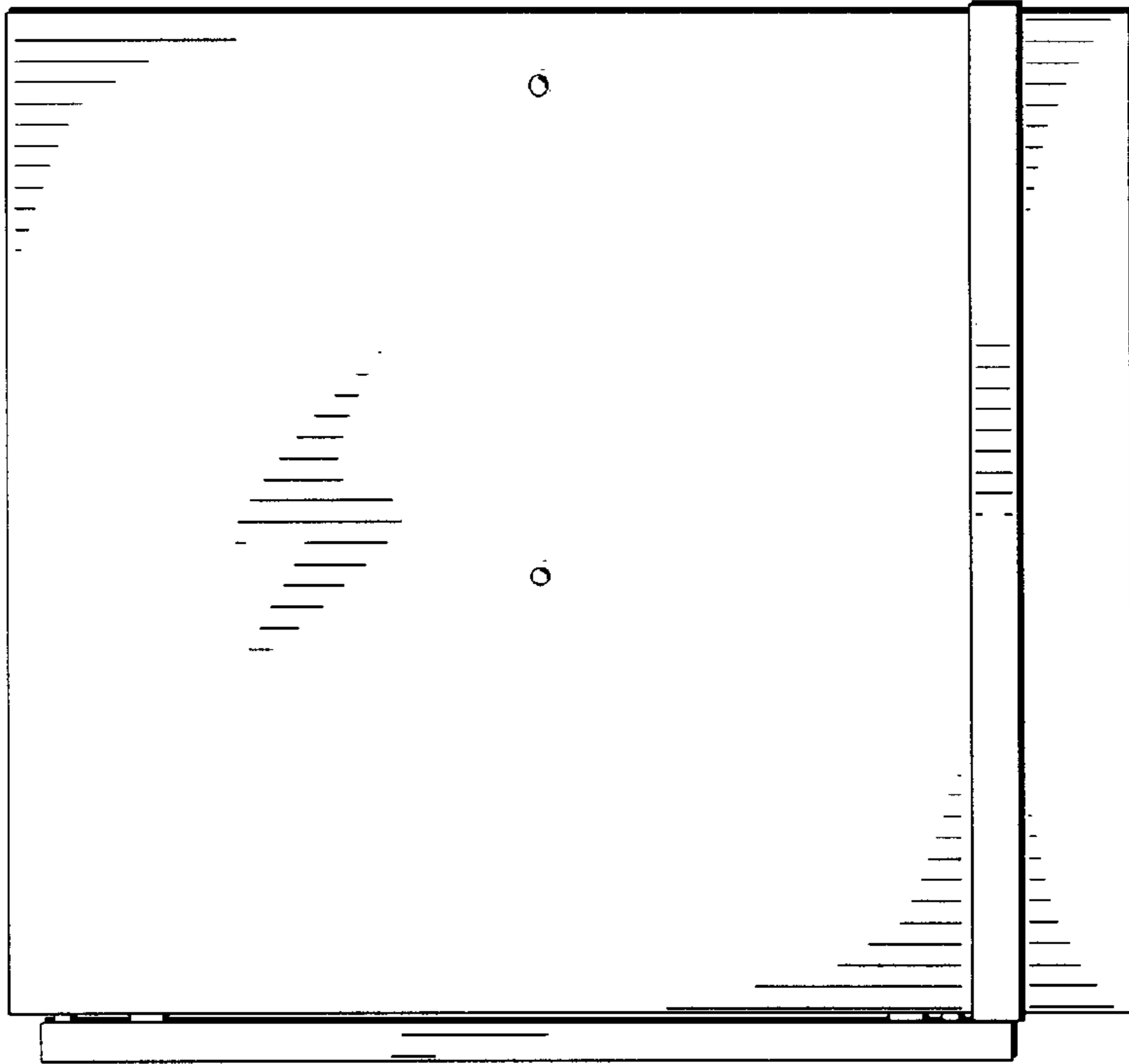
**FIG. 1**



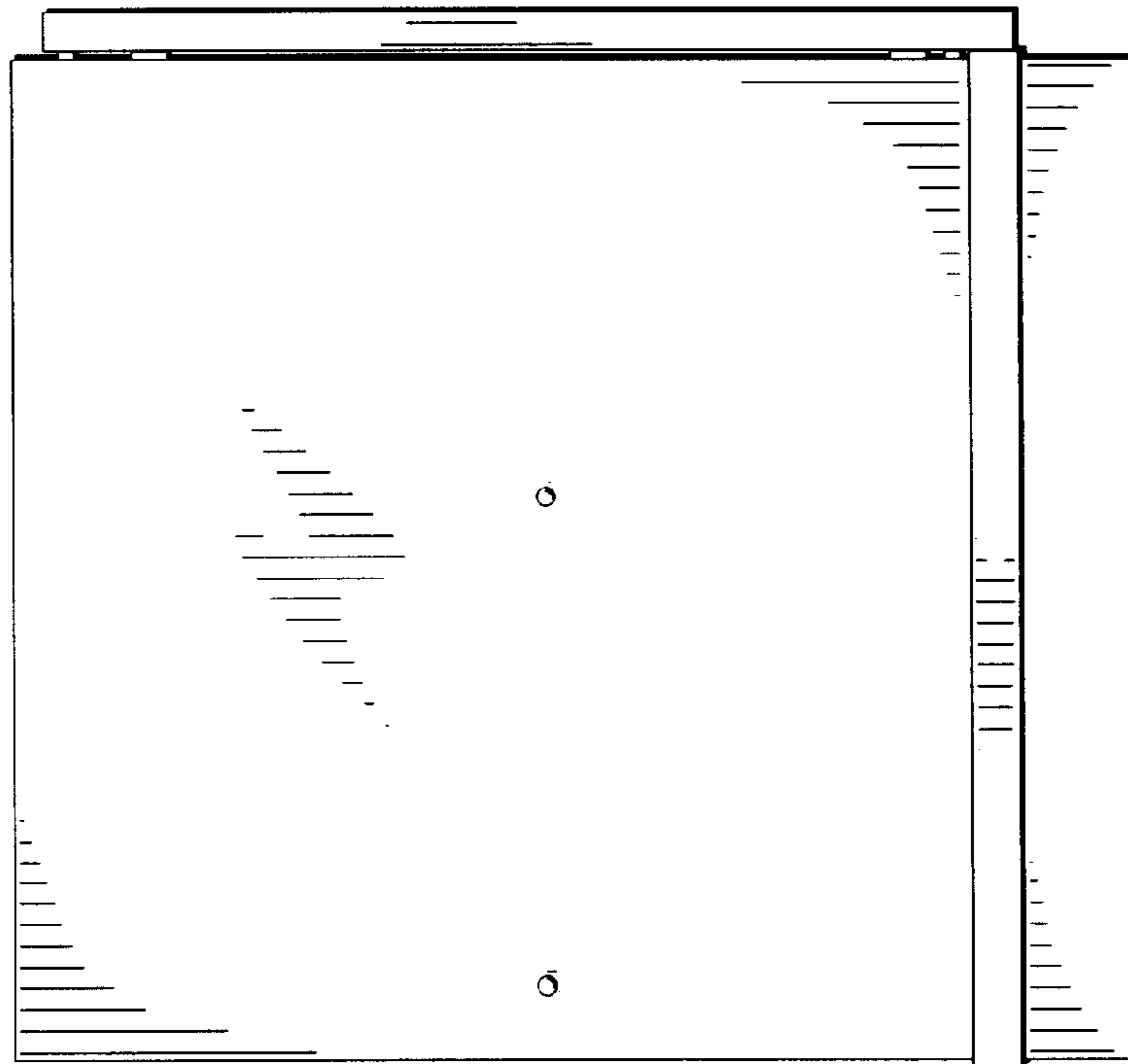
**FIG. 2**



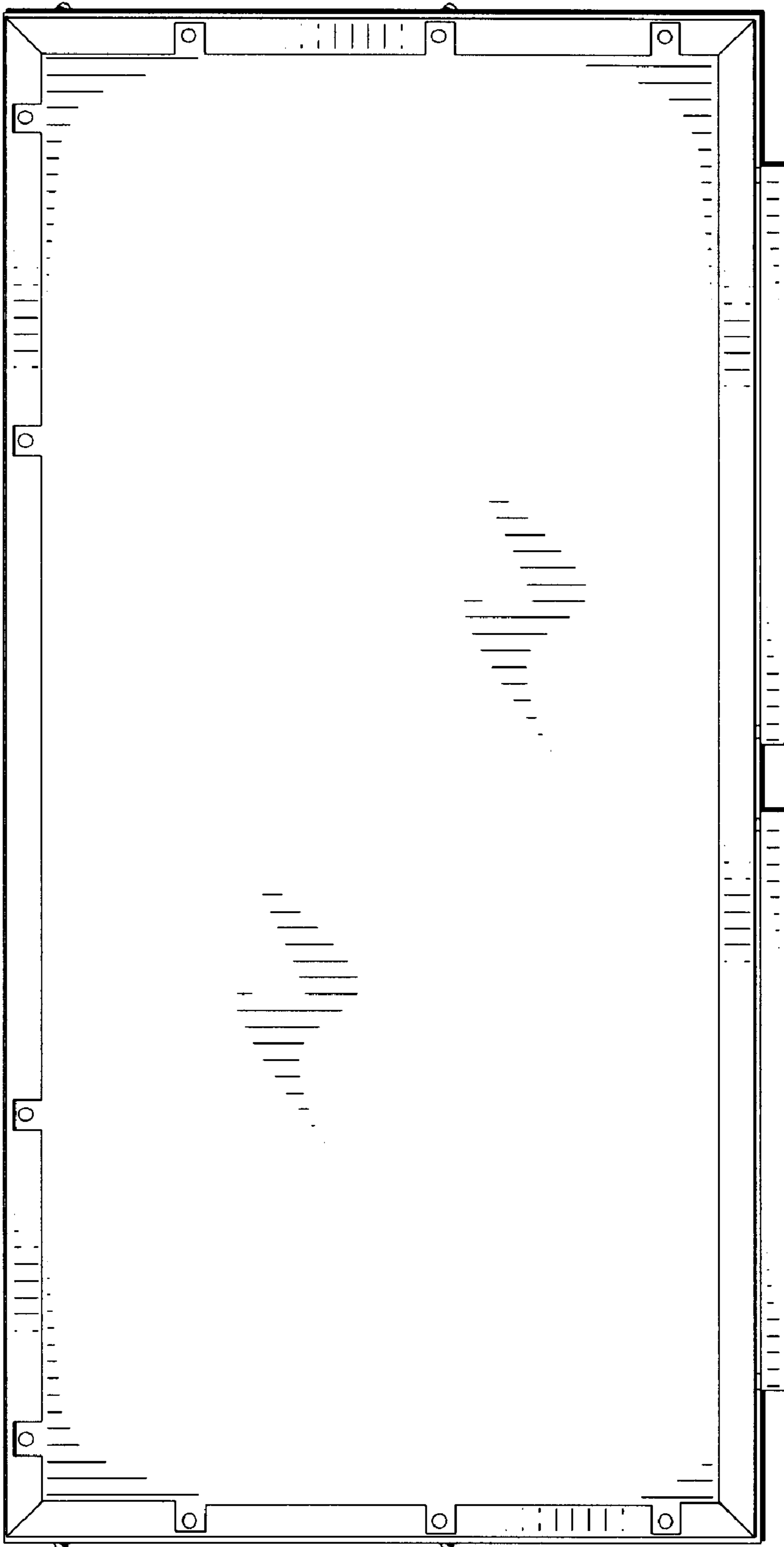
**FIG. 3**



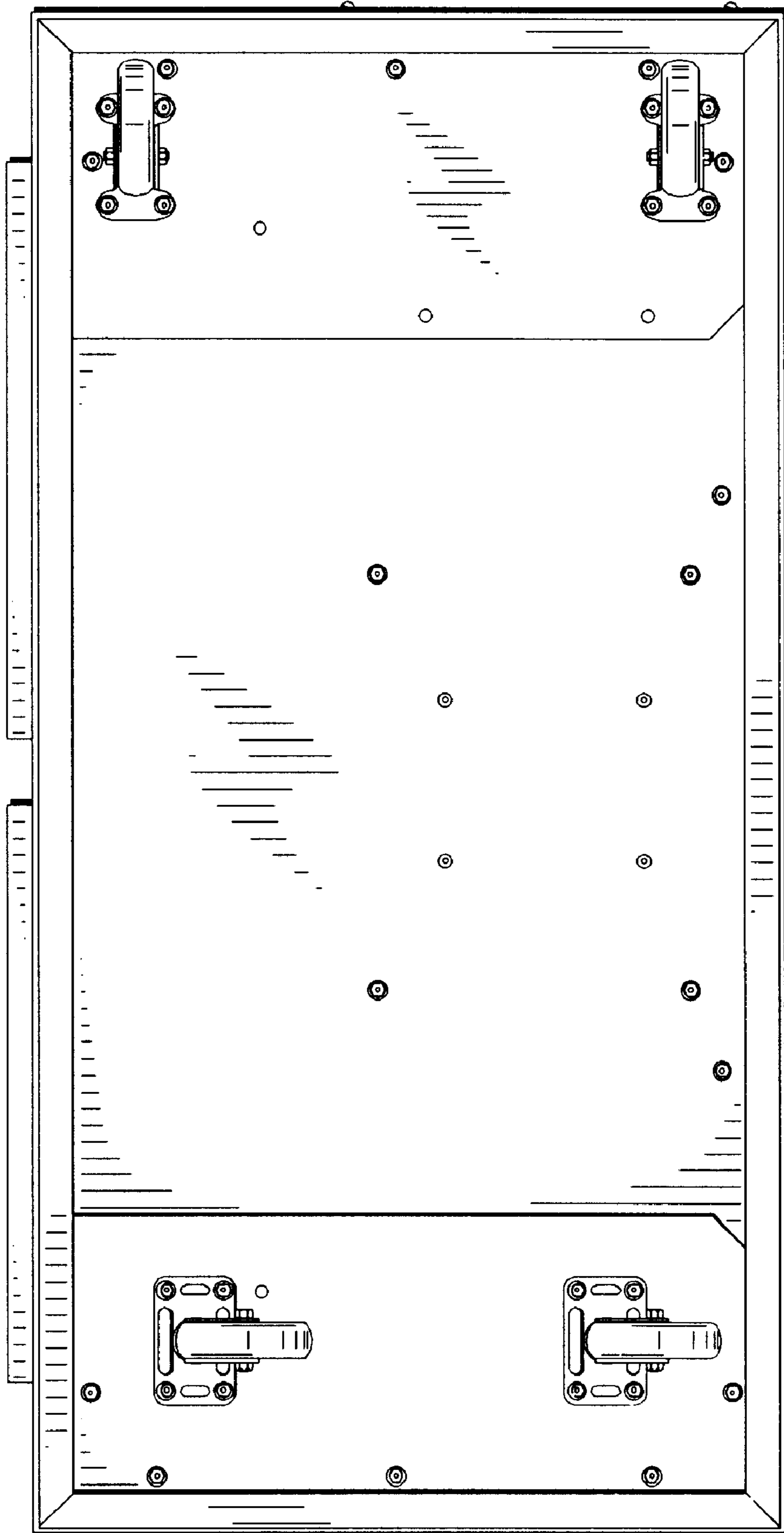
**FIG. 5**



**FIG. 4**



**FIG. 6**



**FIG. 7**