



US00D409793S

United States Patent [19]

Sabol et al.

[11] Patent Number: Des. 409,793

[45] Date of Patent: ** May 11, 1999

[54] CIGAR HUMIDOR

[76] Inventors: Joseph Sabol; Sean Sabol, both of 160 W. End Ave.-Apt. 6F, New York, N.Y. 10023

[**] Term: 14 Years

[21] Appl. No.: 29/078,113

[22] Filed: Oct. 17, 1997

[51] LOC (6) Cl. 27-06

[52] U.S. Cl. D27/192; D21/744; D27/188

[58] Field of Search 312/31; 473/316-323; D21/736-746, 757; D27/172, 183, 192, 188; 131/528, 329, 328

[56] References Cited

U.S. PATENT DOCUMENTS

D. 212,890	12/1968	Rose	D21/739
D. 380,246	6/1997	Solheim et al.	D21/736
D. 398,686	9/1998	Masuda	D21/742
5,544,883	8/1996	Meyer	473/313
5,687,749	11/1997	Brauer, Jr. .	
5,772,525	6/1998	Klein	473/316
5,816,930	10/1998	Brown	473/340

OTHER PUBLICATIONS

Hammacher Schlemmer Catalog, K-96, Back page 104.

Primary Examiner—Susan J. Lucas
Assistant Examiner—Jennifer Rivard

Attorney, Agent, or Firm—Rodman & Rodman

[57] CLAIM

The ornamental design for a cigar humidor, as shown and described.

DESCRIPTION

FIG. 1 is a front perspective view of a cigar humidor showing our new design;

FIG. 2 is a fragmentary exploded perspective view of an upper portion of the shaft thereof;

FIG. 3 is a fragmentary perspective view of the lower portion of the shaft thereof;

FIG. 4 is an front elevation view of the lower portion of the shaft thereof;

FIG. 5 is a top plan view of the lower portion of the shaft thereof;

FIG. 6 is a bottom plan view of the lower portion of the shaft thereof;

FIG. 7 is a end view of the lower portion of the shaft thereof;

FIG. 8 is an end view of the opposite end of the lower portion of the shaft thereof; and,

FIG. 9 is a rear elevation view of the lower portion of the shaft thereof.

The claimed design is fragmentarily shown in FIGS. 2-9 for convenience of illustration. The broken line disclosures of the cigar and matchbox are shown for convenience of illustration and form no part of the claimed design.

1 Claim, 4 Drawing Sheets

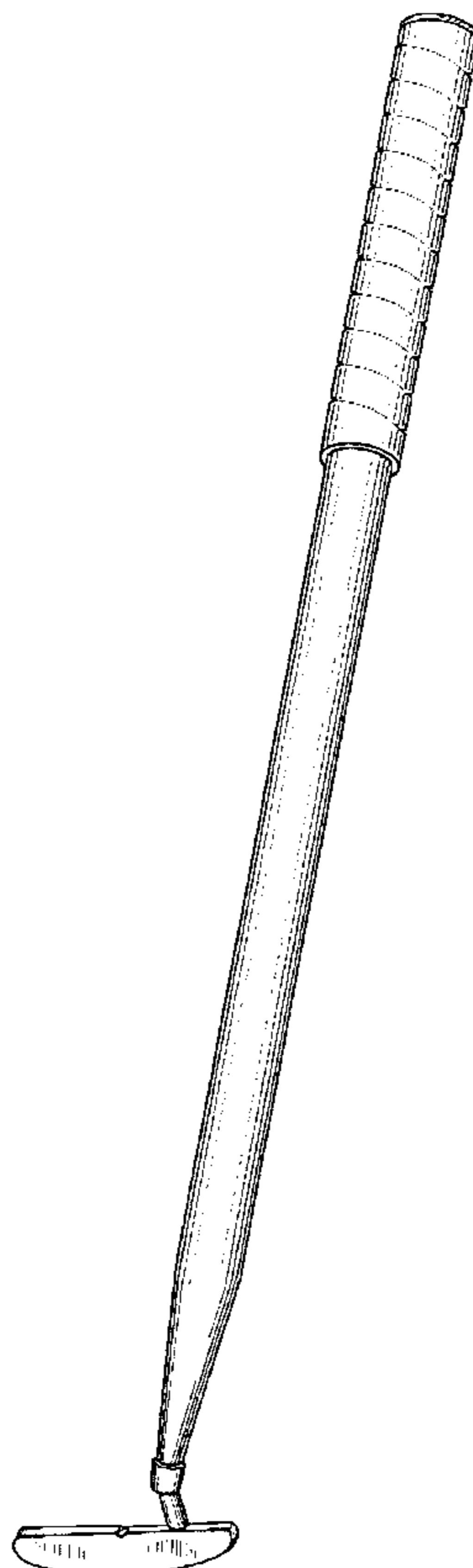

FIG. 1

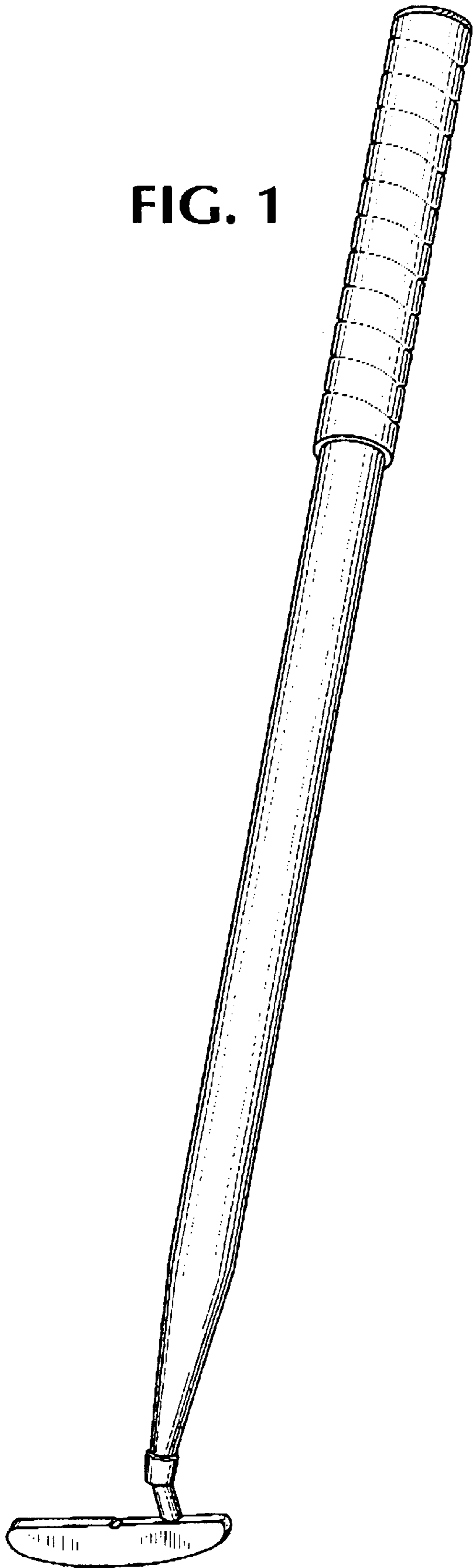
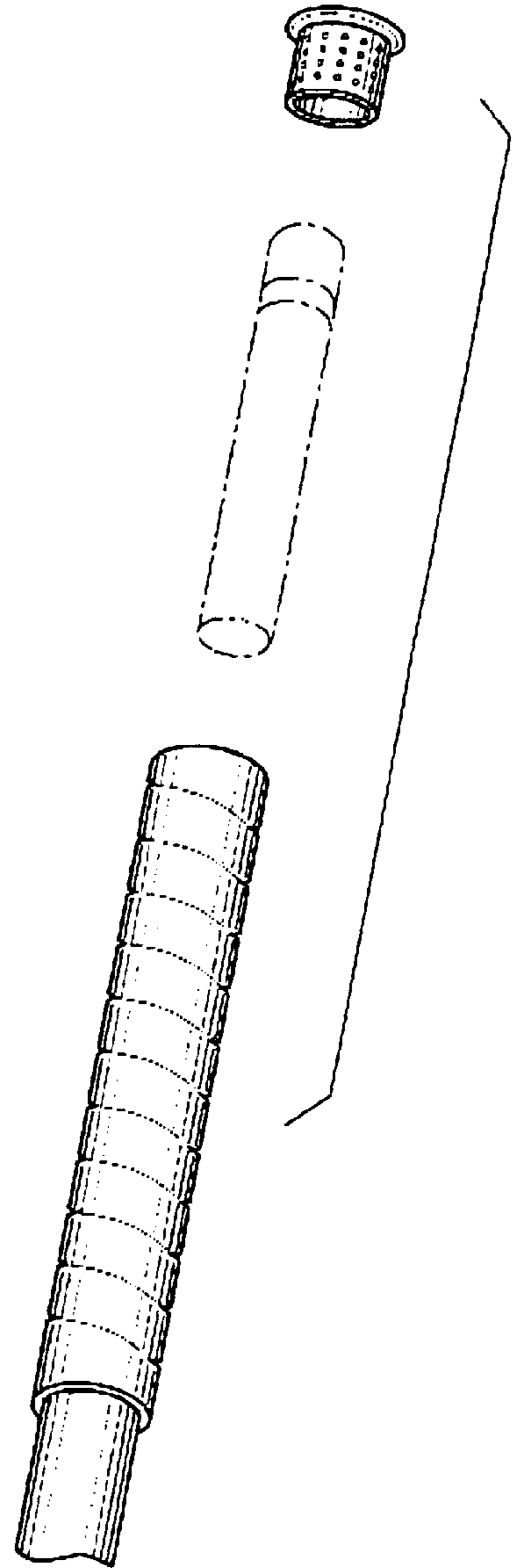

FIG. 2



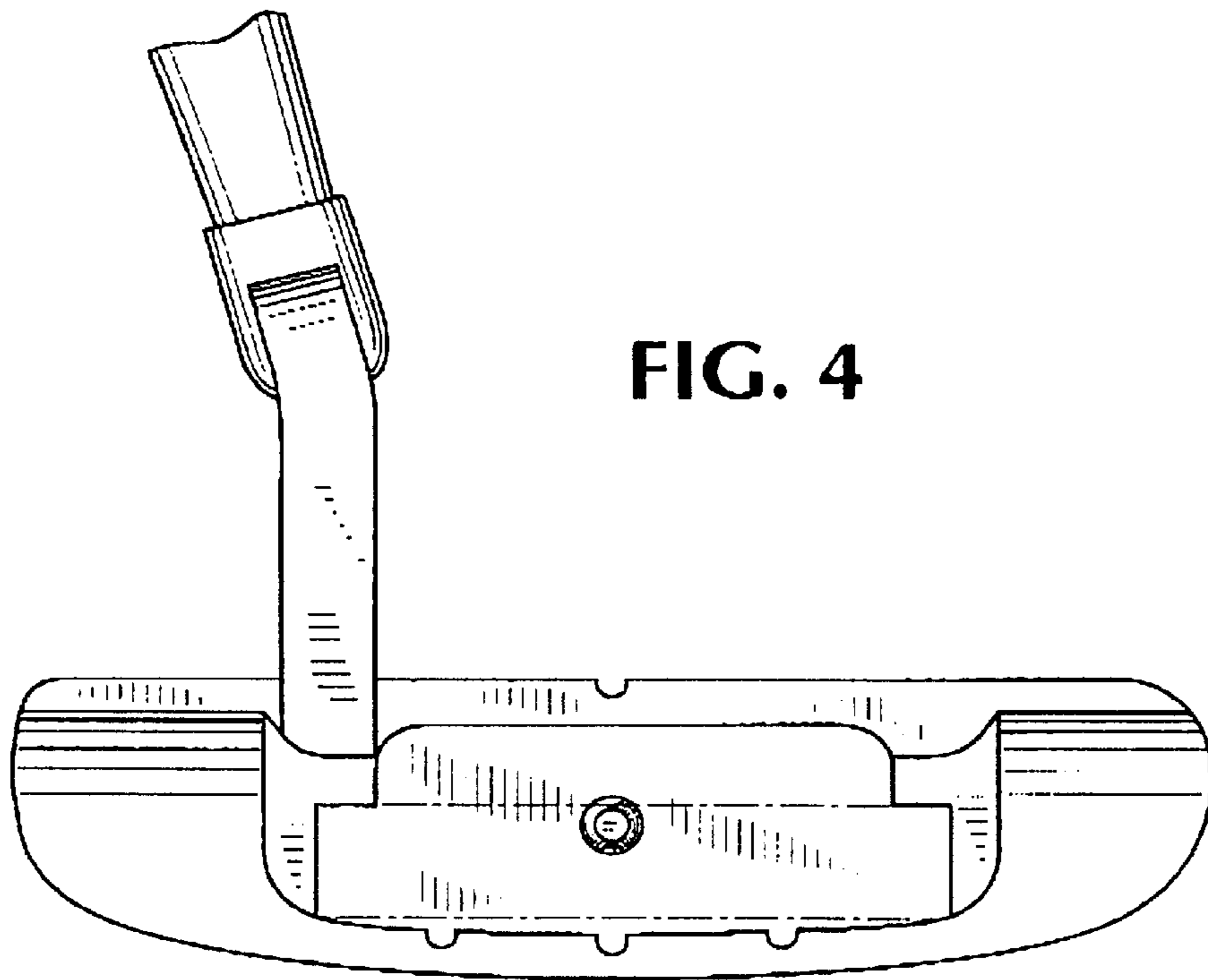
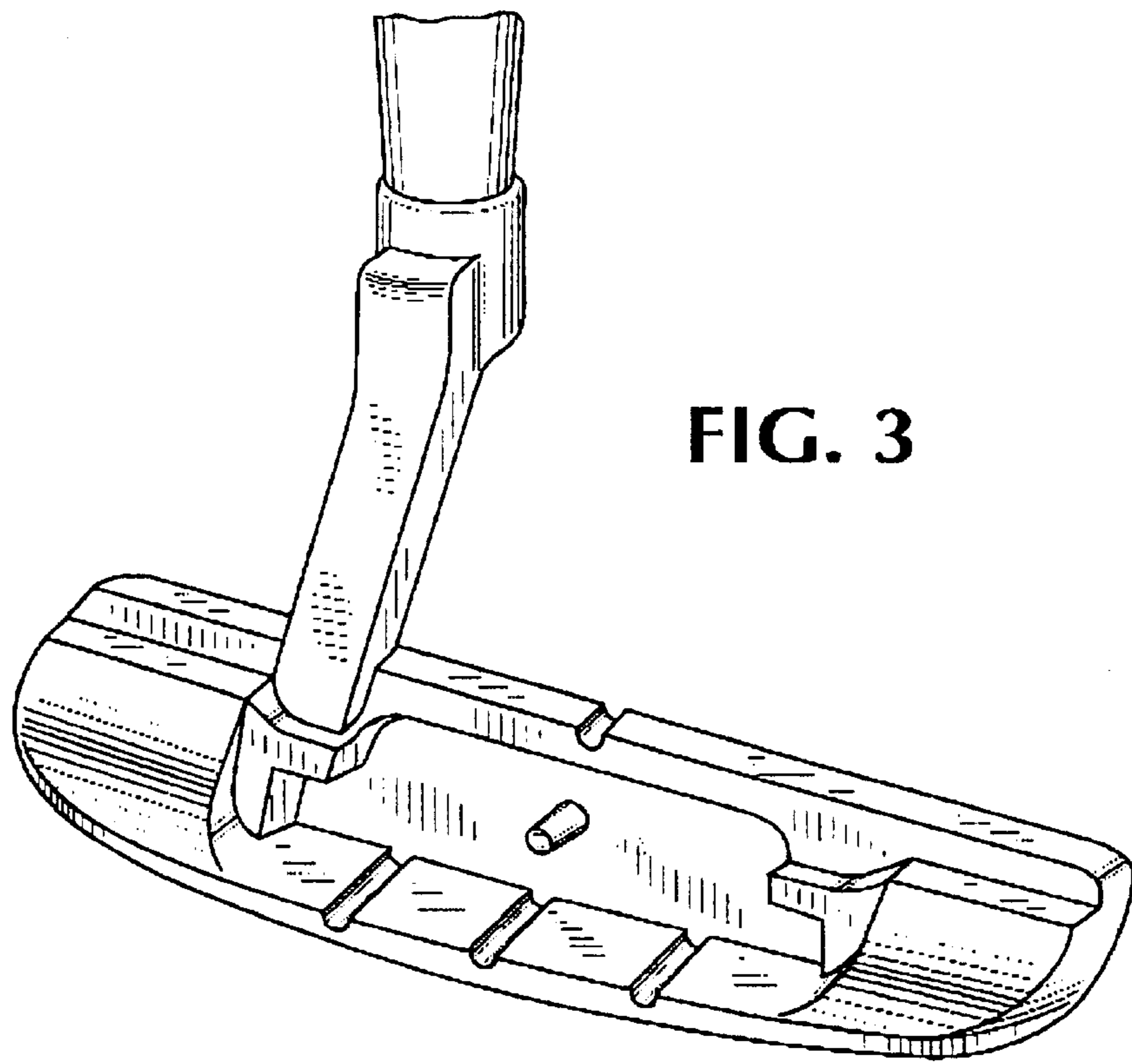

FIG. 5

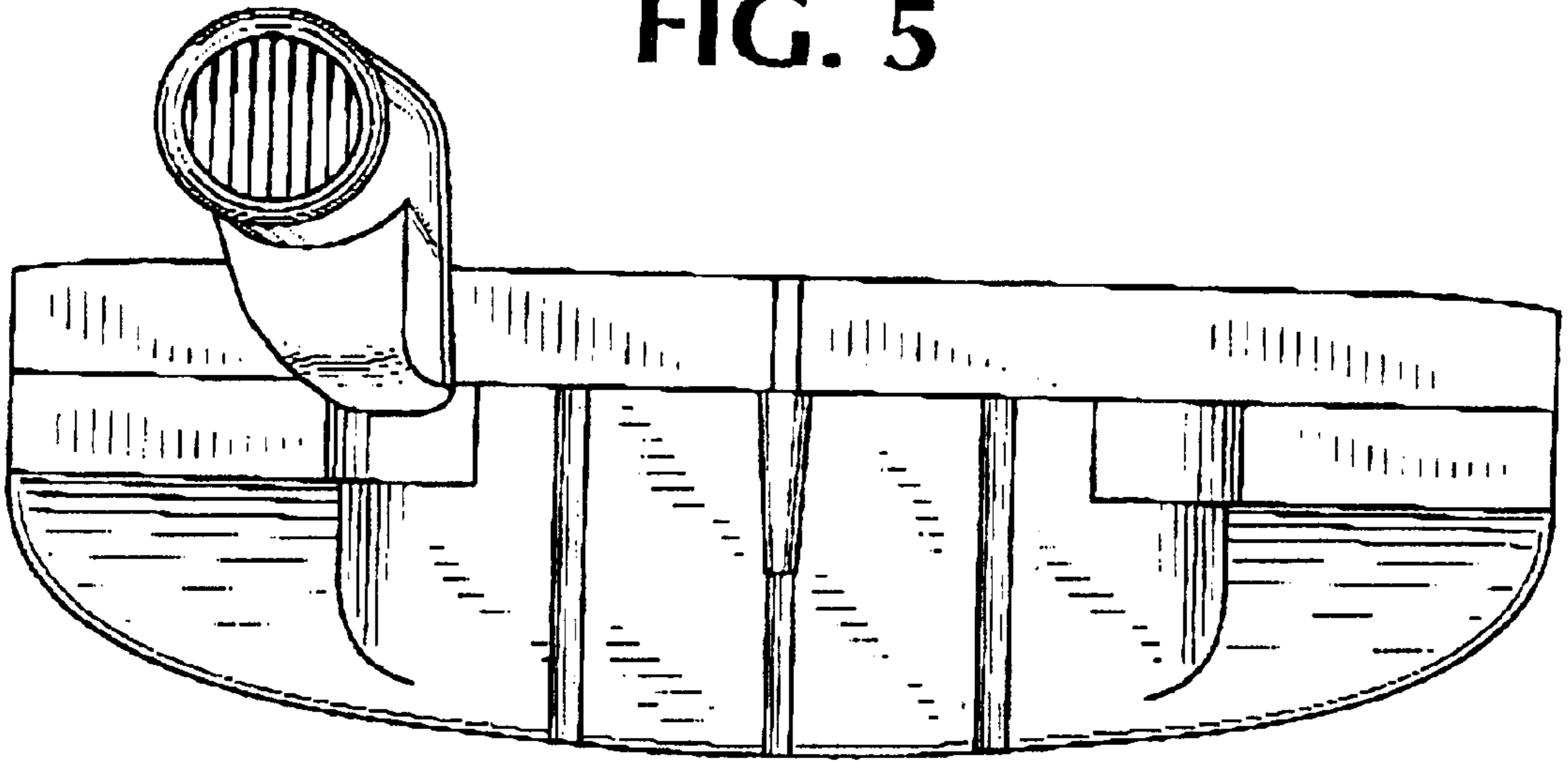

FIG. 6

