



US00D408070S

**United States Patent** [19]  
**Hsu**

[11] **Patent Number: Des. 408,070**

[45] **Date of Patent: \*\*Apr. 13, 1999**

[54] **FAUCET HOUSING**

D. 382,630 8/1997 Doughty et al. .... D23/241

[76] **Inventor: Ming-Tsung Hsu**, No. 10, 7th Road,  
Taichung Industrial Park, Taichung,  
Taiwan

*Primary Examiner*—Louis S. Zarfes  
*Assistant Examiner*—Eric Watterson  
*Attorney, Agent, or Firm*—David and Raymond; Raymond  
Y. Chan

[\*\*] **Term: 14 Years**

[57] **CLAIM**

[21] **Appl. No.: 29/089,035**

The ornamental design for a faucet housing, as shown.

[22] **Filed: Jun. 5, 1998**

**DESCRIPTION**

[51] **LOC (6) Cl. .... 23-01**

FIG. 1 is a front perspective view showing my new design;

[52] **U.S. Cl. .... D23/238**

FIG. 2 is a front view thereof;

[58] **Field of Search .... D23/238-243,**

FIG. 3 is a left end view thereof;

D23/250-257; 4/675-678; 137/801

FIG. 4 is a right end view thereof;

FIG. 5 is a top view thereof;

FIG. 6 is a bottom view thereof;

FIG. 7 is a rear view thereof;

FIG. 8 is a front perspective view; and,

FIG. 9 is a rear perspective view.

The broken line showing is for illustrative purposes only and  
forms no part of the claimed design.

[56] **References Cited**

**U.S. PATENT DOCUMENTS**

D. 229,495	12/1973	Landell	.....	D23/238
D. 346,852	5/1994	Hill	.....	D23/241
D. 347,466	5/1994	Kolada et al.	.....	D23/241
D. 361,827	8/1995	Doughty et al.	.....	D23/241
D. 370,053	5/1996	Hill et al.	.....	D23/241
D. 382,628	8/1997	Doughty et al.	.....	D23/241

**1 Claim, 9 Drawing Sheets**

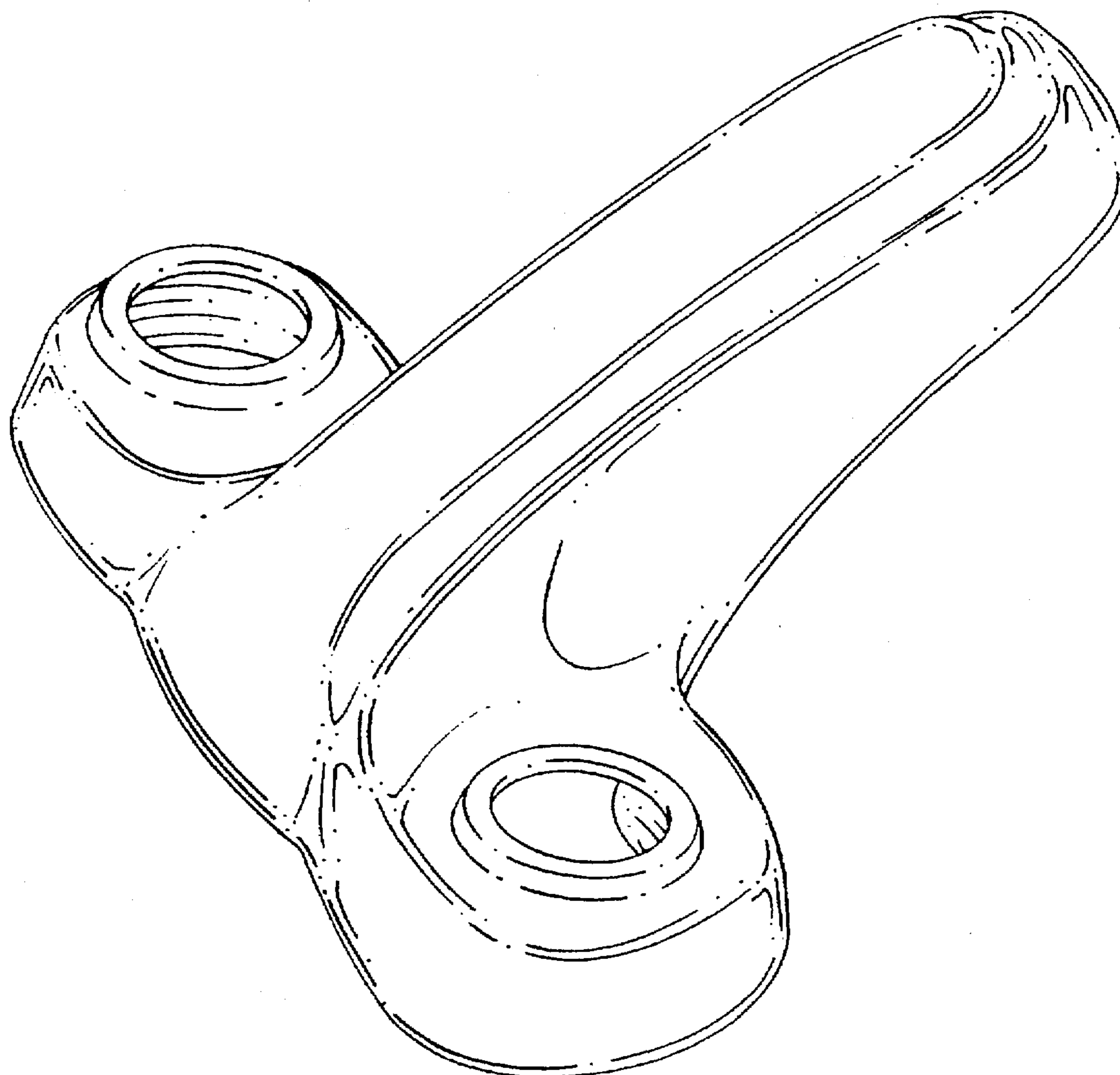

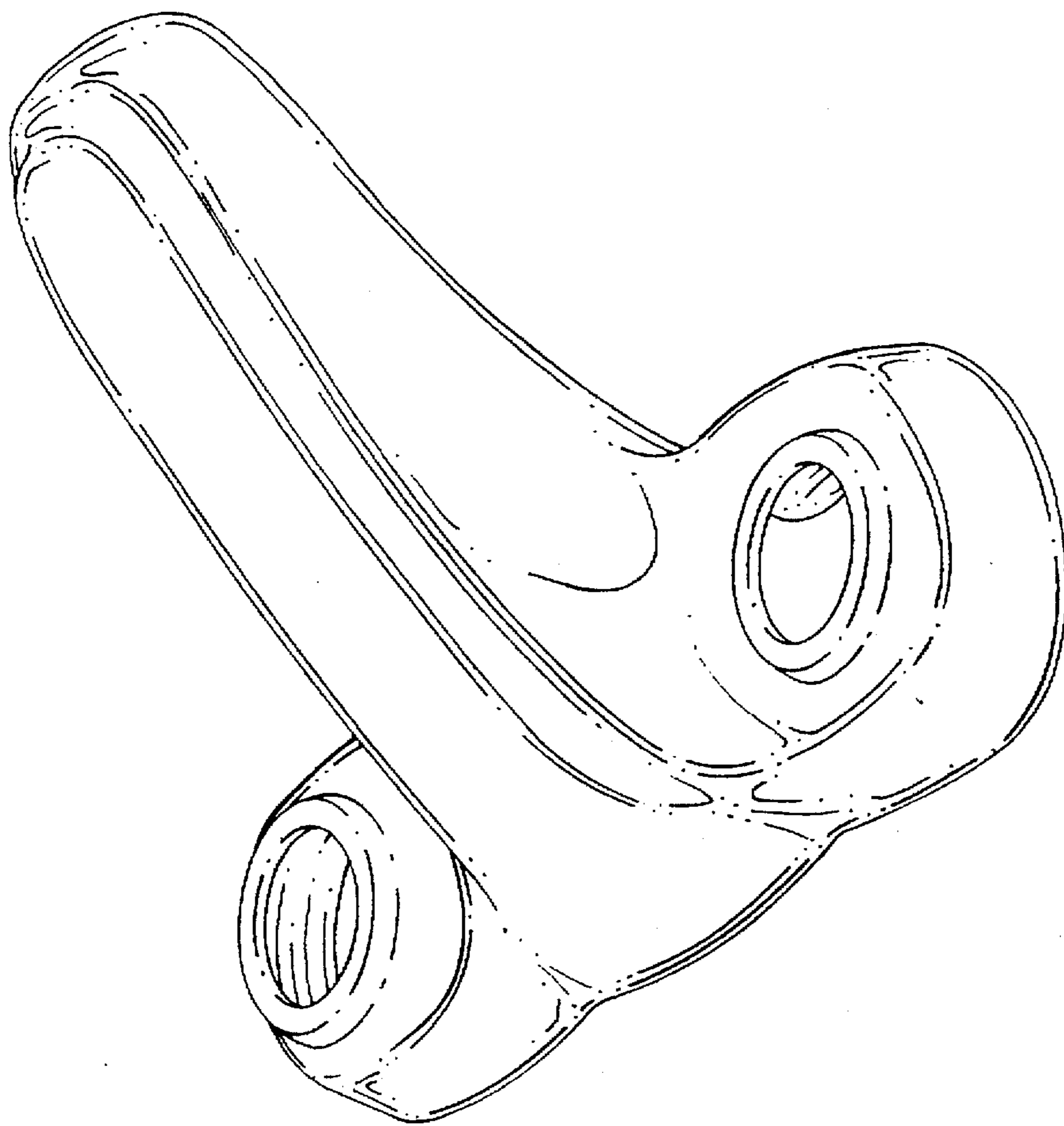

FIG.1.

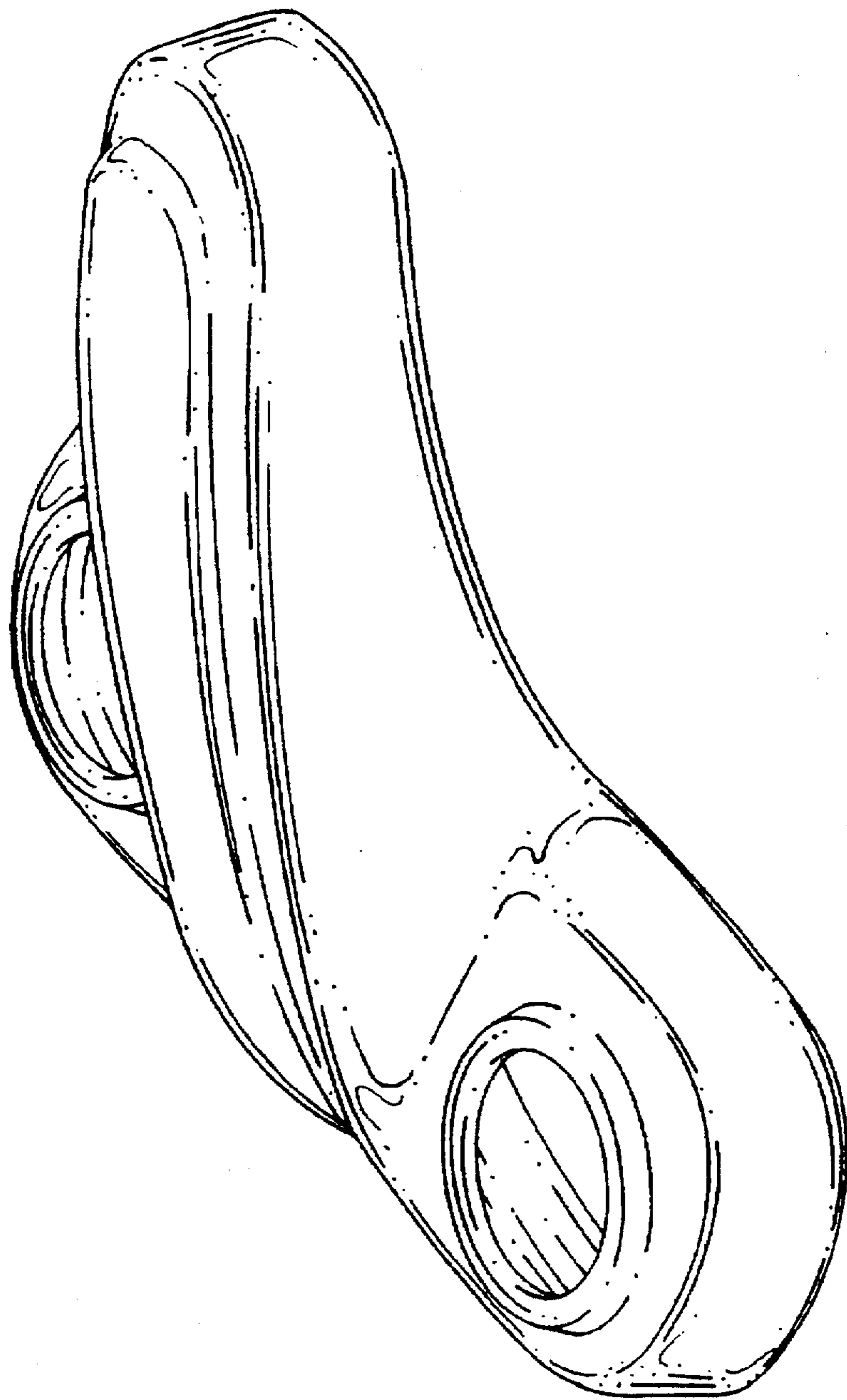

FIG.2.

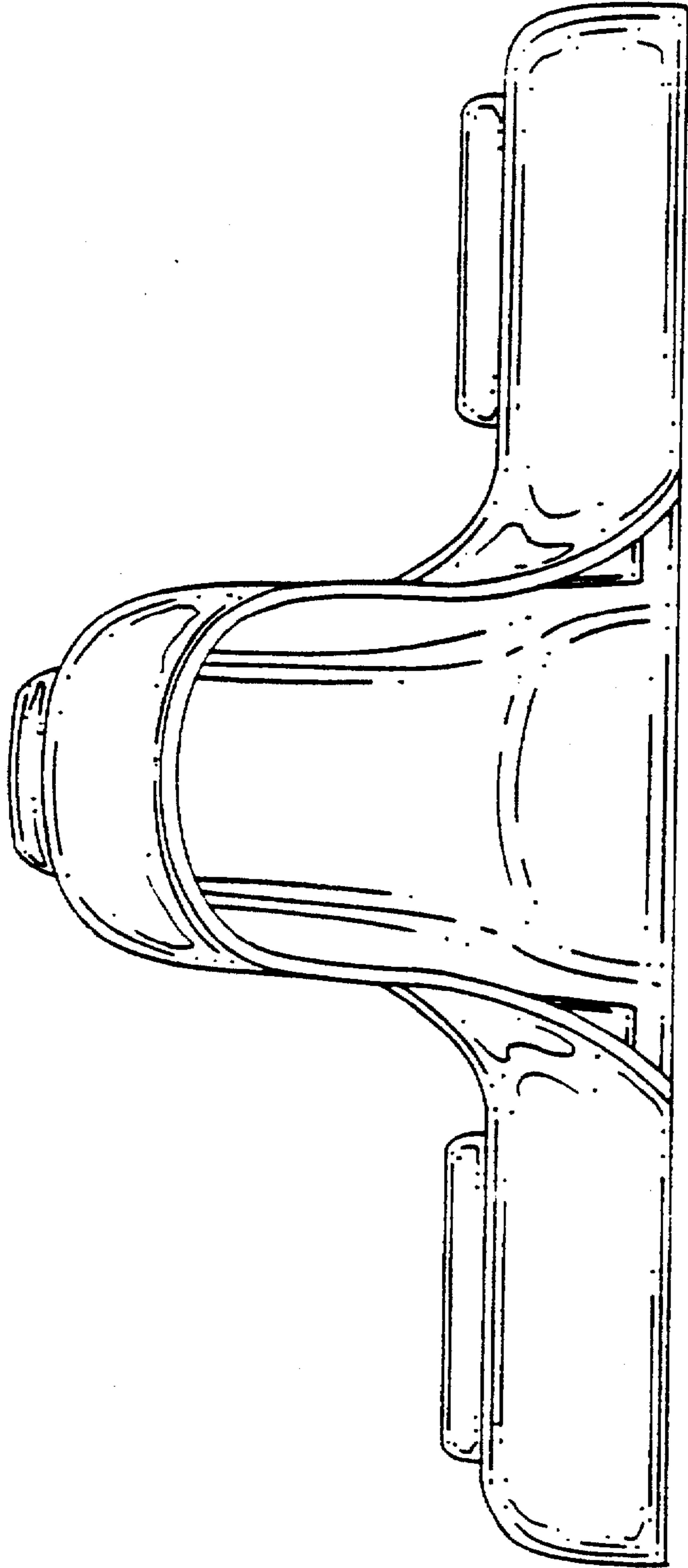

FIG.3.

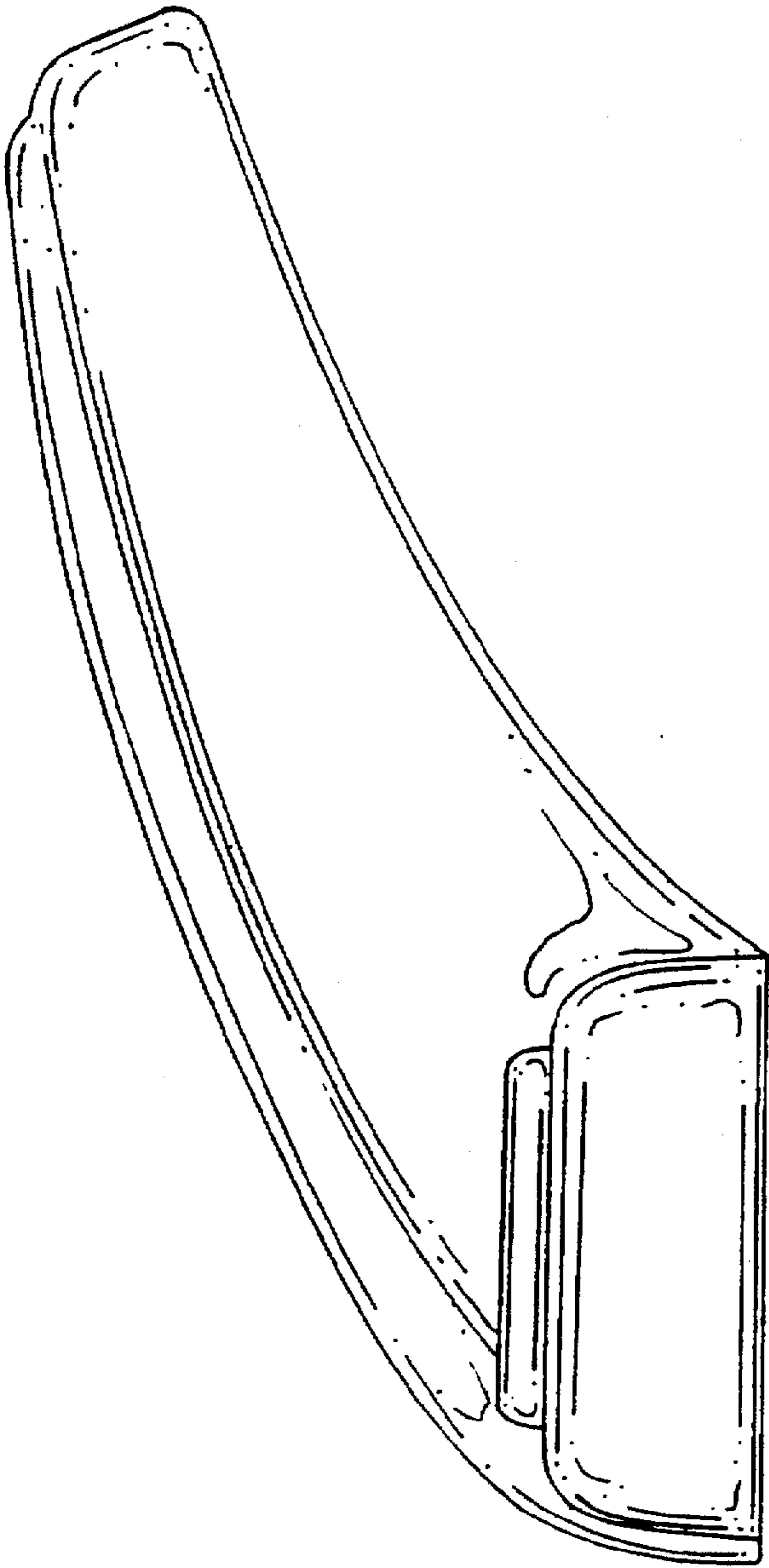

FIG.4.

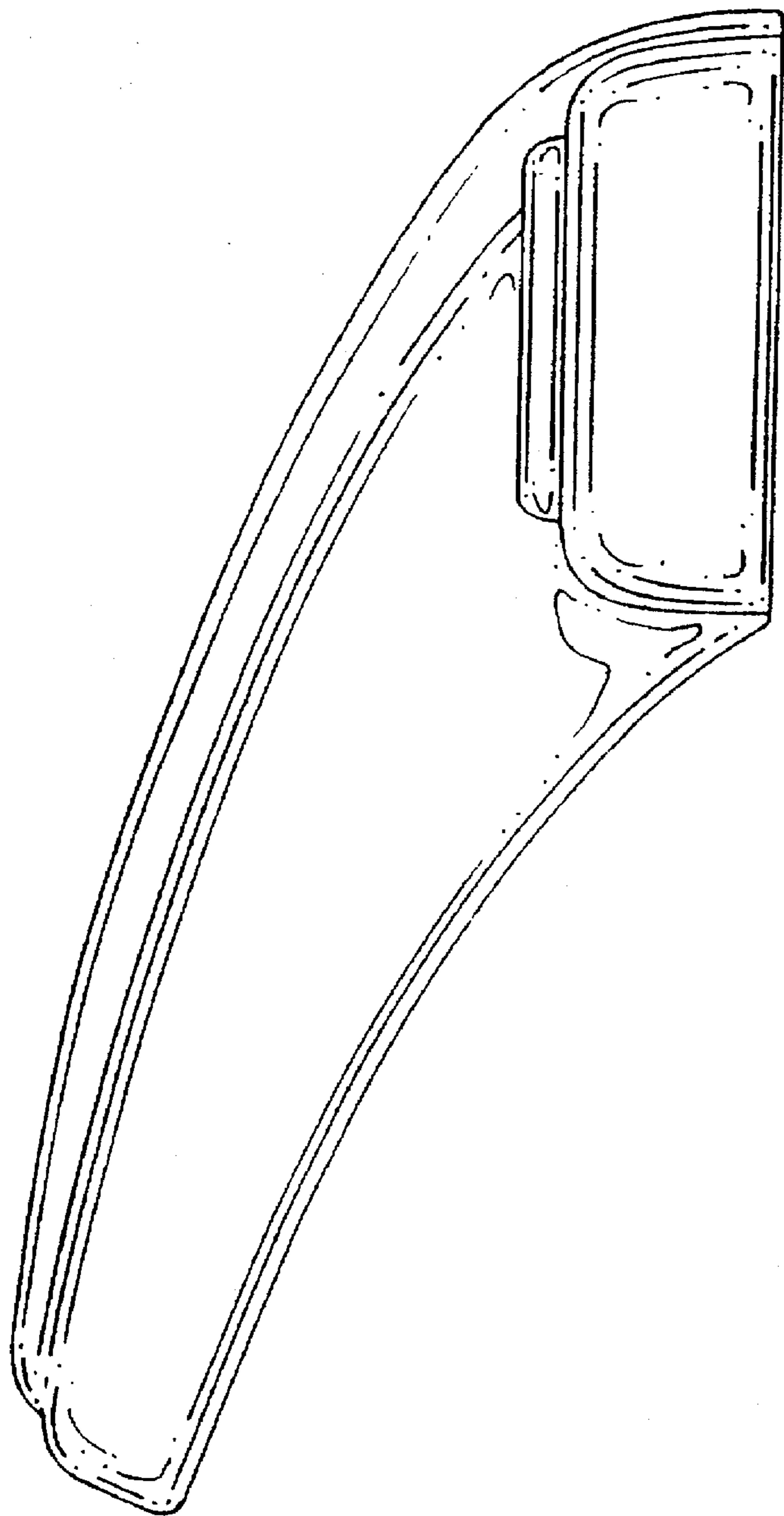

FIG.5.

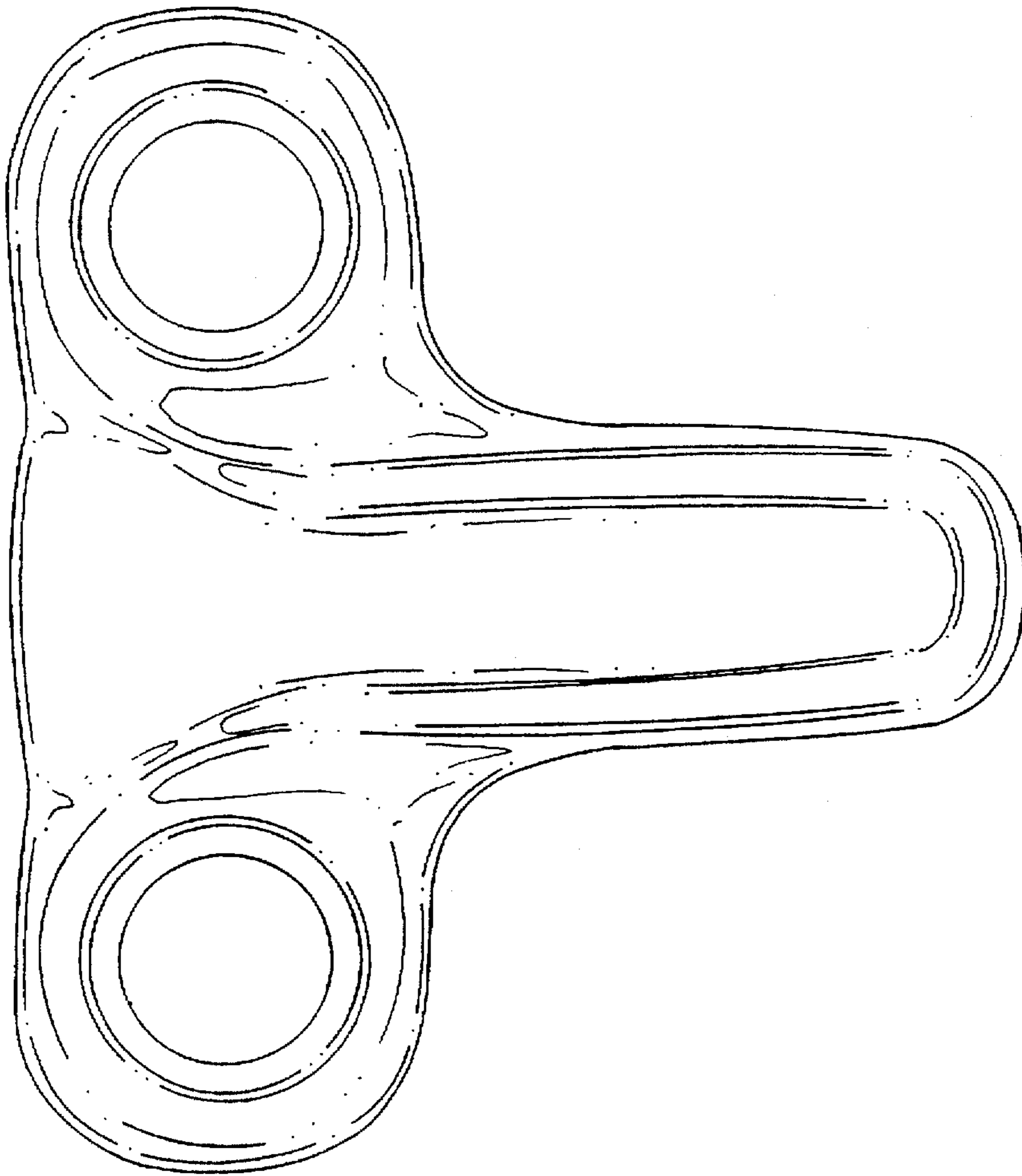

FIG.6.

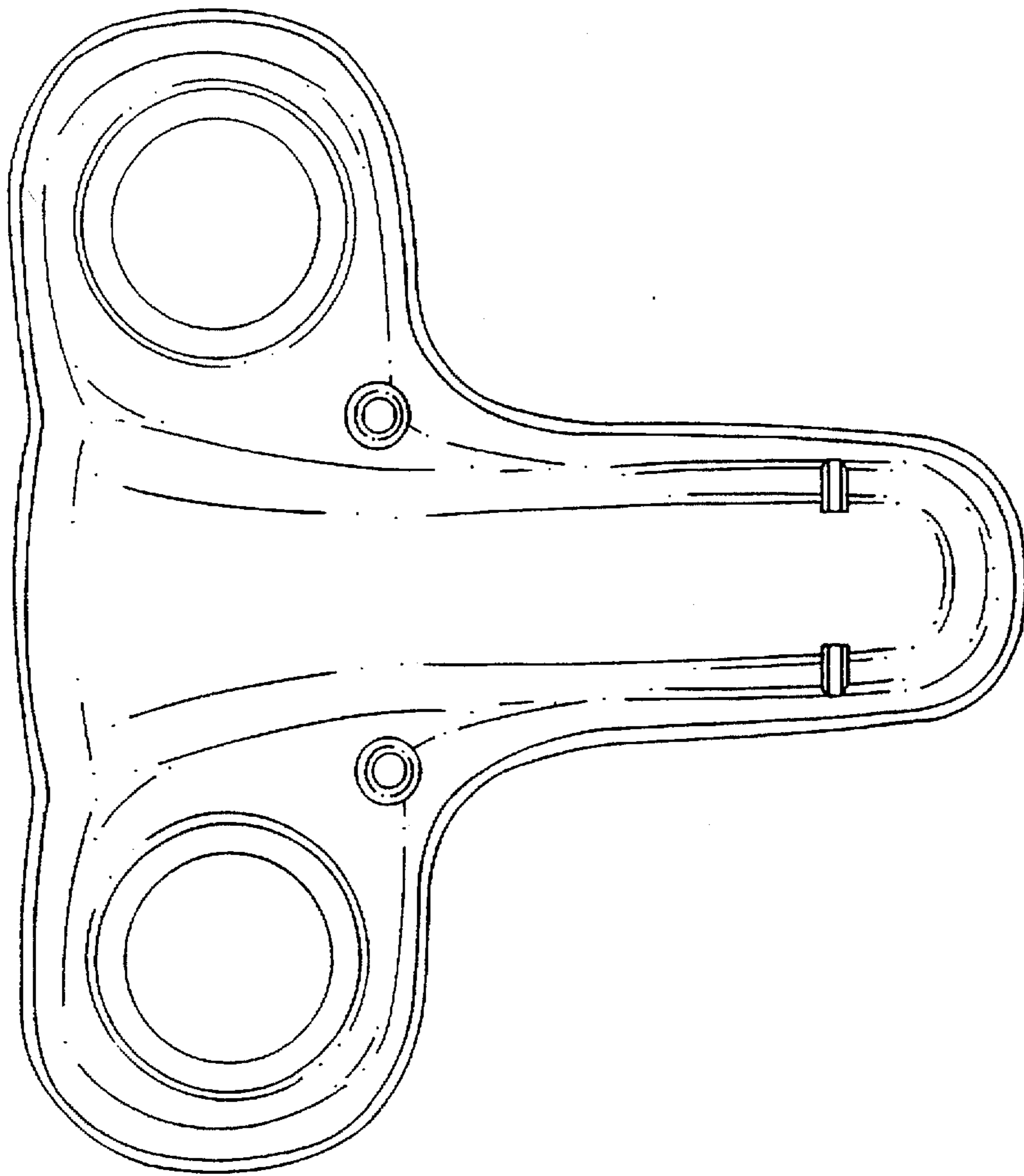

FIG. 7.



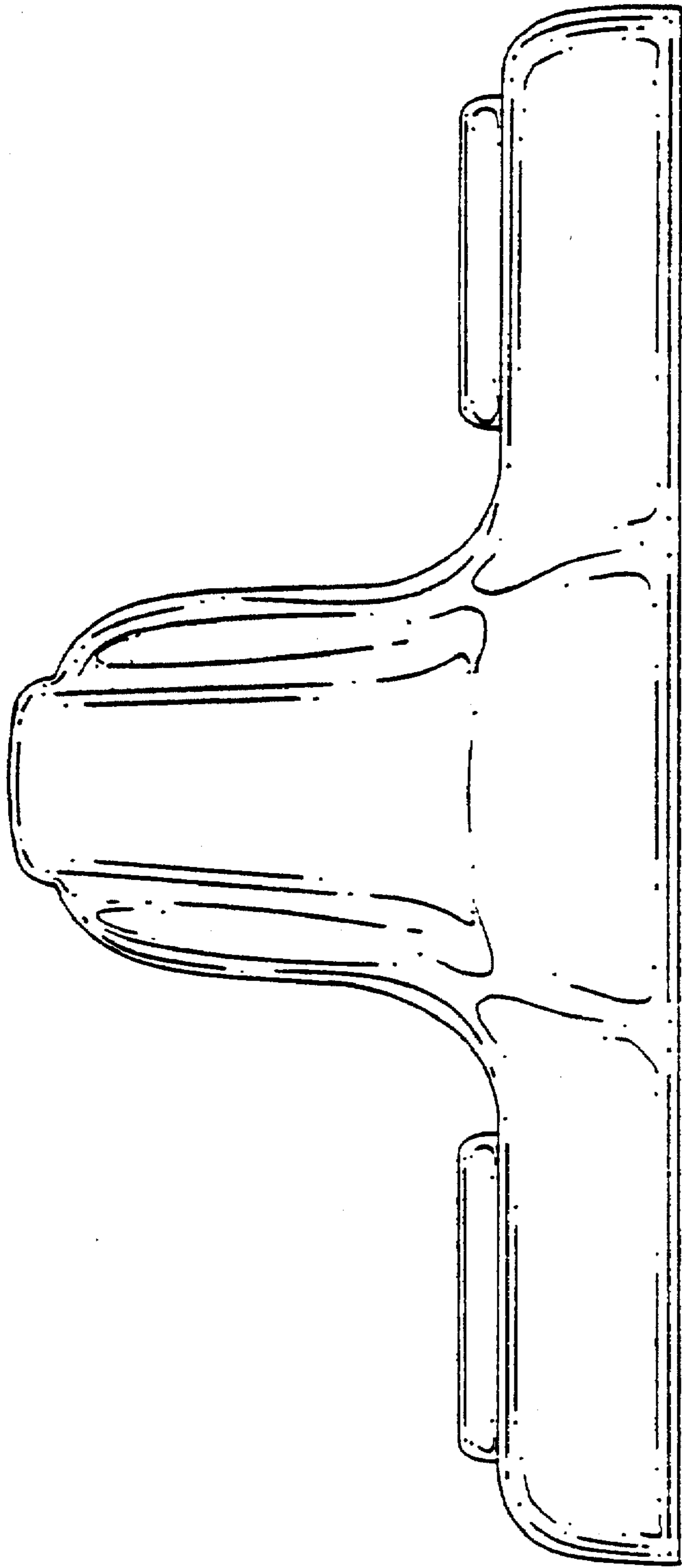

FIG. 8.

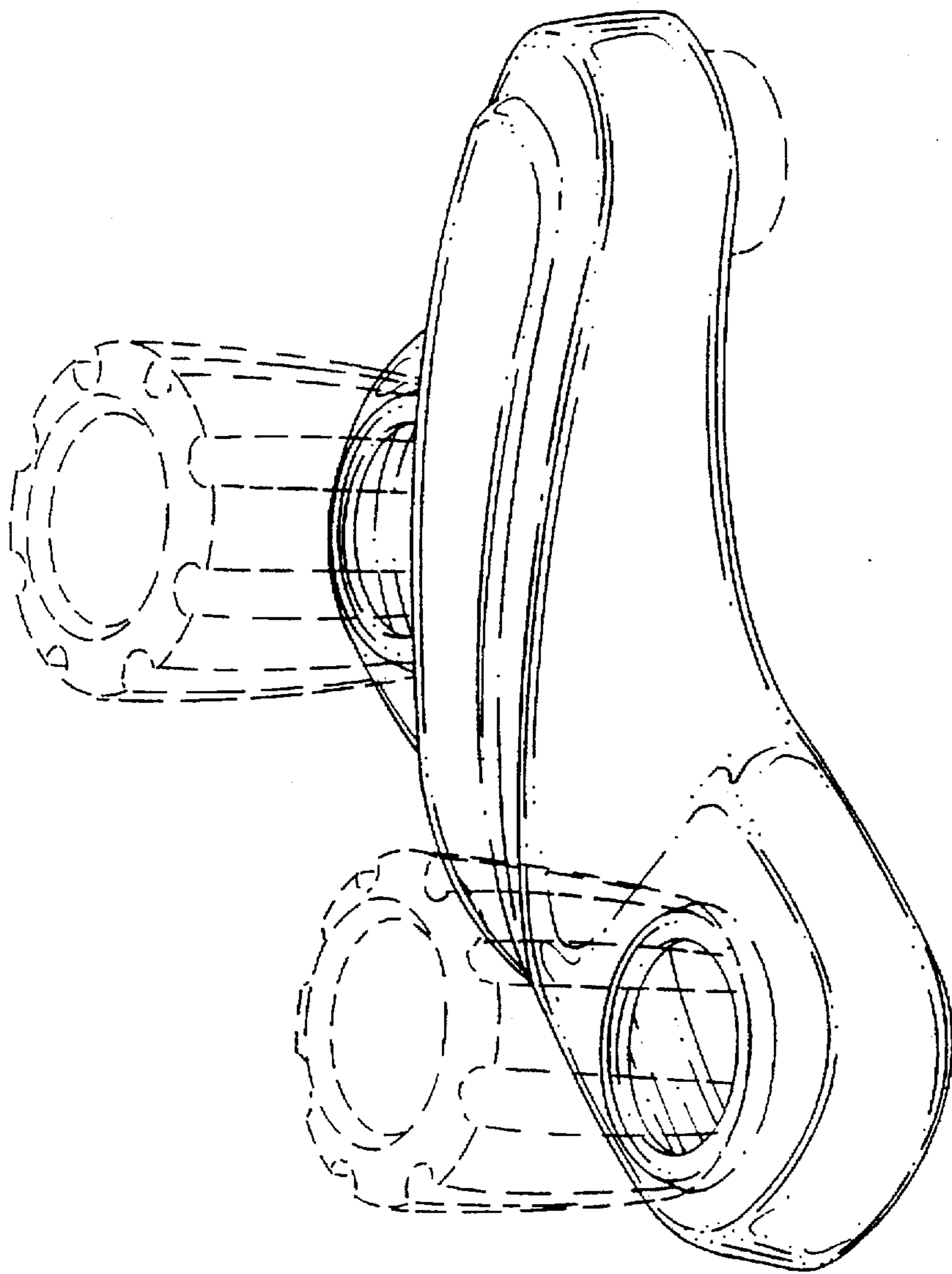

FIG. 9.