



US00D406358S

United States Patent [19]

Risi et al.

[11] Patent Number: **Des. 406,358**

[45] Date of Patent: ****Mar. 2, 1999**

[54] **MODULAR BLOCK**

[75] Inventors: **Angelo Risi**, Richmond Hill; **Stephen A. Acton**, Oakville, both of Canada

[73] Assignee: **Rothbury International Inc.**, Thornhill, Canada

[**] Term: **14 Years**

[21] Appl. No.: **79,270**

[22] Filed: **Nov. 29, 1997**

[30] Foreign Application Priority Data

Sep. 6, 1997 [CA] Canada 1997-1569

[51] **LOC (6) Cl.** **25-01**

[52] **U.S. Cl.** **D25/113**

[58] **Field of Search** D25/113-118,
D25/151; 52/596, 592.1, 592.3, 592.4, 592.5,
592.6, 603, 607

[56] References Cited

U.S. PATENT DOCUMENTS

D. 301,063 5/1989 Risi et al. D25/113
D. 305,938 2/1990 Risi et al. D25/113

D. 346,667 5/1994 Blomquist et al. D25/113
D. 350,611 9/1994 Scales D25/114
4,815,897 3/1989 Risi et al. 52/592.3
4,860,505 8/1989 Bender 52/592.6
5,598,679 2/1997 Orton et al. 52/604

Primary Examiner—Raphael Barkai
Attorney, Agent, or Firm—Robic

[57] CLAIM

The ornamental design for a modular block, as shown and described.

DESCRIPTION

FIG. 1 is a front perspective view of a modular block showing our invention;
FIG. 2 is a top plan view thereof;
FIG. 3 is a bottom plan view thereof;
FIG. 4 is a side elevational view thereof;
FIG. 5 is a front perspective view of a modified embodiment of the design shown in FIGS. 1-4.
FIG. 6 is a top plan view of the modular block thereof;
FIG. 7 is a bottom plan view of the modular block thereof; and,
FIG. 8 is a right side elevational view of the modular block thereof.

1 Claim, 4 Drawing Sheets

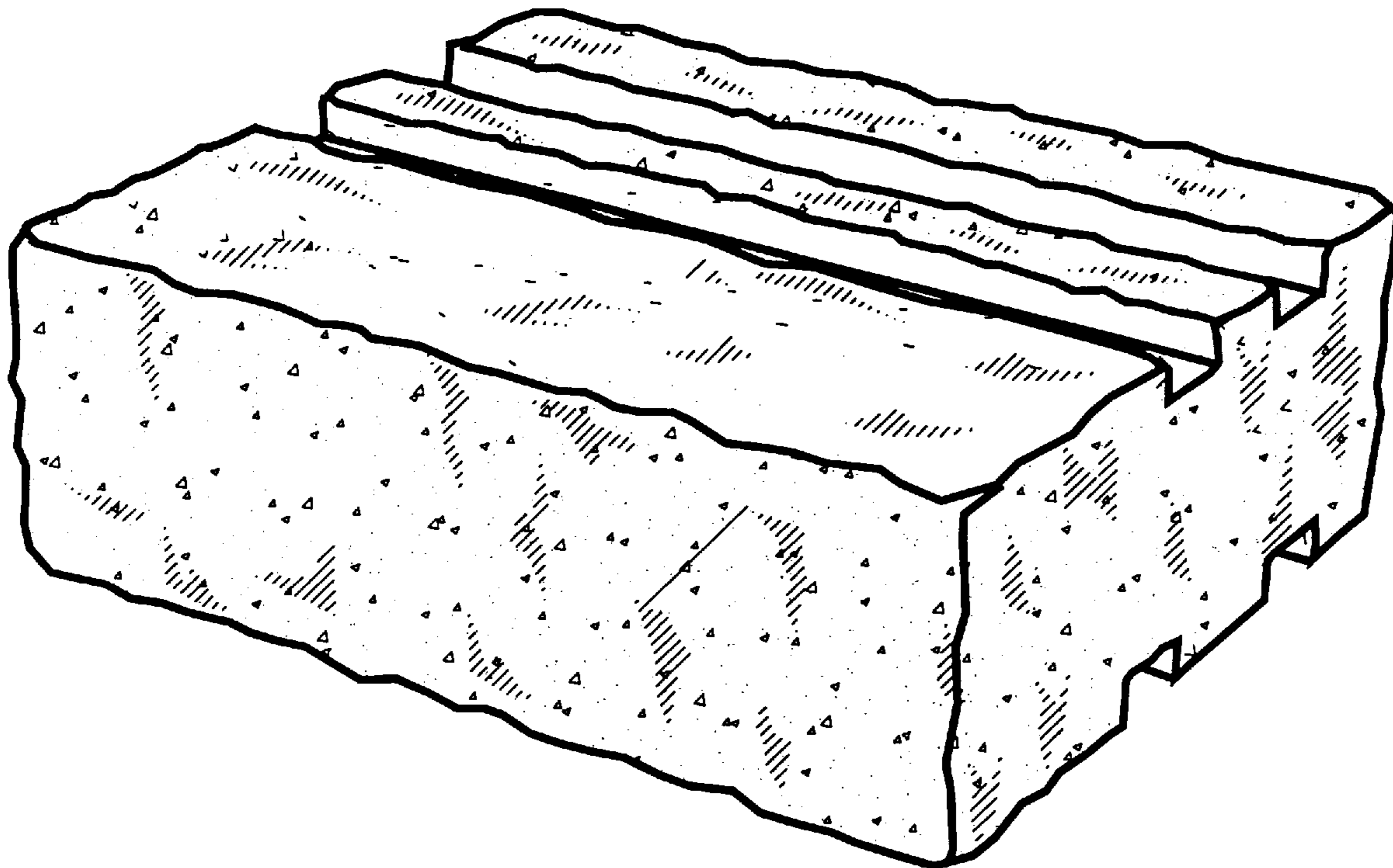

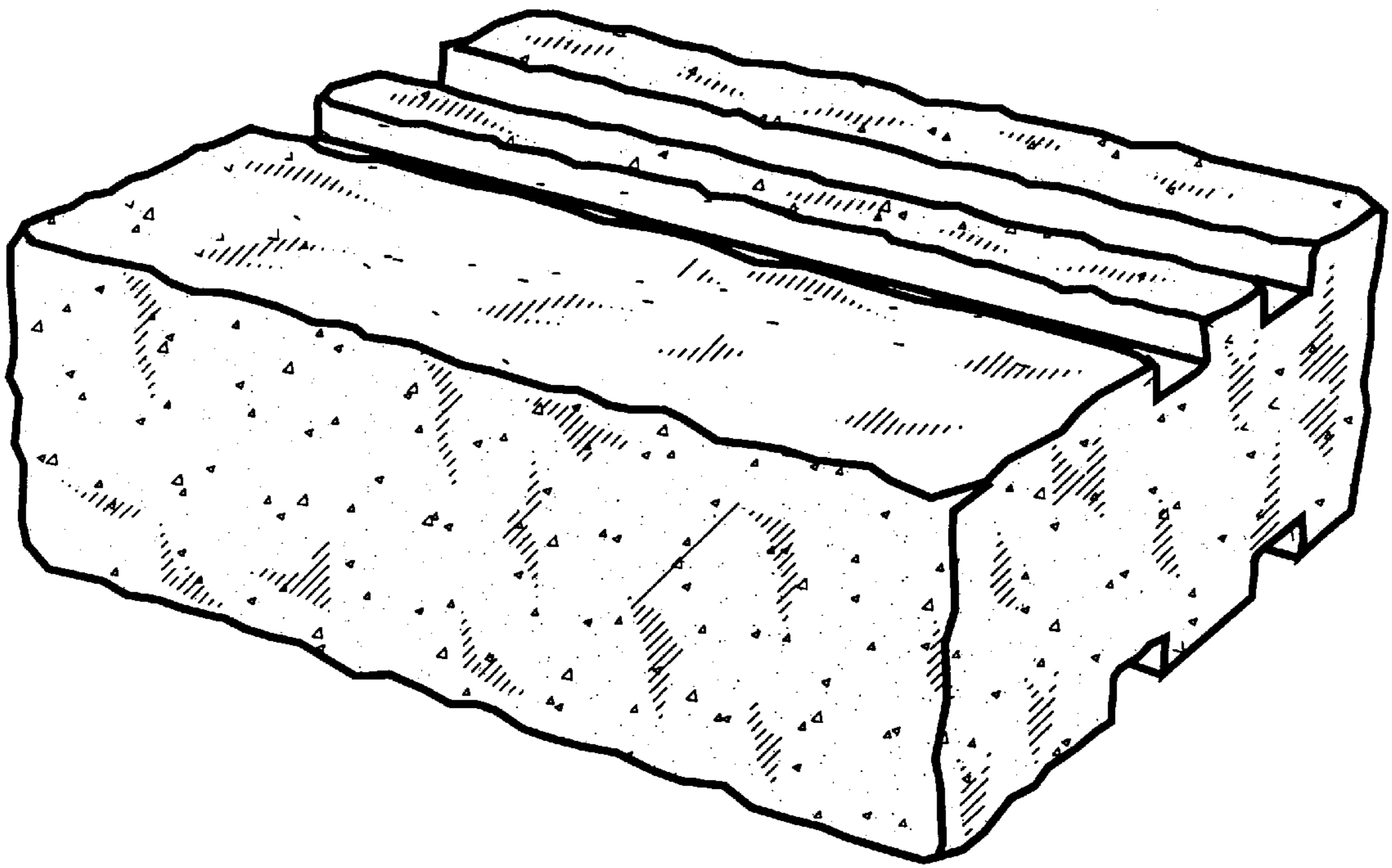

FIG. 1

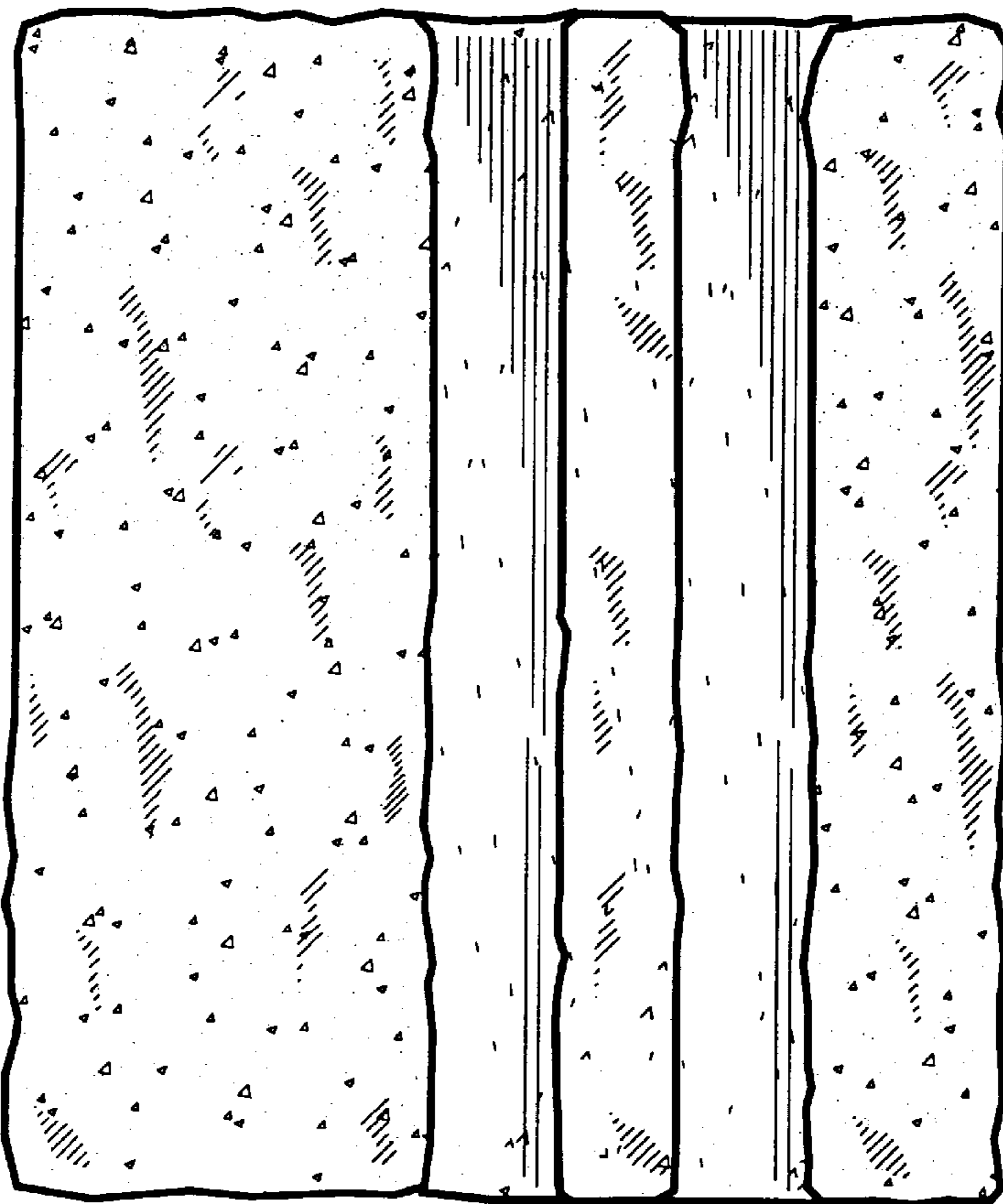

FIG. 2

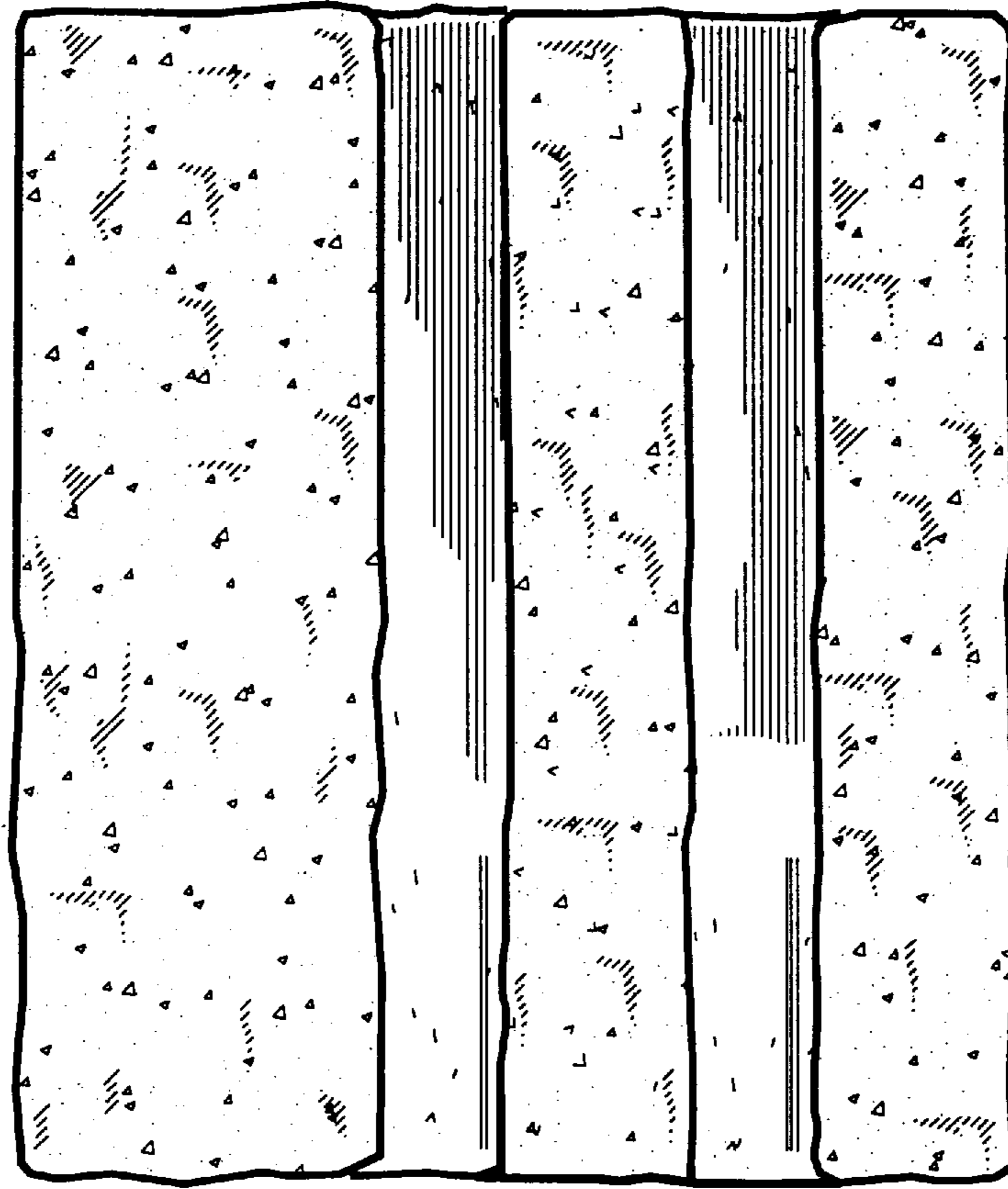

FIG. 3

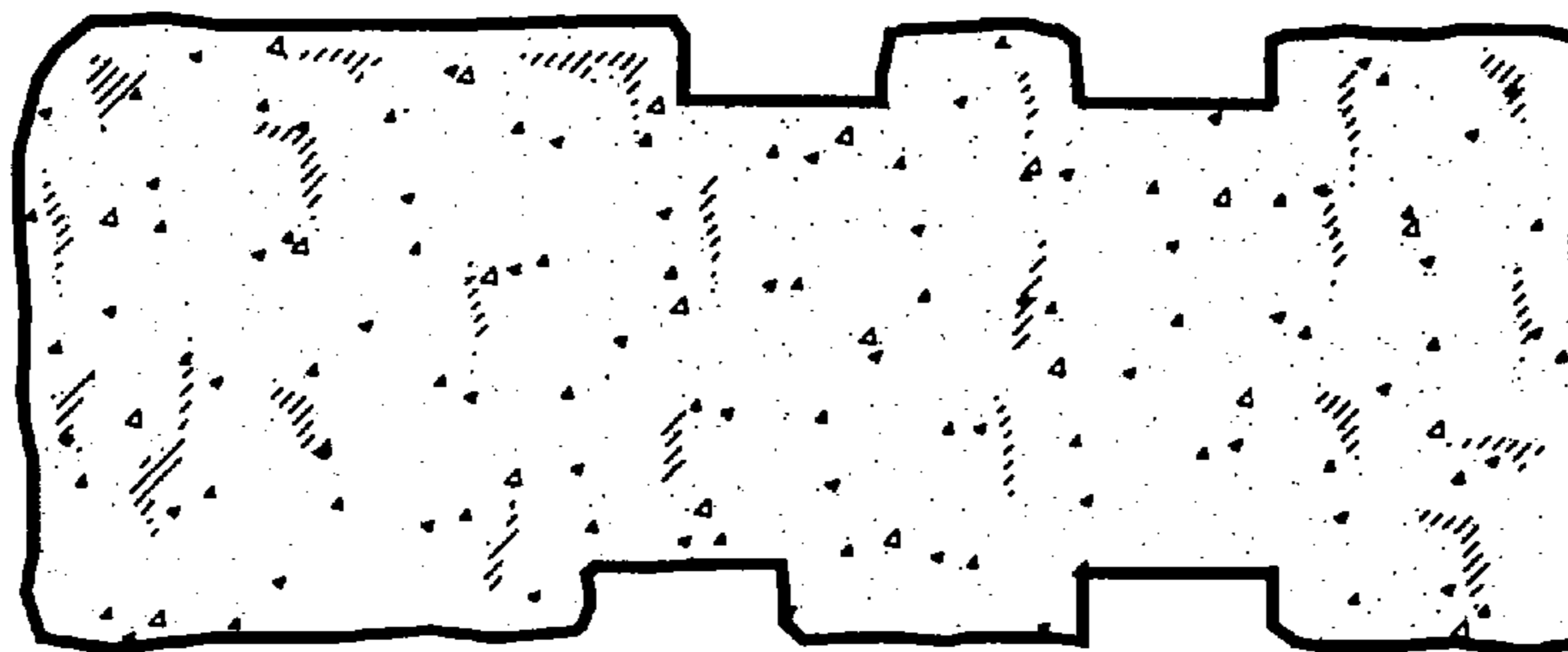

FIG. 4

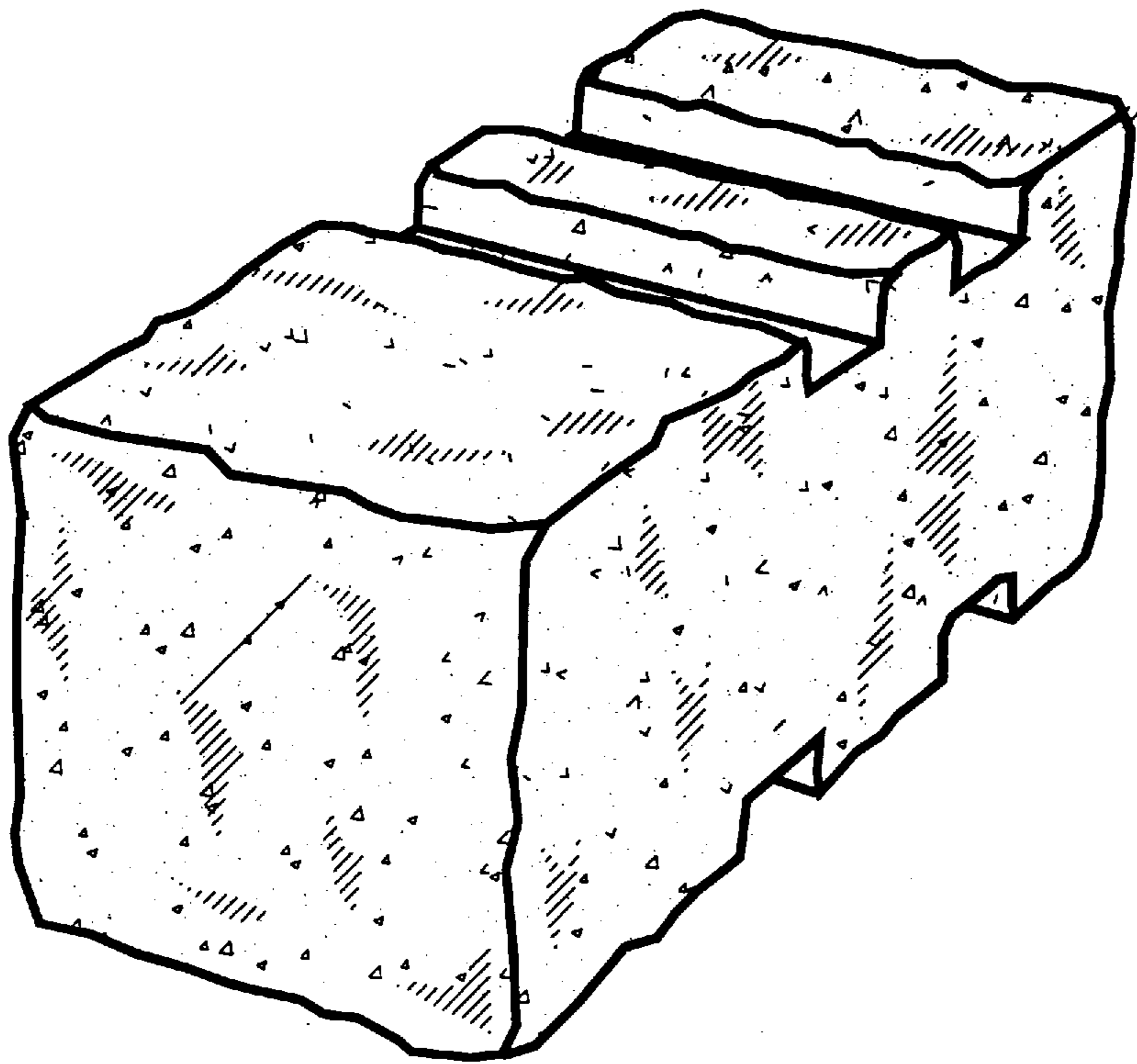

FIG. 5

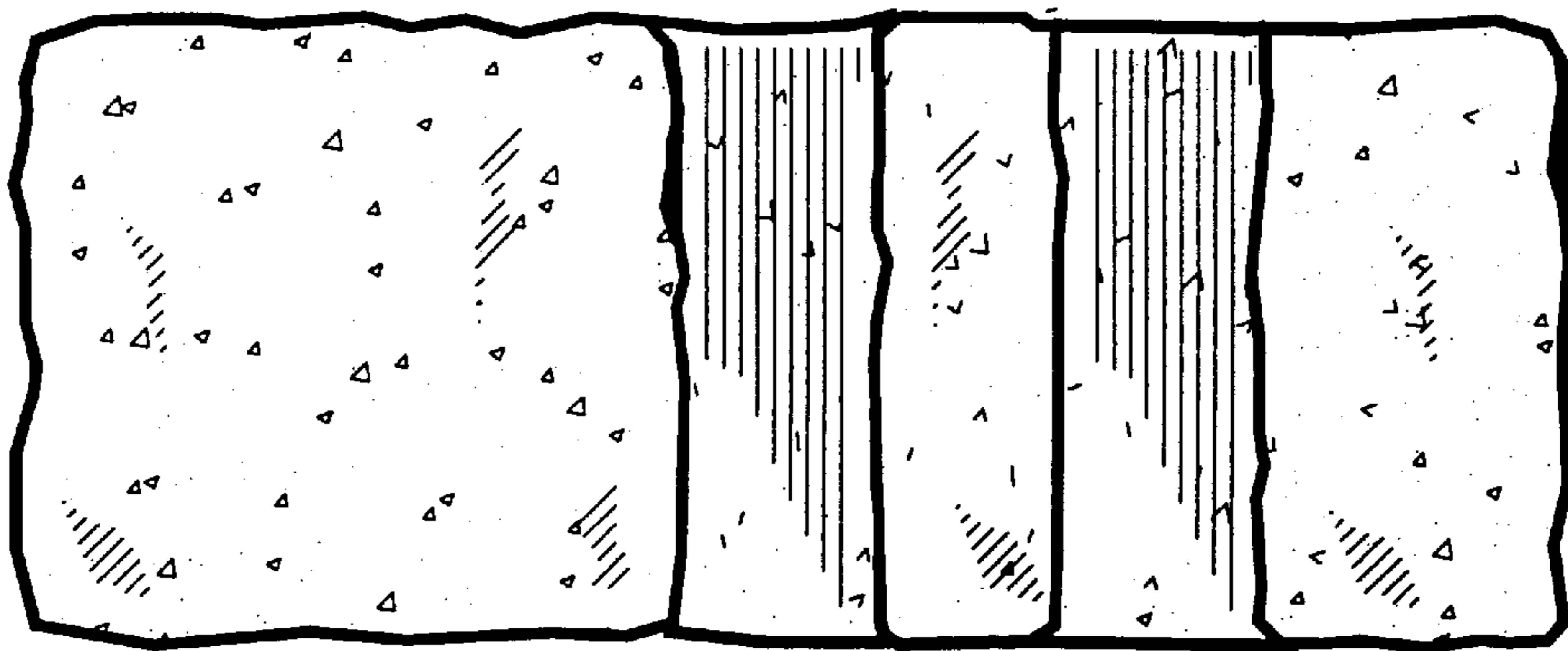

FIG. 6

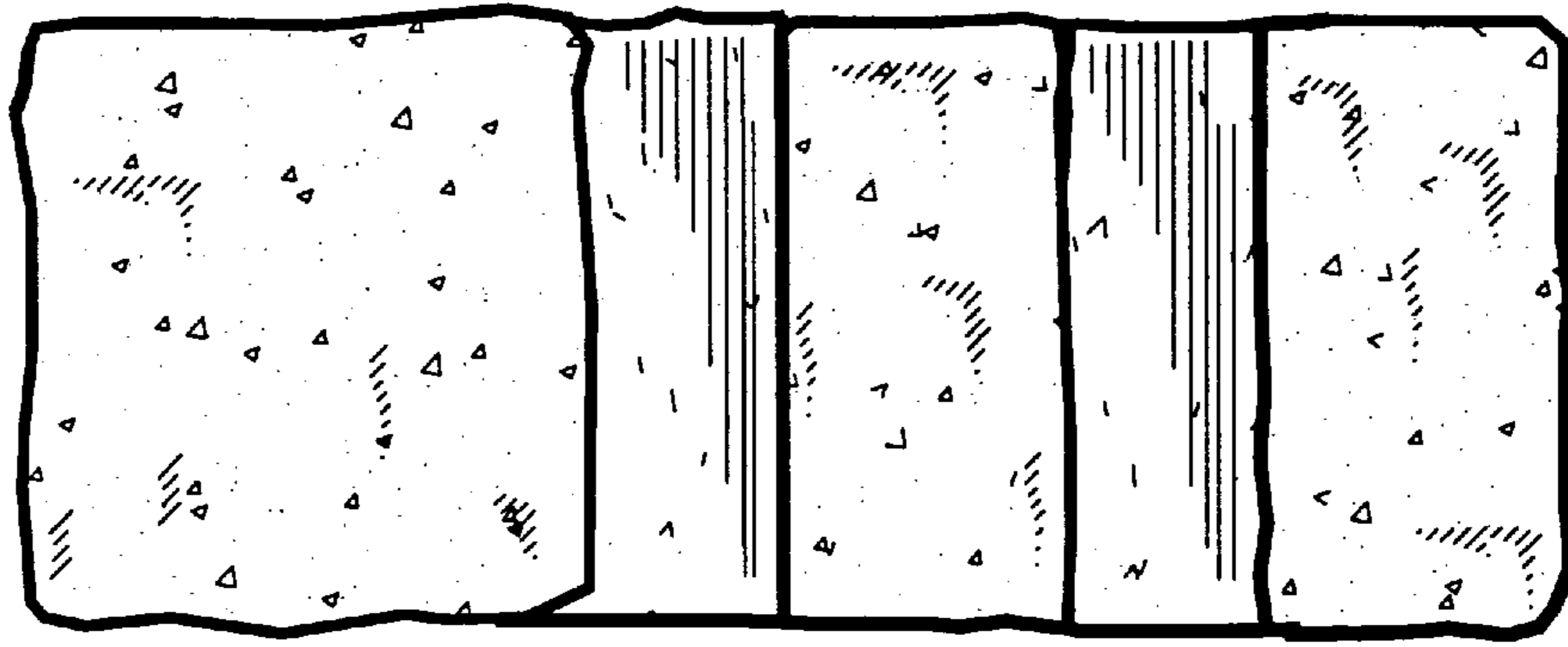

FIG. 7

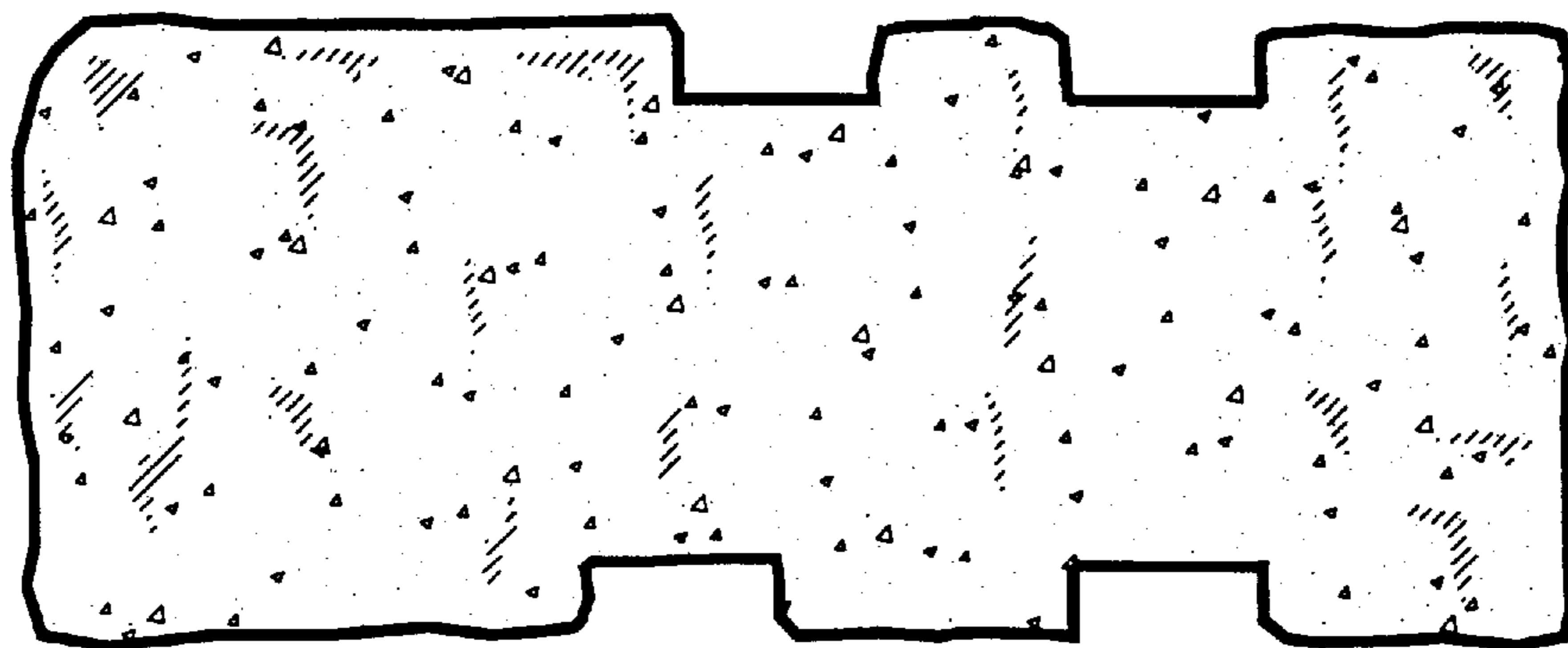

FIG. 8