



US00D404464S

United States Patent [19]
Niemczyk

[11] **Patent Number: Des. 404,464**

[45] **Date of Patent: **Jan. 19, 1999**

[54] **GAS CYLINDER VALVE BODY**

*Attorney, Agent, or Firm—*Reising, Ethington, Learman & McCulloch

[76] Inventor: **Andrew Niemczyk**, 11376 Sobieski St., Hamtramck, Mich. 48212

[57] **CLAIM**

[**] Term: **14 Years**

The ornamental design for a gas cylinder valve body, as shown and described.

[21] Appl. No.: **65,056**

DESCRIPTION

[22] Filed: **Jan. 17, 1997**

[51] **LOC (6) Cl.** **23-01**

FIG. 1 is a top perspective view of a gas cylinder valve body showing my new design;

[52] **U.S. Cl.** **D23/233**

FIG. 2 is a front elevational view thereof;

[58] **Field of Search** D23/233, 235, D23/245, 247, 248; 251/304, 366, 542, 352, 349

FIG. 3 is a side elevational view thereof, the opposite side elevational view being identical;

[56] **References Cited**

FIG. 4 is a rear elevational view thereof;

U.S. PATENT DOCUMENTS

FIG. 5 is a top plan view thereof; and,

D. 96,691 8/1935 Nelson D23/233

FIG. 6 is a bottom plan view thereof.

D. 321,241 10/1991 Ingle D23/235

The broken line is a representation of a valve stem and the closure nut in FIGS. 1, 2, 3, and 4 is for purposes of illustration only and forms no part of the claimed design.

D. 363,762 10/1995 Pingel et al. D23/233

*Primary Examiner—*Alan P. Douglas

1 Claim, 1 Drawing Sheet

*Assistant Examiner—*Robin V. Taylor

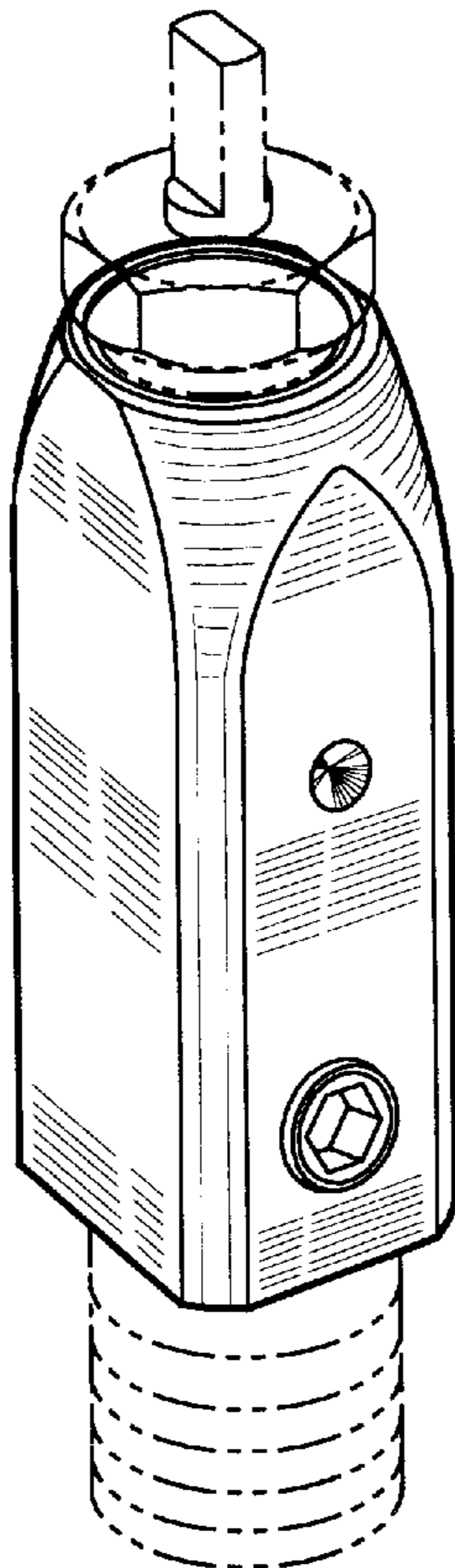

Fig-1

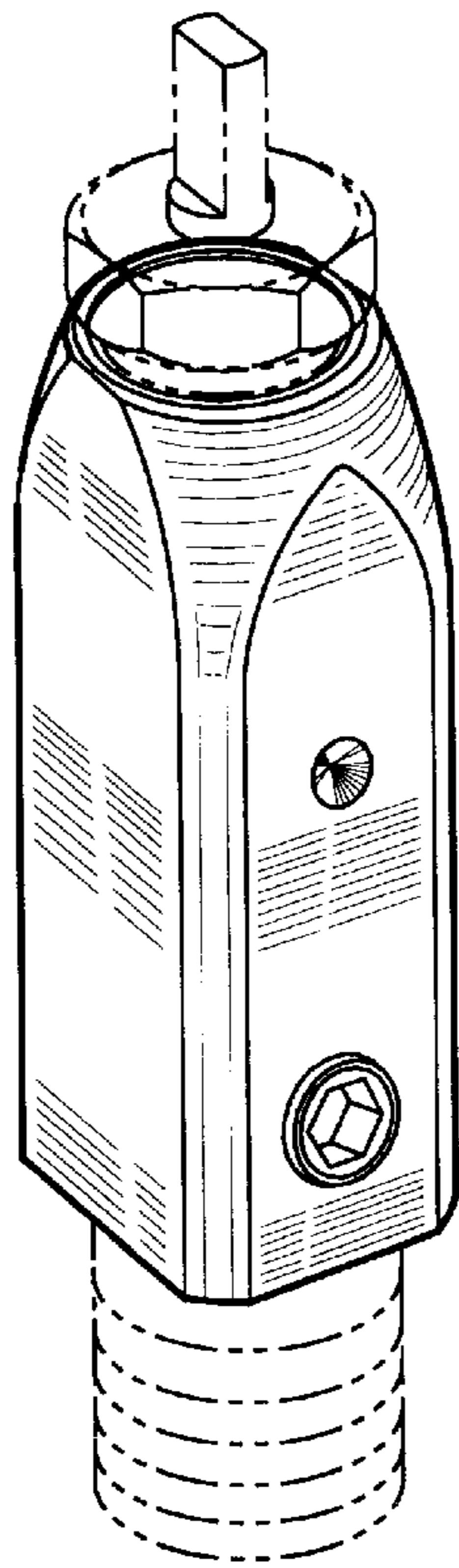

Fig-5

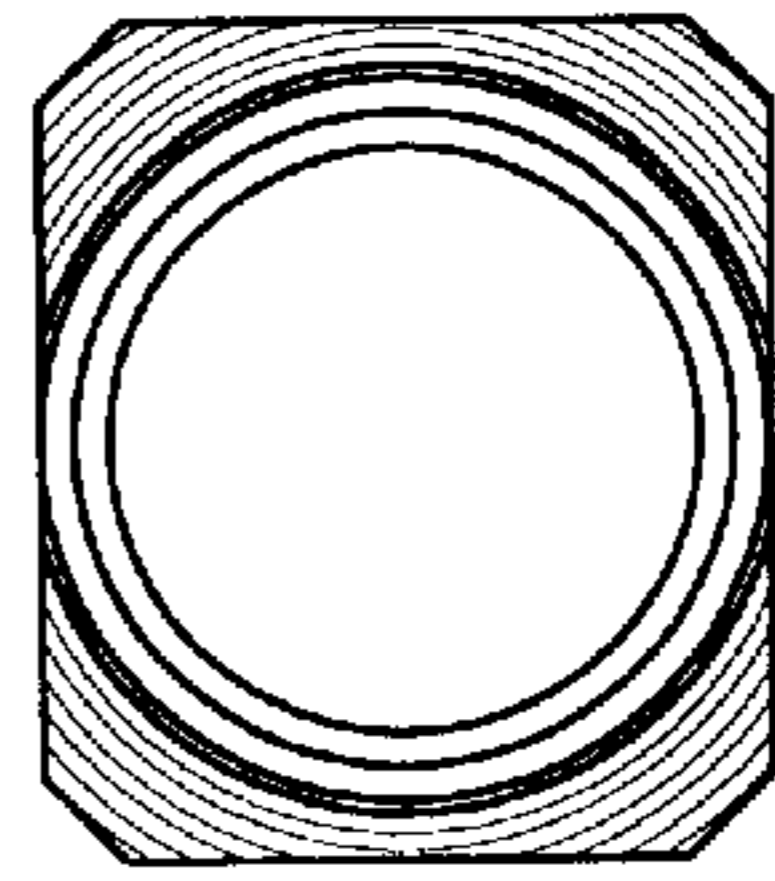

Fig-6

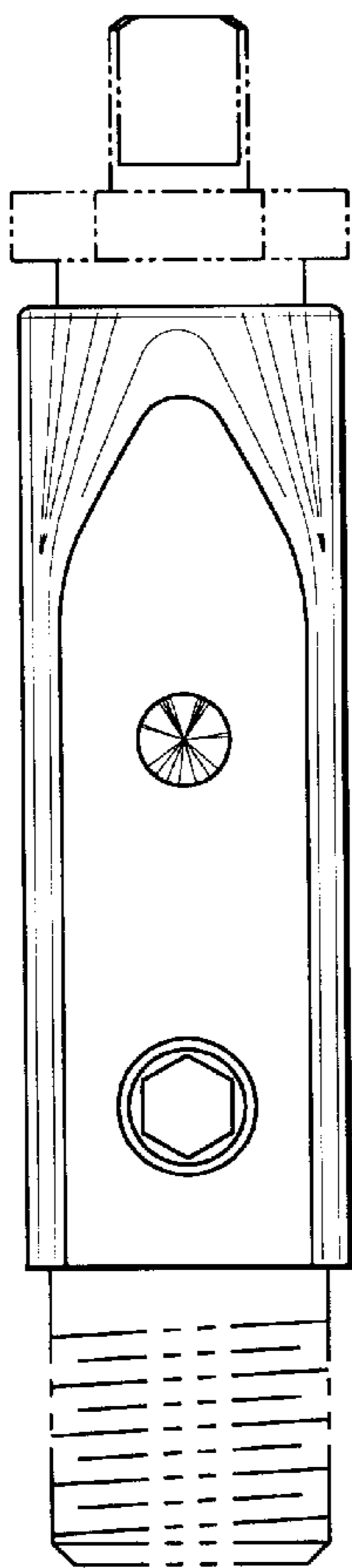
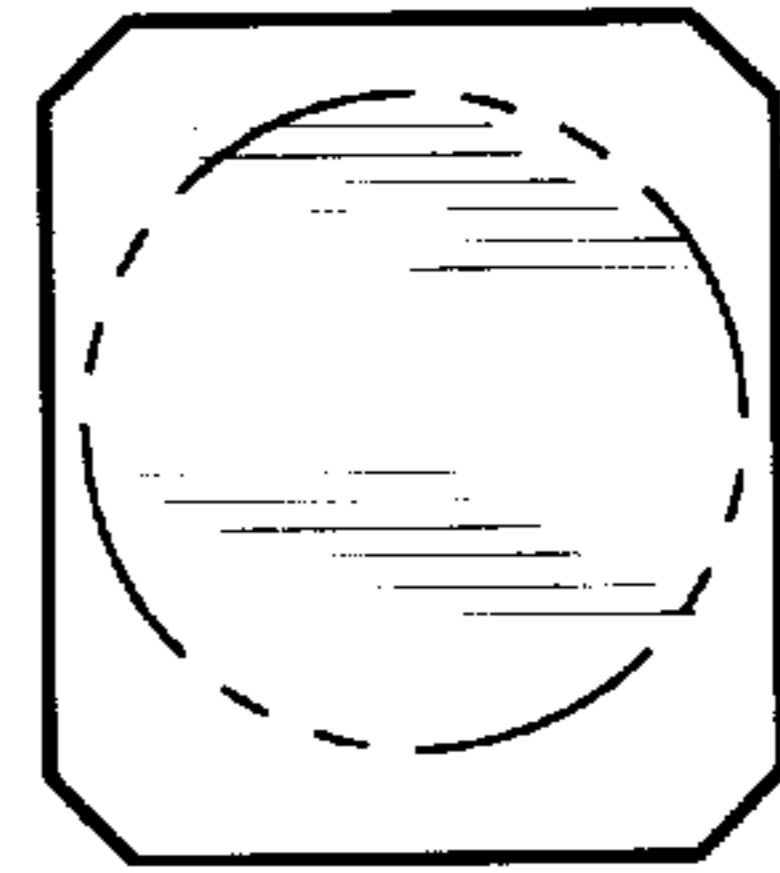

Fig-2

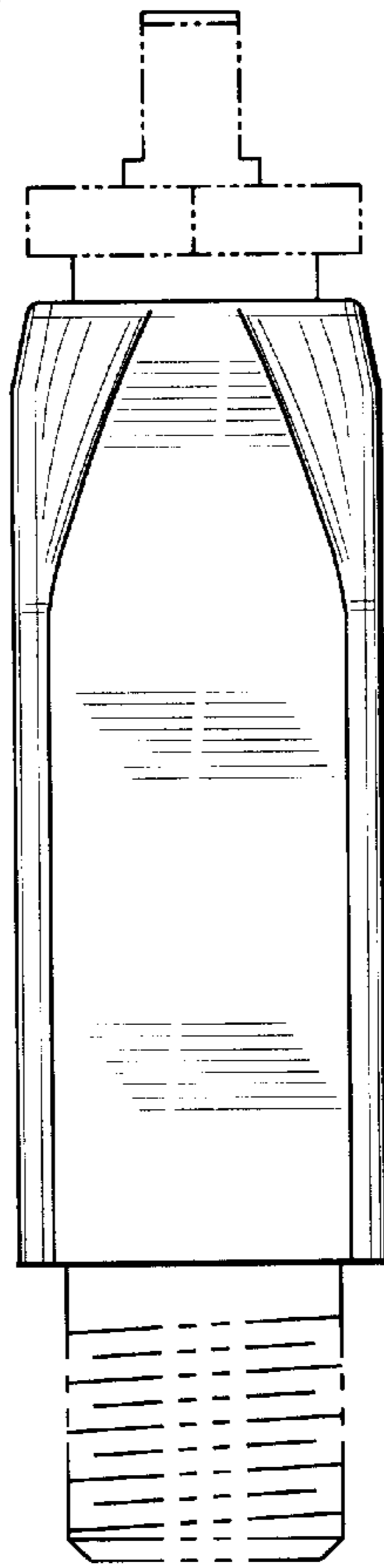

Fig-3

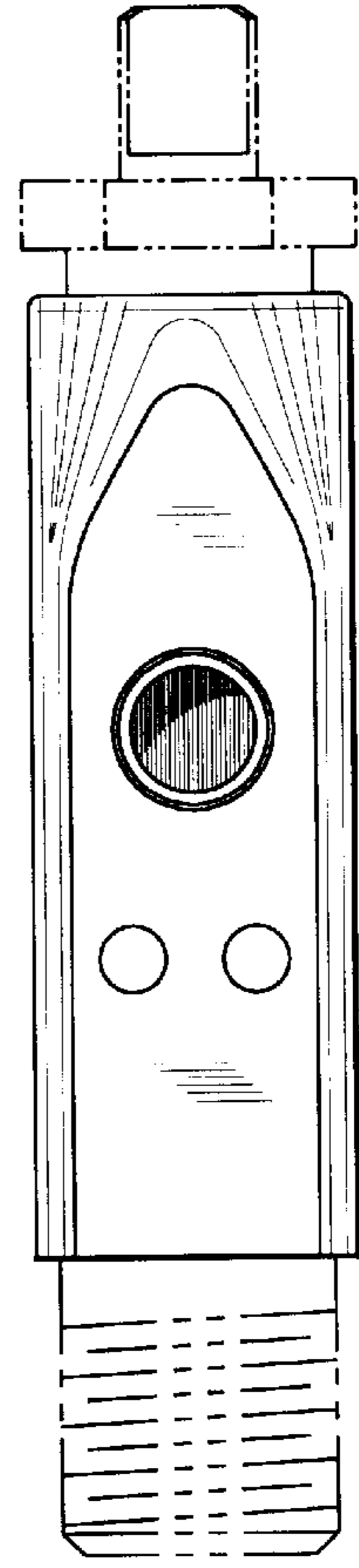

Fig-4