



US00D402538S

United States Patent [19]

Wagter et al.

[11] **Patent Number: Des. 402,538**

[45] **Date of Patent: **Dec. 15, 1998**

[54] **CABLE ROLLER**

[75] Inventors: **Hendrik Sjik Wagter**, Utrecht; **Ralph Stuyver**, Den Haag; **Joop Hakker**, Soest, all of Netherlands

[73] Assignee: **InnoEssentials International B.V.**, Capelle aan den IJssel, Netherlands

[**] Term: **14 Years**

[21] Appl. No.: **59,068**

[22] Filed: **Sep. 3, 1996**

[30] **Foreign Application Priority Data**

Mar. 1, 1996 [WO] WIPO DM/035733

[51] **LOC (6) Cl.** **08-05**

[52] **U.S. Cl.** **D8/358; D8/356**

[58] **Field of Search** D8/356, 358; D13/140; 242/395, 405.3, 403.1, 608.1

[56] **References Cited**

U.S. PATENT DOCUMENTS

D. 195,463 6/1963 Tamarin D13/140

D. 309,094 7/1990 Donis et al. D8/354
D. 331,440 12/1992 Smith D8/349 X
3,809,331 5/1974 Gaul .
5,086,988 2/1992 LaPoint et al. .

Primary Examiner—Susan J. Lucas
Assistant Examiner—Cynthia E. Ramirez
Attorney, Agent, or Firm—Marshall, O’Toole, Gerstein, Murray & Borun

[57] **CLAIM**

The ornamental design for a cable roller, as shown and described.

DESCRIPTION

FIG. 1 is a front view;
FIG. 2 is a top plan view;
FIG. 3 is a rear view;
FIG. 4 is a bottom view;
FIG. 5 is a right side view;
FIG. 6 is a left side view; and,
FIG. 7 is a perspective view of the cable roller, in which the two shell-like house parts are rotated with respect to each other.

1 Claim, 2 Drawing Sheets

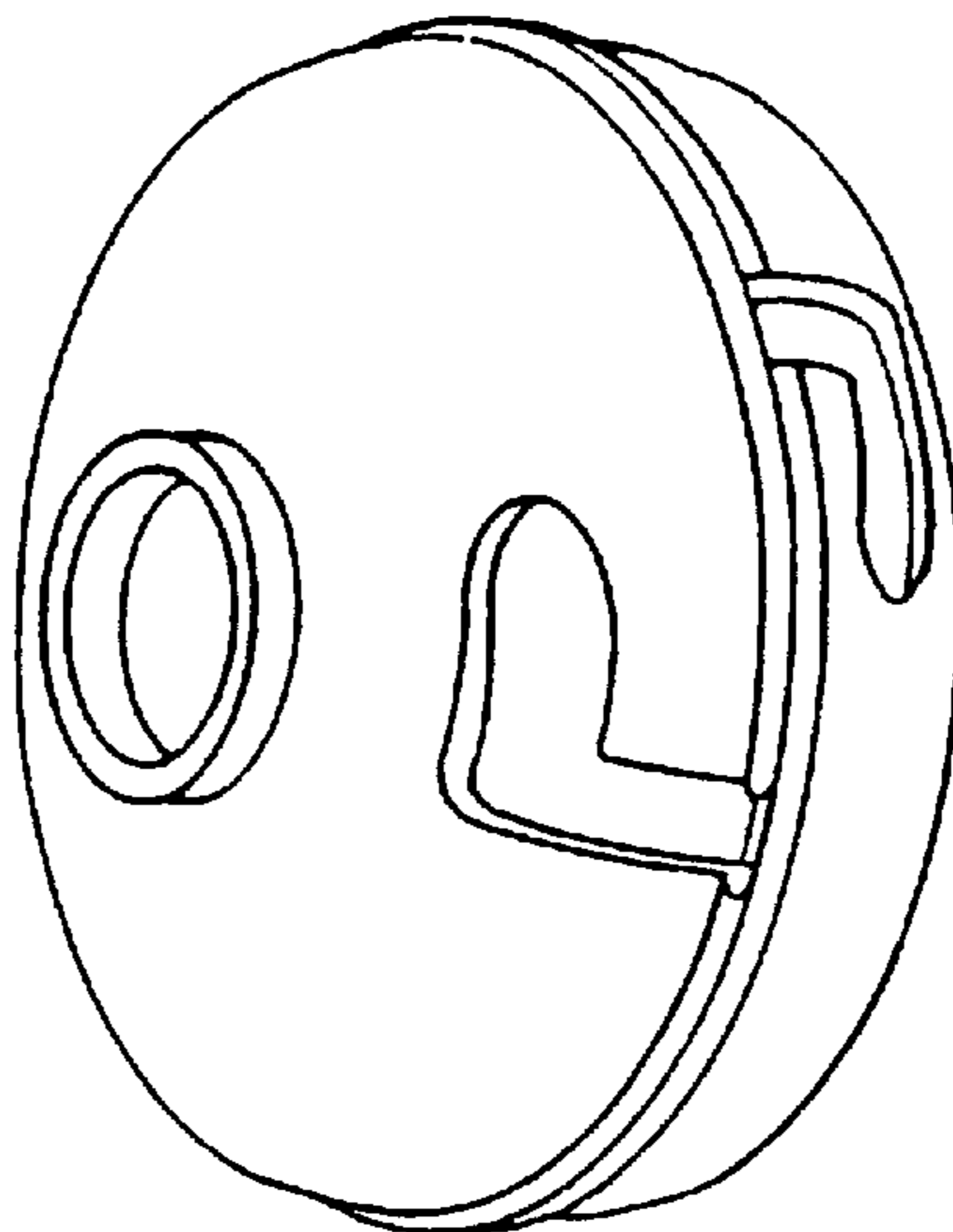

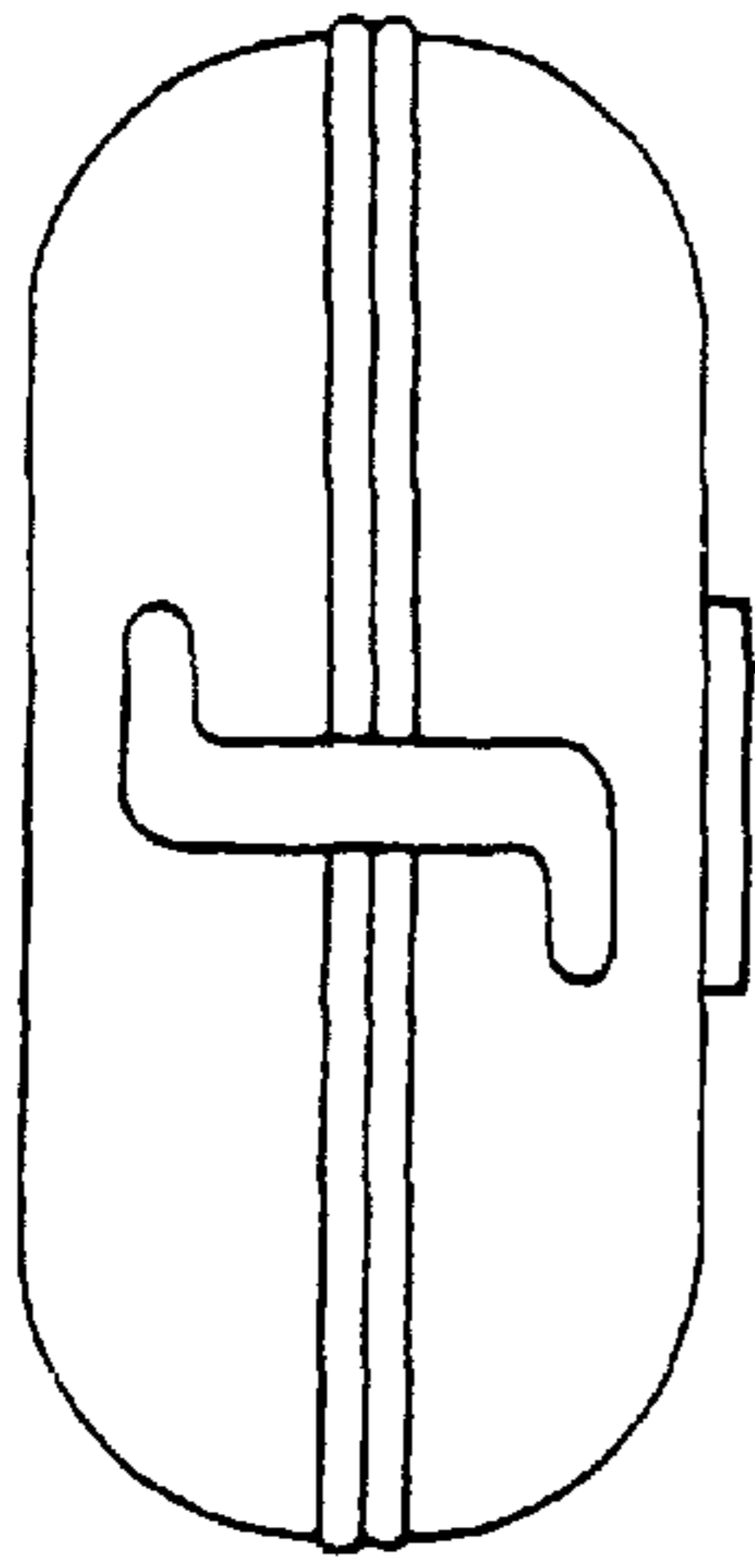

Fig. 1

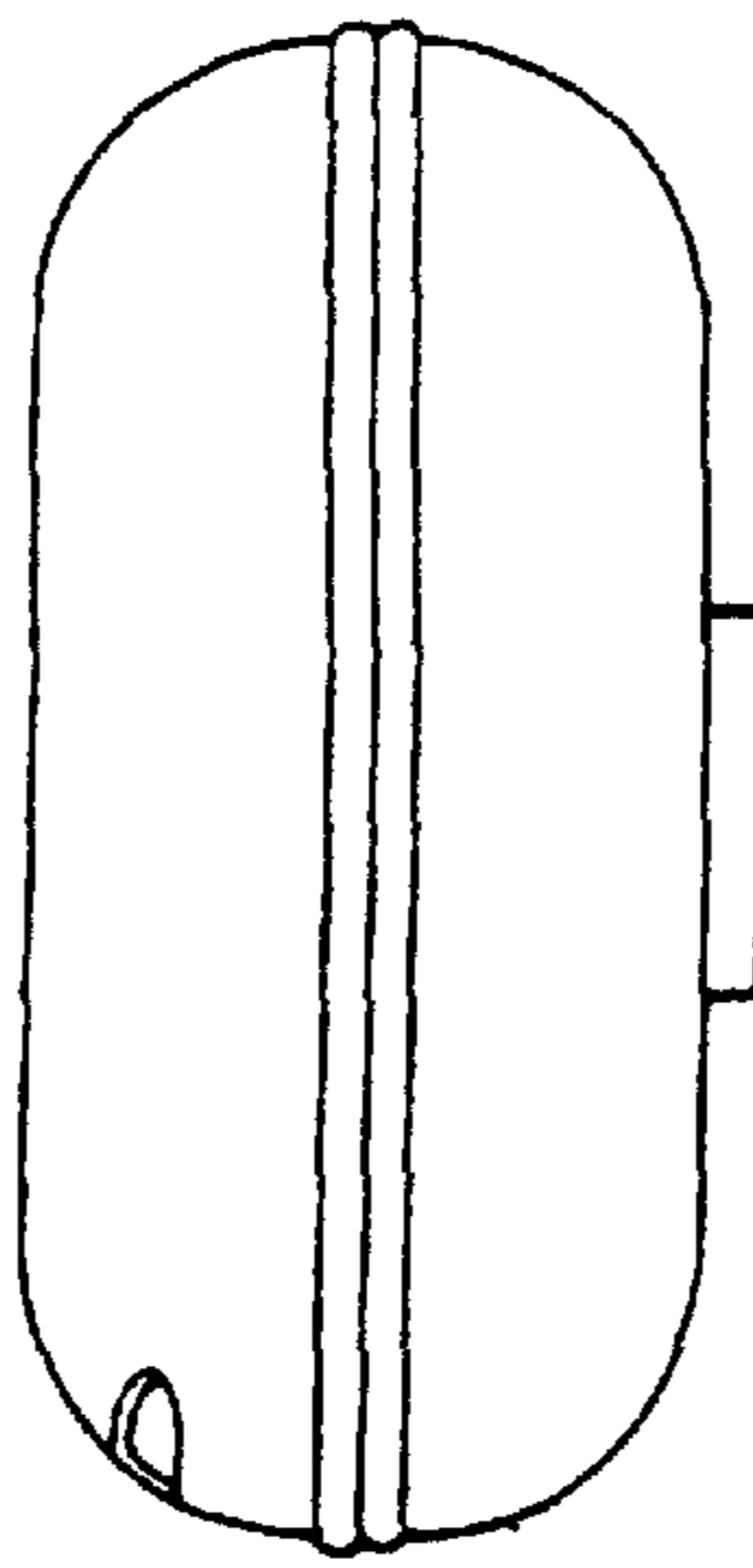

Fig. 2

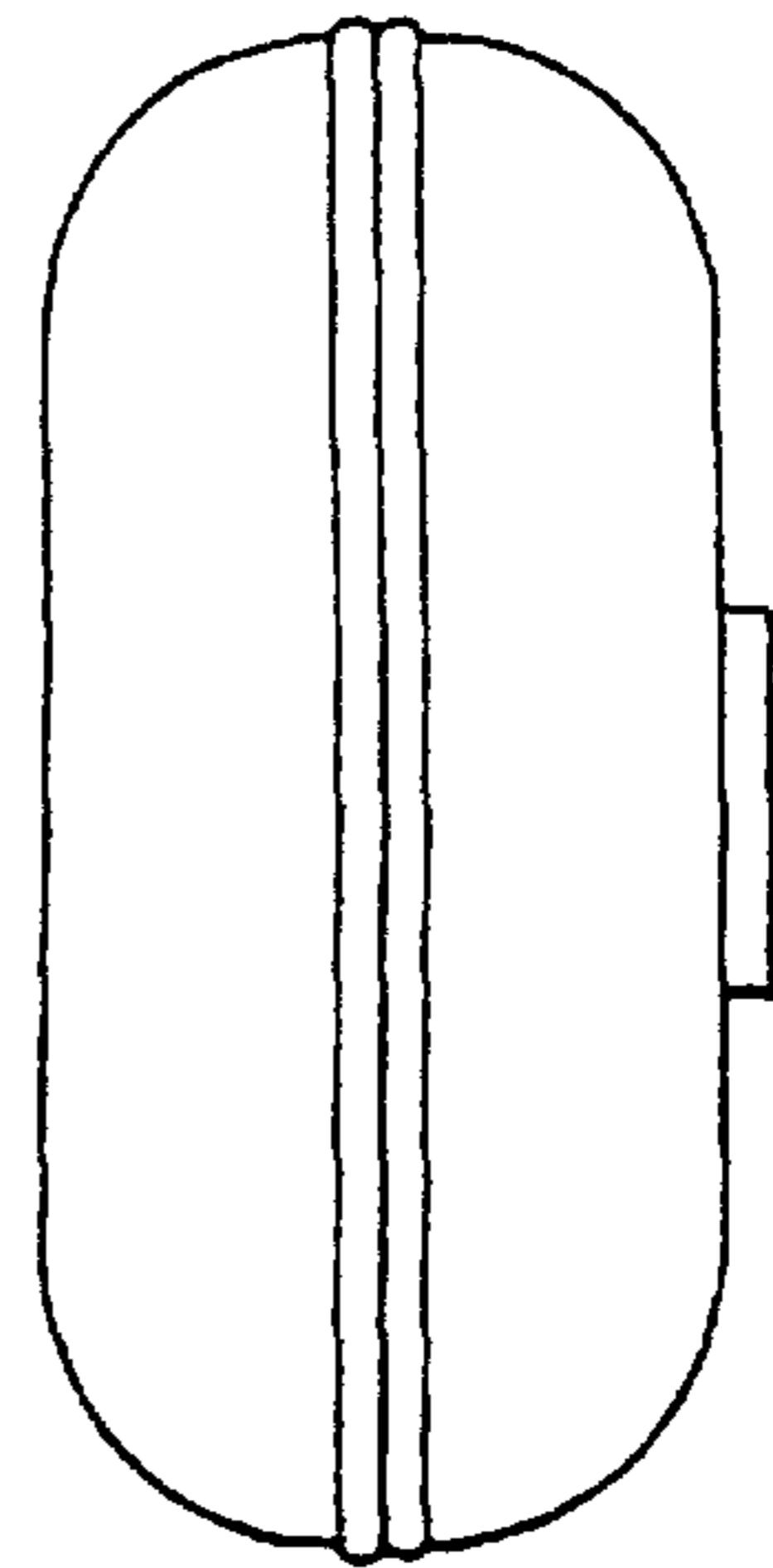

Fig. 3

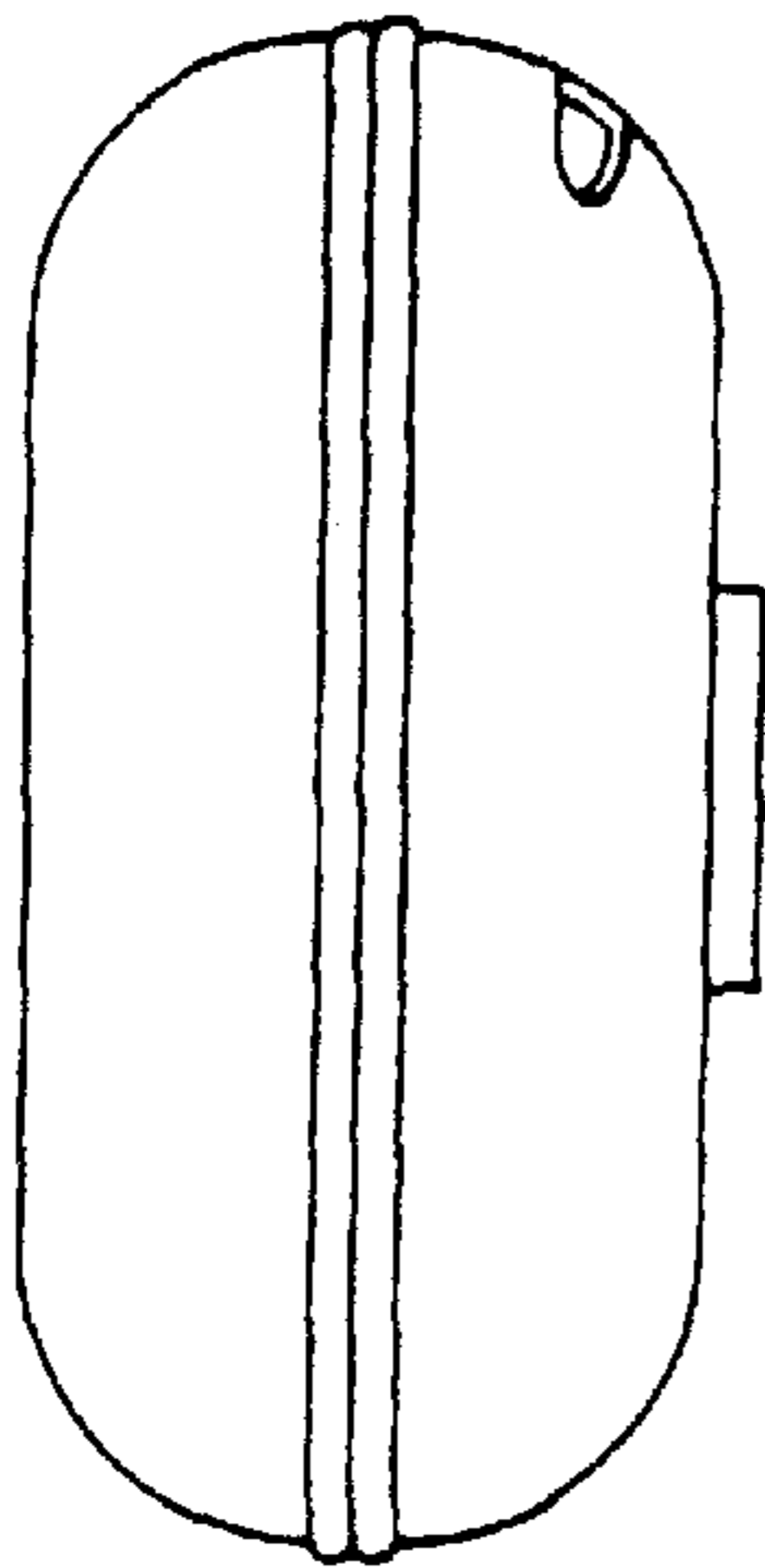

Fig. 4

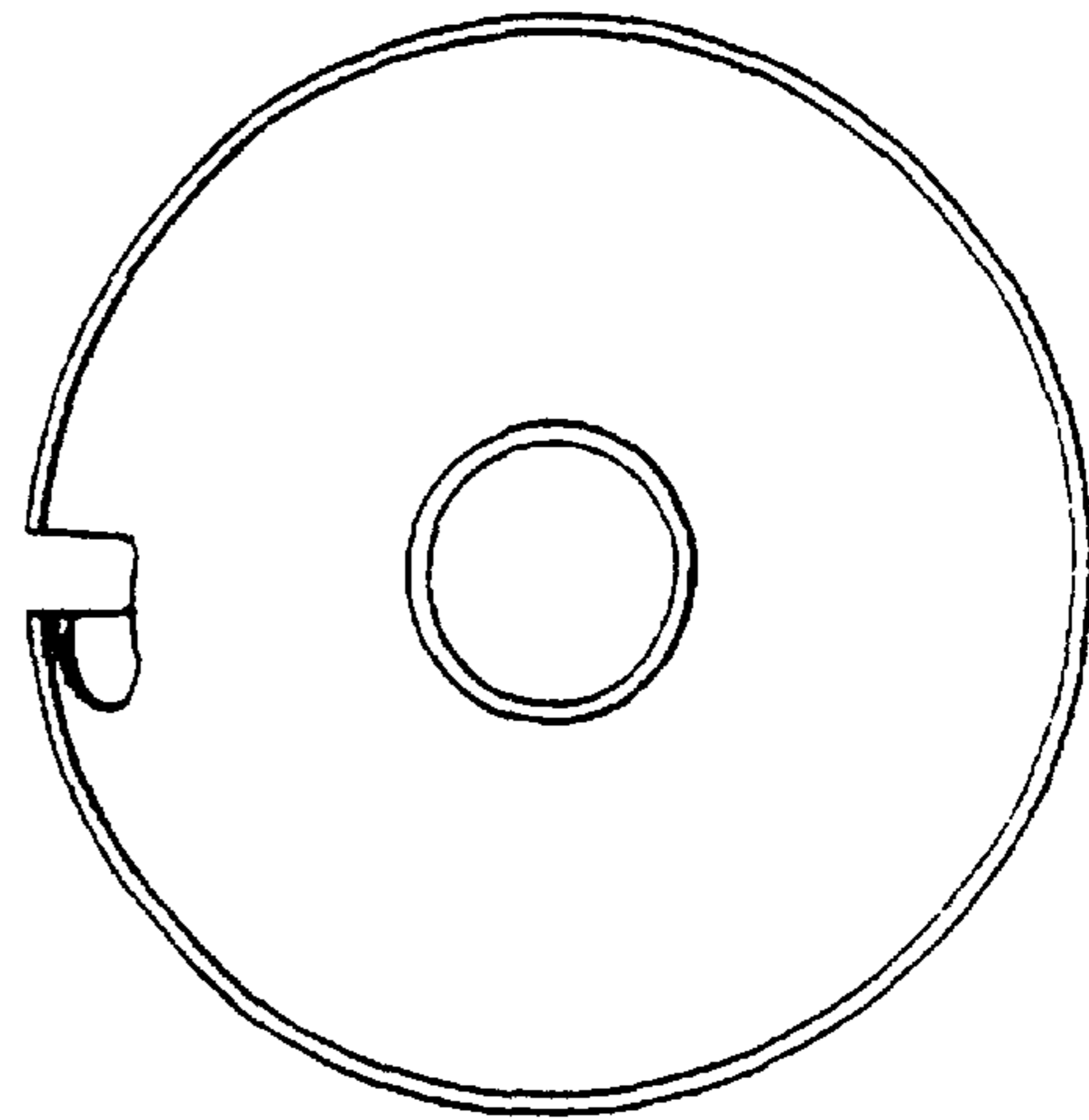

Fig. 5

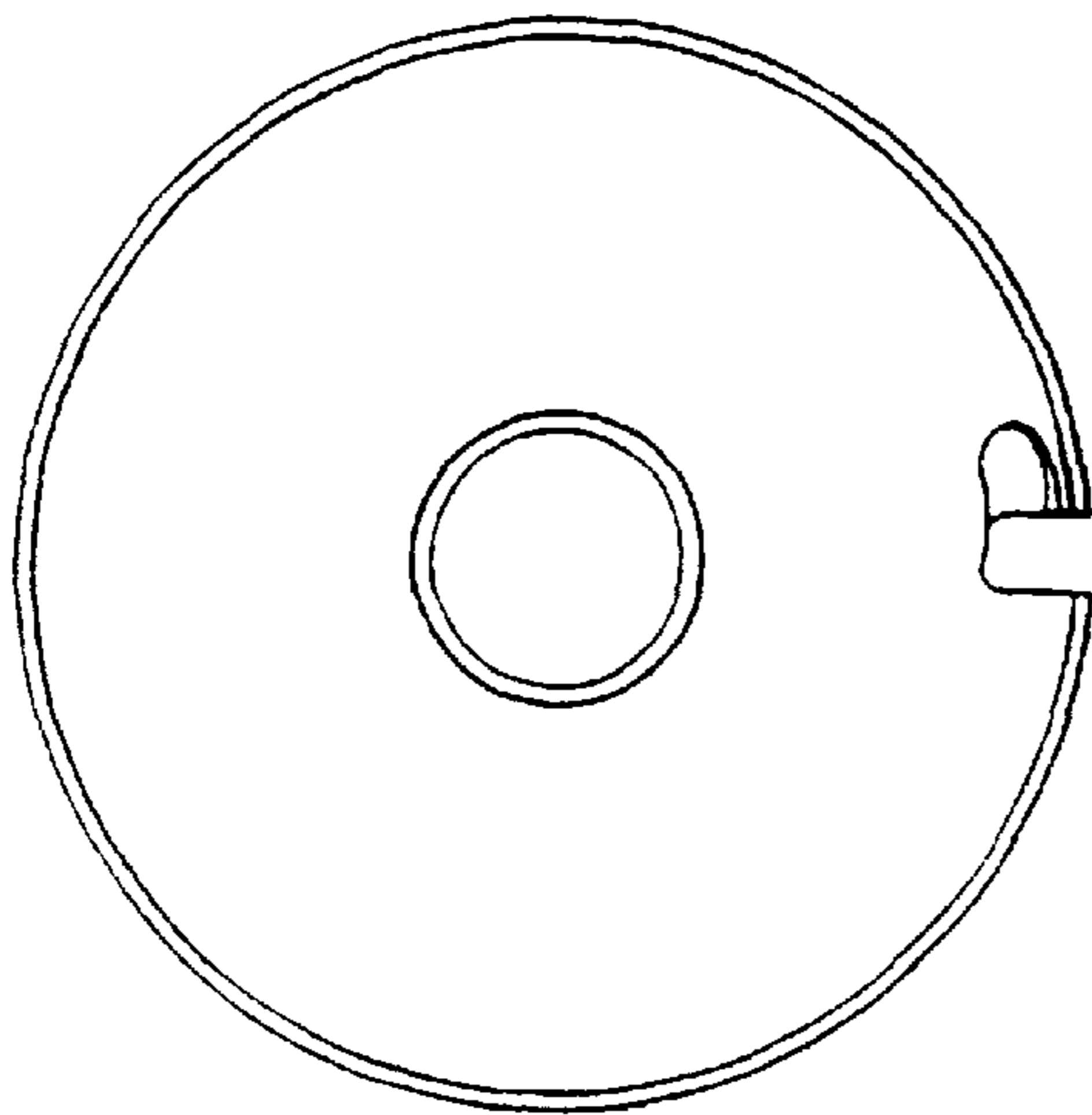

Fig. 6

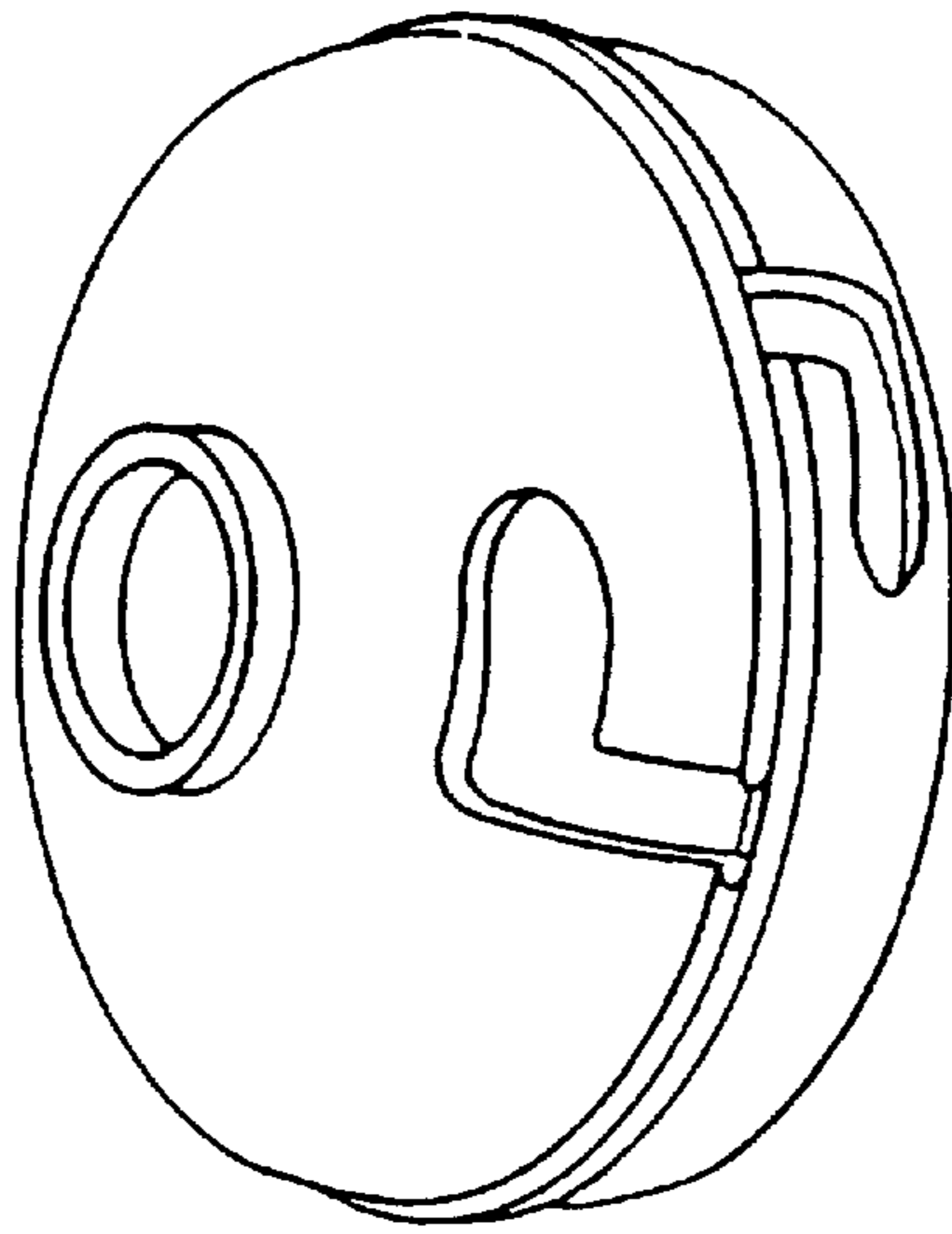

Fig. 7