



US00D402084S

United States Patent [19]

Chen et al.

[11] **Patent Number:** **Des. 402,084**

[45] **Date of Patent:** ****Dec. 1, 1998**

[54] **GUARD BAR**

[75] Inventors: **Evan Chen**, Fairfield; **Ernest Ortiz**,
Cheshire, both of Conn.

[73] Assignee: **Warner Lambert Co.**, Morris Plains,
N.J.

[**] Term: **14 Years**

[21] Appl. No.: **47,047**

[22] Filed: **Jun. 22, 1995**

[51] **LOC (6) Cl.** **28-03**

[52] **U.S. Cl.** **D28/47**

[58] **Field of Search** D28/46, 47, 32,
D28/34.2; 30/48-51, 77, 81-83

[56] **References Cited**

U.S. PATENT DOCUMENTS

D. 142,950	11/1945	Dudas	D28/46
D. 231,050	3/1974	Gray	D28/46
2,068,085	1/1937	Stanley	.	
2,300,794	11/1942	Martin	.	
2,374,612	4/1945	Mellon	.	
2,548,959	4/1951	Eisenberg, et al.	.	
2,568,047	9/1951	Anderson	.	
2,766,521	10/1956	Benvenuti	.	
2,817,146	12/1957	Roberts	.	
3,138,865	6/1964	Meyer	.	
3,722,090	3/1973	Dawidowicz	.	
3,909,939	10/1975	Dootson	.	
4,189,832	2/1980	Harper et al.	.	
4,310,968	1/1982	Buik et al.	.	
4,443,939	4/1984	Motta et al.	30/81 X

4,741,103	5/1988	Hultman	.	
5,141,694	8/1992	Butlin et al.	.	
5,185,927	2/1993	Rivers	.	
5,191,712	3/1993	Crook et al.	.	
5,249,361	10/1993	Apprille et al.	.	
5,590,468	1/1997	Prochaska	30/50 X

FOREIGN PATENT DOCUMENTS

0254491	7/1987	European Pat. Off.	.	
348866	1/1990	European Pat. Off.	30/52
2323502	9/1976	France	.	
M 9402713	10/1994	Germany	28/3
1557177	12/1979	United Kingdom	.	

Primary Examiner—Philip S. Hyder
Assistant Examiner—C. Tuttle
Attorney, Agent, or Firm—Charles E. Almer, III

[57] CLAIM

The ornamental design for a guard bar, as shown and described.

DESCRIPTION

FIG. 1 is a top, front and right perspective view of the guard bar, the undisclosed left end being a mirror image of the right end shown;
FIG. 2 is a perspective view of the guard bar in place on a razor head;
FIG. 3 is a side view thereof;
FIG. 4 is a top view thereof; and,
FIG. 5 is a frontal view thereof.
The broken line showing of the razor head is for illustrative purposes only and forms no part of the claimed design.

1 Claim, 4 Drawing Sheets

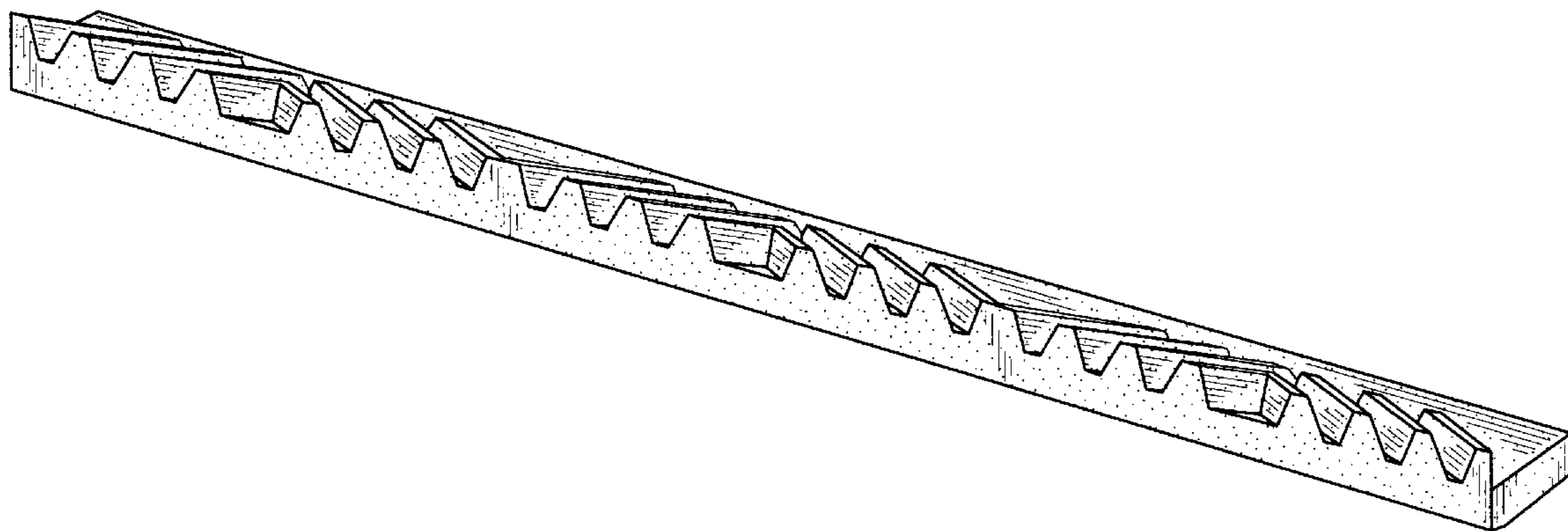

FIG-1

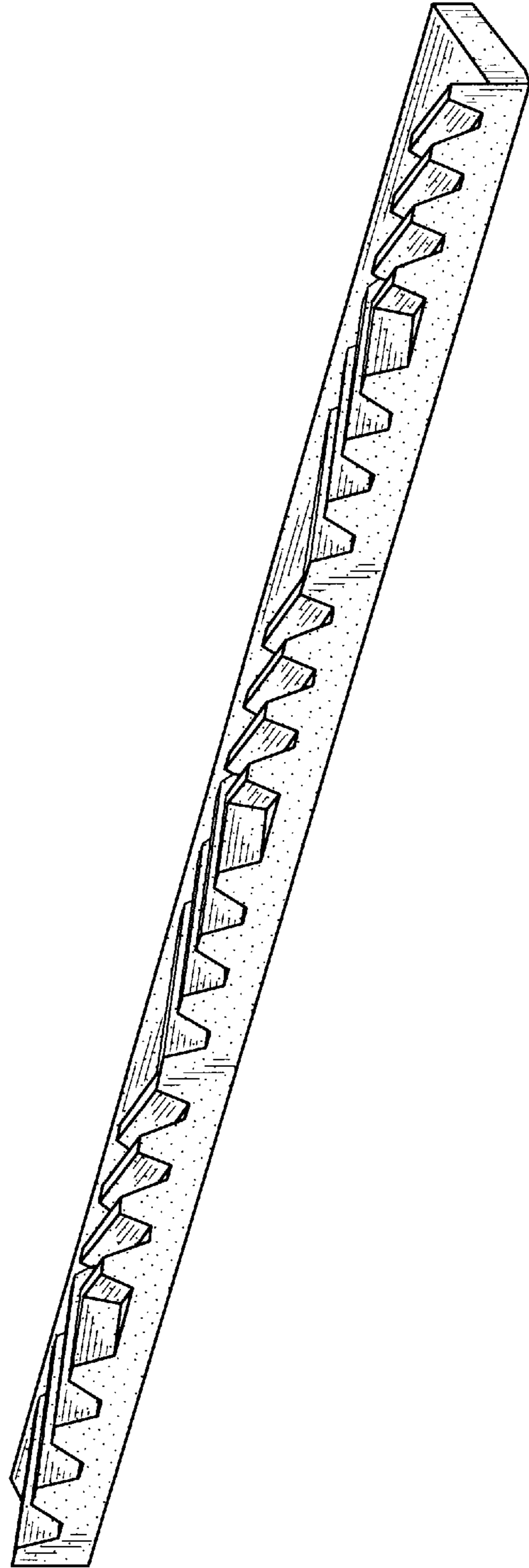

FIG-2

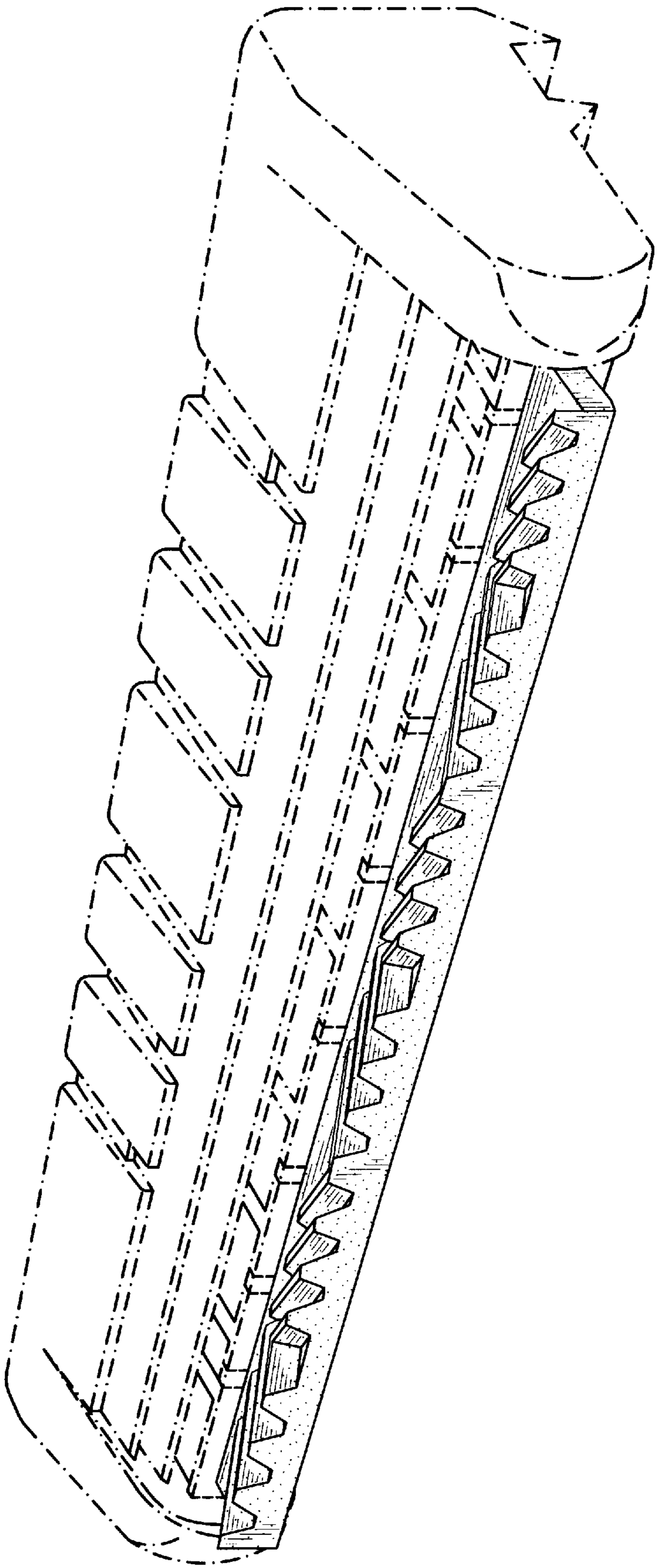

FIG-3

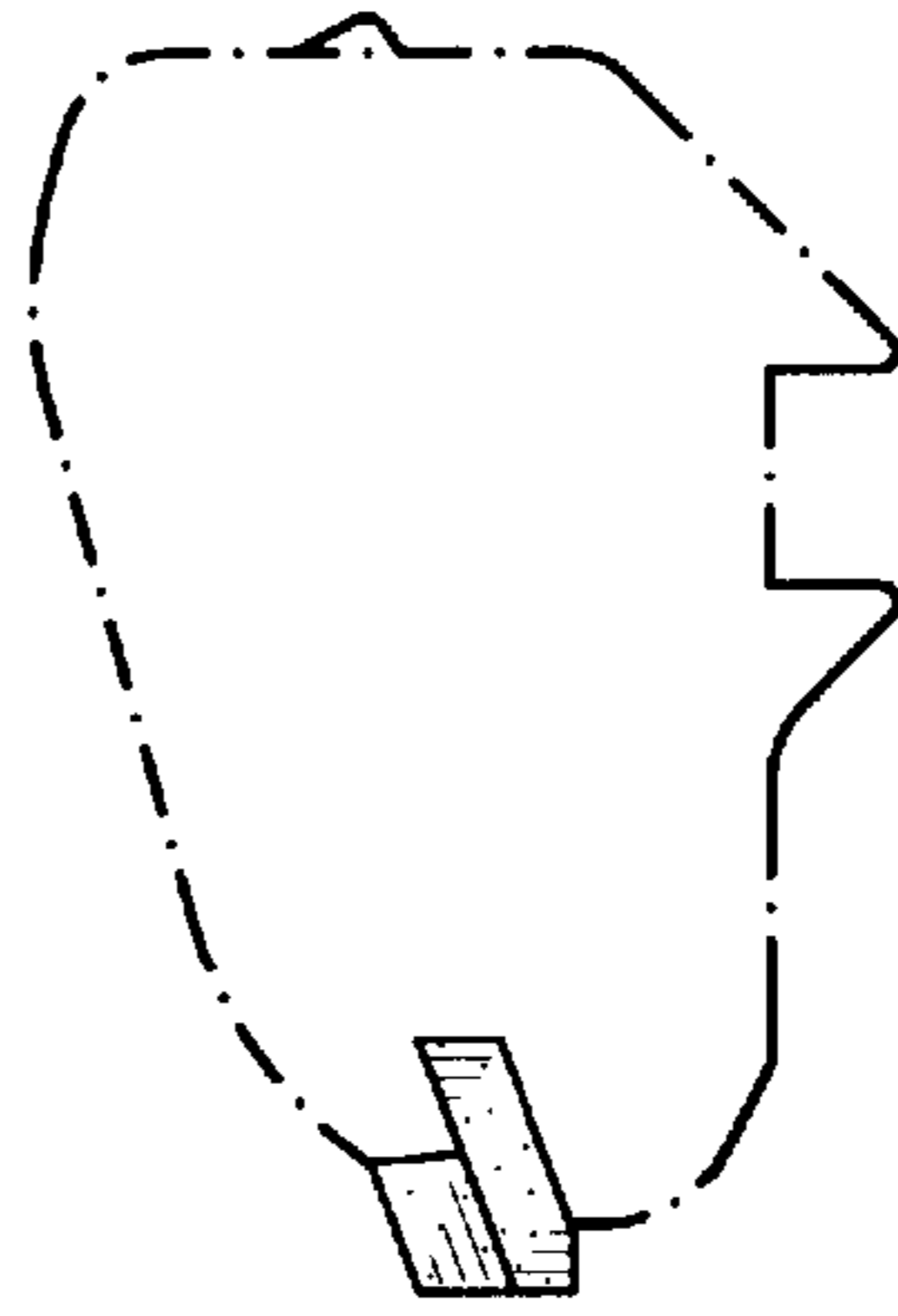

FIG-4

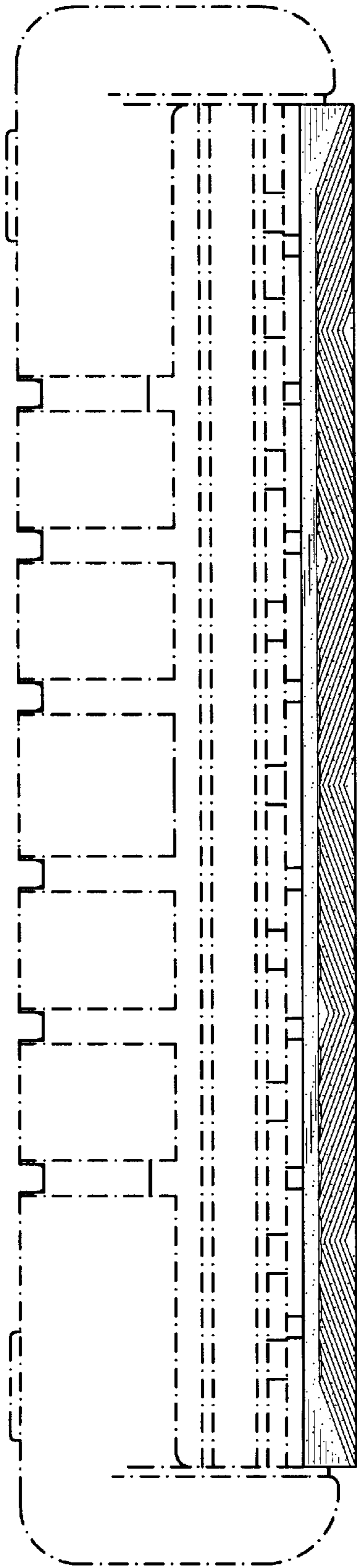

FIG-5

