



US00D398585S

# United States Patent [19]

Richman et al.

[11] Patent Number: **Des. 398,585**

[45] Date of Patent: **\*\*Sep. 22, 1998**

[54] **PROCESS CONTROL MODULE**

[75] Inventors: **Lonnie J. Richman**, Painesville;  
**Leonard R. Polinski, Jr.**, deceased, late  
of Lakewood, both of Ohio, by Carol  
Polinski, legal representative

[73] Assignee: **Elsag International N.V.**, Amsterdam,  
Netherlands

[\*\*] Term: **14 Years**

[21] Appl. No.: **75,805**

[22] Filed: **Aug. 22, 1997**

[51] **LOC (6) Cl.** ..... **13-03**

[52] **U.S. Cl.** ..... **D13/162**

[58] **Field of Search** ..... D13/162, 184;  
D14/100, 114; 361/600, 601, 622, 625-627,  
679, 728-730

[56] **References Cited**

**U.S. PATENT DOCUMENTS**

- D. 274,615 7/1984 Bean et al. .... D13/162
- D. 307,741 5/1990 Gilbert ..... D13/162

- D. 329,843 9/1992 Ishida ..... D13/162
- D. 337,753 7/1993 Ito et al. .... D13/162
- D. 340,698 10/1993 Nystrom ..... D13/162
- D. 375,084 10/1996 Hamada ..... D13/162
- D. 384,037 9/1997 Hamada ..... D13/162
- D. 384,938 10/1997 Hamada et al. .... D13/162
- 4,532,952 8/1985 Norwood ..... 361/600 X

*Primary Examiner*—Brian N. Vinson  
*Attorney, Agent, or Firm*—Michael M. Rickin

[57] **CLAIM**

The ornamental design for a process control module, as shown.

**DESCRIPTION**

FIG. 1 is a top, front and right side perspective view of the process control module showing our new design; FIG. 2 is a front elevational view thereof; FIG. 3 is a rear elevational view thereof; FIG. 4 is a top plan view thereof; FIG. 5 is a bottom plan view thereof; FIG. 6 is a right side elevational view thereof; and, FIG. 7 is a left side elevational view thereof.

**1 Claim, 4 Drawing Sheets**

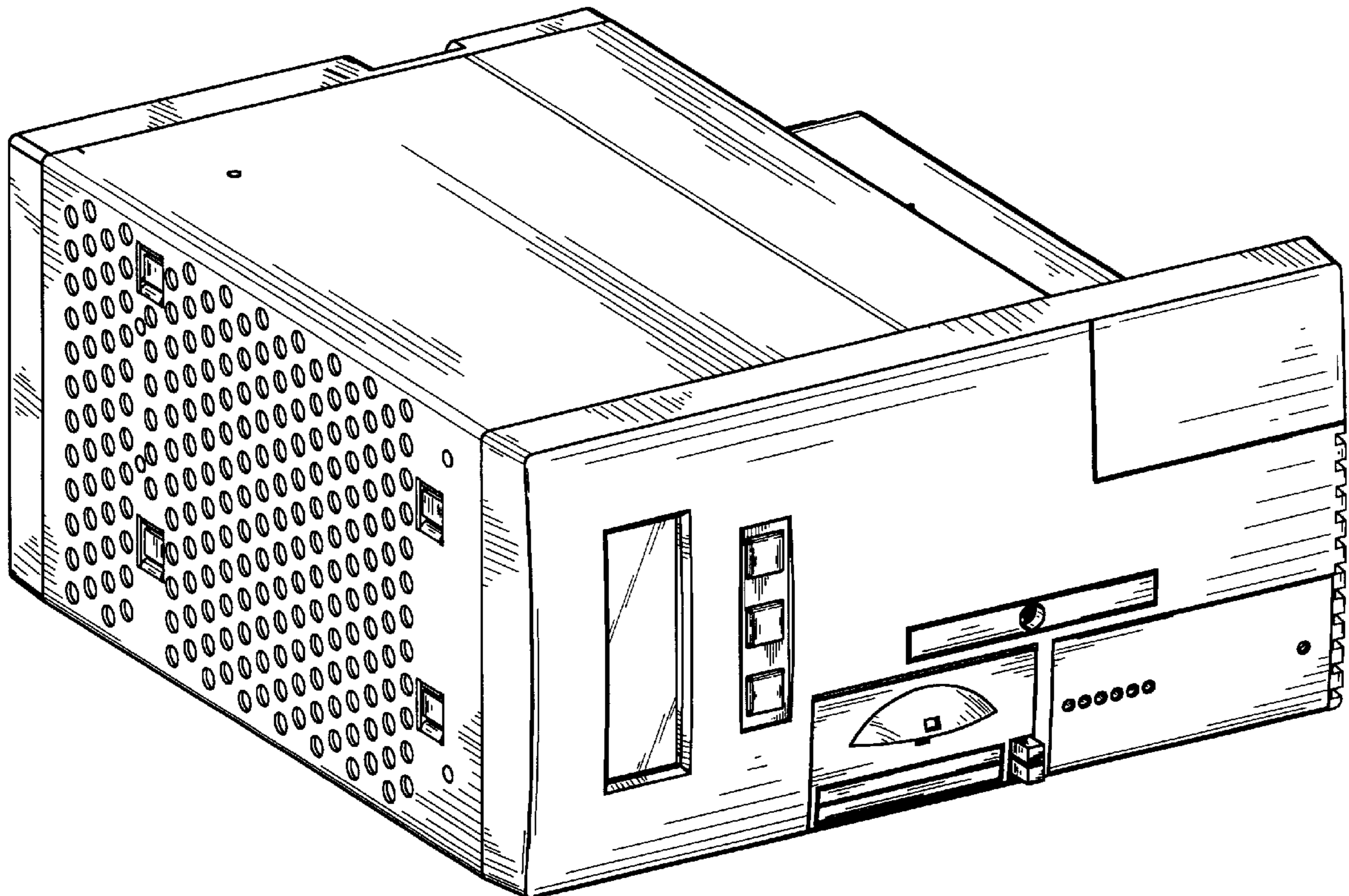

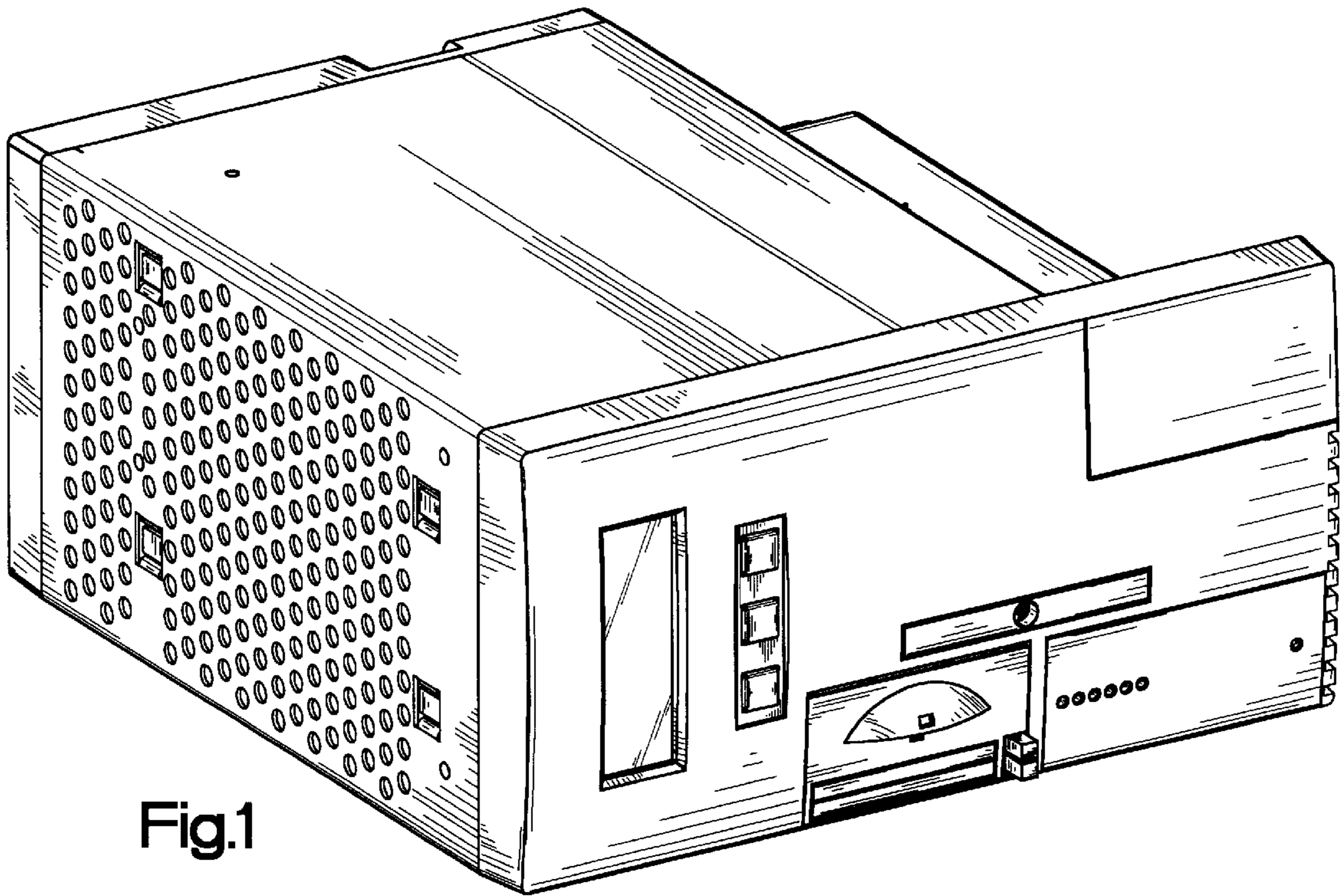

Fig.1

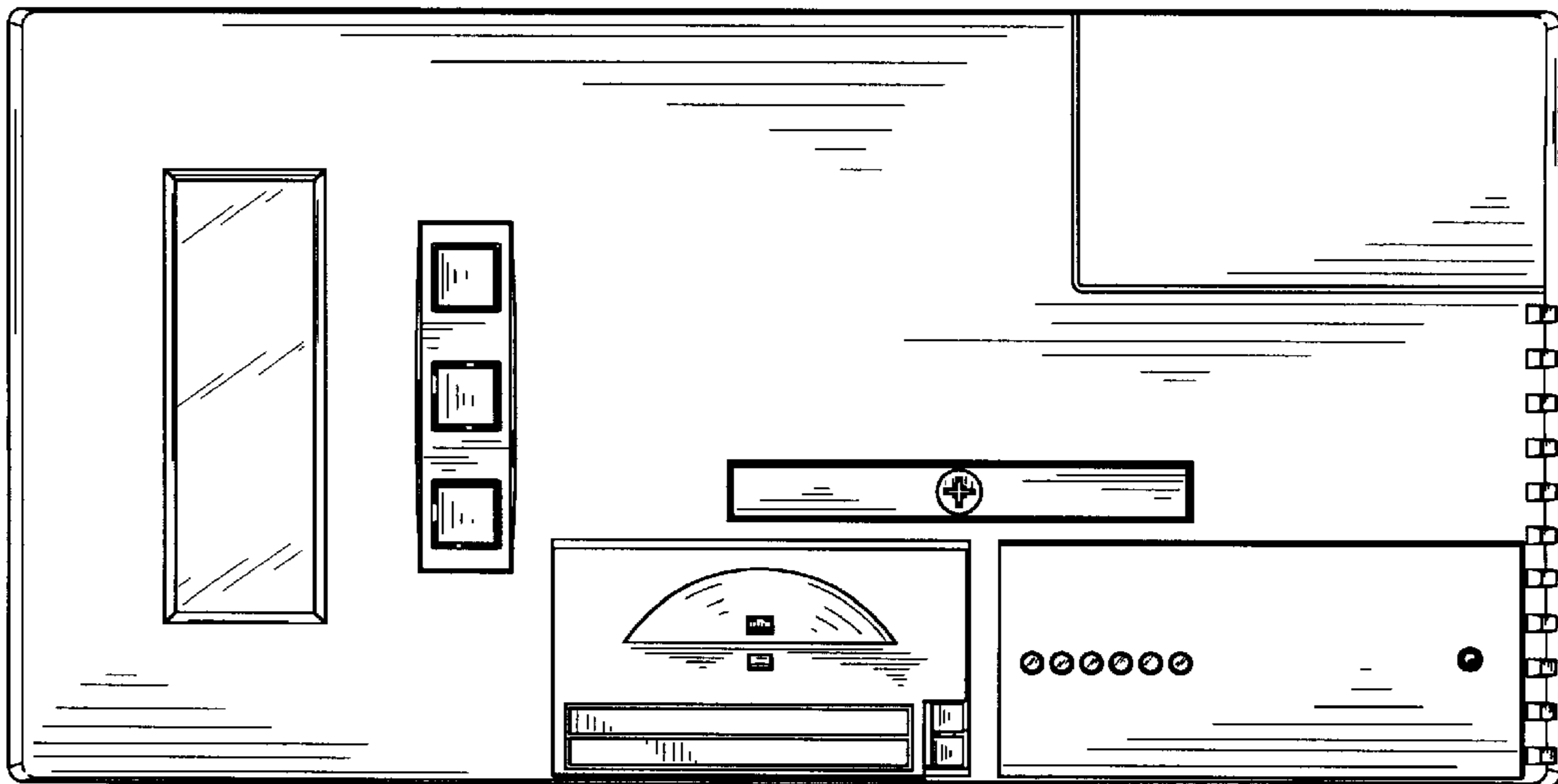

Fig.2

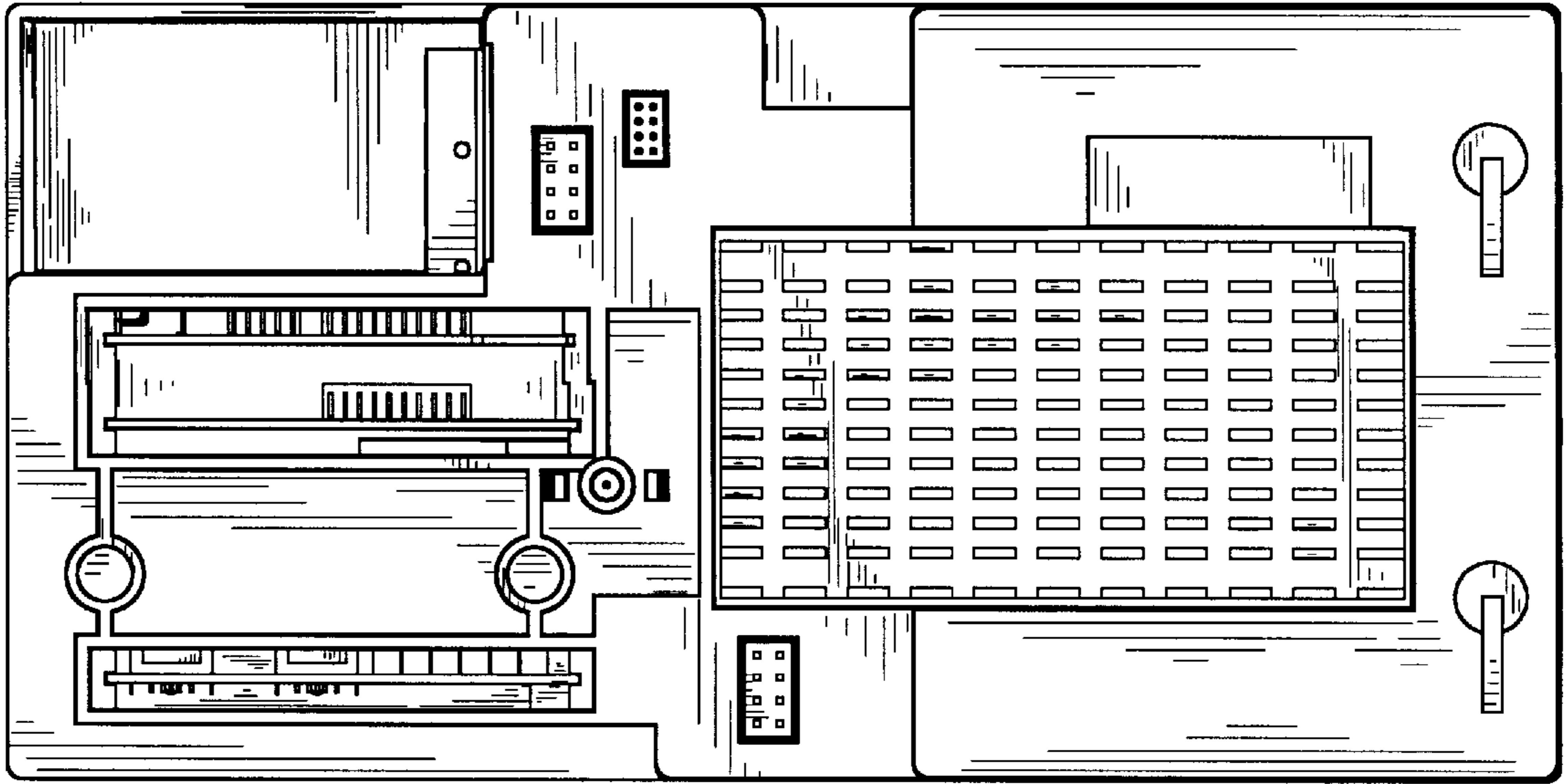

Fig.3

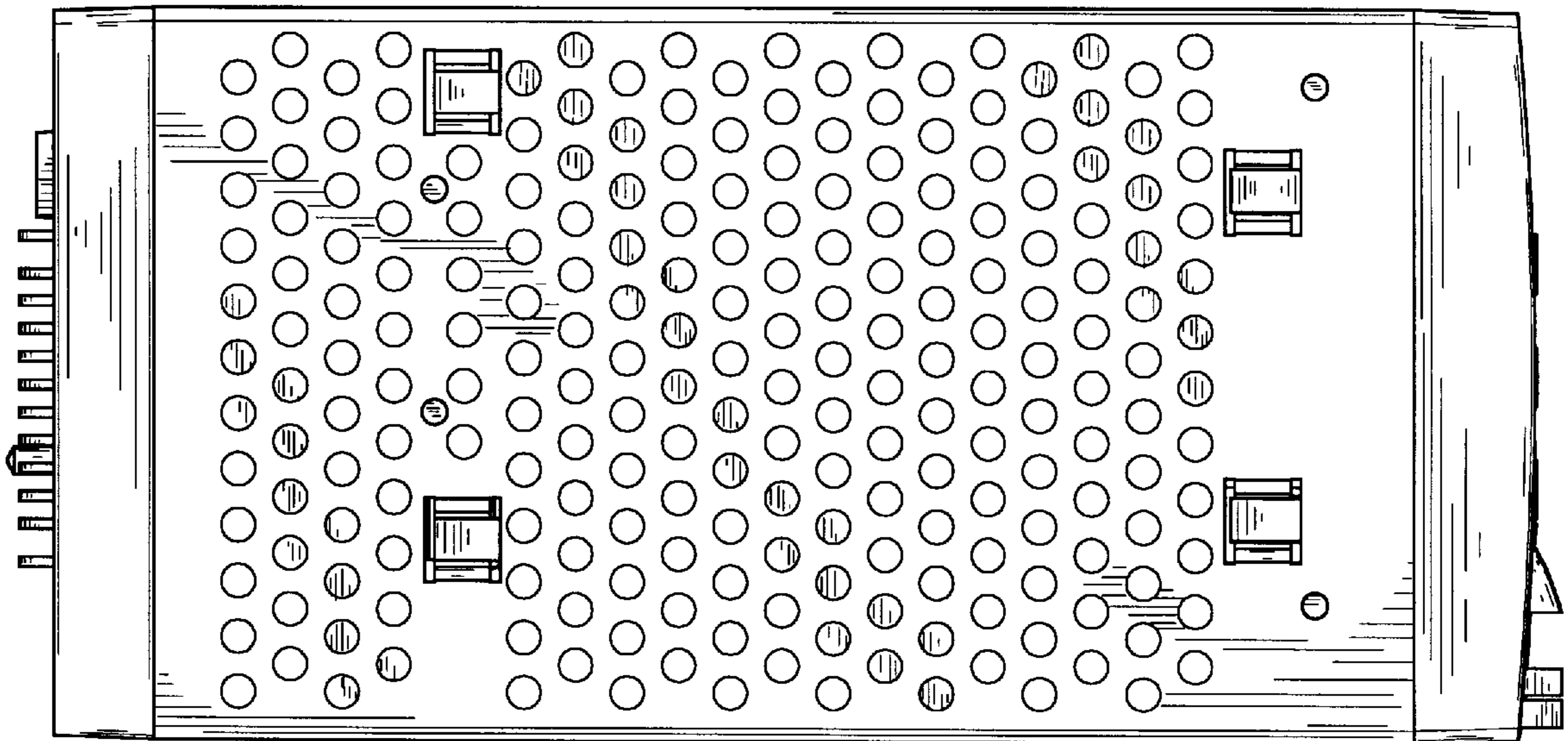

Fig.4

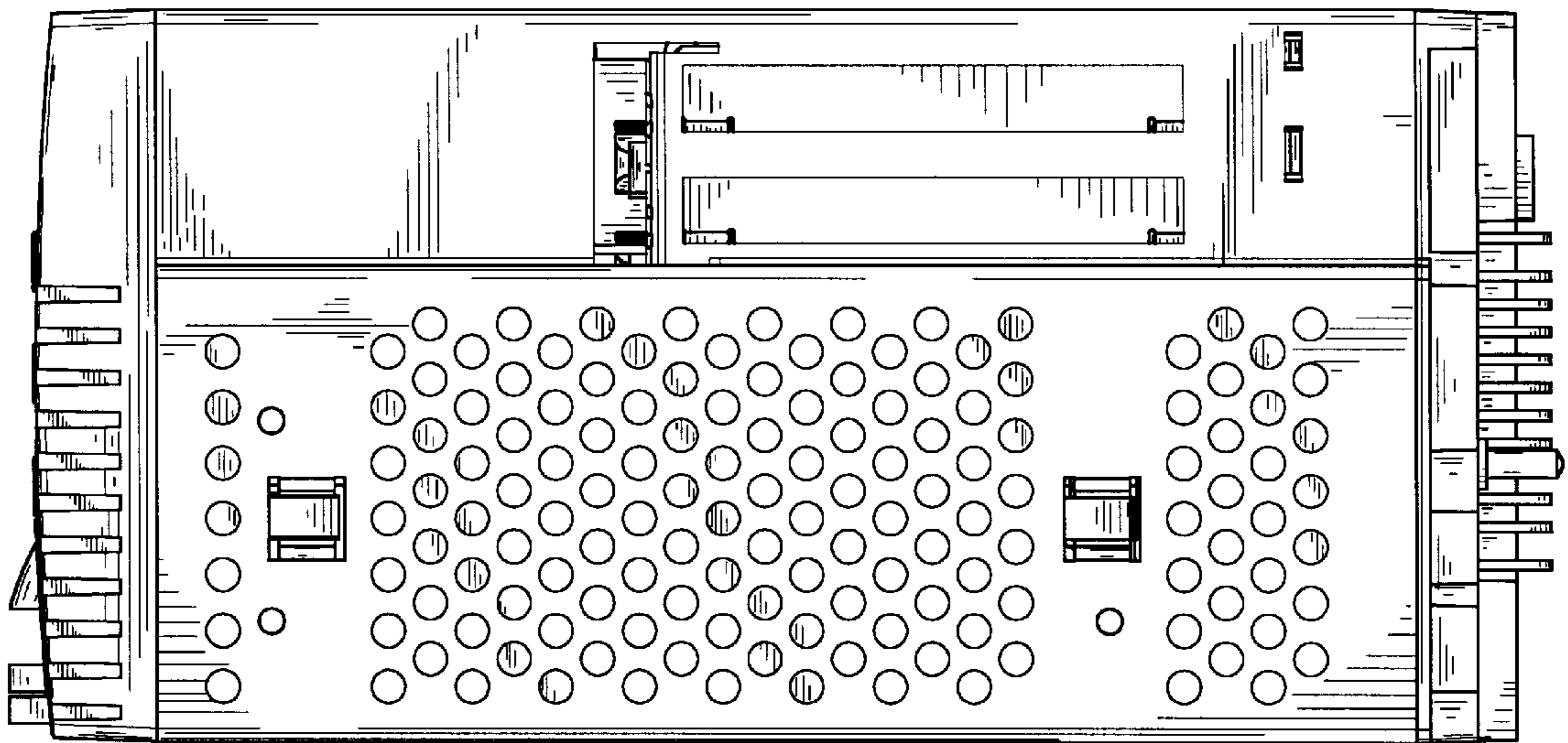

Fig.5

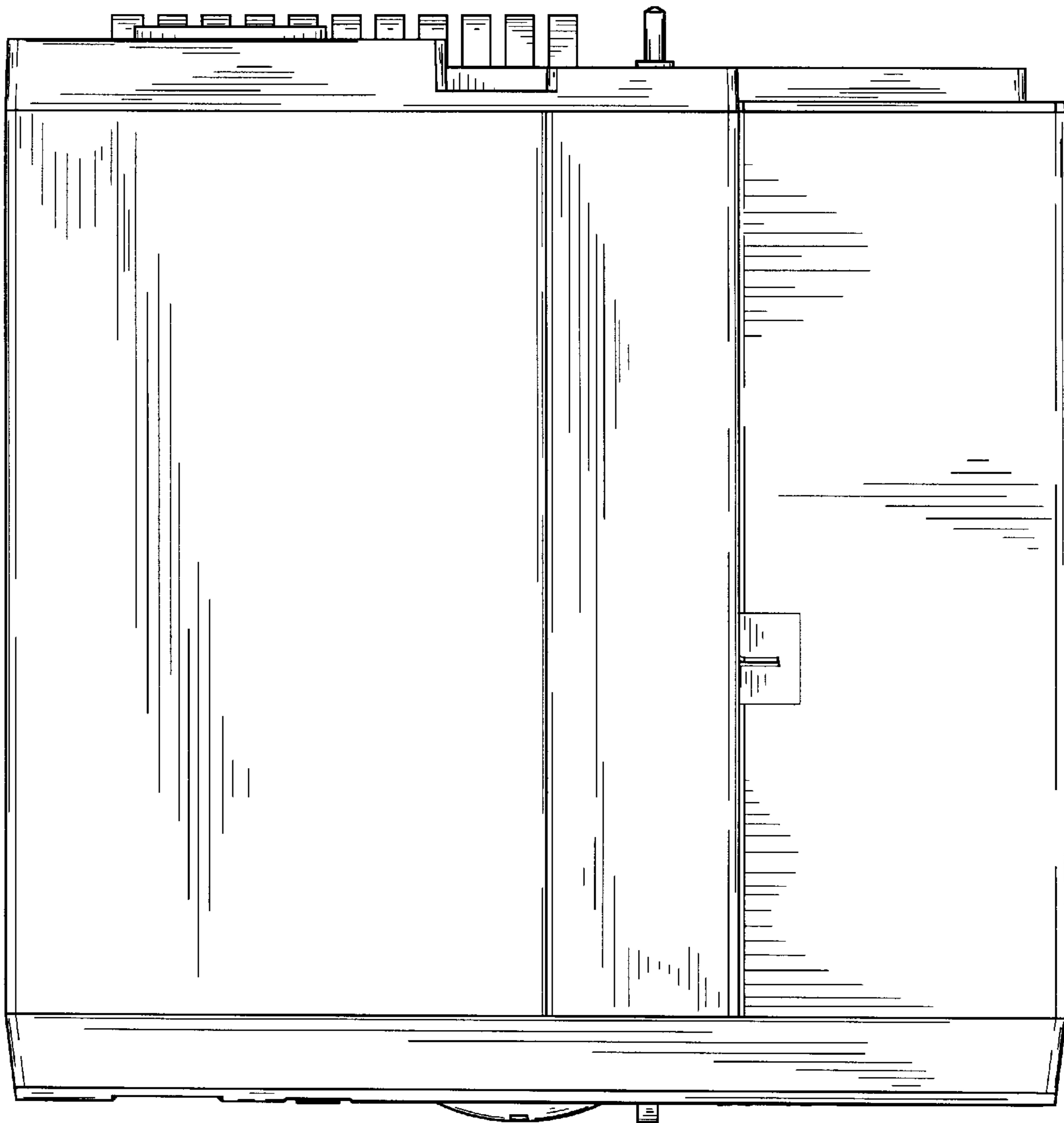

Fig.6

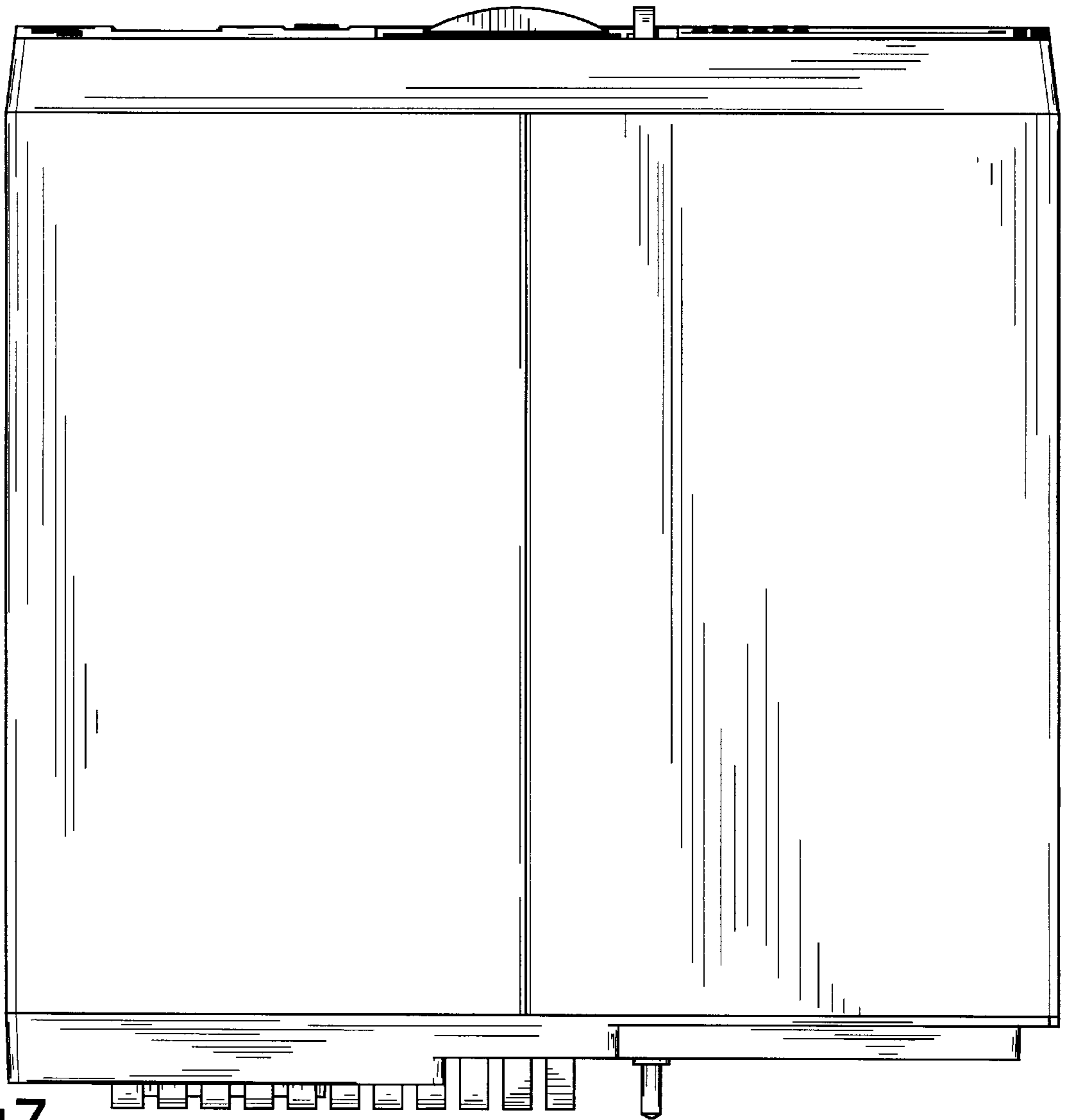

Fig.7