



US00D397967S

United States Patent [19]

Nakayama

[11] **Patent Number:** **Des. 397,967**

[45] **Date of Patent:** ****Sep. 8, 1998**

[54] **POWER UNIT FOR ELECTRIC POWER ASSISTED VEHICLE**

[75] Inventor: **Hironori Nakayama, Iwata, Japan**

[73] Assignee: **Yamaha Hatsudoki Kabushiki Kaisha, Iwata, Japan**

[**] Term: **14 Years**

[21] Appl. No.: **69,495**

[22] Filed: **Apr. 21, 1997**

[30] Foreign Application Priority Data

Dec. 2, 1996 [JP] Japan 8-36702

[51] **LOC (6) Cl.** **12-11**

[52] **U.S. Cl.** **D12/124; D12/123**

[58] **Field of Search** **D12/124, 123, D12/110, 111; 74/594.1-594.3**

[56] References Cited

U.S. PATENT DOCUMENTS

D. 294,338 2/1988 Yamoda et al. D12/110

D. 302,801	8/1989	Lacroix	D12/110
3,779,099	12/1973	Trammell, Jr.	D12/124
5,188,003	2/1993	Trammell, Jr.	74/594.3
5,242,028	9/1993	Murphy et al.	74/594.1 X
5,653,150	8/1997	Gignoux	74/594.1
5,669,467	9/1997	Chiang	74/594.1 X

Primary Examiner—Melody N. Brown
Attorney, Agent, or Firm—Knobbe, Martens, Olson & bear LLP

[57] CLAIM

The ornamental design for a power unit for electrical power assisted vehicle, as shown and described.

DESCRIPTION

FIG. 1 is a front, right side perspective view of the design of a power unit for an electrical power assisted vehicle; FIG. 2 is a left side elevational view thereof; FIG. 3 is a right side elevational view thereof; FIG. 4 is a top plan view thereof; FIG. 5 is a bottom plan view thereof; FIG. 6 is a rear elevational view thereof; and, FIG. 7 is a front elevational view thereof.

1 Claim, 4 Drawing Sheets

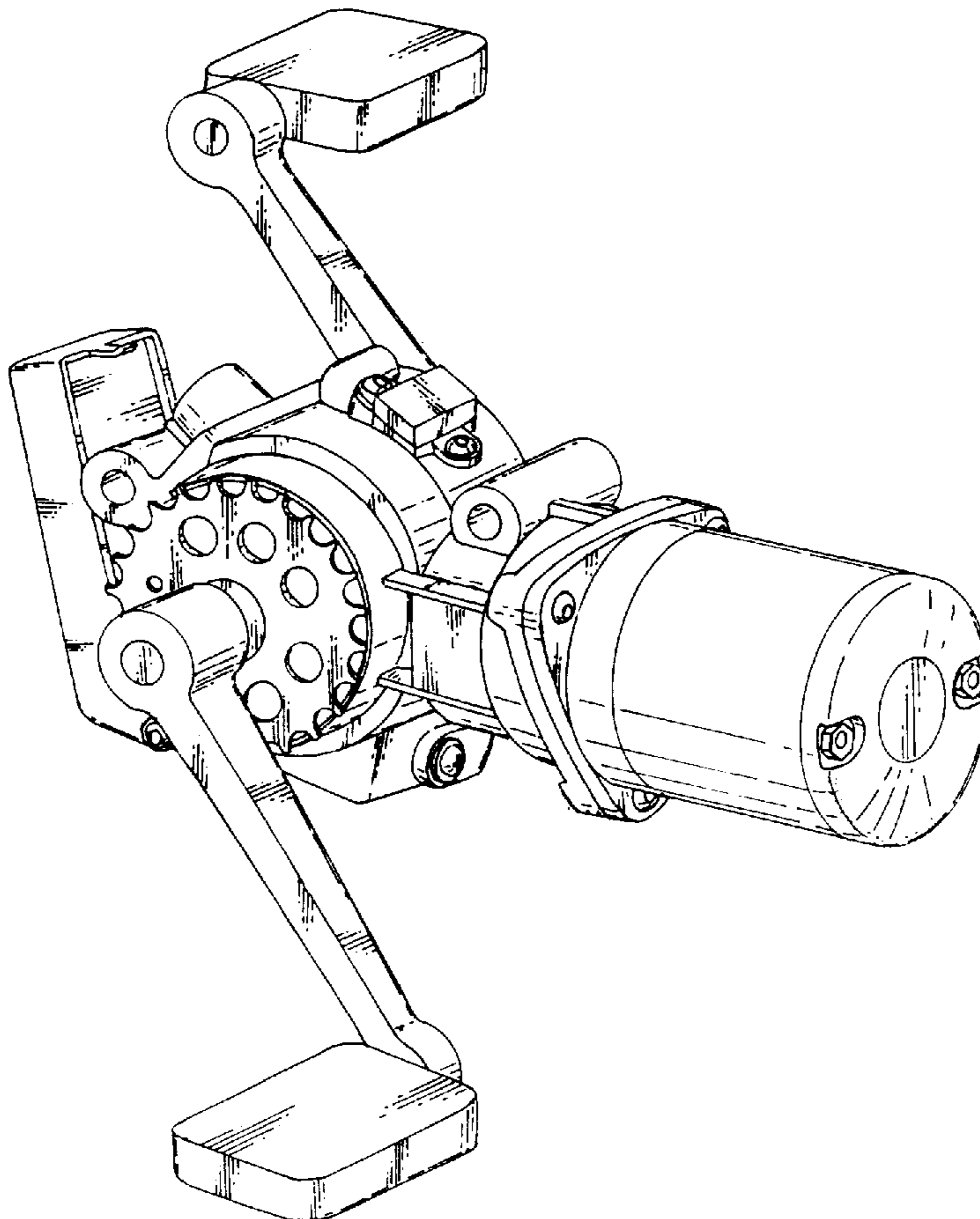

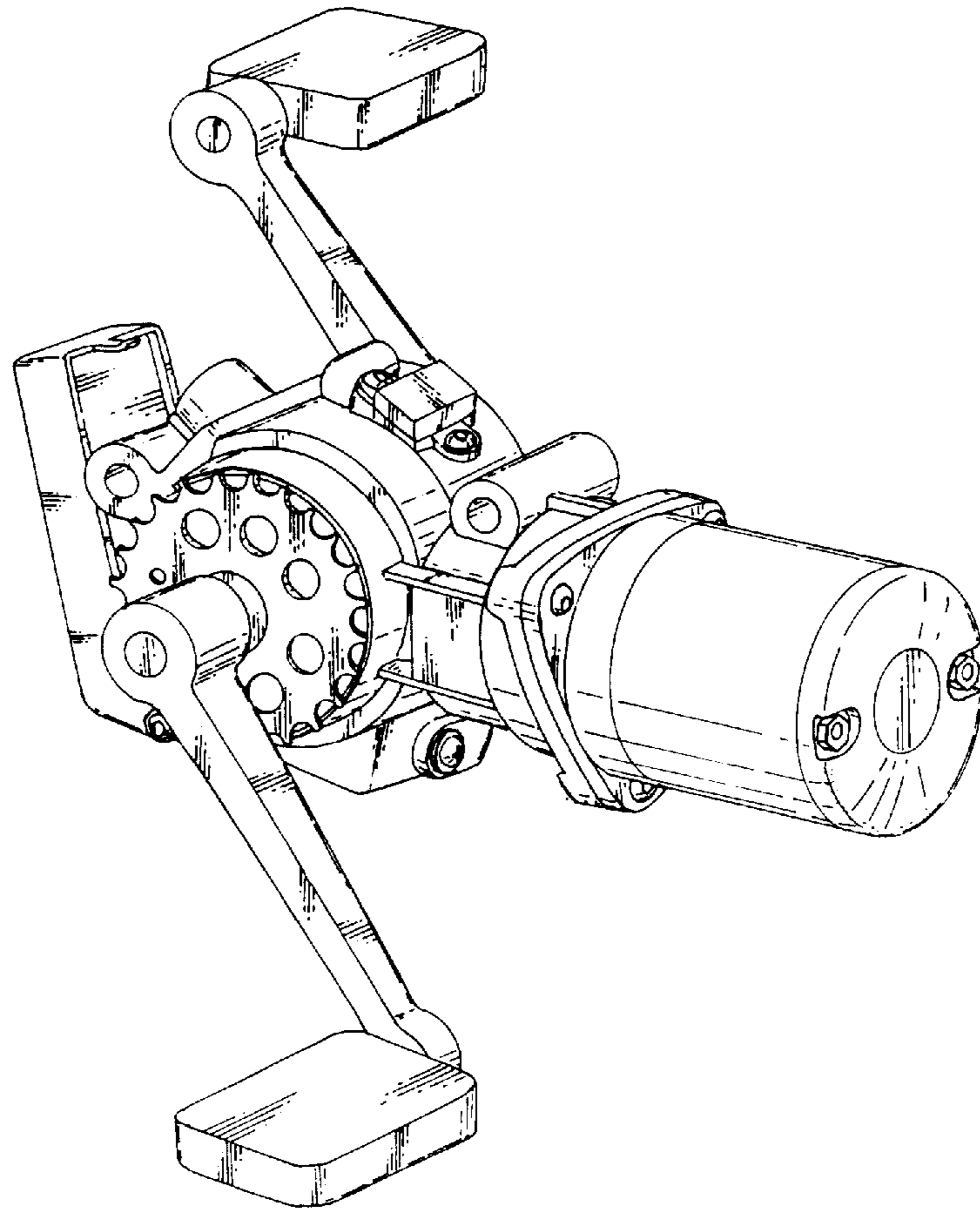

Figure 1

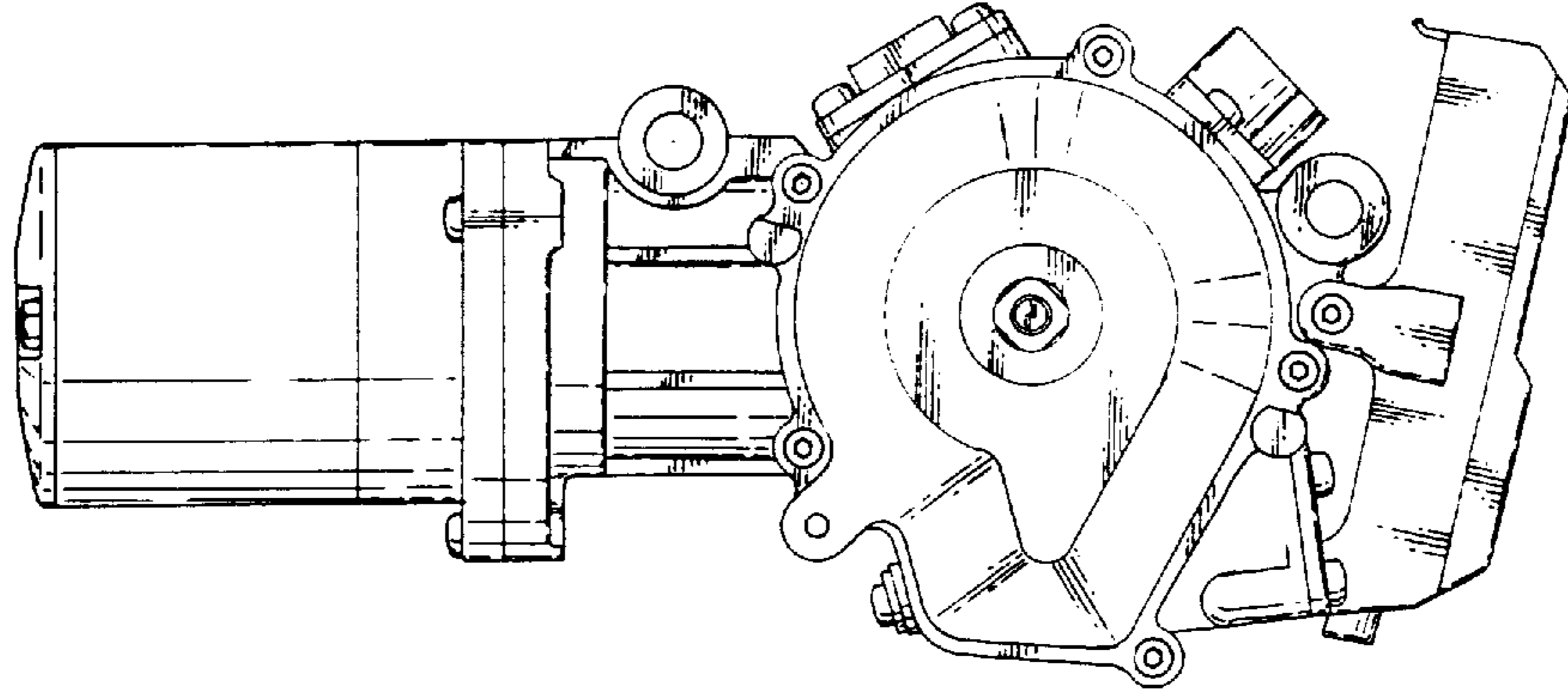

Figure 2

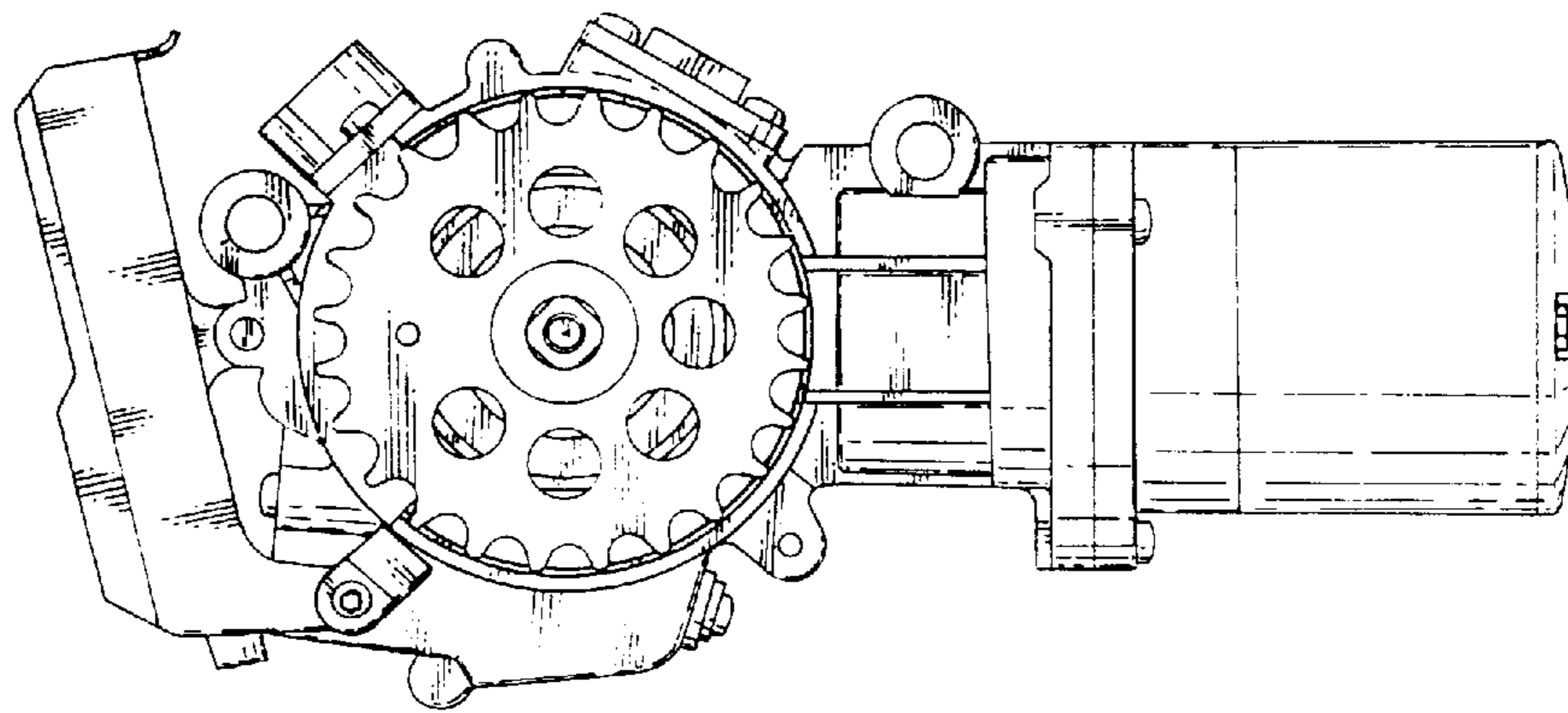

Figure 3

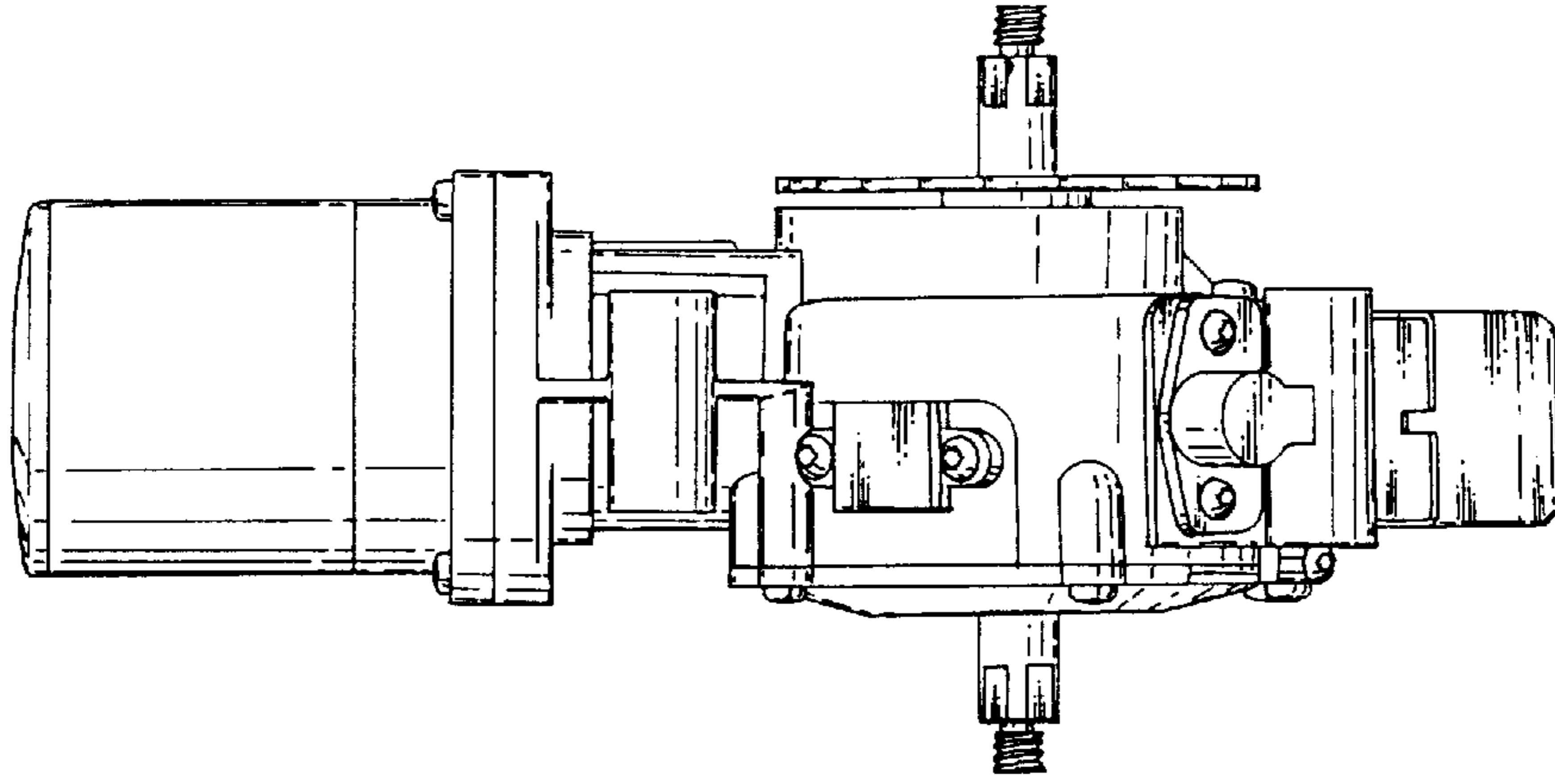

Figure 4

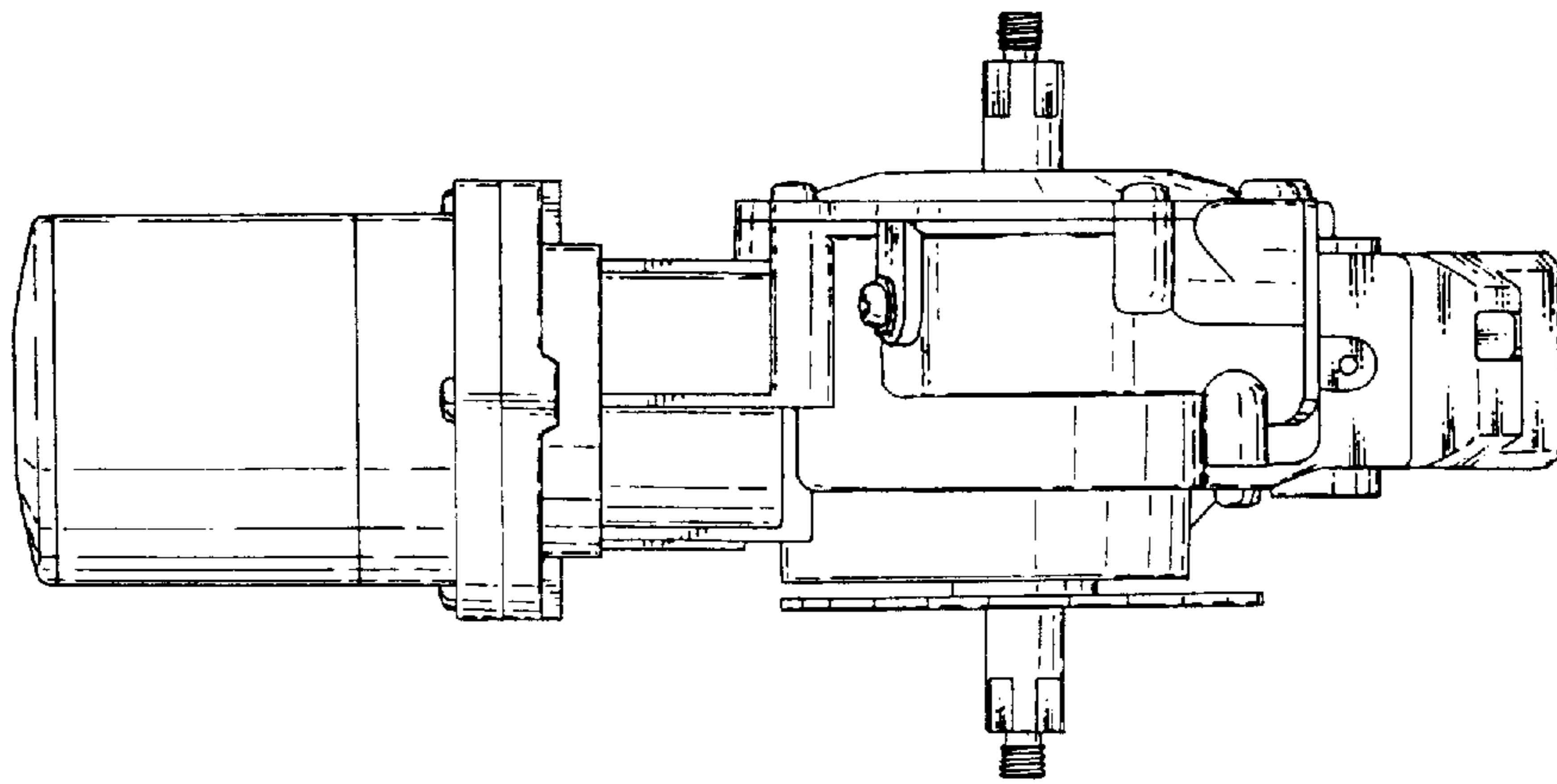

Figure 5

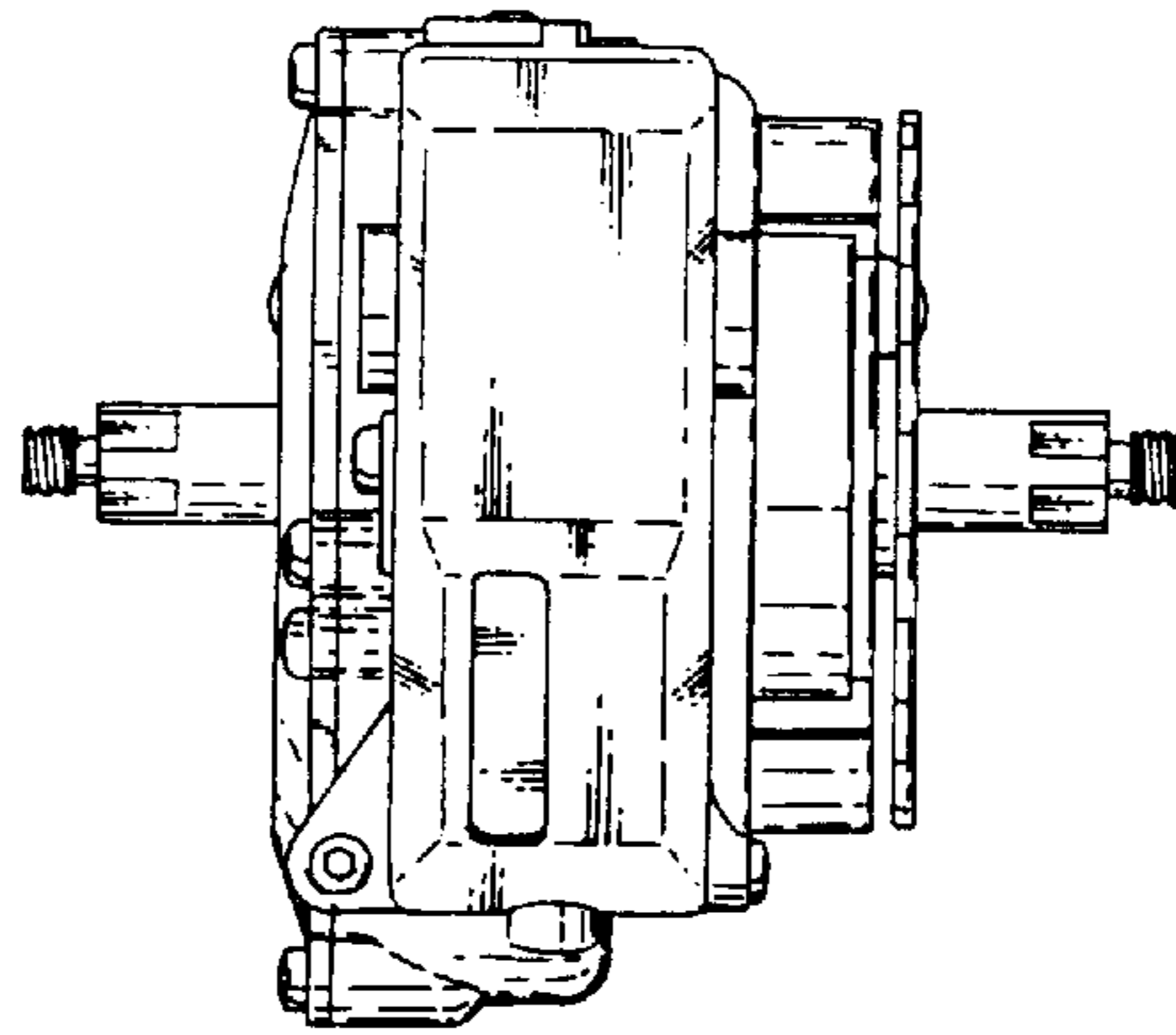

Figure 6

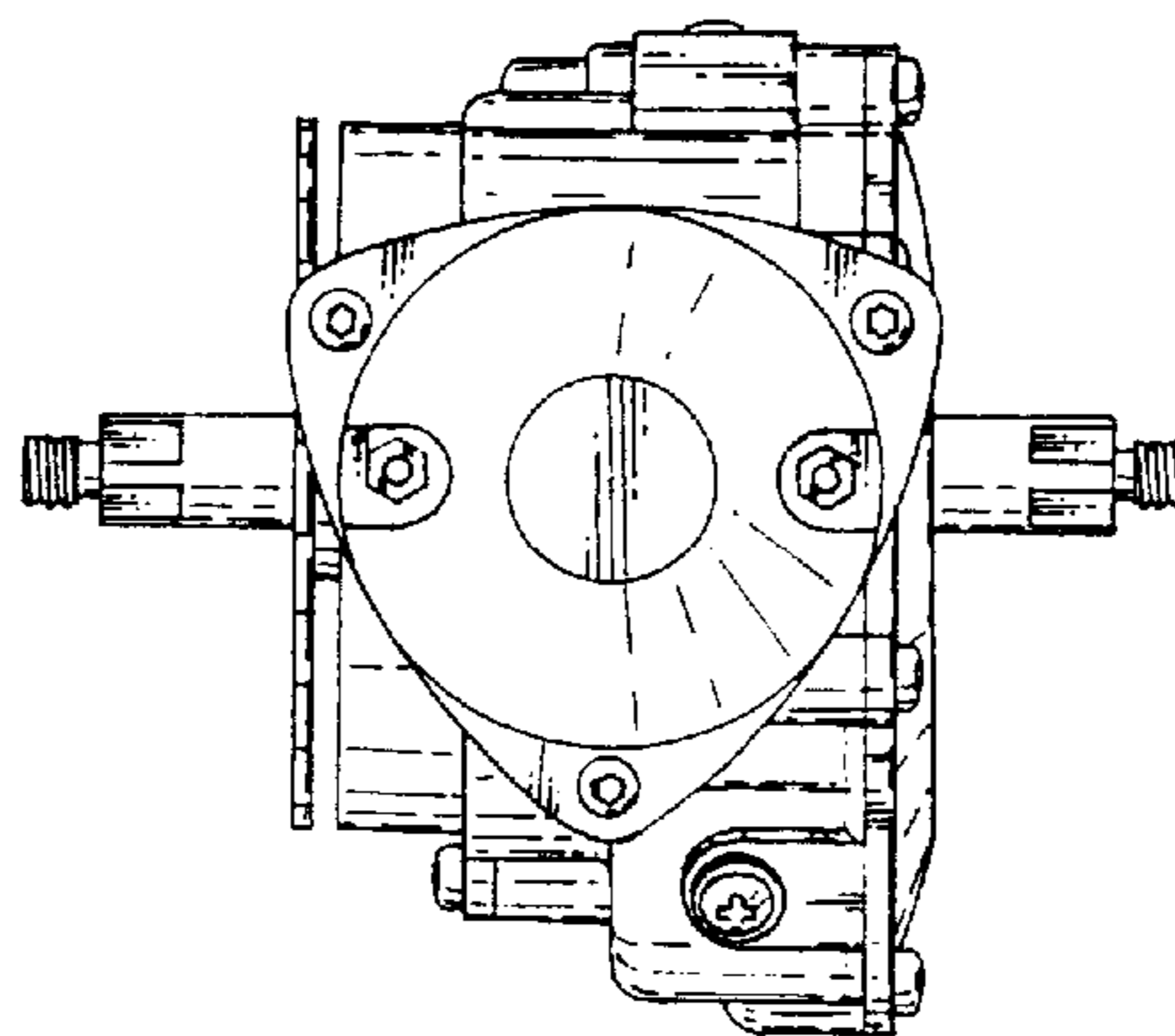

Figure 7