



US00D396005S

United States Patent [19]

[11] Patent Number: **Des. 396,005**

Teags

[45] Date of Patent: ****Jul. 14, 1998**

[54] COLLAPSIBLE CONTAINER SLEEVE

[75] Inventor: **William G. Teags**, Cave Creek, Ariz.

[73] Assignee: **Advanced Package Engineering, Inc.**, Phoenix, Ariz.

[**] Term: **14 Years**

[21] Appl. No.: **63,555**

[22] Filed: **Dec. 10, 1996**

[51] LOC (6) Cl. **09-07**

[52] U.S. Cl. **D9/434**

[58] Field of Search D9/434, 499; D3/304, D3/314; 220/4.29, 6, 7

[56] References Cited

U.S. PATENT DOCUMENTS

D. 306,264	2/1990	Malmanger	D3/314	X
D. 321,653	11/1991	Elgner	D9/434	
5,323,921	6/1994	Olsson	220/6	X
5,558,241	9/1996	Huffstutler, Jr. et al.	220/6	X
5,680,948	10/1997	Schmidt et al.	220/7	X

Primary Examiner—James Gandy

Assistant Examiner—Cathron B. Matta
Attorney, Agent, or Firm—Cahill, Sutton & Thomas, P.L.C.

[57] CLAIM

The ornamental design for a collapsible container sleeve, as shown and described.

DESCRIPTION

FIG. 1 is an exploded left front perspective view of a collapsible container sleeve showing my new design, the top and bottom covers are identical with one another and are shown in dashed lines as part of the environment when the sleeve is used to house goods, and forms no part of the claimed design;

FIG. 2 is a top plan view thereof;

FIG. 3 is a left side elevational view, the right side elevational view being a mirror image thereof;

FIG. 4 is a front elevational view showing an horizontally centered vertical fold line, the rear elevational view is a mirror image thereof; and,

FIG. 5 is a detail view taken within the encircled corner shown in FIG. 1 and identified by numeral 5, the remaining inside corners are duplicative thereof.

1 Claim, 2 Drawing Sheets

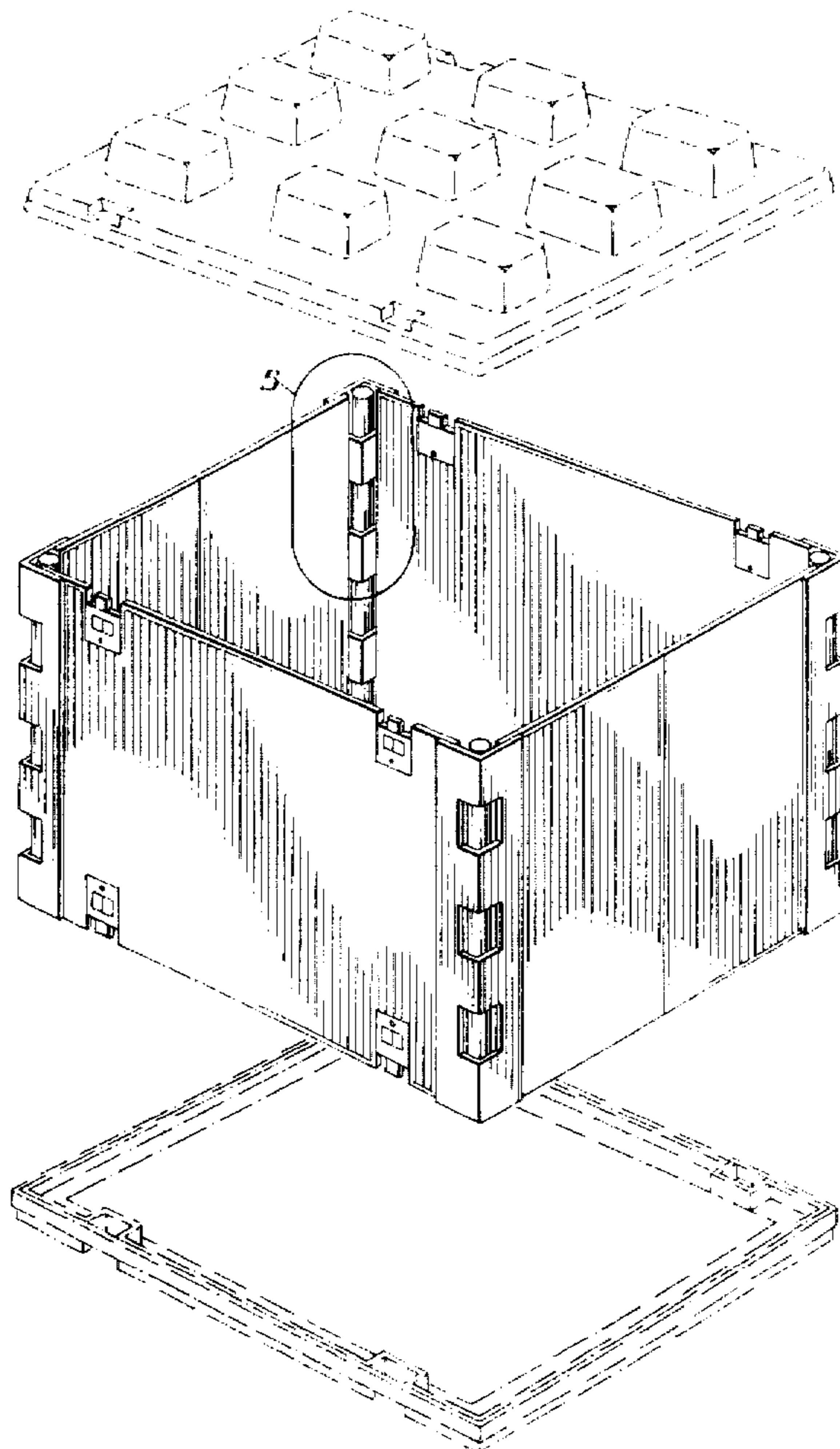

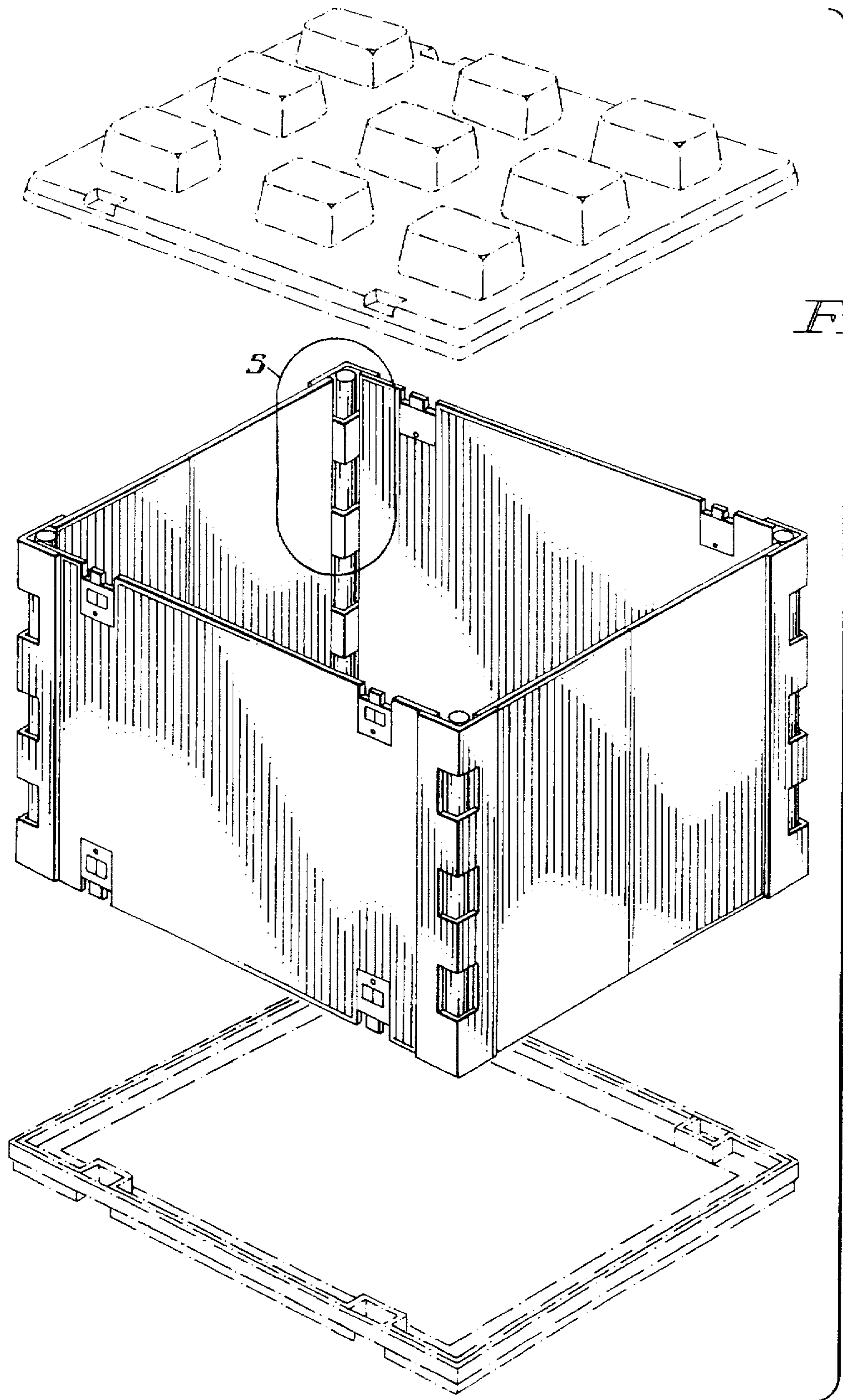

FIG. 1

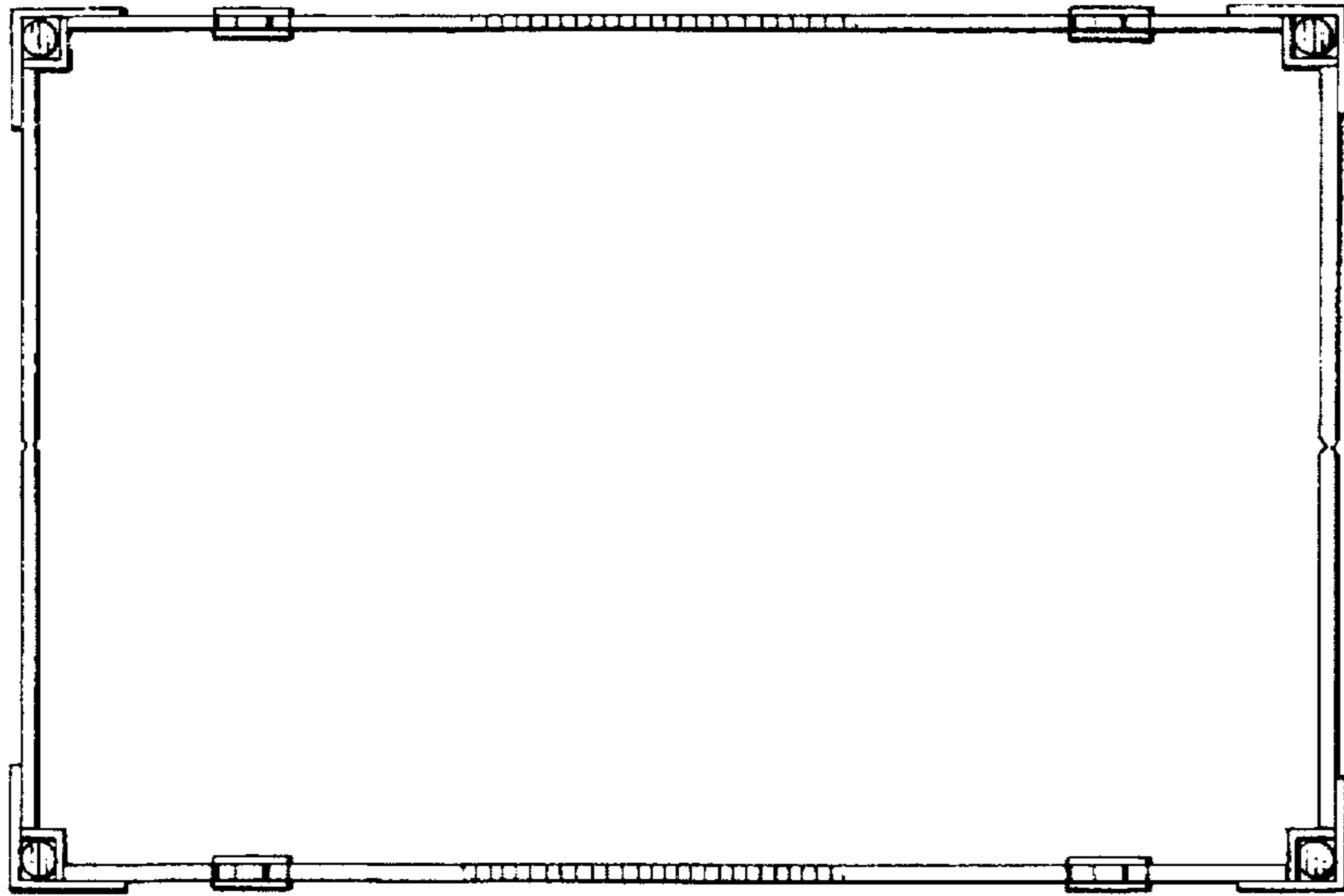

FIG. 2

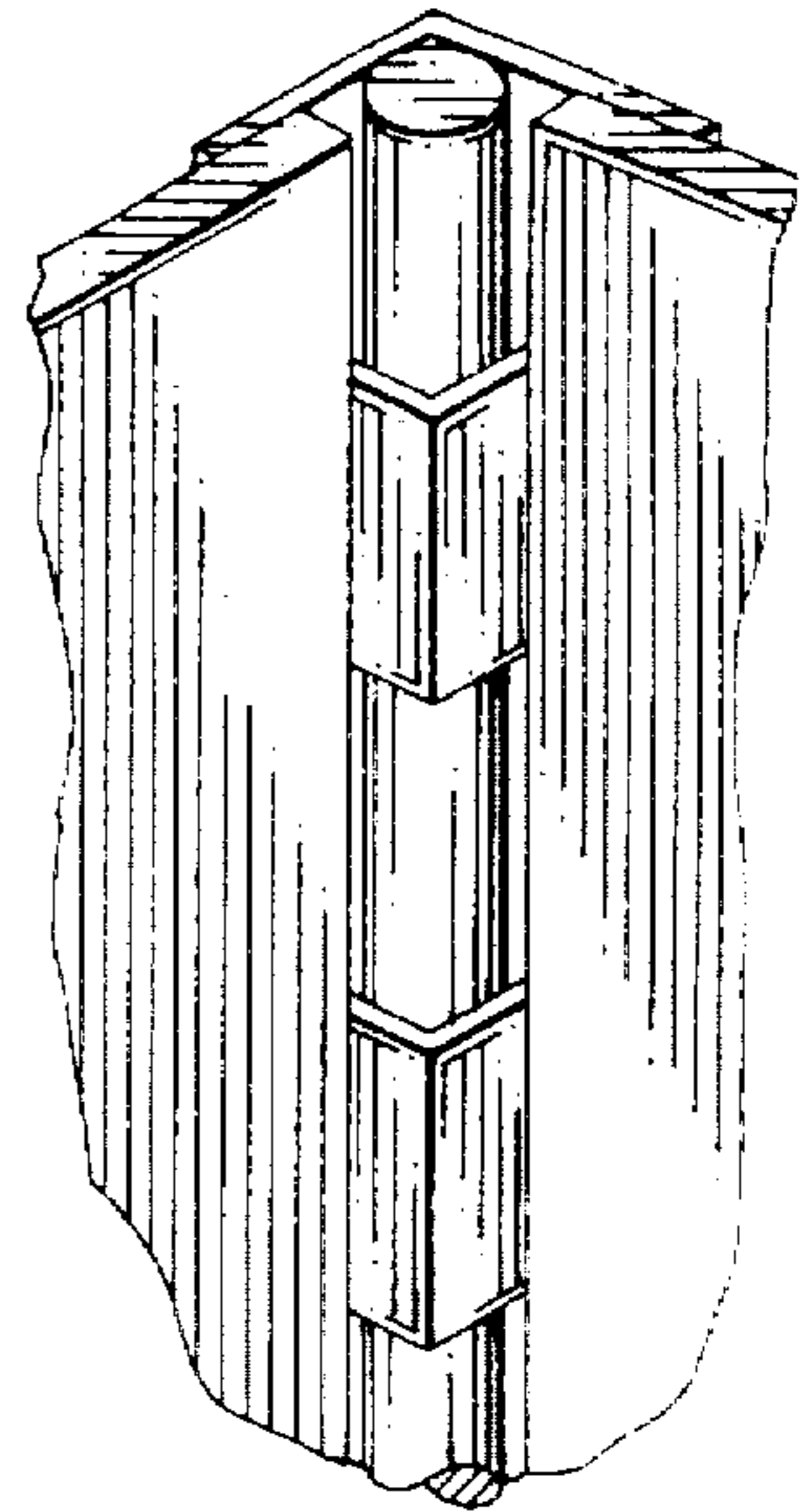

FIG. 5

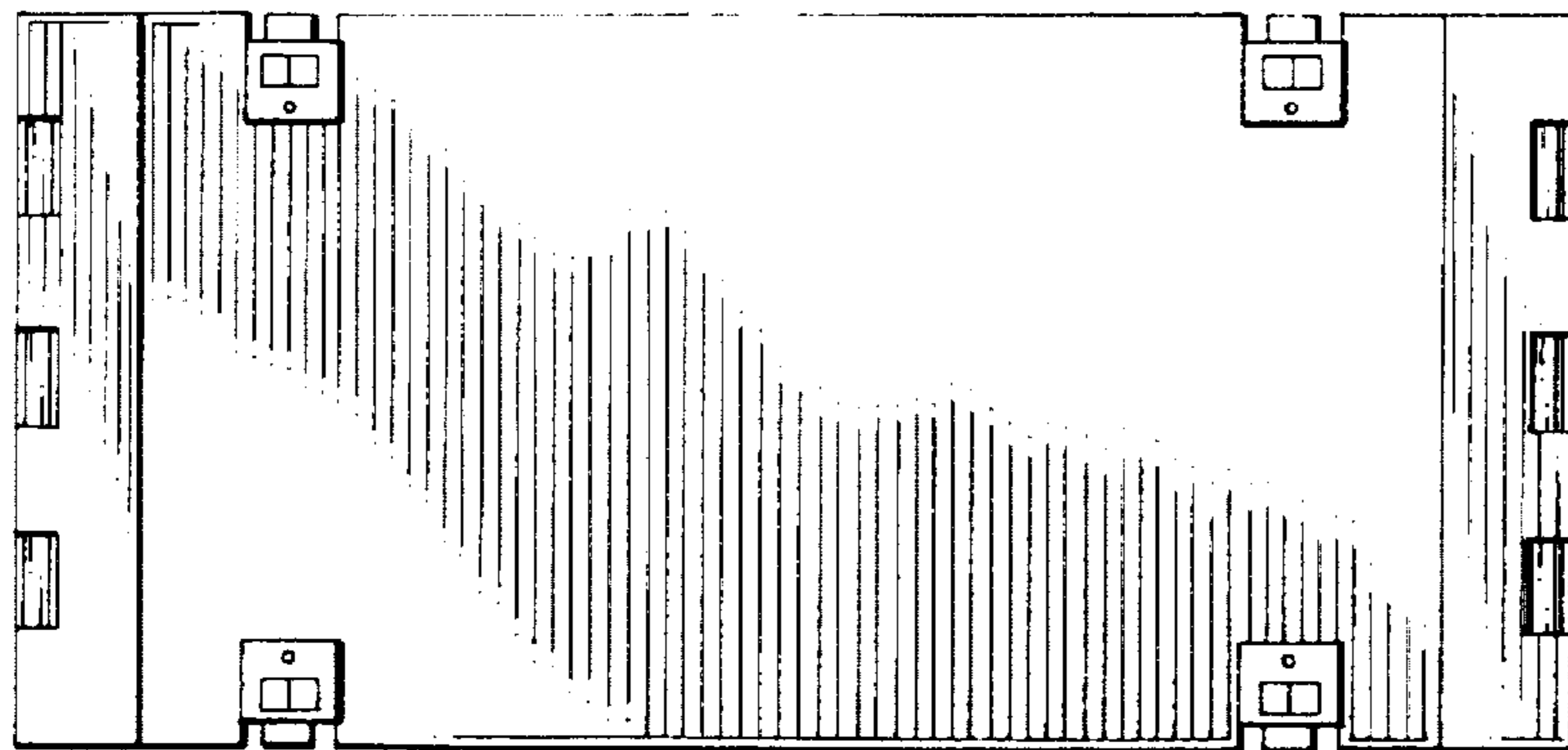

FIG. 3

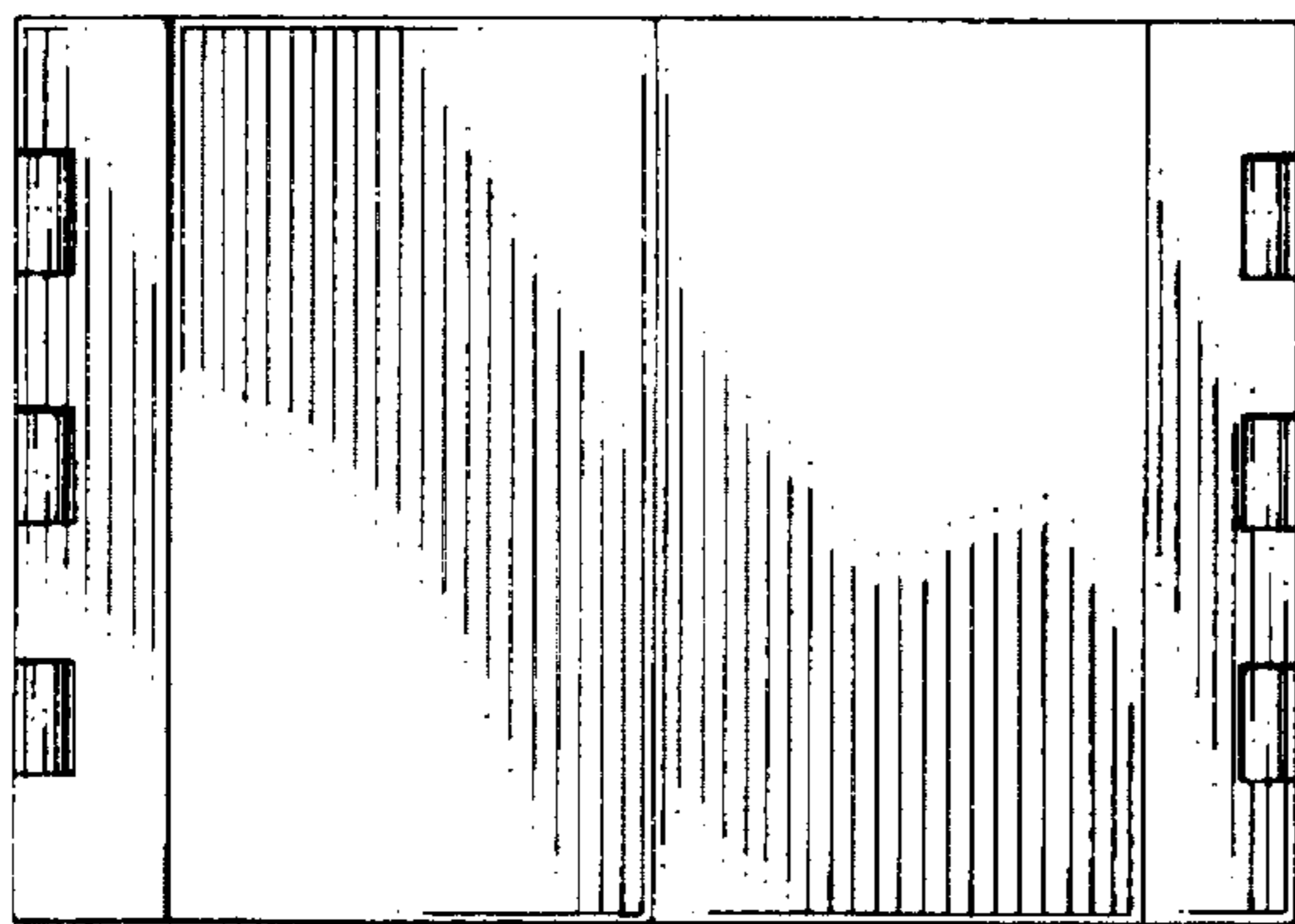

FIG. 4