



US00D395521S

United States Patent [19]

De Leu

[11] Patent Number: **Des. 395,521**

[45] Date of Patent: ****Jun. 23, 1998**

[54] **BOUTIQUE INTERIOR**

[75] Inventor: **Roland De Leu**, Issy-Les-Moulineaux, France

[73] Assignee: **Celine**, Paris, France

[**] Term: **14 Years**

[21] Appl. No.: **467,760**

[22] Filed: **Jan. 19, 1990**

[30] Foreign Application Priority Data

Jul. 21, 1989 [FR] France 89 4710

[51] **LOC (6) Cl.** **25-02**

[52] **U.S. Cl.** **D25/58**

[58] **Field of Search** D25/58, 59, 55;
52/33, 36, 38, 234

[56] References Cited

U.S. PATENT DOCUMENTS

D. 100,779 8/1936 Kanner D25/58
D. 102,100 11/1936 White D25/58

D. 151,715 11/1948 Rettinger D25/58
D. 202,545 10/1965 Gould D25/58
1,494,390 5/1924 Stevenson 52/33
2,285,962 6/1942 Foulkes 52/33
4,154,027 5/1979 Searcy 52/234
4,288,948 9/1981 Harris D25/58
4,472,912 9/1984 Pipp 52/36
4,856,242 8/1989 Baloga et al. 52/79.1

Primary Examiner—Doris Clark
Attorney, Agent, or Firm—John Q. McQuillan

[57] CLAIM

The ornamental design for a boutique interior, as shown and described.

DESCRIPTION

FIG. 1 is a front perspective view of a boutique interior showing my new design;
FIG. 2 is a rear elevational view thereof;
FIG. 3 is a left side elevational view thereof;
FIG. 4 is a right side elevational view thereof; and,
FIG. 5 is a top plan view thereof.

1 Claim, 5 Drawing Sheets

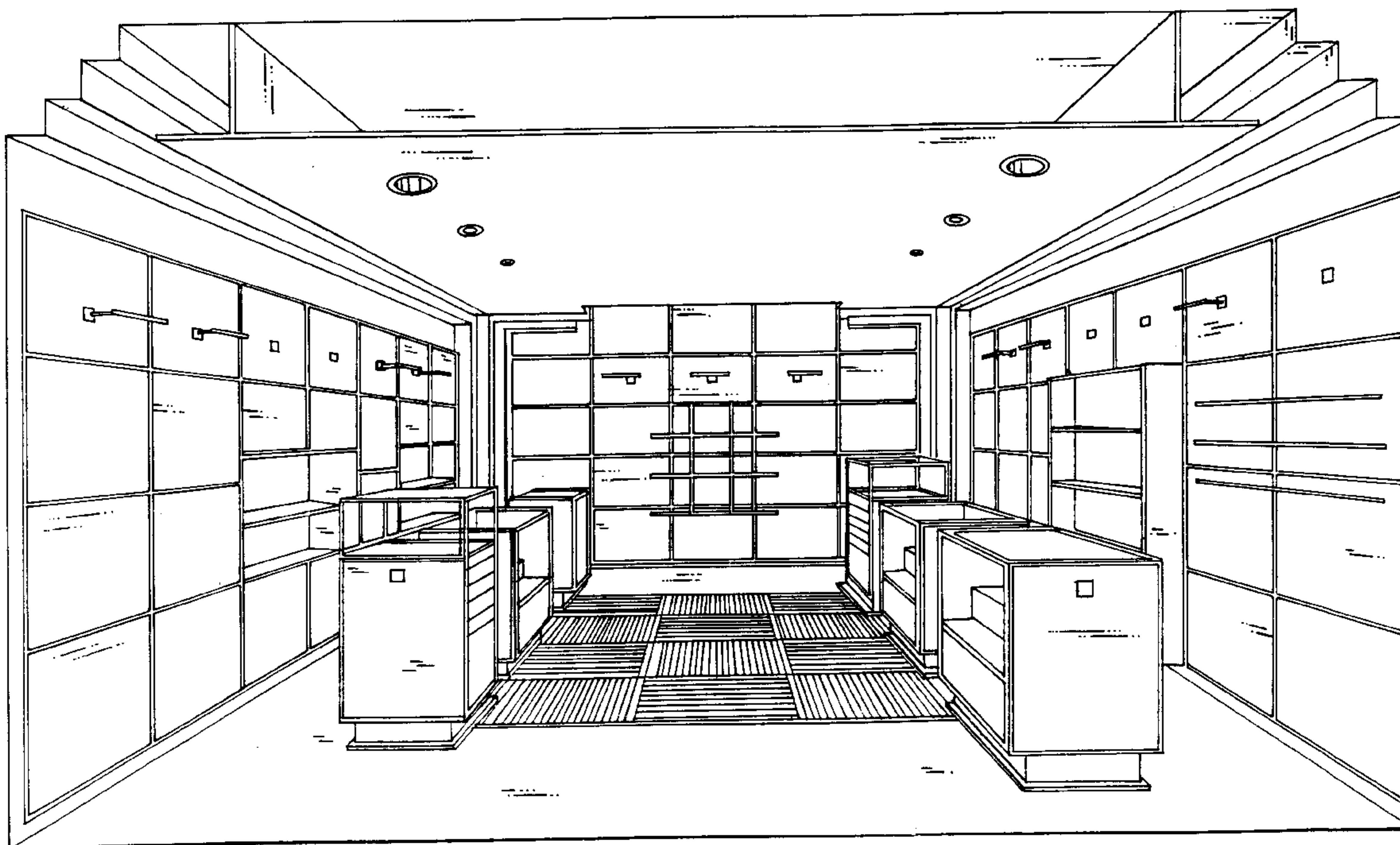

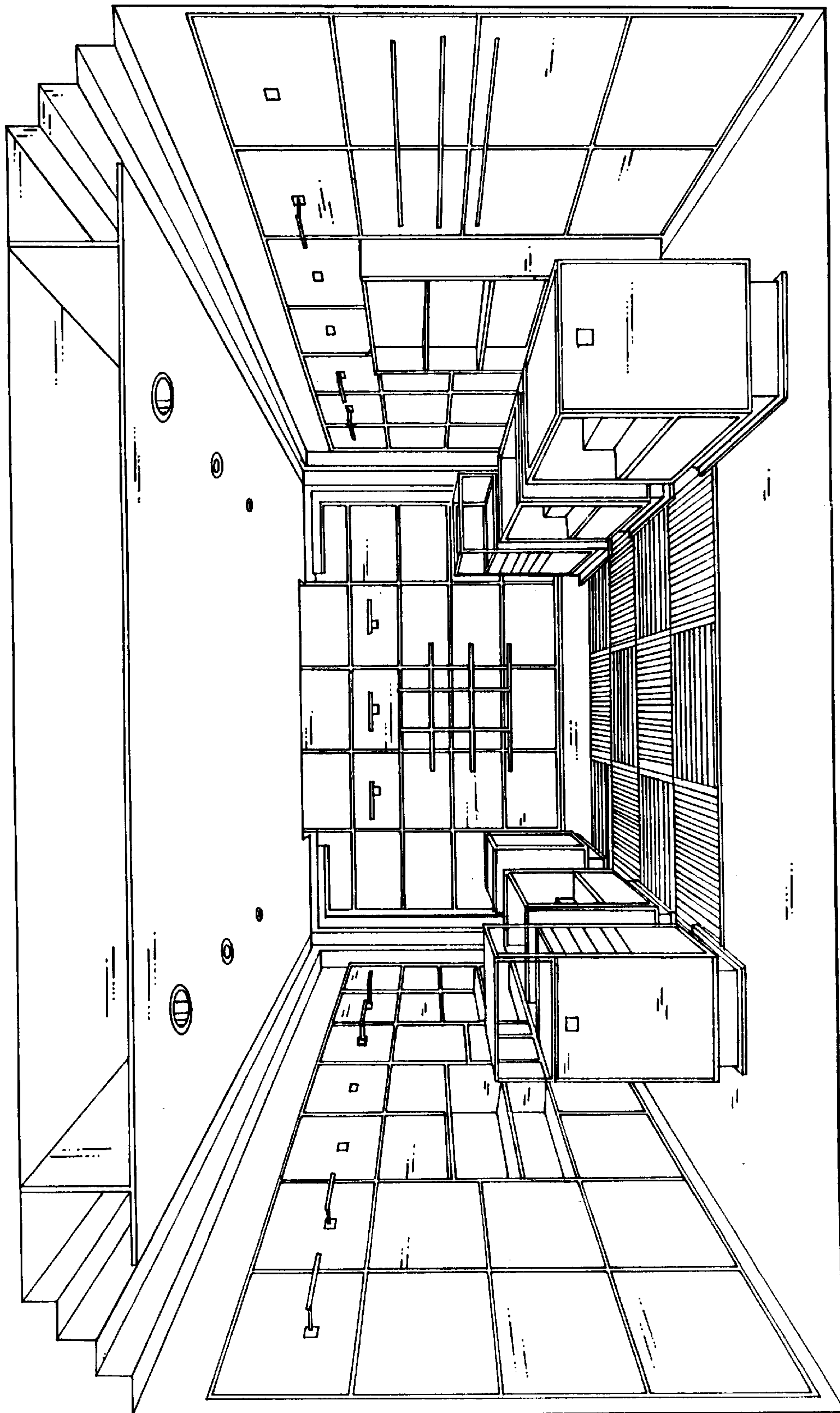

FIG. 1

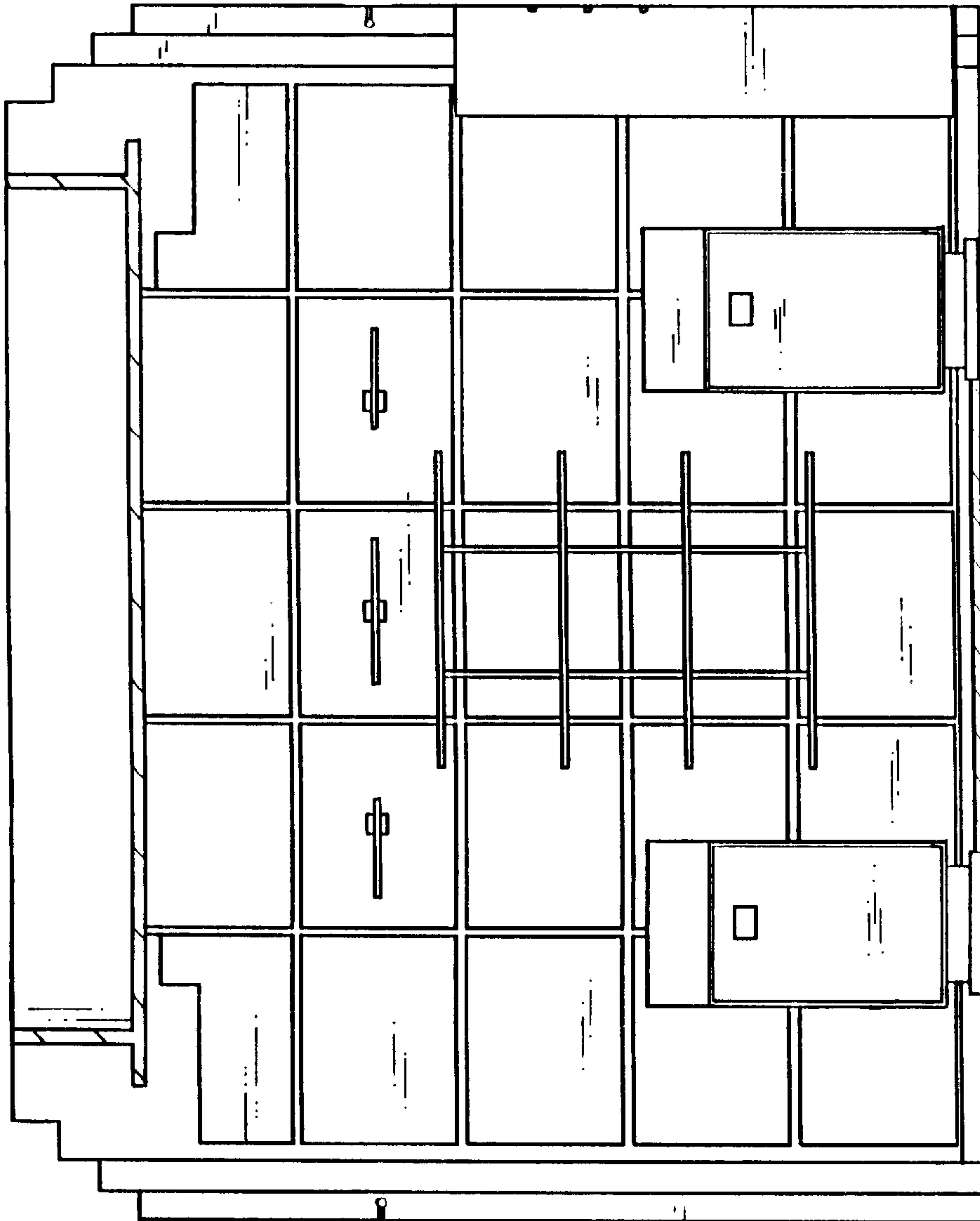

FIG. 2

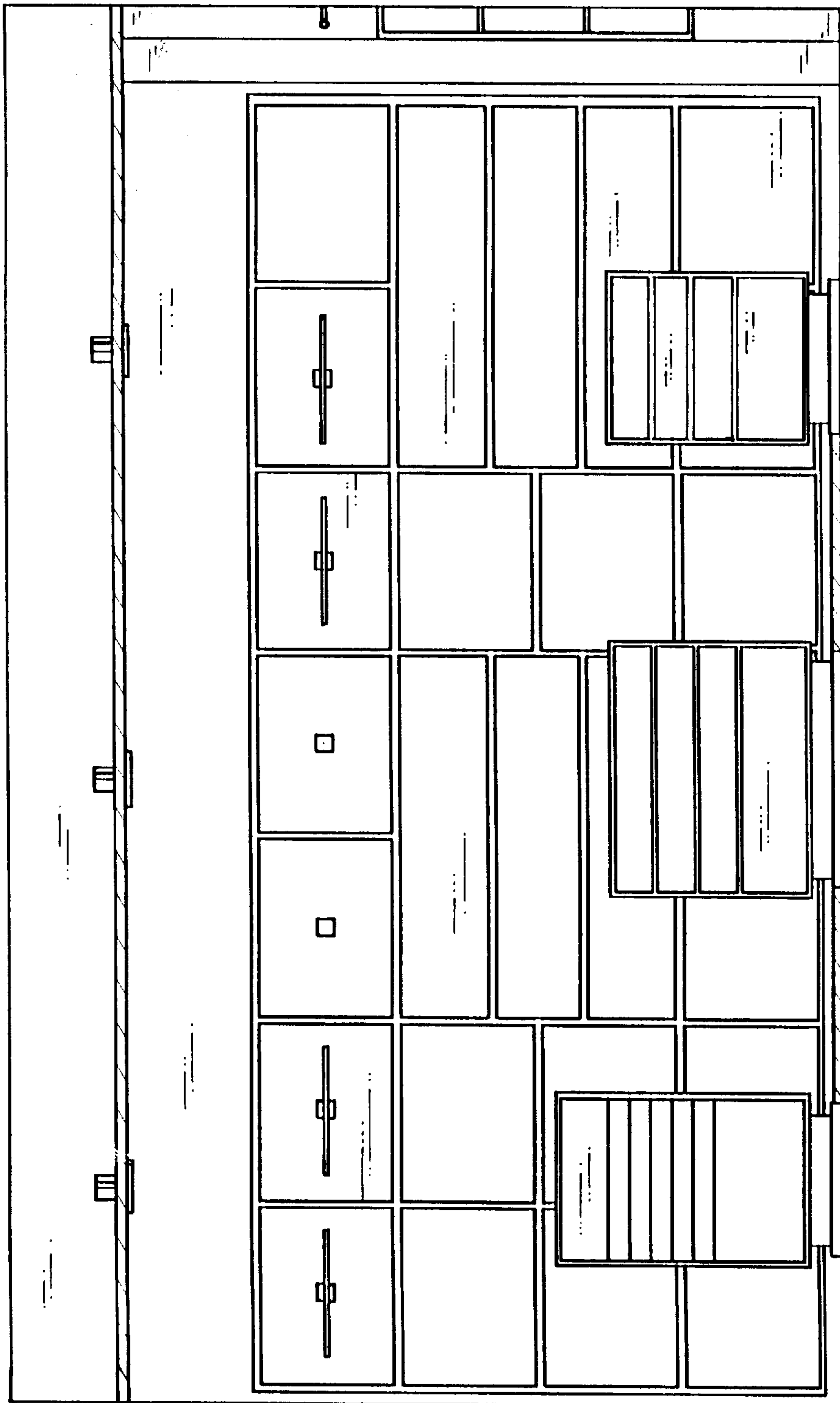

FIG. 3

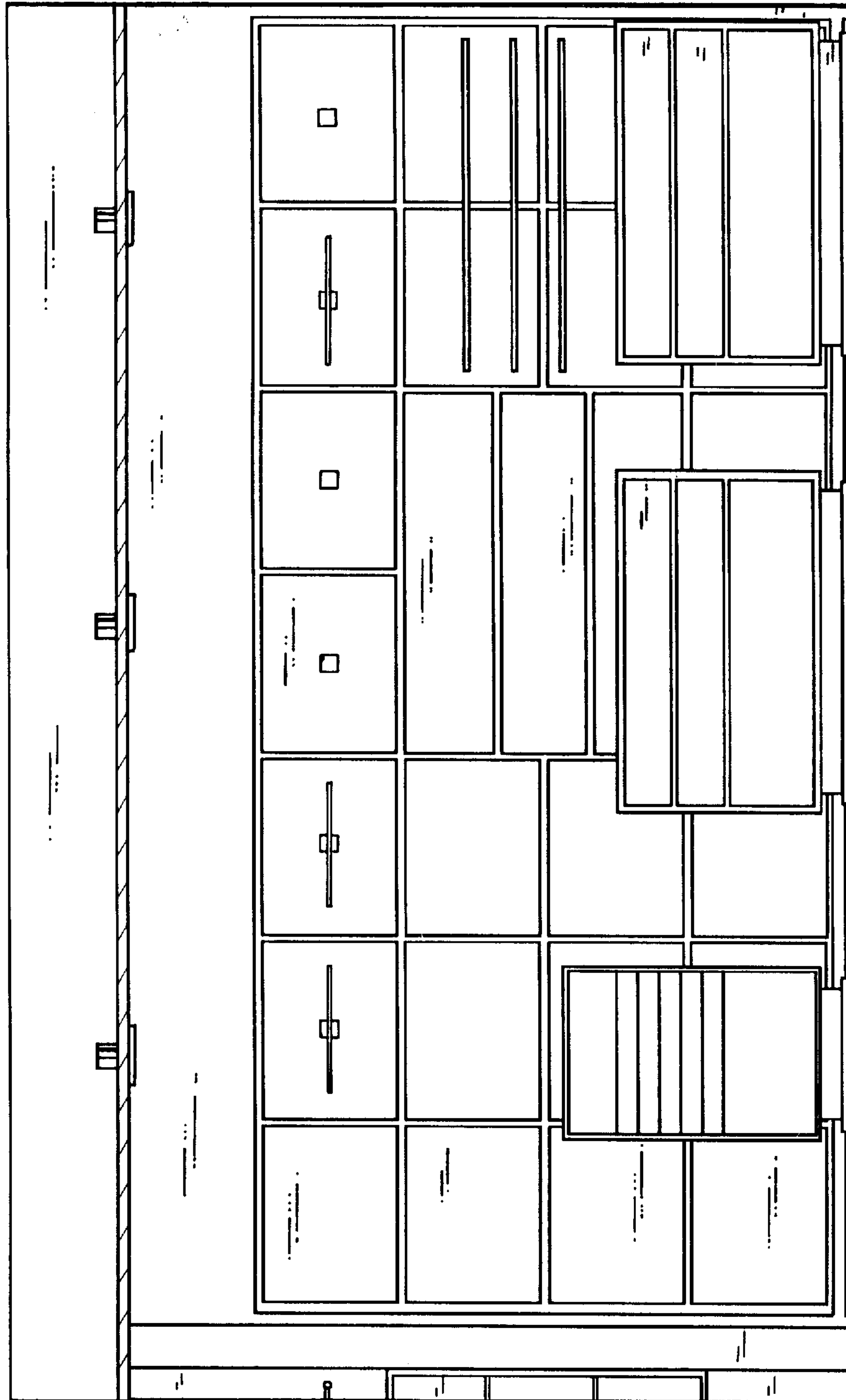

FIG. 4

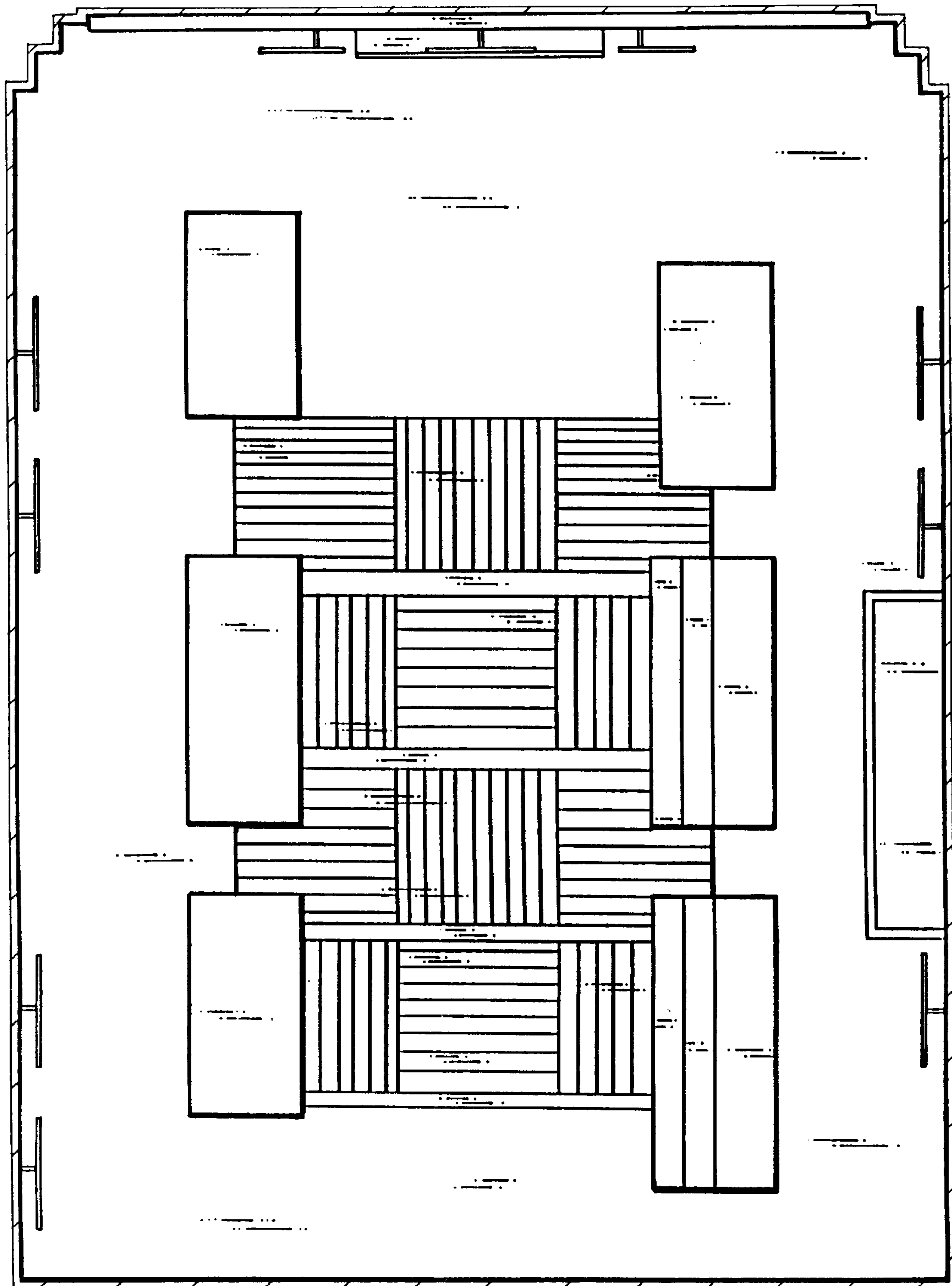

FIG. 5