



US00D394919S

United States Patent [19] Giammarinaro

[11] Patent Number: **Des. 394,919**

[45] Date of Patent: ****Jun. 2, 1998**

[54] **PET BED WITH REMOVABLE DOWN
PILLOW**

[76] Inventor: **Michael J. Giammarinaro, H & S 1/5
U.S.M.C., Camp Pendleton, Calif.
92055**

[**] Term: **14 Years**

[21] Appl. No.: **68,042**

[22] Filed: **Mar. 19, 1997**

[51] LOC (6) Cl. **30-06**

[52] U.S. Cl. **D30/118**

[58] Field of Search D30/118, 108,
D30/160, 161; D6/601-605, 334-335, 382-384;
119/165-166, 168, 499, 161, 28.5

[56] **References Cited**

U.S. PATENT DOCUMENTS

D. 221,558	8/1971	Zimmerman	D30/118
D. 223,760	6/1972	Chestine	D30/118
D. 309,514	7/1990	Marcus et al.	D30/118
D. 349,590	8/1994	Berger	D30/108
D. 360,494	7/1995	Therriault	D30/118
D. 369,443	4/1996	Givens	D30/118
D. 369,885	5/1996	Zeiler	D30/118
D. 375,557	11/1996	Dixon	D30/118
D. 380,880	7/1997	Reid	D30/118
3,479,991	11/1969	Lichtenberger	119/28.5

3,814,058	6/1974	Thompson	119/482
5,033,408	7/1991	Langenbahn	119/25.8
5,050,536	9/1991	Baker	119/499
5,282,439	2/1994	Oaks	119/28.5
5,577,465	11/1996	Cook	119/28.5

FOREIGN PATENT DOCUMENTS

2408301	7/1979	France	D30/118
373779	6/1932	United Kingdom	119/28.5

OTHER PUBLICATIONS

House Furnishings; p. 26; Cuddle-bunk dog bed; 1942.
DogLoo Inc. brochure for Snugglyloo pet bed; Jan. 1991.

Primary Examiner—Cathy Anne MacCormac

[57] **CLAIM**

The ornamental design for a pet bed with removable down pillow, as shown and described.

DESCRIPTION

FIG. 1 is a front elevational view of the pet bed with removable down pillow showing my new design;
FIG. 2 is a rear elevational view thereof;
FIG. 3 is a right side view thereof;
FIG. 4 is a left side view thereof;
FIG. 5 is a top plan view thereof; and,
FIG. 6 is a bottom plan view thereof.

1 Claim, 3 Drawing Sheets

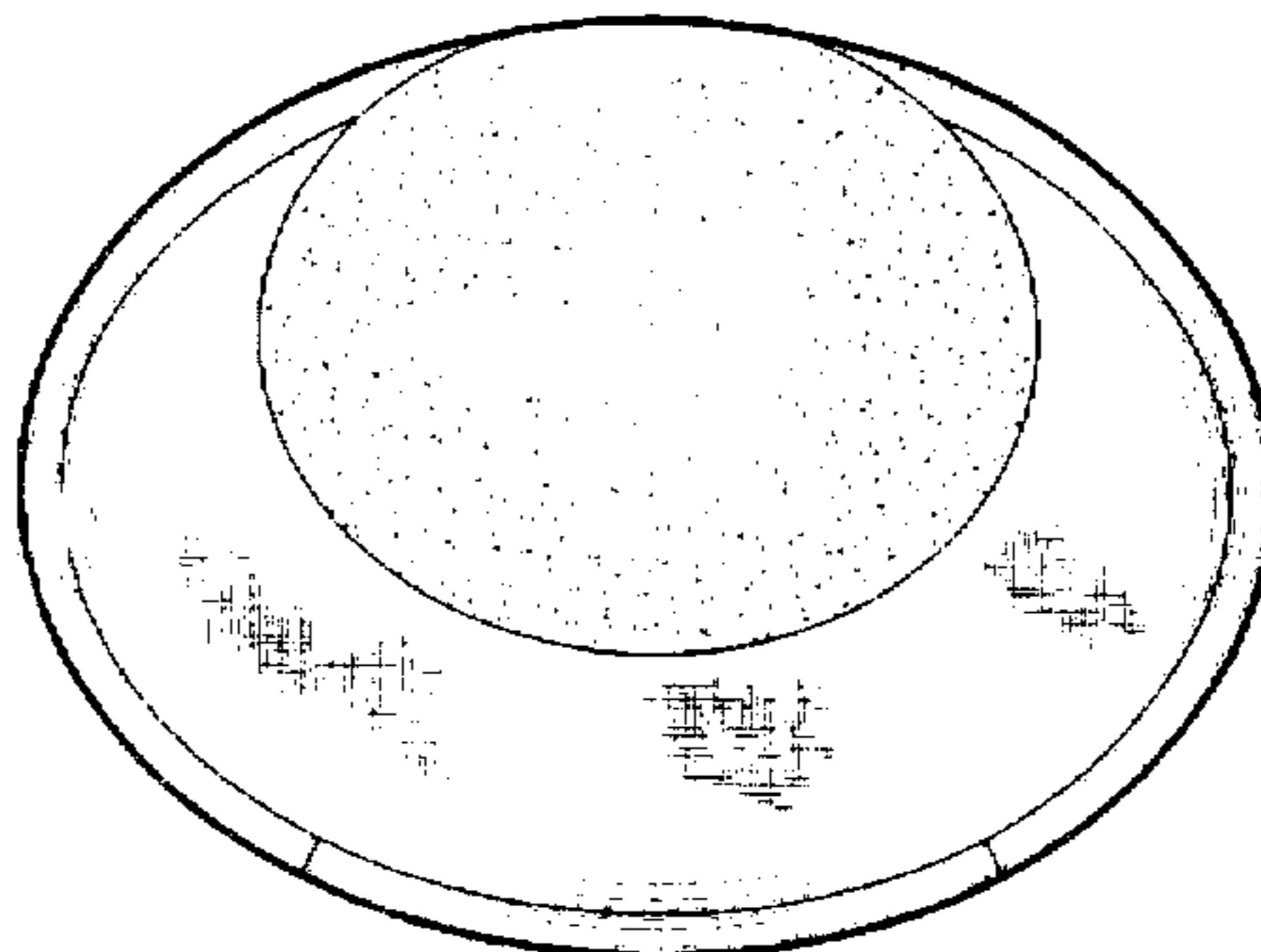
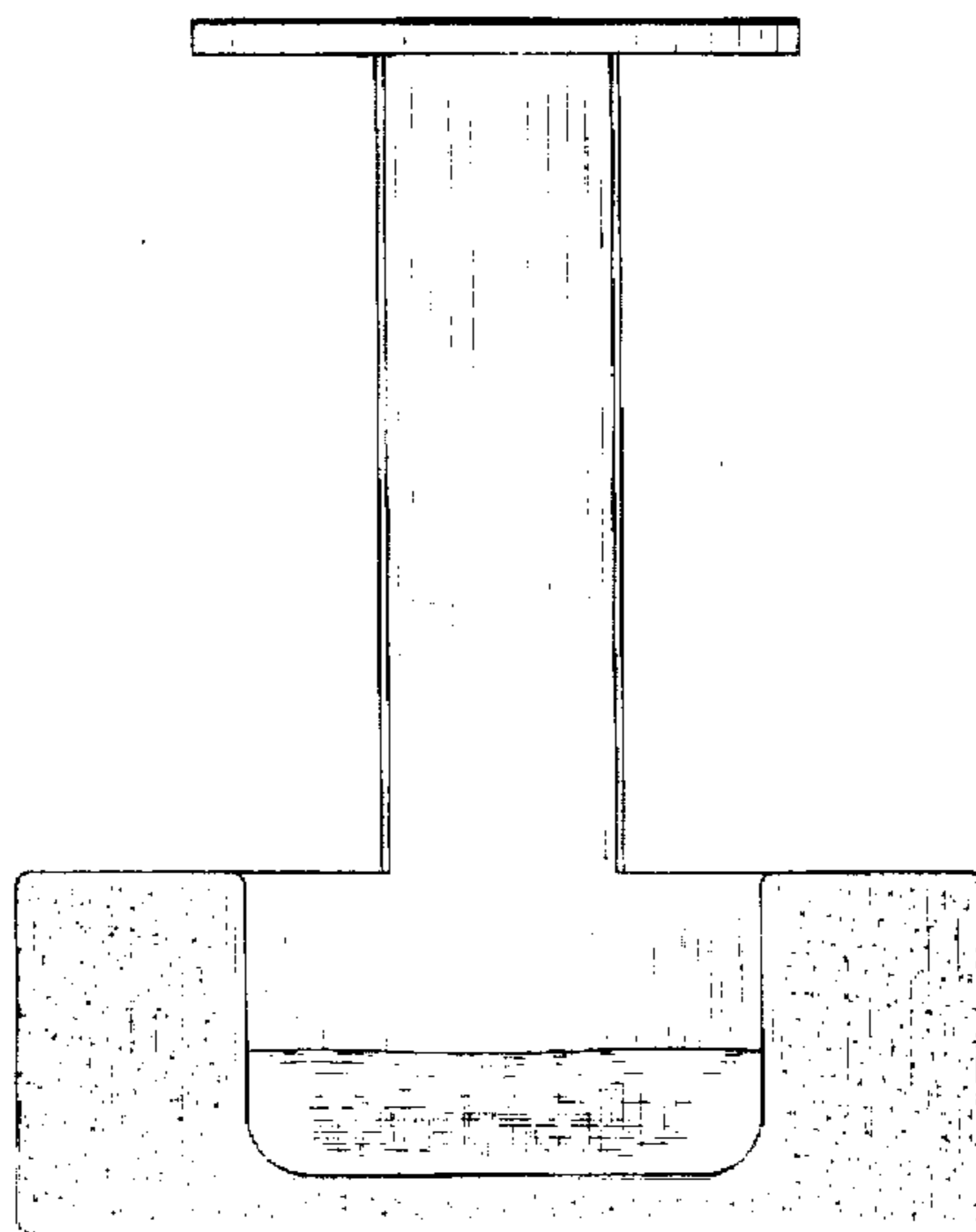

FIG. 1

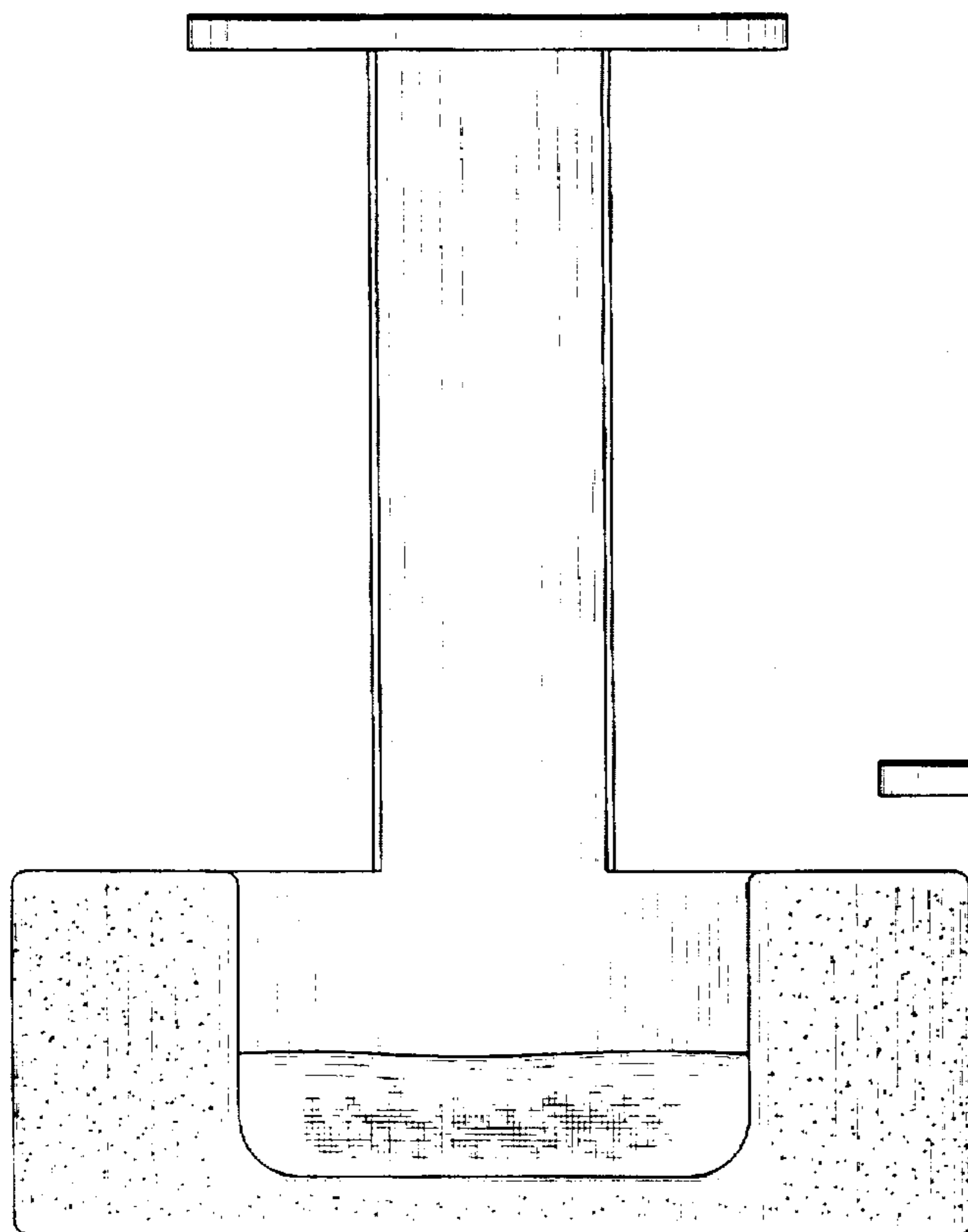

FIG. 2

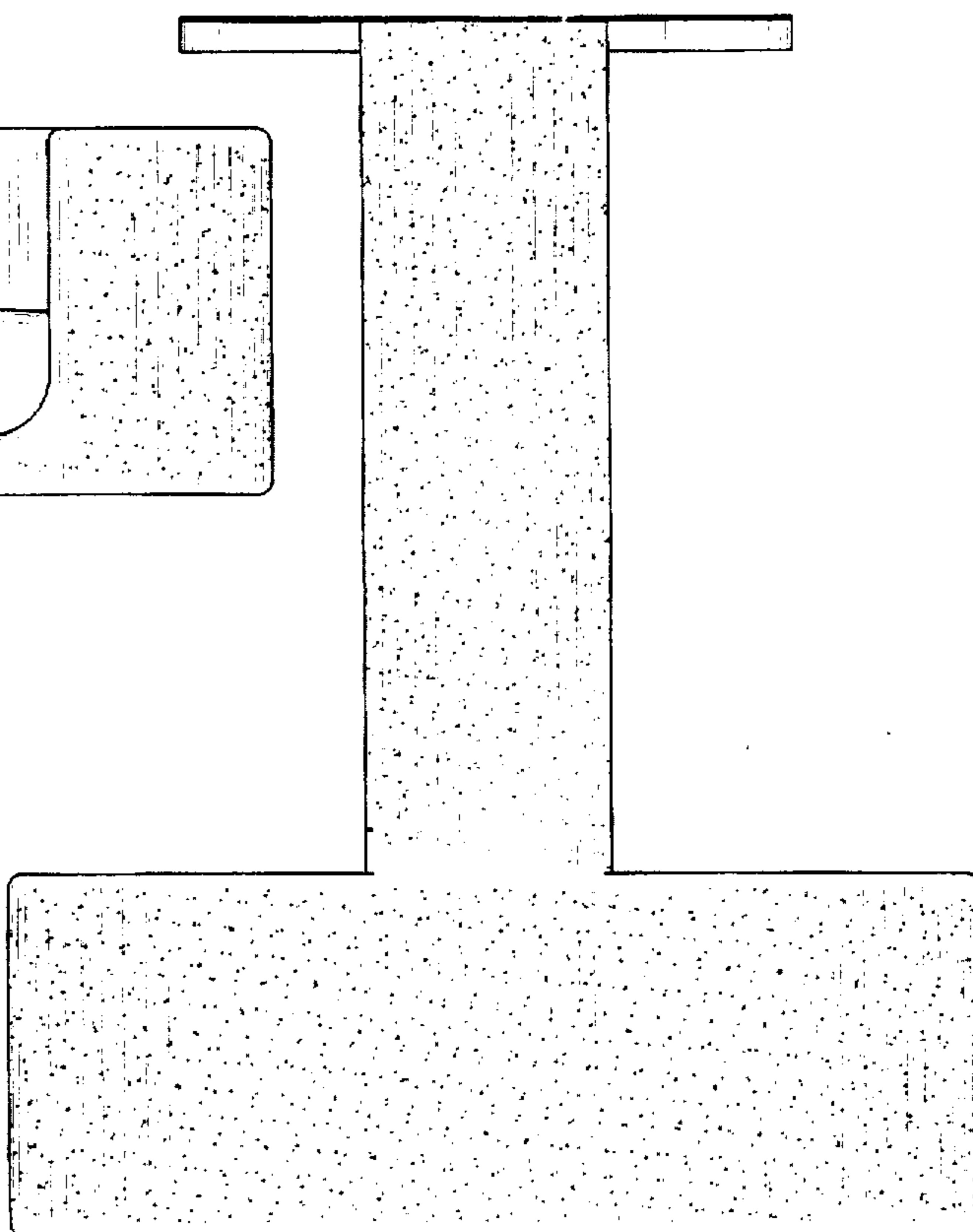

FIG. 3

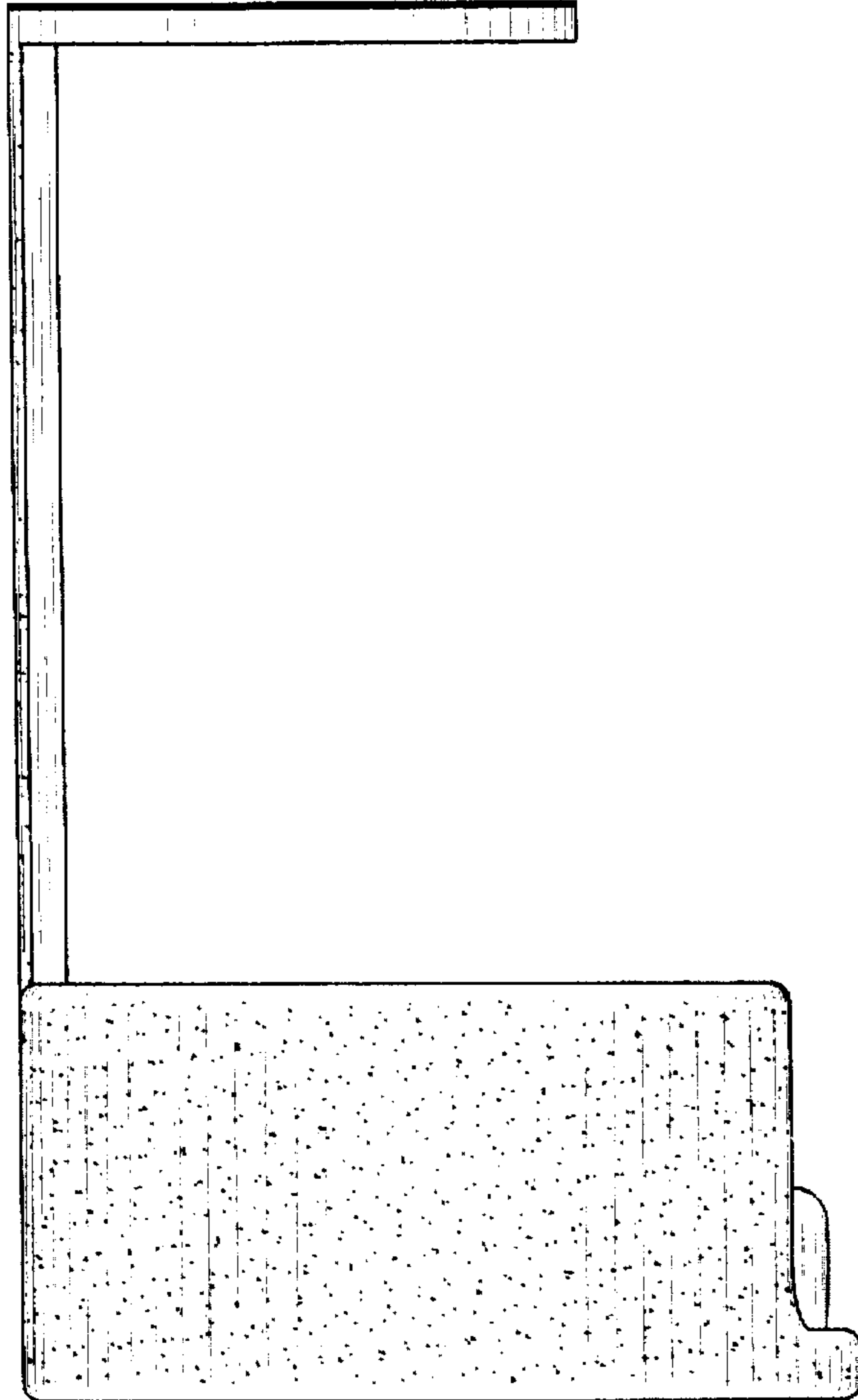

FIG. 4

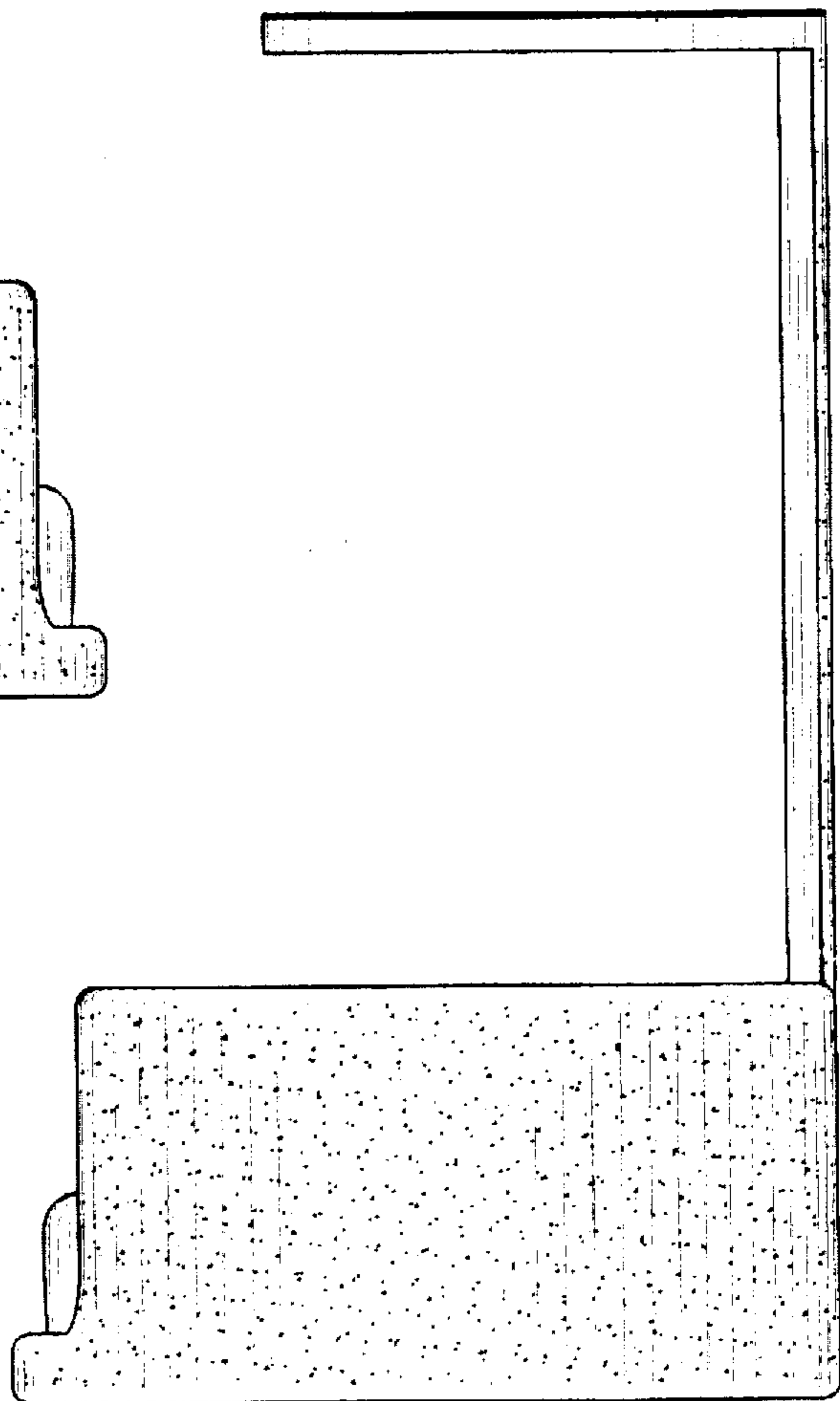

FIG. 5

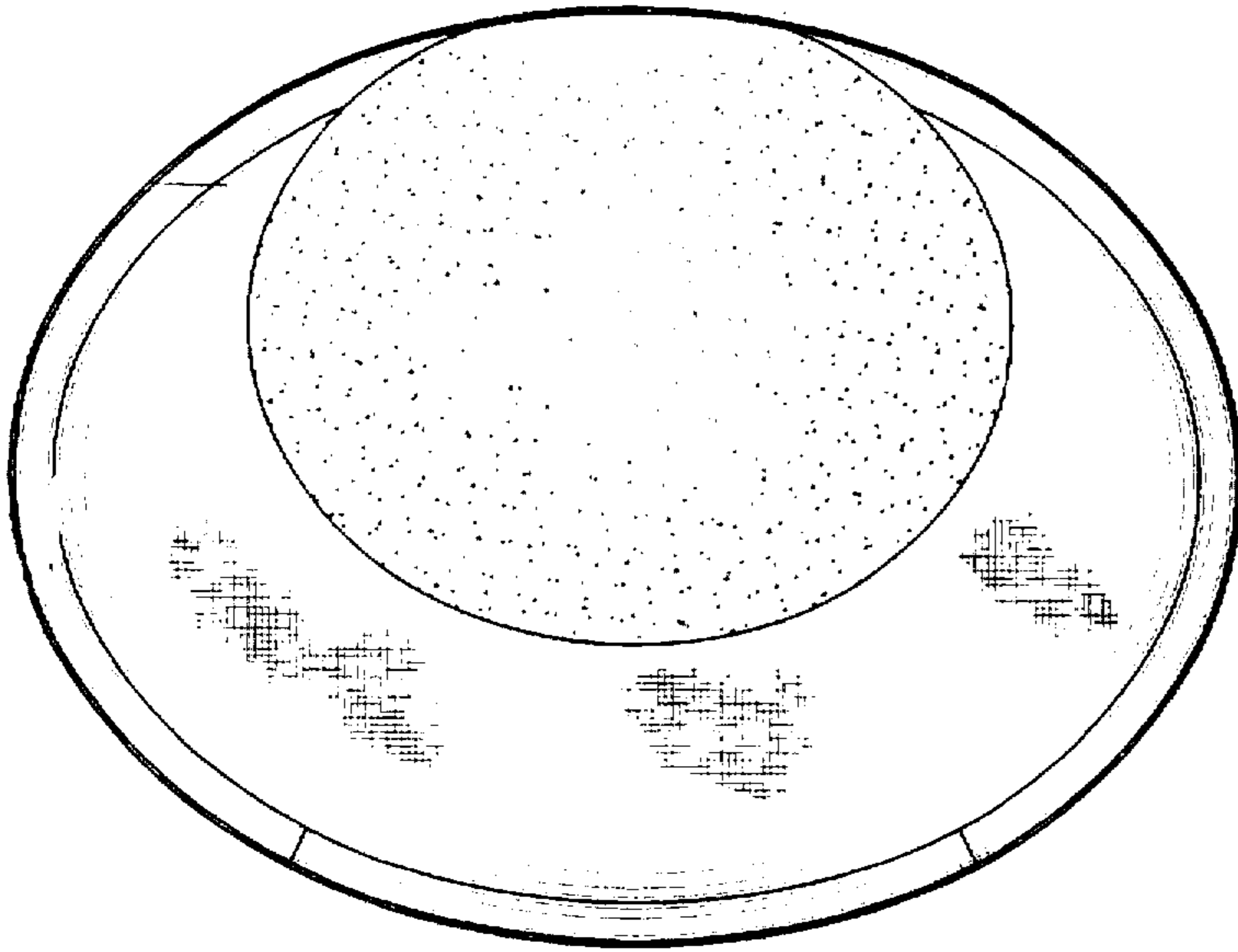

FIG. 6

