



US00D393624S

United States Patent [19]

[11] Patent Number: Des. 393,624

Shim

[45] Date of Patent: **Apr. 21, 1998

[54] BATTERY CASE

[75] Inventor: **Jae Hoon Shim**, Seoul, Rep. of Korea

[73] Assignee: **Daewoo Electronics Co., Ltd.**, Seoul, Rep. of Korea

[**] Term: 14 Years

[21] Appl. No.: 57,257

[22] Filed: Jul. 22, 1996

[30] Foreign Application Priority Data

Apr. 29, 1996 [KR] Rep. of Korea 96-8111

[51] LOC (6) Cl. 13-02

[52] U.S. Cl. D13/103; D13/119

[58] Field of Search D13/103, 119; 429/96-100, 164-170, 178

[56] References Cited

U.S. PATENT DOCUMENTS

4,161,568	7/1979	Lund	429/99
4,383,007	5/1983	Murphy	429/96 X
4,514,477	4/1985	Kobayashi	429/98
4,965,141	10/1990	Suzuki	429/99 X

4,997,731	3/1991	Machida et al.	429/164 X
5,229,220	7/1993	Stanton et al.	429/99 X
5,294,497	3/1994	Muramatsu et al.	429/97
5,431,575	7/1995	Engira	429/99 X
5,528,460	6/1996	Byrd	429/96 X
5,537,022	7/1996	Huang	429/99 X
5,607,322	3/1997	Schaub	429/100 X

Primary Examiner—Joel Sincavage
Attorney, Agent, or Firm—Zarley, McKee, Thomte, Voorhees, & Sease

[57] CLAIM

The ornamental design for a battery case, as shown and described.

DESCRIPTION

FIG. 1 is a perspective view of a battery case embodying my new design;
FIG. 2 is a front view thereof;
FIG. 3 is a rear view thereof;
FIG. 4 is a top plan view thereof;
FIG. 5 is a bottom plan view thereof;
FIG. 6 is a left side view thereof; and,
FIG. 7 is a right side view thereof.

1 Claim, 3 Drawing Sheets

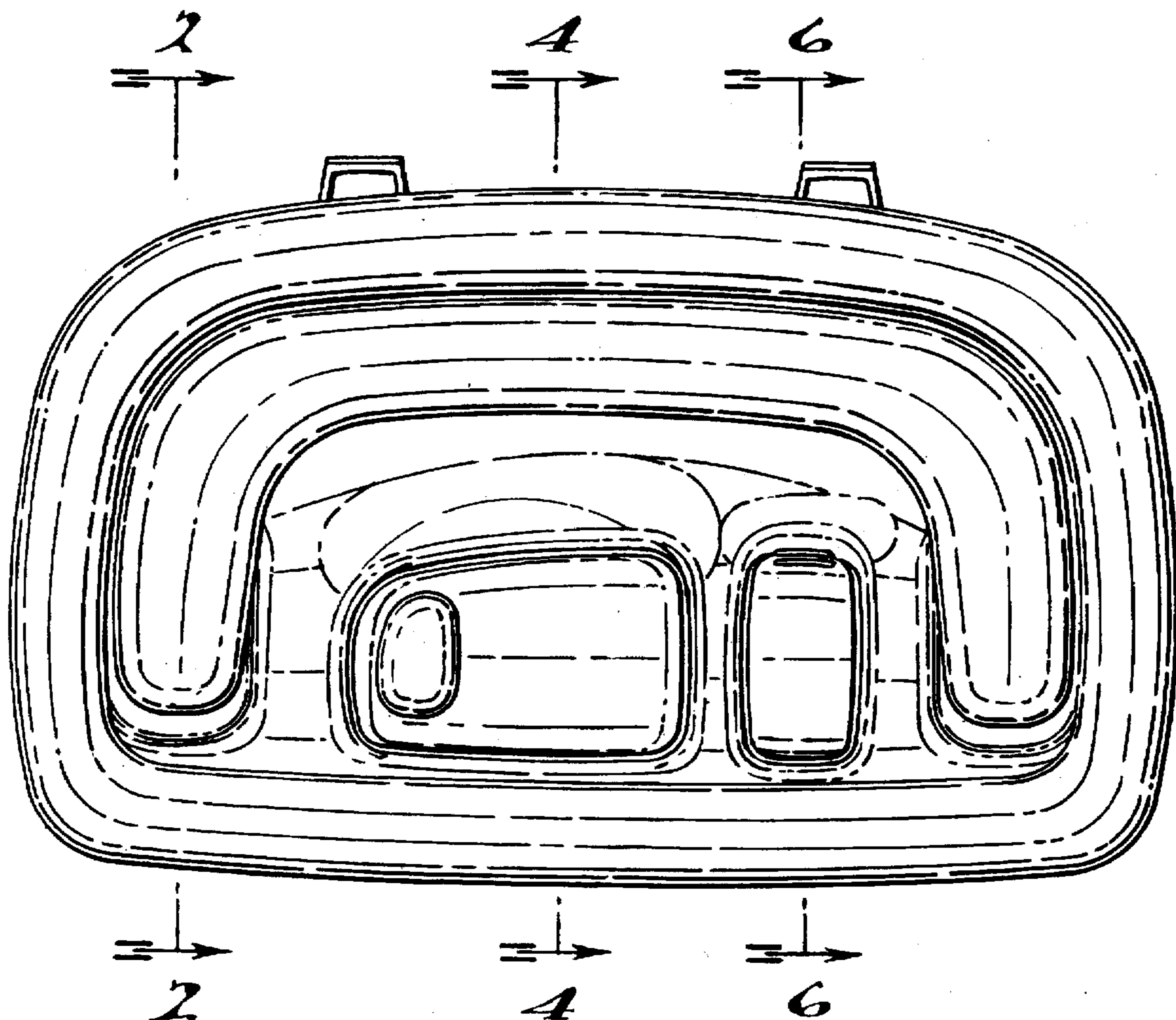

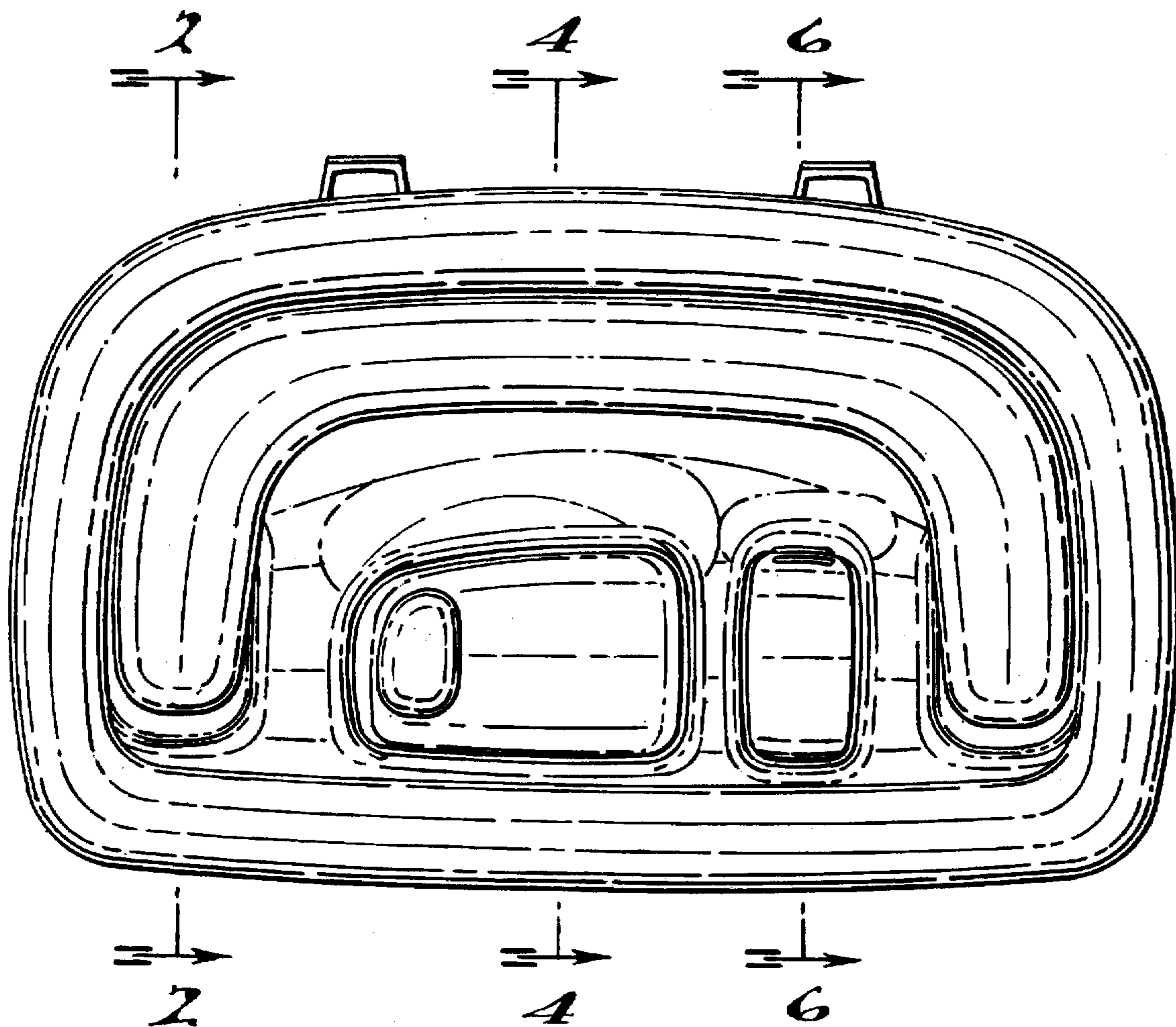

FIG. 2.

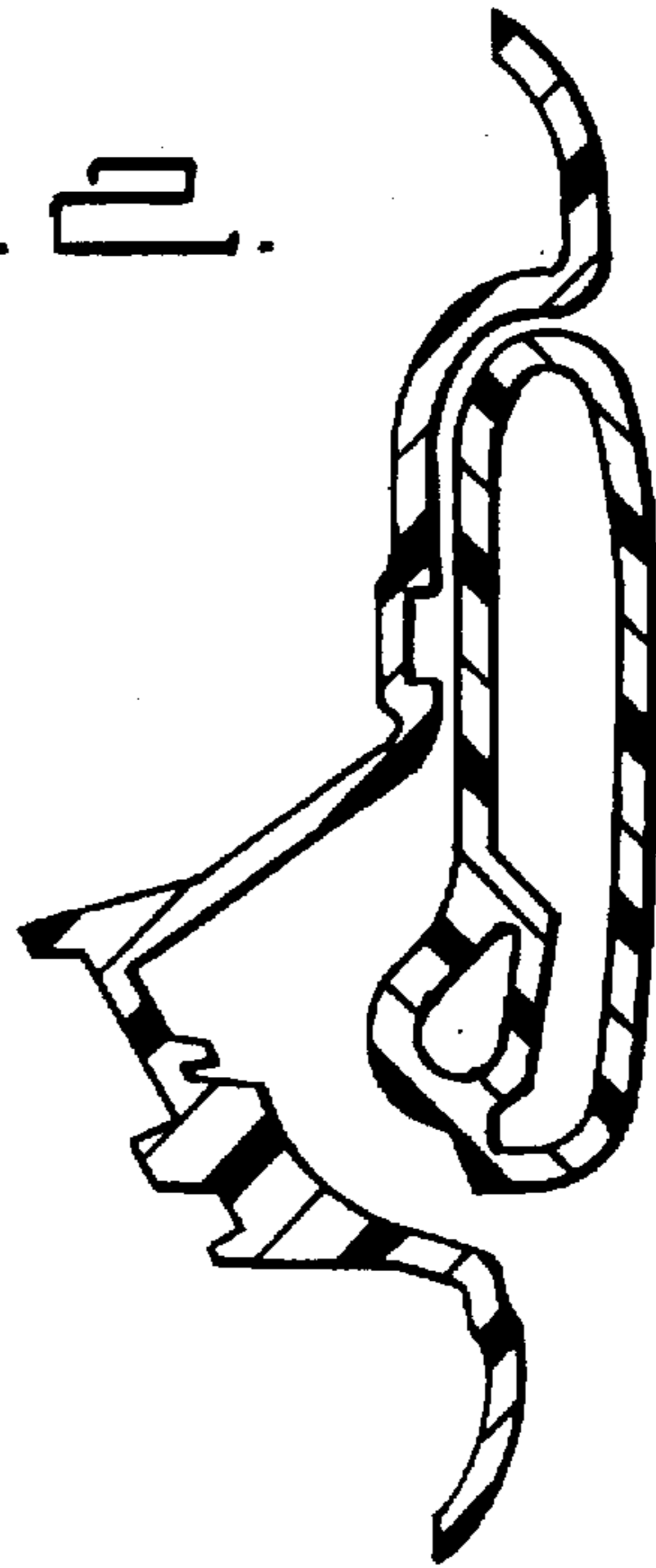

FIG. 4.

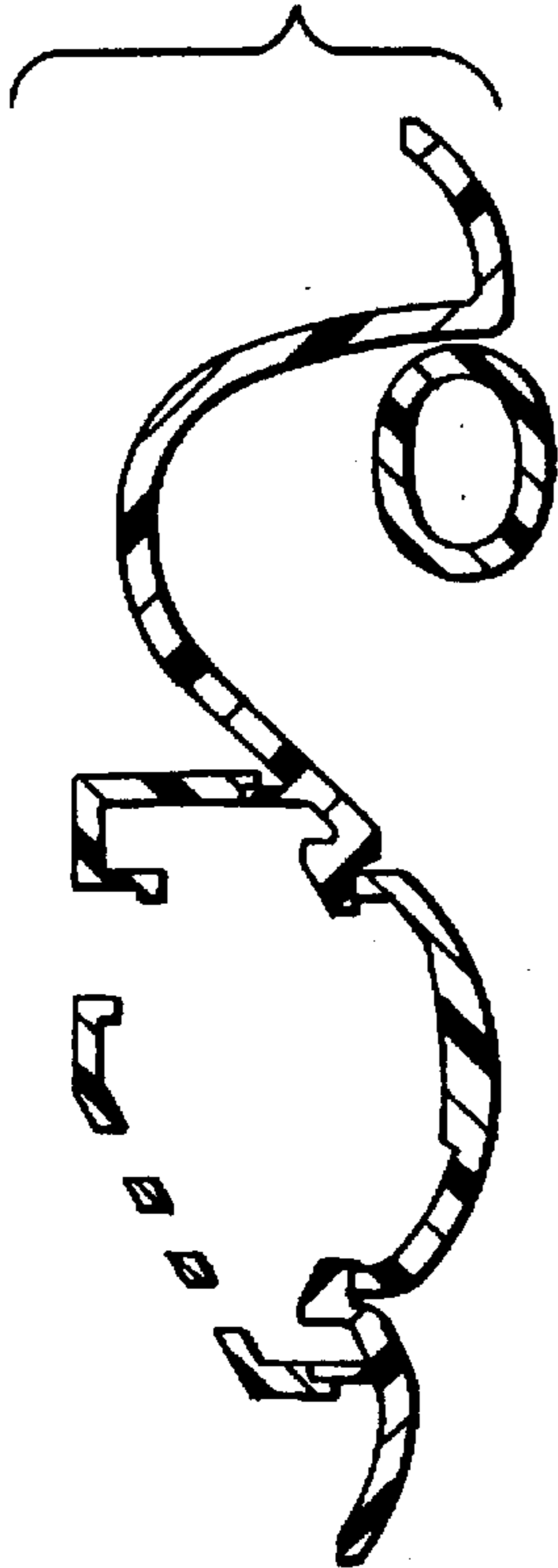

FIG. 6.

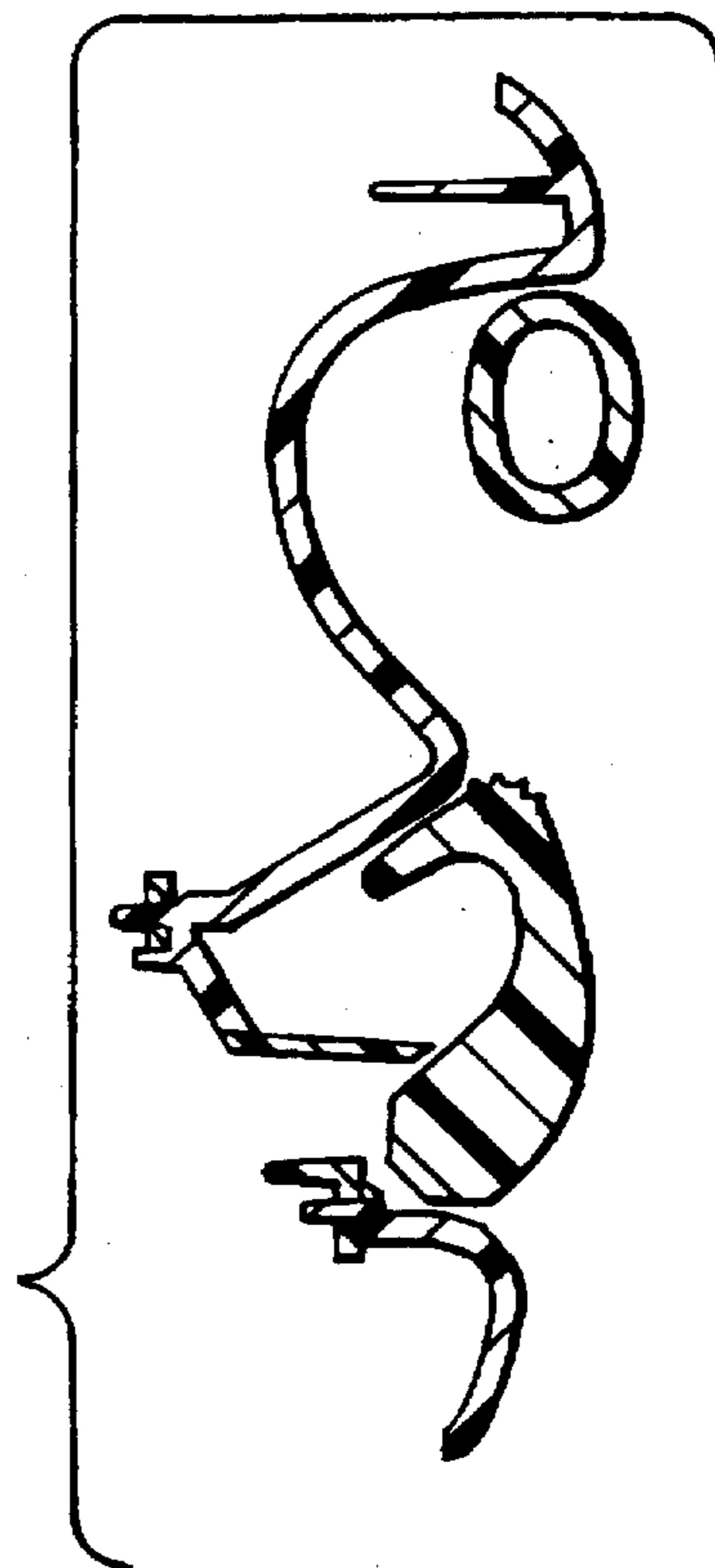

FIG. 3.

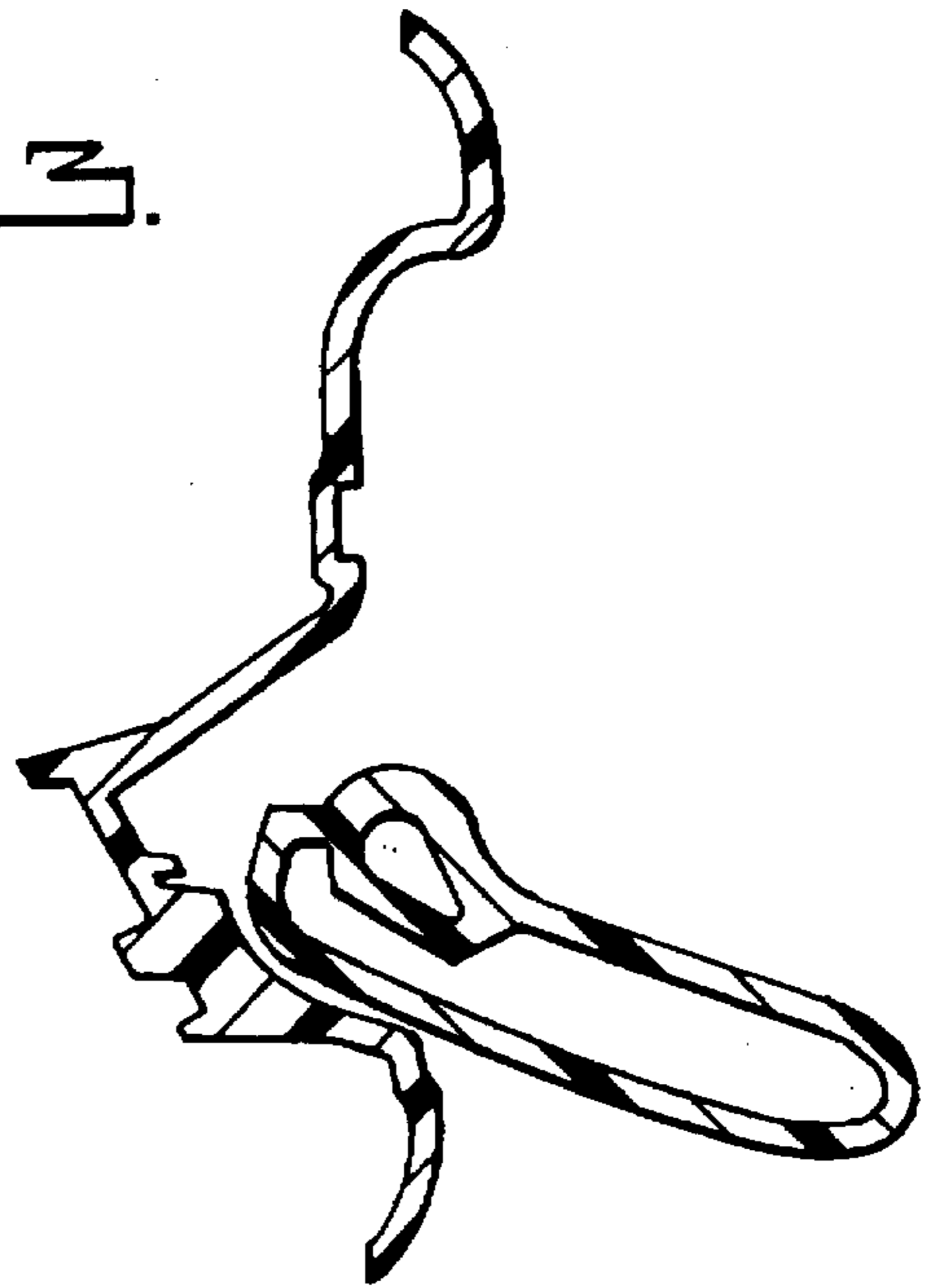

FIG. 5.

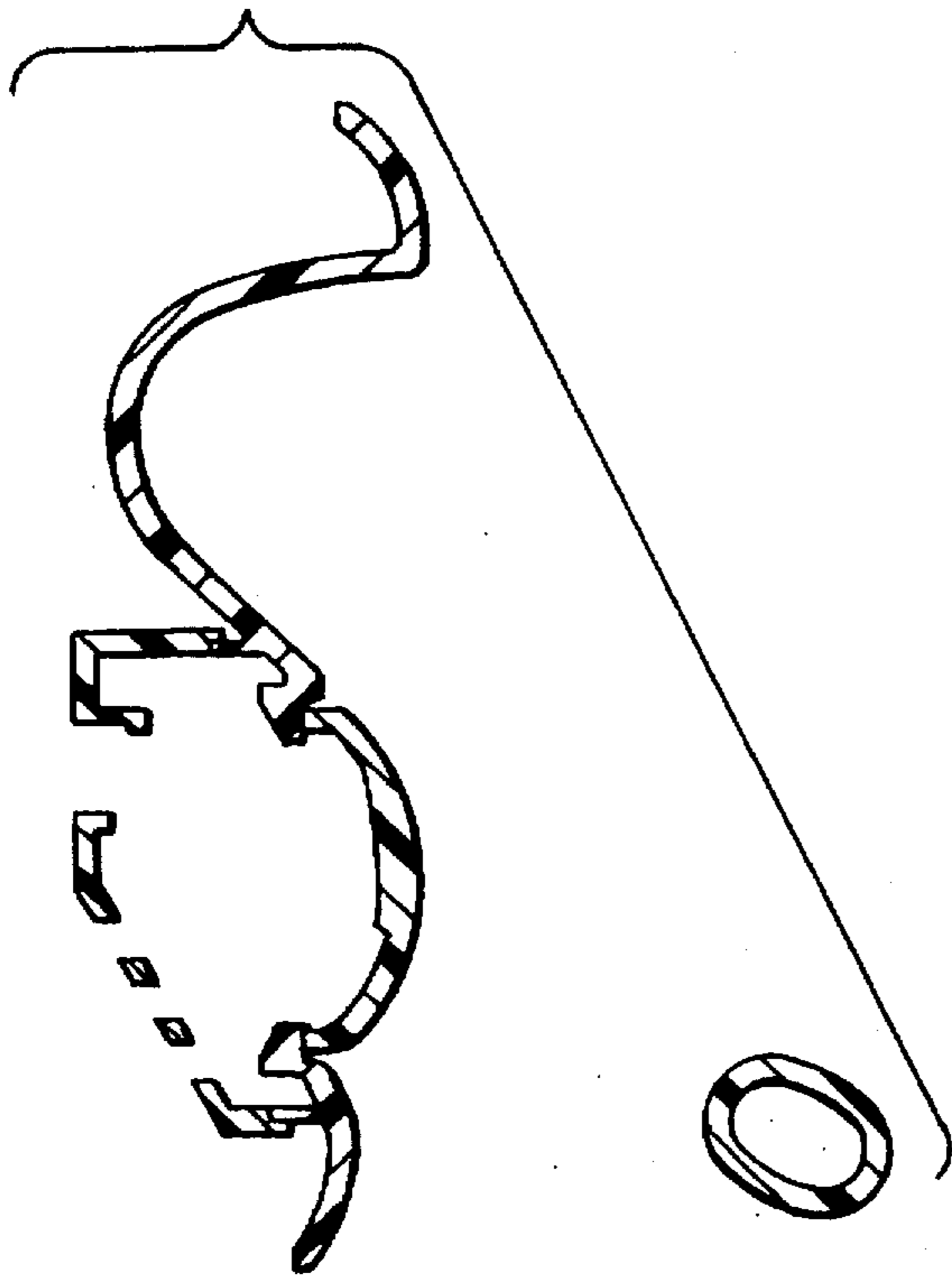
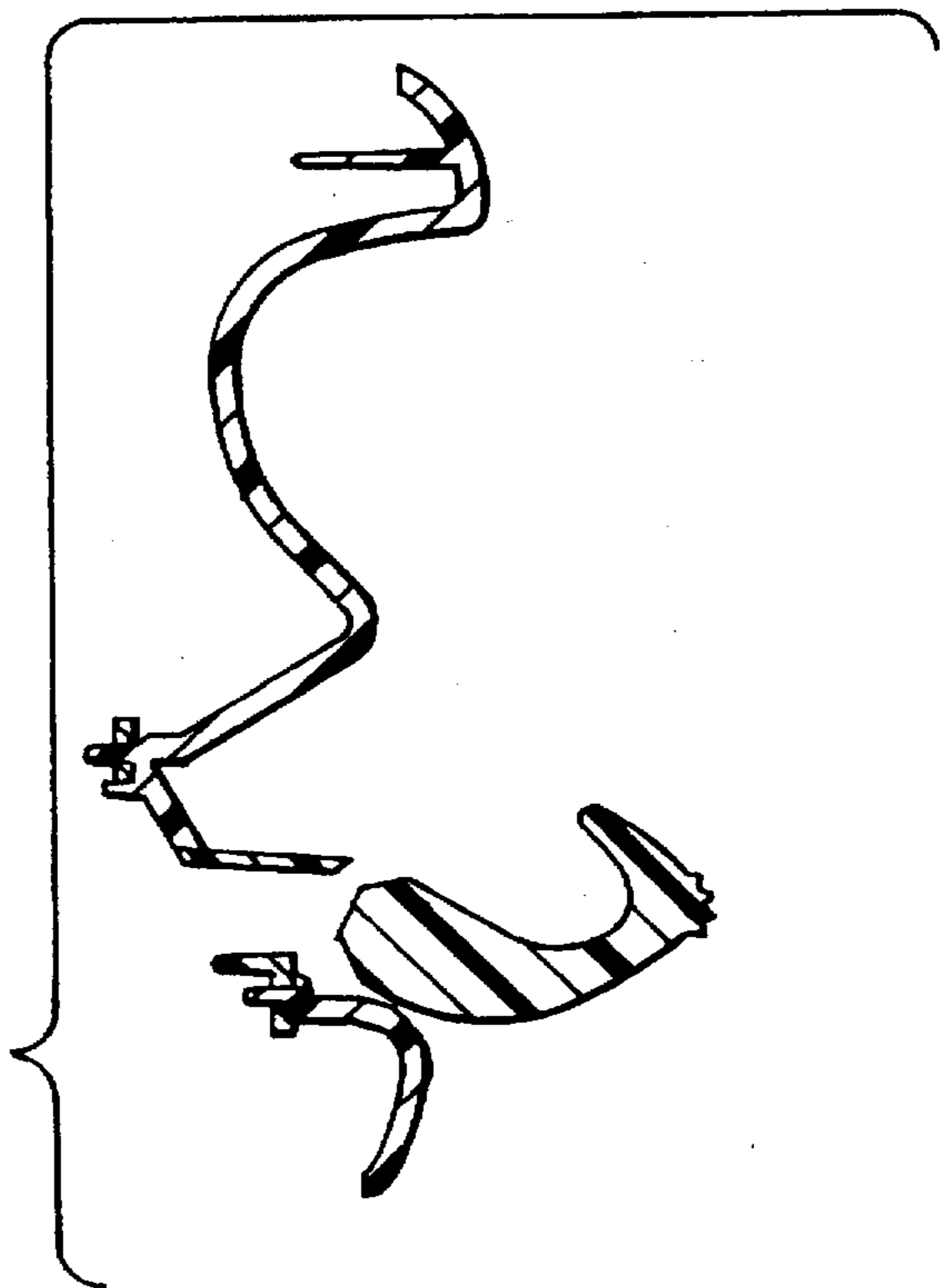

FIG. 7.



UNITED STATES PATENT AND TRADEMARK OFFICE
CERTIFICATE OF CORRECTION

Page 1 of 5

PATENT NO. : D393, 624
DATED : April 21, 1998
INVENTOR(S) : SHIM

It is certified that error appears in the above-identified patent and that said Letters Patent is hereby corrected as shown below:

On title page, showing illustrative figure should be deleted to appear as per the attached title page.

The Drawing Sheets, consisting of Figs. 1-7, should be deleted to be replaced with the Drawing Sheets, consisting of Figs 1-7, as shown on the attached pages.

Signed and Sealed this
Eighth Day of June, 1999



Q. TODD DICKINSON

Acting Commissioner of Patents and Trademarks

Attest:

Attesting Officer



US00D393624S

United States Patent [19]
Shim

[11] **Patent Number:** **Des. 393,624**
[45] **Date of Patent:** ****Apr. 21, 1998**

[54] **BATTERY CASE**
[75] **Inventor:** **Jae Hoon Shim**, Seoul, Rep. of Korea
[73] **Assignee:** **Daewoo Electronics Co., Ltd.**, Seoul, Rep. of Korea
[**] **Term:** **14 Years**

4,997,731 3/1991 Machida et al. 429/164 X
5,229,220 7/1993 Stanton et al. 429/99 X
5,294,497 3/1994 Muramatsu et al. 429/97
5,431,575 7/1995 Engira 429/99 X
5,528,460 6/1996 Byrd 429/96 X
5,537,022 7/1996 Huang 429/99 X
5,607,322 3/1997 Schaub 429/100 X

[21] **Appl. No.:** **57,257**
[22] **Filed:** **Jul. 22, 1996**
[30] **Foreign Application Priority Data**
Apr. 29, 1996 [KR] Rep. of Korea 96-8111

Primary Examiner—Joel Sincavage
Attorney, Agent, or Firm—Zarley, McKee, Thomte, Voorhees, & Sease

[51] **LOC (6) Cl.** **13-02**
[52] **U.S. Cl.** **D13/103; D13/119**
[58] **Field of Search** **D13/103, 119;**
429/96-100, 164-170, 178

[57] **CLAIM**
The ornamental design for a battery case, as shown and described.

[56] **References Cited**
U.S. PATENT DOCUMENTS
4,161,568 7/1979 Lund 429/99
4,383,007 5/1983 Murphy 429/96 X
4,514,477 4/1985 Kobayashi 429/98
4,965,141 10/1990 Suzuki 429/99 X

DESCRIPTION
FIG. 1 is a perspective view of a battery case embodying my new design;
FIG. 2 is a front view thereof;
FIG. 3 is a rear view thereof;
FIG. 4 is a top plan view thereof;
FIG. 5 is a bottom plan view thereof;
FIG. 6 is a left side view thereof; and,
FIG. 7 is a right side view thereof.

1 Claim, 3 Drawing Sheets

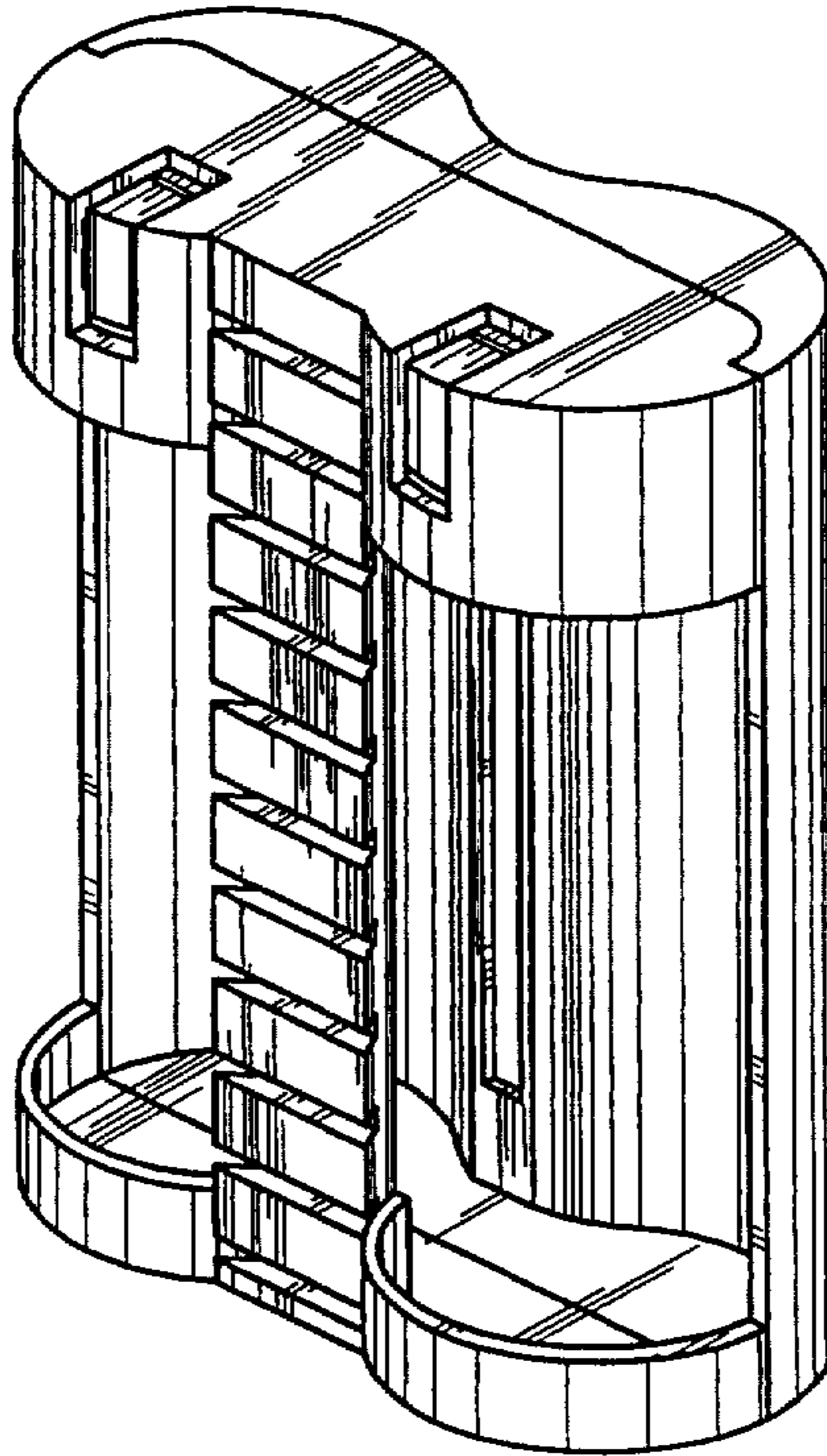

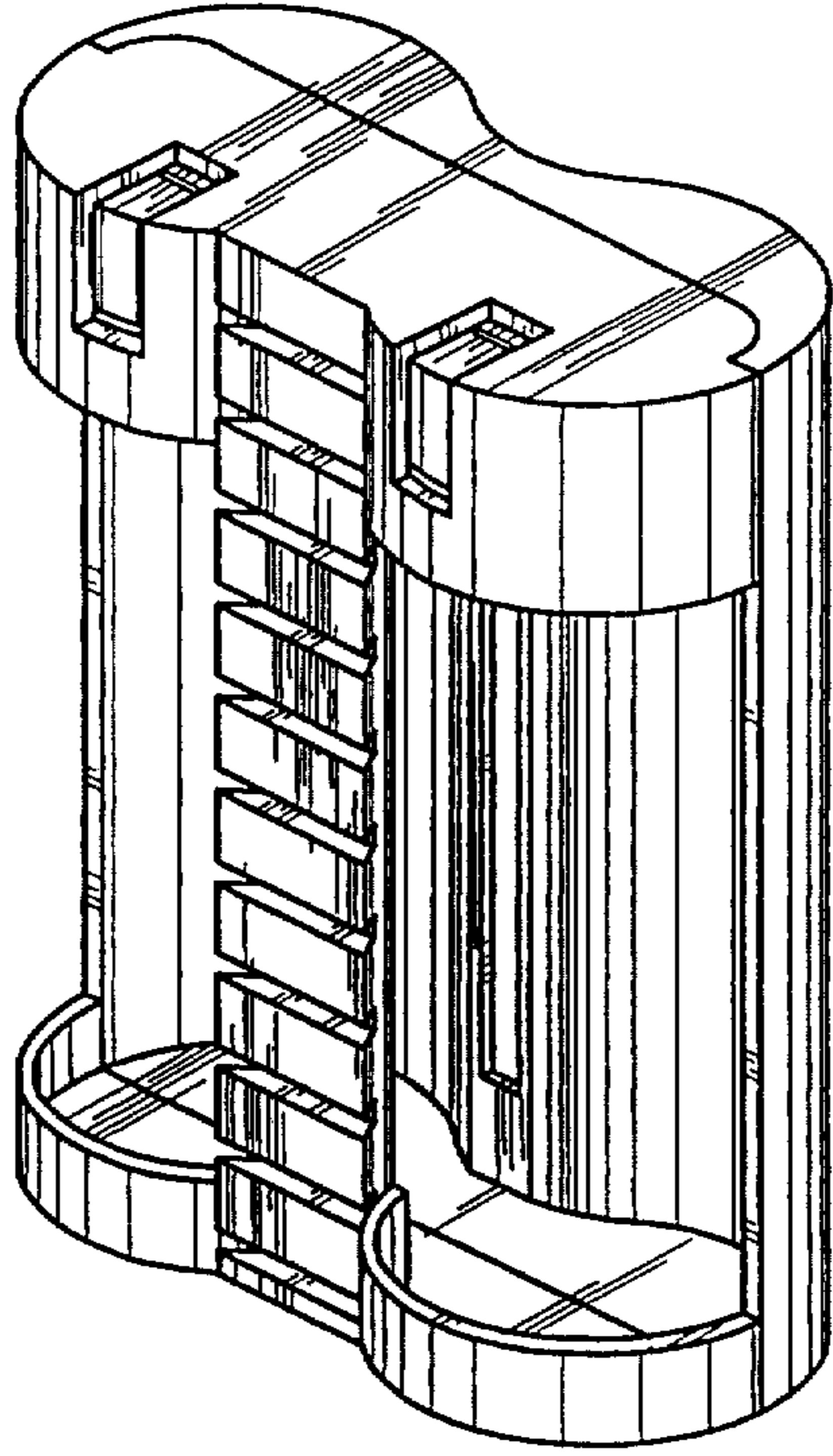

FIG. 1

FIG. 2

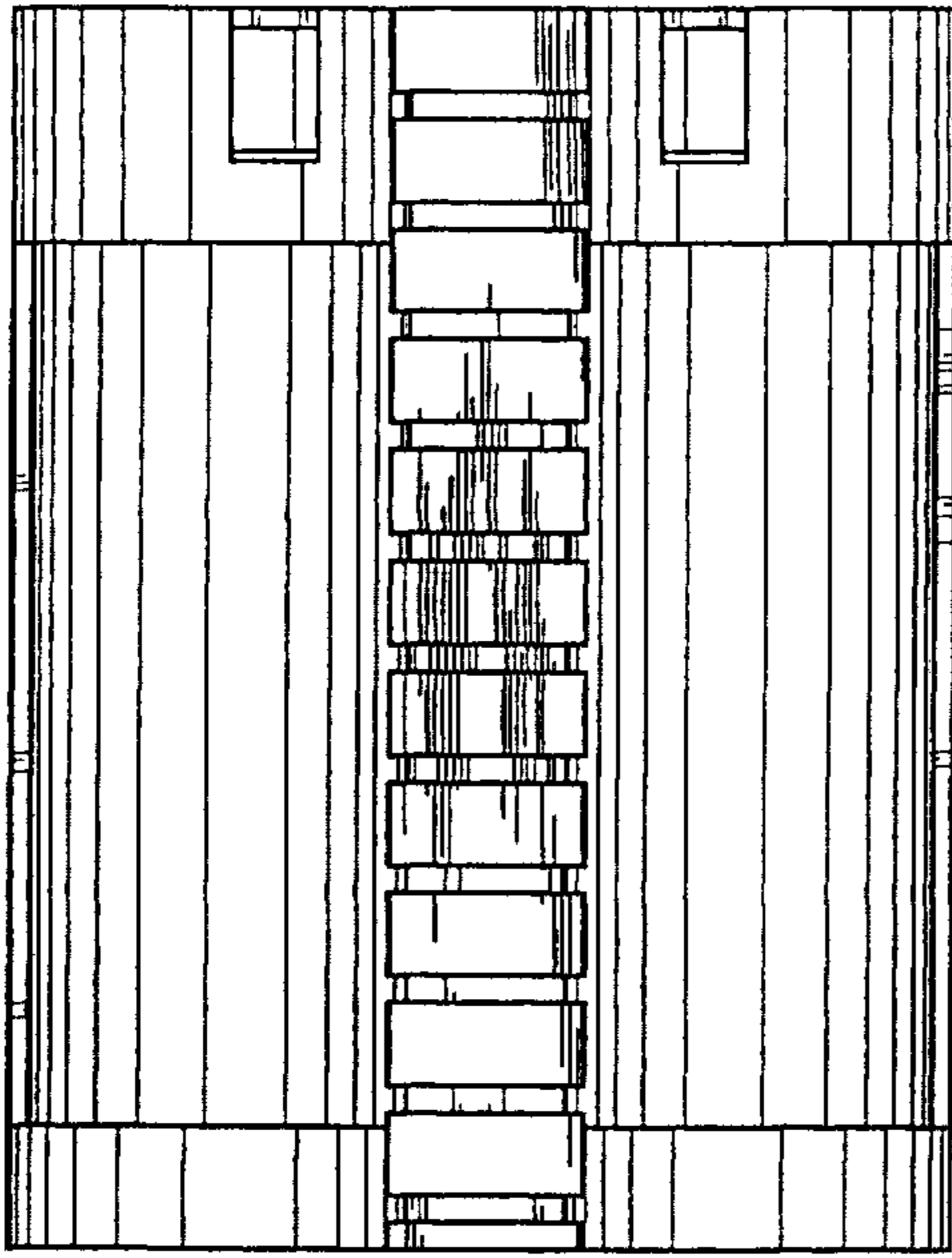

FIG. 3

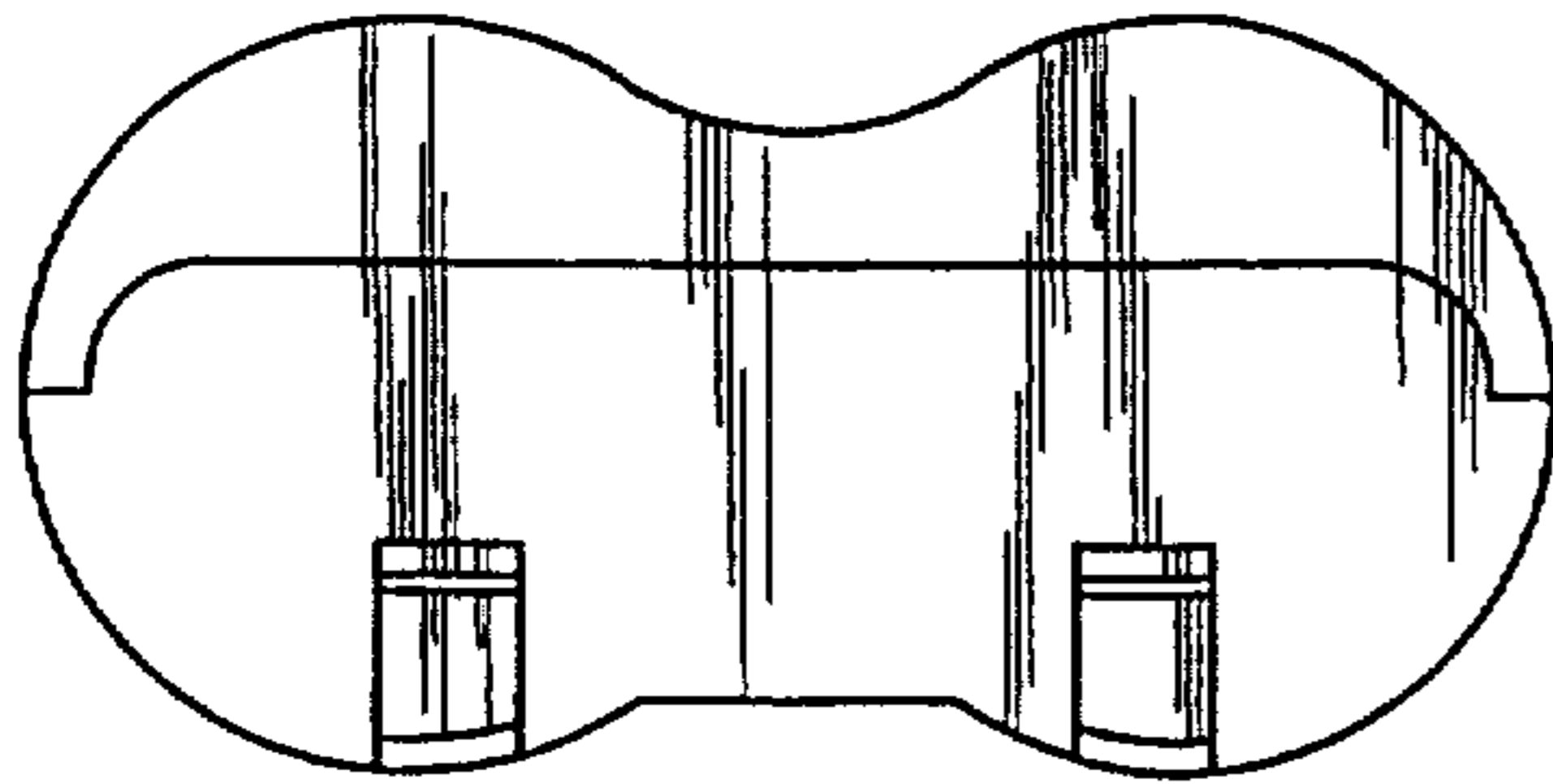
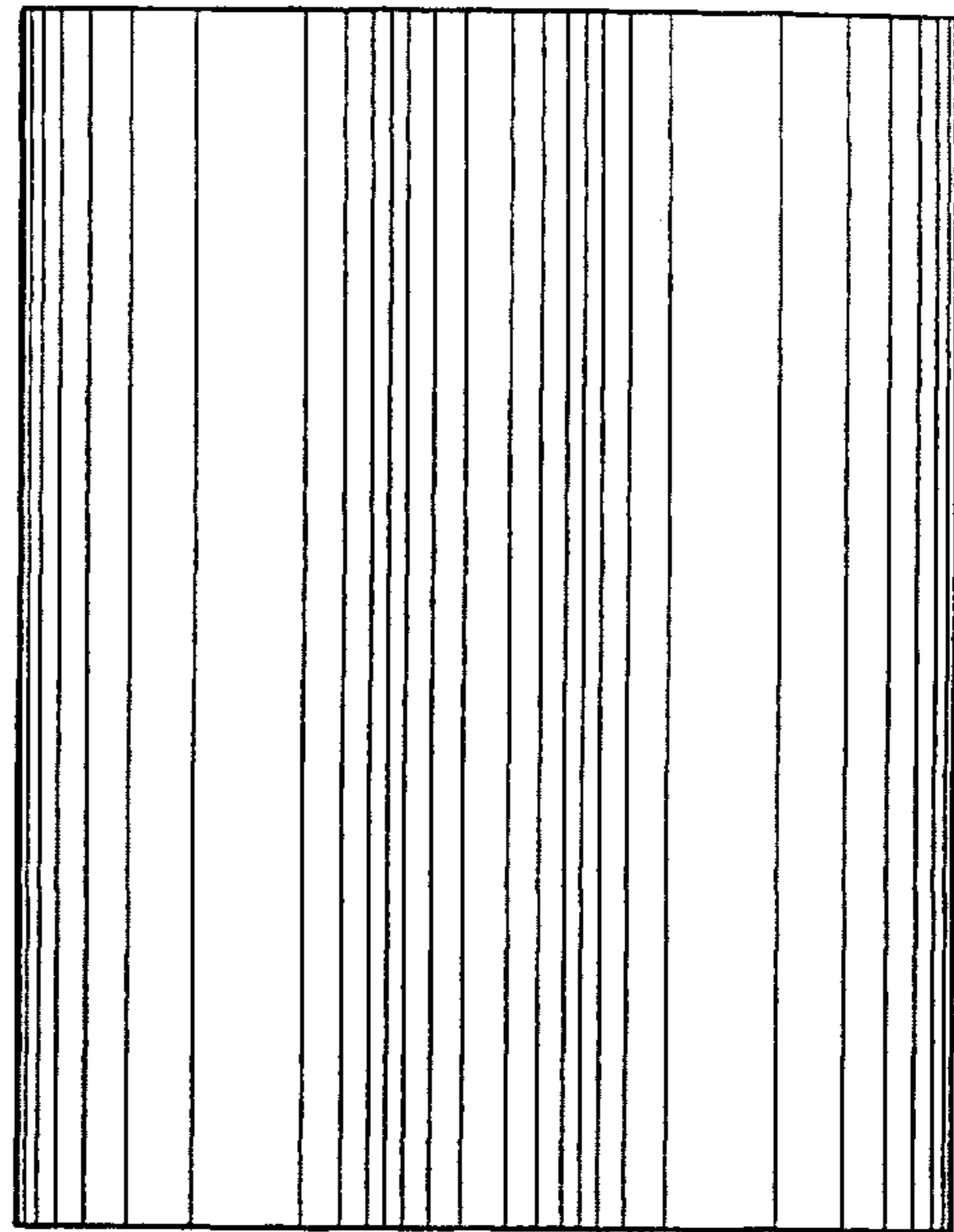

FIG. 4

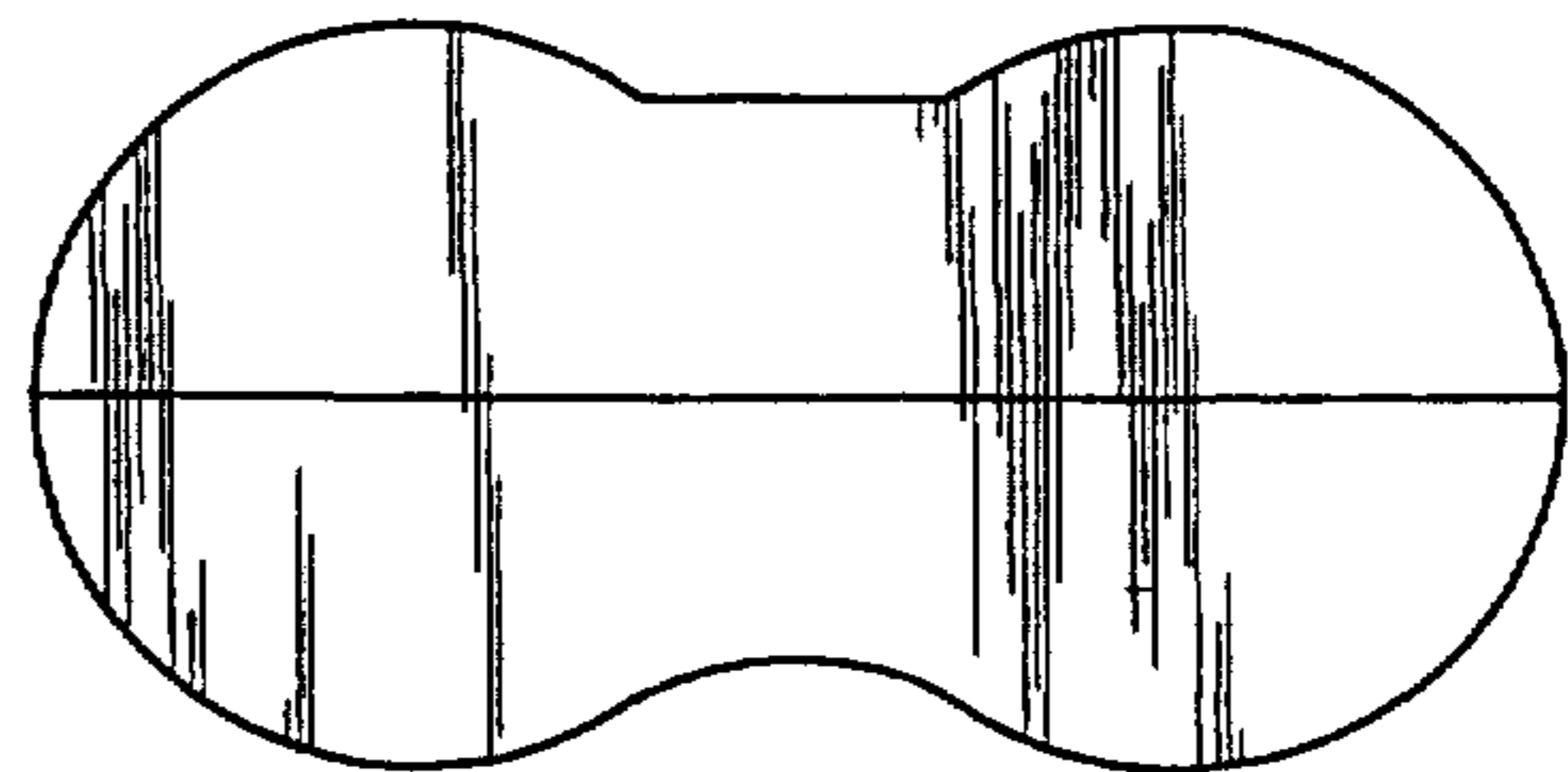

FIG. 5

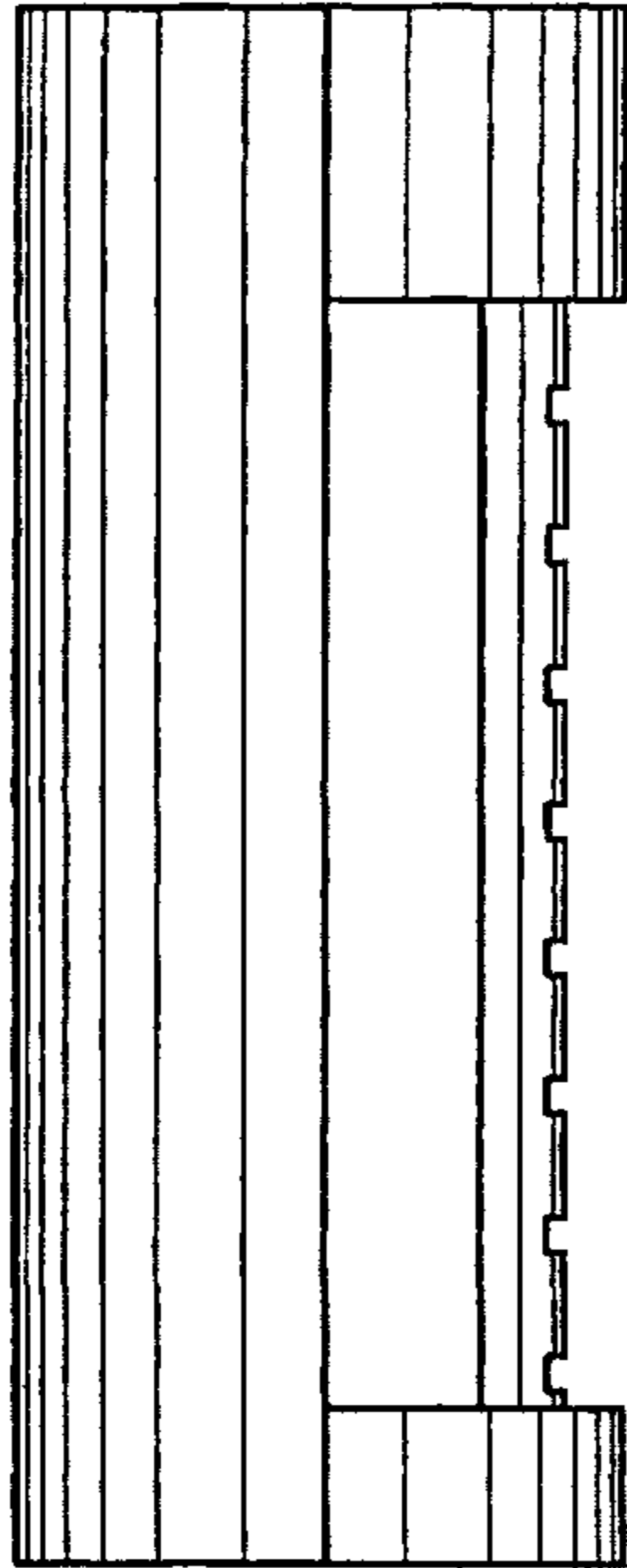

FIG. 6

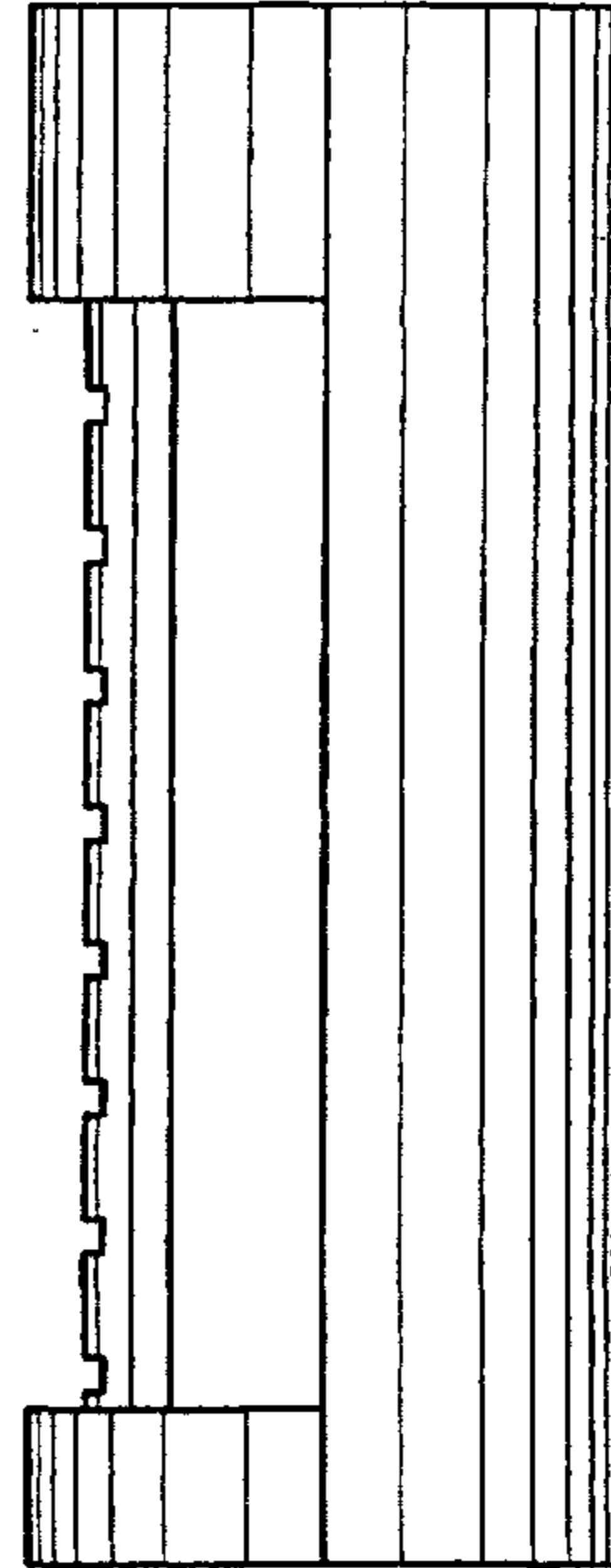

FIG. 7