

US00D392358S

United States Patent [19]

Brouillard et al.

[11] Patent Number: **Des. 392,358**

[45] Date of Patent: ****Mar. 17, 1998**

[54] **CHASSIS DESIGN FOR INLINE SKATES**

[75] Inventors: **Alain Brouillard; Daniel Thibault,**
both of Montreal, Canada

[73] Assignee: **Sport Maska, Inc.,** Quebec, Canada

[**] Term: **14 Years**

[21] Appl. No.: **48,347**

[22] Filed: **Dec. 26, 1995**

[51] LOC (6) Cl. **21-02**

[52] U.S. Cl. **D21/226**

[58] Field of Search **D21/224-227;**
280/11.19, 11.2, 11.22, 11.23, 11.27

[56] **References Cited**

U.S. PATENT DOCUMENTS

D. 301,908	6/1989	Olson et al.	D21/226
D. 321,393	11/1991	Olson et al.	D21/226
D. 323,540	1/1992	Graham	D21/225
D. 324,713	3/1992	Rubin	D21/226
D. 325,418	4/1992	McNamara	D21/226
D. 334,225	3/1993	Graham	D21/226
D. 359,332	6/1995	Chang	D21/226
D. 363,964	11/1995	Chen	D21/226

D. 367,510	2/1996	Losi, II	D21/226
5,253,883	10/1993	Modlenhauer	280/11.22
5,330,208	7/1994	Charron et al.	280/11.22
5,408,763	4/1995	Sartor et al.	280/11.22
5,415,419	5/1995	Bourque	280/11.22
5,460,390	10/1995	Miller	280/11.22
5,470,085	11/1995	Meibock et al.	280/11.22

Primary Examiner—Raphael Barkai
Attorney, Agent, or Firm—Dick and Harris

[57] **CLAIM**

The ornamental design for a chassis design for inline skates, as shown and described.

DESCRIPTION

FIG. 1 is a front elevational view of the chassis design for inline skates showing a new ornamental design therefor; FIG. 2 is a back elevational view thereof; FIG. 3 is a top plan view thereof; FIG. 4 is a bottom plan view thereof; FIG. 5 is a left side elevational view thereof; and, FIG. 6 is a right side elevational view thereof. The broken line showing of the boot in FIGS. 1-6 is for illustrative purposes only and forms no part of the claimed design.

1 Claim, 2 Drawing Sheets

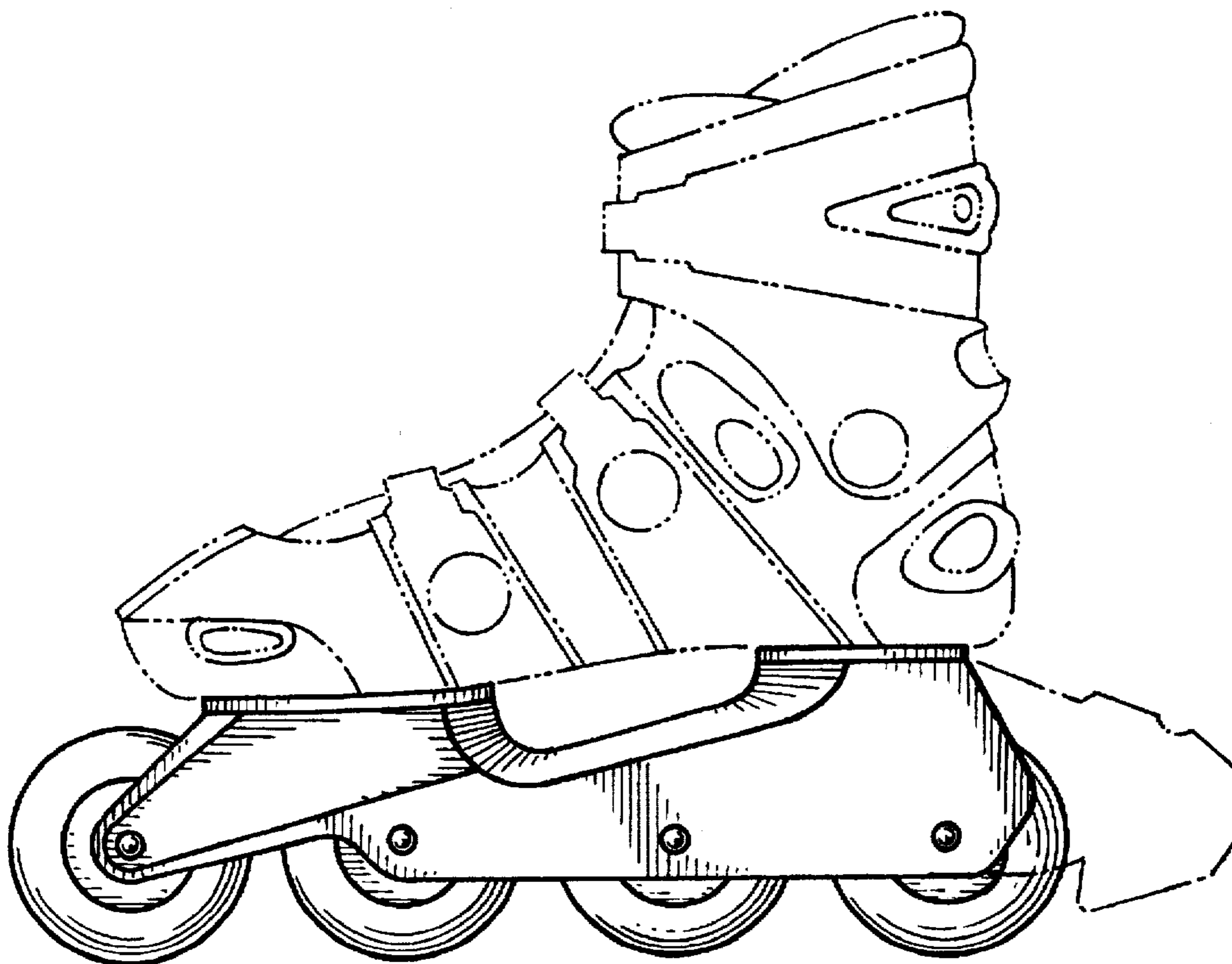

Fig 1

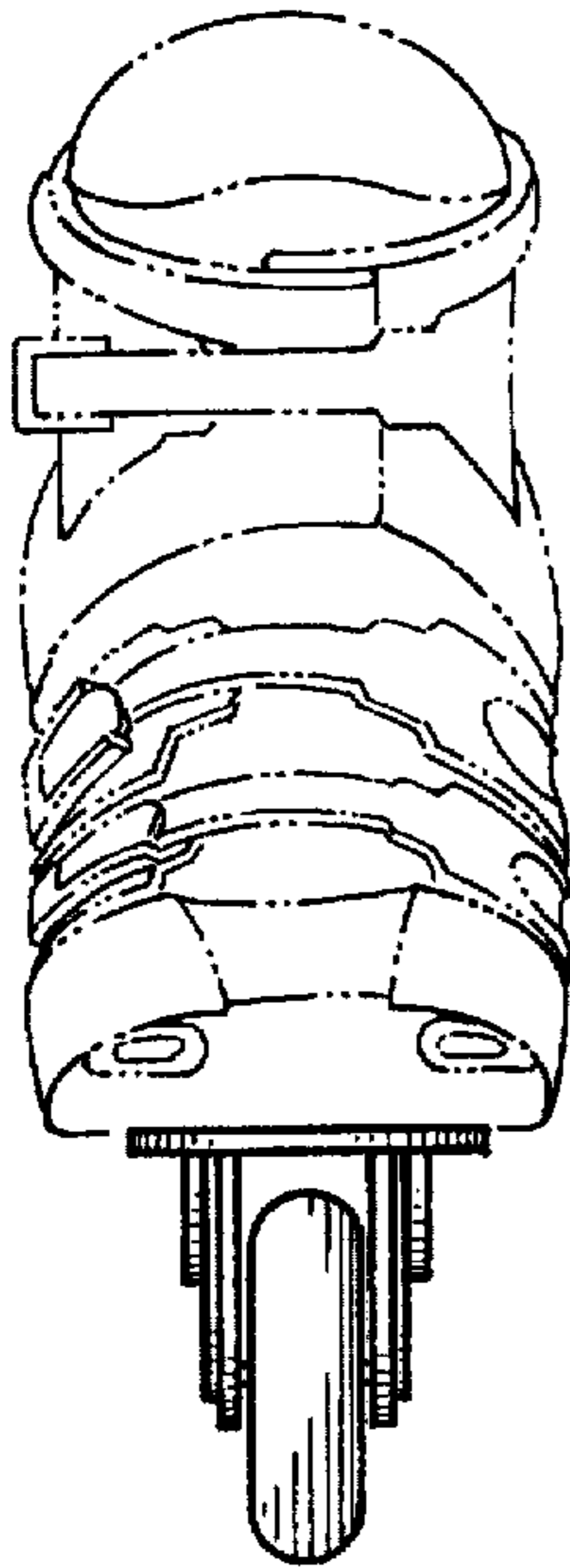

Fig 2

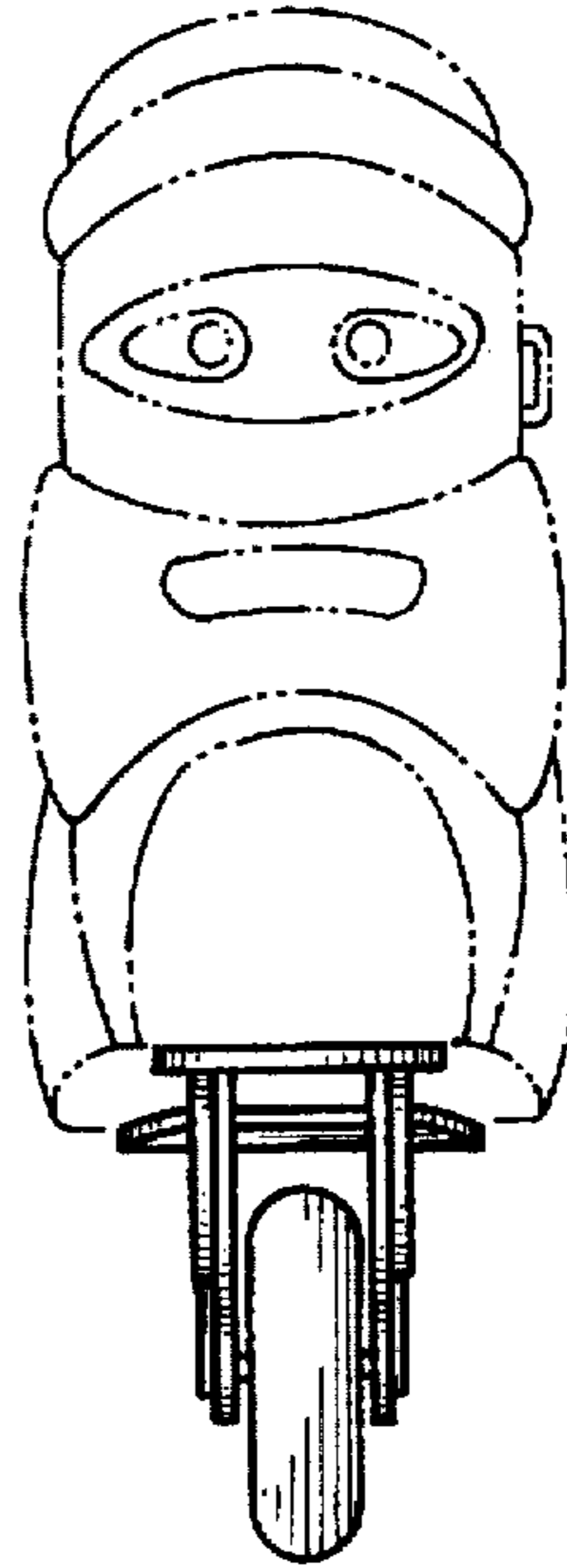

Fig 3

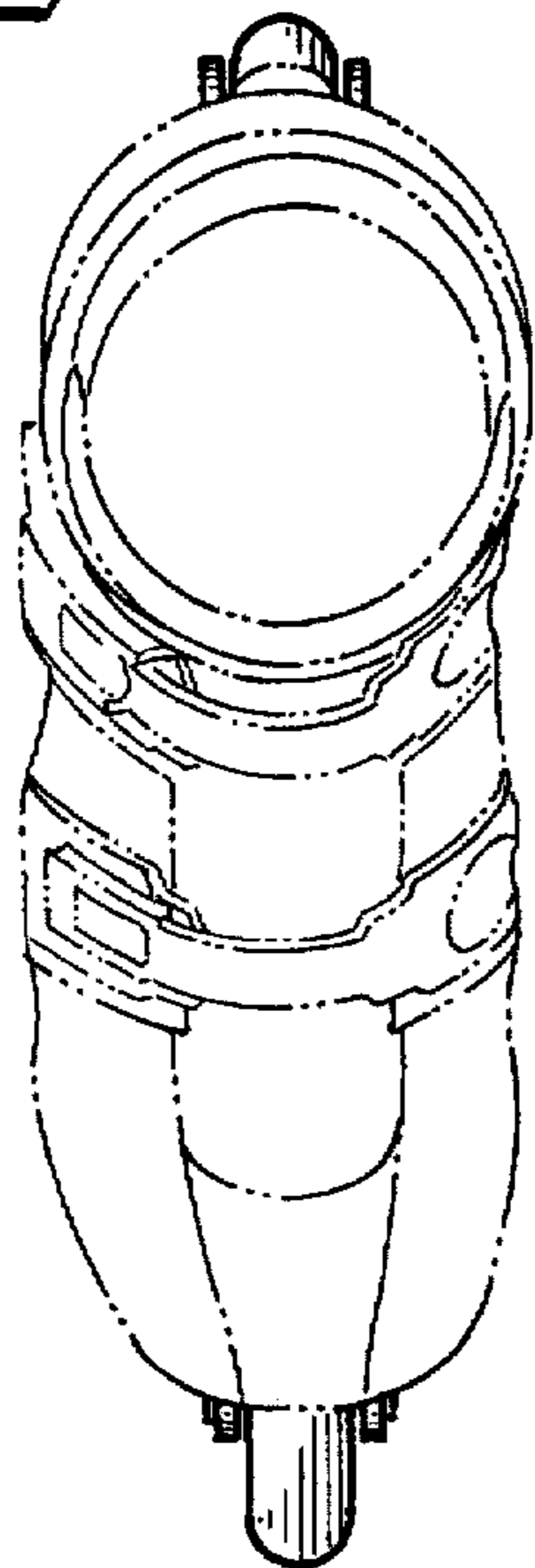

Fig 4

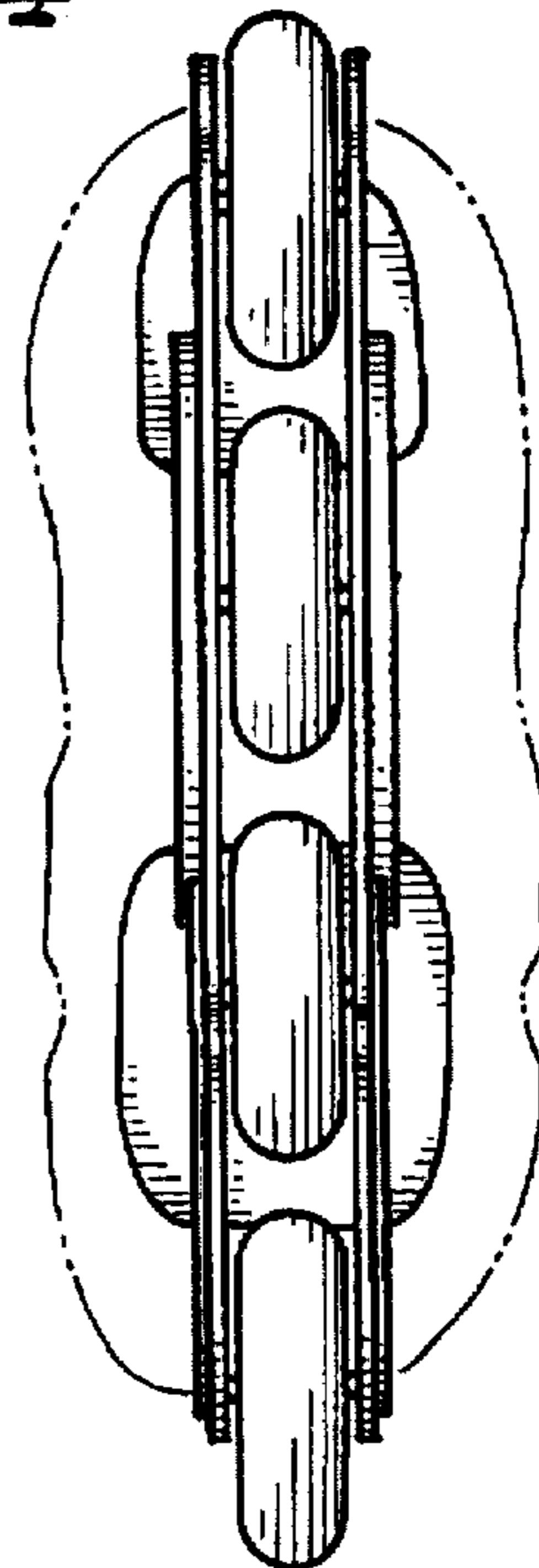

Fig 5

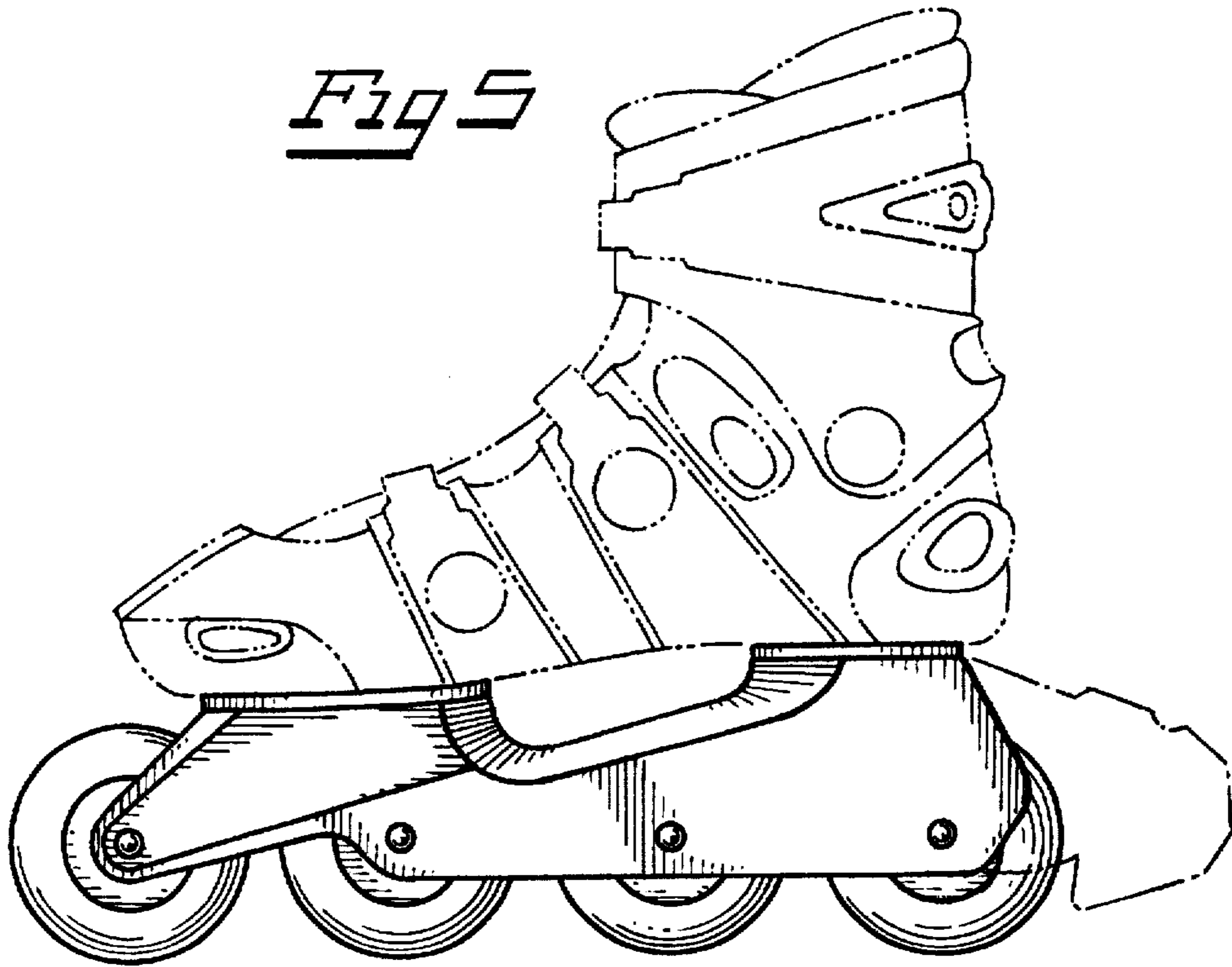

Fig 6

