



US00D391348S

United States Patent [19]
Borgesen

[11] **Patent Number: Des. 391,348**
[45] **Date of Patent: **Feb. 24, 1998**

[54] **FUEL FILTER ADAPTER**

[75] Inventor: **Kjell Borgesen**, Tysber, Norway
[73] Assignee: **D. P. Service A/S**, Tysber, Norway
[**] Term: **14 Years**

Primary Examiner—Alan P. Douglas
Assistant Examiner—Robin V. Taylor
Attorney, Agent, or Firm—Ryan M. Fountain

[21] Appl. No.: **22,520**
[22] Filed: **May 6, 1994**

[57] **CLAIM**

The ornamental design for a fuel filter adapter, as shown and described.

[51] **LOC (6) Cl.** **23-01**
[52] **U.S. Cl.** **D23/209**
[58] **Field of Search** D23/200, 209,
D23/210; 210/167, 169, 416.4, 448, 449,
446, 452, 205, 493.4, 497.1

DESCRIPTION

FIG. 1 is a top perspective view of a fuel filter adapter showing my new design, shown in exploded assembly with a filter head which is shown in broken lines and forming no part of the claimed design;

[56] **References Cited**

U.S. PATENT DOCUMENTS

D. 128,670	8/1941	Marks	D23/209
D. 306,951	4/1990	Brandstrom et al.	D23/200
D. 356,625	3/1995	Petrucci et al.	D23/209
3,085,689	4/1963	Hering et al.	D23/209
3,993,561	11/1976	Swearingen	210/448
5,190,647	3/1993	Balestrieri	210/169

FIG. 2 is a top perspective view thereof, shown in exploded assembly with a fuel filter which is shown in broken lines and forming no part of the claimed design;

FIG. 3 is a right side view thereof;

FIG. 4 is a bottom view thereof;

FIG. 5 is a top plan view thereof; and,

FIG. 6 is a bottom perspective view thereof.

OTHER PUBLICATIONS

PGL 1000, Quick Change Fuel Adapter Kit (Installation Instruction Sheet) and Photographs of Adapter Product Shown on Sheet—undated prior art.

1 Claim, 3 Drawing Sheets

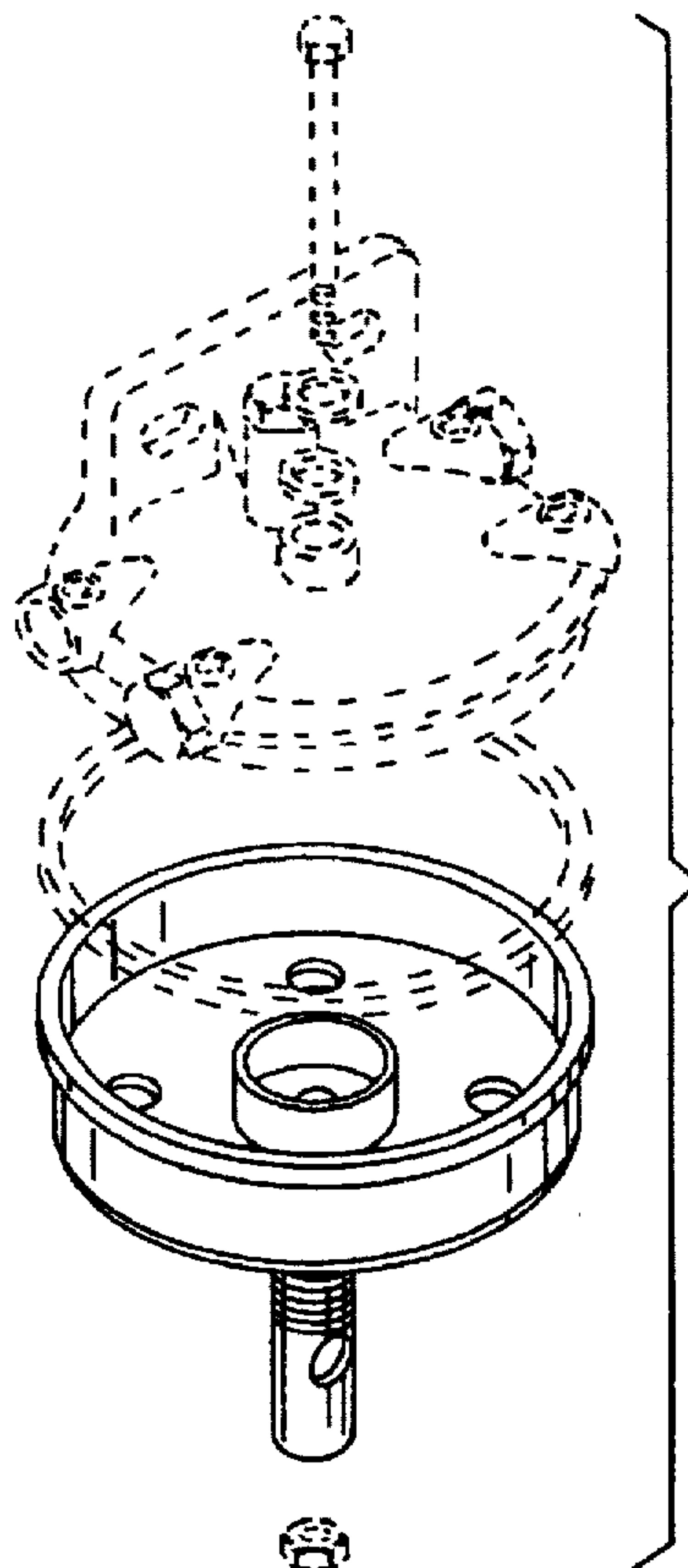

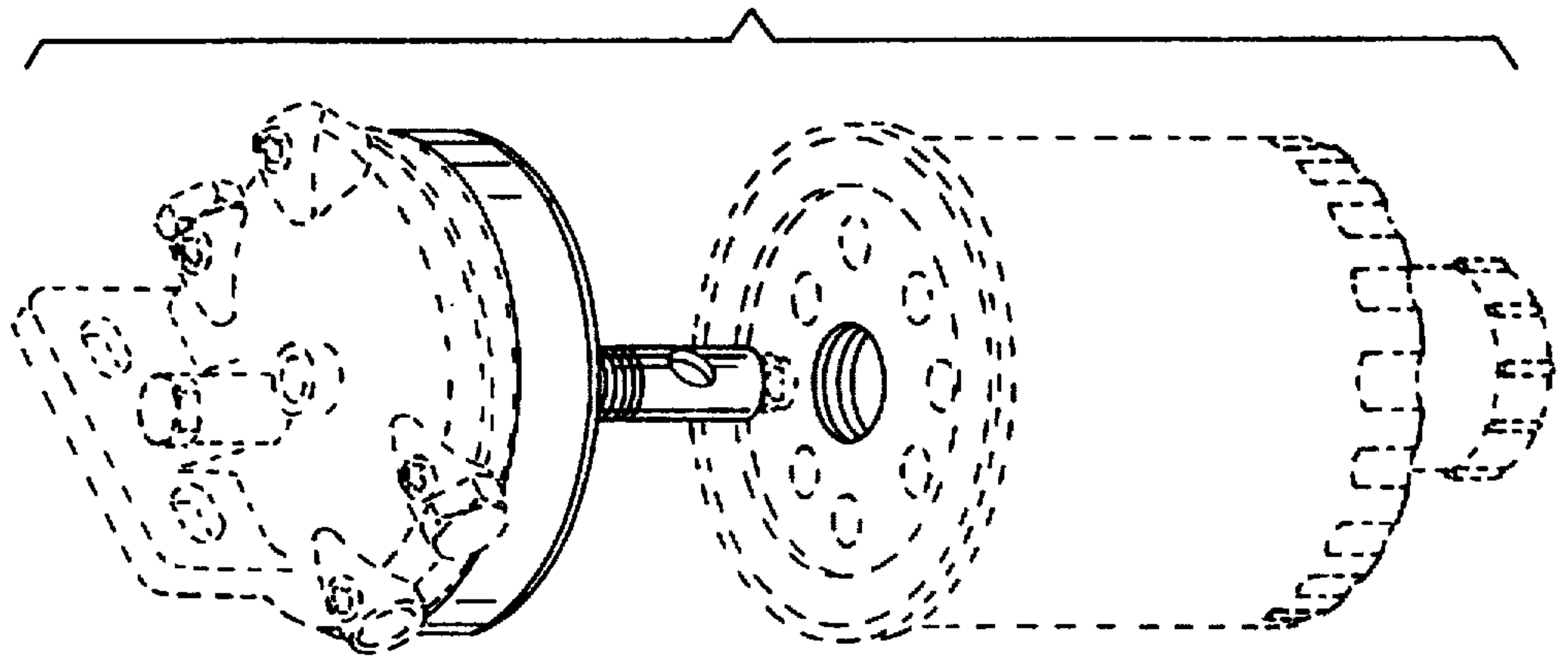

FIG. 2

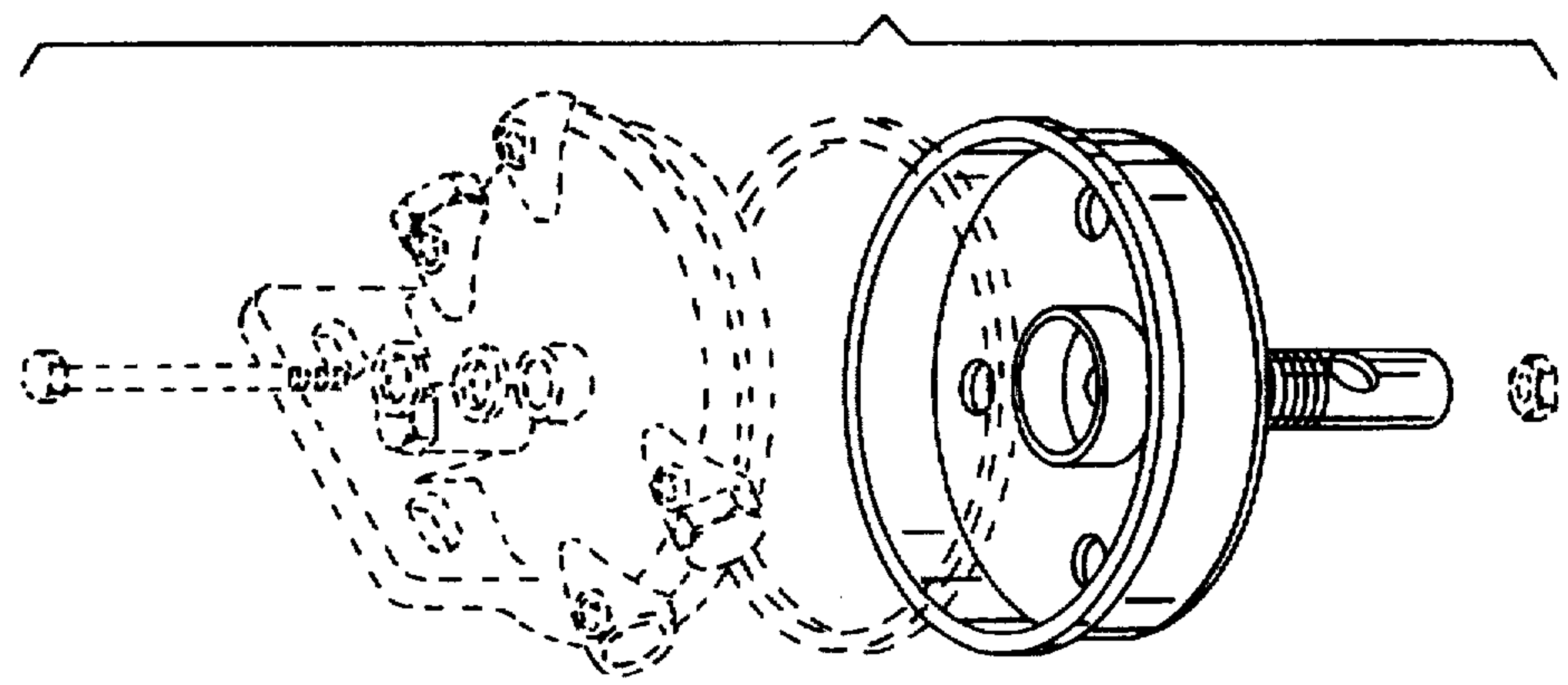

FIG. 1

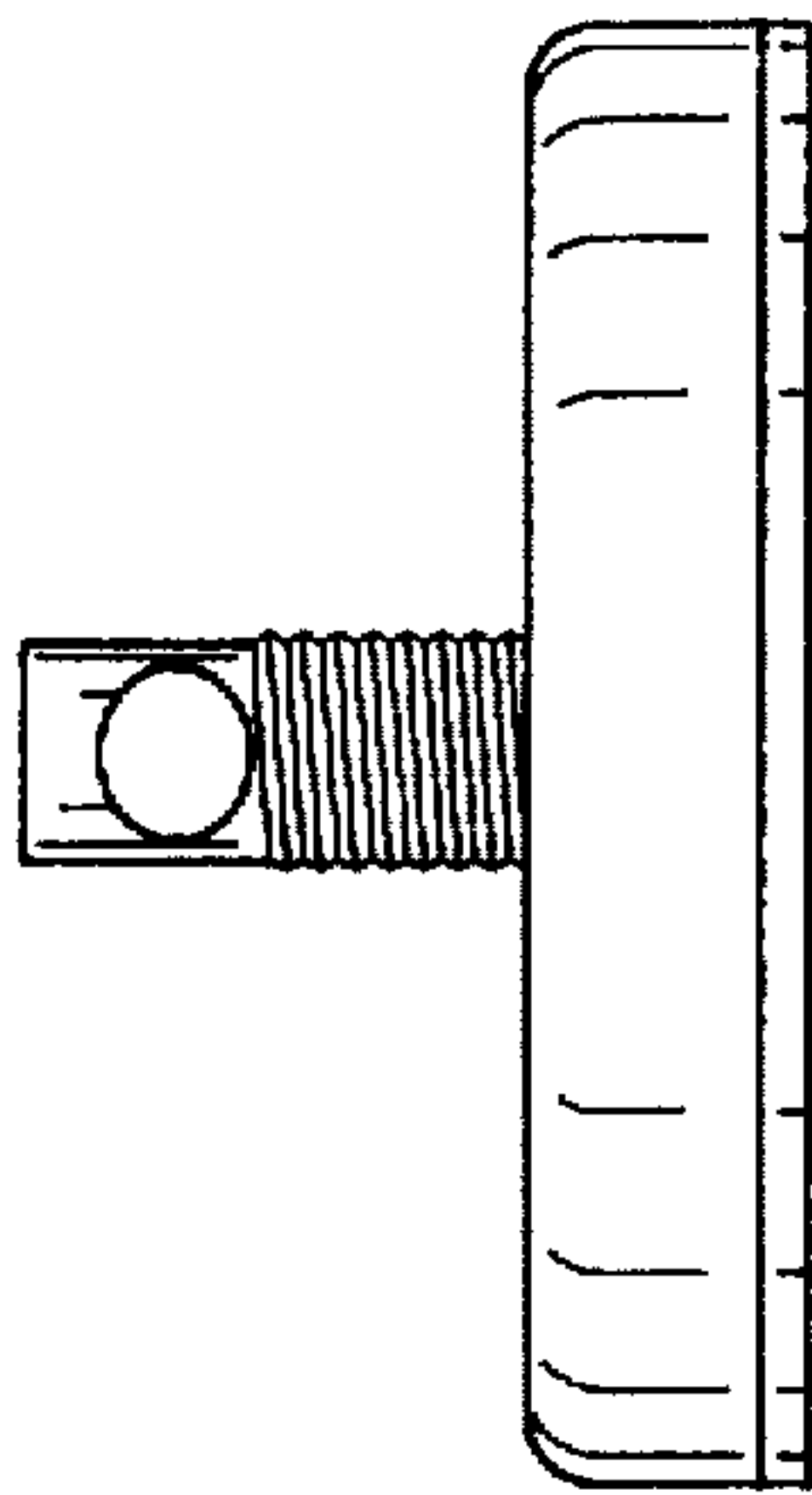

FIG. 3

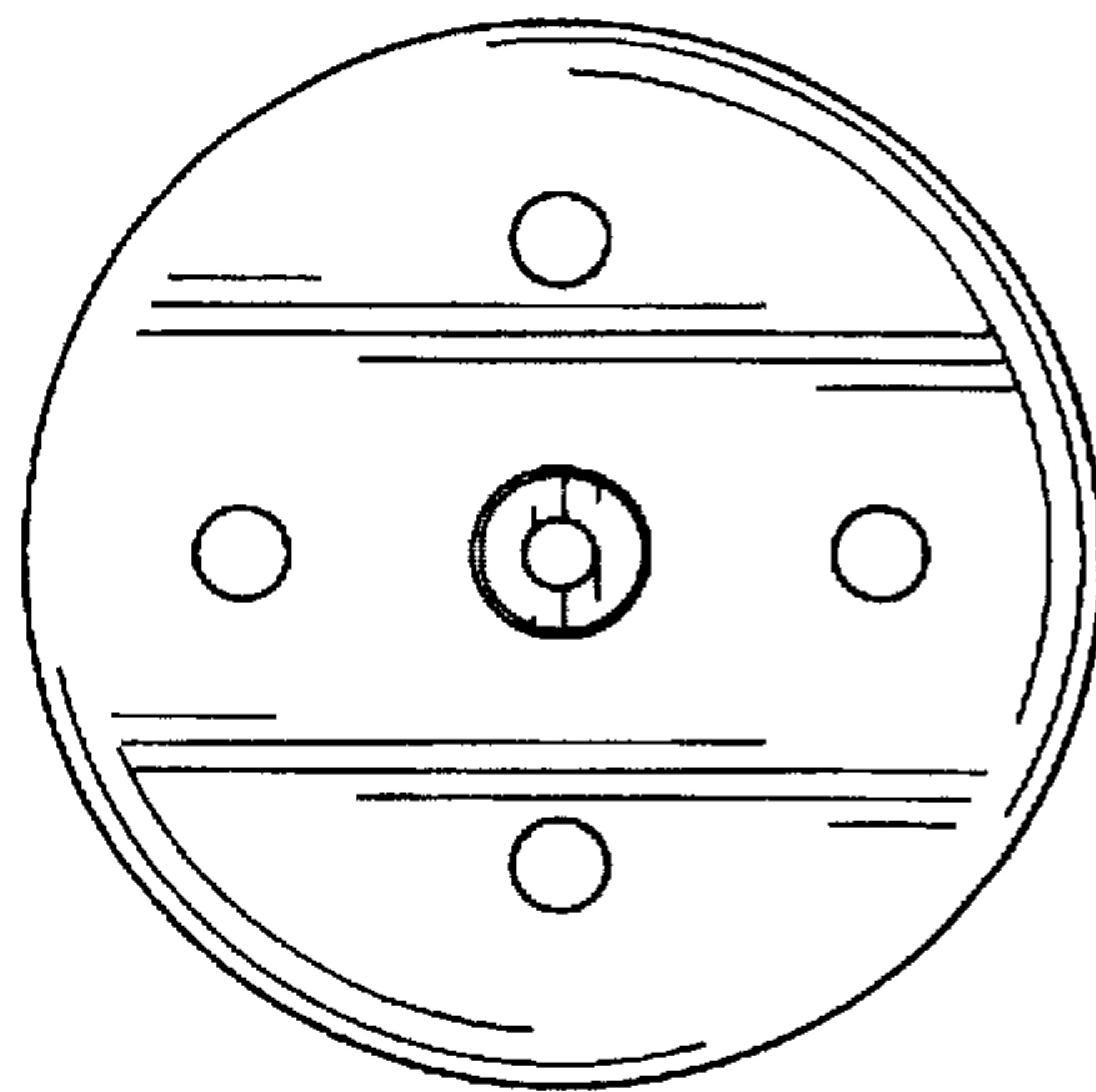

FIG. 4

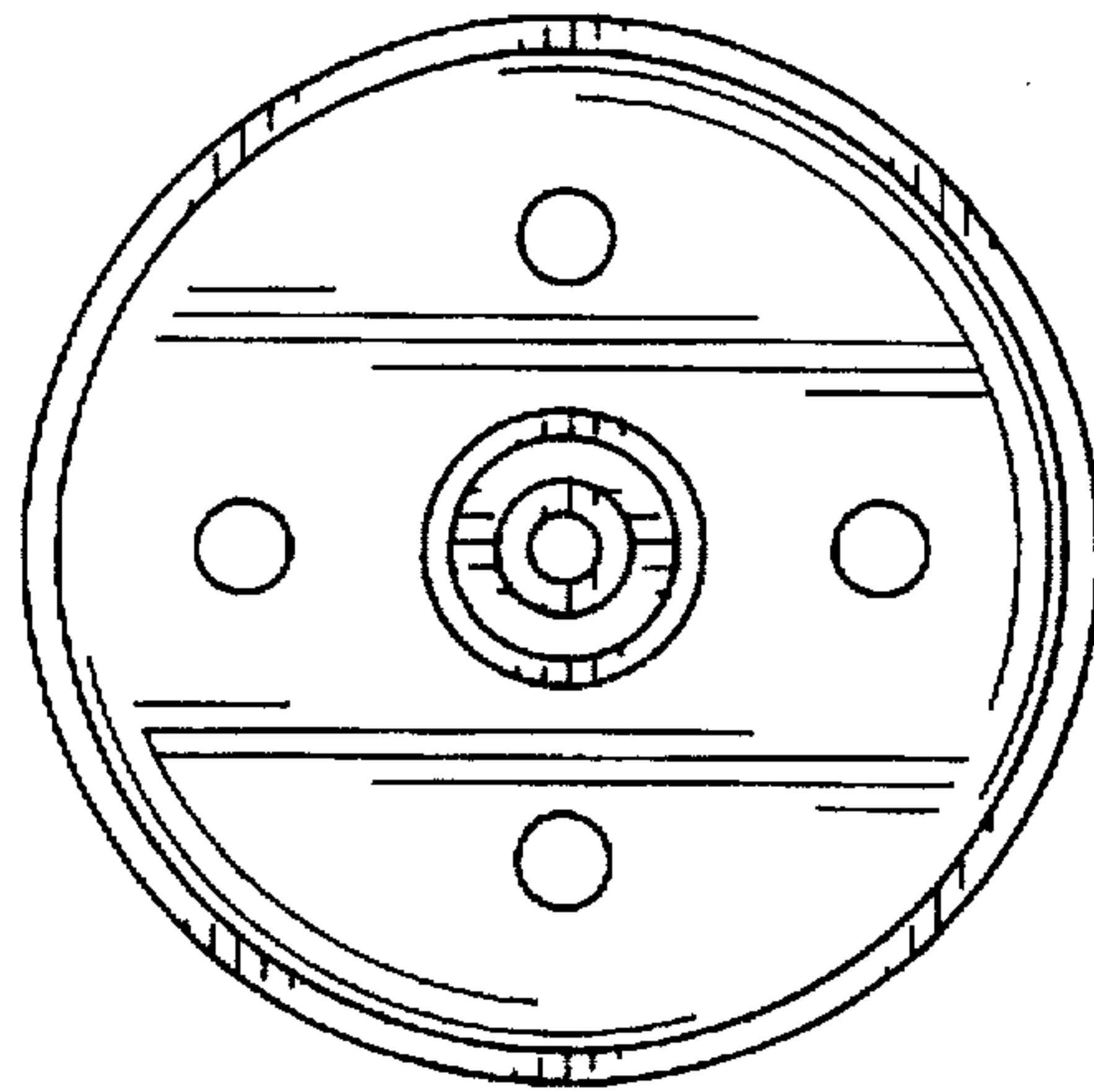

FIG. 5

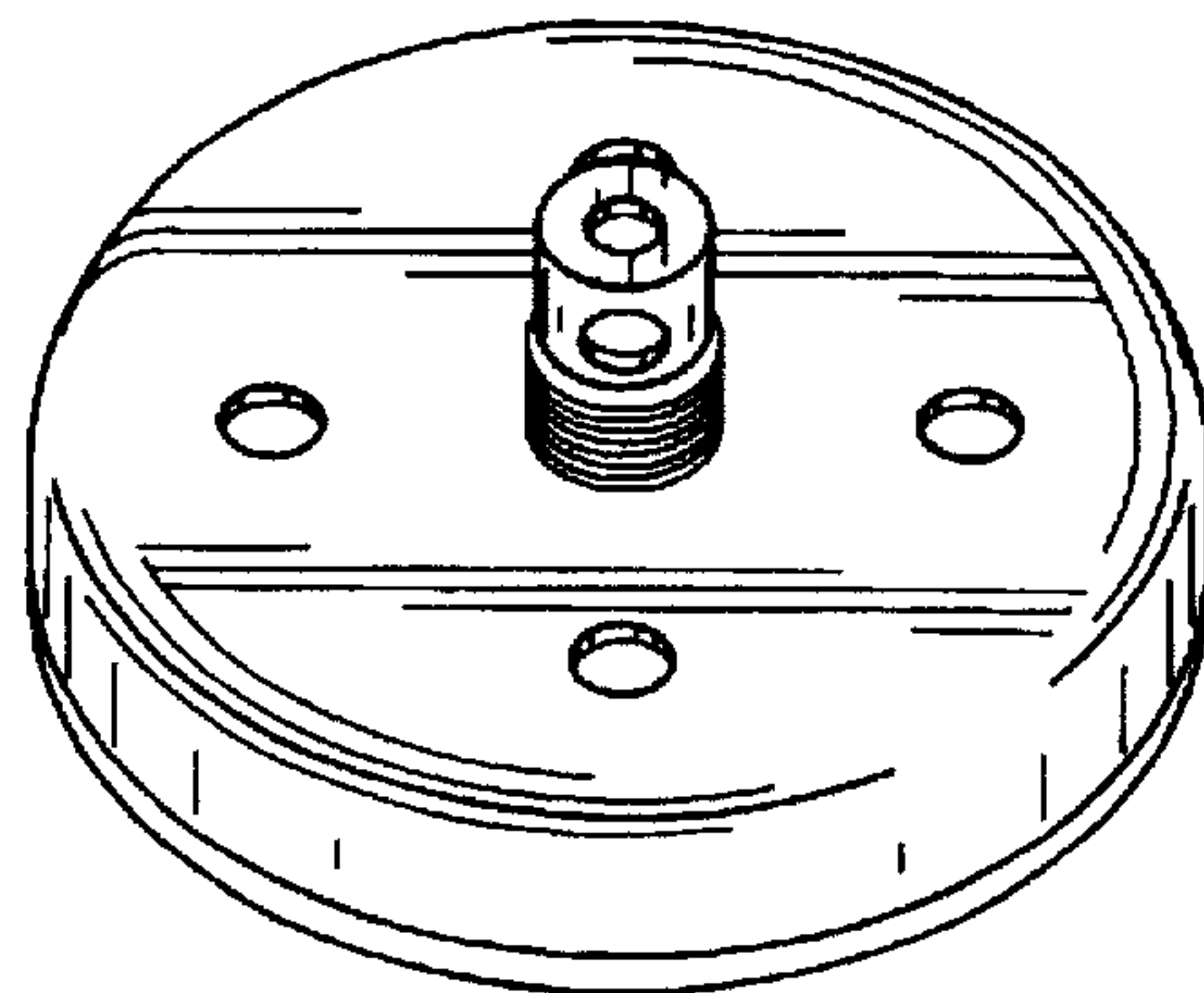

FIG. 6